

- NOTE:**
1. See the following sheets for Sections A-A through C-C, steel rail layouts, and other details.
 2. Use weathering steel for all structural steel and fastener hardware.
 3. Transition shown for curved end structure. For transition to a straight parapet end, install the timber rail so that the face of the timber rail is offset 1 inch towards the roadway.

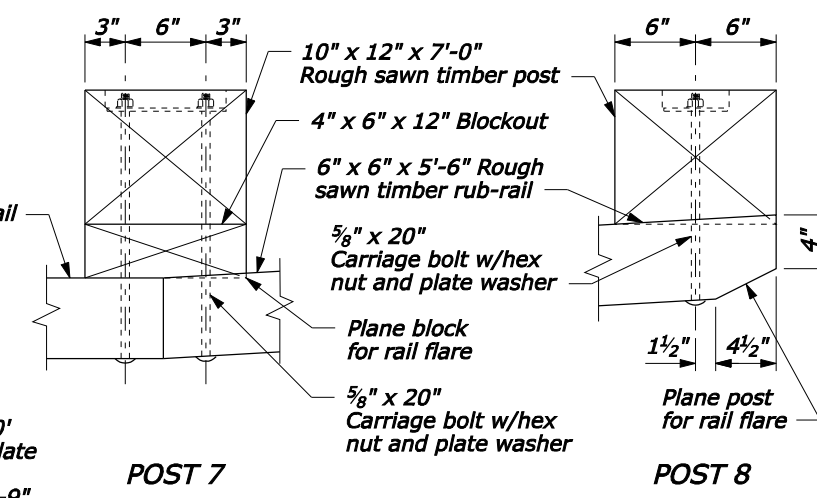

RUBRAIL CONNECTION PLAN

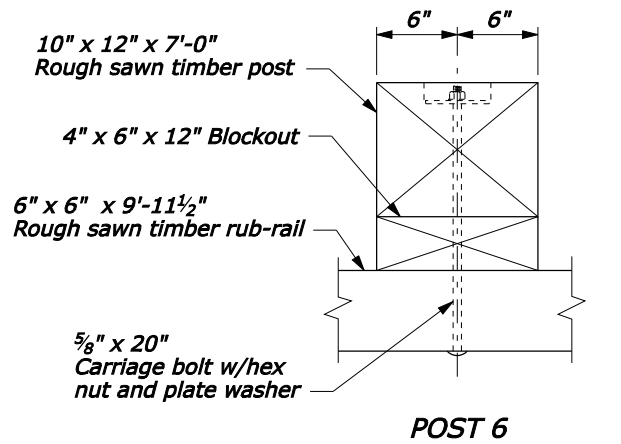
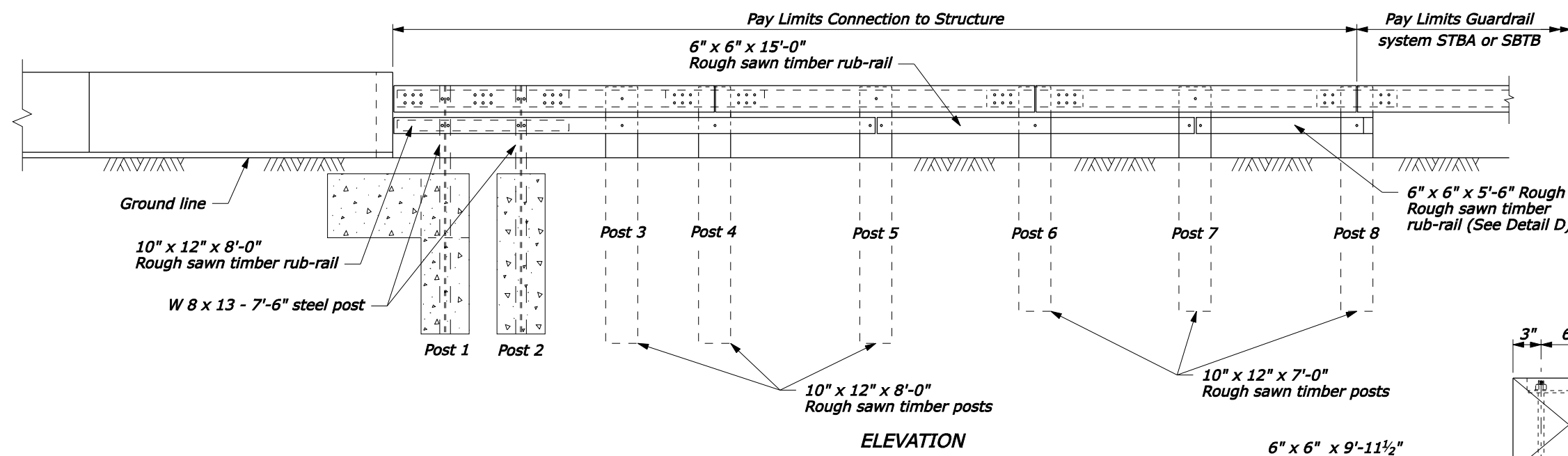
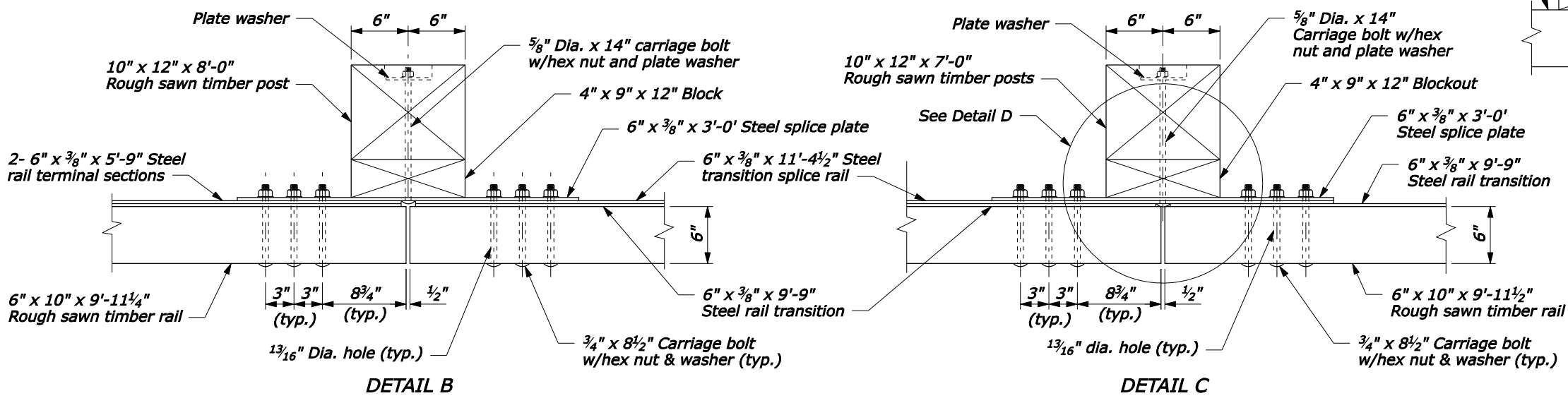

NO SCALE

U.S. DEPARTMENT OF TRANSPORTATION
 FEDERAL HIGHWAY ADMINISTRATION
 FEDERAL LANDS HIGHWAY

U.S. CUSTOMARY STANDARD
**STEEL-BACKED TIMBER GUARDRAIL
 TL-2 TRANSITION TO STRAIGHT
 OR CURVED-END STRUCTURE**
 Sheet 1 of 3

STANDARD APPROVED FOR USE --/----

REVISED: 3/2008

STANDARD 617-67

05-May-2008 04:07 PM
 P:\198.145.186.2\std. plan\std61767.dgn [US Customary]

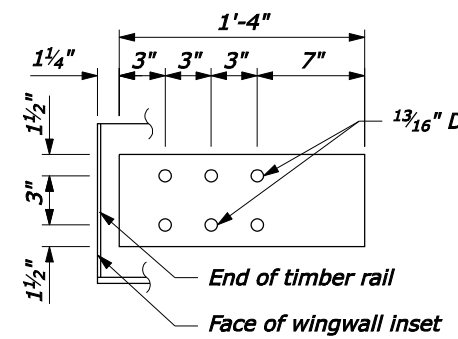

TERMINAL SECTION
6" x 3/8" x 1'-4"

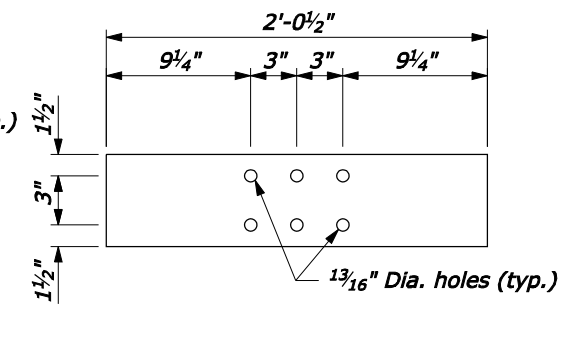

TERMINAL SECTION
6" x 3/8" x 2'-0 1/2"

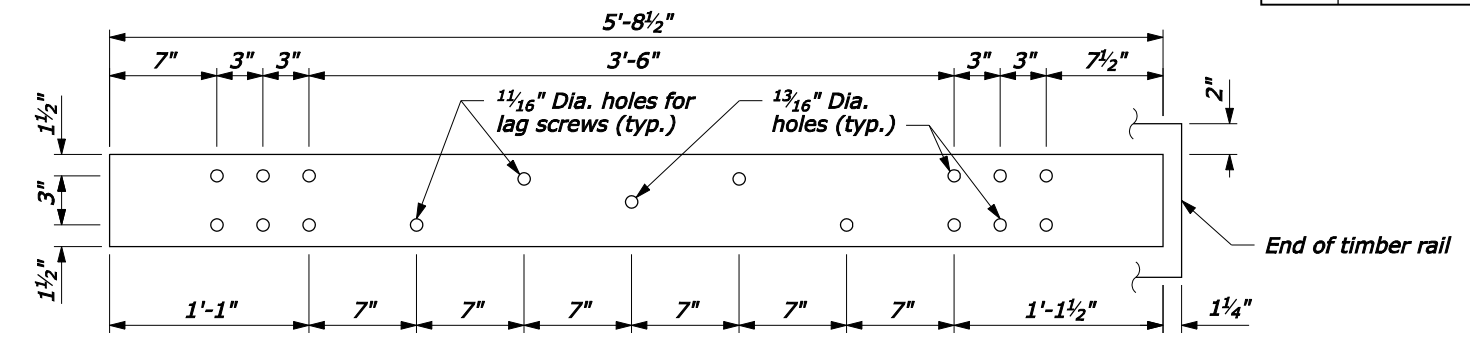

TERMINAL SECTION
6" x 3/8" x 5'-8 1/2"

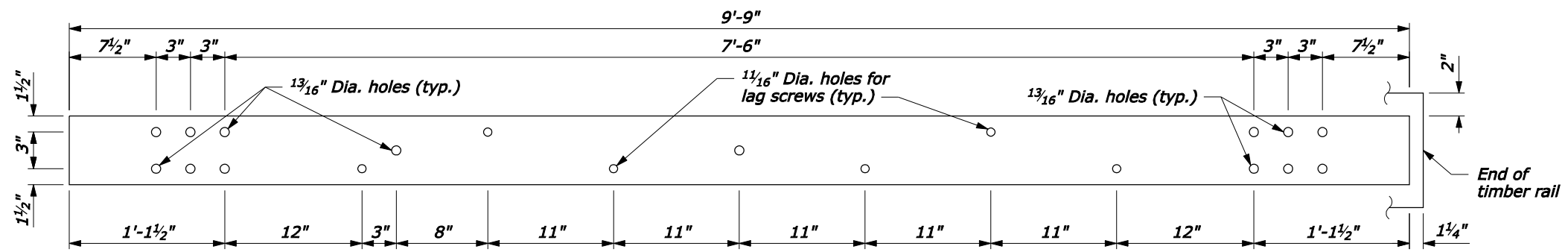

TRANSITION SECTION
6" x 3/8" x 9'-9"

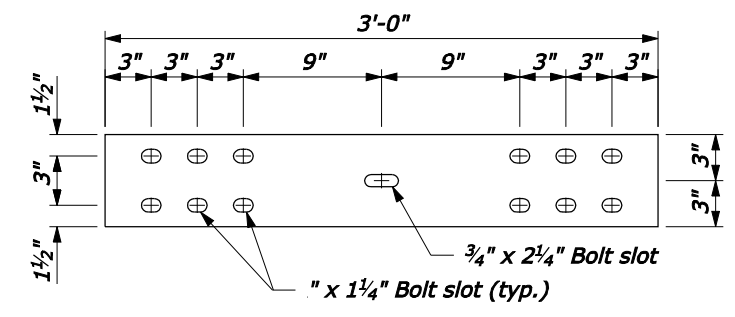

STEEL SPLICE PLATE
6" x 3/8" x 3'-0"

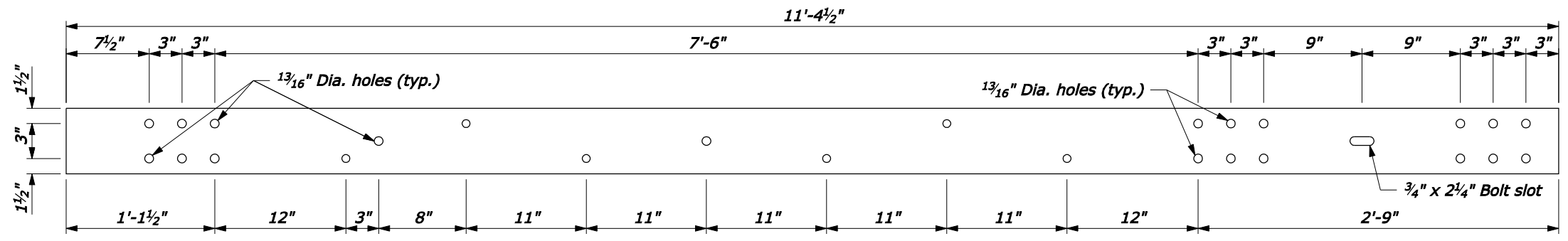

TRANSITION SECTION
6" x 3/8" x 11'-4 1/2"

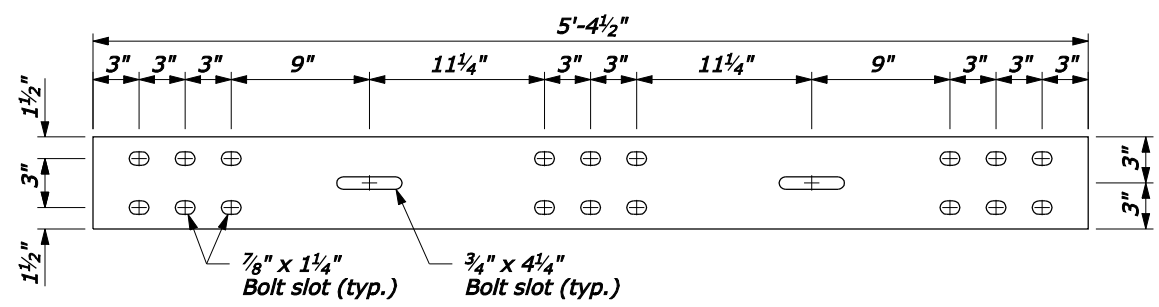

STEEL SPLICE PLATE
6" x 3/8" x 5'-4 1/2"

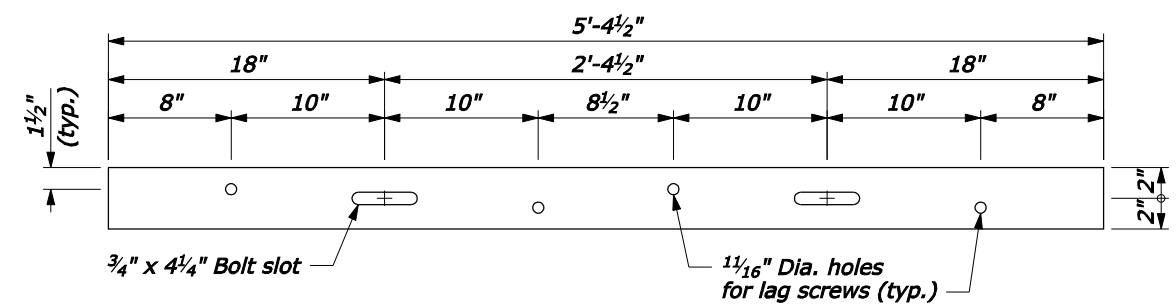

RUB-RAIL TRANSITION SECTION
4" x 3/8" x 5'-4 1/2"

NO SCALE

U.S. DEPARTMENT OF TRANSPORTATION
FEDERAL HIGHWAY ADMINISTRATION
FEDERAL LANDS HIGHWAY

U.S. CUSTOMARY STANDARD
**STEEL-BACKED TIMBER GUARDRAIL
TL-2 TRANSITION TO STRAIGHT
OR CURVED-END STRUCTURE**
Sheet 3 of 3

STANDARD APPROVED FOR USE --/----	STANDARD
REVISED: DRAFT: 3/2008	617-67

05-May-2008 04:08 PM P:\198.145.186.2\std. plan\std.1767.dgn [US Customary]