

THE GAZETTE

Published for members of the SHAPE/Chièvres, Brussels and Schinnen communities

Crossage

Due to the traditional Crossage held Feb. 13, the streets in Chièvres will be blocked off to all traffic. Deviation signs will be posted. Gate 14 to Chièvres Air Base will be closed all day but access to Caserne Daumerie will remain possible from the Chièvres traffic circle.

Chièvres commissary

The Commissary phone numbers are operational again. The community can dial the regular numbers again at DSN 361-6480 or civilian 068-27-6480.

Self Help Store

The Self Help Store on Chièvres Air Base will be closed until further notice except for the loaning issue and turn-in of material. This means that free self-help items are not available at this time.

Gazette submissions

Send your requests for publication to usarmy.benelux.imcom-europe.list.pao@mail.mil.

Schinnen ACS

The USAG Benelux-Schinnen ACS located in Bldg. 39 is now open Friday, 8:30 a.m. to 4:30 p.m.

New PXtra and Exchange hours

Beginning March 2, the PXtra will open on weekends from 10 a.m. to 7 p.m. The Main Store Exchange will now open on Sundays from 10 a.m. to 6 p.m.

U.S. community adopts Dutch traditions



Rita Hoefnagels

Table of Contents

News.....	1-9
Benelux news.....	10
Events & Happenigs.....	11-13
Community Roundup.....	14

Mayor of Schinnen, Mr. Berry Link participated in the USAG Benelux-Schinnen on post Carnaval festivities Friday, February 8, 2013, in an authentic and historic mayor's costume as worn in the 1900s. Tradition has it that the Mayor hands over the keys of the city to the Carnaval prince and princess. In this case, Ms. Kimberley Wayland, Deputy Garrison Manager handed over the key to the gates of Schinnen to Prince John and Princess Marleen, giving the princely couple of USAG Benelux-Schinnen the authority for the afternoon.

First community run takes place on Chièvres Air Base

Keith Houin



USAG Benelux Command Sgt. Maj. Romeo Montez III leads the runners at the start of the 5k run at Chièvres Air Base Saturday, February 9, 2013. The 5k is the first of a series of 5ks that will take place at on Chièvres Air Base and SHAPE. The next run is scheduled for March 2.

THE GAZETTE

To subscribe, email usarmy.benelux.imcom-europe.list.pao@mail.mil

Col. Sergio Dickerson
USAG Benelux
Commander

Marie-Lise Baneton
USAG Benelux
Public Affairs Officer

Editor
Cis Spook

Staff Writers
Rita Hoefnagels
Donovan Abrassart
Keith Houin

The Gazette is an unofficial publication published under the provisions of AR 360-1 for members of the Department of Defense. Contents of *The Gazette* are not necessarily the official views of, or endorsed by, the U.S. Government, Department of the Army or the USAG Benelux. *The Gazette* is a free weekly publication distributed via email every Monday, except when that day is an American, Belgian or Dutch Holiday, then *The Gazette* is published on Tuesday. The editorial content of this publication is prepared, edited, provided, approved and published by the USAG Benelux Public Affairs Office, Unit 21419, APO AE 09708. Telephone (0032) 068-27-5419/DSN 361-5419. Everything advertised in this publication will be made available for purchase, use or patronage without regard to race, color, religion, sex, national origin, age, marital status, physical handicap, political affiliation or any other non-merit factor of the purchaser, user or patron. If a violation or rejection of this equal opportunity policy by an advertiser is confirmed, the publisher will refuse to print advertising from that source until the violation is corrected. The appearance of advertising in this publication, including inserts or supplements, does not constitute endorsement of the products or services advertised by the U.S. Army. Submit content or story ideas to usarmy.benelux.imcom-europe.list.pao@mail.mil by Thursday at 3 p.m.

SHAPE INTERNATIONAL SCHOOL

Construction continues on \$146 million international school campus

By **Vince Little**
USACE

The U.S. Army Corps of Engineers is managing a major push into upgrading decades-old buildings on the NATO base here as part of an endeavor that will have a lasting impact on the culture and mission of Supreme Headquarters Allied Powers Europe, military and education leaders say.

The centerpiece is a multinational-funded, \$146 million construction project at SHAPE International School, the largest under way within USACE Europe District. It'll result in a sprawling international campus by the summer of 2018, represented by 22 NATO nations and featuring state-of-the-art facilities, educational programs and models for the entire community.

"USACE is spearheading this effort for the entire group – how often does the Corps get to do that?" said Steve Keen, the SHAPE International School project manager for Europe District. "SHAPE is looking to foster the relationship among children of international nations. This was specifically designed for that. As most parents know, if the kids are OK, they're OK. This will be a treasure of a campus."

The phased project includes the building of new American elementary, middle and high schools at the SHAPE site. Those facilities are slated for completion in 2014.

The United Kingdom/Canada and Germany buildings should be finished by the summer of 2016. Two years later, work is expected to wrap up on the new school for students from Norway, Italy, Turkey and Poland.

U.S. officials said the campus overhaul is the first domino in an enhanced quality-of-life package being forged at SHAPE, aimed at making Belgium a destination of choice for American troops and their families.

"It's more of a university-style campus, and the kids will mix and interact. It truly becomes an international institution," said Bob Sommer, Europe District's Benelux regional program manager. "We want

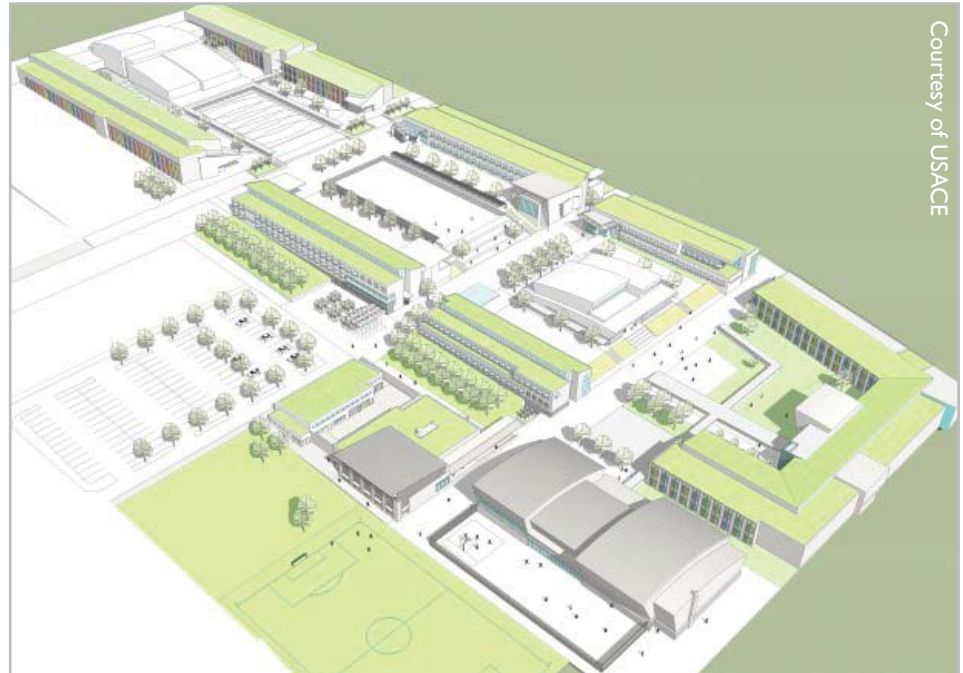

The original design of the project

to make SHAPE the first post of choice. We want to show that Belgium isn't like other countries. It has everything. It's a great place for kids to learn, great place to live."

Once finished, SHAPE International School facilities will go from 83 percent substandard to 100 percent "cutting edge," said Air Force Maj. Curt Fryman, the lead SHAPE engineer, citing environmental surveys and assessments.

"We want to show prospective SHAPE members that their families will be well supported here with an outstanding environment in which to learn," he added. "You don't want them to fall behind and hurt their future. This is something that's going to enhance their future and education, not hinder it."

Europe District Benelux Resident Engineer Jonathan Carr said school facilities in use now were designed to be temporary when first built in the 1960s. Planning for the new campus began several years ago, and ground was broken in January 2012.

In recent years, the biggest problem facing school administrators has been a

lack of space, said Benoit Davin, SHAPE International School's director general. This provides a solution while raising academic possibilities for students and teachers alike.

"It'll be like going from an old car to a Mercedes," he said. "Our space situation will improve dramatically. The quality of infrastructure has an impact on the quality of education. The quality of infrastructure will be much better.

"There's been a clear evolution in terms of technology implementation at SHAPE. We've gone from blackboards to computers in the classroom. This will benefit us with better tools for teachers and students."

Davin said SHAPE International School is a unique model and confederation of various curriculums, languages and elements. It's a complex operation, but part of his job is to promote integration and collaboration among all the national elements, including faculty and students.

"Our school is a small microcosm of NATO," he added.

Balancing the design building codes – every nation has a different standard

Continued on next page

SHAPE School I Continued

-- for the campus construction project has been just as complicated, Sommer said. At a minimum, they must meet the Belgian benchmark since it's being built in the host nation. U.S. standards are being used for a large portion of the design -- Department of Defense Dependents Schools-Europe is funding the three American schools, while international money goes toward the four additional buildings on campus. Planners made tweaks in the blueprint to satisfy individual country requirements in the other nation-funded buildings.

Europe District's support of mission readiness, quality of life and infrastructure improvements at SHAPE extends beyond the classroom.

In December, the new NATO Special Operations Headquarters was unveiled at a ribbon-cutting ceremony attended by top U.S. and international military officials. The facility will allow those forces to plan, coordinate and conduct vital missions around the globe.

"I expect this headquarters to be a venue for ideas about equipment, technology and how we can share that and learn from each other," Adm. James Stavridis, NATO's Supreme Allied Commander Europe and the head of U.S. European Command, said during the Dec. 12 event. "Every nation brings an idea. This must be a venue for ideas about what we use to accomplish our missions as well."

"Special forces (and) special operations... are trained to go behind enemy lines, to destroy aircraft, to destroy ordnance, but above all, to force the enemy to watch for them, to devote forces so that they can be diverted from the front lines. This kind of warfare is very effective, and part of the kind of ideas that we look to see from this venue moving forward."

Lt. Col. Michelle Garcia, the district's deputy commander, said all the construction projects at SHAPE are being engineered with the latest technological advances, modernization and environmental cost-saving features. As the military enters an era of shrinking budgets, USACE is placing even greater emphasis on planning, coordination and teamwork.

"Partnership is key to everything we do as the Army Corps of Engineers," she said. "We work with our partners to help them develop their scope, understand the cost of their requirements and help that fit into their budget. And then we work with our partners as we oversee the construction of the projects, like here."

"As engineers, we solve problems. One of the problems we can solve for our partners and customers is to provide them options for how they can best utilize the dollars they have. Sometimes, it's savings upfront, with cost-saving measures during construction. Sometimes, it's a cost savings on the back end, on the operations and maintenance end, where we can help them use some sustainable technologies to reduce operations and maintenance costs at these facilities."

The NSHQ is the first purpose-built facility designed for use by a NATO operational commander since SHAPE moved from France to Belgium in 1967.

"The investment being put into our schools, all our member nations and the SHAPE international community here is phenomenal," Air Force Lt. Gen. Frank Kisner, the NSHQ commander, said at the ribbon-cutting ceremony. "The Army Corps of Engineers resident office did some great work for us."

Paying local bills saves money, time

Special to the Gazette

The Legal Assistance Office has helped clients from our community that are being required to pay €250 to €300 for an initial bill of €50. Why? After several reminders, collection agencies will recover unpaid bills. Those agencies charge at least €100 for each act of recovery.

Utilities

If you rent a house, you will have bills for utilities but you might also have bills for the water company, waste removal, waste recycle, and sewer maintenance.

If you are in government housing all you need to do is hand these bills over to your housing office and they will inform you how to process those bills. If you rent a house on the economy, you must pay those bills. It states in the Shape-Belgium Agreement that these bills will be paid by the tenant if you live on the economy.

Also, when you move, you must notify the town hall of your new place of residence within seven days if you move within the same city or 15 days if you move to a different city. If you move to a different city you are also required to report your change of residence to your previous town hall. You will show them your Belgian ID and update your resident information with them. Most of the time it is free. The bills will then be forwarded to your new address. If you don't comply with these requirements you will be liable for bills that go to your previous address even if you are not aware of them.

Hospital Bills

We also have clients that have unpaid hospital bills. Tricare will pay the hospital bills but you will be required to pay the collection agency fees; Tricare will not pay these. You should check the status of your Tricare/Hospital bills regularly. If the payments are late, you will face additional costs that will not be refunded by Tricare.

Also note if you get a receipt in the mail from the post office indicating you have mail, this is likely a registered mail. You must pick this mail up at the Belgian Post Office indicated on the form. Many times, it is a reminder for an unpaid bill, so do not ignore it. Either pay the bill or give it to your housing office.

For any questions do not hesitate to contact your housing office or make an appointment with the Belgian legal advisor from the Northern Law Center at DSN 423-4868 or civilian 065-44-4868.

Roots and Shoots club collects for Wounded Warriors

Special to the Gazette

Students from the SHAPE Elementary School Roots and Shoots Club collected nine big bags of clothing items for the Wounded Warriors at Landstuhl Regional Medical Center in Germany.

More than 600 wounded warriors per month use the Landstuhl Clothes Closet. When injured Soldiers are taken to the hospital they literally only have the clothes on their backs. The Clothes Closet provides, free of charge, all of the immediate necessities such as sweat pants, sweat shirt, underwear, socks, shoes and personal care items.



From left to right: Ms. Janice Williams, Mayu Gayton, Jacob Yezpe, Martina Jenkins, Katlyn Payne, Ana Yezpe, and Ms. Stephanie Scott prepare the donation boxes.



Mayu Gayton and Martina Jenkins are collecting donations for the wounded warriors at Landstuhl, Germany.

Last year several teachers from SHAPE Elementary School attended Dr. Jane Goodall's lecture in Brussels. These teachers were so inspired by the lecture that they returned to school the next year determined to start up a club that would make a difference in the animal and human communities. They

established a chapter of Dr. Jane Goodall's Roots & Shoots program and began working with over one hundred students on projects like a cellular phone recycling drive, adoption of orphaned chimpanzees and, most recently, a drive to collect much needed items for the wounded warrior program.

If you missed the clothing drive and would like to help out by donating clothing, it's not too late. Stop by the American Elementary School office and put any donations in the Wounded Warriors box. The Soldiers who will be arriving at Landstuhl Regional Medical Center will appreciate it. The Clothes Closet still needs:

- Men's Boxer shorts (any type), sizes M, S and L
- Gray or black, long sleeved sweatshirts, sizes M and L
- Flip flops, shower shoes, size 8-11
- Small travel size mouthwash
- White socks, ankle only
- Sweatpants M, L, XL
- Men's running shoes, sizes: 9, 9.5, 10, 10.5, 11, 11.5 and 12

Stay safe during local Carnival and crossage festivities

In order to fully enjoy the local festivities, take into account some basic safety tips. It may be the first time you are participating in these events, so take particular attention to safety, both for you and your family members.

- Parents should be aware that those who are riding on the parade vehicles throw candy treats along the route. Extra caution needs to be taken to insure children don't run into the street to retrieve candy and risk being hit by a parade vehicle. In some cities, like in Binche, oranges are being tossed into the crowd. Pay close attention and make sure you or your kids don't get hurt.
- Alcohol consumption is quite common during the festivities. Be prepared and have a plan. If you are consuming alcohol, don't drive. Prior to consume alcohol, make sure you have a designated driver.
- Guard your wallet, purses and personal items as these crowded areas are ideal opportunities for pick pockets.
- During the traditional Crossage in Chièvres, participants are playing on the street with a wooden "rabort" and "chôtelette" (mallet and ball). The game can be compared to croquet or golf but since several players can be tossing wooden balls the size of a grapefruit at the same time in different directions, make sure you don't get hit. Players shout "Chôtelette" when they strike the ball to warn others nearby that the ball is in play.
- For safety reasons, the city of Chièvres is closed off to all traffic during Crossage on Feb. 13.

FEBRUARY IS AMERICAN HEART MONTH

Protect your heart during winter weather

By Laura Vasquez, Program Evaluator
U.S. Army Public Health Command

Every year, heart attacks claim thousands of lives during harsh winter weather. Heart disease is the number one killer of both men and women in the United States. Winter weather and winter weather activities, particularly shoveling snow, increase a person's risk of a heart attack due to overexertion. Cold weather, combined with a sudden change in physical activity, increases the heart's workload.

February is American Heart Month and a good time to learn how to prevent or react to a heart attack, particularly during the winter months.

It's important to know your risk factors for a heart attack. The elderly and those with heart disease are at highest risk. Being male or having a family history of heart disease also

This winter, before heading out to shovel snow, consider your risk factors and take appropriate precautions. Taking certain precautions can be the difference between life and death.

Winter Weather Tips for the Heart:

- Take frequent breaks when shoveling snow.
- Use a small shovel or consider a snow blower.
- Don't eat a heavy meal prior to shoveling to avoid the extra load on your heart.
- Don't drink alcohol before or immediately after shoveling.
- Be aware of the dangers of hypothermia.
- Consult your doctor prior to exercising in cold weather.
- Learn CPR to increase a victim's chances of survival.
- Learn heart attack warning signs.

Warning signs of a heart attack are often ignored or overlooked. Heart attacks often start slowly with mild symptoms. Many people do not know the warning signs and often wait too long before getting help. Minutes matter during a heart attack, and early treatment greatly increases the chances of survival. Learn the signs of a heart attack and you can help save a life.

Warning Signs of a Heart Attack:

- Chest pain or discomfort
- Discomfort in upper body, including arms, back, neck, jaw, or shoulder
- Shortness of breath
- Nausea, lightheadedness, cold sweats

If these signs are present, call the emergency services immediately.

This winter, make sure to take precautions to prevent a heart attack—know your risk factors, check on your elderly neighbors and learn the warning signs of a heart attack. Remember, prevention and early action save lives.

For more information and tips on preventing heart attacks, visit



U.S. Army Photo courtesy of Marny Malin

Winter weather and winter weather activities, particularly shoveling snow, increase a person's risk of a heart attack due to overexertion. Cold weather, combined with a sudden change in physical activity, increases the heart's workload.

puts you at a greater risk. Some risk factors are within your control to change by adjusting your lifestyle or taking medications. These include quitting smoking, exercising regularly, maintaining a healthy weight and controlling high blood pressure or cholesterol.

these Web sites:

- American Heart Association, www.heart.org
- U.S. Centers for Disease Control and Prevention, www.cdc.gov/heartdisease/heart_attack.htm.

598th Transportation Brigade (SDDC) news

Special to the Gazette

After a period of almost 30 years, the 598th Transportation Brigade (SDDC) has officially closed its headquarters in Capelle aan den IJssel, the Netherlands. The keys of the former SDDC building were symbolically transferred to the owner, Jan. 31.

All Military and DoD Civilian personnel have completed the relocation to Sembach, Germany. A remaining contingent of over 30 Dutch Ministry of Defense Civilians moved to the Van Ghentkazerne in Rotterdam, the Netherlands and will continue to handle northern port distribution for the

Military Surface Deployment & Distribution Command (SDDC).

Col. Matthew D. Redding, Commander, 598th Trans BDE (SDDC) officially opened the new office building for the Benelux Detachment, Feb. 1. He spoke of his gratitude to the workforce, comprised of Dutch local nationals, American, Belgian, and Dutch military and civilian personnel were there to witness the start of this new chapter for SDDC. Redding reiterated special thanks for the hospitality of the Royal Dutch Marines and the Dutch Ministry of Defense for their assistance in establishing the temporary facility.

Redding also thanked the Capelle aan den IJssel authorities for the continuous support and patience that SDDC received over the years and highlighted the partnership that the U.S. Army and the Dutch have enjoyed. After the terrorist attacks on the United States (Sept. 11, 2001) the security posture of the building changed the area around the building in Capelle aan den IJssel. Redding said: "We are still grateful for the sympathy and support we received during our mission here from our neighbors and Capelle City Hall. Looking back it was great living and working in Capelle aan den IJssel."

The move of the Brigade Headquarters is part of a larger U.S. Army consolidation plan that affects over 30,000 U.S. Forces this summer. These unit movements are designed to



Col. Matthew D. Redding, Commander 598 Transportation Brigade (SDDC) and Lt. Col. RNLMC Bert Aben, Commander Van Ghentkazerne, cut the ribbon during the Opening's Ceremony for the SDDC Benelux, Friday, February 1, 2013.

consolidate American forces and create efficiencies in command structure and operating costs. The strategic importance of the Benelux Region is highlighted by the fact that the brigade will maintain an operational detachment in a semi-permanent building placed on the premises of the Van Ghentkazerne.

SDDC is the Army Service Component of the U.S. Transportation Command and is a major subordinate command to Army Materiel Command. SDDC is a global U.S. Army command that delivers world-class distribution solutions through planning and execution of movements for the delivery of equipment

and supplies. In Fiscal Year 2012, SDDC moved more than 126.4 million metric tons of cargo in support of U.S. forces worldwide. Current SDDC missions and operations tempo requires management and execution of over five billion dollars per year.

The roots of the 598th Transportation Brigade (SDDC) go back to 1945, when a tremendous influx of U.S. military cargo was transported to build up Europe after WWII. The port operations were initially orchestrated from Bremerhaven, Germany. In 1957 a sub-port was activated in Rotterdam. This became the Benelux Terminal. The command headquarters moved to Jobshaven, Rotterdam in 1970 and was transferred from the 4th Transportation Brigade (USAREUR) to the Military Traffic Management Command (MTMC) during that same year. The 598th Headquarters occupied the office building in Capelle aan den IJssels in 1983.

The 598th Transportation Brigade (SDDC) is a regional transportation command with manned sites in eight European countries. It operates in multiple European ports handling well over three million metric tons of cargo per year. The command executes SDDC's worldwide mission in the U.S. European Command, U.S. Africa Command, U.S. Central Command, and wherever else needed.

Tax information



Many United States residents mark Tax Day as the deadline to file their income tax details to the Internal Revenue Service (IRS). The date is usually on or around April 15. However, this deadline is not applicable to the U.S. military overseas as their deadline is June 15.

If you need assistance in filing your income tax, USAG Benelux has opened four tax centers in the Benelux which are listed below. Don't wait until the last minute to request assistance, contact one of the centers to make an appointment.

SHAPE - Bldg. 318, room 207

DSN: 423-4906

Civilian: 065-44-4906

Hours: Monday to Friday, 9 a.m. to 4:30 p.m.

Chièvres - Food Court area of PX

DSN: 361-5706

Civilian: 068-27-5706

Hours: Tuesday to Saturday, noon to 7 p.m.

Brussels - Bldg. 4, second floor

Drop off only on Tuesdays 9 a.m. to 3 p.m.

Schinnen - Bldg. 37

DSN: 360-7688

Civilian: 046-443-7688/7691

Hours: Monday to Friday, 9 a.m. to 4 p.m.



REPORT SUSPICIOUS ACTIVITY OR BEHAVIOR

SHAPE/CHIEVRES - DSN 361-5301 or civilian 068-27-5301

SHAPE Police Desk - DSN 423-3333/3334 or civilian 065-44-3333/3334

BRUSSELS - DSN 368-9769 or civilian 02-717-9769.

SCHINNEN - DSN 360-7555 or civilian 046-443-7555

Keeping energy costs down

As you all know, money is tight for the Department of Defense. Utility expenses represent a significant "must pay" bill for the Army and on a per unit basis, energy costs are rising much faster than the standard rate of inflation. As a result, new guidance had to be set to continue our efforts in saving on energy costs:

- During the heating season, temperatures in occupied facilities will be maintained at 68 degrees Fahrenheit (20 degrees Celsius) during working hours and heating setback temperatures during unoccupied times shall be set at 55 degrees Fahrenheit (13 degrees Celsius).
- Wherever mechanical cooling is authorized, cooling season temperatures for occupied working and living spaces shall be maintained at 78 degrees Fahrenheit (25.5 degrees Celsius) and 85 degrees Fahrenheit (29.5 degrees Celsius) during unoccupied times.



Cis Spook

- To respect these changes, make sure that your thermostat valve is not over '3' and that your thermostat and/or Heating Ventilation Air Conditioning (HVAC) temperature set-points correspond to these new values.
- Turn off everything that is not necessary (lights, equipment, etc.) especially at the end of the day.

Together we can make the difference and as you adopt these measures at work, why not do the same at home. This will allow you to save on your personal energy costs.

community briefs - community briefs - community briefs

SHAPE International Library

Stop by the SHAPE International Library or visit our web site at www.library.eur.army.mil to browse the catalog of free eBooks and eAudio books. Click on the "Free Downloads" graphic and choose "Army Digital Media Library" to view the catalog. These resources are free for members and work on most devices including Kindles and iPads. All you need is a username and PIN. For more information, call the library at DSN 423-5631 or civilian 065-44-5631, e-mail at mwr.shape.library.info@us.army.mil or stop by during regular hours.

CYSS

Schinnen Baseball and Girls Softball

Enrollment is open for the 2013 CYSS Sports & Fitness baseball/softball season. Practice begins April 2 with play running through June 1. Location is the JFC Sports Field. Cost is \$20 for 3-5 year old boys and \$45 for boys 6-15 and girls 10-15 years. Enroll at CYSS Parent Central Services with a valid health assessment. Volunteer coaches are needed. For information, stop by Parent Central Services or call 045-526-3121.

Schinnen Rock Climbing clinics

Enrollment is open through Feb. 15. The clinics will be held on Wednesdays from Feb. 27 through April 24. Last session held April 27 will be a competition. Open to 2nd grade to 12th grade. Fee is \$125 and it must be paid at time of registration. The price includes transportation to/from Rocca Indoor facility, two hours of professional instruction and snack. You can enroll at the CYSS Parent Central Services, JFC Brunssum, Bldg. 505. No refunds will be provided after Feb. 15. For information call CYSS at DSN 364-4195 or civilian 045-526-4195. Spaces are limited.

Schinnen Baseball/Softball Officials clinic

Sign up now for the upcoming clinic on March 30. The CYSS office is offering a free baseball, softball officials/scorekeepers certification for anyone wanting to learn more about these sports or for those who are pursuing a paid contracting position as an Official or Scorekeeper for CYSS. Clinic will be from 9 a.m. to 6 p.m. at Bldg. H603. For information, call DSN 364-4195 or civilian 045-526-4195.

SHAPE/Chièvres Volleyball

Registration is open through March 8. Cost is \$20. For information call DSN 423-5612 or civilian 065-44-5612.

SHAPE/Chièvres Baseball

Registration is open through March 15 for ages six to 15 years old. Cost is \$45. For information call DSN 423-5612 or civilian 065-44-5612.

SHAPE/Chièvres Girls Softball

Registration is open through March 15 for ages 10 to 15. Cost is \$45. For information call DSN 423-5612 or civilian 065-44-5612.

SHAPE/Chièvres Developmental Soccer

Registration is open through March 8 for ages 4-5. Fee is \$20. For information call DSN 423-5612 or civilian 065-44-5612.

SHAPE/Chièvres Soccer

Registration is open through March 15 for ages 6 to 14.

Fee is \$40. For information call DSN 423-5612 or civilian 065-44-5612.

Brussels Spring Break Camp

Registration is open until full for the April 8-12 camp. For registration call DSN 368-9651 or civilian 02-717-9651.

Brussels Crèche

Full-time/part-time child care spaces are now available at the crèche across from the Garrison for ages 6 weeks to 3 years old. Crèche fees are subsidized by CYSS. Parents pay according to their DoD Fee Category. All U.S. and NATO ID cardholders are eligible. For more information call CYSS at DSN 368-9651 or civilian 02-717-9651.

Brussels Volleyball

Registration is open through March 8 for ages 12-18. Fee is \$20. For information, call DSN 368-9651 or civilian 02-717-9651.

Brussels Baseball

Registration is open through March 15 for ages 6-15. Fee is \$45. For information, call DSN 368-9651 or civilian 02-717-9651.

Brussels Developmental Soccer

Registration is open through March 8 for ages 4-5. Fee is \$20. For information, call DSN 368-9651 or civilian 02-717-9651.

Brussels Track and Field

Registration is open through March 15 for ages 10-15. Fee is \$40. For information, call DSN 368-9651 or civilian 02-717-9651.

Central Texas College Europe recruits

Central Texas College Europe is recruiting a Counselor Aide (Part-Time/Substitute) with duty at USAG Benelux - Brussels (open until filled). Bachelor's degree from a regionally accredited college or university is required as well as at least six months experience in a position requiring frequent public speaking and/or briefings. Duties are: Provide enrollment services, after a guidance counselor has developed and approved an education program; issue and process TA forms; conduct educational briefings; assist Soldiers in documenting experience for credit evaluation; assist in conducting needs assessment; assist customers in obtaining financial aid; update Soldier records on the existing community automation system; and provide general education information to customers. Send your application to USAG Benelux SHAPE Education Center, ATTN: CTC/LPM, Unit 21420 - APO AE 09705.

Andrews Federal Credit Union Scholarship

In an effort to promote the importance of financial literacy, Andrews Federal awards scholarships to student members of any age. We encourage our members to take advantage of this opportunity to apply for one of eight \$1,500 non-renewable scholarships for higher education and books. Any Andrews Federal member or member's dependent pursuing a degree from an accredited college or university is eligible to apply. Application Process Applications are available online and in branches from Feb. 1 through April 26. All applicants must be a member or member's dependent with an Andrews Federal account in good standing.

||| = BENELUX NEWS ||| = ||| = BENELUX NEWS ||| =

General strike in Belgium

The socialist trade union FGTB announced that it withdrew from the social negotiations. The union is upset because the government wants to impose flexibility in working hours after having imposed a freeze of salaries and a modification of the way the cost of living index is computed. The union is opposed to allowing workers to work more overtime hours at a moment when there are so many people who don't have a job. They have announced a day of major protests on Feb. 21 and they will be joined by other unions.

Drugs trafficking

Employees of several Colruyt supermarkets in Belgium who were emptying boxes of bananas to put them in shelves discovered packages of cocaine. Some packages were of approximately 11 kilograms each and a total of 65 kilograms were found in four different shops, i.e. a total value of 3.2 million Euros. The bananas were coming from Colombia and had been imported via the port of Antwerp. The Belgian federal police are investigating.

Top Dutch city for expensive homes

The town of Blaricum near Hilversum, the Netherlands has the most expensive homes in the country, with an average house price of €761,000. Nevertheless, Blaricum has not escaped the malaise on the housing market, with the average price down 1.8% on a year ago. In addition, 21% fewer houses changed hands last year. The nearby city of Laren rose from fourth to second place with an average price of just over €600,000. Waasenaar is third. Bloemendaal, on the coast west of Amsterdam fell from second to fourth place as the average house price plummeted 21%. The cheapest homes in the country are in Kerkrade, Limburg, where house prices averaged €136,000 last year.

Shale gas

The energy company Shell has set aside 100,000 Euros to investigate where they could drill in the North East of Belgium (Kempen) to find shale gas. Sample drillings have already taken place in the Netherlands, Germany and the United Kingdom, and now it seems Belgium is next. According to geologists at the KU Leuven and VITO (Flemish Institute for Technological research), the Belgian gas supply is not like in the US, but is not to be neglected. It still has to be determined where the best gas supplies are, the Kempen around Liège or around Mons.

Pepsi

The soft drink giant PepsiCo wants to launch a drink in America this year, using the sweetener, Tagatose. This is great news for the Belgian company Damhert based in

Heusden-Zolder. Although Damhert did not invent Tagatose, it is the only company that can currently produce the low-calorie sugar substitute. It also needs equal quantities of Tagatose to replace sugar.

Tourists view of the Netherlands

People who come to the Netherlands on holiday are most likely to associate the country with tulips, windmills and cheese, according to a survey of over 11,000 holidaymakers for the Dutch tourist board. The most positive aspect of the Netherlands named by tourists is Amsterdam, which was highlighted by 51%. Cycling (41%) and the landscape (32%) came second and third. On the downside, drugs were regarded as a negative attraction by 55%, followed by prostitution (39%) and the language (32%). The survey was conducted in the 13 countries which are home to the majority of tourists. Of those, nearly all said the price quality ratio offered by the hospitality industry was the least positive aspect of their stay. Some 67% of those interviewed said they regarded the Dutch as tolerant, 64% said they were open and 63% said they were friendly. Despite the mainly positive image of the Netherlands, the country is less popular as a holiday destination than it was a year ago. German, British and Belgian nationals dominated the record of 11.7 million foreign tourists who visited the Netherlands last year.

Putin to visit the Netherlands

Russian president Vladimir Putin is to visit the Netherlands April 8 at the invitation of queen Beatrix. The visit coincides with the start of celebrations to mark 400 years of ties between the Netherlands and Russia. The last time Putin visited the Netherlands was in 2005.

Commemoration of the Dutch floods of 1953

Special events have been organized in many places in the Netherlands last week to remember the great floods of 1953, in which over 1,800 people died. In the early hours of Feb. 1, 1953, dykes in the south of the country broke, and large parts of Zeeland, the Zuid-Holland islands and western Brabant were flooded. Over 100,000 people lost their homes in the disaster, which was caused by a combination of strong winds and high tides. Some 500 buildings were destroyed and many more were damaged. Almost 200,000 hectares of farmland land was devastated by the salt water. In the Zuid-Holland village of Oude Tonge, where 305 people lost their lives, a wreath-laying ceremony was held to remember the dead. Other events are taking place throughout the affected areas. The tragedy led to the development of the Delta Works flood prevention scheme, a massive complex of dykes and sluice gates along much of the southern coastline.



This column includes events within close distance to Chièvres, SHAPE and Brussels.

11-12 February

• **Carnaval in Binche** - This world famous carnaval, now on the UNESCO world heritage list, dates back to the 16th century.



Laurent Dussaussois

- Feb. 11, Children's day.

On Monday, the feast is traditionally more private. And the locals will go from pub to pub and from pub to friends' house while dancing in the streets. At about 4 p.m., the youth gather and dance to the music of the drums heading to the Grand'Place. At about 7 p.m., they all watch the fireworks.

- Feb. 12, Fat Tuesday. Only on Tuesday, the "Gilles" are allowed to wear their Gilles costume. The day starts in the very early hours with the dressing after which they will go from house to house. At 8:30 a.m., reception at the City Hall. The Gilles wear their traditional mask. Parade starts at 3 p.m. on Avenue Charles Deliège and heads to the Grand' Place. The Gilles wear their impressive hats covered with ostrich feathers (if weather allows) and offers hundreds of oranges. Torchlight procession and final gathering on the Grand' Place around 8 p.m.

12 February

• **Carnaval of Malmédy** - Starting at 2 p.m., the carnival societies go around the town all afternoon. At 7 p.m., burning of the Haguète on Place Albert I, symbolizing the end of the winter.

15 February

• **Volksmarch in Feluy** for 4, 6, 12 km. Departure is on Grand'Rue from 2 to 6 p.m.

15-22 February

• **International Festival Of Love Films in Mons** - This festival is dedicated to "Love" in all its forms and presents 80 long films and 35 short films from all over the world. From Bulgaria to Burundi, from Slovakia to Quebec, the film selection will let you discover faraway regions, different cultures, through love stories. More information on www.fifa-mons.be/english/essential_news.

16 February

• **Volksmarch in Jumet** for 4, 6, 12, 25 km. Departure is on Rue Anseele, 36 from 8 a.m. to 3 p.m.

16-25 February

• **Anima, Animated 2D & 3D Film Festival in Brussels** - Anima screens 2D and 3D animations, competitions, clips for all ages and much more on a giant-sized screen at Flagey. Anima presents more than 100 films with all types of techniques, an "animated" night, previews and video-clips. More information on www.animatv.be/anima.php?pageID=1&ln=3&inc=3.

17 February

• **Military memorabilia in Pipaix** on the square from 8 a.m. to 1 p.m. Entrance is €3.



This column includes events within close distance to Brunssum and Schinnen.

10-13 February Carnaval parades

Following is the parade schedule for most of the towns in South-Limburg and, unless otherwise specified, all parades start around 2 p.m.



Courtesy Photo

- Beek** - Main parade Feb. 11.
- Bocholtz** - Feb. 11.
- Brunssum** - Main parade Feb. 11, begins 1:40 p.m.
- Geleen** - children's parade Feb. 11.
- Hoensbroek** - Main parade Feb. 11 at 1:11 p.m.
- Hulsberg** - Feb. 11. Starts at 1.30 p.m.
- Jabeek** - Feb. 12.
- Meerssen** - Main parade Feb. 11; Children's parade Feb. 12.
- Munstergeleen** - Main parade Feb. 11; Children's parade Feb. 12.
- Neerbeek** - Feb. 12.
- Nieuwenhagen** - Feb. 12.
- Nieuwstadt** - Main parade Feb. 11; Children's parade Feb. 12.
- Noorbeek** - Children's parade Feb. 12.
- Schaesberg** - Feb. 12.
- Schinnen** - Main parade Feb. 11; Children's parade Feb. 12.
- Schinveld** - Main parade Feb. 11.
- Simpelveld** - Main parade Feb. 11, begins at 2:33 p.m.
- Stein** - Children's parade Feb. 13 at 1 p.m.
- Susteren** - Main parade Feb. 11; children's parade Feb. 12.
- Sweikhuizen** - Feb. 12.
- Thorn** - Feb. 11.
- Ubach over Worms** - Feb. 11.
- Valkenburg** - Main parade Feb. 11, begins 1:30 p.m.

12 February

- **Clowns' Carnaval Parade in Maaseik (BE)** in the town center at 7:11 p.m.
- **Carnaval brass band contest in Maastricht** on the Vrijthof in the center of town at 2:11 p.m.
- **The End of Carnaval in Maastricht** on the Vrijthof in the center of town at 11:55 p.m.



This column includes events within close distance to Chièvres, SHAPE and Brussels.

17 February continued

- **Volksmarch in Ghlin** for 4, 7, 12, 20, 30 km. Departure is on Rue du Temple 15 from 8 a.m. to 3 p.m.
- **Volksmarch in Godarville** for 5, 10, 15, 20 km. Departure is from the sports center on Place de Gaulle from 9 a.m. to 6 p.m.
- **Volksmarch in Montignies-Sur-Sambre** for 5, 10, 20 km. Departure is on Rue des Cartiers 4/6 from 9 a.m. to 6 p.m.
- **Volksmarch in Beloeil** for 5, 10, 20 km. Departure is on Rue de Mons 45 from 9 a.m. to 6 p.m.
- **Volksmarch in Naast** for 5, 10, 15, 20 km. Departure is on Rue du Moulin 9 from 9 a.m. to 6 p.m.

Through 17 February

- **Anima Festival in Brussels** - The annual Animation Film Festival will take place during the Carnaval Holiday in Belgium. An event for all the family with more than 100 movies, openings and the Gold Cartoon Prize.
- **Exhibition "Space oddity, design fiction" in Grand Hornu** - This is an exploration of some science fiction themes found in the work of many contemporary designers: anticipation, cosmology, the supernatural. More information on www.grand-hornu-images.be.

- **Terracotta Army Exhibition** - The Brussels Stock Exchange hosts an exhibition consisting of a reconstruction of the army of the 1st Emperor of China Qin Shi Huangdi. The exhibit presents over 150 warriors chariots, as well as a portion of the pit in which they were discovered, over more than 800 m². More information on www.expoterracotta.be/default.aspx.



Terracotta Army

24 March - Sign up now

- **Dead Man's Ridge Walk (Registration needed with payment by 11 March)** - The non-profit 101st Airborne Division Belgian Friendly organizes a walk for 8 and 16 km



to honor the men of the 17th Airborne Division. Departure from Champs at 9:30 a.m. Registration will be firm upon payment of €5 per person (12 years and up) the "101st Airborne Belgian" account 732-0005542-

64 (IBAN: BE29 7320 0055 4264 - BIC: CREGBEBB). Put the following communication: Marche 17AB + last name(s) and first name(s) of the participants. For more information go to www.17thairbornewalk.blogspot.com, call 0479-961934 or 0477-722852 or send an email to 17thairbornewalk@gmail.com.



This column includes events within close distance to Brunssum and Schinnen.

12 February continued

- **Carnavaal events in Sittard** starts at 2:11 p.m. in the center of Sittard (NL) with groups of costumed people giving out oranges to kids and adults who yell: "Appelsiene, Appelsiene" (oranges, oranges).

13 February

- **The Dülkener Schöppenmarkt in Viersen (GE)** is a traditional yearly market which takes place on Ash Wednesday.

15-16 February



- **The Koninck Blues Festival in Delft** is where the best blues artists from all over the world will come to the inner city and perform at 25 bars and inns. Starts on Feb. 15 at 6 p.m. and Feb. 16 at 3 p.m. No entrance fees.

16-17 February

- **Easter Egg Market in Delbrück (GE)**, at Das Gastliche Dorf. Visitors will find all kinds of Easter eggs: painted, ceramic, etc. Open Feb. 16, from 1 to 5 p.m. and Feb. 17, from 11 a.m. to 5 p.m.

16-24 February

- **Annual Home Fair held in Amsterdam** at the RAI. Visitors will find a variety of exhibitors, artists, workshops, new products and many sales. Entry is €19; children €5.50. Open Feb. 16-20 & 23-24, from 11 a.m. to 6 p.m. and Feb. 21-22, from 11 a.m. to 10 p.m.

17 February

- **Indoor Flea Market in Horst** at Merthal on Gas-thuisstraat from 9:30 a.m. to 3:30 p.m. Entry is €2.50.

SHAPE Trips & Tours

For information on the trips below,
call DSN 423-3884 or civilian 065-44-3884

- Champagne Tour, February 16** - Spend a relaxing day out in the Champagne Region of France. The trip begins with a stop in Reims where you will have a few hours to enjoy lunch (not included), shop, take a stroll to the famous Cathedral of Notre-Dame in Reims, or tour the beautiful old bishops' palace (now the Palace of Tau archaeological museum), the Basilica and Abby Museum of St. Remi, and the Museum of Surrender. You will continue your journey with a photo stop at the church where Dom Perignon, the monk credited with inventing this bubbly masterpiece, is buried. The final destination is Epernay where you will visit the famous Champagne Caves of Mercier. An elevator with a panoramic view will take you down 30 meter below ground to the cellars. You will then tour a portion of the 18 km of caves on a laser guided train. The tour will end with a complimentary Champagne tasting. You will then have free time to enjoy the town on your own. Price: € 80 Adults, € 68 Youth (10-17), € 62 Child (0-9). Departs SHAPE at 7:45 a.m. and returns to SHAPE at 9:15 p.m. Departs Brussels at 6:30 a.m. and returns to Brussels at 10:30 p.m.
- Maastricht, February 23** - Touching Belgium on its west and just a few miles from Germany to the east, Maastricht is a town rich in history and culture, bars, cafes and restaurants. Have a drink at a café in one of the beautiful squares and watch the people go by, or visit the city's old town fortifications. Departs SHAPE at 9:30 a.m. and returns to SHAPE at 11:30 p.m. Departs Brussels at 10:45 a.m. and returns to Brussels at 10:15 p.m. Price is €40 adults, children.
- Belgian beer tour, March 2** - Discover by yourself why Belgium is known for creating the best beers in the world. The day begins at Du Bocq where you will have a brewery tour and see firsthand how their brews are carefully crafted. Then tempt your taste buds with a sample from one of the many fine brews that are only available in Europe. Our next stop is Brewery Abbaye du Val Dieu. Here you will enjoy a late lunch (included) of soup and ham with beer sauce paired with one of their delicious beers. Our final destination is St. Feuillien to learn about and sample their delicious brews as well. Departs SHAPE at 9 a.m. and returns to SHAPE at 8:30 p.m. Departs Brussels at 7:45 a.m. and returns at Brussels at 9:30 p.m. Price is €97 per adult.



Maastricht

Schinnen Trips and Tours

For information on the trips below
call DSN 360-7561 or civilian 0031-(0)46-4437561

- Spring Break getaway to Malgrat de Mar, Spain is now sold out. Next trip is March 16 (day trip to Paris) see details in next Gazette.**

SHAPE Travel Group

For information on the trips below call civilian 065-336560
Travel Group members are available every Wednesday and Friday
from 11 a.m. to 1 p.m. in the Foyer of the SHAPE Library, Bldg. 307.

- Creativa (near Brussels), March 7** - Creativa is the fair for creative leisure. The fair has over 200 exhibitors displaying and selling everything you need for scrapbooking, jewellery making, patchwork quilting, card making, mosaics, cake decorating etc. Come with us and stock up on supplies for your crafts, or find ideas for new hobbies. Price is €25 including entrance fee and transportation.

For recurring events check on www.usagbenelux.eur.army.mil/sites/local/pages/gazette/GazetteExtra.pdf.

MARK YOUR CALENDAR

BRUNSSUM/SCHINNEN COMMUNITY

February 13-15

- **Carnaval Week Specials at the Bowling center** - To add to the fun, the Schinnen Bowling Center will feature two bowling specials on Wednesday, Thursday and Friday. The first special: order a full meal and bowl a game for free. The second: kids 18 and under can bowl two games for just one dollar. Center hours are 11 a.m. to 9 p.m. For details about any of the activities, call 046-443-7207.

SHAPE/CHIEVRES COMMUNITY

February 12

- **Lunch and Learn** - This week's topic is Principles of Healthy Relationships and Marriages. The meeting will be in the ACS training room, SHAPE Bldg. 318 from noon to 1 p.m. For more information call DSN 423-5324 or civilian 065-44-5324.

February 14

- **Investing Basics Seminar** - Learn to make sense of bonds, stocks, mutual funds, IRAs, the Thrift Savings Plan (TSP) and more from 1 to 2 p.m. at Bldg. 318, SHAPE. To register, call DSN 423-5324 or civilian 065-44-5324.

Sign up now

- **CYSS/4-H Adult Babysitting Course** - Learn basic childcare skills and get CPR/First Aid certified. Classes will be offered Feb. 27 from 8:30 a.m. to 5:30 p.m. and Feb. 28 from 9 a.m. to 5 p.m. at Bldg. 503, SHAPE. Cost is \$10. Spaces are limited so register as soon as possible at CYSS, DSN 423-5612 or civilian 065-44-5612.

BRUSSELS COMMUNITY

February 14

- **Infant Massage Instruction** - From 10 to 11 a.m. at the Playgroup, Bldg. 2, Rm 240. To register, contact ACS at DSN 368-9783 or civilian 02-717-9783.

February 15

- **Valentine's Day Dinner** - At the 3 Star Lounge from 7 to 11 p.m. Choice of prime rib or salmon. For reservations call DSN 368-9822 or civilian 02-717-9822.
- **Parents' Night Out** - Movie, light dinner, fun games and activities from 6:30 to 11:30 p.m. Cost is \$25 per child. Reserve your slot by Feb. 13 at the CYSS.

Open to US & NATO ID Card Holders and their bona fide guests.

CELEBRATE VALENTINE'S DAY

Feb 15 7-11 PM

HAPPY VALENTINE DAY

Parent's Night Out!
Enjoy a romantic evening with your special someone at the

3 Star Lounge
Your choice of Prime Rib or Salmon.
\$14.95

Call MWR for your reservation today!
DSN: 368-9822 CIV: 02.717.9822



Community Roundup



KEEPING YOU CONNECTED

The Official Website of the American Forces Network Benelux
benelux.afneurope.net

Brussels: 101.7 FM – Chièvres 107.9 FM – SHAPE 106.5 FM and 104.2 FM