

FLOOD CONTROL
MISSISSIPPI RIVER AND TRIBUTARIES
MISSISSIPPI RIVER LEVEES

ITEM M-75.6 TO 74.5-L
SCARSDALE-STELLA LEVEE SETBACK

PLAQUEMINES PARISH, LOUISIANA
RELOCATION OF FACILITIES
DESIGN MEMORANDUM NO. 69

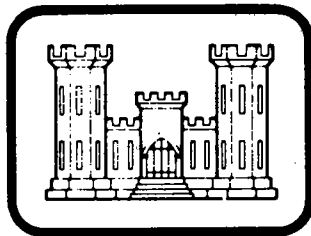

**United States Army
Corps of Engineers**

*... Serving the Army
... Serving the Nation*

DEPARTMENT OF THE ARMY
NEW ORLEANS DISTRICT, CORPS OF ENGINEERS
NEW ORLEANS, LOUISIANA

JUNE 1981

+ DYNIX 271781

Serial No. 15

TC
7
P5
2/26/81
1981

64

Copy

MRCED-TD (NOD 9 Jun 81) 3d Ind
SUBJECT: Flood Control, Mississippi River and Tributaries, Mississippi
River Levees, Item M-75.6 to 74.5-L, Scarsdale-Stella Levee
Setback, Plaquemines Parish, Louisiana, Relocation of Facilities
Design Memorandum No. 69

DA, Mississippi River Commission, Corps of Engineers, Vicksburg, MS 39180

18 AUG 81

TO: Commander, New Orleans District, ATTN: LMNED-MR

Satisfactory.

FOR THE PRESIDENT OF THE COMMISSION:

Frank J. Weaver
R. H. RESTA
for Chief, Engineering Division

2 Incl
1. wd
2-3. wd 10 cy

CF:
DAEN-CWE-B (5 cy)
w 5 cy 2d Ind & Incl 2&3

ED-7D

LMNED-MR (9 Jun 81) 2nd Ind

SUBJECT: Flood Control, Mississippi River and Tributaries, Mississippi River Levees, Item M-75.6 to 74.5-L, Scarsdale-Stella Levee Setback, Plaquemines Parish, Louisiana, Relocation of Facilities Design Memorandum No. 69

DA, New Orleans District, Corps of Engineers, P.O. Box 60267, New Orleans, La. 70160 3 August 1981

TO: President, Mississippi River Commission, ATTN: MRC-ED-TD

We concur with the comments contained in the 1st Ind. Revised portions of the report are forwarded for inclusion in your copies of the subject design memorandum.

FOR THE COMMANDER:



FREDERIC M. CHATRY
Chief, Engineering Division

- 3 Incl
- Added 2 Incl (11 copies)
- 2. Main body revisions
(pages 2 through 6 and plate 7)
- 3. Appendix I revisions
(pages 2 through 6)

Er/16

MRCED-TD (NOD 9 Jun 81) 1st Ind
SUBJECT: Flood Control, Mississippi River and Tributaries, Mississippi
River Levees, Item M-75.6 to 74.5-L, Scarsdale-Stella Levee
Setback, Plaquemines Parish, Louisiana, Relocation of Facilities
Design Memorandum No. 69

DA, Mississippi River Commission, Corps of Engineers, Vicksburg, Miss.
39180

9 JUL 81

TO: Commander, New Orleans District, ATTN: LMNED-MR

Subject memorandum is approved, subject to the following comments:

a. Main Body.

(1) Page 1, para 1. The date of the cited ER should be 1 July 1980.

(2) Page 2, para 4b(3). The second sentence should be completed by adding "will be affected by the project" after the word "valves."

(3) Page 2, para 4b(3), and page 6, para 8b(3). The number of valves mentioned in the two paragraphs is not in agreement. This disparity should be reconciled.

(4) Plate 7. Although the Description of Proposed Work paragraph includes the provision for slope protection (sand-cement bags placed to flowline grade), the sections shown on this plate should be revised to show such placement as a part of the required construction.

b. Appendix I.

(1) Page 5, Section VII, third paragraph. The second sentence should be clarified.

(2) Page 5, Section VII, fourth paragraph. In the last line, the word "us" should be changed to "United States."

(3) Page 5, Sections VII and VIII. The citations listed in these sections relative to ER 1180-1-1 should be revised as follows: 1 July 1980, Section 73, para 73-002.

(4) General. Errors in spelling, etc., have been noted in red on pages 2, 4, 5, and 6.

FOR THE PRESIDENT OF THE COMMISSION:

1 Incl
1. wd 11 sets

for Robert J Kaufman
R. H. RESTA
Chief, Engineering Division

CF w incl:
DAEN-CWE-BB (5 cy)



DEPARTMENT OF THE ARMY
NEW ORLEANS DISTRICT, CORPS OF ENGINEERS
P. O. BOX 60267
NEW ORLEANS, LOUISIANA 70160

REPLY TO
ATTENTION OF:

9 JUN 1981

LMNED-MR

SUBJECT: Flood Control, Mississippi River and Tributaries, Mississippi River Levees, Item M-75.6 to 74.5-L, Scarsdale-Stella Levee Setback, Plaquemines Parish, Louisiana, Relocation of Facilities, Design Memorandum No. 69

President
Mississippi River Commission
ATTN: MSRC-ED-TD

1. The subject design memorandum is submitted herewith for review and approval in accordance with the provisions of ER 1110-2-1150 dated 19 June 1970.
2. The final Environmental Impact Statement (EIS) for the Mississippi River Levees and Channel Improvement projects, which includes the Scarsdale-Stella Levee Setback, was filed with the Council on Environmental Quality (CEQ) on 8 April 1976 and the notice of its availability was published in the Federal Register on 16 April 1976. No inadequacies in the EIS were reported.
3. A cultural resources survey will be completed by 15 August 1981, and management summary of results will be available 1 September 1981. The purpose of the cultural resources survey will be to ascertain the existence of archeological resources in the work area and to determine the applicable procedures to be followed to avoid damage to the archeological resources, if any are found. Additionally, specifications covering the work to be performed in constructing and maintaining the levees provide for preservation of any items of apparent historical or archeological interest which may be discovered in the course of construction activities. The specifications will require immediate notification of proper authorities if any items of this nature are encountered, and will further require that the work cease until the items can be classified and salvaged, if salvage is considered appropriate.

9 JUN 1981

LMNED-MR

SUBJECT: Flood Control, Mississippi River and Tributaries, Mississippi River Levees, Item M-75.6 to 74.5-L, Scarsdale-Stella Levee Setback, Plaquemines Parish, Louisiana, Relocation of Facilities, Design Memorandum No. 69

4. The Section 404 public notice for the levee district covering this item of work was issued on 8 October 1976. No adverse comments were received. In compliance with applicable regulations pursuant to Section 404(b) of Federal Water Pollution Control Act, a statement of findings covering proposed future construction of Mississippi River levees within the New Orleans District was submitted to the Environmental Protection Agency (EPA) on 14 July 1978. The statement of findings was approved on 6 November 1978. No endangered species are known to live within the project area. There is no known factual evidence of critical habitat in the rights-of-way for any of the species considered endangered in Louisiana by the US Wildlife Service.

5. This report is being submitted as scheduled. Approval of the design memorandum is recommended.

1 Incl (12 sets)
Design Memorandum No. 69



THOMAS A. SANDS
Colonel, CE
District Engineer

FLOOD CONTROL, MISSISSIPPI RIVER AND TRIBUTARIES
MISSISSIPPI RIVER LEVEES
ITEM M-75.6 - 74.5-L
SCARSDALE-STELLA, LEVEE SETBACK
PLAQUEMINES PARISH, LOUISIANA
RELOCATION OF FACILITIES
DESIGN MEMORANDUM NO. 69

STATUS OF DESIGN MEMORANDUMS

<u>Design Memo No.</u>	<u>Title</u>	<u>Actual (A) or Scheduled (S) Submission Date</u>
1	Flood Control, Mississippi River and Tributaries, Item M-25.0-R, Buras Levee Setback, Plaquemines Parish, Louisiana, Relocation of Facilities	23 Nov 70 (A)
2	Flood Control, Mississippi River and Tributaries, Item M-26.0-R, Upper Buras Levee Setback, Plaquemines Parish, Louisiana, Relocation of Facilities	21 Jan 71 (A)
3	Flood Control, Mississippi River and Tributaries, Mississippi River Levees, Item M-14.9-R, Commander Levee Enlargement, Plaquemines Parish, Louisiana, Relocation of Facilities	11 Jun 71 (A)
4	Flood Control, Mississippi River and Tributaries, Mississippi River Levees, Item M-10.7-R, Venice Levee Enlargement and Setback, Plaquemines Parish, Louisiana, Relocation of Facilities	6 Apr 71 (A)
5	Lower Red River - South Bank Red River Levees, Item R-117.0-R (1957 Mileage), Levee Enlargement, Rapides-Cotton Bayou Levee, Rapides Parish, Louisiana, Relocation of Facilities	22 Jan 71 (A)
6	Flood Control, Mississippi River and Tributaries, Mississippi River Levees, Item M-31.3-R, Tropical Bend Levee Setback, Plaquemines Parish, Louisiana, Relocation of Facilities	30 Mar 71 (A)
7	Flood Control, Mississippi River and Tributaries, Mississippi River Levees, Item M-10.4-R, Lower Venice Levee Enlargement and Setback, Plaquemines Parish, Louisiana, Relocation of Facilities	27 Aug 71 (A)

STATUS OF DESIGN MEMORANDUMS (cont'd)

<u>Design Memo No.</u>	<u>Title</u>	<u>Actual (A) or Scheduled (S) Submission Date</u>
8	Flood Control, Mississippi River and Tributaries, Mississippi River Levees, Item M-18.9-R, Fort Jackson-Boothville Levee Enlargement, Plaquemines Parish, Louisiana, Relocation of Facilities	30 Nov 72 (A)
9	Flood Control, Mississippi River and Tributaries, Mississippi River Levees, Item M-21.5-R, Childress Levee Enlargement, Plaquemines Parish, Louisiana, Relocation of Facilities	23 Sep 71 (A)
10	Flood Control, Mississippi River and Tributaries, Mississippi River Levees, Item M-23.2-R, Buras-Triumph Levee Enlargement, Plaquemines Parish, Louisiana, Relocation of Facilities	31 May 73 (A)
11	Flood Control, Mississippi River and Tributaries, Mississippi River Levees, Item M-55.3-R, Upper Junior Levee Setback, Plaquemines Parish, Louisiana, Relocation of Facilities	21 June 71 (A)
12	Flood Control, Mississippi River and Tributaries, Mississippi River Levees, Item M-51.0-L, Gravolet Levee Enlargement and Setback, Plaquemines Parish, Louisiana, Relocation of Facilities	14 Sep 72 (A)
13	Flood Control, Mississippi River and Tributaries, Lower Red River - South Bank Red River Levees, Item R-123.5-R (1957 Mileage), Scott Home-Bertrand Levee Enlargement, Rapides Parish, Louisiana, Relocation of Facilities	15 Sep 72 (A)
14	Flood Control, Mississippi River and Tributaries, Mississippi River Levees, Item M-96.9-R, Amelia Street Levee, Jefferson Parish, Louisiana, Relocation of Facilities	31 Aug 71 (A)

STATUS OF DESIGN MEMORANDUMS (cont'd)

<u>Design Memo No.</u>	<u>Title</u>	<u>Actual (A) or Scheduled (S) Submission Date</u>
15	Flood Control, Mississippi River and Tributaries, Mississippi River Levees, Item M-41.7-R, Port Sulphur Levee Enlargement and Setback, Plaquemines Parish, Louisiana, Relocation of Facilities	28 Jan 74 (A)
16	Flood Control, Mississippi River and Tributaries, Mississippi River Levees, Item M-33.4-R, Nairn Levee Enlargement, Plaquemines Parish, Louisiana, Relocation of Facilities	22 Dec 75 (A)
17	Flood Control, Mississippi River and Tributaries, Mississippi River Levees, Item M-37.7-R, Homeplace Levee Enlargement, Plaquemines Parish, Louisiana, Relocation of Facilities	5 Jan 73 (A)
18	Flood Control, Mississippi River and Tributaries, Mississippi River Levees, Item M-57.7-R, Myrtle Grove Levee Enlargement, Plaquemines Parish, Louisiana, Relocation of Facilities	31 Jan 73 (A)
19	Flood Control, Mississippi River and Tributaries, Mississippi River Levees, Item M-28.0-R, Empire Levee Enlargement, Plaquemines Parish, Louisiana, Relocation of Facilities	30 Aug 74 (A)
20	Flood Control, Mississippi River and Tributaries, Mississippi River Levees, Item M-49.5-R, Woodland Levee Enlargement, Plaquemines Parish, Louisiana, Relocation of Facilities	24 Aug 73 (A)
21	Flood Control, Mississippi River and Tributaries, Mississippi River Levees, Item M-47.2-R, Nolan Levee Enlargement, Plaquemines Parish, Louisiana, Relocation of Facilities	29 Jun 73 (A)

STATUS OF DESIGN MEMORANDUMS (cont'd)

<u>Design Memo No.</u>	<u>Title</u>	<u>Actual (A) or Scheduled (S) Submission Date</u>
22	Flood Control, Mississippi River and Tributaries, Mississippi River Levees, Item M-45.0-R, Socola Levee Enlargement, Plaquemines Parish, Louisiana, Relocation of Facilities	28 Nov 72 (A)
23	Flood Control, Mississippi River and Tributaries, Mississippi River Levees, Item M-75.0-L, Scarsdale Levee Setback, Plaquemines Parish, Louisiana, Relocation of Facilities	7 Dec 73 (A)
24	Flood Control, Mississippi River and Tributaries, Mississippi River Levees, Item M-89.5-R, Cutoff Levee Setback, Orleans Parish, Louisiana, Relocation of Facilities	20 Dec 74 (A)
25	Flood Control, Mississippi River and Tributaries, Mississippi River Levees, Item M-130.0-L, Gypsy Levee Setback, St. Charles Parish, Louisiana, Relocation of Facilities	30 Dec 74 (A)
26	Flood Control, Mississippi River and Tributaries, Atchafalaya River Levees, Item A-31.3-L, Cross Bayou Levee Setback, Pointe Coupee Parish, Louisiana, Relocation of Facilities	8 Nov 74 (A)
27	Flood Control, Mississippi River and Tributaries, Mississippi River Levees, Item M-39.0-R, Freeport Levee Enlargement, Plaquemines Parish, Louisiana	27 Dec 74 (A)
28	Flood Control, Mississippi River and Tributaries, Mississippi River Levees, Item M-30.2-R, Upper Empire Levee Enlargement and Setback, Plaquemines Parish, Louisiana, Relocation of Facilities	30 Apr 75 (A)

STATUS OF DESIGN MEMORANDUMS (cont'd)

<u>Design Memo No.</u>	<u>Title</u>	<u>Actual (A) or Scheduled (S) Submission Date</u>
29	Flood Control, Mississippi River and Tributaries, Mississippi River Levees, Item M-63.0-L, Monsecour Levee Enlargement, Plaquemines Parish, Louisiana, Relocation of Facilities	15 Oct 75 (A)
30	Flood Control, Mississippi River and Tributaries, Atchafalaya River Levees, Item A-25.5-R, Goudeau Levee Setback, St. Landry Parish, Louisiana, Relocation of Facilities	30 Jun 76 (A)
31	Flood Control, Mississippi River and Tributaries, Mississippi River Levees, Item M-320 to 303-R, Fifth Louisiana Levee District Levee Enlargement, Concordia, West Feliciana, and Pointe Coupee Parishes, Louisiana, Relocation of Facilities	30 Jun 75 (A)
32	Flood Control, Mississippi River and Tributaries, Atchafalaya River Levees, Item A-4.6-L, Legonier Levee Setback, Pointe Coupee Parish, Louisiana, Relocation of Facilities	30 Sep 75 (A)
33	Flood Control, Mississippi River and Tributaries, Mississippi River Levees, Item M-35.0-R, Nairn Levee Setback, Plaquemines Parish, Louisiana, Relocation of Facilities	22 Dec 75 (A)
34	Flood Control, Mississippi River and Tributaries, Mississippi River Levees, Item M-99.0-L, Louisiana Avenue Floodwall, Orleans Parish, Louisiana, Relocation of Facilities	21 Oct 75 (A)
35	Flood Control, Mississippi River and Tributaries, Mississippi River Levees, Item M-144.5-L, Angelina Levee Setback, Saint John the Baptist Parish, Louisiana, Relocation of Facilities	12 Dec 75 (A)

STATUS OF DESIGN MEMORANDUMS (cont'd)

<u>Design Memo No.</u>	<u>Title</u>	<u>Actual (A) or Scheduled (S) Submission Date</u>
36	Flood Control, Mississippi River and Tributaries, Mississippi River Levees, Item M-205.0-R, Point Pleasant Levee Setback, Iberville Parish, Louisiana, Relocation of Facilities	29 Nov 76 (A)
37	Flood Control, Mississippi River and Tributaries, Mississippi River Levees, Item M-58.0-L, St. Sophie Levee Enlargement, Plaquemines Parish, Louisiana, Relocation of Facilities	15 Sep 75 (A)
38	Flood Control, Mississippi River and Tributaries, Atchafalaya River Levees, Item A-38.0L, Holloway Lake Levee Setback, Pointe Coupee Parish, Louisiana, Relocation of Facilities	26 Mar 76 (A)
39	Flood Control, Mississippi River and Tributaries, Mississippi River Levees, Item M-90.5-L, Chalmette Slip Levee Enlargement, St. Bernard Parish, Louisiana, Relocation of Facilities	5 May 77 (A)
40	Flood Control, Mississippi River and Tributaries, Mississippi River Levees, Item M-95.3L, Thalia-Poydras Street Floodwall, Orleans Parish, Louisiana, Relocation of Facilities	10 Jun 76 (A)
41	Flood Control, Mississippi River and Tributaries, Mississippi River Levees, Item M-217.5-L, Chariot Levee Setback, East Baton Rouge Parish, Louisiana, Relocation of Facilities	11 Jun 76 (A)
42	Flood Control, Mississippi River and Tributaries, Mississippi River Levees, Item M-52.6-R and M-52.1-R Junior and Lower Junior Levee Setbacks, Plaquemines Parish, Louisiana, Relocation of Facilities	24 Jan 77 (A)

STATUS OF DESIGN MEMORANDUMS (cont'd)

<u>Design Memo No.</u>	<u>Title</u>	<u>Actual (A) or Scheduled (S) Submission Date</u>
43	Flood Control, Mississippi River and Tributaries, Mississippi River Levees, Item M-86.0-R, Stanton Levee Setback, Orleans Parish, Louisiana, Relocation of Facilities	10 Oct 78 (A)
44	Flood Control, Mississippi River and Tributaries, Mississippi River Levees, Item M-215.3-L, Manchac Bend Levee Setback, East Baton Rouge Parish, Louisiana, Relocation of Facilities	23 Dec 76 (A)
45	Flood Control, Mississippi River and Tributaries, Mississippi River Levees, Item M-28.5-R, Empire Levee Setback, Plaquemines Parish Louisiana, Relocation of Facilities	16 Dec 77 (A)
46	Flood Control, Mississippi River and Tributaries, Mississippi River Levees, Item M-49.0-R, Woodland Levee Setback, Plaquemines Parish Louisiana, Relocation of Facilities	28 Nov 77 (A)
47	Flood Control, Mississippi River and Tributaries, Atchafalaya Basin Floodway, New Berwick Floodwall, St. Mary Parish, Louisiana, Relocation of Facilities	14 Mar 79 (A)
48	Flood Control, Mississippi River and Tributaries, Atchafalaya Basin Floodway, New Morgan City Floodwall, St. Mary Parish, Louisiana, Relocation of Facilities	16 Mar 81 (A)
49	Flood Control, Mississippi River and Tributaries, Atchafalaya Basin Floodway, New Tiger Island Floodwall, St. Mary Parish, Louisiana, Relocation of Facilities	17 Oct 79 (A)
50	Flood Control, Mississippi River and Tributaries, Mississippi River Levees, Item M-24.8-R, Buras-Triumph Levee Setback, Plaquemines Parish, Louisiana, Relocation of Facilities	30 Sep 77 (A)

STATUS OF DESIGN MEMORANDUMS (cont'd)

<u>Design Memo No.</u>	<u>Title</u>	<u>Actual (A) or Scheduled (S) Submission Date</u>
51	Flood Control, Mississippi River and Tributaries, East Atchafalaya Basin Protection Levee, Item E-69.0 and E-73.3, Levee Enlargements, St. Martin and Iberville Parishes, Louisiana, Relocation of Louisiana State Route 997	3 Jun 77 (A)
52	Flood Control, Mississippi River and Tributaries, Mississippi River Levees, Item M-100.0-L, Nashville-Napoleon Floodwall, Orleans Parish, Louisiana Relocation of Facilities	25 Aug 77 (A)
53	Flood Control, Mississippi River and Tributaries, Mississippi River Levees, Item M-88.0-R, Algiers Lock Forebay Levee Enlargement, Orleans Parish, Louisiana, Relocation of Facilities	1 Aug 77 (A)
54	Flood Control, Mississippi River and Tributaries, Mississippi River Levees, Item M-29.4-R, Empire Lock Modifications, Plaquemines Parish, Louisiana, Relocation of Facilities	19 May 78 (A)
55	Flood Control, Mississippi River and Tributaries, West Atchafalaya Basin Protection Levee, Item W-86.0 Levee Enlargement, St. Mary Parish, Louisiana, Relocation of Facilities	NOT SCHEDULED
56	Flood Control, Mississippi River and Tributaries, East Atchafalaya Basin Protection Levee, Item E-89, Driving Steel Sheet Piling and Levee Enlargement, St. Mary Parish, Louisiana, Relocation of Facilities	15 May 78 (A)
57	Flood Control, Mississippi River and Tributaries, Algiers Point Setback, Levee Enlargement and Slope Pavement, Item M-94.3-R, Orleans Parish, Louisiana Relocation of Facilities	8 Aug 79 (A)

STATUS OF DESIGN MEMORANDUMS (cont'd)

<u>Design Memo No.</u>	<u>Title</u>	<u>Actual (A) or Scheduled (S) Submission Date</u>
58	Flood Control, Mississippi River and Tributaries, Item M-48.7-L, East Pointe-a-la-Hache Ferry Landing and Levee Enlargement, Plaquemines Parish, Louisiana, Relocation of Facilities	2 Jun 78 (A)
59	Flood Control, Mississippi River and Tributaries, Jackson Avenue Floodgate, Item M-97.2-L, Orleans Parish, Louisiana, Relocation of Facilities	9 Jun 78 (A)
60	Flood Control, Mississippi River and Tributaries, Item M-303 to 293-R, Torras Levee Enlargement and Berm, Pointe Coupee Parish, Louisiana, Relocation of Facilities	26 Jul 78 (A)
61	Flood Control, Mississippi River and Tributaries, East Atchafalaya Basin Protection Levee, Item E-36.0, Levee Enlargement, Iberville Parish, Louisiana, Relocation of Facilities	28 Mar 79 (A)
62	Flood Control, Mississippi River and Tributaries, Item M-293 to 283-R, Raccourci Levee Enlargement, Pointe Coupee Parish, Louisiana, Relocation of Facilities	12 Jun 79 (A)
63	Flood Control, Mississippi River and Tributaries, West Atchafalaya Basin Protection Levee, Item W-85.0A, Levee Enlargement, Iberia and St. Martin Parishes, Louisiana, Relocation of Facilities	6 Oct 80 (A)
64	Flood Control, Mississippi River and Tributaries, Louisiana-Jackson Avenue Floodwall, Item M-98.2 to 97.2-L, Orleans Parish, Louisiana, Relocation of Facilities	Dec 81 (S)

STATUS OF DESIGN MEMORANDUMS (cont'd)

<u>Design Memo No.</u>	<u>Title</u>	<u>Actual (A) or Scheduled (S) Submission Date</u>
65	Flood Control, Mississippi River and Tributaries, Canal-Toulouse Street Floodwall, Item M-94.9-94.6-L, Orleans Parish, Louisiana, Relocation of Facilities	Nov 81 (S)
66	Flood Control, Mississippi River and Tributaries, West Atchafalaya Basin Protection Levee, Item W-117.0, Levee Enlargement, St. Mary Parish Louisiana, Relocation of Facilities	15 Dec 80 (A)
67	Flood Control, Mississippi River and Tributaries, Mississippi River Levees, Item M-56.0-L, Harlem Levee Setback Plaquemines Parish, Louisiana, Relocation of Facilities	17 Feb 81 (A)
68	Flood Control, Mississippi River and Tributaries, Mississippi River Levees, Item M-71.0-L, Linwood Levee Setback Plaquemines Parish, Louisiana, Relocation of Facilities	16 Mar 81 (A)
69	Flood Control, Mississippi River and Tributaries, Mississippi River Levees, Item M-75.6 - 74.5-L, Scarsdale-Stella Levee Setback and Enlargement, Plaquemines Parish, Louisiana, Relocation of Facilities	Jun 81 (A)
70	Flood Control, Mississippi River and Tributaries, West Atchafalaya Basin Protection Levee, Item W-68.0, Levee Enlargement & Berms, St. Martin Parish, Louisiana, Relocation of Facilities	31 Dec 81 (S)
71	Flood Control, Mississippi River and Tributaries, East Atchafalaya Basin Protection Levee, Item E-58.0A, Levee Enlargement & Berms, Iberville Parish, Louisiana, Relocation of Facilities	27 Mar 81 (A)

TABLE OF CONTENTS

<u>Paragraph</u>	<u>Title</u>	<u>Page</u>
	PERTINENT DATA	A
1	PURPOSE OF DESIGN MEMORANDUM	1
2	PROJECT AUTHORIZATION	
	a. Construction, Enlargement, or Improvement of Main Line Mississippi River Levees	1
	b. Levee Setbacks, Main Line Mississippi River Levees	1
3	AUTHORITY FOR ACCOMPLISHING RELOCATIONS	1
4	DESCRIPTION OF FACILITIES AFFECTED BY THE PROJECT	
	a. Road	2
	b. Utilities	2
5	OWNER'S COMPENSABLE INTEREST	4
6	FIELD RECONNAISSANCE AND INVESTIGATION	4
7	CRITERIA FOR RELOCATED FACILITIES	
	a. Road	4
	b. Utilities	5
8	DESCRIPTION OF PROPOSED RELOCATIONS	
	a. Road	5
	b. Utilities	5
9	PROCEDURE FOR ACCOMPLISHING RELOCATIONS	
	a. Road	6
	b. Utilities	6
10	ATTITUDE OF OWNERS	7
11	ESTIMATE OF COST	7
12	COMPARISON WITH PRIOR COST ESTIMATES	7
13	JUSTIFICATION FOR COST REVISION	8
14	RECOMMENDATIONS	8

TABLES

<u>No.</u>	<u>Title</u>	<u>Page</u>
1	LIST OF EXISTING FACILITIES	C
2	SUMMARY OF ESTIMATED FEDERAL RELOCATIONS COSTS	7
3	COMPARISON OF COSTS MAINTENANCE FUNDS	8

PLATES

<u>No.</u>	<u>Title</u>
1	LOCATION MAP
2-6	PROJECT PLAN
7	TYPICAL SECTIONS

APPENDIXES

I	ATTORNEY'S REPORT
II	LOUISIANA OFFICE OF HIGHWAYS MINIMUM DESIGN STANDARDS FOR RURAL HIGHWAYS AND ROADS
III	PERTINENT CORRESPONDENCE
IV	DETAILED COST ESTIMATES

FLOOD CONTROL, MISSISSIPPI RIVER AND TRIBUTARIES
MISSISSIPPI RIVER LEVEES
ITEM M-75.6 to 74.5-L
SCARSDALE-STELLA LEVEE SETBACK
PLAQUEMINES PARISH, LOUISIANA
RELOCATION OF FACILITIES
DESIGN MEMORANDUM NO. 69

PERTINENT DATA

The Scarsdale-Stella Levee Setback, Item M-75.6 to 74.5-L, is located in Plaquemines Parish, Louisiana on the left descending bank of the Mississippi River between levee stations 903+00 and 964+40 (approximate river mile 75.6 to 74.5 above the Head of Passes).

Purpose:

The Mississippi River and Tributaries Flood Control project embodies a plan to protect the Lower Mississippi Valley against the project design flood. The plan includes the use of levees, floodways, channel improvements and major tributary flood control improvements. Specifically, item M-75.6 to 74.5-L is designed to provide flood protection to a portion of the Plaquemines Parish area. Justification for the need for this work is based on LMNED-FD "Supplemental Report - Mississippi River Revetment, Scarsdale-Stella, Louisiana" approved 5 July 1978. The stability control line, established in the above referenced report, applied to overbank cross sections requires a setback between the station limits shown on Plates 2 through 6 in order to maintain the required safety factor of 1.3.

Authorization:

The Flood Control Act of 15 May 1928 (Public Law 391, 70th Congress), as amended, provides authorization for the project.

Assuring Agency:

The local assuring agency for the Scarsdale-Stella levee setback, item M-75.6 to 74.5-L is the Plaquemines Parish Commission Council, the governing body of the Grand Prairie Levee District.

Description of Proposed Work. The levee will be set back between stations 904+00 and station 953+00. Smooth transitions 100-feet in length will be provided on each end to blend the new levee into the existing levee. Embankment material will be obtained from the existing levee and from designated batture borrow areas. The new levee will be constructed in two separate lifts. The first lift will be constructed to elevation 19.3 NGVD. The second lift will be constructed after foundation settlement has occurred, bringing the levee up to the authorized design grade. The second lift can be constructed within the right-of-way established for the first lift. Riverside slope protection will consist of sand-cement bags placed to flowline

grade during the first lift construction. Extension of the slope paving will be made during second lift construction after settlement occurs. The levee design section is the 1947 code section which consists of a 1V on 4H landside slope, IV on 3H riverside slope and 10-foot crown width. The project will dislocate over 5,000 linear feet each of the adjacent State highway and natural gas, water, telephone and power facilities. All facilities which are located outside of the existing levee right-of-way are to be relocated at Federal expense. The right-of-way to be occupied by the proposed project is shown on plates 2 through 6; typical sections for the levee and relocated road are shown on plate 7.

TABLE 1
LIST OF EXISTING FACILITIES

Item No.	Owner	Description	Disposition	Location
R-1	State of Louisiana Dept of Transportation and Development, Office of Highways	State Route Louisiana 39	Relocate	Plates 2 thru 6
G-1	Louisiana Gas Service Company	4-inch - Diameter Gas Main	Relocate	Plates 2 thru 6
P-1	Louisiana Power & Light Company	13.8 kV distribution line	Relocate	Plates 2 thru 6
W-1	Plaquemines Parish Commission Council	8-inch - diameter potable water line	Relocate	Plates 2 thru 6
T-1	South Central Bell Telephone Company	600-pair, 400-pair, 100-pair, and 50-pair - 22 gauge buried telephone cables	Relocate	Plates 2 thru 6
W-2	Mr. Chalin O. Perez	8-inch - diameter water siphon	Relocate	Plate 4
P-2	U.S. Coast Guard	Aerial powerline to Scarsdale Light	Relocate	Plate 5

1. PURPOSE OF DESIGN MEMORANDUM. The purpose of this design memorandum is to present the plans for the relocation and alteration of the facilities which will be affected by the construction of item M-75.6 - 74.5-L Scarsdale-Stella Levee Setback, hereinafter referred to as the Scarsdale-Stella reach. It is being submitted in compliance with Part 3, Section LXXIII, ER 1180-1-1, dated 1 July 1980, and DIVR 1110-2-1, dated 29 January 1968. It establishes the necessity for the relocation of the facilities and the plans of relocations; it establishes the legal obligation of the Federal Government, and it will provide the basis for utilizing Federal funds in accomplishing the relocations described herein.

2. PROJECT AUTHORIZATION.

a. Construction, Enlargement, or Improvement of Main Line Mississippi River Levees.

Authority for construction, enlargement, or improvement of main line Mississippi River levees, including berms, is contained in the Act of 15 May 1928 (PL 391, 70th Congress) as amended. The furnishing of right-of-way for levee foundations and levees on the main stem Mississippi River, except levee setbacks, is an obligation of local interests (see Section 3, Act of 15 May 1928). The replacement or relocation of public roads, highways, railroads, public utilities, and pipelines required for the construction of main line Mississippi River levees will be accomplished at Federal expense. Reimbursement of costs to local cooperating agencies in perfecting relocation of interfering facilities may be made pursuant to the Act of 23 April 1934 (PL 171, 73d Congress).

b. Levee Setbacks, Main Line Mississippi River Levees.

Authority for the construction of levee setbacks of main line Mississippi River levees is contained in the Act of 15 May 1928 (P.L. 391, 70th Congress), as amended. Payment or reimbursement of costs to local cooperating agencies for rights-of-way furnished including necessary relocation or alteration of public roads, highways, railroads, public utilities, and pipelines is authorized by the Flood Control Act of 18 August 1941 (PL 228, 77th Congress, 1st Session), as amended by the Flood Control Act of 22 December 1944 (PC 534, 78th Congress, 2d Session).

3. AUTHORITY FOR ACCOMPLISHING RELOCATIONS. Policy for relocations is provided by DIVR 1110-2-1. The legal obligations of the Federal Government regarding the affected facilities and the extent of authority for the relocations are as established in the attorney's report which is attached as Appendix I.

4. DESCRIPTION OF EXISTING FACILITIES AFFECTED BY THE PROJECT.

a. Road. The State of Louisiana owns a two lane, 24-foot wide, bituminous-surfaced highway located adjacent and parallel to the existing levee. This highway is designated by the Louisiana Department of Transportation and Development, Office of Highways as State Route Louisiana 39. The most recent traffic count available for this highway is provided by a 1979 traffic map for State of Louisiana roads as prepared by Louisiana Office of Highways in cooperation with the U.S. Department of Transportation, Federal Highway Administration. This map indicates that the 24-hour average traffic count for Highway 39 is 900 vehicles per day at a point in the vicinity of the proposed levee setback. This traffic count supports a classification of class 4 in the Louisiana Department of Transportation and Development, Office of Highways' Minimum Design Standards for Rural Highways and Roads (Appendix II). Further discussion regarding this facility is found in paragraph 7.a. (page 4) of this report. Approximately 5,350 linear feet of the existing highway will be affected by the Scarsdale-Stella reach. This facility is shown as item R-1 on plates 2 thru 6 of this report.

b. Utilities.

(1) Louisiana Gas Service Company (LGS). Louisiana Gas Service Company, a Louisiana corporation domiciled in Jefferson Parish, Louisiana owns a 4-inch diameter steel gas main located adjacent and parallel to the existing State Route Louisiana 39. The total length of this facility is 17.4 miles of which approximately 5,500 linear feet (1.04 miles) will be affected by the Scarsdale-Stella reach. This facility was installed in 1962 with continuous cathodic protection and is in good condition. The owner claims indefinite design life for the facility. For purposes of this report, it will be assumed that the gas main has a design life of 100 years. The gas main is located completely outside of the existing levee right-of-way, and it is shown as item G-1 on plates 2 thru 6 of this report.

(2) Louisiana Power and Light Company (LP&L). Louisiana Power and Light Company, a Louisiana corporation domiciled in Orleans Parish, Louisiana owns a 13.8 kV 3-phase aerial distribution line located adjacent and parallel to the existing State Route Louisiana 39. The total length of this facility is 20 miles, of which approximately 5,500 linear feet (1.04 miles) will be affected by the project. This facility was originally installed in the early 1940's and it was completely updated in 1964. The facility has a design life of 33 years, and it is in good condition. The powerline is located completely outside of the existing levee right-of-way, and it is shown as item P-1 on plates 2 thru 6 of this report.

(3) Plaquemines Parish. Plaquemines Parish owns an 8-inch diameter potable water main located adjacent and parallel to the existing State Route Louisiana 39. The total length of this facility is 23 miles of which approximately 5,500 linear feet (1.04 miles), including seven fire hydrant assemblies and

three main line valves will be affected by the project. This facility was installed in 1959, and it was composed entirely of cast iron pipe with a design life of 50 years. Approximately 1,200 linear feet of the cast iron main was replaced in 1975 with 8-inch diameter asbestos cement (A.C.) pipe as a relocation item of work by the Scarsdale Levee Setback, item M-75.0-L. This facility is in good condition and is located completely outside of the existing levee right-of-way. It is shown as item W-1 on plates 2 thru 6 of this report.

(4) South Central Bell Telephone Company (SCB). South Central Bell Telephone Co., a Delaware Corporation owns a 600 pair 22-gauge, a 400 pair 22 gauge, a 100 pair 22-gauge, and a 50 pair 22-gauge buried cable located adjacent and parallel to the existing State Route Louisiana 39. There are two cables buried in a common trench throughout the limits of work. The 600 and 50 pair cables run along the upper two-thirds of the reach while the 400 and 100 pair cables run along the lower one-third of the Scarsdale reach. Short lengths of 25 pair cable are used to tie in to terminals to provide local service. The total length of the existing cables is 35.6 miles, of which approximately 4,000 linear feet of the 600 and 50 pair cables, 2,000 linear feet of the 400 and 100 pair cables, and 70 linear feet of 25 pair cable will be affected by the Scarsdale-Stella reach. This facility was installed in 1977; it has a design life of 33 years and is in good condition. The telephone cables are located completely outside of the existing levee right-of-way, and are shown as item T-1 on plates 2 thru 6 of this report.

(5) Mr. Chalin O. Perez. Mr. Chalin O. Perez, a private individual domiciled in Plaquemines Parish, Louisiana owns an 8-inch diameter steel pipeline which crosses the levee at right angles at approximate levee station 932+00. This facility is used to siphon water from the Mississippi River to a crayfish pond located on the landside off the adjacent road. The total length of this facility is 320 linear feet, and it will be affected in its entirety by the Scarsdale-Stella reach. This facility was installed in 1975 with a design life of 20 years and is in good condition. Approximately 25% (80 linear feet) of the affected facility is located outside of the existing levee right-of-way, and it is shown as item W-2 on plate 4 of this report.

(6) United States Coast Guard. The United States Coast Guard owns an aerial electrical service line which crosses the levee at right angles at approximate levee station 934+50. This facility furnishes electrical power to the Scarsdale Navigation Light which is located on the riverside of the levee. The total length of this service line which is approximately 150 linear feet, all of which will be affected by the Scarsdale-Stella reach. The navigation light itself will not be disturbed. Approximately 25% (40 linear feet) of the affected facility is located outside of the existing levee right-of-way, and is shown as item P-2 on plate 5 of this report.

5. OWNER'S COMPENSABLE INTERESTS. The attorney's report, which considers the compensable interests of the owners of the facilities affected by the Scarsdale-Stella project, is attached as Appendix I. The report finds that the Department of Transportation and Development (item R-1) and Plaquemines Parish (item W-1) are political subdivisions of the State of Louisiana, that LGS, LP&L and SCB (items G-1, P-1 and T-1, respectively) are public utilities, all of which enjoy the power of eminent domain. The report also finds that the facilities owned by Mr. Chalin O. Perez (item W-2) and by the U.S. Coast Guard (item P-2) enjoy a compensable interest where the facilities are located outside of the existing levee right-of-way. Where items W-2 and P-2 exist within the existing levee right-of-way, they are located there by permission of the local levee authority, and therefore, no compensable interest can be established. The attorney's report concludes that it is the obligation of the United States to relocate all of the public utilities (items P-1, G-1, W-1, and T-1) where they exist outside of the existing levee right-of-way. The portion of Mr. Perez's facility (item W-2) which is located outside of the existing levee right-of-way will be acquired by the local assuring agency as part of the real estate acquisition process. The remainder of this facility will be removed by the owner at no expense to the Federal Government. Pursuant to the provisions of ER-1180-1-1, civil works funds may not be used to relocate facilities owned by another federal agency. Therefore, the Coast Guard's item P-2 is to be relocated at the owner's expense.

6. FIELD RECONNAISSANCE AND INVESTIGATION. Field surveys, field inspections, consultations, and correspondence with the affected facility owners and with members of the Plaquemines Parish Commission Council (PPCC), the local assuring agency for this project, provided the basic information from which this design memorandum and the proposed relocations were prepared.

7. CRITERIA FOR RELOCATED FACILITIES.

a. Road. The design and relocation of State Route Louisiana 39 (item R-1) will be accomplished by this District in accord with the standards of the Louisiana Department of Transportation and Development, Office of Highways. As discussed in paragraph 4.a. (page 2) of this report, the latest traffic count supports a classification of class 4 for the existing roadways which would dictate a replacement road contained in a 120-foot wide right-of-way. However, in consideration of limited usable land in the Scarsdale-Stella project area, the Louisiana Department of Transportation and Development has concurred that the replacement road should be built in a right-of-way of averaging 95 feet in width. Copies of pertinent correspondence regarding the affected highway are provided by Appendix III, Exhibits A through K. The replacement road will encompass some features attributable to class 4 highways (lane and shoulder widths), while other features (right-of-way width) will be incorporated at the request of the Plaquemines Parish Commission Council and as concurred in by the Louisiana Office of Highways. The replacement road will be designed by this District and will be included as an item of work in the levee contract.

b. Utilities. The owners of the affected facilities (items G-1, P-1, W-1, and T-1, respectively) will accomplish the design and relocation of their facilities to their individual criteria and in a manner which will eliminate interference with the project. If an owner's criteria results in a betterment, that betterment will be discussed with the owner, and payment for the betterment will be disallowed by this District. This is in accord with paragraph 73-106 of ER 1180-1-1, which stipulates that "... a substitute facility will be provided which will, as nearly as practicable, serve the owner in the same manner and reasonably as well as does the existing facility." The owners of items W-2 and P-2 will remove their existing facilities prior to the start of levee construction. After the new levee is constructed, the removed facilities may be replaced pursuant to the local levee board's permission.

8. DESCRIPTION OF PROPOSED RELOCATIONS.

a. Road. The alinement for the proposed relocation of State Route Louisiana 39 is shown on plates 2 thru 6 of this report. The new road will approximate the design standards of a class 4 road, as outlined by the Louisiana Office of Highways' Minimum Design Standards for Rural Highways and Roads (Appendix II). The primary deviation from class 4 standards is that the new road will be built within an average right-of-way width of 95 feet, in lieu of 120 feet (reference appendix III and plate 7). The new road will consist of approximately 5,350 linear feet of asphaltic concrete pavement 24 feet wide by 3 1/2 inches thick, built on an 8 1/2 inch thick base course. Compacted shell shoulders will be 8 feet wide. A typical section for the relocated road is shown on plate 7. Drainage culverts will be placed under the road to drain runoff from the levee side to the landside of the road. Temporary bypass roads will be constructed at each end of the job limits to assure continued flow of traffic during construction of the relocated road.

b. Utilities.

(1) Louisiana Gas Service Company. LGS will relocate item G-1 on an alinement just inside the landside boundary of the new road right-of-way. The relocated facility will consist of approximately 5,500 linear feet of 4-inch diameter steel gas main with continuous cathodic protection. This relocation is to be accomplished at Federal expense.

(2) Louisiana Power and Light Co. LP&L will relocate item P-1 on an alinement just outside the landside boundary of the new road right-of-way. The new facility will consist of approximately 5,500 linear feet of 13.8 kV aerial transmission powerline attached on treated timber poles. The Federal Government will pay for the cost of constructing the new facility.

(3) Plaquemines Parish. Plaquemines Parish will relocate item W-1 on an alinement parallel and adjacent to item G-1, the LGS gas main. The new facility will be located 5 feet inside the new road right-of-way, and it will consist of approximately 5,500 linear feet of 8 inch

diameter A.C. water main with three main line valves and seven fire hydrant assemblies. This facility will be relocated at Federal expense. Installing 8" A.C. pipe is not considered a betterment since the cost of installing the proposed 8" A.C. pipe is estimated to be 30 percent less than the cost of replacing the existing water main with 8" C.I. pipe.

(4) South Central Bell Telephone Co. SCB will relocate item T-1 on the new LP&L power poles which will be located just outside of the new road right-of-way. The new facility will consist of 5,500 linear feet of 106 pair, 22 gauge screen aerial cable and 1,250 linear feet of 50 pair, 22 gauge aerial cable. The existing four buried cables will be abandoned in place. Item T-1 will be relocated at Federal expense.

9. PROCEDURE FOR ACCOMPLISHING RELOCATIONS.

a. Road. The Louisiana Department of Transportation and Development, Office of Highways and the Plaquemines Parish Engineering and Public Works Department furnished the criteria and basic design for item R-1, State Route Louisiana 39. This District will prepare the detailed plans and specifications for the relocated roadway, which will be constructed by the Government's contractor at no cost to the owner. The right-of-way for the relocated road is shown on plates 2 thru 6 of this report.

b. Utilities. The affected utility owners will prepare detailed plans and specifications for the cutting, abandoning, removing, or relocating of their facilities, and they will accomplish their work in a manner that will not interfere with the project. The owners' plans and specifications will be reviewed by this District to determine if the owners' proposals are compatible with the project. The relocations will be closely coordinated among all parties involved. Upon approval of this design memorandum and in accord with the provisions described herein, the Plaquemines Parish Commission Council being the governing body of the Grand Prairie Levee District, the local assuring agency, will advise the affected owners to effect their relocation. This District will advise the PPCC of the dollar amount (based on the approved design memorandum) available for reimbursement to each owner (items P-1, G-1, W-1, and T-1). Payments will be based on actual cost for accomplishing the work, adjusted where appropriate, for depreciation, salvage value, and betterments. Upon completion of the relocation, the PPCC will furnish a reimbursement assembly to this District consisting of: copies of any contracts (including plans and specifications) covering work performed by others or itemized billings for labor and materials if the work was performed by the owner, and a copy of all canceled checks covering related payment. Further all records related to the reimbursement request will be subject to audit by the Government and original time cards or payrolls, material records, and accounts for all charges and expenditures for which reimbursement will be claimed from the Government will be available at all reasonable times for Government inspection. Finally, so far as practicable, the owner will maintain separate records for all items and accounts constituting the basis of information from which the reimbursement assembly is prepared. Item W-2 will be acquired by the local levee district as part of its right-of-way acquisition for the project. Item P-2 will be relocated by the U.S. Coast Guard at its own expense.

10. ATTITUDE OF OWNERS: All of the affected facility owners and representatives of the Plaquemines Parish Commission Council have cooperated in developing the information presented in this design memorandum. Our latest contacts with these owners indicate that they will be ready to perform the relocations in a timely manner upon notification by this District. We do not anticipate any problems in accomplishing the relocations required by this project.

11. ESTIMATE OF COST.

The estimated Federal cost for accomplishing the proposed relocations has been prepared in accordance with the provisions of ER-1180-1-1 and is based on relocation plans proposed by or agreed to by the affected owners. The relocations costs are summarized in Table 2 below, and they are presented in more detail in Tables IV-1 through IV-5 of Appendix IV. All costs presented in this report shall be chargeable to "Maintenance Funds".

TABLE 2
SUMMARY OF ESTIMATED FEDERAL RELOCATIONS COST
(JUNE 1981 PRICE LEVELS)

<u>DESCRIPTION/OWNER</u>	<u>ESTIMATED COST (\$)</u>
Road	
State Route Louisiana 39	1,012,000
Road R/W	226,000
Subtotal Road	<u>1,238,000</u>
Utilities	
Louisiana Gas Service Co.	113,000
Louisiana Power and Light Co.	72,000
Plaquemines Parish	92,000
South Central Bell Telephone Co.	<u>24,000</u>
Subtotal Utilities	301,000
Subtotal Relocations	1,539,000
E&D (6%+)	78,500
S&A (6%+)	<u>78,500</u>
TOTAL	1,696,000

¹Includes 25% contingencies

²No E&D or S&A for Road R/W

12. COMPARISON WITH PRIOR COST ESTIMATES. The latest approved cost estimate for the Mississippi River Levees project, maintenance funds, is the Detailed Project Schedule (PB-2A), CYR ES 013, effective 1 October 1980, as approved 15 December 1980. The funds for the Scarsdale-Stella reach are not itemized in the PB-2A, but they are contained in the "Lands and Damages" (Maintenance) line item. The funds for the Scarsdale-Stella reach have been broken out as indicated below to facilitate a comparison.

TABLE 3
COMPARISON OF COST - MAINTENANCE FUNDS

<u>Item</u>	<u>Latest Approved PB-2A (\$1,000's)</u>	<u>Current Working Estimate (\$1,000's)</u>	<u>Difference from PB-2A (\$1,000's)</u>
Relocations			
Road	525.0	1,238.0	+713.0
Utilities	482.0	301.0	-181.0
E&D	78.5	78.5	0.0
S&A	<u>78.5</u>	<u>78.5</u>	<u>0.0</u>
TOTAL	1,164.0	1,696.0	+532.0

13. JUSTIFICATION FOR COST REVISION. The original relocations cost estimates were prepared in December 1979, and they were based on preliminary information available about the Scarsdale-Stella reach at that time. The estimates were prepared "in-house" without benefit of input from the affected owners. The unit prices used in the original estimate have proven to be very much on the low side. The current working estimates are based on more detailed data now available for the Scarsdale-Stella and on contacts with the affected owners. Additionally, the original cost estimates provided for 15% contingencies, whereas 25% contingencies are considered more appropriate and are used in the current working estimate.

14. RECOMMENDATIONS. We recommend that this design memorandum be approved as the basis for reimbursing the Plaquemines Parish Commission Council for accomplishing the relocations as described in this report.

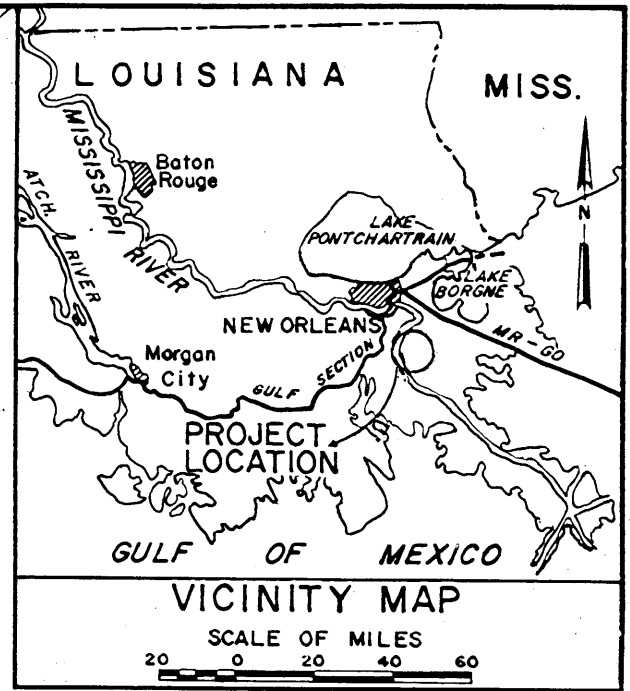
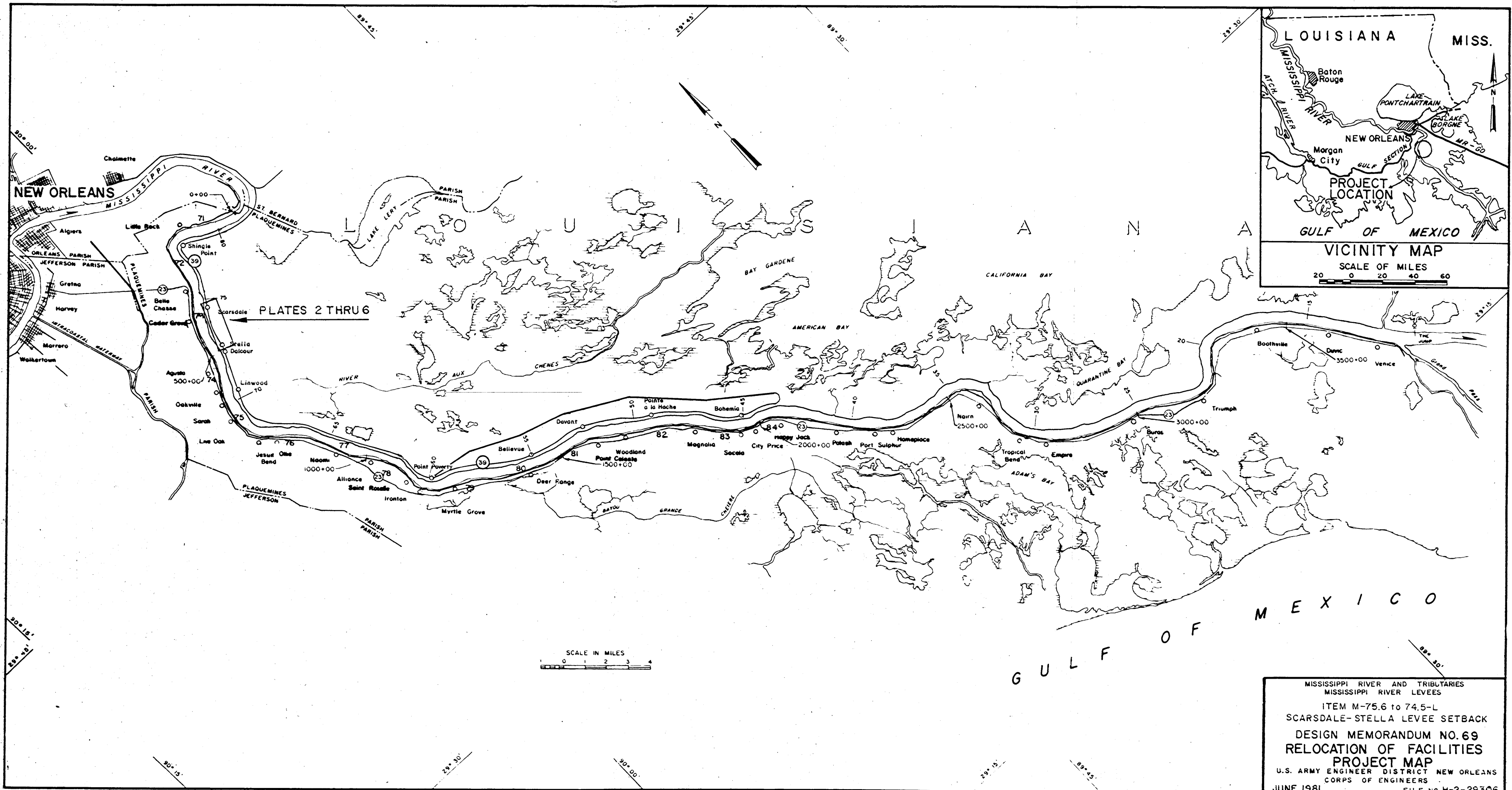

PLATES 2 THRU 6

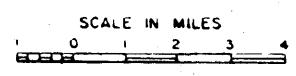

MISSISSIPPI RIVER AND TRIBUTARIES
 MISSISSIPPI RIVER LEVEES
 ITEM M-75.6 to 74.5-L
 SCARSDALE-STELLA LEVEE SETBACK
 DESIGN MEMORANDUM NO.69
 RELOCATION OF FACILITIES
 PROJECT MAP
 U.S. ARMY ENGINEER DISTRICT NEW ORLEANS
 CORPS OF ENGINEERS
 JUNE 1981 FILE NO. H-2-29306

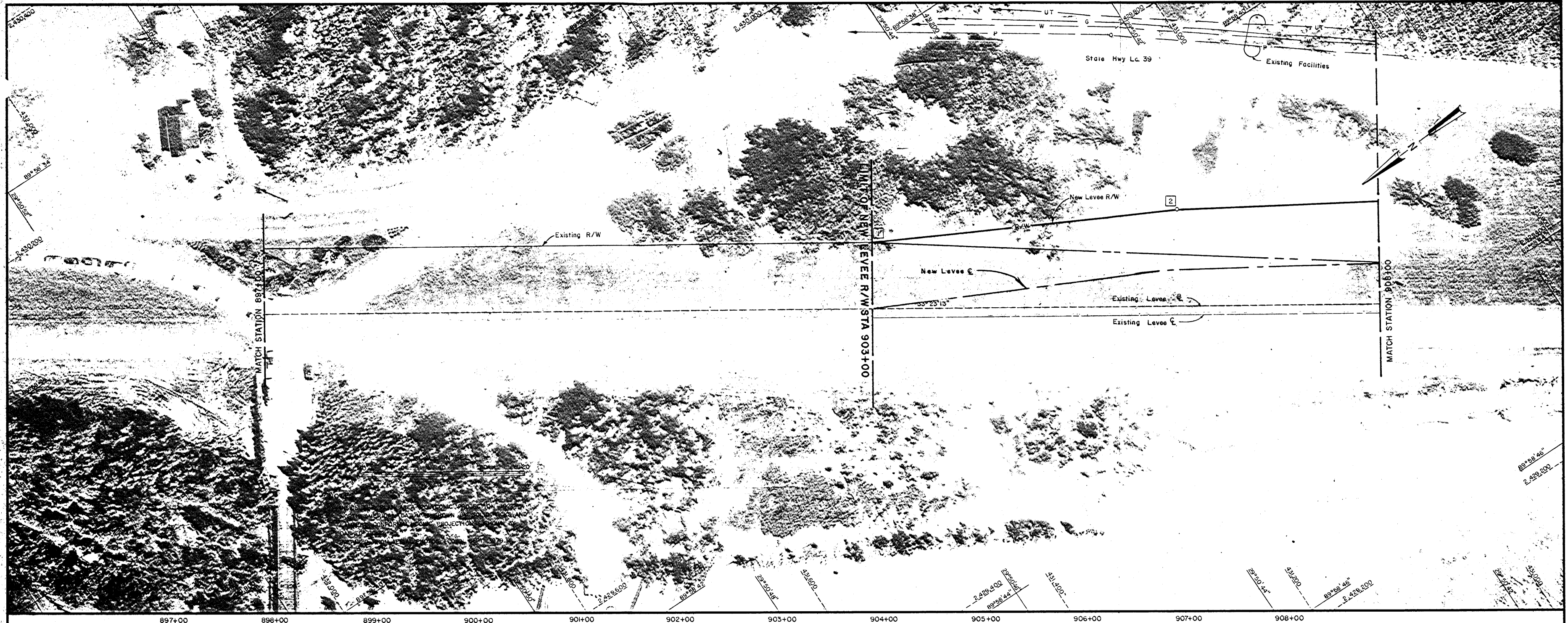

897+00 898+00 899+00 900+00 901+00 902+00 903+00 904+00 905+00 906+00 907+00 908+00

FOR LEGEND AND EXISTING FACILITIES TABLE SEE PLATE 3

LEVEE R/W TABULATIONS			
PI	B/L STATION	OFFSET	OFFSET AZIMUTH
1	903+00	65'	303°23'13"
2	906+00	95'	303°23'13"

MISSISSIPPI RIVER AND TRIBUTARIES
 MISSISSIPPI RIVER LEVEES
ITEM M-75.6 TO 74.5-L
SCARSDALE-STELLA LEVEE SETBACK

DESIGN MEMORANDUM NO.69

PROJECT PLAN
 U. S. ARMY ENGINEER DISTRICT, NEW ORLEANS
 CORPS OF ENGINEERS

JUNE 1981 FILE NO. H-2-29306

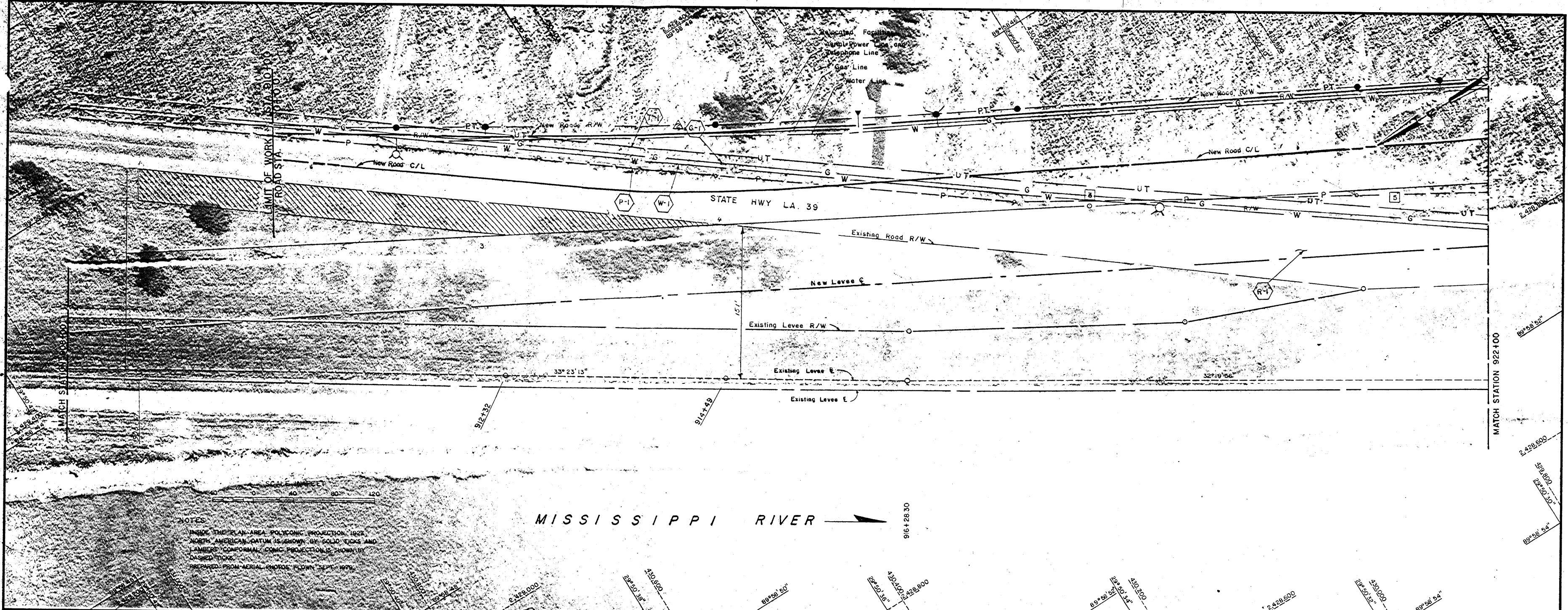

NOTES
 INSIDE THE PLAN AREA POLYCONIC PROJECTION 1927
 NORTH AMERICAN DATUM IS SHOWN BY SOLID TICKS AND
 LAMBERT CONFORMAL CONIC PROJECTION IS SHOWN BY
 DASHED TICKS
 PREPARED FROM AERIAL PHOTOS FLOWN SEPT. 1978

CONSTRUCTION EASEMENT			
P I	B/L STATION	OFFSET	
1	908+67	198'	303°00'00"
2	908+67	167'	303°00'00"
3	912+32	138'	303°00'00"
4	914+49	151'	303°00'00"

TABULATION OF LEVEL R/W OFFSET			
P I	B/L STATION	OFFSET	Azimuth
3	918+00	172'	302°19'56"

TABULATION OF ROAD R/W OFFSET				
BASELINE STATION	C/L PI	B/L STATION	OFFSET	Azimuth
910+00	▲	0+00	236'	303°00'00"
914+00	▲	3+99.84	231.66'	303°00'00"

- LEGEND
- Pole with down guy
 - Aerial powerline
 - W — Waterline
 - G — Gasline
 - UT — Buried telephone cable
 - ★ — Navigation light
 - ⦿ — Fire Hydrant
 - ⦿ — Gas Meter

EXISTING FACILITIES				
ITEM NO.	DESCRIPTIONS	STA.	OWNER	DISPOSITION
P-1	13.8KV POWER LINE	909+00 TO 964+00	LOUISIANA POWER & LIGHT CO.	RELOCATE
T-1	4 BURIED TELE. CABLES	909+00 TO 964+00	SOUTH CENTRAL BELL TELEPHONE CO.	RELOCATE
G-1	4" φ GAS LINE	909+00 TO 964+00	LOUISIANA GAS SERVICE CO.	RELOCATE
W-1	8" φ WATER LINE	909+00 TO 964+00	PLAQUEMINES PARISH	RELOCATE
R-1	ROAD LA. 39	909+00 TO 964+00	LOUISIANA OFFICE OF HIGHWAYS	RELOCATE

MISSISSIPPI RIVER AND TRIBUTARIES
 MISSISSIPPI RIVER LEVEES
ITEM M-75.6 TO 74.5-L
SCARSDALE-STELLA LEVEE SETBACK
 DESIGN MEMORANDUM NO. 69
 RELOCATION OF FACILITIES
 PROJECT PLAN
 U.S. ARMY ENGINEER DISTRICT, NEW ORLEANS
 CORPS OF ENGINEERS
 JUNE 1981 FILE NO. H-2-29306

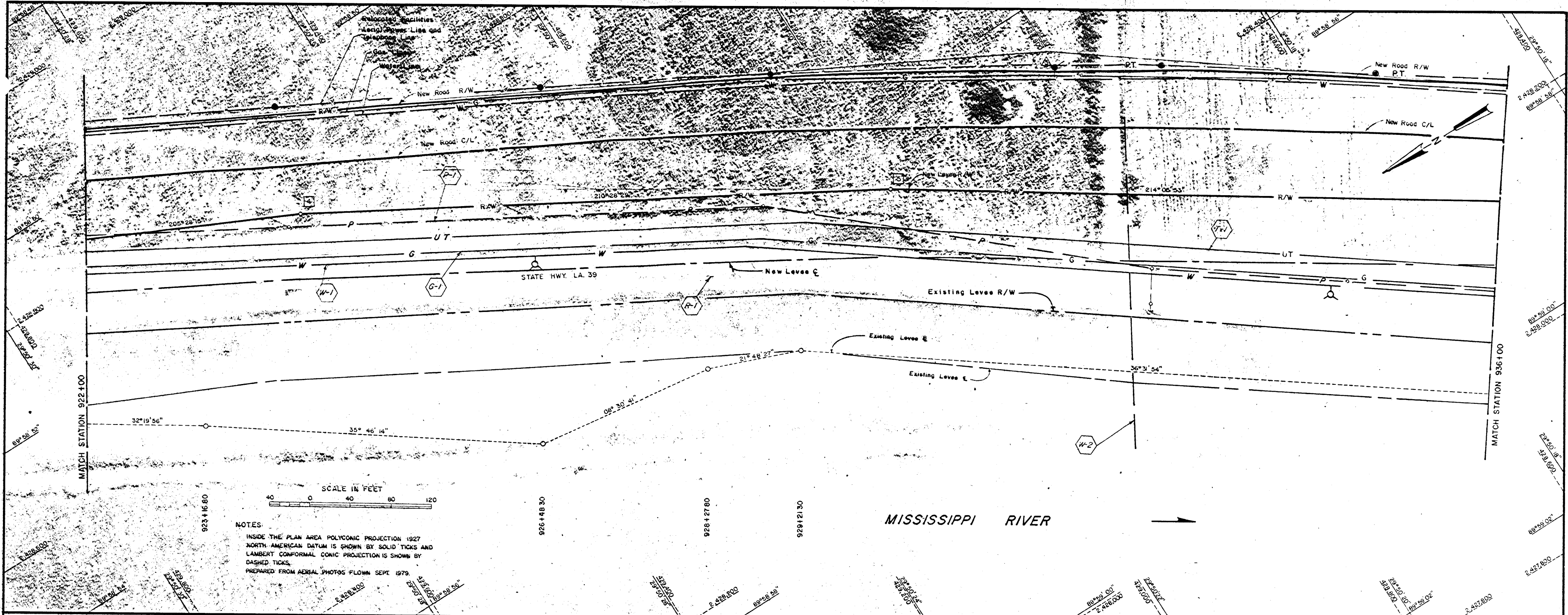

NOTES:
 INSIDE THE PLAN AREA POLYCONIC PROJECTION 1927
 NORTH AMERICAN DATUM IS SHOWN BY SOLID TICKS AND
 LAMBERT CONFORMAL CONIC PROJECTION IS SHOWN BY
 DASHED TICKS.
 PREPARED FROM AERIAL PHOTOS FLOWN SEPT 1979.

FOR LEGEND SEE PLATE 3

P I	B/L STATION	OFFSET	AZIMUTH
4	924+00	211'	305°46'14"
5	930+00	163'	306°31'54"

BASILINE STATION	C/L PI	R/W STATION	OFFSET	AZIMUTH
931+43.3	△	21+48.04	306'	306°31'54"

ITEM NO.	DESCRIPTIONS	STA.	OWNER	DISPOSITION
P-1	13.8KV POWER LINE	909+00 to 964+00	LOUISIANA POWER & LIGHT CO.	RELOCATE
T-1	4 BURIED TELE. CABLES	909+00 to 964+00	SOUTH CENTRAL BELL TELEPHONE CO.	RELOCATE
G-1	4" φ GAS LINE	909+00 to 964+00	LOUISIANA GAS SERVICE CO.	RELOCATE
W-1	8" φ WATER LINE	909+00 to 964+00	PLAQUEMINES PARISH	RELOCATE
R-1	ROAD LA. 39	909+00 to 964+00	LOUISIANA OFFICE OF HIGHWAYS	RELOCATE
W-2	8" φ WATER SIPHON	932+00	CHANLIN O. PEREZ	RELOCATE

MISSISSIPPI RIVER AND TRIBUTARIES
 MISSISSIPPI RIVER LEVEES
ITEM M-75.6 TO 74.5-L
SCARSDALE-STELLA LEVEE SETBACK
 DESIGN MEMORANDUM NO. 69'
 RELOCATION OF FACILITIES
 PROJECT PLAN
 U.S. ARMY ENGINEER DISTRICT, NEW ORLEANS
 CORPS OF ENGINEERS
 JUNE 1981
 FILE NO. H-2-29306

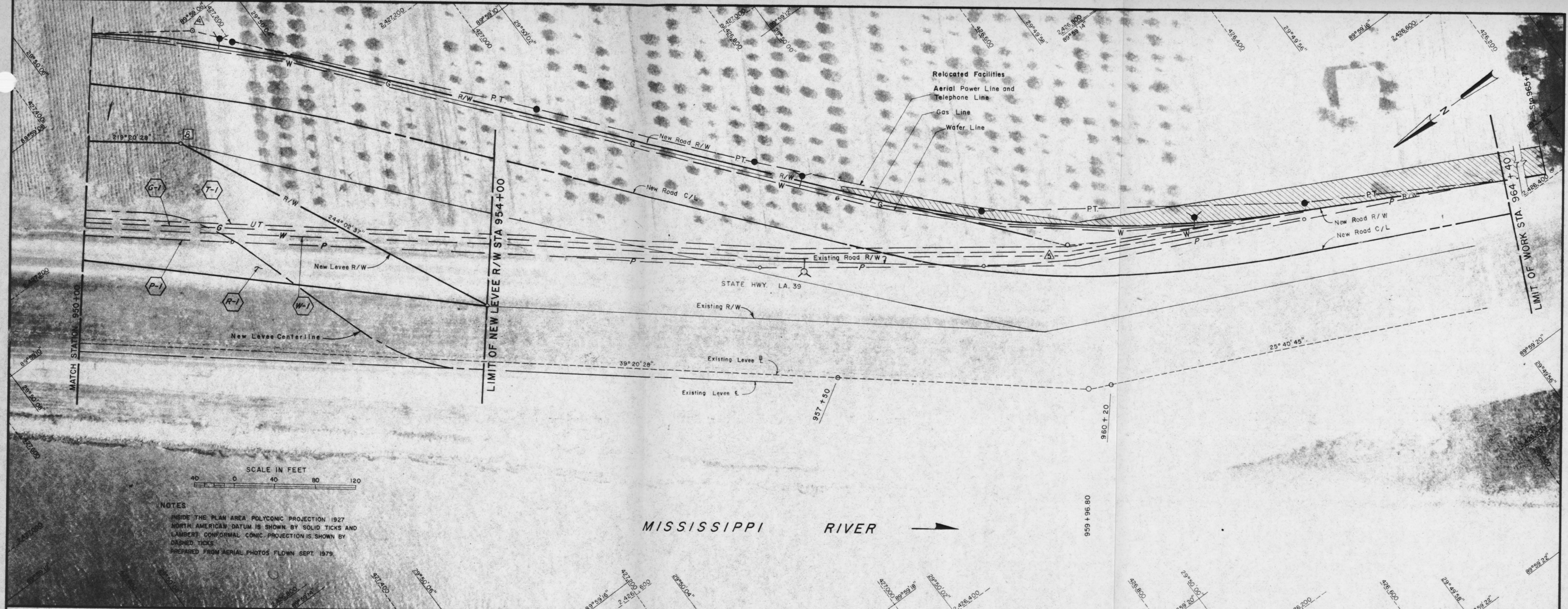

NOTES:
 INSIDE THE PLAN AREA POLYCONIC PROJECTION 1927
 NORTH AMERICAN DATUM IS SHOWN BY SOLID TICKS AND
 LAMBERT CONFORMAL CONIC PROJECTION IS SHOWN BY
 DASHED TICKS
 PREPARED FROM AERIAL PHOTOS FLOWN SEPT. 1979.

MISSISSIPPI RIVER

EXISTING FACILITIES				
ITEM NO	DESCRIPTIONS	STA.	OWNER	DISPOSITION
P-1	13.8KV POWER LINE	909+00 to 964+00	LOUISIANA POWER & LIGHT CO.	RELOCATE
T-1	4 BURIED TELE. CABLES	909+00 to 964+00	SOUTH CENTRAL BELL TELEPHONE CO.	RELOCATE
G-1	4" φ GAS LINE	909+00 to 964+00	LOUISIANA GAS SERVICE CO.	RELOCATE
W-1	8" φ WATER LINE	909+00 to 964+00	PLAQUEMINES PARISH	RELOCATE
R-1	ROAD LA. 39	909+00 to 964+00	LOUISIANA OFFICE OF HIGHWAYS	RELOCATE

CONSTRUCTION		EASEMENT	
PI	B/L STATION	OFFSET	OFFSET Azimuth
5	957+50	190'	309° 20' 28"
6	957+50	185'	309° 20' 28"
7	960+20	165'	295° 35' 24"
8	965+73	118'	295° 35' 24"
9	965+73	145'	295° 35' 24"

TABULATION OF LEVEL R/W OFFSET			
PI	B/L STATION	OFFSET	Azimuth
8	951+00	198'	309° 20' 28"

TABULATION OF ROAD R/W OFFSET				
BASLINE STATION	PI	B/L STATION	OFFSET	Azimuth
951+00	▲	41+17.85	312'	309° 20' 28"
960+00	▲	49+96.41	148.36'	295° 35' 24"

FOR LEGEND SEE PLATE 3

MISSISSIPPI RIVER AND TRIBUTARIES
 MISSISSIPPI RIVER LEVEES
ITEM M-75.6 TO 74.5-L
SCARSDALE-STELLA LEVEE SETBACK
 DESIGN MEMORANDUM NO.69
 RELOCATION OF FACILITIES
 PROJECT PLAN
 U.S. ARMY ENGINEER DISTRICT, NEW ORLEANS
 CORPS OF ENGINEERS

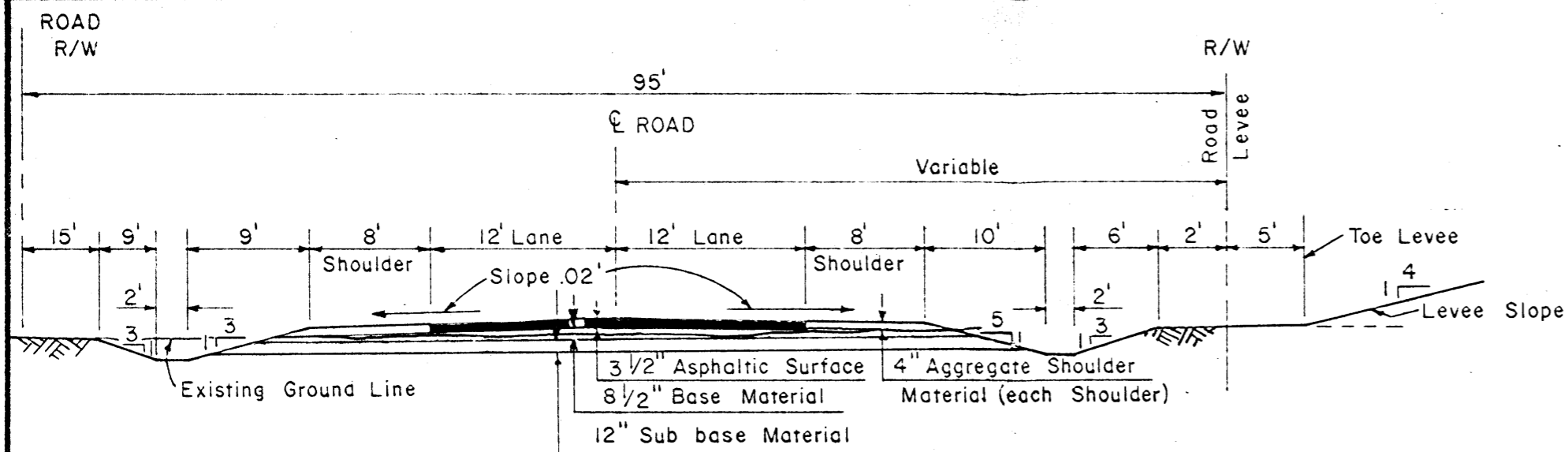

TYPICAL ROAD SECTION

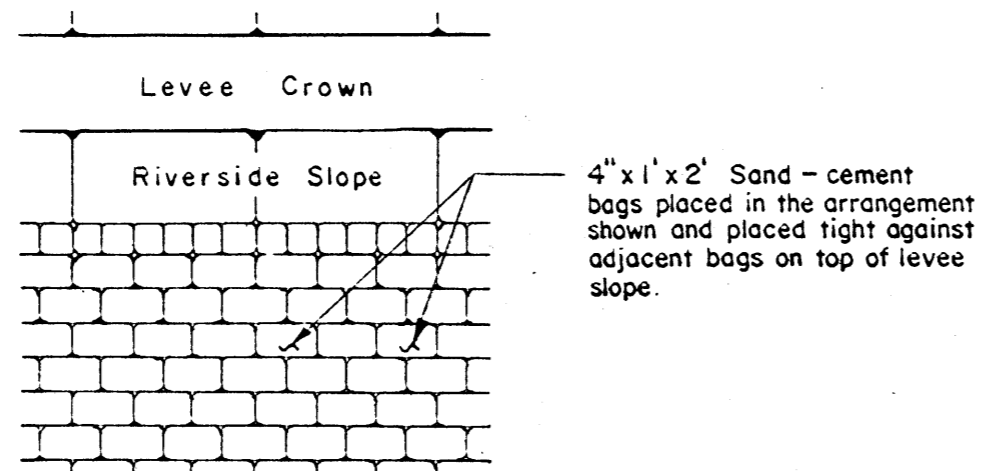

SAND-CEMENT BAG PATTERN

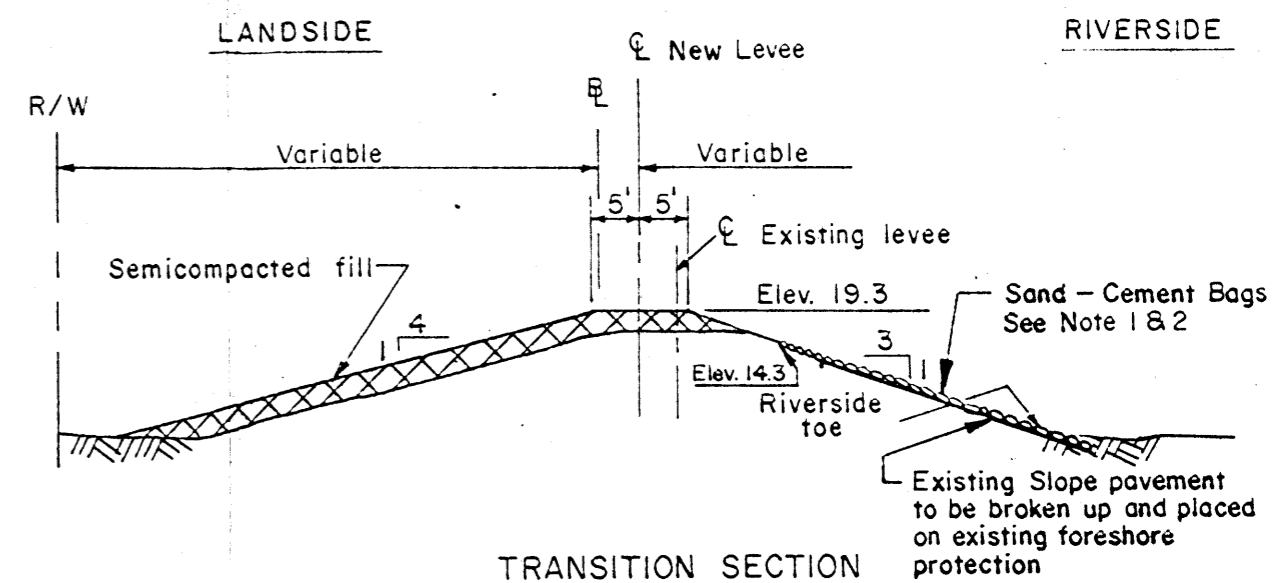

TRANSITION SECTION

Transition from existing levee Sta.903+00 to 904+00
 Transition from Sta.953+00 to existing levee Sta.954+00

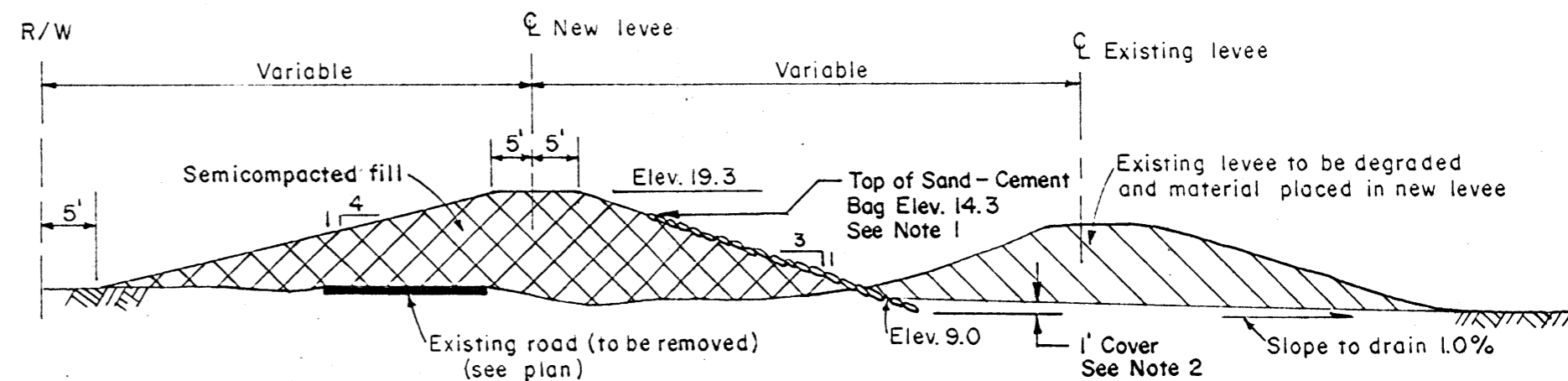

TYPICAL SECTION I

Sta.904+00 to Sta.918+00
 Sta.924+00 to Sta.927+00
 Sta.933+00 to Sta.953+00

NOTES:

1. Top bag placed on end to provide adequate cutoff.
2. Bottom bag to penetrate 1ft. beneath ground surface. Toe trench to be backfilled with uncompacted fill after placing the sand - cement bags.

NOT TO SCALE

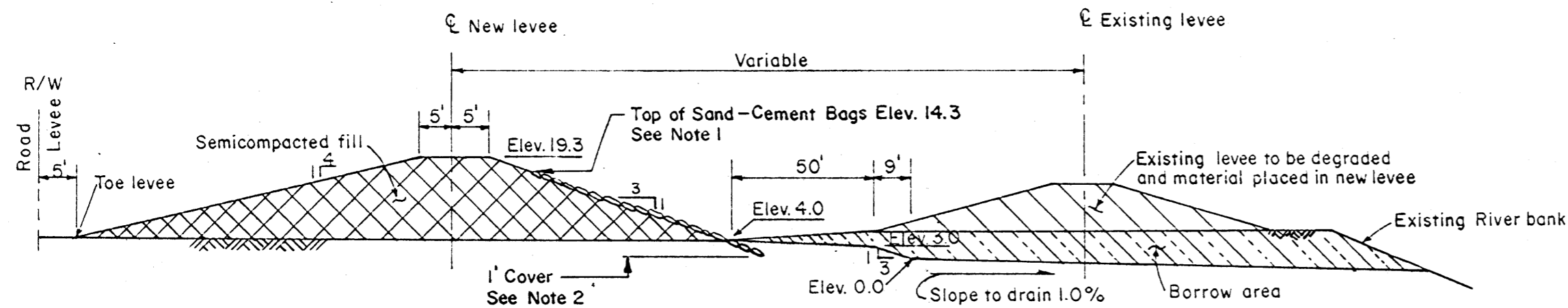

TYPICAL SECTION II

STA.918+00 to STA.924+00
 STA.927+00 to STA.933+00

MISSISSIPPI RIVER AND TRIBUTARIES
 MISSISSIPPI RIVER LEVEES
 ITEM M-75.6 to 74.5-L
 SCARSDALE-STELLA LEVEE SETBACK
 DESIGN MEMORANDUM NO. 69
 RELOCATION OF FACILITIES
 TYPICAL SECTIONS
 U.S. ARMY ENGINEER DISTRICT NEW ORLEANS
 CORPS OF ENGINEERS
 JUNE 1981 FILE NO. H-2-29306

FLOOD CONTROL, MISSISSIPPI RIVER AND TRIBUTARIES
MISSISSIPPI RIVER LEVEES
ITEM M-75.6 - 74.5-L
SCARSDALE-STELLA, LEVEE SETBACK
PLAQUEMINES PARISH, LOUISIANA
RELOCATION OF FACILITIES
DESIGN MEMORANDUM NO. 69

APPENDIX I
ATTORNEY'S REPORT

ATTORNEY'S INVESTIGATION
AND
REPORT OF COMPENSABLE INTEREST

Item M-75.6 to 74.5-L
Scarsdale-Stella Levee Setback
Mississippi River Levees
Plaquemines Parish, Louisiana

This investigation and report is made in accordance with DIVR 1110-2-2 (see also DIVR 1110-2-1, 29 January 1968) and ER 1180-1-1, Section 73, Part 3, 73-203 and 73-204 on the following facilities which will be affected by the subject project:

- a. State Route Louisiana 39 owned by State of Louisiana through the Department of Transportation and Development, Office of Highways;
- b. A 4-inch diameter gas pipeline, parallel to and landside of LA Highway 39 owned by Louisiana Gas Service Company;
- c. A 13.8 KV distribution powerline, parallel to and landside of Louisiana Highway 39 owned by Louisiana Power and Light Company;
- d. An 8-inch diameter cast-iron pipe potable water line, a portion of which was relocated in 1975 with AC pipe, parallel to and landside of Louisiana Highway 39, owned by Plaquemines Parish Commission Council;
- e. Four buried cables (600-pair, 400-pair, 100-pair, and 50-pair, all 22-gauge), parallel to and landside of Louisiana Highway 39, owned by South Central Bell Telephone Company;
- f. An 8-inch diameter steel pipe water siphon which crosses the levee at approximate levee station 932+00, privately owned by Mr. Chalin O. Perez;
- g. An aerial power line servicing the navigation aide known as Scarsdale Light, located at approximate levee station 934+50 on the riverside, owned by the U.S. Coast Guard.

The location of the above facilities are indicated on Plates 2, 3, 4, 5 and 6 entitled, "Item M-75.6 to 74.5-L, Scarsdale-Stella Levee Setback, Mississippi River Levees, Relocation of Facilities".

I

COMPENSABLE INTEREST
OF
STATE OF LOUISIANA
THROUGH

THE DEPARTMENT OF TRANSPORTATION AND DEVELOPMENT

The Department of Transportation and Development is a political subdivision of the State of Louisiana through LA. REV. STAT ANN. 48:13. Pursuant to LA. REV. STAT. ANN. 48:21, the Department is empowered to "study, administer, construct, improve, maintain and regulate the use of public transportation systems...".

The facility listed in "a" is part of the state highway system. This facility is located outside the existing levee right-of-way. There has been no evidence furnished to date that the right-of-way for the highway was purchased from the fee owners. However, a political subdivision through the power or right of eminent domain possesses a vested right in the right-of-way in need of relocation, even without the use of conventional negotiation and acquisition of the subject right-of-way. See LA. REV. STAT. ANN. 48:441 and 19:14. LA. REV. STAT. ANN. 19:14 is the statutory enactment of the Doctrine of Unopposed Use. Under this Doctrine, when a political corporation or any corporation possesses the powers of eminent domain takes possession of or constructs facilities on privately owned land with the consent or acquiescence of the owner, then it acquires a vested right in the property. Investigation has shown that no land owner has objected to the State's use of the land.

Accordingly, the Department does have a real interest and therefore a compensable interest in this facility where it is located outside the existing levee right-of-way.

II

COMPENSABLE INTEREST
OF
LOUISIANA GAS SERVICE COMPANY

Louisiana Gas Service Company is a Louisiana public utility domiciled in Jefferson Parish, Louisiana. It provides a natural gas service to customers located in Plaquemines Parish, Louisiana and has the right of eminent domain. See LA. REV. STAT ANN. 19:2(5).

The location of the facility listed in "b" is outside the existing levee right-of-way. There is no evidence furnished to date that the right-of-way for the gas pipeline was purchased from the fee owner. However, a corporation having the power or right of eminent domain possesses a vested right in the right-of-way in need of relocation, even without the use of conventional negotiation and acquisition of the subject rights-of-way. See LA. REV. STAT ANN. 19:2(5) and 19:14.

Thus, Louisiana Gas Service Company does possess a compensable interest to this facility when it is located outside the existing levee right-of-way.

III

COMPENSABLE INTEREST
OF
LOUISIANA POWER AND LIGHT COMPANY

Louisiana Power and Light Company is a Louisiana public utility domiciled in Orleans Parish. It provides electric service throughout southeast Louisiana and has the right of eminent domain. See LA. REV. STAT. ANN. 19:2(7).

The facility listed in "c" is owned and maintained by Louisiana Power and Light. It is located outside the existing levee right-of-way. There has been no evidence furnished to date that the portion of the right-of-way outside the existing levee right-of-way was purchased from a fee owner. However, a public utility through the power of eminent domain possesses a real right in the right-of-way in need of relocation, even without the use of conventional negotiation and acquisition of the subject right-of-way. See LA. REV. STAT. ANN. 19:2(7) and 19:14.

Accordingly, Louisiana Power and Light Company does have a compensable interest to this facility where it is located outside the existing levee right-of-way.

IV

COMPENSABLE INTEREST
OF
THE PLAQUEMINES PARISH COMMISSION COUNCIL

Plaquemines Parish is a political subdivision of the State of Louisiana. The governing body of Plaquemines Parish is the Commission Council. The commission council form of government is authorized pursuant to LA. REV. STAT. ANN. 13:1271. Plaquemines Parish Commission Council is authorized to own and operate a waterline through the authority granted by LA. REV. STAT. ANN. 33:1324 and has the power of eminent domain. See LA. REV. STAT. ANN. 33:4621 and 19:2(1).

The facility listed in "d" is located outside the existing levee right-of-way. There has been no evidence furnished to date that this right-of-way was purchased from a fee owner. However, a political subdivision through the power or right of eminent domain possesses a vested right in the right-of-way in need of relocation even without the use of conventional negotiation and acquisition of subject right-of-way. See LA. REV. STAT. ANN. 33:4621, 19:2(1) and 19:14.

Thus, Plaquemines Parish Commission Council does have a compensable interest to this facility where it is located outside the existing levee right-of-way.

V

COMPENSABLE INTEREST
OF
SOUTH CENTRAL BELL TELEPHONE COMPANY

South Central Bell Telephone Company is a Delaware corporation licensed to do business in the State of Louisiana. The company is considered to be a public utility by virtue of LA. REV. STAT. ANN. 45:781. Pursuant to this authority, South Central Bell possesses the right of eminent domain. See LA. REV. STAT. ANN. 19:2(6).

The facilities listed in "e" are located outside the existing levee right-of-way. There is no evidence furnished to date that the rights-of-way for these facilities were purchased from the fee owners. However, a public utility having the right of eminent domain possesses a vested right in the right-of-way in need of relocation, even without the use of conventional negotiation and acquisition of the subject right-of-way. See LA. REV. STAT. ANN. 19:2(6) and 19:14.

Therefore, South Central Bell does have a compensable interest to these facilities where they are located outside the existing levee right-of-way.

VI

COMPENSABLE INTEREST
OF
MR. CHALIN O. PEREZ

Mr. Chalin O. Perez owns a steel water siphon which crosses the levee at approximate levee station 932+00. The water siphon is located here through permission of the local levee authority. Since Mr. Perez's facility is located here through permission, he cannot acquire a real right to this property. Consequentially, no compensatory interest can be established for those portions of this facility which lie within the existing levee right-of-way.

Under Louisiana Law, pipelines are considered to be component parts of the land when they belong to the landowner. As such, they are classified as an immovable and are part of the real estate. See LA. CIV. CODE. ART. 462. Mr. Perez has a compensable interest to this facility where it exists outside the levee right-of-way because it is part of the real estate to be acquired with the land.

VII

COMPENSABLE INTEREST OF THE U.S. COAST GUARD

The U.S. Coast Guard is a division of the Department of Commerce, a Federal agency. The Coast Guard owns an aerial powerline which services the navigation aide known as Scarsdale Light. This powerline crosses the levee at approximate station 934+50.

A portion of the powerline which is situated within the existing levee right-of-way is there through the permission of the local levee authority. As such, the Coast Guard cannot acquire a compensable interest to this property where it lies within the existing levee right-of-way.

A portion of this facility lies outside the existing levee right-of-way. The Coast Guard has an easement for the powerline located outside the existing levee right-of-way. This easement grants the Coast Guard a real right to the land burdened by this servitude. Thus, the Coast Guard does have a compensable interest to the facility where it is located outside the existing levee right-of-way.

Pursuant to ER 1180-1-1, 1 July 1980, Section 73, para. 73-002, facilities of a Federal agency cannot be relocated or altered using civil works funds. Thus, even though the Coast Guard does have a compensable interest in this property, existing regulations prevent the United States Army Corps of Engineers from providing relocation assistance.

VIII

AUTHORITY AND OBLIGATION

Authority for the construction and enlargement or improvement of mainline Mississippi River levees, including berms, is contained in the Act of 15 May 1928 (Public Law 391, 70th Congress), as amended. The furnishing of the rights-of-way for levee foundations and levees on the mainline on the Mississippi River, except for levee setbacks, is the obligation of the local interests (See Section 3, Act of 15 May 1928). The replacement or relocation of public roads, highways, railroads, public utilities and pipelines required for construction of mainline levees of the Mississippi River will be accomplished at federal expense. Reimbursement of costs to local cooperating agencies affecting relocations of interfering facilities may be made pursuant to the Flood Control Act of 18 August 1941 (Public Law 228, 77th Congress, 1st Session), as amended by the Flood Control Act of 22 December 1944 (Public Law 534, 78th Congress, 2d Session).

Payment for facilities owned by a federal agency is prohibited by ER 1180-1-1, 1 July 1980, Section 73, para. 73-002.

SUMMARY

It is the obligation of the local interests, subject to reimbursement by the United States, to relocate all of the facilities listed in "a", "b", "c", "d", and "e" where they exist outside the existing levee right-of-way. The facility listed in "f" where it exists outside the existing levee right-of-way will be acquired as part of the real estate acquisition process. Where the facility listed in "f" exists inside the existing levee right-of-way it will be relocated at the expense of the landowner.

The facility listed "g" will be relocated at the expense of the U.S. Coast Guard where it exists within the existing levee right-of-way. Where it exists outside the existing levee right-of-way, the relocation will be accomplished at other than civil works expense.

20 May 1981
DATE

Randy D. Florent
RANDY D. FLORENT
Attorney-at-law
U. S. Army Engineer District
New Orleans

FLOOD CONTROL, MISSISSIPPI RIVER AND TRIBUTARIES
MISSISSIPPI RIVER LEVEES
ITEM M-75.6 - 74.5-L
SCARSDALE-STELLA, LEVEE SETBACK
PLAQUEMINES PARISH, LOUISIANA
RELOCATION OF FACILITIES
DESIGN MEMORANDUM NO. 69

APPENDIX II
LOUISIANA OFFICE OF HIGHWAYS
MINIMUM DESIGN STANDARDS
FOR RURAL HIGHWAYS AND ROADS

FLOOD CONTROL, MISSISSIPPI RIVER AND TRIBUTARIES
MISSISSIPPI RIVER LEVEES
ITEM M-75.6 - 74.5-L
SCARSDALE-STELLA, LEVEE SETBACK
PLAQUEMINES PARISH, LOUISIANA
RELOCATION OF FACILITIES
DESIGN MEMORANDUM NO. 69

APPENDIX III
PERTINENT CORRESPONDENCE

REPLY TO
ATTENTION OF:

LMBED-MR

5 November 1979

Chief Engineer
Louisiana Department of Transportation and Development
Office of Highways
P.O. Box 44245, Capitol Station
Baton Rouge, Louisiana 70804

Dear Sir:

Personal contact with Messrs. Jack Reid and Harvey Shaffer of your office was made on 16 October 1979 by Messrs. Robert Campos and Vera Carrier of our office to discuss the proposed levee setbacks along the left descending bank of the Mississippi River in the areas of Scarsdale-Stella (Mile 75.6 to 74.5-L), Linwood (Mile 71.0-L), and Harlem (Mile 56.1-L). The proposed levee setbacks will affect State Route LA 39 in these three areas. Our projects are scheduled for award as follows: Harlem in August 1981, Linwood in September 1981 and Scarsdale-Stella in January 1982.

We understand that using "new location" road design criteria, a replacement road designed for the average daily traffic count for the affected reaches of Route LA 39 would require a minimum of 120 feet of right-of-way. Since we are proposing to relocate only three short segments of LA 39, it appears that your criteria for an "existing location" would be more appropriate; i.e., a right-of-way width that would contain all elements of the proposed road cross-section and its appropriate border areas.

You may recall that a short segment of LA 39 was dislocated in 1975 by our project, item M-75.0-L, Scarsdale Levee Setback. The relocated road was built within an 80 foot wide right-of-way in lieu of the 120 foot wide right-of-way dictated for a "new location". The location of the old Scarsdale Setback is now contained in the current Scarsdale-Stella reach.

We note that in the Linwood reach, private residences will be dislocated by the relocated road. Accordingly, this project is particularly sensitive to right-of-way requirements.

Exhibit A,

LMNED-MR
Chief Engineer

5 November 1979

In light of the preceding considerations, we propose to provide 80 feet of right-of-way for each segment of LA 39 that will be affected by our current projects. Additionally, we suggest that the design and construction of the required road relocations be accomplished as part of our levee project, subject to appropriate reviews and approvals by your office. We ask for your concurrence regarding this proposed action.

Inclosed for your information (inclosures 1, 2 and 3) are copies of preliminary work limits and right-of-way alignments of the three proposed levee setbacks. We ask that you furnish us a description of LA 39 in each of the areas by giving the applicable information on the inclosed forms (inclosures 4, 5, and 6).

Should you have any questions, please contact Mr. Robert Campos at 838-2998 or Mr. Vern Carrier at 838-2630.

Sincerely,

- 2 Incl (dups)
1. Preliminary Right-of-Way dugs
2. Descriptive information for
Highways

FREDERIC N. CHATRY
Chief, Engineering Division

Copies Furnished without inclosures:
Mr. Chalin Perez, President
Plaquemines Parish Commission Council
Pointe-a-la-Hache, Louisiana 70082

Mr. Arthur R. Theis, Chief Engineer
Office of Public Works
Department of Transportation and Development
P.O. Box 44155, Capitol Station
Baton Rouge, Louisiana 70804

Mr. A. E. Simpson, District Engineer
Louisiana Office of Public Works
7252 Lakeshore Drive
New Orleans, Louisiana 70124

Mr. A. E. Simpson, District Engineer
Louisiana Office of Public Works
P.O. Box 9179
Bridge City, Louisiana 70094

LMNED-DL
LMNRE-AP
LMNOC

State of Louisiana
Department of Transportation and Development

MMF/30



JWIN EDWARDS
GOVERNOR

GEORGE A. FISCHER
SECRETARY

Office of Highways

P. O. Box 44245 Capitol Station Baton Rouge, Louisiana 70804

January 21, 1980

Mr. Frederic M. Chatry
Chief, Engineering Division
Department of the Army
New Orleans District
Corps of Engineers
P. O. Box 60267
New Orleans, La. 70160

Dear Mr. Chatry:

RE: LMNED-MR

The following comments are in response to your letter of 5 November, 1979, concerning levee setbacks at Harlem, Linwood and Scarsdale - Stella, all affecting La. 23 in Plaquemines Parish.

Please accept our apologies for the delay in replying to your letter. As we explained verbally to Mr. Campos, this delay was caused by the necessity to develop a new policy and obtain the necessary approvals, concerning right-of-way acquisitions for realigned roadways.

Our policy is: WHEN A ROADWAY IS REALIGNED TO THE EXTENT THAT PRIVATE PROPERTY IS PERMITTED TO REMAIN BETWEEN THE EXISTING ROADWAY AND THE NEW ROADWAY, DESIGN STANDARDS FOR NEW LOCATION SHALL BE USED.

I believe that this will answer the question raised in the second paragraph of your letter. Please note that this does not necessarily mean that we approve of any fixed amount of right-of-way for these projects, such as the 80' mentioned in paragraph 5 of your letter. The actual amount of right-of-way to be acquired should be established from construction limits, with appropriate border areas. The distance between construction limits and required right-of-way line should generally be an average of 10'.

We concur in your suggestion to include the necessary relocation of La. 39 in the levee contracts. Some of the information that you requested concerning the existing roadway and traffic information is shown on the attached forms, for each location. Other information is not readily available. If additional information is absolutely necessary and you need our further assistance, please advise.

Sincerely,

Dempsey D. White
Chief Engineer

DDW/HDS/jnd
Attachments

cc: Mr. Jack R. Reid
Mr. Harvey D. Shaffer

Exhibit B

REPLY TO
ATTENTION OF:

LMNEU-MR

24 June 1980

Chief Engineer
Department of Transportation and Development
Office of Highways
P. O. Box 44245, Capitol Station
Baton Rouge, Louisiana 70804

Dear Sir:

We are continuing our planning for the (Scarsdale-Stella Levee Setback) which will affect State Route La 39 in Plaquemines Parish. The inclosed set of aerial photos (inclosure 1) shows the location of the project. Also, shown on the maps is an 80-foot wide right-of-way for the relocated road. The proposed right-of-way width is based on "Typical Section II" shown on inclosure 2.

Please advise us of your concurrence in the typical section and proposed 80-foot wide right-of-way for the replacement road. We would appreciate receiving your comments by 11 July 1980 so that we may be able to maintain our project schedule.

Sincerely,

- 2 Inclosures
1. File H-S-29068, sheets
1 thru 5, marked in red
2. Typical sections
(preliminary)

FREDERIC M. CHATRY
Chief, Engineering Division

Copies furnished with inclosures:
(See page 2)

Exhibit C.

W470



PAUL J. HARDY
SECRETARY

Department of Transportation and Development

P. O. BOX 44245 CAPITOL STATION

BATON ROUGE, LA. 70804

July 14, 1980



DAVID C. TREEN
GOVERNOR

Mr. Frederic M. Chatry
Chief, Engineering Division
Department of the Army
New Orleans District
Corps of Engineers
P. O. Box 60267
New Orleans, La. 70160

Dear Mr. Chatry:

RE: LMNED-MR
Scarsdale - Stella
Levee Setback
Plaquemines Parish
La. 39

This is in response to your letter of June 24, 1980. We have reviewed the plans for the levee setback and we concur with the use of "Typical Section II".

We do not necessarily approve of the fixed 80' of right-of-way. The required right-of-way should be established from the construction limits plus appropriate border areas, which average approximately 10' in width.

We are attaching a copy of our typical section for Class 4 highways.

If additional information is needed, please advise us.

Sincerely,

Verdi Adam
Chief Engineer

VA/JTH/jnd
Attachment

cc: Mr. Jack R. Reid
Mr. Frank M. Heroy, Jr.
Mr. Harvey D. Shaffer

Exhibit D

24 June 1980

LMED-MR
Chief Engineer

Mr. Jack E. Reid, Director of Preconstruction
Louisiana Office of Highways
P. O. Box 44245, Capitol Station
Baton Rouge, Louisiana 70804

Mr. Arthur Theis, Chief Engineer
Department of Transportation and Development
Office of Public Works
P. O. Box 44155, Capitol Station
Baton Rouge, Louisiana 70804

Mr. Gaspar Chifci
Louisiana Office of Public Works
7252 Lakeshore Drive
New Orleans, Louisiana 70124

Mr. Chalin O. Perez, President
Plaquemines Parish Commission Council
Pointe-a-la-Hache, Louisiana 70082

Rev
9/14/80
9/10

Plaquemines Parish Commission Council

POINTE-A-LA-HACHE, LA. 70082

CHALIN O. PEREZ, PRESIDENT
LUKE A. PETROVICH, VICE-PRESIDENT
MRS. E. LAFRANCE, SECRETARY

COMMISSIONERS:
ALBERT J. BESHEL
MICHAEL E. KIRBY
LENNARD H. MACKENROTH

August 27, 1980

U. S. Corps of Engineers
Office of the District Engineer
New Orleans District
Post Office Box 60267
New Orleans, Louisiana 70160

Attention: Mr. Frederic M. Chatry, Chief
Engineering Division

Dear Mr. Chatry:

We are herewith enclosing two certified copies of a resolution adopted by the Plaquemines Parish Commission Council at its meeting held on July 2, 1980, recommending that the State of Louisiana Highway Standards requiring an eighty (80) foot right of way for construction of a new highway for Louisiana State Highway No. 39 in the Scarsdale-Stella Levee Setback Area be waived and that a total right of way width of approximately sixty-five (65') feet be utilized and that the replacement road for the Scarsdale-Stella Levee Setback be designed in such a way as to eliminate the ditch between the levee and the highway.

Yours very truly,

Plaquemines Parish Commission Council

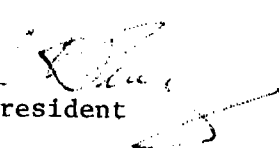
President

COP:sb
encls.
cc's: Mr. Wallace J. Buras, Jr.

Mr. Carroll J. Martin

Exhibit E

R E S O L U T I O N

On motion of Commissioner Beshel, seconded by Commissioner Mackenroth and on roll call, all members present and voting "Yes", except Mr. Chalin O. Perez who recused himself from voting, the following resolution was adopted:

WHEREAS, State of Louisiana Highway Standards require an eighty (80') foot right of way for construction of a new highway for Louisiana State Highway No. 39 in the Scarsdale-Stella Levee Setback Area; and

WHEREAS, the highways upriver and downriver from said road have recently been and are now being widened and overlaid in order to improve the roads and the design of those roads have eliminated the ditch between the levee and the highway, and

WHEREAS, the new stretch of highway to accommodate the Scarsdale-Stella Levee Setback should be similarly constructed which would reduce the right of way needed to approximately sixty-five (65') feet, and

WHEREAS, the Plaquemines Parish Commission Council is in accord with and recommends the narrower right of way and the method of construction which would eliminate the ditch between the levee and the highway,

THEREFORE:

BE IT RESOLVED by the Plaquemines Parish Commission Council that it hereby recommends to the State of Louisiana, Department of Transportation and Development, Office of Public Works, and to the U. S. Corps of Engineers that a total right of way width of approximately sixty-five (65') feet be utilized and that the replacement road for the Scarsdale-Stella Levee Setback be designed in such a way as to eliminate the ditch between the levee and the highway.

I hereby certify the above and foregoing to be a true and correct copy of a resolution adopted by the Plaquemines Parish Commission Council at its regular meeting held at its Office in the Courthouse, Pointe ala Hache, Louisiana, on July 2, 1980.

Merl D. Ancardi

Secretary

Exhibit F

REPLY TO
ATTENTION OF:

LMNED-MR

17 September 1980

Mr. Verdi Adam
Chief Engineer
Louisiana Department of Transportation
and Development
Office of Highways
P. O. Box 44245, Capitol Station
Baton Rouge, Louisiana 70804

Dear Mr. Adam:

This is in regard to our project, item M-75.6 to 74.5-I, Scarsdale-Stella Setback, which will dislocate Route La. 39 in Plaquemines Parish. Inclosed is one set of aerial photos showing the limits of the levee setback. Please note that these photos show a "deeper" levee setback, i.e., further landward from the existing levee, than we had previously communicated to you.

Your letters of 14 July 1980 advised us that the relocated roadways for both the Linwood and Scarsdale-Stella should be constructed with a normal (two way) crown with ditches on each side of the road. By letter of 4 September 1980, Mr. Harvey Shaffer of your staff advised us that the Department has rescinded its earlier position on the Linwood reach; that is, the Department will accept a one-way tangent crown sloping away from the levee with no ditch between the levee and the road.

Coincidentally with our receipt of Mr. Shaffer's letter, we also received a letter dated 27 August 1980 from Mr. Chalin O. Perez, President, Plaquemines Parish Commission Council (PPCC). The letter forwarded a 2 July 1980 PPCC resolution which "...Recommends... that a total right of way width of approximately sixty-five (65) feet be utilized and that the replacement road for the Scarsdale-Stella Levee Setback be designed in such a way as to eliminate the ditch between the levee and the highway." Copies of the Plaquemines Parish letter and resolution are inclosed for your evaluation.

Please advise us if the Department will rescind its earlier position on the Scarsdale-Stella highway, as it has done on the Linwood reach. We would appreciate your reply by 10 October 1980.

Exhibit G.

LMNED-MR
Mr. Verdi Adam

17 September 1980

Mr. R. Campos of my staff is available at telephone number 838-2998 to answer any questions you may have regarding this correspondence.

Sincerely,

- 2 Inclosures
1. File No. H-8-29068, 5 drwgs
2. PPCC Ltr of 27 Aug 80 with
Resolution dtd 2 Jul 80

FREDERIC M. CHATRY
Chief, Engineering Division

Copies furnished with inclosures:
Mr. Neil Wagoner, Asst. Secretary
La. Dpt of Transp and Development

Mr. Harvey D. Shaffer
Road Design Engineer
La. Dpt of Transp and Development

Mr. Chalin O. Perez, President
PPCC

Mr. Wallace J. Buras, Jr., Supervisor
Plaq. Parish Engr. & Public Works

Mr. Arthur Theis
La. Ofc of Public Works

Mr. Gaspar Chifici
La. Ofc of Public Works

CF:
LMNED-DL
LMNRE-AP



PAUL J. HARDY
SECRETARY

Department of Transportation and Development

P. O. BOX 44245 CAPITOL STATION

BATON ROUGE, LA. 70804

September 23, 1980



DAVID C. TREEN
GOVERNOR

9/24/80

SCARSDALE - STELLA
LEVEE SETBACK
PLAQUEMINES PARISH
LA. 39

Mr. Frederic M. Chatry
Chief, Engineering Division
Department of the Army
New Orleans District
Corps of Engineers
P. O. Box 60267
New Orleans, La. 70160

Dear Mr. Chatry:

YOUR FILE: LMNED-MR

This will acknowledge your letter of September 17, 1980, requesting that we advise you of our position concerning design standards as related to right-of-way width for the roadway relocation on the captioned project.

We have reviewed the drawings transmitted with your letter, and the design of the roadway has been discussed within the Department. As you know from previous correspondence, we prefer two-way crowns on roadways adjacent to river levees. In specific situations, with adequate justification, we do permit exceptions. The Linwood Levee Setback is an example of an exception that we have approved.

The Scarsdale-Stella project differs from the Linwood project, as follows. First, the Scarsdale-Stella setback is in a relatively undeveloped area, so the impact of the additional right-of-way required is minor. Second, the existing roadway in the Scarsdale-Stella area has a two-way crown, with ditches on both sides. A one-way crown to replace this would represent a reduction in design standards.

Therefore, we have concluded that the requirements which we specified in our letter of July 14, 1980, are still appropriate for this project.

Sincerely,

Verdi Adam
Chief Engineer

VA/HDS/jnd

cc: Mr. Neil L. Wagoner
Mr. Jack R. Reid
Mr. Frank M. Heroy, Jr.
Mr. Harvey D. Shaffer

Exhibit H

REPLY TO
ATTENTION OF:

LMNED-MR

10 October 1980

Mr. Chalin O. Perez, President
Plaquemines Parish Commission Council
Governing Body, Grand Prairie
Levee District
Pointe-a-la-Hache, Louisiana 70082

Dear Mr. Perez:

Inclosed please find a copy of a letter from Louisiana Department of Transportation and Development, Office of Highways, dated 23 September 1980, advising us of their position concerning the design standards, as related to the right-of-way for their Highway LA 39, in the Scarsdale-Stella Levee Satback reach. Based on their decision we are proceeding with our project using the design standards for Class 4 highways, ditches on each side of the highway, and the new road contained within a right-of-way approximately 90 feet wide.

If you have any questions, please contact Mr. Robert Campos of this office, telephone 838-2998.

Sincerely,

1 Incl

FREDERIC M. CHATRY
Chief, Engineering Division

Copies Furnished: w incl
Mr. Verdi Adam, Chief Engineer
Louisiana Office of Highways

Mr. Arthur R. Theis, Chief Engineer
Office of Public Works
Department of Transportation

Mr. Gasper Chifici, District Engineer
Louisiana Office of Public Works

Exhibit I

REPLY TO
ATTENTION OF

LMNED-MR

25 November 1980

Mr. Harvey D. Shaffer
Road Design Engineer
Department of Transportation
and Development
Office of Highways
P.O. Box 44245, Capitol Station
Baton Rouge, Louisiana 70804

Dear Mr. Shaffer:

Reference is made to your letter of 23 September 1980, Scarsdale-Stella Levee Setback, Plaquemines Parish. We are inclosing for your information one set of aerial photos for the Scarsdale-Stella Setback indicating the project location, the proposed centering and right-of-way for the proposed relocation of Route La. 39. Another set of the drawings was hand-carried to your Mr. Joe Hoskins by Mr. R. Campos of my staff on 18 November 1980.

We will begin developing the plans and specifications for the new road based on a class 4 highway as soon as we have your approval of the proposed road alignment and right-of-way. The plans and specifications will then be forwarded to you for your review and approval.

Please advise us of your concurrence in the proposed road alignment and right-of-way for the replacement road. We would appreciate receiving this information by 19 December 1980 in order to maintain our project schedule.

If you have any questions, you may contact Mr. Robert Campos of this office, telephone 504-838-2998.

Sincerely,

Frederic M. Chatry
Chief, Engineering Division

Incl
As stated

Copies Furnished
(see page 2)

Exhibit J1

LMNED-MR
Mr. Shaffer

25 November 1980

Copies Furnished:

Wallace J. Buras, Jr.: Supervisor
Plaquemines Parish Commission Council
Engineering & Public Works
102 Avenue G
Belle Chasse, La. 70037

Mr. Arthur R. Theis, Chief Engineer
Office of Public Works
Dept. of Transportation and Development
P.O. Box 44155, Capitol Station
Baton Rouge, La. 70804

Mr. Gaspar Chifichi
Louisiana Office of Public Works
7252 Lakeshore Drive
New Orleans, La. 70124

LMNED-DL
LMNRE-AP

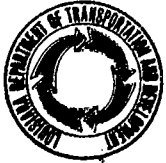

PAUL J. HARDY
SECRETARY

Department of Transportation and Development

P. O. BOX 44245 CAPITOL STATION

BATON ROUGE, LA. 70804

December 2, 1980



DAVID C. TREEN
GOVERNOR

LMNED- MR
SCARSDALE - STELLA LEVEE SETBACK
RELOCATION OF LA 39
PLAQUEMINES PARISH

Mr. Frederick Chatry
Chief, Engineering Division
Department of the Army
New Orleans District
Corps of Engineers
P. O. Box 60267
New Orleans, Louisiana 70160

Dear Mr. Chatry:

I refer to your letter of November 25, 1980, transmitting for our review, Aerial photographs for the Scarsdale Stella Levee Setback, and the proposed relocation of LA 39. We have reviewed the plans and our comments are as follows:

We concur in the proposed roadway alignment.

The required right-of-way width as shown meets our Minimum Design Standards. As the information needed to determine the actual construction limits is not available, we assume the required right-of-way will be adequate for the construction of the Section plus appropriate border areas (10 ft.).

Very truly yours,

HARVEY D. SHAFFER
ROAD DESIGN ENGINEER

HDS/JTH:pat

cc: Mr. Jack R. Reid
Mr. Frank M. Heroy, Jr.

Exhibit K

FLOOD CONTROL, MISSISSIPPI RIVER AND TRIBUTARIES
MISSISSIPPI RIVER LEVEES
ITEM M-75.6 - 74.5-L
SCARSDALE-STELLA, LEVEE SETBACK
PLAQUEMINES PARISH, LOUISIANA
RELOCATION OF FACILITIES
DESIGN MEMORANDUM NO. 69

APPENDIX IV
DETAILED COST ESTIMATES

TABLE IV-1
 DETAILED COST ESTIMATE
 LOUISIANA OFFICE OF HIGHWAYS
 (JUNE 1981 PRICE LEVELS)

I. ROADS: Item R-1

<u>Description</u>	<u>Unit</u>	<u>Quantity</u>	<u>Unit Cost(\$)</u>	<u>Amount(\$)</u>
Mob & Demob	Job	Job	20,000.00	20,000
Clearing & Grubbing	Acres	12	1,000.00	12,000
Excavation	Cu.Yds.	8,325	2.50	20,813
Fill, Semi Compacted	Cu.Yds.	3,000	2.50	7,500
Sand-Shell Sub base Compacted 12" thick	Cu.Yds.	11,692	30.00	350,760
Cement Treated Sand-Shell Base Course 8 1/2" thick	Cu.Yds.	3,646	47.00	171,362
Shoulders, 4" thick Compacted Shell	Cu.Yds.	832	21.00	17,472
Prime Coat	Gal.	3,633	1.35	4,905
Asphaltic Concrete, 3 1/2" thick	Ton	2,813	55.00	154,715
Detour Road, Shell- Surfaced	Job	Job	25,000.00	25,000
Signs & Barricades	Job	Job	3,000.00	3,000
Environmental Pro- tection	Job	Job	4,000.00	4,000
22"x13" Bituminous Coated Arch Pipe	Feet	500	36.00	<u>18,000</u>
Subtotal				809,527
Contingencies (25%+)				<u>202,473</u>

TABLE IV-1
 DETAILED COST ESTIMATE
 LOUISIANA OFFICE OF HIGHWAYS
 (JUNE 1981 PRICE LEVELS)
 (continued)

<u>Description</u>	<u>Unit</u>	<u>Quantity</u>	<u>Unit Cost(\$)</u>	<u>Amount(\$)</u>
Subtotal				1,012,000
Right-of-Way				<u>226,000¹</u>
Subtotal Federal Cost				1,238,000
E&D (6%+)				61,000 ²
S&A (6%+)				<u>61,000²</u>
TOTAL				1,360,000

¹Based on \$152,650 for land and improvements (one building and one pipeline), \$35,000 for relocation assistance (P.L. 91-646), plus \$38,350 for contingencies.

²No E&D and S&A for road right-of-way.

TABLE IV-2
 DETAILED COST ESTIMATE
 LOUISIANA GAS SERVICE COMPANY
 (JUNE 1981 PRICE LEVELS)

UTILITIES: Item G-1

<u>Description</u>	<u>Amount(\$)</u>
Installation Cost: 5,500 linear feet of 4" diameter steel gas main at \$16.00 per linear foot	88,000 ¹
Plus removal cost: Cut and abandon old main, install two line stoppers, install one plug valve, tie in new facilities, test and purge system	<u>2,000²</u>
Subtotal	90,000
Contingencies (25%+)	<u>23,000</u>
Subtotal Federal Cost	113,000
E&D (6%+)	7,000
S&A (6%+)	<u>7,000</u>
TOTAL	127,000

¹No betterments are involved; no depreciation based on ECI 73-209.3(b)(1)b, dated 1 Jul 80.

²Facilities retired, with the exception of meters and regulators, will be abandoned in place and have no salvage value. The existing meters and regulators will be reinstalled on the new gas main.

TABLE IV-3
 DETAILED COST ESTIMATE
 LOUISIANA POWER AND LIGHT COMPANY
 (JUNE 1981 PRICE LEVELS)

UTILITIES: Item P-1

<u>Description</u>	<u>Amount(\$)</u>
Installation Cost: 5,500 linear feet of 13.8kV, 3-phase, aerial distribution line (poles, conductors, guys & anchors, etc.) at \$4.50 per linear foot, plus clearing 10'x5,500' right-of- way (tree trimming) at \$4.00 per linear foot	46,750 ¹
Removal Cost: 5,500 linear feet of 13.8kV, 3-phase, aerial distribution line (poles, conductors, guys & anchors, etc.) at \$2.00 per linear foot	<u>11,000¹</u>
Subtotal	57,750
Contingencies (25%+)	<u>14,250</u>
Subtotal Federal Cost	72,000
E&D (6%+)	4,000
S&A (6%+)	<u>4,000</u>
TOTAL	80,000

¹No Betterments are involved; no depreciation or salvage value since existing materials will be reused.

TABLE IV-4
 DETAILED COST ESTIMATE
 PLAQUEMINES PARISH
 (JUNE 1981 PRICE LEVELS)

UTILITIES: Item W-1

<u>Description</u>	<u>Cost(\$)</u>
Installation Cost:	
5,500 linear feet of 8 inch diameter asbestos cement water main at \$10.50 per linear foot plus 16 3/4" water services at \$100.00 each (new 3/4" copper tubing and remove and reinstall existing "water service" assemblies)	59,350 ^{1,2}
3 gate valves at \$450.00 each	1,350
7 fire hydrant assemblies at \$1,350.00 each	9,450
Plus removal cost:	
Cut and abandon old main, tie in new facilities, test and purge system	3,000 ³
Subtotal	73,150
Contingencies (25%+)	18,850
Subtotal Federal Cost	92,000
E&D (6%+)	5,500
S&A (6%+)	5,500
TOTAL	103,000

¹No betterment since cost of installing A.C. is approximately 30 percent less than the cost of installing 6" C.I. pipe.

²No depreciation based on ECI 73-209.3(b)(1)b dated 1 Jul 80.

³Facilities retired, with the exception of the "water service" assemblies will be abandoned in place and have no salvage value.

TABLE IV-5
 DETAILED COST ESTIMATE
 SOUTH CENTRAL BELL TELEPHONE CO.
 (JUNE 1981 PRICE LEVELS)

UTILITIES: Item T-1

<u>Description</u>	<u>Amount(\$)</u>
Installation Cost:	
Install 5,500 linear feet of 106 pair, 22 gauge aerial telephone (screen) cable at \$3.00 per linear foot on new LP&L poles.	16,500.00
Install 1,250 linear feet of 50 pair, 22 gauge aerial telephone cable at \$2.00 per linear foot on new LP&L poles.	2,500.00
Subtotal	19,000.00 ¹
Contingencies (25%+)	<u>5,000.00</u>
Subtotal Federal Cost	24,000.00
E&D (6%+)	1,000.00
S&A (6%+)	<u>1,000.00</u>
TOTAL	26,000.00

¹No betterments are involved; no depreciation based on ECI 73-209.3(b)(1)b, dated 1 Jul 80. No salvage value since the existing cables will be abandoned in place.