

Pass March 20 Traffic Count
 USGS Gage Site
 Southeastern Louisiana University
~~Experiment Station~~
 Environmental Research Station
 GPS-1 is a PK Nail set flush with
 the top of the wooden gage
 platform 6' NE of the gage and
 29' NW of an 8" oak tree.

RM-1 is a chiseled square in a
 3.9' x 2.4' concrete slab on the north
 side of Building 23 3' NE of the NW
 corner of the Building 80' SE of
 GPS-1 and 85' SE of the gage.

Purpusa, J.
 Webb, B.
 Dial, M.

1-14-06

(25)

RP-1 = Lag Bolt in outside FACE of
 gage Platform - 0.6' below top of
 Deck of gage Platform 5.6' NW of gage.
 3.2' east of N.W. corner of gage
 Platform 9.5' NW of GPS 1.

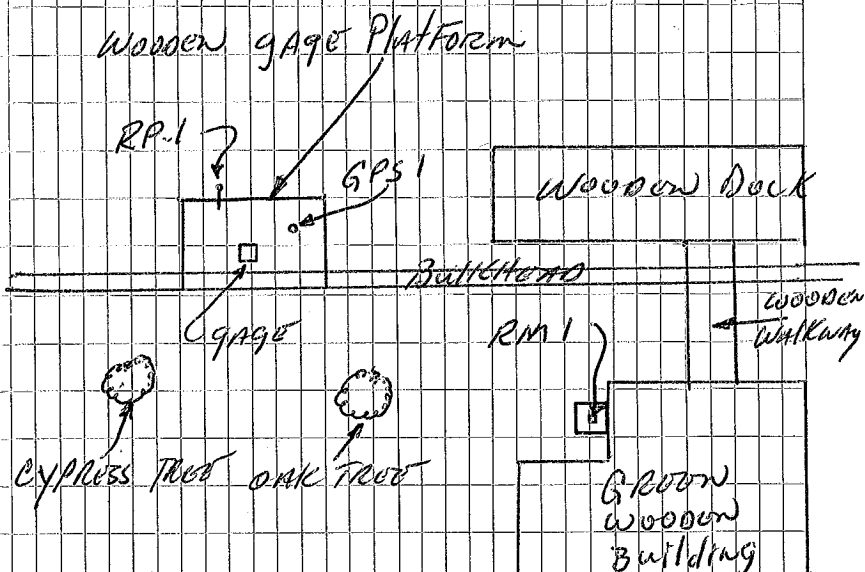

Southeastern Louisiana University
 Environmental Research Station

1-14-06

Pass Manchaca - Turtle Cove
USGS GAGE Site
Level Run

STA	+	Hgt.	-	Elev.
GPS-1	4.15	6.99		2.838 = 2.84
RP-1	4.85	7.26	4.58	2.41
RM-1	4.66	7.11	4.81	2.45
GPS-1			4.28	2.83 F
				2.84 G
				-0.01 E

GPS - Nail in Dock - see sketch
pg. 25

USGS GAGE - I-510

STA + Hgt. - Elev
 1678 A (1982) 10.016

3.45 13.466
 TP 9.10 4.366

3.83 8.196
 W.S. 9.63 -1.434

RP1 † 1.700 6.496

1.65 8.146
 TP 3.78 4.366

9.25 13.616
 1678 A 3.60 10.016 F
 1982 10.016 G
 0.000 E

Purport

1-15-06

web

DIVE

Johnson

= GPS Point 167A

Measure up to RP1 From water surface
 = 1.94 = Elev. 6.506 F - Given 6.496
 2 Filed marks on top of Alumn. &
 Iron above gage transmission. on
 the south side of Bridge Pier
 on I-510. First Pier North of South
 Water cage.

Levels - Gauge at Southshore
MADAMA

1-15-06

(12)

Sta	+	Hgt	-	Elev.
APD1				0.817 = 0.82
TP	5.35	6.17	4.30	1.87
TP	5.65	7.52	4.32	3.20
TP	5.83	9.03	4.49	4.54
TP	4.50	9.04	5.12	3.92
TP	5.46	9.38	3.95	5.43
TP	4.25	9.68	4.12	5.56
TP	4.16	9.72	1.39	8.33
1A	0.85	9.18	3.63	5.55
	4.15	9.70	4.28	5.42
	4.05	9.47	5.55	3.92
	5.72	9.64		

GPS

PID - 851394

Levels - Cont

1-15-06 (29)

Sta	+	H.L.	-	etov
		9.04		
TP	4.71	9.25	5.10	4.54
TP	4.74	7.94	6.05	3.20
TP	4.55	6.43	6.06	1.88
AP#1			5.61	4.0.82
				<u>4.0.82</u>
				5 0.00

BM-1A to GAGE Site			
South Shore Marina			
STA	+	H.L.	- Elev.
BM-1A			8.33
	3.23	11.56	
TP			4.14 7.12
	6.13	13.55	
TP			8.27 5.28
	5.29	10.57	
RPA			6.15 4.42
STAFF GAGE	3.44	7.86	
			8.65 / -0.79 ^{0.00} / _{9.19}
	8.60	7.81	
RPA			3.39 4.42
RPA			4.42
	6.03	10.45	
TP			5.18 5.27
	8.58	13.85	
TP			6.45 7.40
	4.55	11.95	
1A			3.64 8.31 F
			8.33 G 0.00

RSD 1394

RPA is a R/R spike driven flush with the concrete. 1' west of the E of the south end of a concrete curb, 8' North of the E of a wooden dock (bearing east) 50' west of GAGE.

WOODEN STAFF GAGE SET ON A CLUSTER OF 3 WOODEN PLINGS - 50' EAST OF RPA, ORLEANS LEVEE DISTANT GAGE. THE SHOTS - 8.65 & 8.60 WERE ACTUALLY READINGS ON THE GAGE. 0.00 OF THE GAGE IS ACTUALLY -0.79

Sketch
Southshore Marina Base

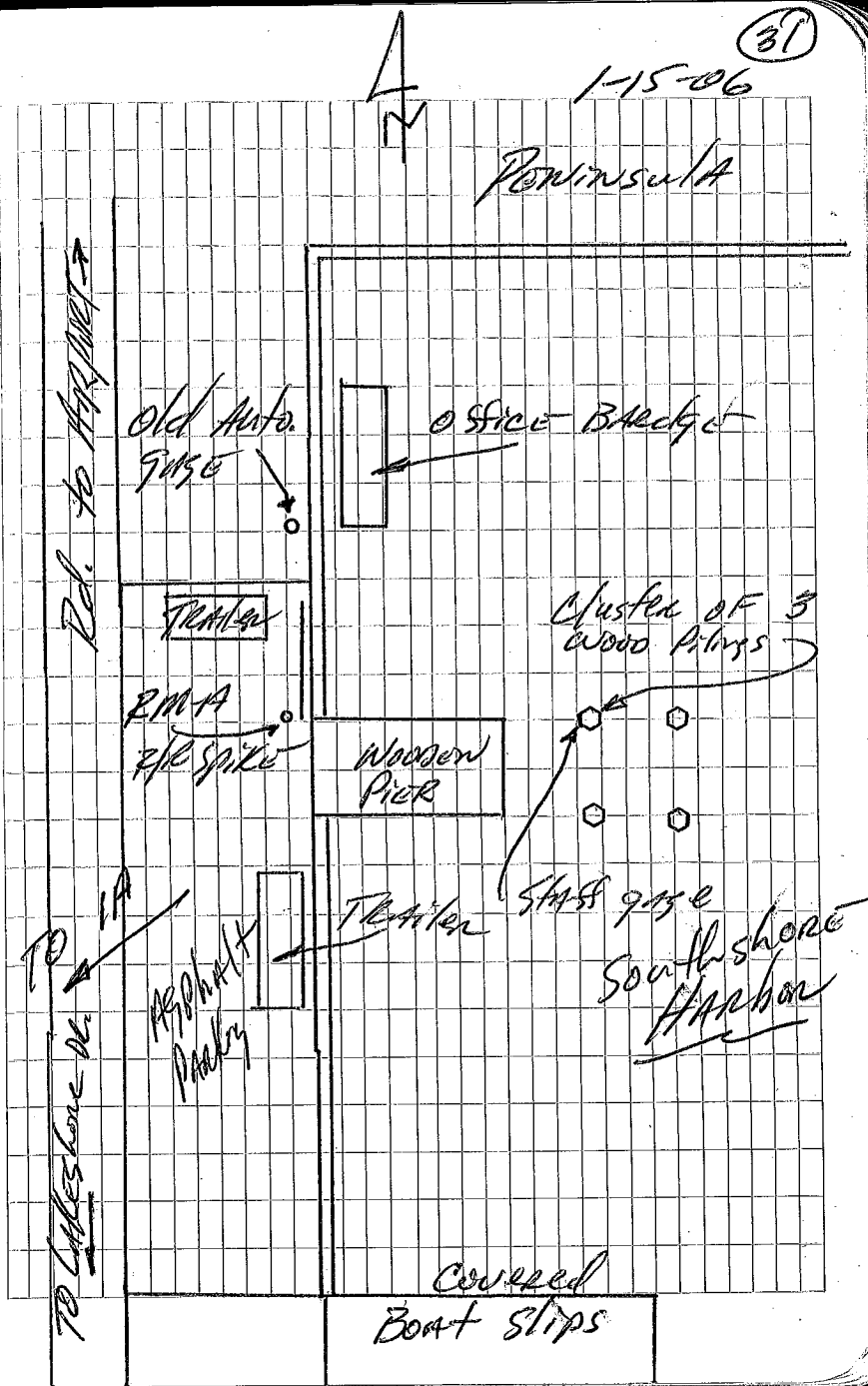

NWS USGS & ORLEANS Levee BOARD Pages
 Little Irish Bayou @ Hwy #1 Near Slidell, LA.

STA	+	HZ	-	Elev
AG06				3.62
	4.92	8.54		
GPS 1			3.58	4.96
	3.40	8.36		
R.M. 1			3.36	5.00
	6.50	11.50		
R.P. -1			1.83	9.67
	1.49	11.16		
R.M. 2			6.14	5.02
	5.74	10.76		
AG06			7.14	3.62 F.
				3.62 G.
				0.00 F.

HAVARD & Pety

10 JAN. 2006

(27)

GPS	Remarks
GPS 1	CHiseled square on SE Abutment
R.M. 1	CHiseled X on SW Abutment
R.P. -1	Head of a 1/2" bolt on the SE side of Gauge House
R.M. 2	CHiseled square on NW Abutment
	See A Bole

INDUSTRIAL CANAL GAGES
 L & N Bridge under THE I-10 High Rise

STA.	+	IH	-	EL.
TBM F				10.262
	4.12	14.38		
R.P.1			4.29	10.09
	3.98	14.07		
STAFF Gage			4.45	9.62
	4.37	13.99		
TBM F			3.74	10.25
	<u>7.2</u>			<u>10.262</u>
				- 0.01

Levels
 (Cont'd next Pg)

Harvard & Gen.

Jan 12, 2006

(36)

Remarks
 Ref. Tbl. 2 Pg 52
 Top 1 1/2" Alum. & Iron directly over Pressure Transducer Pipe. (USGS gage)
 Top of wooden levee boxes back STAFF Gage - 10 FT. mark on gage
 See above