

# SPACE TYPES & REQUIREMENTS



## Outdoor Play Areas

School Type:



### Functional Area Descriptions

Outdoor play areas shall include open turf areas, hard surface areas, outdoor tables and seating (middle schools) and play equipment (elementary schools). At CONUS middle schools (DDESS), athletic fields may also be provided if the school participates in interscholastic sports.

#### 1 Play Lot

The play lot serves as the primary exterior activity center for preschool and kindergarten children up to 5 years of age. Used in association with the kindergarten, pre-kindergarten, Sure Start and PSCD programs, locate the play lot adjacent to the neighborhoods they serve, or a short distance away with an accessible path. Separate the kindergarten from the pre-kindergarten and Sure Start areas. A professionally designed play lot should accommodate the number of students it serves, site constraints, and specific equipment requirements. The play lot must comply with US Consumer Product Safety Commission (CPSC) and Americans with Disabilities Act (ADA).

### Conceptual Plan

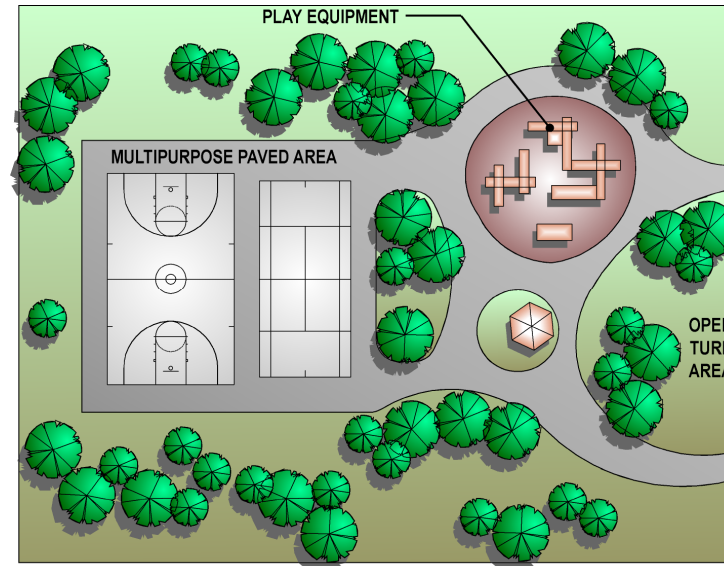

### Planning Requirements

Area Description	SF	M <sup>2</sup>	Notes
<b>Outdoor Play Areas</b>			
1 Play Lot	3,000	279	+800sf (74m2) / classroom served (over 2)
1 Play Lot (enclosed storage)	100	9	
2 Elementary/Middle School Playground	21,780	2,023	1 - 100 students
2 Elementary/Middle School Playground	43,560	4,047	101 - 500 students
2 Elementary/Middle School Playground	87,120	8,094	501 - 1000 students
2 Elementary/Middle School Playground	130,680	12,141	1001+ students

NOTE: Adjacency plan shown above is intended to provide an example to spark design creativity.

The minimum size for the play lot is 3,000 sf (279 m<sup>2</sup>). An additional 800 sf (74 m<sup>2</sup>) per learning studio served (over 2) shall be provided. Each play lot should have enclosed outdoor storage of at least 100 sf (9 m<sup>2</sup>) which can be secured.

An enclosed area with age appropriate play equipment and special facilities shall be provided, including:

- Provide play equipment such as climbers, slides, play walls and playhouses, play sculptures, and a play sand area conforming to the US Consumer Product Safety Commission Guidelines (CPSC) and Americans with Disabilities Act (ADA). Play sand areas may only be used if the area is fenced and can be segregated from dogs and cats.
- Locate and arrange equipment with adequate surrounding space in small, natural play groups.
- Locate playhouses, and play sculpture away from equipment like swings and slides for safety.
- Ensure that all elevated play structures are at least 6 ft (1.83 m) away from any hard surface.
- Provide a CPSC compliant Playground surface. These may include, but are not limited to poured rubber, rubber tiles or engineered wood fiber.
- Provide adequate drainage for playground surfaces.
- Use the open turfed area and shaded quiet areas around the enclosed play area to serve as buffers around it.
- Conveniently locate secured benches to assure good visibility for supervision of all areas of the play lot.
- Consider a tricycle path/track in design

## 2 Elementary/Middle School Playground

The playground serves children from 5 to 12 years of age. A professionally designed playground should accommodate the number of students it serves, site constraints, and specific equipment requirements. The playground must comply with US CPSC and ADA.

Age appropriate play equipment and special facilities shall be provided, including:

- Locate the playground equipment area adjacent to the school.
- Disperse popular or heavy use equipment to avoid crowding and locate exit slides in non-congested areas.
- Avoid rung ladders and climbing components as the sole means of access to play equipment.
- Consider prevailing sun angles. Keep slides out of the heat of the sun by locating the slide surface facing north. Use plastic slide surfaces only.
- Provide a CPSC compliant Playground surface. These may include, but are not limited to poured rubber, rubber tiles or engineered wood fiber.
- Provide adequate drainage for playground surfaces.
- Provide tree-shaded areas for quiet activities, somewhat removed from the active play areas, i.e. play tables and activity panels.
- Fully develop the playground with landscape planting for activity and traffic control and to increase the interest and attractiveness of the playground.
- Avoid trees, shrubs, and ground covers with thorns, poisonous parts, or that attract bees. Also avoid trees with fruit or nuts.



▶ Play Lot, Coeur d'Alene Ray & Joan Kroc Corps Community Center, Coeur d'Alene, Idaho



▶ Playground, Porter Ridge, California

NOTE: Images shown are intended to provide real-world examples and spark design creativity.

- Consider security when developing landscape planting. Keep shrubs under 3 ft (91 cm) in height and tree limbs at a minimum of 7 ft (2.1 m) above each designated play surface or use zone (ASTM 1487-07).

#### Open Turf Areas

Open turf areas shall provide space for informal active games for elementary school students. An area for field games including softball, touch or flag football, and soccer shall be provided for middle school students. Place the field games area on fairly level, well-drained land. Provide a shaded area for quiet activities such as reading, story-telling, and quiet games.

#### Paved Hard Surface Areas

A paved hard surface area shall be provided. This space should be large enough for activities such as hopscotch, four square, jump rope and other outdoor games. Set off the paved multipurpose area from the other areas by plantings and locate near the school gymnasium. Create a division between active, energetic spaces and quiet, discovery zones. At the elementary school level, several basketball hoops shall be provided at 6 ft (1.83 m), 8 ft (2.44 m), and 10 ft (3.05 m) heights, spaced far enough apart to avoid collisions when multiple baskets are in use. At the middle school level provide full basketball courts with regulation height baskets.

#### Outdoor Tables and Seating (Middle School)

At the middle school level, outdoor tables and seating may be provided near the dining area for outdoor dining or socializing at lunch or recess times.

#### Play Equipment

Separate play equipment areas shall be provided for pre-k and kindergarten children up to age 5 and older elementary children ages 5-12. Play equipment is not typically provided at the middle school level. The area for the younger children is called the play lot. It is a fenced area adjacent to the neighborhoods it serves, or a short distance away along an accessible path. A separate playground serving children ages 5-12 shall be provided at all elementary schools. Play equipment meeting ADA standards shall be provided at all age levels.