

# SPACE TYPES & REQUIREMENTS



## Professional Development Center

School Type:



### Functional Area Descriptions

The professional development center contains the staff lounge, and central workroom. Staff will use this area for general staff functions such as informal meetings, dining, and general staff relaxation. This area shall be centrally located with easy access from the neighborhoods, and should be a distinct and separate space that does not need to have direct access to students.

#### 1 Staff Lounge

The staff lounge provides space for general staff work, staff meetings, staff socialization, light food preparation, and dining. Provide dining tables and chairs along with a small area for comfortable sofa/ chair lounge furniture. Provide a kitchenette along one wall with a sink, refrigerator and power above the counter for a microwave and coffee pot.

Adjacency Diagram

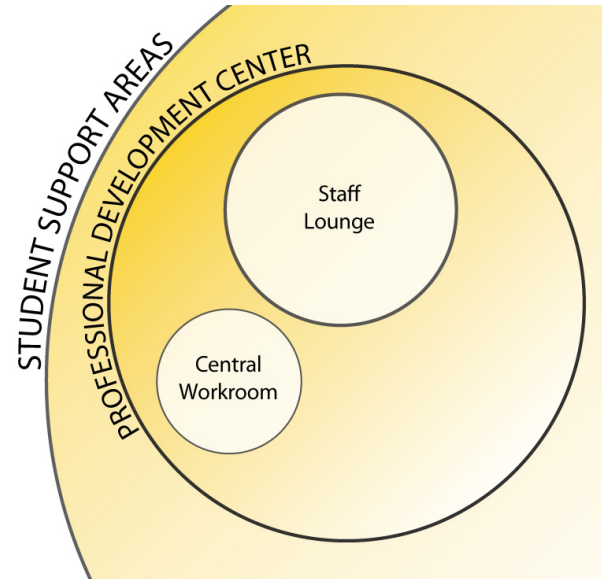

Planning Requirements

Area Description	SF	M <sup>2</sup>	Notes
<b>Professional Development Center</b>			
1 Staff Lounge	600	56	
2 Central Workroom	300	28	
<b>Total</b>	<b>900</b>	<b>84</b>	

## 2 Central Workroom

The central workroom provides space for large reproduction equipment and items such as a die-cut machine, laminator or other specialized equipment that cannot be distributed to the neighborhoods. Provide layout space convenient to the reproduction equipment. Provide casework as required for specialized items such as the die-cut machine and templates. This noisy area should be acoustically separated from any adjacent areas as needed. Typically, a fairly square room with a central work table and built-in cabinets on one wall works well. This leaves open floor space for large copiers and printers.



► Professional Development Center: Hudson Alpha Institute for Biotechnology, Cooper-Carry Architects, Huntsville, AL



► Professional Development Center: Zeeland West High School, GMB Architects, Zeeland, MI



► Professional Development Center: Northwest Middle School, VCBO Architecture, Salt Lake City, UT

NOTE: Images shown are intended to provide real-world examples and spark design creativity.

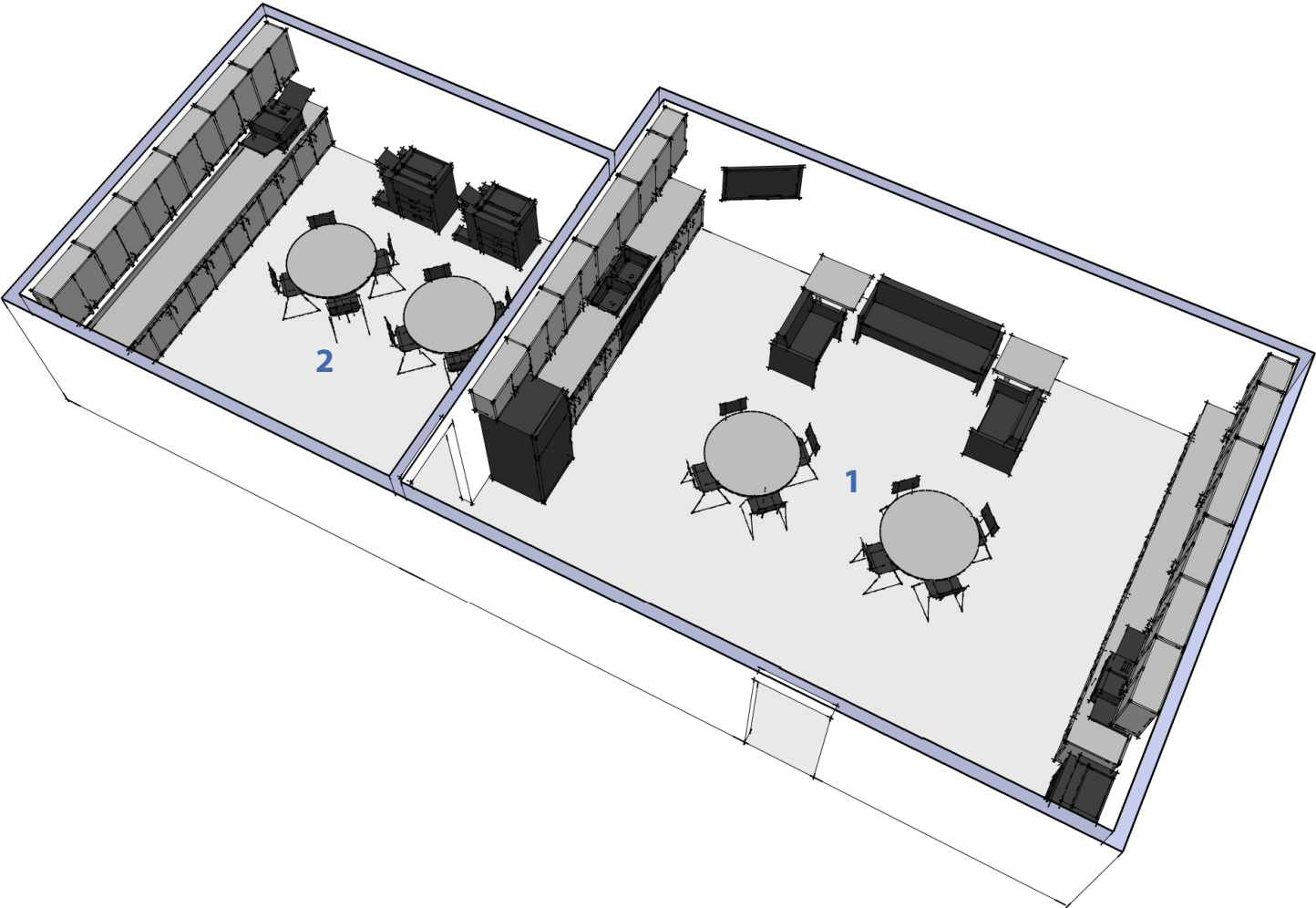

Professional Development Center Concept Perspective

NOTE: 3D illustrations are shown for informational purposes and are not intended to limit design options.