

SPACE TYPES & REQUIREMENTS



Flex Laboratory

School Type:



Functional Area Descriptions

The flex lab provides flexible space to allow multiple lab and project-based instruction to occur regardless of subject matter. The space should provide flexible furniture where students may work at individual workstations or collaboratively in small groups. It should be routed for seamless technology and use of instructional technology such as interactive white boards and table top tablets. Some examples of uses for the flex lab include: computer lab, business education, computer science, virtual science, or any other exploratory curriculum needed. This will be a totally flexible space with ample access to technology.

This space should be designed to accommodate 24 students. An instructional area should be provided for the teacher to give group instruction and demonstrate different applications and techniques. If computer stations are included, they may be placed either around the perimeter or in rows, but should always be positioned where the instructor can easily monitor the screens and provide over-the-shoulder instruction. All furniture layouts should include individual and collaborative work options.

Built-in casework should not be provided in order to retain maximum flexibility for this space. Provide data and power connections on all walls. Maximize the use of wall space with tack boards for work display and review.

Adjacency Diagram

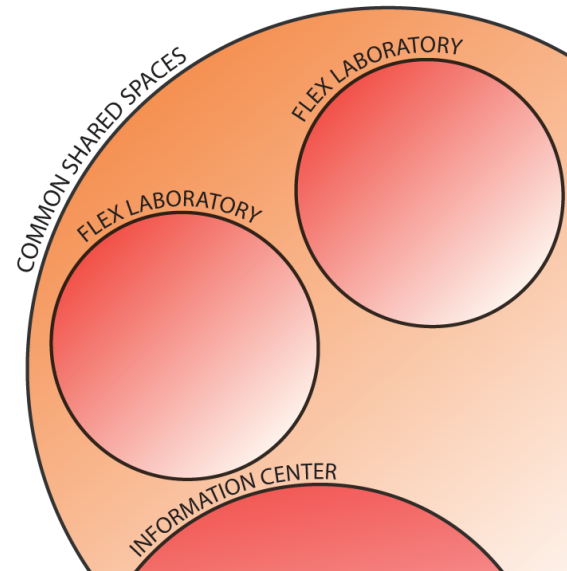

Planning Requirements

Area Description	SF	M ²	Notes
Flex Laboratory			
1 Flex Laboratory	1,300	121	
Total	1,300	121	

One flex lab will be provided adjacent to the information center. This will provide some instructional space near the information center and also provide a space for the Educational Technologist to work with classes and groups of teachers. A single flex lab will be provided for an environment of 0-349 students. If there are 350-699 students, a second flex lab will be provided and a third flex lab will be provided when the student environment is at 700 or greater.

1 Flex Laboratory

Some examples for uses of the flex lab:

Business Education Laboratory

This will be provided within the CTE space for middle school and high schools.

Computer Science Laboratory

This will be provided within the CTE space for middle school and high schools.



► *University of Notre Dame, Notre Dame, IN*



► *Flex Lab: ACT, Virginia Beach City Public Schools & Tidewater Community College, Virginia Beach, VA*

NOTE: Images shown are intended to provide real-world examples and spark design creativity.

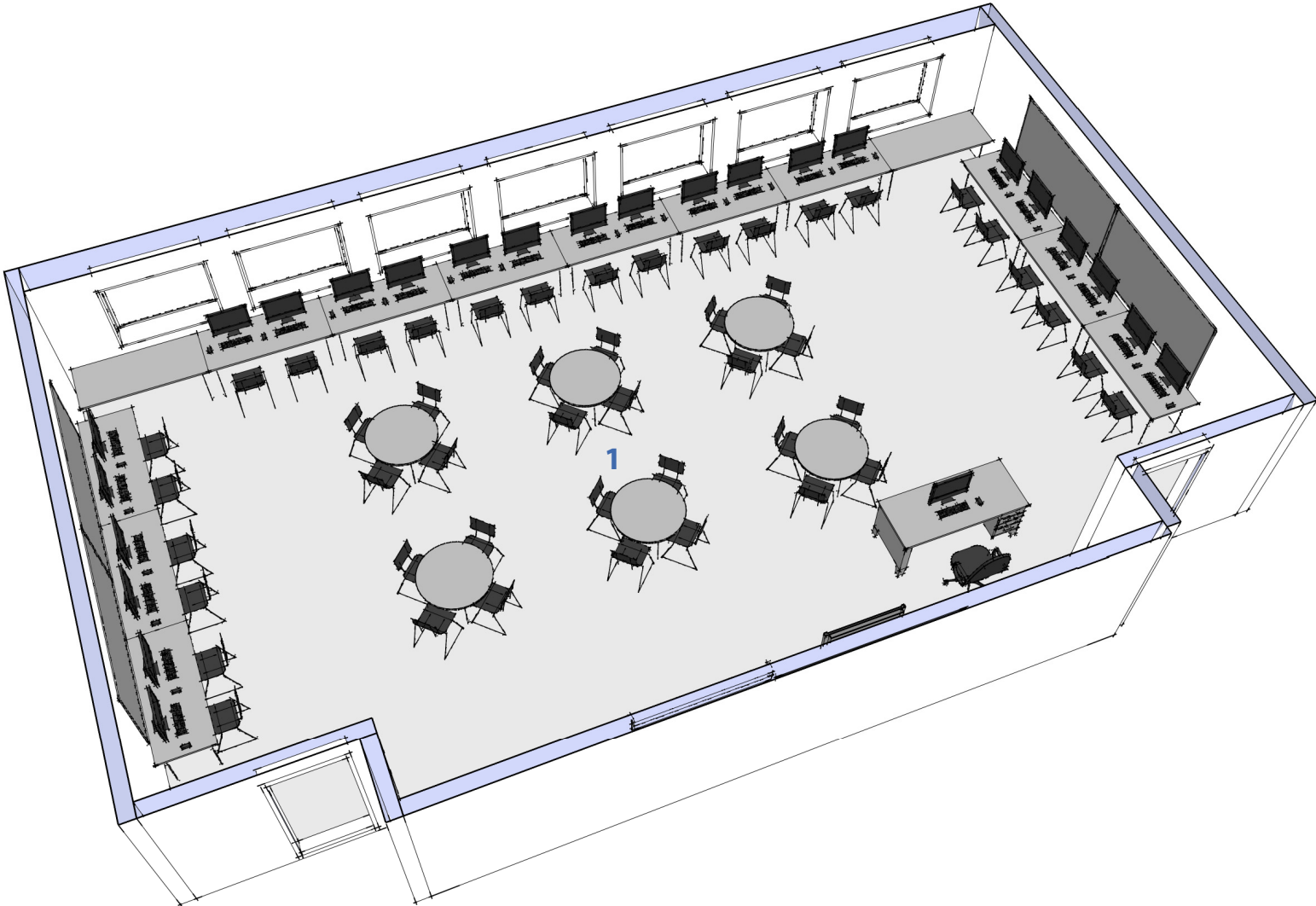

Flex Lab Concept Perspective

NOTE: 3D illustrations are shown for informational purposes and are not intended to limit design options.

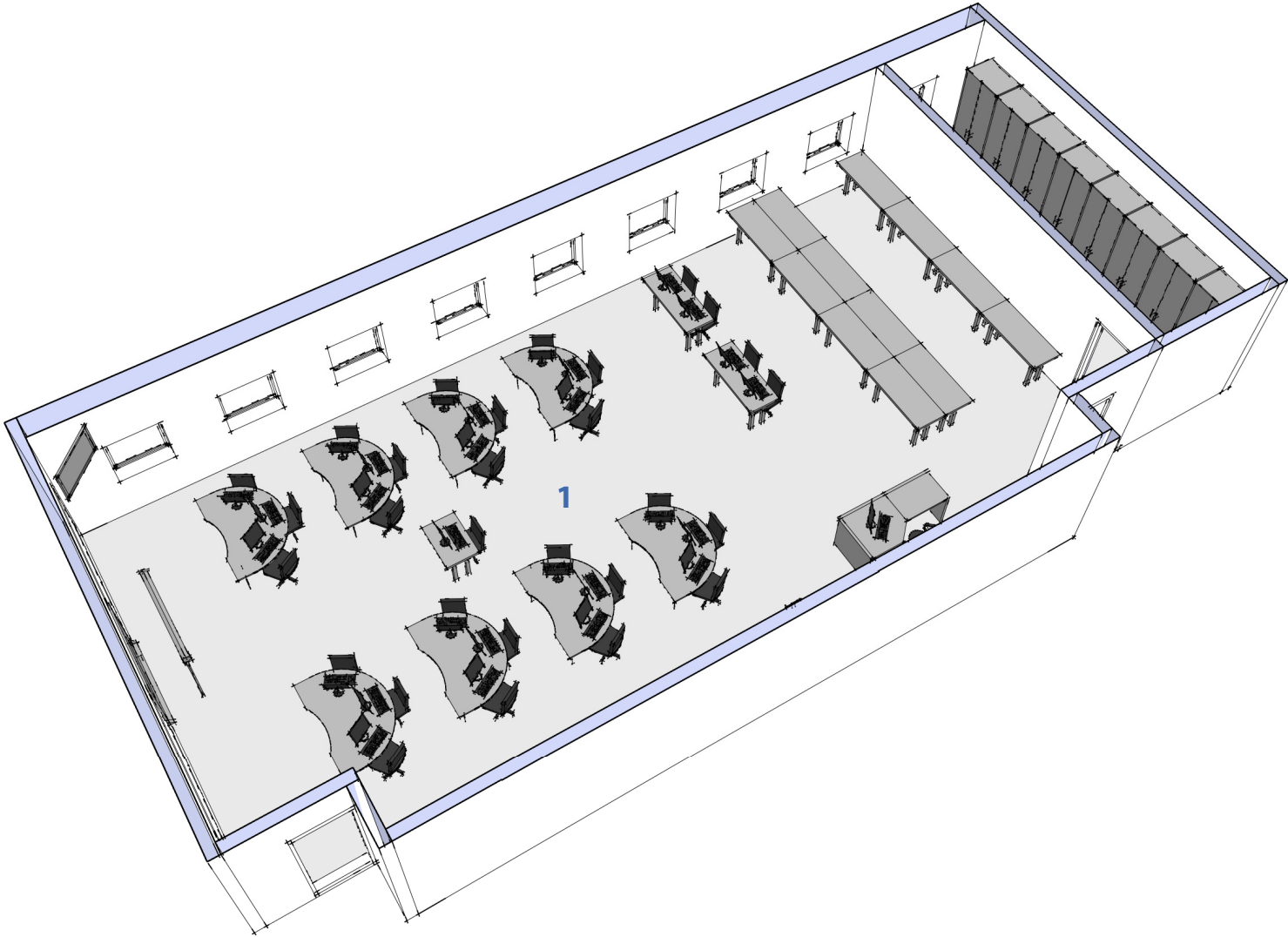

Flex Lab Concept Perspective

NOTE: 3D illustrations are shown for informational purposes and are not intended to limit design options.