

SPACE TYPES & REQUIREMENTS



Learning Impaired Moderate/Severe

School Type:



Functional Area Descriptions

The learning impaired moderate/severe area is the instructional space for children with more severe learning difficulties. The room should accommodate up to 12 students. These students will spend more than 50 percent of their day in this room. Learning impaired classrooms should have convenient access to mainstream education and be located as close to peers of the same age as possible. The classroom should have variable lighting control and high quality acoustical controls including ADA compliant, built-in sound field systems to accommodate students with specific learning disabilities, hearing impairments, and/or severe auditory processing deficits. For elementary school, the room should be on the ground floor close to the general play area. For middle school and high school, the room should be on the ground floor and have outdoor access. Built-in and loose furniture must be ADA compliant.

1 Learning Impaired Moderate/Severe

Instruction Area

The student instruction area uses desks and/or tables to allow demonstrations by the teacher in group or individual settings. Building structure should support two areas for specialized equipment hung from the ceiling to provide flexibility in arranging the space. Locate an instructional area at the front of the

Adjacency Diagram

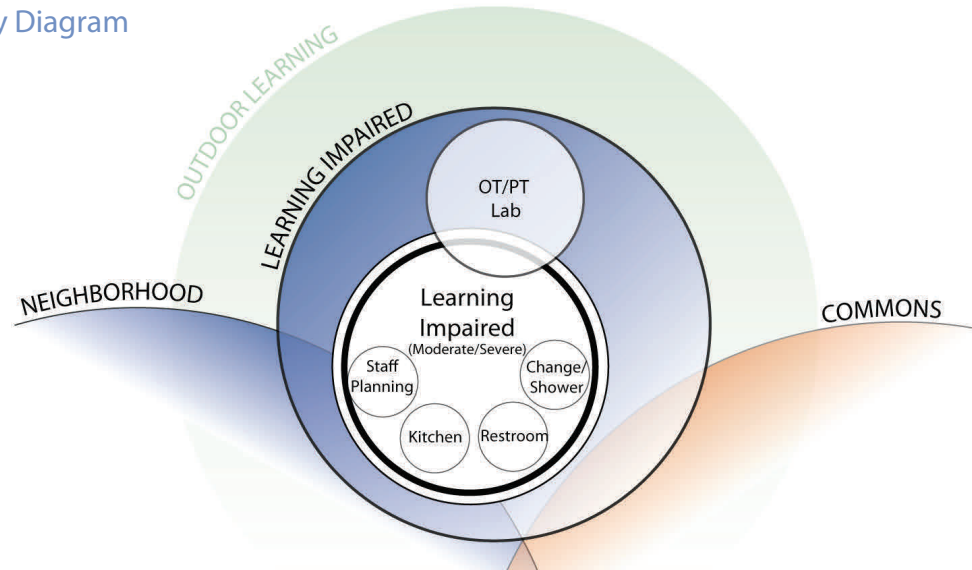

Planning Requirements

Area Description	SF	M ²	Notes
Learning Impaired Moderate/Severe			
1 Learning Impaired Moderate/Severe - Instruction Area	1,500	139	
2 Staff Planning Area	100	9	Calculated in Staff Collaboration
3 Kitchen			Included in Instruction Area
4 Handicap-accessible Restroom			Included in Instruction Area
5 Changing and Shower Area			Included in Instruction Area
Total	1,600	149	



classroom with direct access to the intercom, main entrance, and a teacher-controlled master switch for all electrical equipment.

Provide a computer area with accessible stations with ample room for over-the-shoulder tutoring. Provide adequate maneuvering clearances for students to make and retrieve their own printed material. There should be a common printer location.

Provide a storage area with space for equipment and instructional materials. A sink and drinking fountain should be provided. Counter and sink heights should be based on the age of the students using them.

Home Living Area

Home living skills are an important part of the special education program. Coordinate with special education instructor for appropriate dining room, living room, and bedroom furniture to be provided.

2 Staff Planning Area

Provide an area for the teacher's desk that is designed to restrict student access but allow visual supervision of the instructional area at all times. This area may be combined with the kitchen area so that it is behind the gate to restrict student access. This area should not be a separate enclosed room.

3 Kitchen

The kitchen shall provide a double sink, refrigerator, range with commercial hood, microwave, dishwasher, and clothes washer and dryer. The kitchen must be designed so that access may be restricted when not in use. This may be with a dutch-door or gate, but

does not have to be a solid wall. It is desirable to have an open counter area that is wheelchair accessible between the kitchen and the instructional area so that students can gather to watch a demonstration or work on a project.

For middle and high school students, the kitchen will be used to teach home living skills. All appliances and counters should be handicap accessible. The controls for the range should be at the front of the appliance so that students do not have to reach across the hot burners. The washer and dryer should be accessible for teaching purposes.

4 Handicap accessible Restroom

A unisex, ADA compliant restroom, containing a water closet and a lavatory, shall be provided.

5 Changing and Shower Area

A separate room containing a shower with fold down seat, lavatory, and space for a changing table with hydraulic lift shall be provided. Provide power for hydraulic lift. Include storage for diapering and hygiene supplies. Be sure that these supplies are within easy reach of the caregiver, but will not present a hazard to the child.

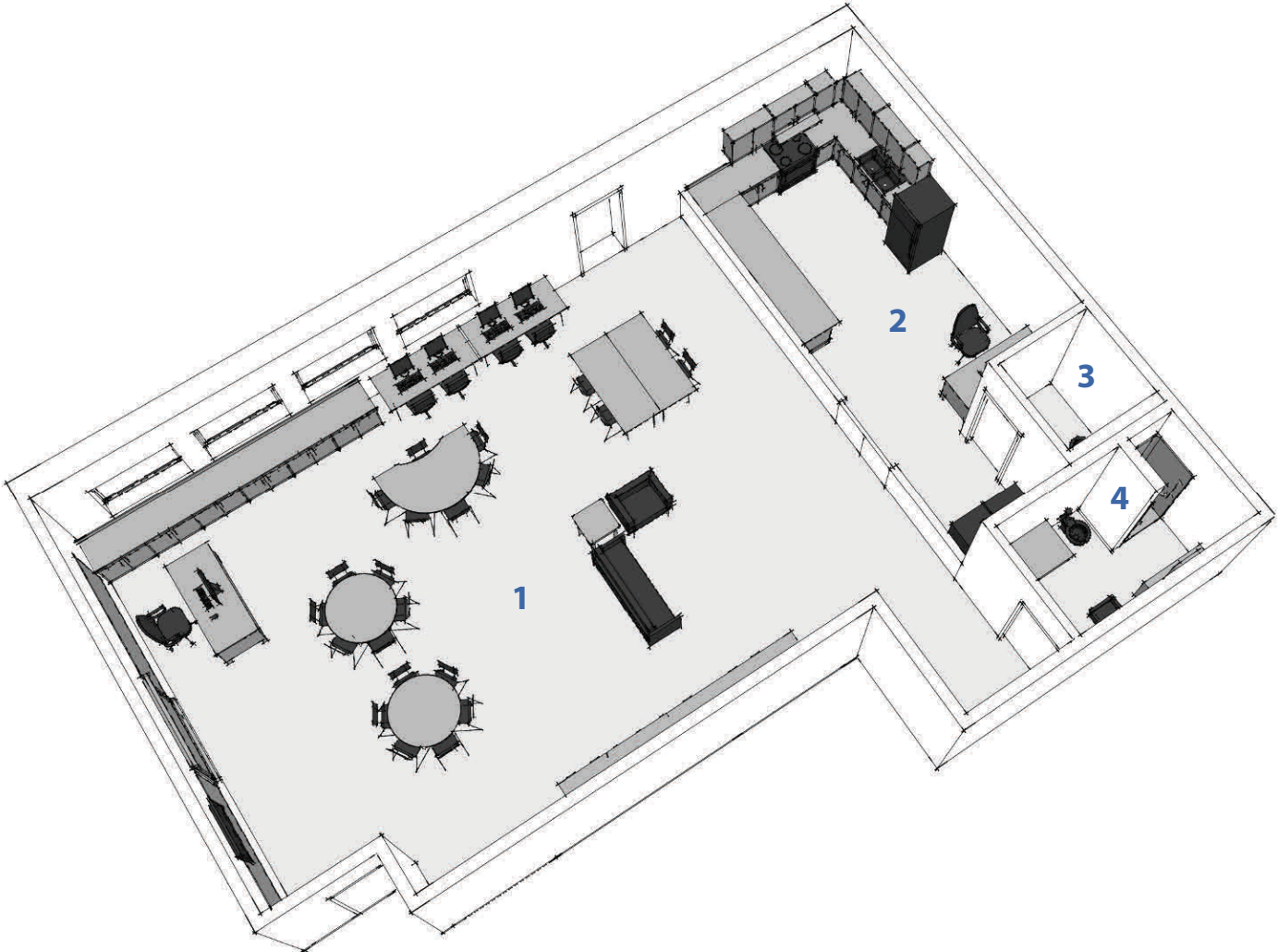

Learning Impaired Moderate/Severe Concept Perspective

NOTE: 3D illustrations are shown for informational purposes and are not intended to limit design options.