

1 LAYOUT AND LANDSCAPE PLAN
PLAN

- NOTES:**
1. ALL TREES BEING PLANTED ALONG CLAIBORNE AVENUE (FRONTING), SHALL BE 12' FROM THE BACK OF CURB UNLESS NOTED OTHERWISE.
 2. FOR PLANTING DETAILS, NOTES AND PLANT SCHEDULE SEE SHEET L-24.

LEGEND

- EXISTING LIGHT POLE
- ⊕ PROPOSED LIGHT POLE (N.I.C.)
- LARGE TREE SYMBOL - HIGHTOWER WILLOW OAK
- ⊕ LARGE PALM SYMBOL - CANARY ISLAND DATE PALM
- ⊕ SMALL TREE SYMBOL - MUSKOGEE CRAPE MYRTLE
- ☁ EXISTING TREE TO REMAIN

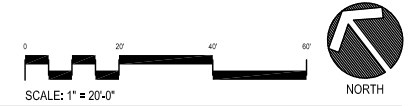

MARK	DESCRIPTION	DATE	APPR. MARK	DATE	APPR.
	DRAWING REVISIONS PER REVIEW COMMENTS	11.24.09			
	DRAWING REVISIONS PER REVIEW COMMENTS	12.23.09			

DESIGNED BY: CC: E. BA.	CHECKED BY: E. BA.	DATE: 08-15-2009
SUBMITTED BY: BRANDON ADAMS	CONTRACT NO.: W9127P-09-4-0041	STATUS: WORK PACKAGE #004
PLOT SCALE: 1:1	FILE NUMBER: H-#-###	FILE NAME:
SIZE: ANSI:		

U.S. ARMY CORPS OF ENGINEERS
NEW ORLEANS DISTRICT
NEW ORLEANS, LOUISIANA

SOUTH CLAIBORNE AVE. & NAPOLEON AVE.
LANDSCAPE IMPROVEMENTS

LAYOUT AND LANDSCAPE PLAN

SHEET IDENTIFICATION
L-01

Draft

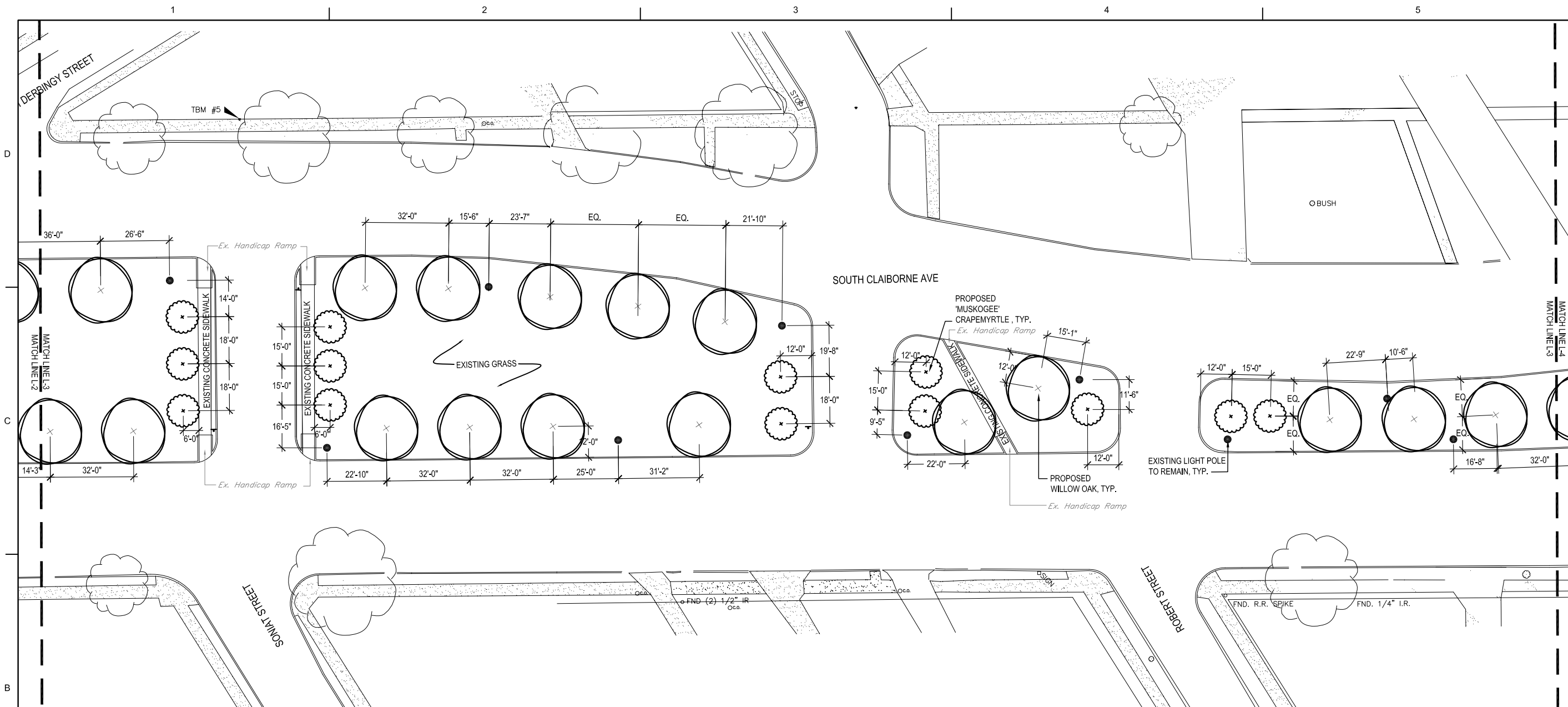

DATE	DESCRIPTION	APPR. MARK	DATE	APPR. MARK
11.24.09	DRAWING REVISIONS PER REVIEW COMMENTS			
12.23.09	DRAWING REVISIONS PER REVIEW COMMENTS			

DATE: 08-15-09	DESIGNED BY: CC, J. BA.	SCALE: 1" = 20'-0"
DATE: 08-15-09	DRAWN BY: BRANDON ADAMS	FILE NAME: H-#-###
DATE: 08-15-09	CHECKED BY: BRANDON ADAMS	FILE NUMBER: H-#-###
DATE: 08-15-09	APPROVED BY: BRANDON ADAMS	FILE NUMBER: H-#-###

U.S. ARMY CORPS OF ENGINEERS
 NEW ORLEANS DISTRICT
 NEW ORLEANS, LOUISIANA

SOUTH CLAIBORNE AVE. & NAPOLEON AVE.
 LANDSCAPE IMPROVEMENTS
 LAYOUT AND LANDSCAPE PLAN

SHEET IDENTIFICATION
L-03

1 LAYOUT AND LANDSCAPE PLAN

- NOTES:**
- ALL TREES BEING PLANTED ALONG CLAIBORNE AVENUE (FRONTING), SHALL BE 12' FROM THE BACK OF CURB UNLESS NOTED OTHERWISE.
 - FOR PLANTING DETAILS, NOTES AND PLANT SCHEDULE SEE SHEET L-24.

LEGEND

	EXISTING LIGHT POLE		LARGE TREE SYMBOL - HIGHTOWER WILLOW OAK		SMALL TREE SYMBOL - MUSKOGEE CRAPE MYRTLE		EXISTING TREE TO REMAIN
	PROPOSED LIGHT POLE (N.I.C.)		LARGE PALM SYMBOL - CANARY ISLAND DATE PALM				

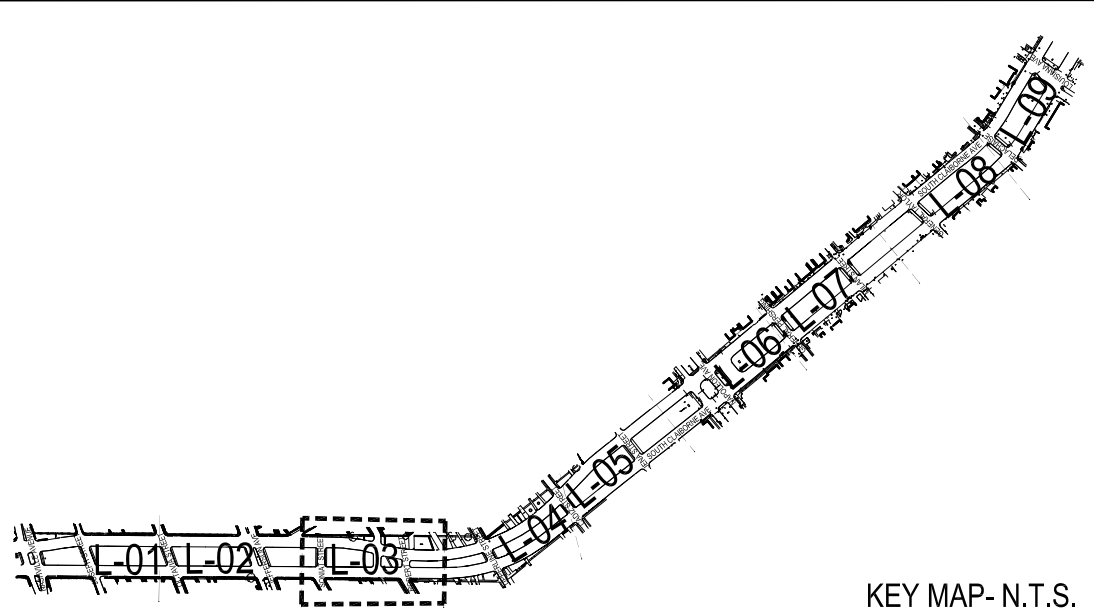
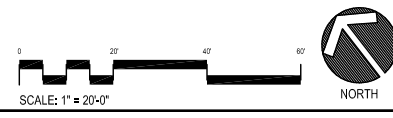

Draft

MARK	DESCRIPTION	DATE	APPR. MARK	DATE	APPR.
	DRAWING REVISIONS PER REVIEW COMMENTS	11.24.09			
	DRAWING REVISIONS PER REVIEW COMMENTS	12.23.09			

DATE:	09-15-09	STATUS:	WORK PACKAGE #004
DESIGNED BY:	CC BY	SCALE:	AS SHOWN
CHECKED BY:	BRANDON ADAMS	CONTRACT NO.:	W912P6-09-2-0041
SUBMITTED BY:	BRANDON ADAMS	FILE NUMBER:	H-#-###
DESIGNED BY:	CC BY	FILE NAME:	

U.S. ARMY CORPS OF ENGINEERS
NEW ORLEANS DISTRICT
NEW ORLEANS, LOUISIANA

SOUTH CLAIBORNE AVE. & NAPOLEON AVE.
LANDSCAPE IMPROVEMENTS
LAYOUT AND LANDSCAPE PLAN

SHEET IDENTIFICATION
L-04

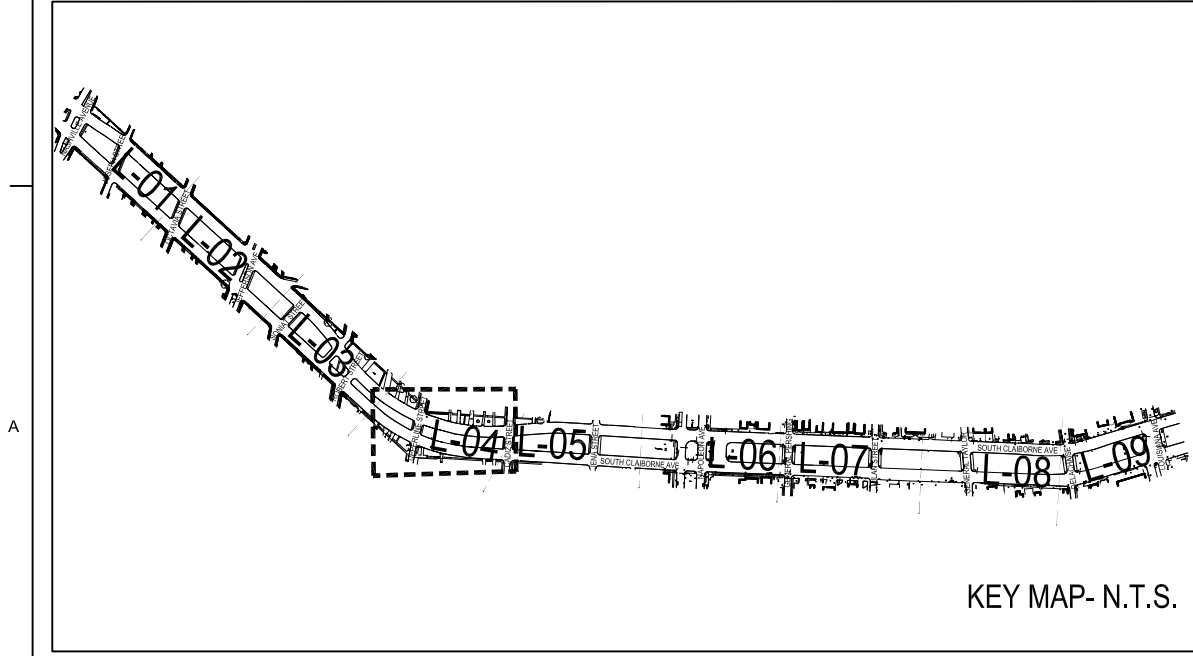
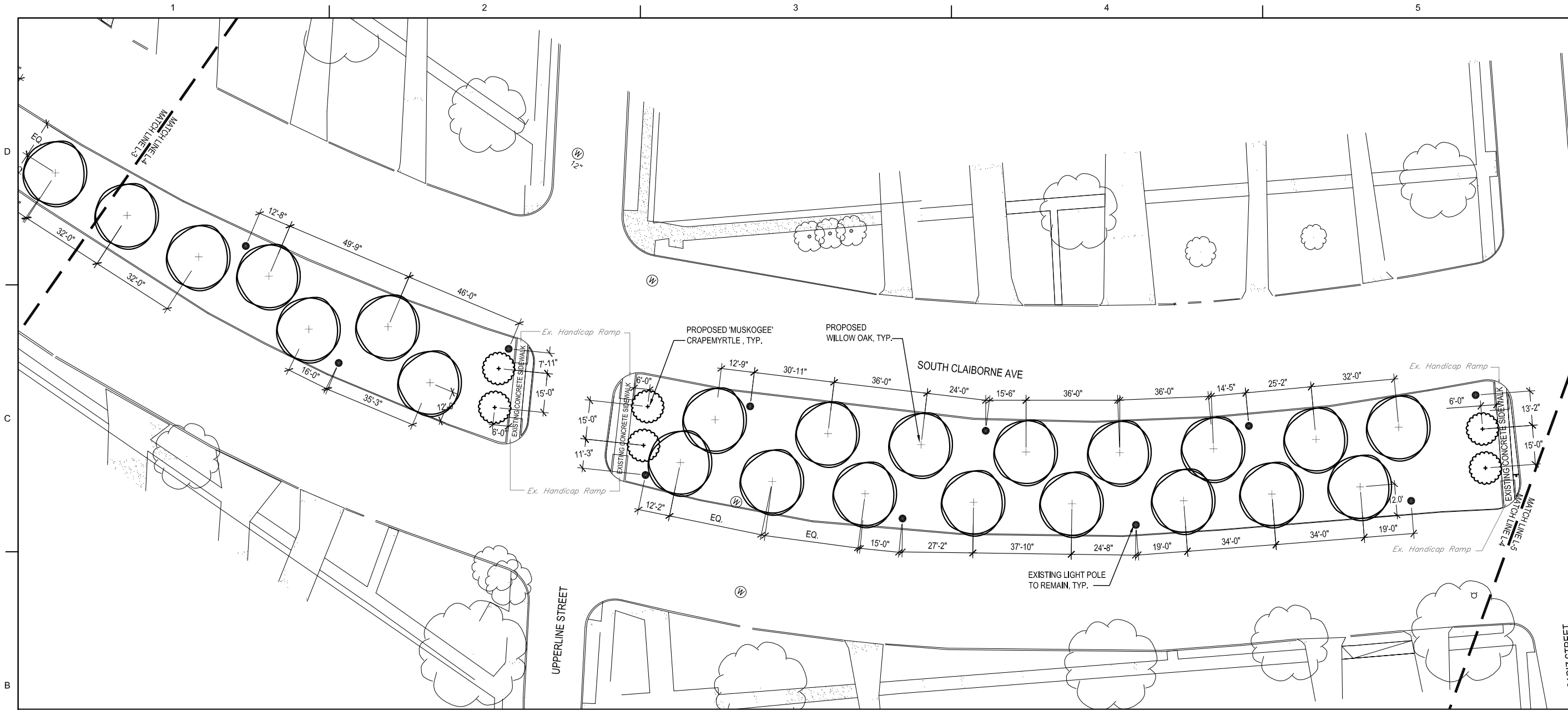

1 LAYOUT AND LANDSCAPE PLAN
PLAN

- NOTES:**
1. ALL TREES BEING PLANTED ALONG CLAIBORNE AVENUE (FRONTING), SHALL BE 12' FROM THE BACK OF CURB UNLESS NOTED OTHERWISE.
 2. FOR PLANTING DETAILS, NOTES AND PLANT SCHEDULE SEE SHEET L-24.

LEGEND

- EXISTING LIGHT POLE
- PROPOSED LIGHT POLE (N.I.C.)
- LARGE TREE SYMBOL- HIGHTOWER WILLOW OAK
- SMALL TREE SYMBOL- MUSKOGEE CRAPE MYRTLE
- LARGE PALM SYMBOL - CANARY ISLAND DATE PALM
- EXISTING TREE TO REMAIN



Draft

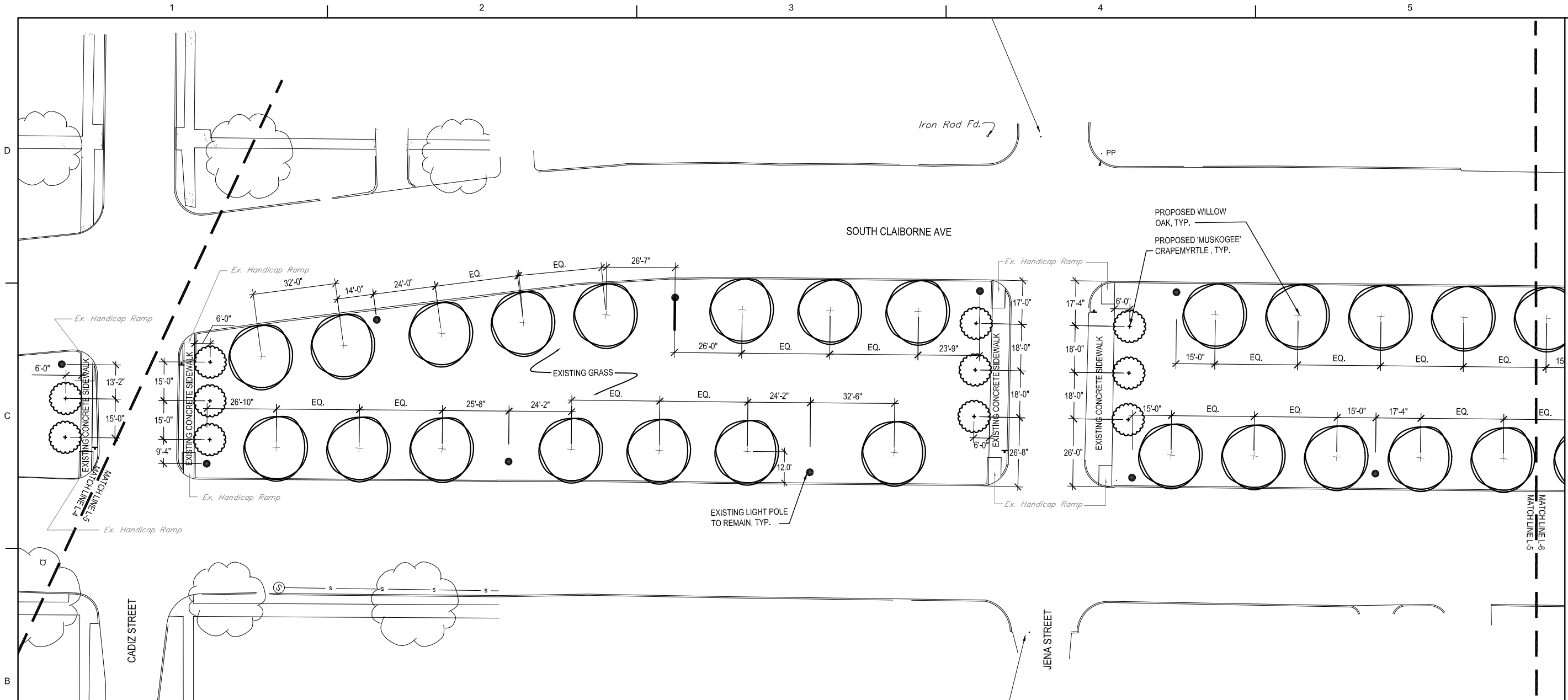

DATE	DESCRIPTION	APPR. MARK
11.24.09	DRAWING REVISIONS PER REVIEW COMMENTS	
12.23.09	DRAWING REVISIONS PER REVIEW COMMENTS	

DESIGNED BY: C.C. BA.	DATE: 08-15-09
DRAWN BY: BRANDON ADAMS	CHECKED BY: C.C. BA.
PROJECT NO.: V91278-09-0-041	CONTRACT NO.: V91278-09-0-041
FILE NUMBER: H-#-####	WORK PACKAGE #004

U.S. ARMY CORPS OF ENGINEERS
NEW ORLEANS DISTRICT
NEW ORLEANS, LOUISIANA

SOUTH CLAIBORNE AVE. & NAPOLEON AVE.
LANDSCAPE IMPROVEMENTS
LAYOUT AND LANDSCAPE PLAN

SHEET IDENTIFICATION
L-05

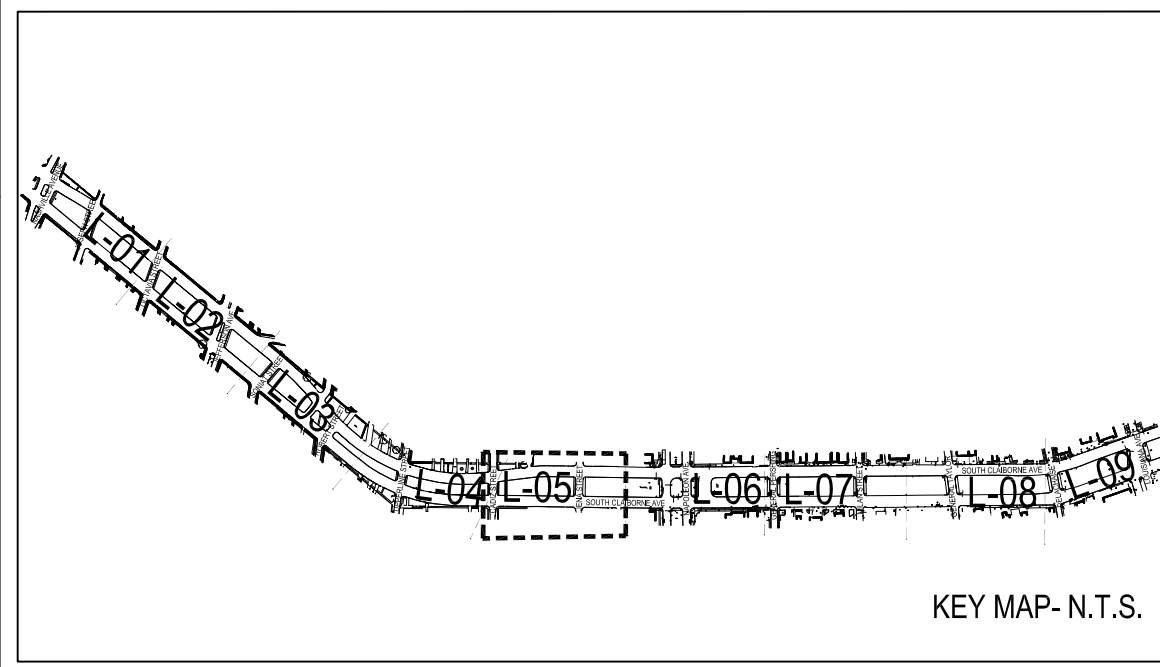

1 LAYOUT AND LANDSCAPE PLAN

- NOTES:**
- ALL TREES BEING PLANTED ALONG CLAIBORNE AVENUE (FRONTING), SHALL BE 12' FROM THE BACK OF CURB UNLESS NOTED OTHERWISE.
 - FOR PLANTING DETAILS, NOTES AND PLANT SCHEDULE SEE SHEET L-24.

LEGEND

	EXISTING LIGHT POLE		LARGE TREE SYMBOL- HIGHTOWER WILLOW OAK		SMALL TREE SYMBOL- MUSKOGEE CRAPE MYRTLE		EXISTING TREE TO REMAIN
	PROPOSED LIGHT POLE (N.I.C.)		LARGE PALM SYMBOL - CANARY ISLAND DATE PALM				

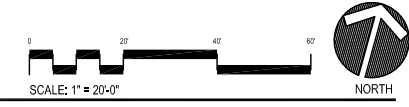

Draft

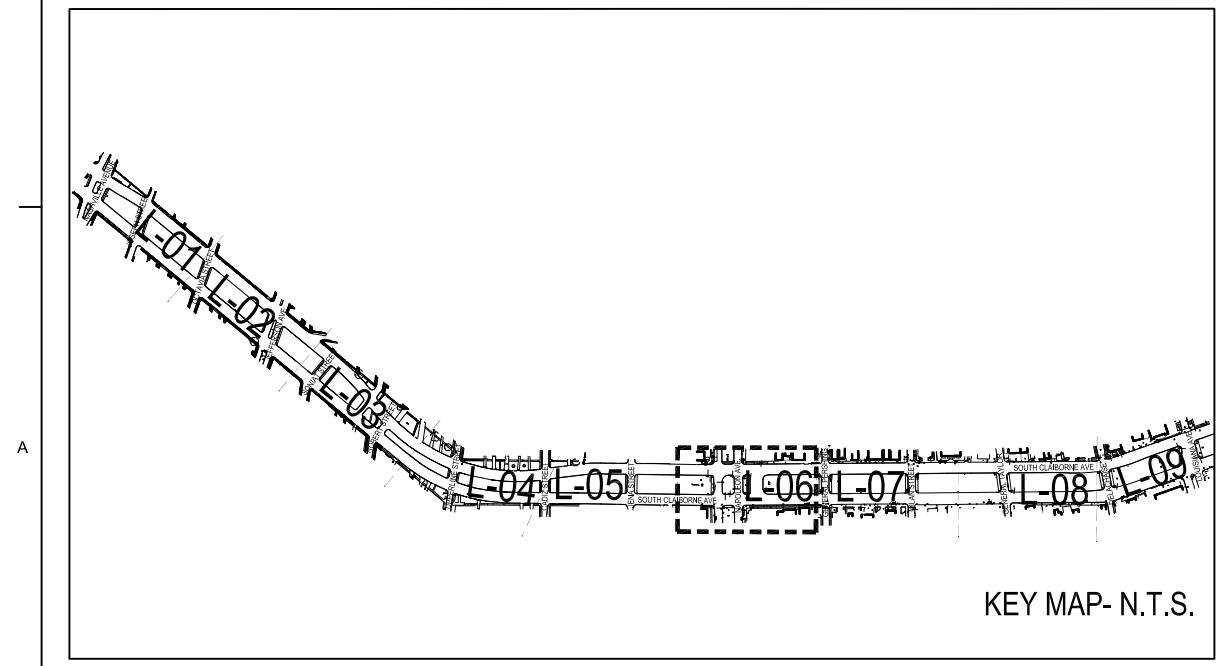
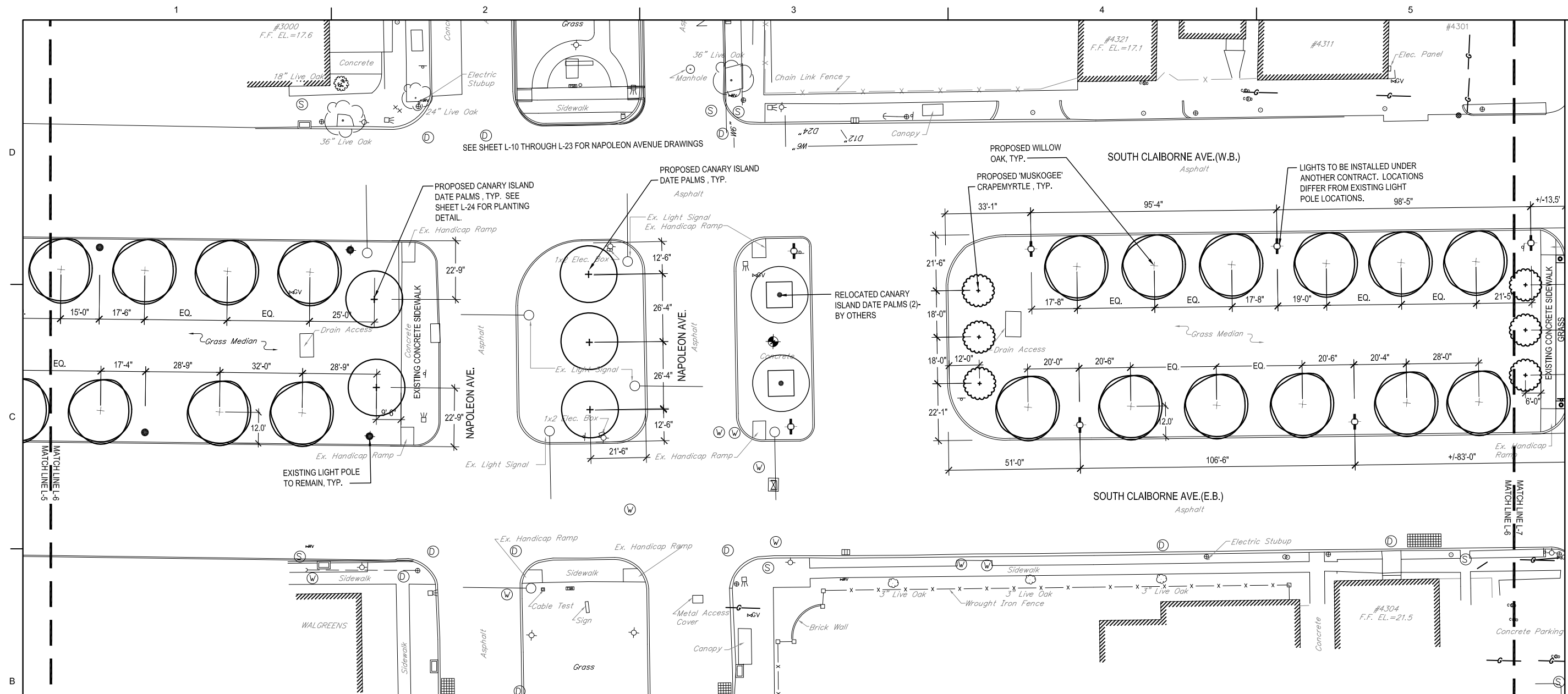

1 LAYOUT AND LANDSCAPE PLAN

- NOTES:**
1. ALL TREES BEING PLANTED ALONG CLAIBORNE AVENUE (FRONTING), SHALL BE 12' FROM THE BACK OF CURB UNLESS NOTED OTHERWISE.
 2. FOR PLANTING DETAILS, NOTES AND PLANT SCHEDULE SEE SHEET L-24.

LEGEND

- EXISTING LIGHT POLE
- ⊕ PROPOSED LIGHT POLE (N.I.C.)
- LARGE TREE SYMBOL- HIGHTOWER WILLOW OAK
- ⊕ LARGE PALM SYMBOL - CANARY ISLAND DATE PALM
- ⊕ SMALL TREE SYMBOL- MUSKOGEE CRAPE MYRTLE
- ⊕ EXISTING TREE TO REMAIN

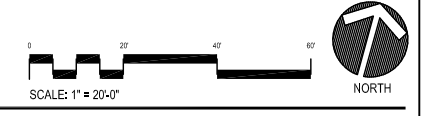

DATE	DESCRIPTION	APPR. MARK
11.24.09	DRAWING REVISIONS PER REVIEW COMMENTS	
12.23.09	DRAWING REVISIONS PER REVIEW COMMENTS	

DESIGNED BY: CC: J. BA.	DRAWN BY: BRANDON ADAMS	DATE: 08-15-2009
CHECKED BY: BRANDON ADAMS	DATE: 08-15-2009	STATUS: WORK PACKAGE #004
CONTRACT NO.: W912P9-09-2-0041	FILE NUMBER: H-#-###	
PLOT SCALE: 1:1	FILE NAME: ANSID	

U.S. ARMY CORPS OF ENGINEERS
NEW ORLEANS DISTRICT
NEW ORLEANS, LOUISIANA

SOUTH CLAIBORNE AVE. & NAPOLEON AVE.
LANDSCAPE IMPROVEMENTS

LAYOUT AND LANDSCAPE PLAN

SHEET IDENTIFICATION
L-06

Draft

DATE	DESCRIPTION	APPR. MARK
11.24.09	DRAWING REVISIONS PER REVIEW COMMENTS	
12.23.09	DRAWING REVISIONS PER REVIEW COMMENTS	

DATE: 09-15-09	DESIGNED BY: BRANDON ADAMS
SCALE: 1" = 20'-0"	CHECKED BY: BRANDON ADAMS
PROJECT NO.: W912P9-09-0-041	CONTRACT NO.: W912P9-09-0-041
FILE NUMBER: H-#-###	FILE NAME:

U.S. ARMY CORPS OF ENGINEERS
NEW ORLEANS DISTRICT
NEW ORLEANS, LOUISIANA

SOUTH CLAIBORNE AVE. & NAPOLEON AVE.
LANDSCAPE IMPROVEMENTS
LAYOUT AND LANDSCAPE PLAN

SHEET IDENTIFICATION
L-07

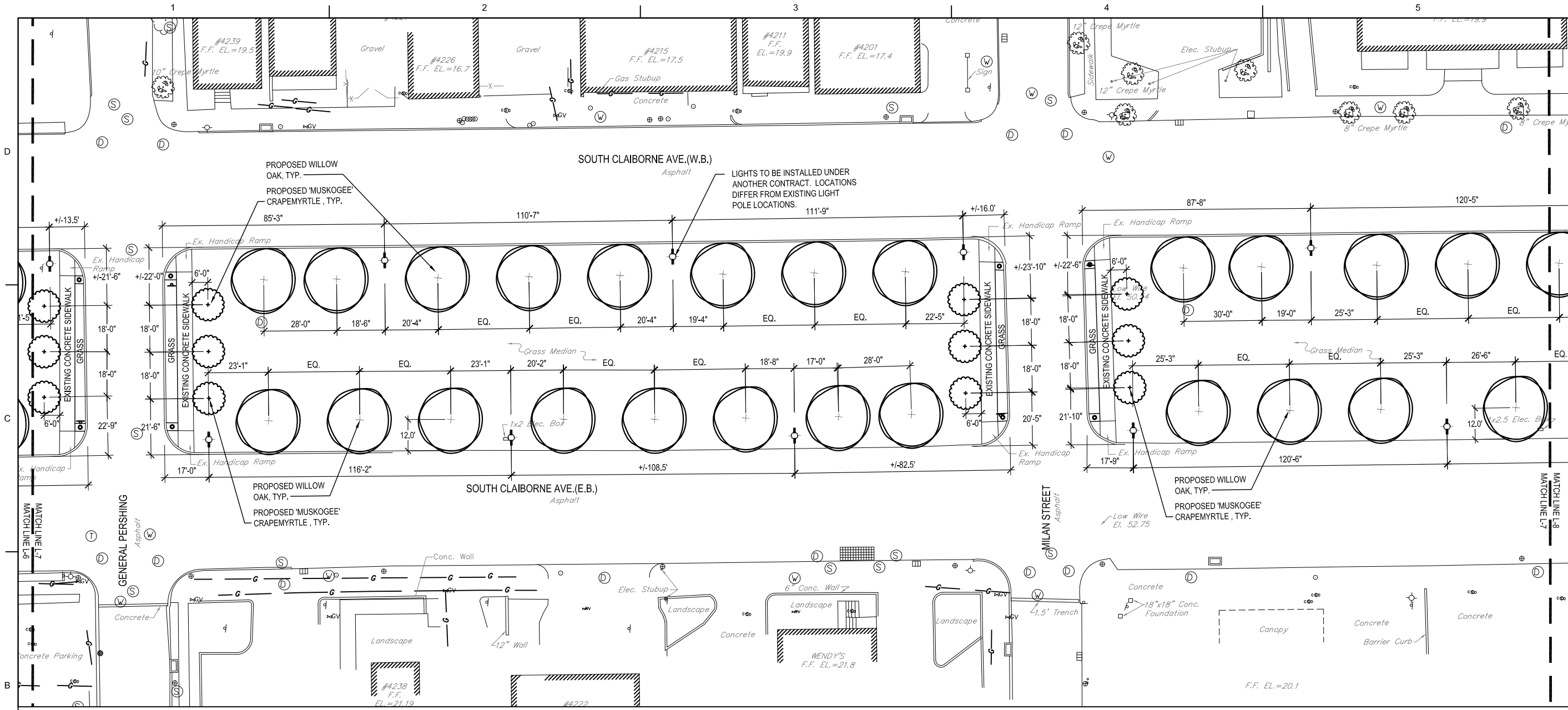

1 LAYOUT AND LANDSCAPE PLAN
PLAN

- NOTES:**
- ALL TREES BEING PLANTED ALONG CLAIBORNE AVENUE (FRONTING), SHALL BE 12' FROM THE BACK OF CURB UNLESS NOTED OTHERWISE.
 - FOR PLANTING DETAILS, NOTES AND PLANT SCHEDULE SEE SHEET L-24.

LEGEND

- EXISTING LIGHT POLE
- PROPOSED LIGHT POLE (N.I.C.)
- LARGE TREE SYMBOL - HIGHTOWER WILLOW OAK
- SMALL TREE SYMBOL - MUSKOGEE CRAPE MYRTLE
- LARGE PALM SYMBOL - CANARY ISLAND DATE PALM
- EXISTING TREE TO REMAIN

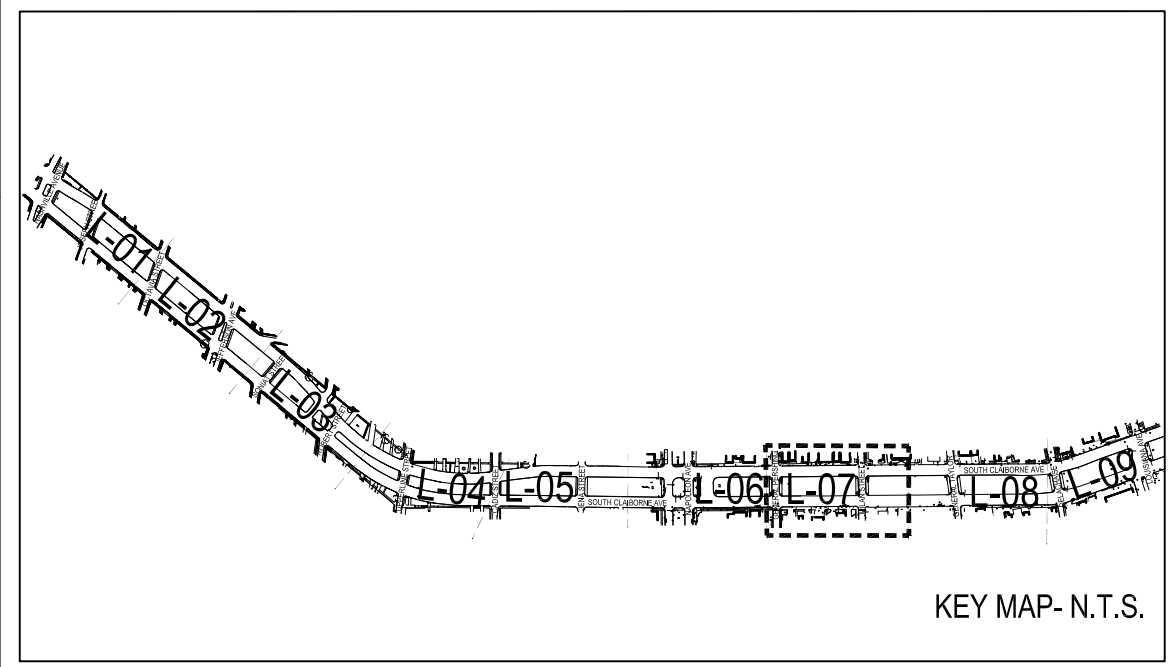

Draft

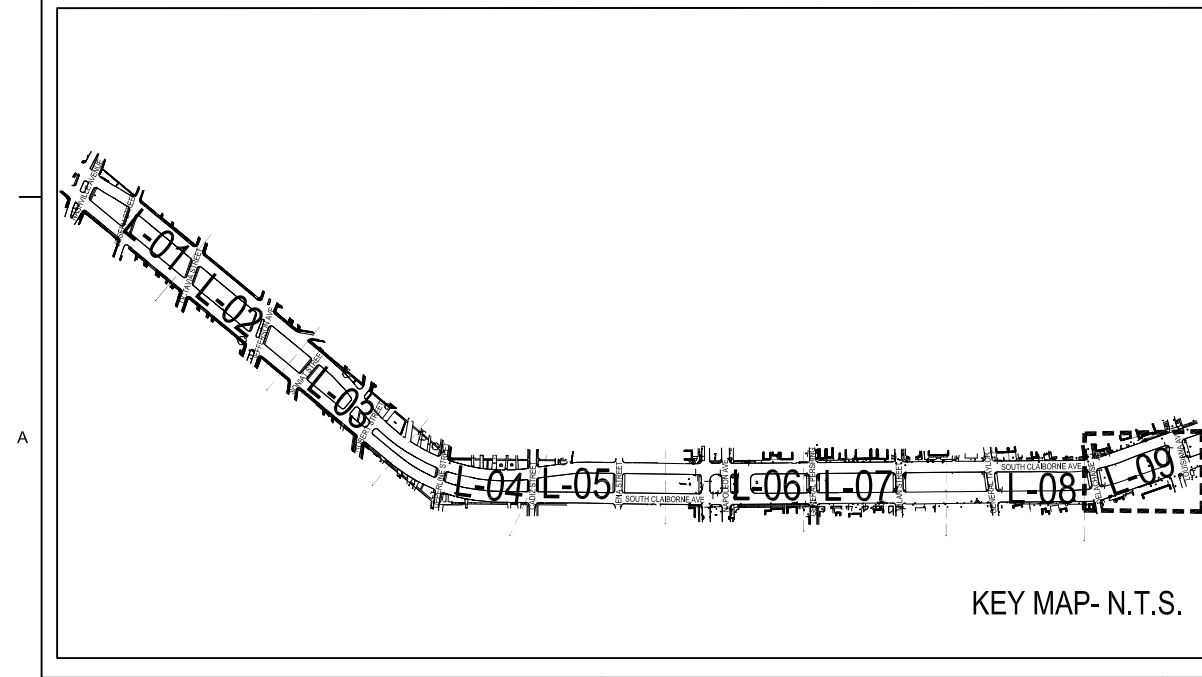
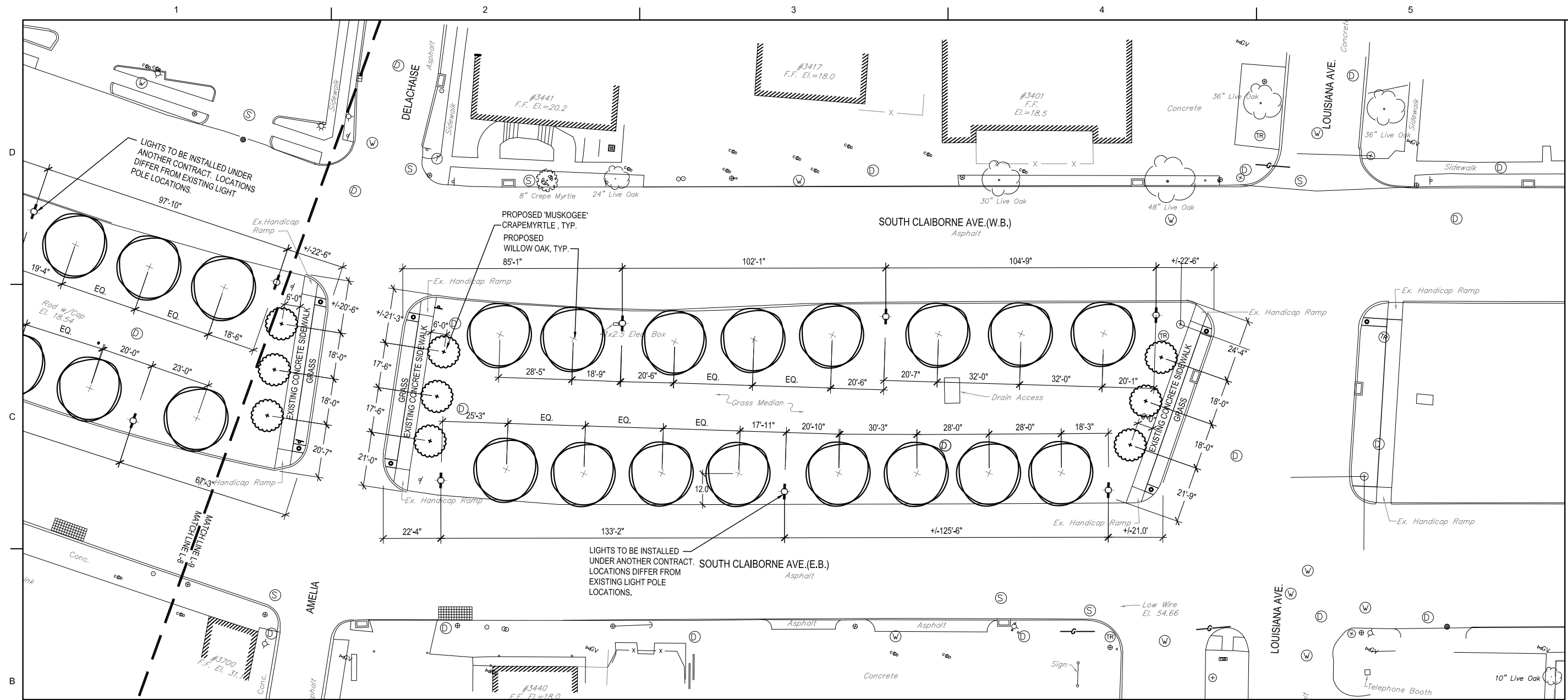

1 LAYOUT AND LANDSCAPE PLAN

PLAN

- NOTES:**
1. ALL TREES BEING PLANTED ALONG CLAIBORNE AVENUE (FRONTING), SHALL BE 12' FROM THE BACK OF CURB UNLESS NOTED OTHERWISE.
 2. FOR PLANTING DETAILS, NOTES AND PLANT SCHEDULE SEE SHEET L-24.

LEGEND

- EXISTING LIGHT POLE
- ⊕ PROPOSED LIGHT POLE (N.I.C.)
- LARGE TREE SYMBOL - HIGHTOWER WILLOW OAK
- ⊕ LARGE PALM SYMBOL - CANARY ISLAND DATE PALM
- ⊕ SMALL TREE SYMBOL - MUSKOGEE CRAPE MYRTLE
- ☼ EXISTING TREE TO REMAIN

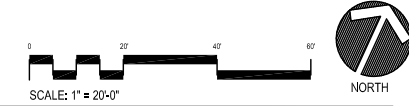

DATE	DESCRIPTION	APPR. MARK
11.24.09 <td>DRAWING REVISIONS PER REVIEW COMMENTS</td> <td></td>	DRAWING REVISIONS PER REVIEW COMMENTS	
12.23.09 <td>DRAWING REVISIONS PER REVIEW COMMENTS</td> <td></td>	DRAWING REVISIONS PER REVIEW COMMENTS	

DATE: 08-15-2009	DESIGNED BY: BRANDON ADAMS	CONTRACT NO.: W9127P-09-2-0041
SCALE: 1" = 20'-0"	CHECKED BY: BRANDON ADAMS	FILE NUMBER: H-#-####
PROJECT: SOUTH CLAIRBORNE AVE. & NAPOLEON AVE. LANDSCAPE IMPROVEMENTS	SUBMITTED BY: BRANDON ADAMS	FILE NAME:

U.S. ARMY CORPS OF ENGINEERS
 NEW ORLEANS DISTRICT
 NEW ORLEANS, LOUISIANA

SOUTH CLAIRBORNE AVE. & NAPOLEON AVE.
 LANDSCAPE IMPROVEMENTS

LAYOUT AND LANDSCAPE PLAN

SHEET IDENTIFICATION
L-09

Draft

LEGEND - LAYOUT AND MATERIALS

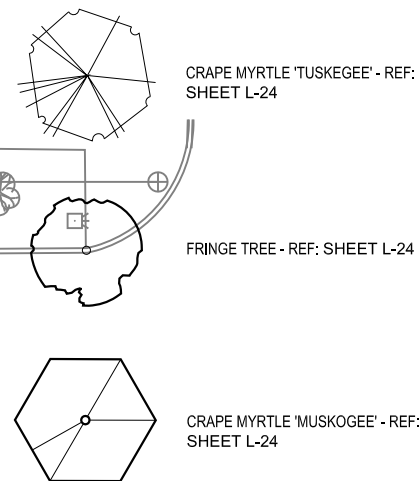

- EXISTING CONCRETE AND CURB TO BE REMOVED
- CONCRETE SIDEWALK - REF: DETAIL 1/L-22
- EXPANSION JOINT - REF: DETAIL 3/L-22
- CONTROL JOINT - REF: DETAIL 2/L-22
- CENTERLINE OF WALK
- CENTERPOINT OF ARC
- TANGENT POINT
- EXISTING LIGHT POLE
- EXISTING STOP SIGN - TO BE RE-LOCATED WHERE NEW RAMPS ARE INSTALLED- REF: 3/L-23

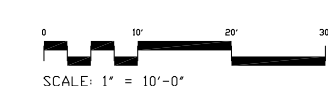
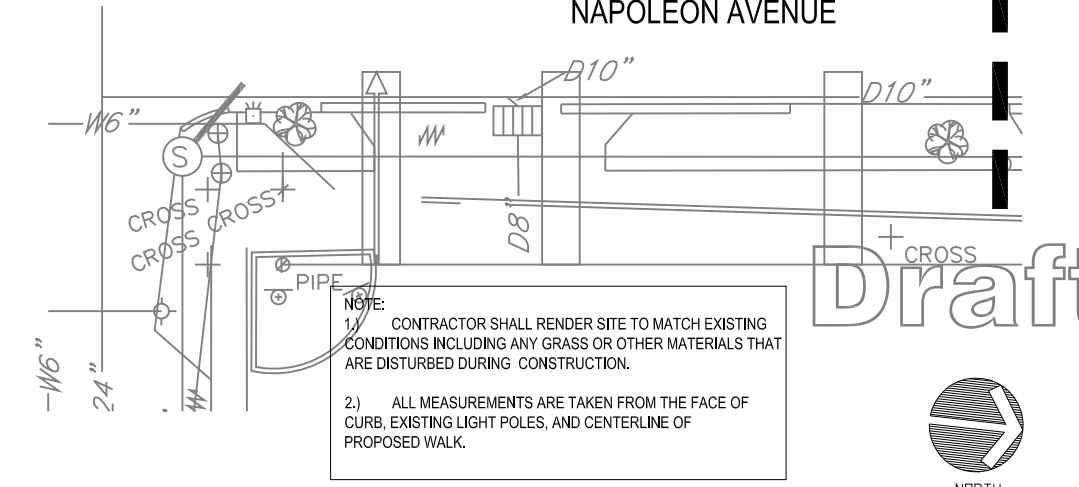
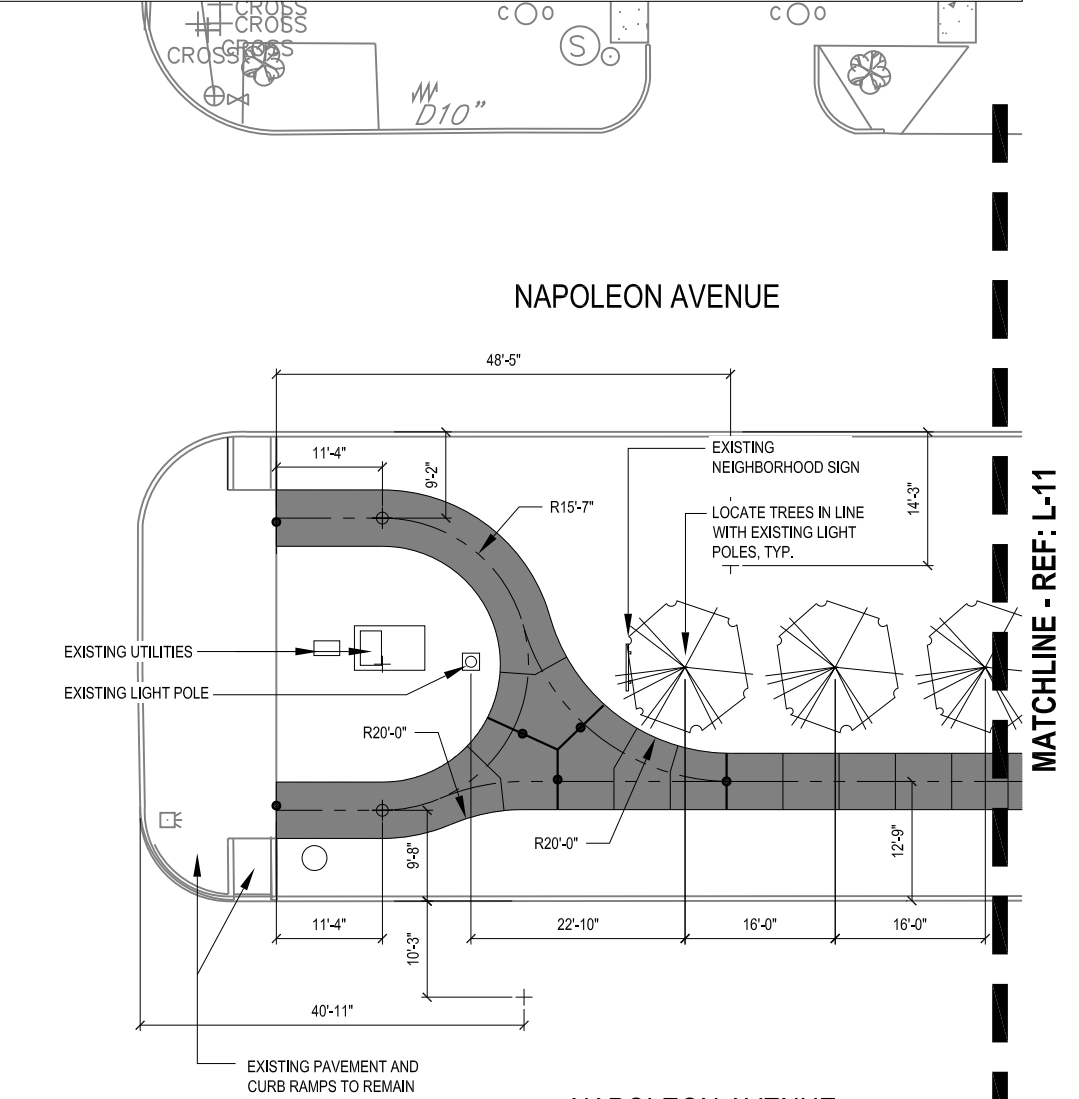
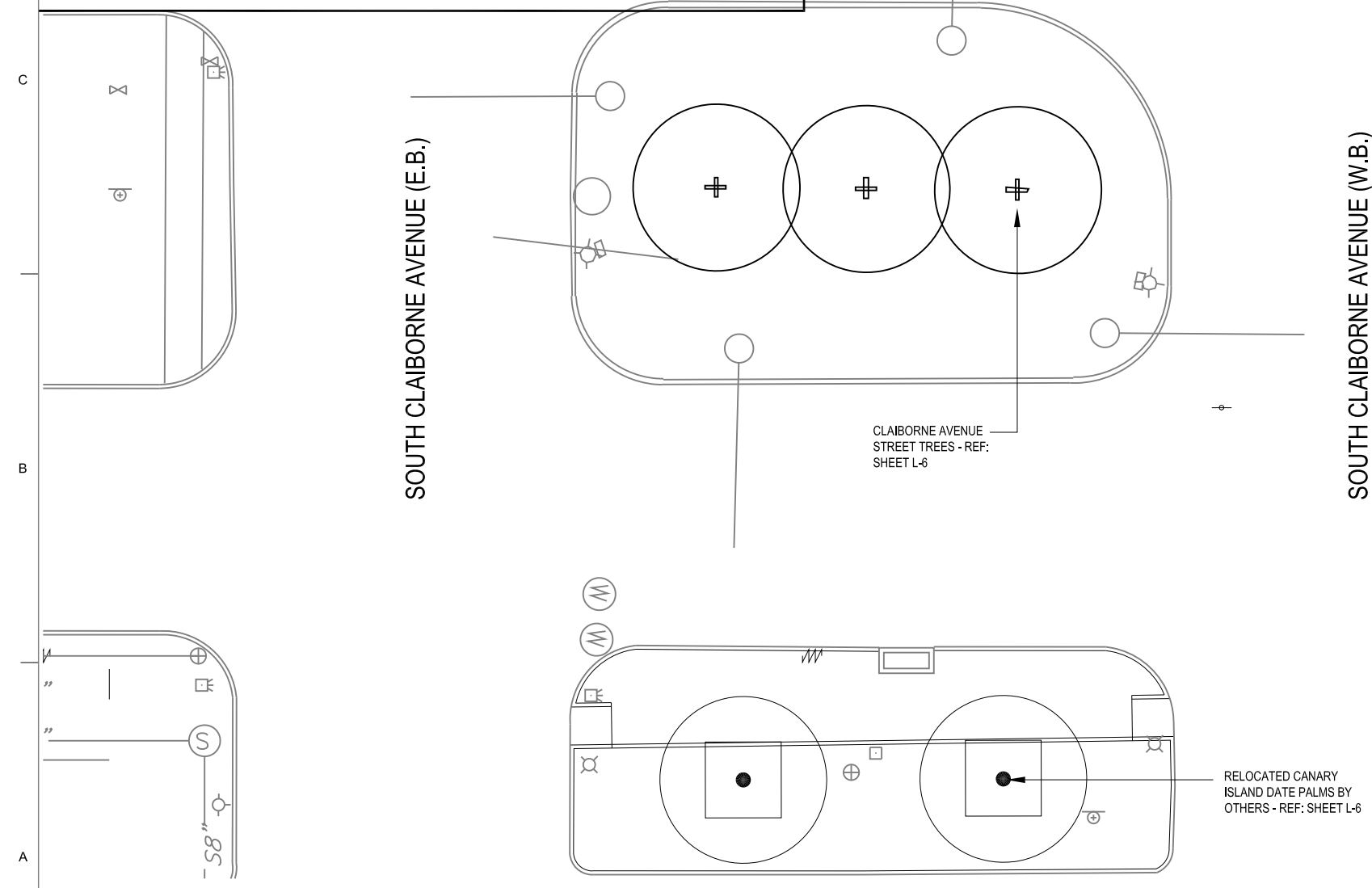
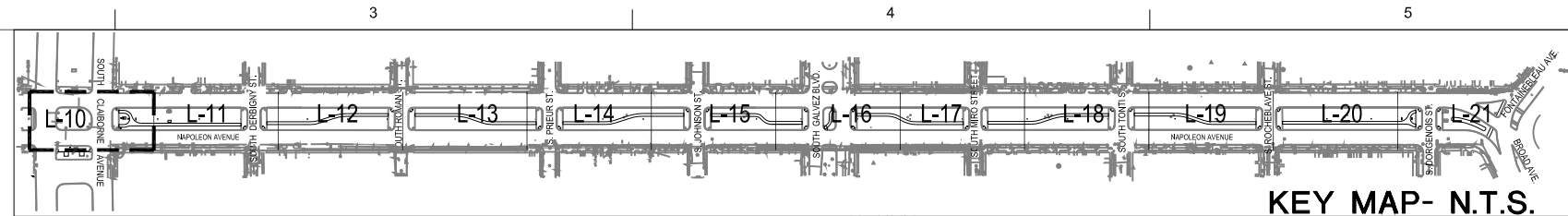

1 LAYOUT AND MATERIALS PLAN

U.S. Army Corps of Engineers
NEW ORLEANS DISTRICT

DATE	DESCRIPTION	MARK	DATE	DESCRIPTION	APPR. MARK	DATE	DESCRIPTION
11.24.09	DRAWING REVISIONS PER REVIEW COMMENTS						

DESIGNED BY: CC/CL/BA
DRAWN BY: JH
CHECKED BY: JH
SUBMITTED BY: Brandon Adams
PLOT SCALE: 1" = 10'-0"
DATE: 11/19/2009
SIZE: ANSIC
FILE NAME: Layout.dwg

DATE: 09-17-2009
DRAWN BY: JH
CHECKED BY: JH
SUBMITTED BY: Brandon Adams
CONTRACT NO.: W9127P-09-2-0041
PLOT DATE: 11/19/2009
FILE NUMBER: H-#-###

U.S. ARMY CORPS OF ENGINEERS
NEW ORLEANS DISTRICT
NEW ORLEANS, LOUISIANA

SOUTH CLAIBORNE AVE. & NAPOLEON AVE.
LANDSCAPE IMPROVEMENTS

LAYOUT AND MATERIALS PLAN

SHEET IDENTIFICATION
L-10

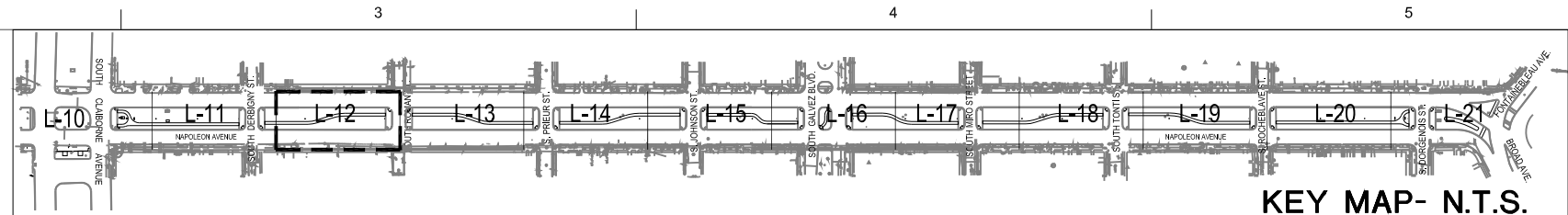

KEY MAP- N.T.S.

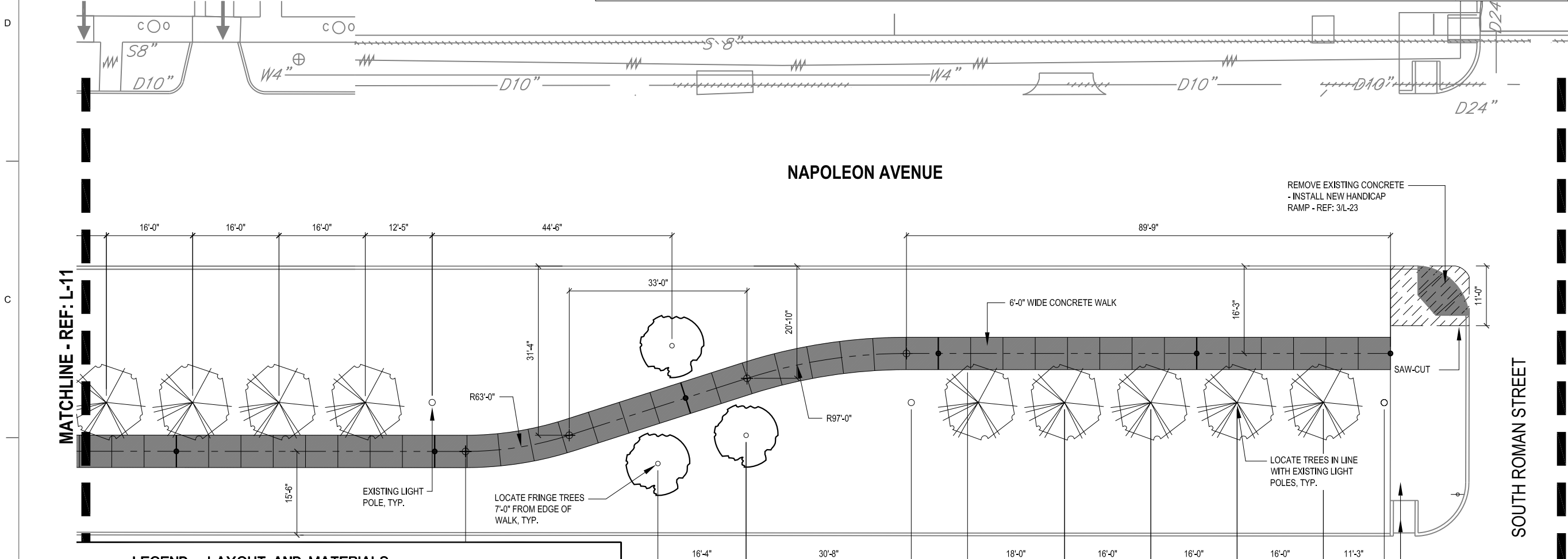

LEGEND - LAYOUT AND MATERIALS

	CRAPE MYRTLE 'TUSKEGEE' - REF: SHEET L-24		EXISTING CONCRETE AND CURB TO BE REMOVED
	FRINGE TREE - REF: SHEET L-24		CONCRETE SIDEWALK - REF: DETAIL 1/L-22
	CRAPE MYRTLE 'MUSKOGEE' - REF: SHEET L-24		CENTERLINE OF WALK
	EXPANSION JOINT - REF: DETAIL 3/L-22		CONTROL JOINT - REF: DETAIL 2/L-22
	CENTERPOINT OF ARC		TANGENT POINT
	EXISTING LIGHT POLE		EXISTING STOP SIGN - TO BE RE-LOCATED WHERE NEW RAMPS ARE INSTALLED- REF: 3/L-23

1 LAYOUT AND MATERIALS PLAN

NOTE:
 1.) CONTRACTOR SHALL RENDER SITE TO MATCH EXISTING CONDITIONS INCLUDING ANY GRASS OR OTHER MATERIALS THAT ARE DISTURBED DURING CONSTRUCTION.
 2.) ALL MEASUREMENTS ARE TAKEN FROM THE FACE OF CURB, EXISTING LIGHT POLES, AND CENTERLINE OF PROPOSED WALK.

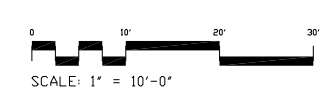

US Army Corps of Engineers
 NEW ORLEANS DISTRICT

DATE	DESCRIPTION	APPR.
11.24.09	DRAWING REVISIONS PER REVIEW COMMENTS	

DESIGNED BY: CC/CLBA	CHECKED BY: JH	DATE: 08-17-2009
DRAWN BY: JH	SCALE: AS SHOWN	WORK PACKAGE NO.: 1000
SUBMITTED BY: Brennan Adams	CONTRACT NO.: W9127P-09-2-0041	FILE NUMBER: H-#-####
PLOT SCALE: 1" = 10'-0"	DATE: 11/19/2009	FILE NAME: Layout.dwg
SIZE: A	ANSI D	Layout.dwg

U.S. ARMY CORPS OF ENGINEERS
 NEW ORLEANS DISTRICT
 NEW ORLEANS, LOUISIANA

SOUTH CLAIBORNE AVE. & NAPOLEON AVE.
 LANDSCAPE IMPROVEMENTS

LAYOUT AND MATERIALS PLAN

SHEET IDENTIFICATION
L-12

LEGEND - LAYOUT AND MATERIALS

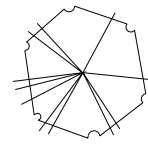

CRAPE MYRTLE 'TUSKEGEE' - REF: SHEET L-24

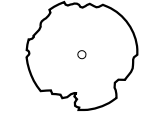

FRINGE TREE - REF: SHEET L-24

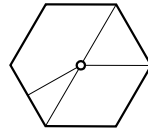

CRAPE MYRTLE 'MUSKOGEE' - REF: SHEET L-24

EXISTING CONCRETE AND CURB TO BE REMOVED

CONCRETE SIDEWALK - REF: DETAIL 1/L-22

EXPANSION JOINT - REF: DETAIL 3/L-22

CONTROL JOINT - REF: DETAIL 2/L-22

CENTERLINE OF WALK

CENTERPOINT OF ARC

TANGENT POINT

EXISTING LIGHT POLE

EXISTING STOP SIGN - TO BE RE-LOCATED WHERE NEW RAMPS ARE INSTALLED- REF: 3/L-23

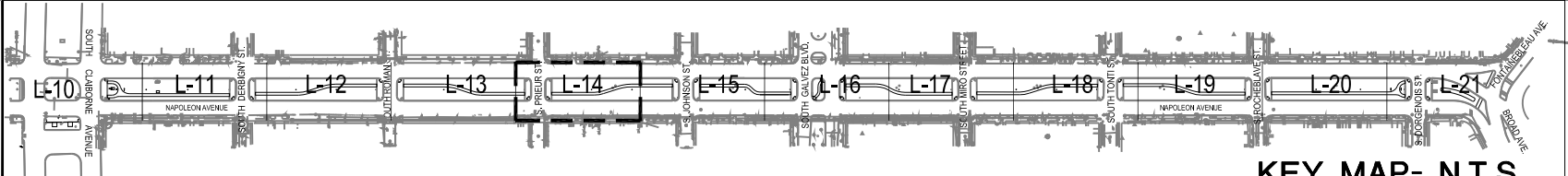

KEY MAP - N.T.S.

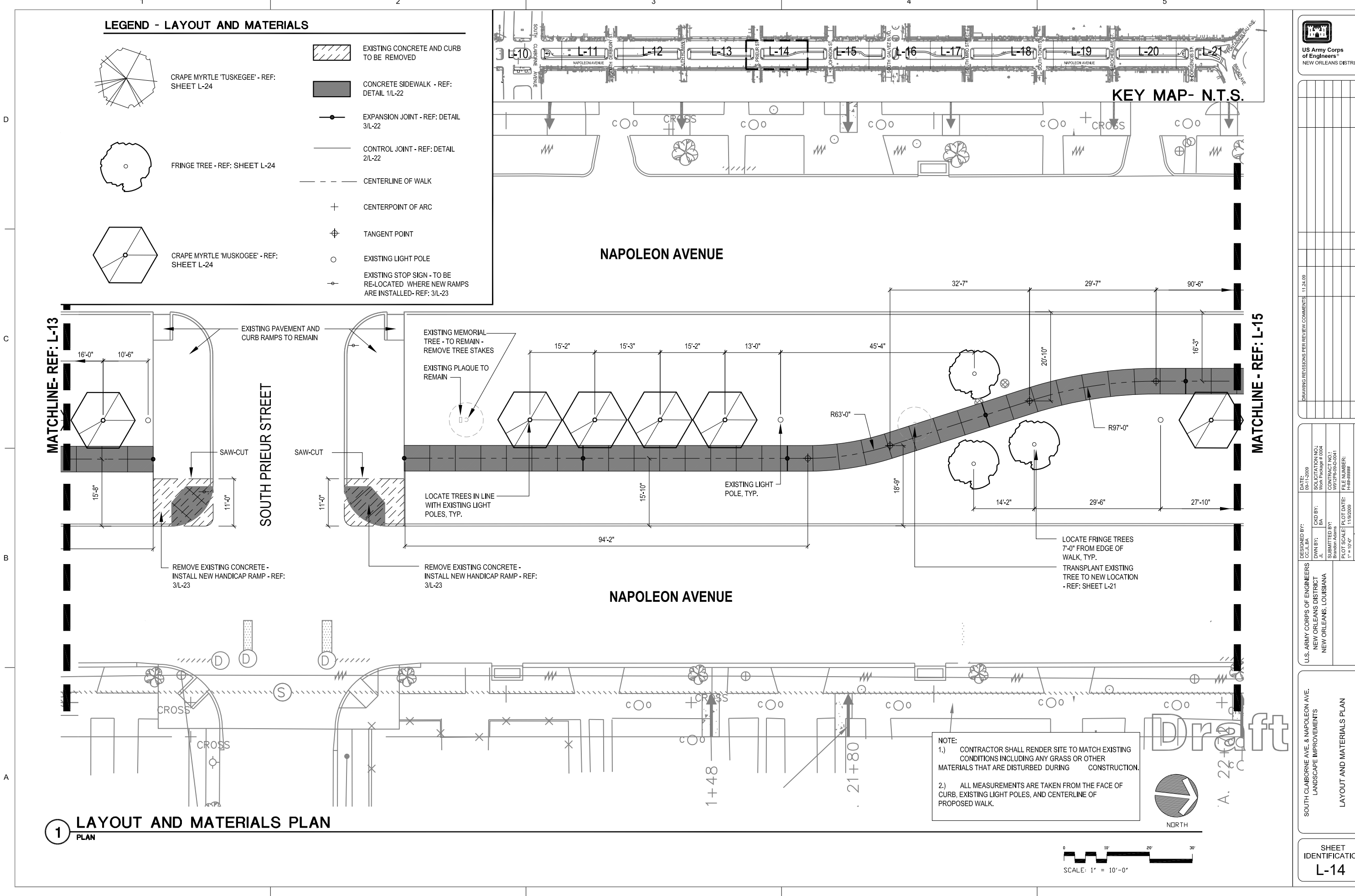

MATCHLINE - REF: L-13

MATCHLINE - REF: L-15

SOUTH PRIEUR STREET

NAPOLEON AVENUE

1 LAYOUT AND MATERIALS PLAN

NOTE:
 1.) CONTRACTOR SHALL RENDER SITE TO MATCH EXISTING CONDITIONS INCLUDING ANY GRASS OR OTHER MATERIALS THAT ARE DISTURBED DURING CONSTRUCTION.
 2.) ALL MEASUREMENTS ARE TAKEN FROM THE FACE OF CURB, EXISTING LIGHT POLES, AND CENTERLINE OF PROPOSED WALK.

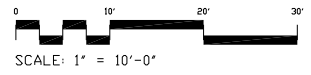

SCALE: 1" = 10'-0"



US Army Corps of Engineers
 NEW ORLEANS DISTRICT

DATE	DESCRIPTION	APPR. MARK	DATE	DESCRIPTION	APPR. MARK
11.24.09	DRAWING REVISIONS PER REVIEW COMMENTS				

DESIGNED BY: CC/CLBA	CHECKED BY: JH	DATE: 08-17-2009
DRAWN BY: JH	SCALE: AS SHOWN	WORK PLAN NO.: 1000
SUBMITTED BY: Brennan Adams	CONTRACT NO.: W912P9-09-2-0041	FILE NUMBER: H-#-####
DATE: 11/19/2009	FILE NAME: Layout.dwg	SIZE: ANSID

SOUTH CLAIBORNE AVE. & NAPOLEON AVE.
 LANDSCAPE IMPROVEMENTS
 LAYOUT AND MATERIALS PLAN

SHEET IDENTIFICATION
L-14

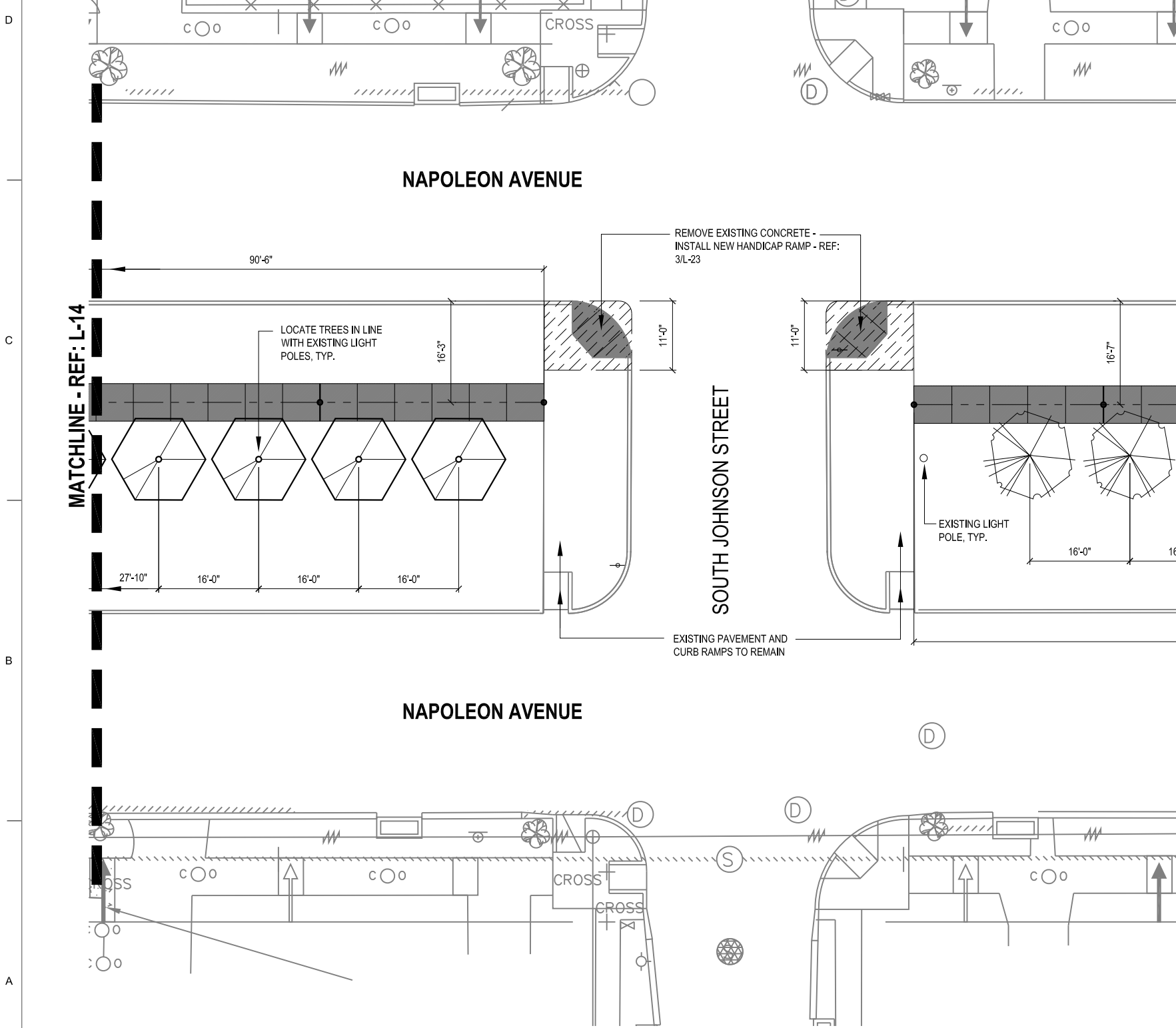
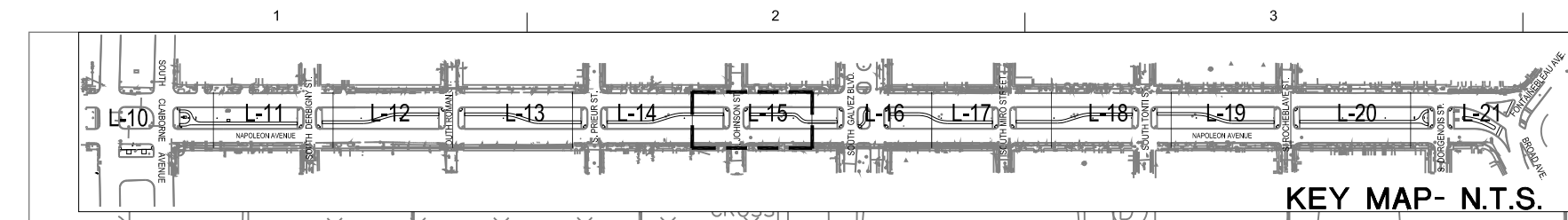

LEGEND - LAYOUT AND MATERIALS

	CRAPE MYRTLE 'TUSKEGEE' - REF: SHEET L-24		EXISTING CONCRETE AND CURB TO BE REMOVED
	FRINGE TREE - REF: SHEET L-24		CONCRETE SIDEWALK - REF: DETAIL 1/L-22
	CRAPE MYRTLE 'MUSKOGEE' - REF: SHEET L-24		EXPANSION JOINT - REF: DETAIL 3/L-22
			CONTROL JOINT - REF: DETAIL 2/L-22
			CENTERLINE OF WALK
			CENTERPOINT OF ARC
			TANGENT POINT
			EXISTING LIGHT POLE
			EXISTING STOP SIGN - TO BE RE-LOCATED WHERE NEW RAMPS ARE INSTALLED - REF: 3/L-23

1 LAYOUT AND MATERIALS PLAN
PLAN

NOTE:
 1.) CONTRACTOR SHALL RENDER SITE TO MATCH EXISTING CONDITIONS INCLUDING ANY GRASS OR OTHER MATERIALS THAT ARE DISTURBED DURING CONSTRUCTION.
 2.) ALL MEASUREMENTS ARE TAKEN FROM THE FACE OF CURB, EXISTING LIGHT POLES, AND CENTERLINE OF PROPOSED WALK.

Draft

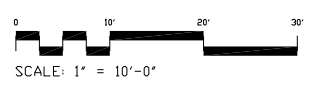

DATE	DESCRIPTION	APPR. MARK	DATE	APPR. MARK
11.24.09 <td>DRAWING REVISIONS PER REVIEW COMMENTS</td> <td></td> <td></td> <td></td>	DRAWING REVISIONS PER REVIEW COMMENTS			

DESIGNED BY: CC/CL/BA	DATE: 08-17-2009
DRAWN BY: JL	CHECKED BY: WPK/PJA/10/09
SUBMITTED BY: Bryan Adams	CONTRACT NO.:
FILE NUMBER:	FILE NUMBER:
FILE NAME: Layout.dwg	FILE NAME:

U.S. ARMY CORPS OF ENGINEERS
 NEW ORLEANS DISTRICT
 NEW ORLEANS, LOUISIANA

SOUTH CLABORNE AVE. & NAPOLEON AVE.
 LANDSCAPE IMPROVEMENTS

LAYOUT AND MATERIALS PLAN

SHEET IDENTIFICATION
L-15

MARK	DESCRIPTION	DATE	APPR. MARK	DATE	APPR.

DESIGNED BY: C.C.A.B.A.	CHECKED BY: J.L.	DATE: 08-17-2009
SUBMITTED BY: Brenton Adams	CONTRACT NO.:	WORK PACKAGE NO.:
FILE NUMBER:	FILE NUMBER:	FILE NUMBER:
FILE NAME: Layout.dwg	FILE NAME:	FILE NAME:

U.S. ARMY CORPS OF ENGINEERS
NEW ORLEANS DISTRICT
NEW ORLEANS, LOUISIANA

SOUTH CLARBORNE AVE. & NAPOLEON AVE.
LANDSCAPE IMPROVEMENTS

LAYOUT AND MATERIALS PLAN

SHEET IDENTIFICATION
L-18

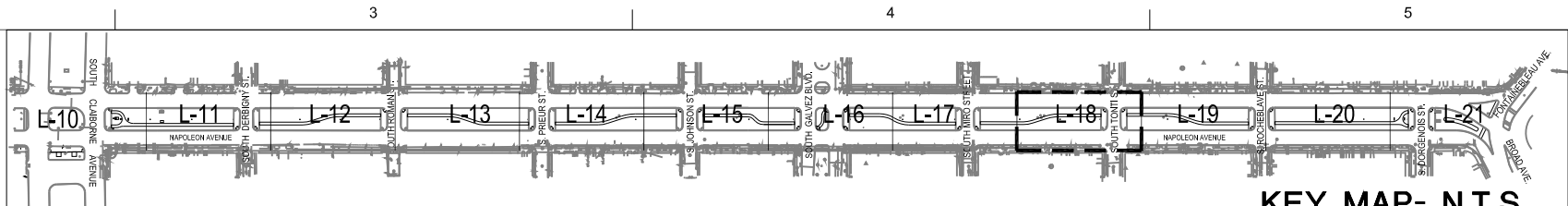

KEY MAP- N.T.S.

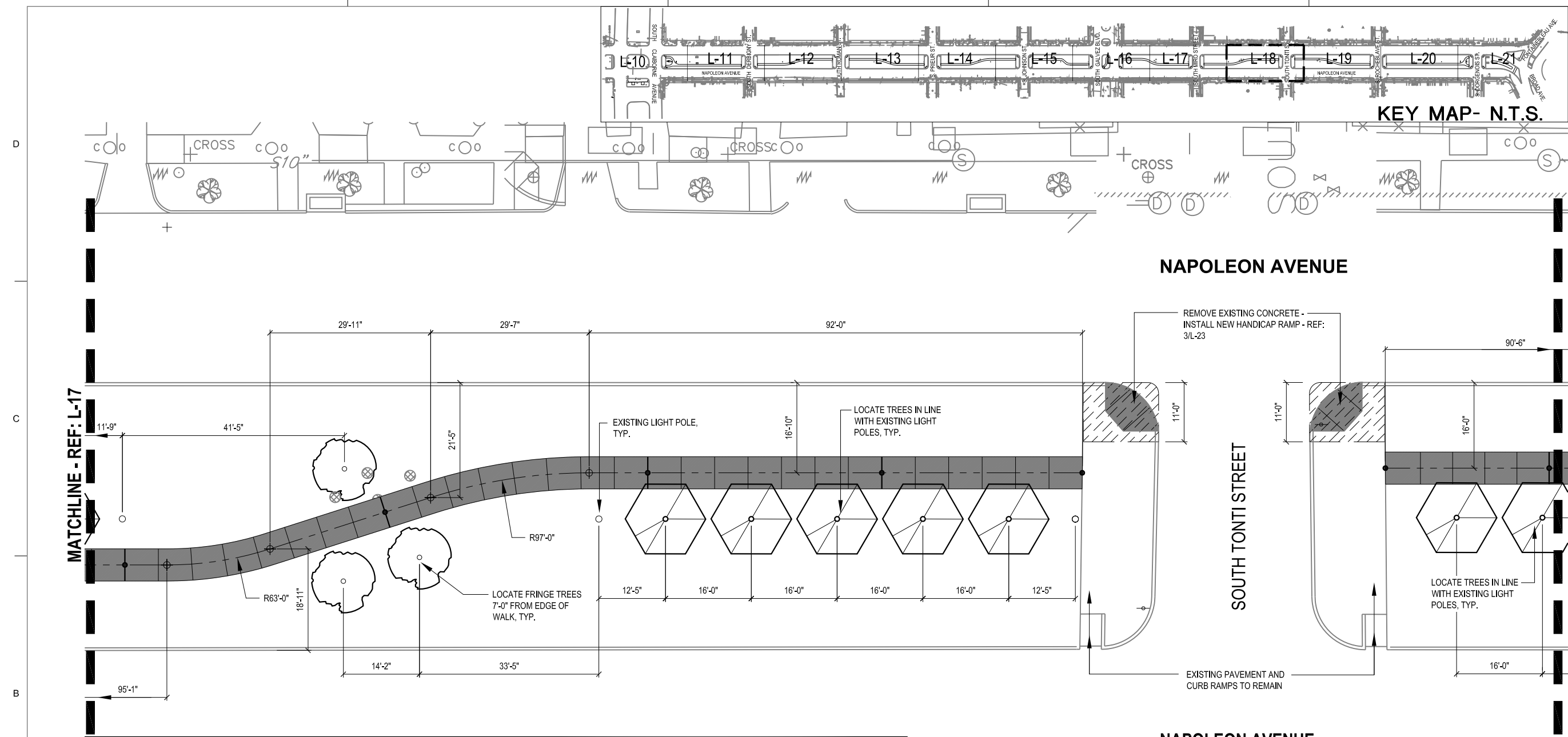

LEGEND - LAYOUT AND MATERIALS

- FRINGE TREE - REF: SHEET L-24
- CRAPE MYRTLE 'MUSKOGEE' - REF: SHEET L-24
- CONCRETE SIDEWALK - REF: DETAIL 1/L-22
- EXPANSION JOINT - REF: DETAIL 3/L-22
- CONTROL JOINT - REF: DETAIL 2/L-22
- EXISTING LIGHT POLE
- EXISTING CONCRETE AND CURB TO BE REMOVED
- CRAPE MYRTLE 'TUSKEGEE' - REF: SHEET L-24
- TANGENT POINT
- CENTERLINE OF WALK
- CENTERPOINT OF ARC
- EXISTING STOP SIGN - TO BE RE-LOCATED WHERE NEW RAMPS ARE INSTALLED- REF: 3/L-23

NOTE:
 1.) CONTRACTOR SHALL RENDER SITE TO MATCH EXISTING CONDITIONS INCLUDING ANY GRASS OR OTHER MATERIALS THAT ARE DISTURBED DURING CONSTRUCTION.
 2.) ALL MEASUREMENTS ARE TAKEN FROM THE FACE OF CURB, EXISTING LIGHT POLES, AND CENTERLINE OF PROPOSED WALK.

Draft

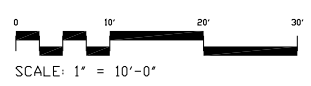

1 LAYOUT AND MATERIALS PLAN
PLAN

MARK	DESCRIPTION	DATE	APPR.

DESIGNED BY: CC/BA	CHECKED BY: BA	DATE: 08-17-2009
DRAWN BY: BA	SCALE: AS SHOWN	WORK PACKAGE NO.: 000
SUBMITTED BY: Bridget Adams	CONTRACT NO.: W912PE-09-2-0041	FILE NUMBER: H#-###
PLOT SCALE: 1" = 10'-0"	PLOT DATE: 11/02/2009	FILE NAME: Layout.dwg

U.S. ARMY CORPS OF ENGINEERS
NEW ORLEANS DISTRICT
NEW ORLEANS, LOUISIANA

SOUTH CLARBORNE AVE. & NAPOLEON AVE.
LANDSCAPE IMPROVEMENTS

LAYOUT AND MATERIALS PLAN

SHEET IDENTIFICATION
L-19

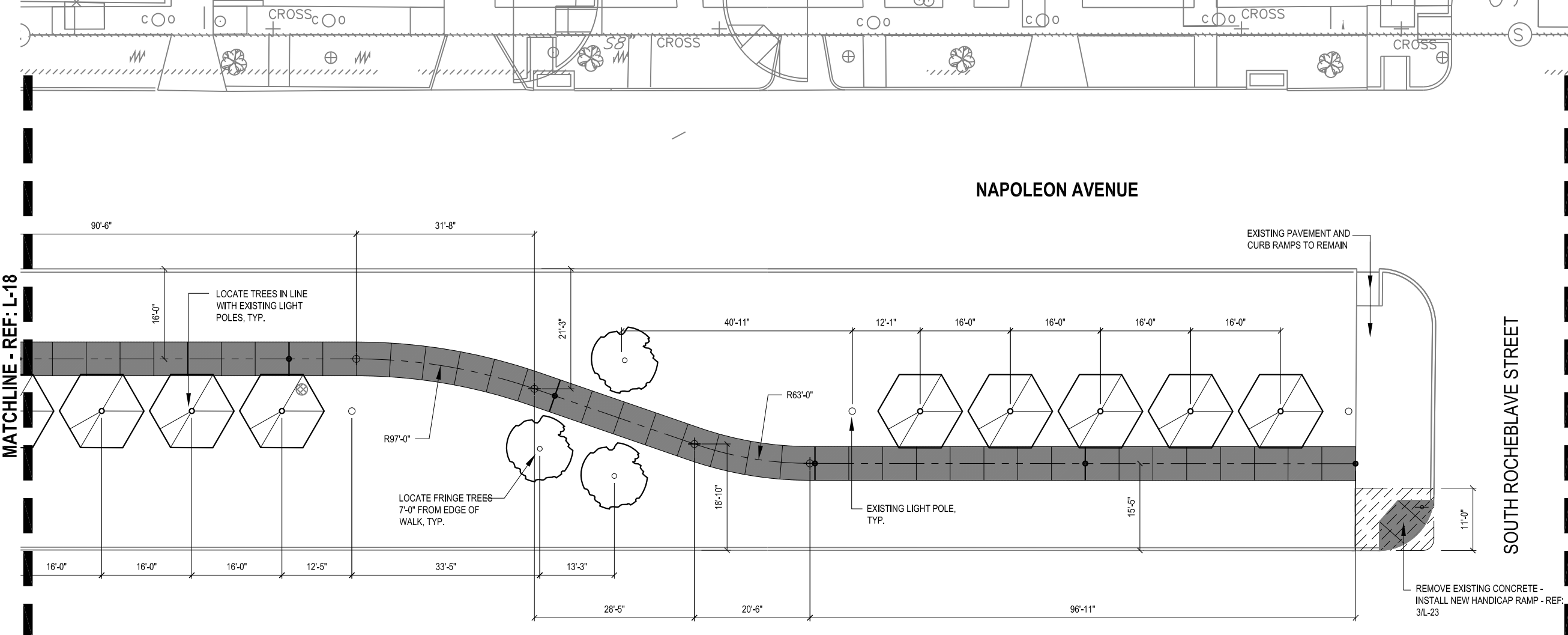
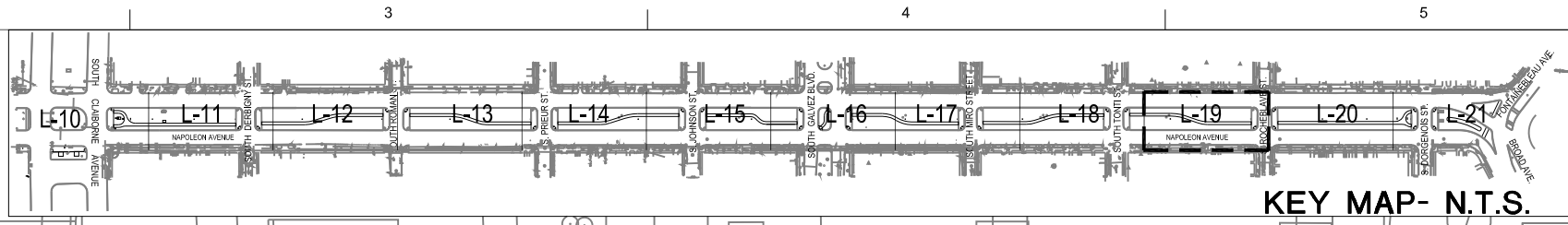

LEGEND - LAYOUT AND MATERIALS

- FRINGE TREE - REF: SHEET L-24
- CRAPE MYRTLE 'MUSKOGEE' - REF: SHEET L-24
- CONCRETE SIDEWALK - REF: DETAIL 1/L-22
- EXPANSION JOINT - REF: DETAIL 3/L-22
- CONTROL JOINT - REF: DETAIL 2/L-22
- EXISTING LIGHT POLE
- EXISTING CONCRETE AND CURB TO BE REMOVED
- CRAPE MYRTLE 'TUSKEGEE' - REF: SHEET L-24
- TANGENT POINT
- CENTERLINE OF WALK
- CENTERPOINT OF ARC
- EXISTING STOP SIGN - TO BE RE-LOCATED WHERE NEW RAMPS ARE INSTALLED - REF: 3/L-23

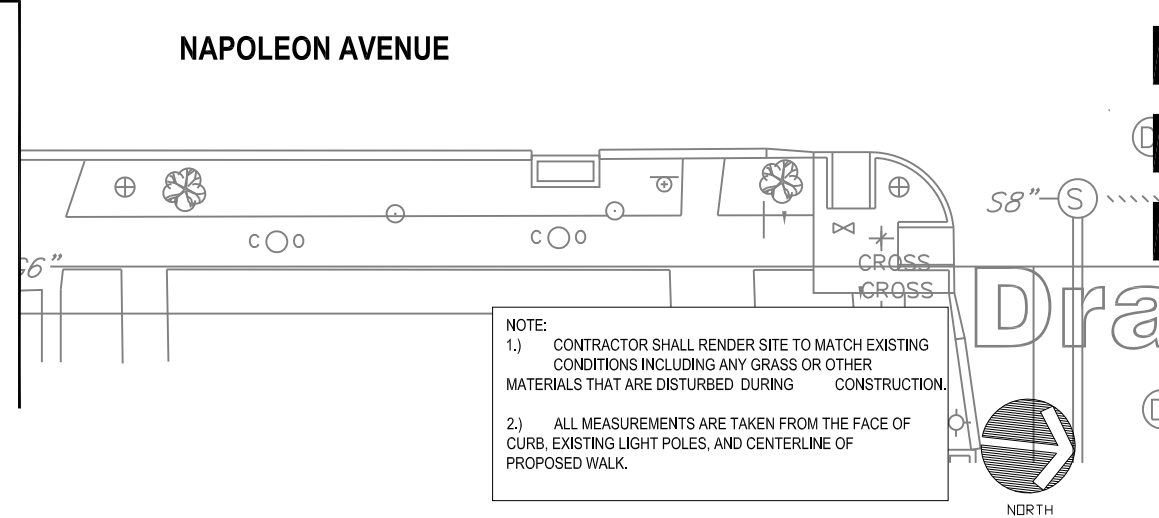

NOTE:
1.) CONTRACTOR SHALL RENDER SITE TO MATCH EXISTING CONDITIONS INCLUDING ANY GRASS OR OTHER MATERIALS THAT ARE DISTURBED DURING CONSTRUCTION.
2.) ALL MEASUREMENTS ARE TAKEN FROM THE FACE OF CURB, EXISTING LIGHT POLES, AND CENTERLINE OF PROPOSED WALK.

1 LAYOUT AND MATERIALS PLAN
PLAN

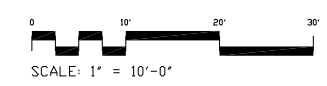

Draft

NORTH

MARK	DESCRIPTION	DATE	APPR. MARK	DATE	APPR.

DESIGNED BY: CC/CA/BA	DATE: 08-17-2009	ISSUED BY: JL	DATE: 11/24/09
CHECKED BY: JL	DATE: 11/24/09	CONTRACT NO.:	
APPROVED BY: 	DATE: 	FILE NUMBER:	

U.S. ARMY CORPS OF ENGINEERS
NEW ORLEANS DISTRICT
NEW ORLEANS, LOUISIANA

SOUTH CLARBORNE AVE. & NAPOLEON AVE.
LANDSCAPE IMPROVEMENTS

LAYOUT AND MATERIALS PLAN

SHEET IDENTIFICATION
L-20

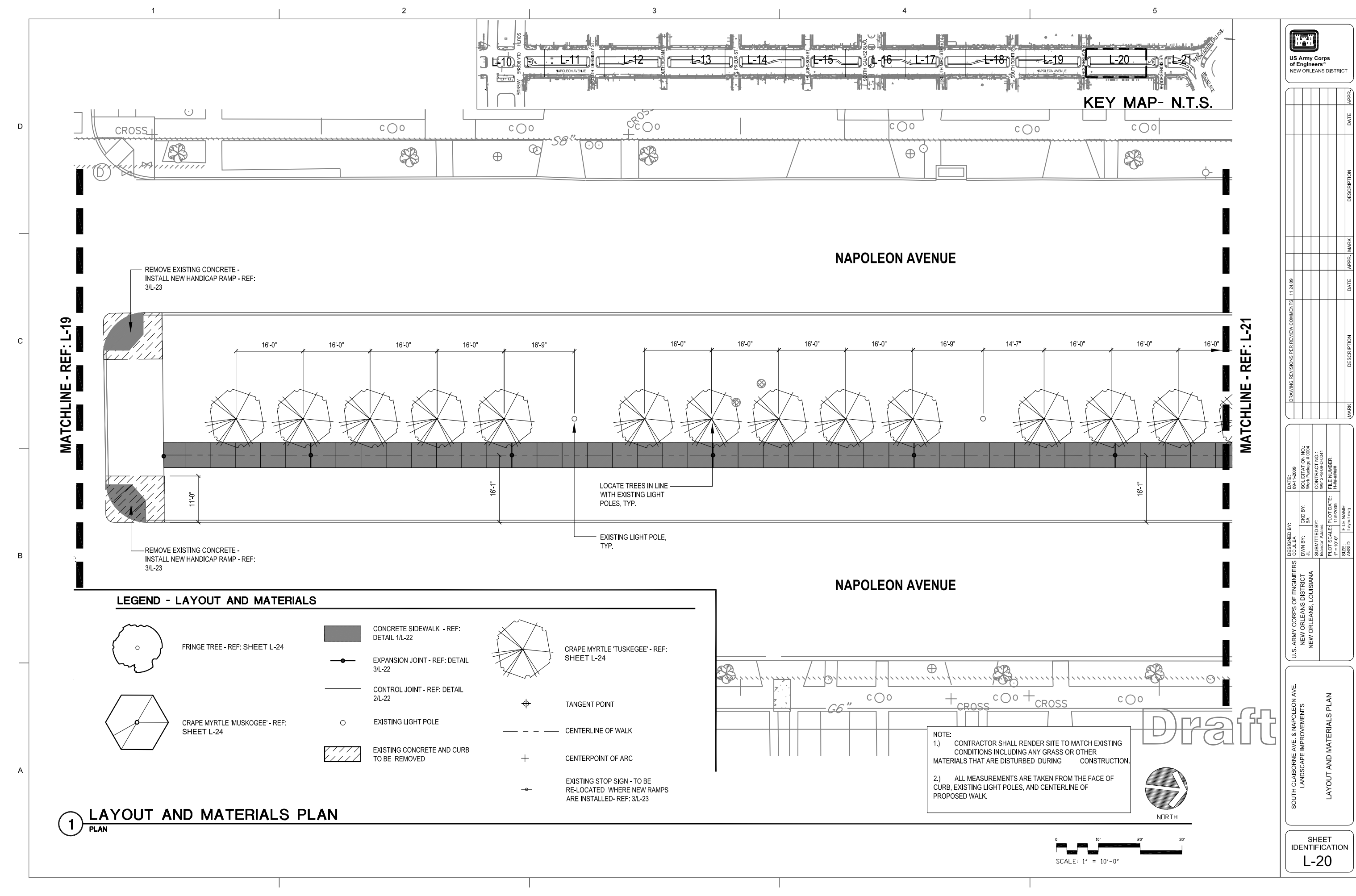

MATCHLINE - REF: L-19

MATCHLINE - REF: L-21

LEGEND - LAYOUT AND MATERIALS

- FRINGE TREE - REF: SHEET L-24
- CRAPE MYRTLE 'MUSKOGEE' - REF: SHEET L-24
- CONCRETE SIDEWALK - REF: DETAIL 1/L-22
- EXPANSION JOINT - REF: DETAIL 3/L-22
- CONTROL JOINT - REF: DETAIL 2/L-22
- EXISTING LIGHT POLE
- EXISTING CONCRETE AND CURB TO BE REMOVED
- CRAPE MYRTLE 'TUSKEGEE' - REF: SHEET L-24
- TANGENT POINT
- CENTERLINE OF WALK
- CENTERPOINT OF ARC
- EXISTING STOP SIGN - TO BE RE-LOCATED WHERE NEW RAMPS ARE INSTALLED- REF: 3/L-23

NOTE:
1.) CONTRACTOR SHALL RENDER SITE TO MATCH EXISTING CONDITIONS INCLUDING ANY GRASS OR OTHER MATERIALS THAT ARE DISTURBED DURING CONSTRUCTION.
2.) ALL MEASUREMENTS ARE TAKEN FROM THE FACE OF CURB, EXISTING LIGHT POLES, AND CENTERLINE OF PROPOSED WALK.

Draft

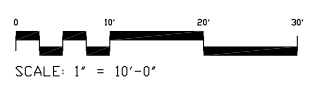

1 LAYOUT AND MATERIALS PLAN
PLAN

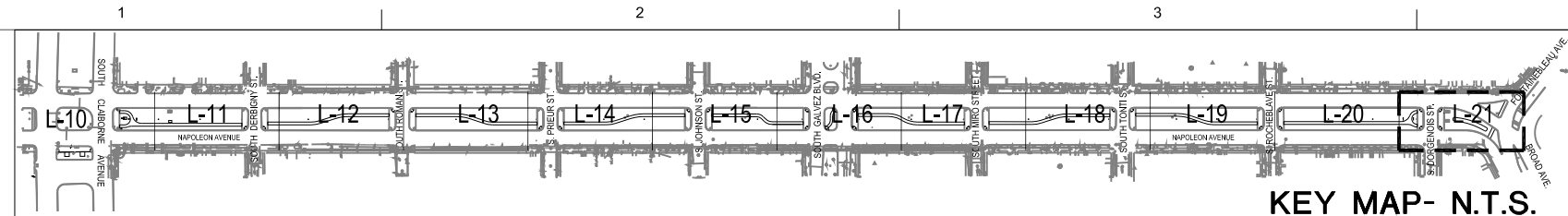

LEGEND - LAYOUT AND MATERIALS

- KNOCK OUT ROSE VARIETIES - REF:
- EXISTING CONCRETE AND CURB TO BE REMOVED
- EXISTING LIGHT POLE
- CRAPE MYRTLE 'TUSKEGEE' - REF: SHEET L-24
- CONCRETE SIDEWALK - REF: DETAIL 1/L-22
- FRINGE TREE - REF: SHEET L-24
- EXPANSION JOINT - REF: DETAIL 3/L-22
- CRAPE MYRTLE 'MUSKOGEE' - REF: SHEET L-24
- CONTROL JOINT - REF: DETAIL 2/L-22
- EXISTING RE-LOCATED NEIGHBORHOOD SIGN
- CENTERLINE OF WALK
- CENTERPOINT OF ARC
- TANGENT POINT
- EXISTING NEIGHBORHOOD SIGN
- EXISTING STOP SIGN - TO BE RE-LOCATED WHERE NEW RAMPS ARE INSTALLED- REF: 3/L-23

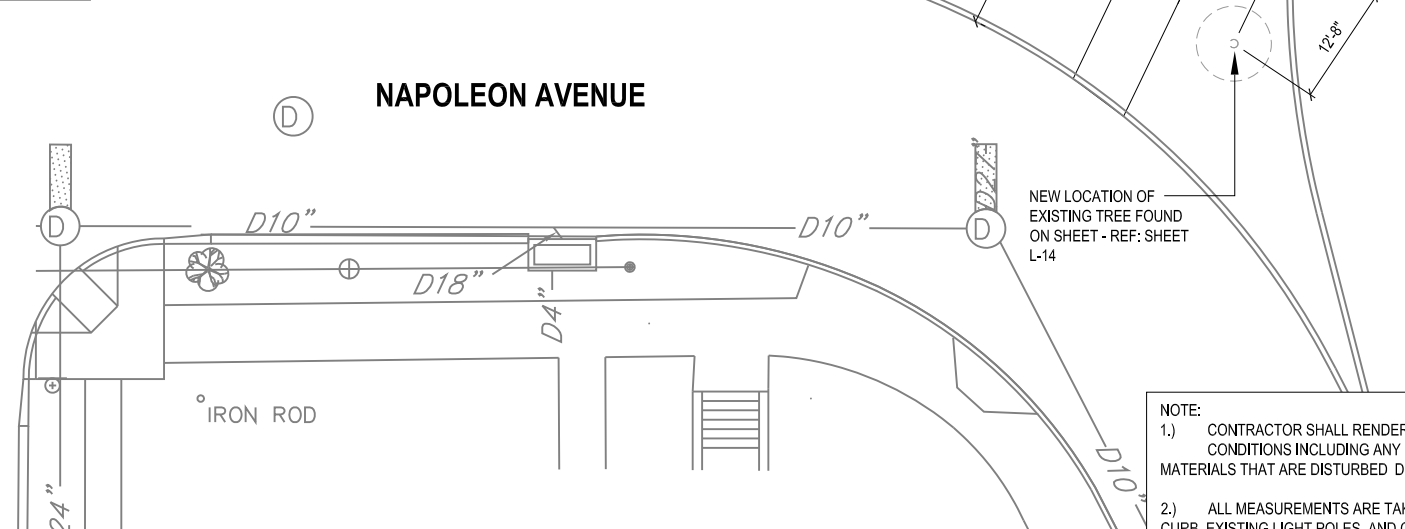
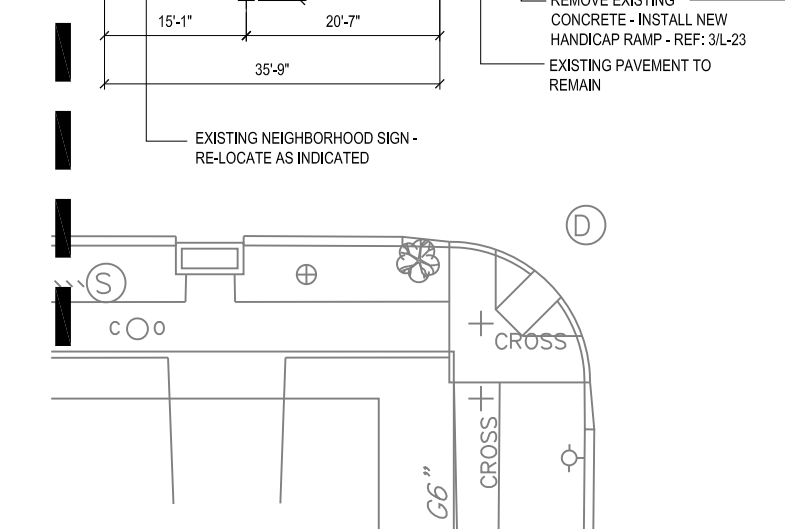
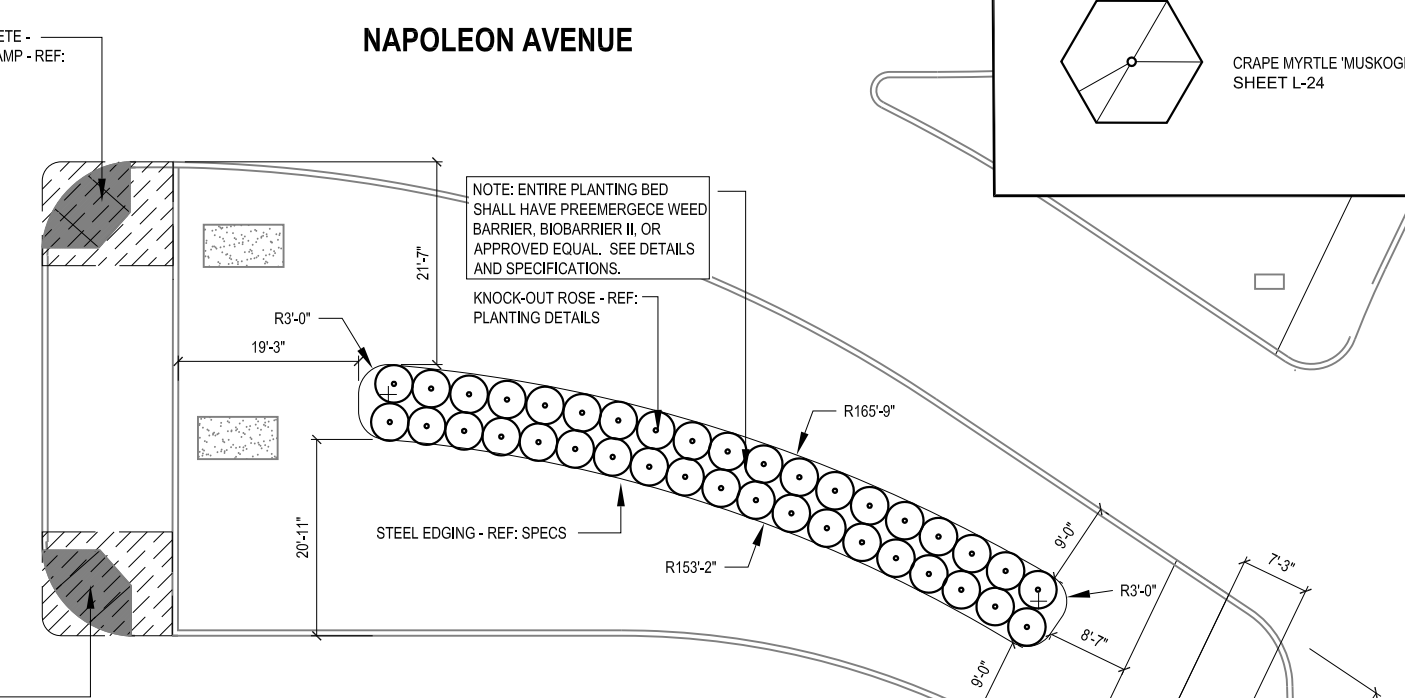
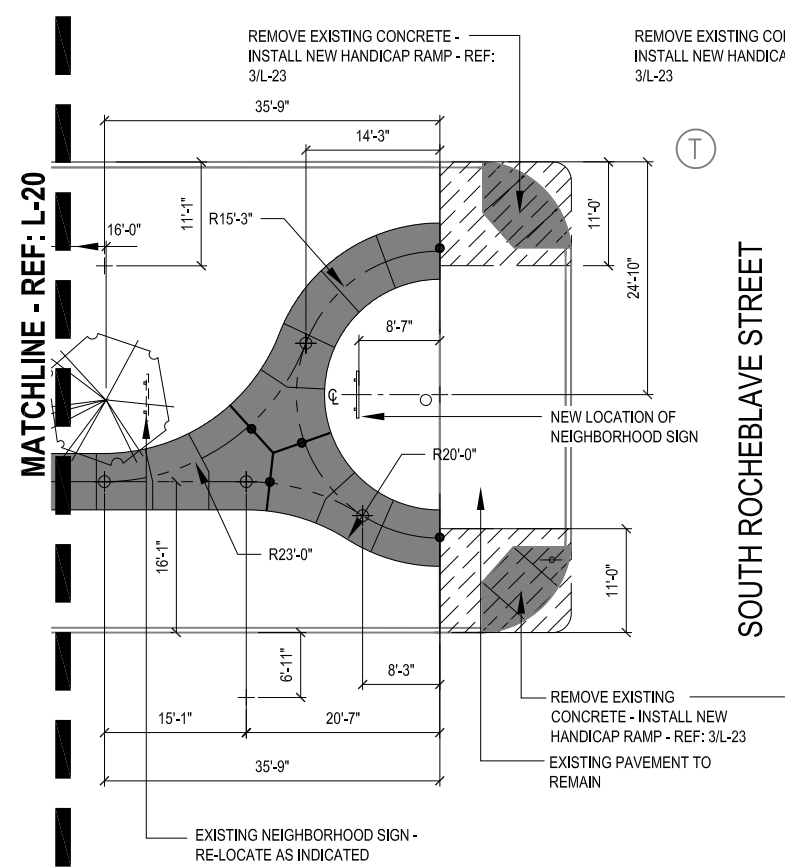

NOTE:
 1.) CONTRACTOR SHALL RENDER SITE TO MATCH EXISTING CONDITIONS INCLUDING ANY GRASS OR OTHER MATERIALS THAT ARE DISTURBED DURING CONSTRUCTION.
 2.) ALL MEASUREMENTS ARE TAKEN FROM THE FACE OF CURB, EXISTING LIGHT POLES, AND CENTERLINE OF PROPOSED WALK.

1 LAYOUT AND MATERIALS PLAN

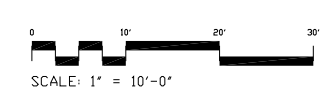

Draft

U.S. Army Corps of Engineers
NEW ORLEANS DISTRICT

DATE	DESCRIPTION	APPR.	DATE	APPR.
11.24.09	DRAWING REVISIONS PER REVIEW COMMENTS			

DESIGNED BY: CC/CL/BA	CHECKED BY: JL	DATE: 08-17-2009
DRAWN BY: JL	SCALE: AS SHOWN	WORK PLAN NO.: 1000
SUBMITTED BY: Bryan Adams	CONTRACT NO.: W9127P-09-2-0041	FILE NUMBER: H#-####
PLOT SCALE: 1" = 10'-0"	PLOT DATE: 11/09/2009	FILE NAME: Layout.dwg

U.S. ARMY CORPS OF ENGINEERS
NEW ORLEANS DISTRICT
NEW ORLEANS, LOUISIANA

SOUTH CLAIBORNE AVE. & NAPOLEON AVE.
LANDSCAPE IMPROVEMENTS

LAYOUT AND MATERIALS PLAN

SHEET IDENTIFICATION
L-21