

# YOUTH SERVICES CENTER

COUNTY OF EL PASO

Project Status: Under Construction



SOUTH VIEW

## Performance Design Elements

### Passive Climatic Concepts:

- \* Building Orientation and Openings
- \* Windows Orientation and Size
- \* Awnings For Openings Protection
- \* Day-lighting Strategies Using Radiance™
- \* Cool Roof
- \* Low Flow Plumbing Fixtures
- \* Waterless Urinals
- \* High Performance Envelope
- \* Water Harvesting Green Spaces
- \* Drought Tolerant Landscaping
- \* Low Flow Irrigation

### Active Systems:

- \* High Efficiency HVAC Using Hourly Analysis Program
- \* High Efficiency Lighting & Controls With Daylight System
- \* Building Automation System
- \* Solar Water Heating System

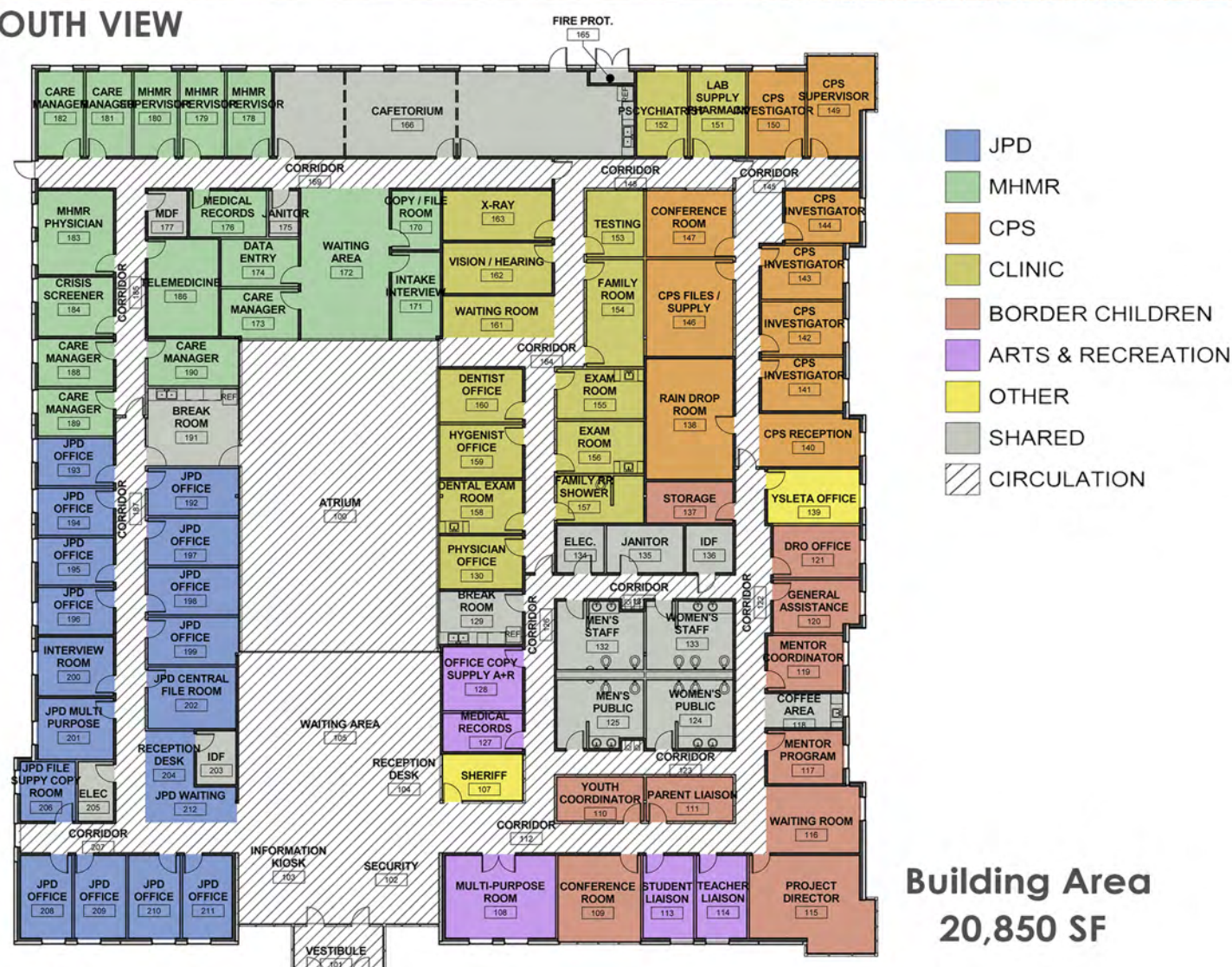

Building Area  
20,850 SF



DESIGNED  
TO EARN THE  
ENERGY STAR

The estimated energy performance for this design meets US EPA criteria. The building will be eligible for ENERGY STAR after maintaining superior performance for one year.

## DESIGN ENERGY RESULTS Energy (Estimates)

Source Energy Use Intensity (kBtu/sqft/yr)	122
Percent Energy Reduction(%)	43
ENERGY STAR Design Rating (1-100)	88
Site Energy Use Intensity (kBtu/sf/yr)	36
Total Annual Site Energy Use (kBtu/yr)	758,519
Total Annual Source Energy Use (kBtu/yr)	2,533,453
Total Annual Energy Costs (\$)	\$22,384
POLLUTION EMISSIONS (metric tons/yr) CO2-eq	127

## ANNUAL SAVINGS STATISTICS

(compared to an average building EPA rating of 50)

- \*Energy saving
- \*CO2 Savings

1,916,341 kBtu  
96 Metric Tons

## Design Team:

Wright & Dalbin Architects  
Spencer & Associates  
EMC Engineers  
H.K.Ng Consulting Engineers  
Lisa McNelis Landscape



INDOOR ATRIUM



NORTHEAST CORNER