



AFRH - Washington

Rooms to THRIVE



Connected single rooms are available for eligible couples.

Our Washington community offers you many activities and wide-open spaces to explore. Yet, sometimes, we all wish to retire to the privacy of our own space. At AFRH-W, you'll enjoy your own private room with heat and air conditioning, plus a private shower and walk-in closet.

Supplied Amenities:

- > A comfortable single bed, desk, chair & reading lamp
- > Cable TV & personal phone lines; services are at your expense

Resident Rules:

- > All new residents will reside in Independent Living rooms
- > You must keep your room sanitary & presentable always
- > AFRH is a non-smoking facility. However, smoking is permitted in designated outdoor areas



Washington Apartments:

- > Available to new residents
- > Approx. room size: 180 sq. ft.
- > Bring your TV & Microwave

Directions to THRIVE

From Maryland & Parts North/West:

- > Take I-495 - Capital Beltway
- > Exit 31 - Silver Spring
- > Stay on Georgia Ave. in Silver Spring
- > Pass Walter Reed Army Medical Center
- > Turn LEFT on Upshur St. - between 4200 & 4300 block
- > Cross Rock Creek Church Rd. & enter AFRH Main "Eagle Gate"
- > Check in with Security (140 Rock Creek Church Rd.)

From Virginia & Points South:

- > Take I-395 North
- > Interstate ends at New York Ave.
- > Turn RIGHT on New York Ave.
- > Go 2 Blocks, veer RIGHT onto M St. (at sign: "N. Capitol St.")
- > Go to 2nd Stoplight and turn LEFT onto N. Capitol St. NW
- > Continue on N. Capitol for about 1.5 miles
- > Pass the Home & Sign: "Armed Forces Retirement Home" (on left)
- > Go down Hill, make LEFT onto Allison St. NE
- > Go 1 short block - turn LEFT onto Rock Creek Church Rd. NW
- > Go uphill .25 mi. to Upshur St.
- > Turn LEFT into AFRH at the "Eagle Gate"
- > Check in with Security (140 Rock Creek Church Rd.)

AFRH-W is inside the Capital Beltway (I-495) in NW DC.

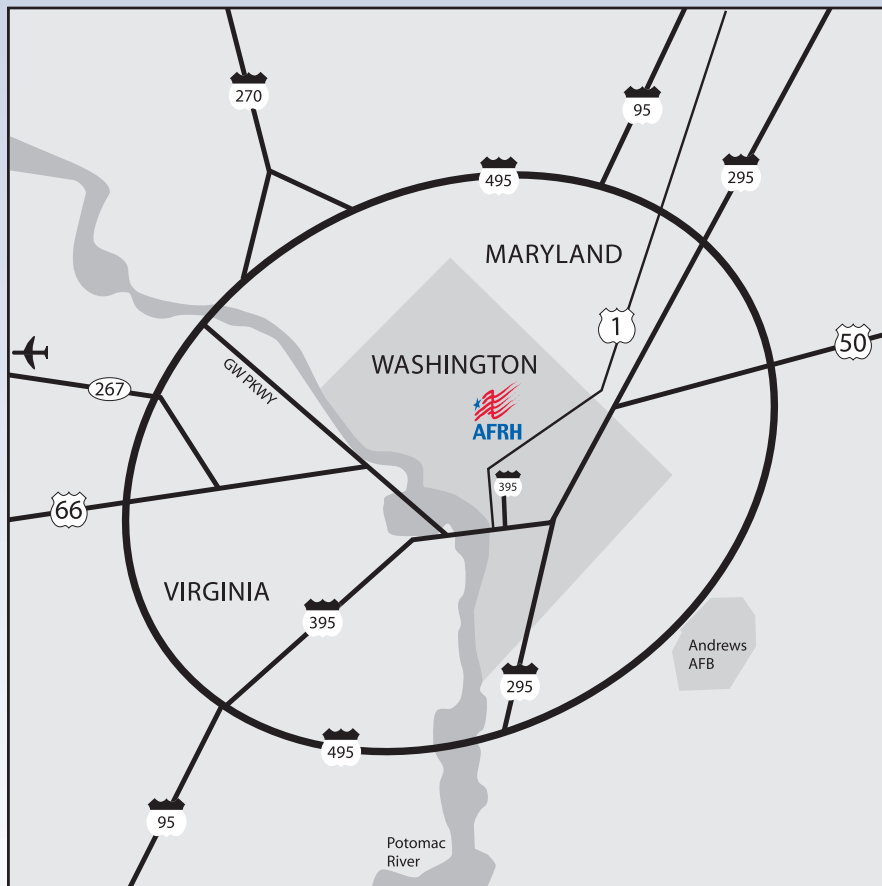

Our veterans proudly display medals, war memorabilia and cherished photos.

From Annapolis & Points East:

- > Take State Rt. 50 West - which becomes New York Ave. in DC
- > Take the S. Dakota exit
- > Cont. on S. Dakota
- > Make a LEFT onto Taylor
- > Turn RIGHT onto N. Capitol St. NW
- > Continue on N. Capitol for about 1.5 miles
- > Pass the Home & Sign: "Armed Forces Retirement Home" (on left)
- > Go down Hill, make LEFT onto Allison St. NE
- > Go 1 short block - turn LEFT onto Rock Creek Church Rd. NW
- > Go uphill .25 mi. to Upshur St.
- > Turn LEFT into AFRH at the "Eagle Gate"
- > Check in with Security (140 Rock Creek Church Rd.)



Our historic home is the site of President Lincoln's Cottage.

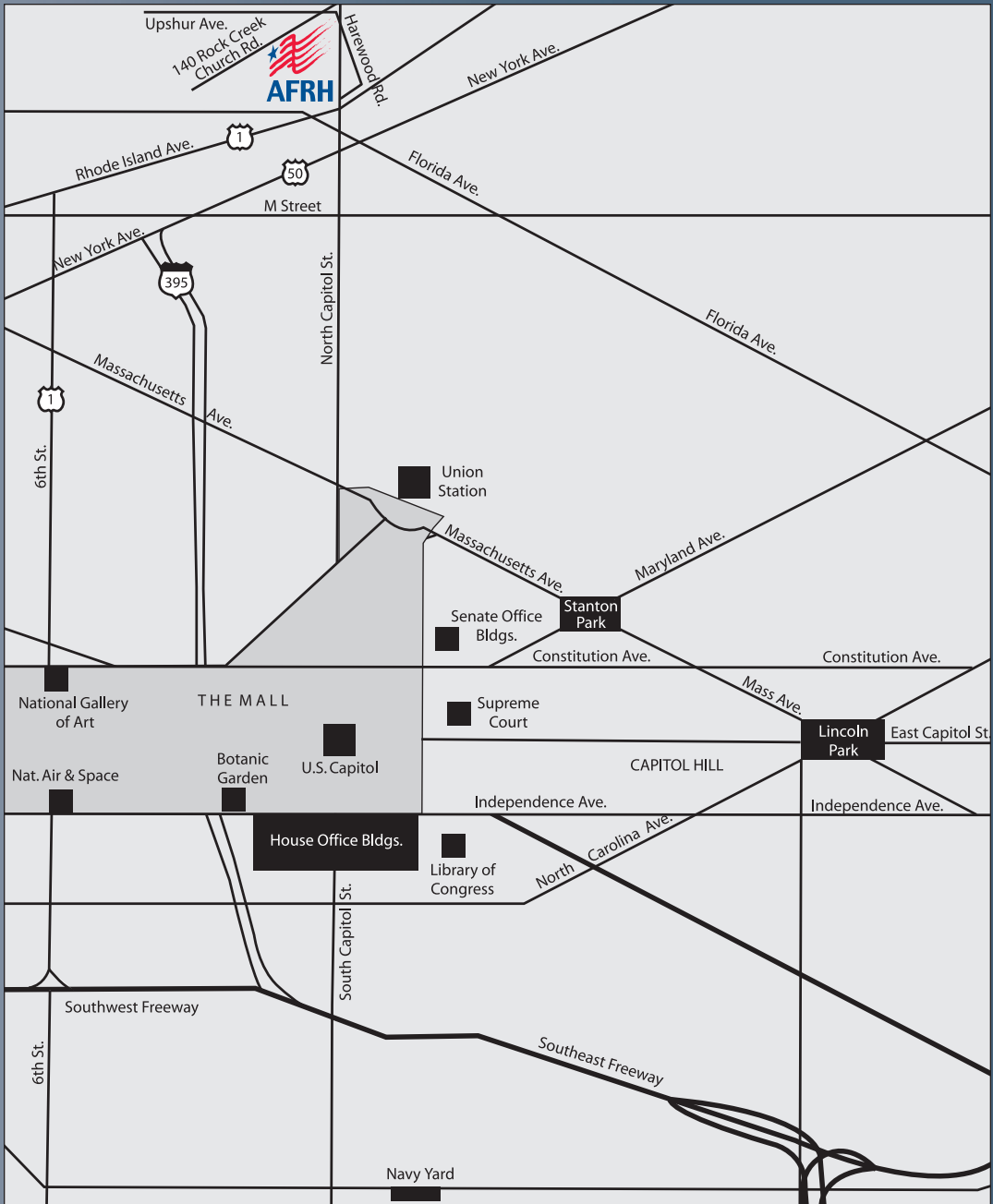

*We're located
on N. Capitol St.
37 blocks North
of the US Capitol*

From Elsewhere

Review a map or visit a map application on the Internet for specific directions from a unique location. Or call us at 800.422.9988 and we'll personally help you. Have a safe journey and we look forward to meeting you.



PAO #1305
3700 N. Capitol Street, NW
Washington, DC 20011
ATT: Public Affairs

Email: public.affairs@afrh.gov
 Phone: 800.422.9988
 Fax: 202.541.7519





AFRH - Gulfport

Rooms to THRIVE



"Couples suites" are available for eligible residents.

Our Gulfport community offers you many amenities and sandy beaches for relaxation. Yet, sometimes, we all wish to retire to the privacy of our own space. At AFRH-G, you'll enjoy a spacious private room with heat and air conditioning, plus a private shower and closet.

Supplied Amenities:

- > A comfortable double bed, table, 2 kitchenette chairs & reading lamp
- > Cable TV & personal phone lines; services are at your expense
- > Wireless Internet is available in community areas

Resident Rules:

- > All new residents will reside in Independent Living rooms
- > You must keep your room sanitary & presentable always
- > AFRH is a non-smoking facility. However, smoking is permitted in designated outdoor areas

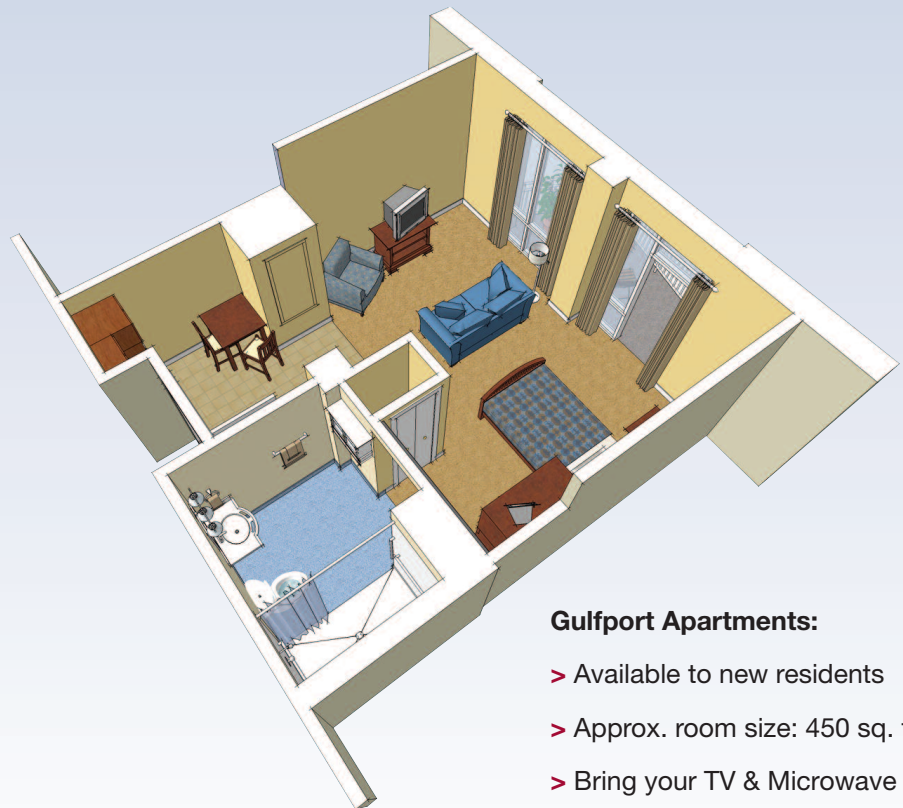

Gulfport Apartments:

- > Available to new residents
- > Approx. room size: 450 sq. ft.
- > Bring your TV & Microwave

Directions to THRIVE

From Gulfport-Biloxi Airport:

- > Head East on Airport Rd. (.1 mi.)
- > Make a U-turn on Airport Rd. heading NW (1.2 mi.)
- > Turn LEFT onto US-49 South (3.8 mi.)
- > Turn LEFT onto US-90 E / E Beach Blvd. (4.4 mi.)
- > Turn slight LEFT onto Beach Dr. (.4 mi.)
- > AFRH-G, 1800 Beach Dr., is on your Left

From New Orleans & parts West:

- > Take I-10 toward Slidell & Mississippi (71.8 mi)
- > Take Exit 34A to merge onto US-49 to Gulfport (4.9 mi.).
- > Turn LEFT onto US-90 E / E Beach Blvd. (4.4 mi.)
- > Turn slight LEFT onto Beach Dr. (.4 mi.)
- > AFRH-G, 1800 Beach Dr., is on your Left



From Mobile & parts East:

- > Take I-10 to Pascagoula & Mississippi (57 mi.)
- > Take Exit 46A to I-110 S / MS-15 S (on Left) to Biloxi / Keesler AFB (4.5 mi.)
- > Take Exit 1B to US-90 W / Beach Blvd. to Keesler AFB (8.1 mi.)
- > Turn RIGHT onto Beach Dr. (.3 mi.)
- > AFRH-G, 1800 Beach Dr., is on your Right

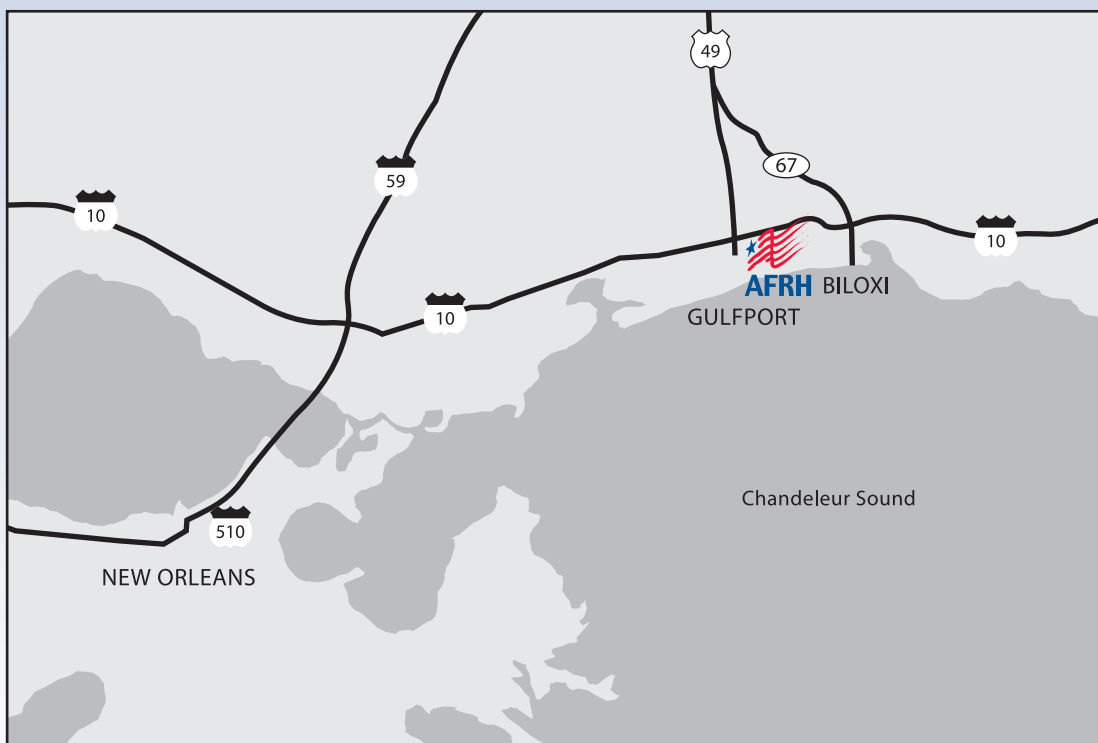

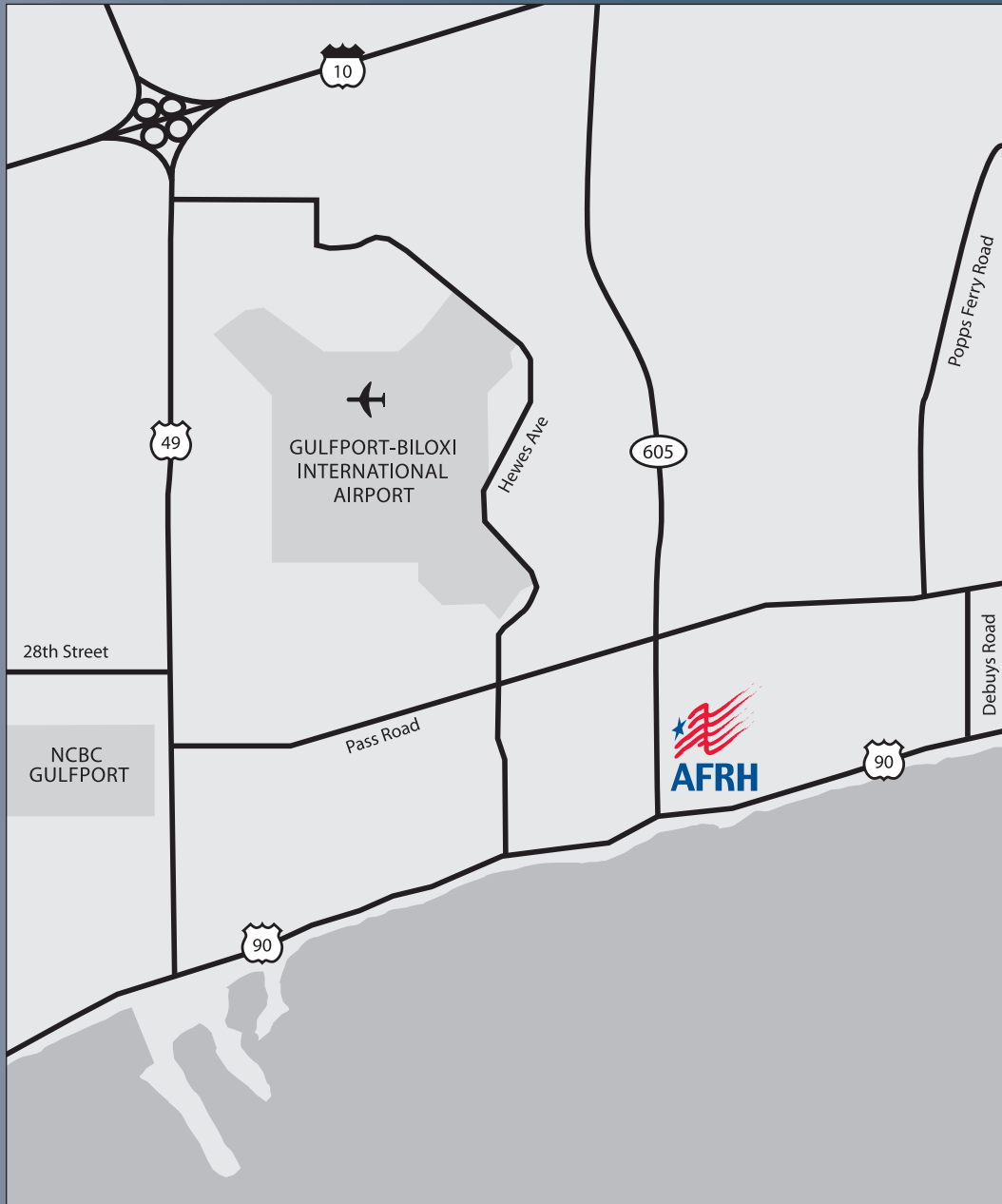

*We're just off
Beach Drive,
100 yards from
the Gulf.*

From Elsewhere

Review a map or visit a map application on the Internet for specific directions from a unique location. Or call us at 800.422.9988 and we'll personally help you. Have a safe journey and we look forward to meeting you.



The Premier Retirement Community for America's Veterans

PAO #1305
3700 N. Capitol Street, NW
Washington, DC 20011
ATT: Public Affairs

Email: public.affairs@afrh.gov
 Phone: 800.422.9988
 Fax: 202.541.7519

