



▶ MARKET UPDATE.....1

▶ ACCOMPLISHMENTS... ..2

▶ SPOTLIGHT3

▶ WRAP UP..... 4

Clinical BRAC Monthly Update

April 2010

The CBRAC Monthly Leadership Update provides news and information on the progress of the Clinical BRAC Program. The market updates for the **National Capital Region (NCR)**, **San Antonio Military Medical Center (SAMMC)** and **Medical Command Headquarters Collocation (Business Plan 198)** components are below.

National Capital Region (NCR)

The construction of Building A (Ambulatory Care) and Building B (Inpatient Care) at the future WRNMMC Bethesda continues to progress on schedule. The completion percentages are: Building A 86%, Building B 88%, Patient Parking Garage 99%, Central Utility Plant 80% and Building 17 4%. The NICoE Utilities reached 100% completion in April 2010 and the Contractor has demobilized.

Construction of the new Ft. Belvoir Community Hospital is 60% complete, and continues on all eight buildings. On the main hospital (building C), the Oaks Pavilion, structural slabs and topping are complete.

San Antonio (SAT)

Throughout April 2010, construction activities at the SAMMC North Campus (SAMMC-N) continued. **On 12 Apr 10, Brook Army Medical Center ((BAMC) Renovation Package F was ready to advertise. On 19 Apr 10, construction on BAMC Packages D & E began.** Construction on the Fort Sam Houston (FSH) Primary Health Clinic (PHC) continued and is on track to meet the beneficial occupancy date (BOD) of 12 May 10.

Twelve intra-facility transition moves were completed in April 2010 including Pediatric Endoscopy, Oncology and Inpatient Wards; Pulmonary, Medical Maintenance and Womens Health Clinic.

Medical Command Headquarters Collocation (BP 198)

The lease procurement is underway with General Services Administration (GSA) to select a site for the Medical Command Headquarters (MCHQ). The lease facility will collocate personnel from TRICARE Management Activity and the three Service Medical Departments to a single site in Northern Virginia within 4 miles driving distance of an existing Metrorail station. More information will be publicly available once the lease is awarded.



Milestones and Accomplishments

Site	APRIL 2010	MAY 2010	JUNE 2010
Financial Management	22 APR FBCH Dental Cost Saving Congressional Notifications 22 APR WHMC Pull Back Congressional Notifications	4 MAY NCR Mid-Year Review 11-13 SAT SAT Mid-Year Review	MAY 2010 FBCH/SAMMC-N Congressional Notifications JUN 2010 DFAS review with PPMD
NCR	6 APR 10 NCR MCM	4 MAY 10 NCR MCM	1 JUN 10 NCR MCM
Ft. Belvoir	APR 2010 Bldg A: Start Commissioning	MAY 2010 S Garage: Elevators Complete MAY 2010 S Garage: Striping/Sign (Controls) Start MAY 2010 Bldg A: Exterior Skin Complete MAY 2010 Bldg A: Conditioned Air MAY 2010 Bldg A: Start Formal Punchlist	MAY 2010 Bldg C: Start Doors & Hardware MAY 2010 Bldg B: Conditioned Air MAY 2010 Bldg E: Exterior Skin Complete MAY 2010 Bldg E: Start Floor Finishes MAY 2010 N Garage: Elevator Complete MAY 2010 Move Naval Med Research Ctr to Ft. Detrick JUN 2010 First Clinic Available for Start of Transition JUN 2010 S Garage: Start Formal Punchlist JUN 2010 Bldg E: Conditioned Air
Walter Reed		4 MAY 10 Award Multi-Use Parking Structure Project 6 MAY 10 Award Main OR Project	27 JUN 10 Phase 1a Lab/Penthouse Complete 24 JUN 10 Phase 1 Radiology/Cardiology Complete 24 JUN 10 NICoE Ribbon Cutting Ceremony
Bethesda	15 APR 10 Begin dismantle of Building 155	MAY 2010 100% Design Complete for Building 62 MAY 2010 100% Design Complete for Building 17	
SAT	27 APR 2010 SAT MCM	May 2010 FY10 Financial Mid-Year Review	27 JUN 10 SAT MCM
SAMMC-North	APR 2010 Thirteen (13) Intra-facility transition moves 12 APR 10 BAMC Reno Pkg F Ready to Advertise 27 APR 10 BAMC Reno Pkg D Construction Start	MAY 2010 Seven (7) Intra-facility transition moves 12 MAY 10 FSH Clinic Construction End	JUN 2010 Five (5) Intra-facility transition moves
SAMMC-South			
BP 171 & 173			
BP 198	APR 2010 GSA Continues Lease Procurement Activities 28 APR 10 I-Team Meeting	MAY 2010 GSA Continues Lease Procurement Activities MAY 2010 I-Team Meeting	JUN 2010 GSA Continues Lease Procurement Activities

LEGEND: Communications Milestone (green diamond), Design/Construction Milestone (yellow diamond), Transition Milestone (orange diamond), Financial Management Milestone (grey diamond), Decision Making Milestone (black diamond), Medical Command HQs Planning Milestone (blue diamond), Medical Command HQs I-Team Milestone (red diamond)

National Naval Medical Center, 14 Apr 10



Consolidated Tower, 28 Apr 10



National Capital Region (NCR)

- WRNMMC: Preliminary punchwork complete for Building A Levels 2 and 3. Pre-final punchwork complete in Building B Basement.
- WRNMMC: The Department of Behavioral Health began its transition this month.
- FBCH: Commissioning of the River clinic (building A) began on 16 Apr 10.

San Antonio (SAT)

- The Pediatric Ward and Pediatric Intensive Care Unit moved to Brooke Army Medical Center, the first of all inpatient care moving from Wilford Hall.
- The Fort Sam Houston Community Development Office opened to help citizens and businesses connect with opportunities from BRAC in San Antonio.
- In April 2010, twelve transitional moves were completed and an additional seven moves are scheduled for May 2010.

Medical Command Headquarters Collocation (BP 198)

- The Senate Committee on Environment and Public Works adopted a resolution to approve the BP 198 lease prospectus. Economic Development, Public Buildings and Emergency Management has not been scheduled at this time.
- The review of the lease prospectus by the House Committee on Transportation and Infrastructure and Subcommittee on Congressional approval of the lease prospectus is required before a lease may be awarded.

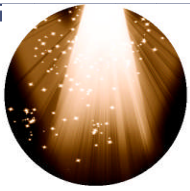

Spotlight and Major Event

Spotlight: Andrea Docos, Project Manager, NAVFAC

Andrea Docos grew up in Vienna, Va and graduated from James Madison University in 2007. She has been with Naval Facilities Engineering Command (NAVFAC) since September 2008. She started as a development intern with NAVFAC MIDLANT in Norfolk, Va., working in interior design. In May 2009, she came to Bethesda, Md., as an intern working with interior design. By late December 2009, Andrea was made a renovations project manager for 49,000 square feet of hospital renovation where she coordinates construction between the hospital and the contractor.



As a project manager, Andrea addresses technical aspects of the BRAC design-build construction contract to establish the Walter Reed National Military Medical Center at Bethesda, MD. She answers contractor requests for information, assigns invoice reviews, attends meetings with the contractor and users, reviews construction submittals for approval or disapproval. Andrea ensures submittals are reviewed according to schedule and notifies the contractor of any delays during the review period, making certain the construction schedule is being met. When problems arise, she analyzes and assesses, collaborates with engineering technicians to review, and implements solutions. She coordinates with the hospital to minimize the impact of construction on its operations. For example, in the medical surgery renovation, a project she also manages, the construction was creating too much noise, which disturbed warriors returned from war zones. She incorporated a solution amendable to the contractor that reduced sound and minimized impact to the hospital.

Major Event: WHMC Inpatient Services begin shift to BAMC with Pediatrics

After years of planning, the first of many inpatient wards has successfully moved to Brooke Army Medical Center (BAMC) from Wilford Hall Medical Center (WHMC). This movement is a major milestone in the implementation of the BRAC law that requires the relocation of all inpatient services from WHMC to BAMC before Sept 15, 2011. A total of about 150 nurses, technicians, staff and residents made the move from WHMC to BAMC's fully renovated Pediatrics wing on the 5th floor. "Everybody from every corner of the hospital has [worked] really hard to make this come together," said Col. (Dr.) Mary Pelszynski, Commander, 59th Maternal/Child Care Squadron.

The Pediatric Ward is staffed for 16 pediatric patients and the Pediatric Intensive Care Unit is staffed for six patients. Inpatient pediatrics at BAMC also has a dedicated pediatric sedation unit so that procedures requiring intravenous sedation can be performed and recovered in this area.

Major Event courtesy of SAMBIO



SAMBIO Project Integrators, Teresa Gates and Sandra Witthauer, apply finishing touches to a patient room in the renovated PICU.



BRAC in The News

San Antonio Express News: *Three military installations become one, 27 Apr 10*

The Air Force took over Fort Sam Houston on Monday, and it didn't have to drop a bomb or fire a shot. But then, it wasn't that kind of a takeover, and in fact was celebrated as a new era of cooperation among rival services, right down to the joint Army-Air Force band that played before a crowd of 300 on MacArthur Parade Field....The Air Force will run Fort Sam's logistical services. The support group's parent organization, the 502nd Air Base Wing, already oversees logistics at Randolph and Lackland AFBs. "Think about the power, the power in what we can do for our nation from right here," Air Force Brig. Gen. Len Patrick, commander of the wing, also called Joint Base San Antonio, told the crowd.

"We are training combat medics and deploying forward, and saving lives on the battlefield," he said. "We're teaching pilots how to be instructor pilots. Every young man and woman who comes into the United States Air Force marches across the parade field at Lackland AFB." As ordered by the 2005 Defense Base Closure and Realignment Commission law, Joint Base San Antonio will handle logistics at Fort Sam, Lackland and Randolph....Joint Base San Antonio will funnel \$850 million a year in goods, services and salaries into the three installations.

USA Today: *Troops care facility listed as critical, 26 Apr 10*

WASHINGTON — The Pentagon effort to consolidate two premier hospitals for treating wounded troops has more than doubled in price and is so rudderless that an independent review and a bipartisan group of legislators say the care could suffer. The cost of closing Walter Reed Army Medical Center, replacing it with a larger complex at the National Naval Medical Center in Bethesda, Md., and building a hospital at Fort Belvoir, VA has risen from \$1 billion to \$2.6 billion, Pentagon records show.

Correcting the problems raised by Congress will cost another \$781 million, according to a Pentagon report released Monday. And improvements must wait until after the new Bethesda facility — named the Walter Reed National Military Medical Center — is finished in September 2011, the report says.

WMAR/ABC2-TV (Baltimore): *Budget woes in Maryland may shortchange preparations for BRAC, 23 Apr 10*

[Fort Meade] faces its own challenge. "We're bring in roughly about 5,600 new employees hopefully when the BRAC deadline comes up in October, 2011... and as you saw today, there's a lot of construction going on to prepare for that," said Base Public Affairs Director Chad Jones...The country's new Defense Information Systems Agency will occupy five buildings..and workers worked at break-neck speed to construct it in such a short time frame. That's why Anne Arundel County Executive John Leopold is so frustrated that road improvements in preparation for as many as 25,000 new families arriving here are falling behind."

San Antonio Express News: *Military medicine's future now in S.A., 17 Apr 10*

When the Medical Education & Training Campus starts its first class at Fort Sam Houston this summer, it will be the largest facility of its kind in the world. Close to 50,000 students a year from the Army, Air Force and Navy will graduate from the campus and Army Medical Department Center and School. But the \$940 million campus is more than that...It's also five medical instructional facilities and six dormitories, each to be home to 1,200 soldiers, sailors and airmen... METC was created by the 2005 Defense Base Closure and Realignment Commission, or BRAC.

Building for the Future

The pictures below represent the future facilities (from left to right) of the **San Antonio Military Medical Center North (SAMMC-N) Consolidated Tower (CoTo)**, the **Ft. Belvoir Community Hospital (FBCH)** and the **Walter Reed National Military Medical Center (WRNMMC)**. Once completed, these medical facilities will provide leading, world class healthcare to all service members and their families.

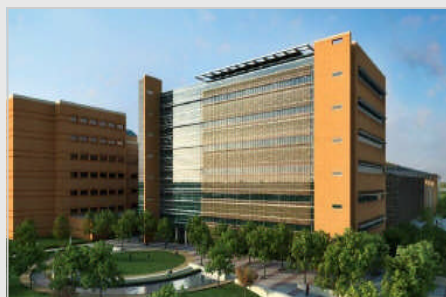

External Links Disclaimer - The appearance of hyperlinks to external sites does not constitute endorsement by TMA of the linked web site or the information, products or services contained therein. For other than authorized activities such as military exchanges and Morale, Welfare and Recreation sites, TMA does not exercise any editorial control over the information you may find at these locations.

Such links are provided consistent with the stated purpose of this edition of the Clinical BRAC Newsletter.