

TYPICAL ALLEY RETURN

NOTE: Curb and gutter, fillets and slab to be poured together.

Height of curb at this point is 6".

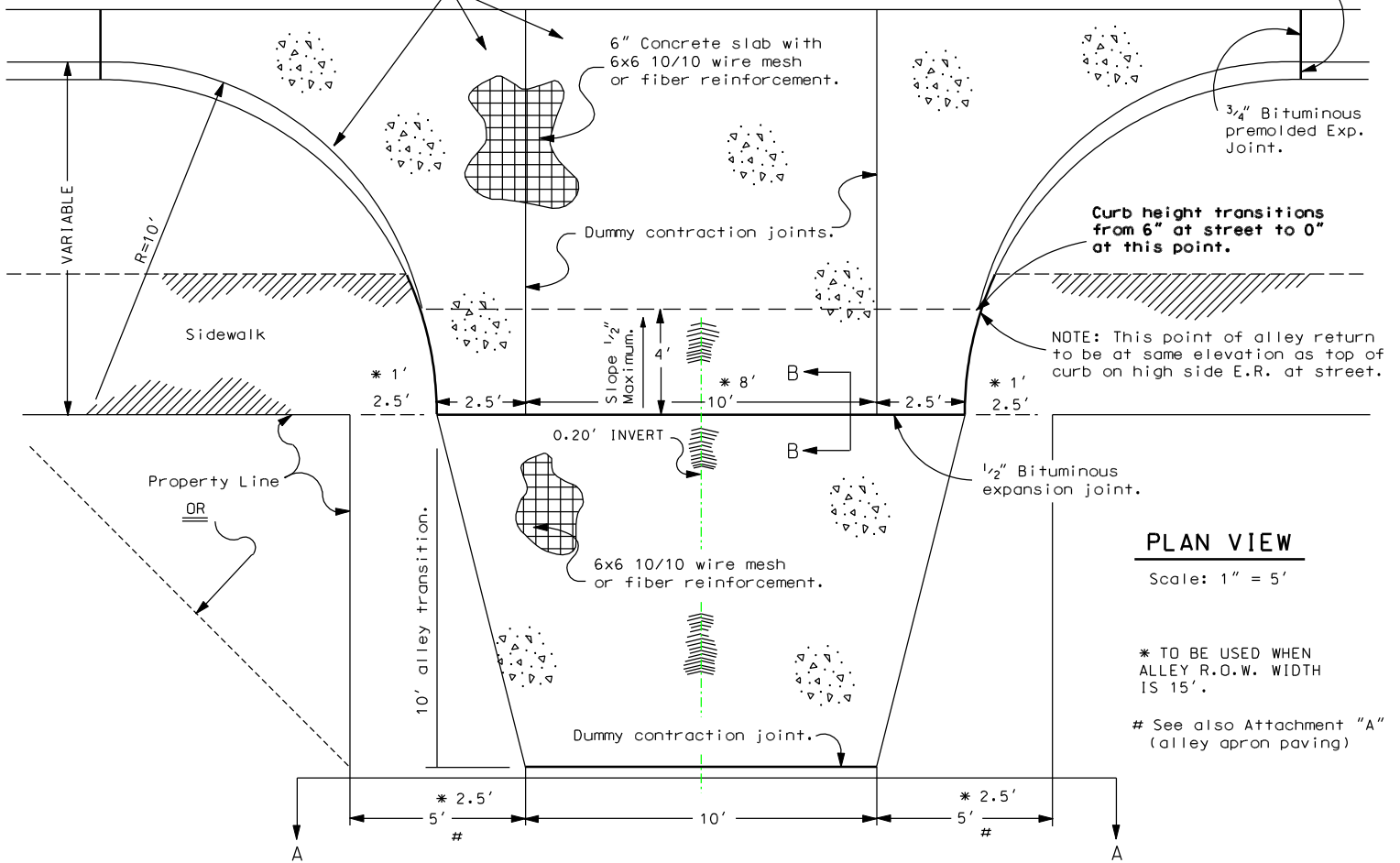

SECTION A-A

No Scale

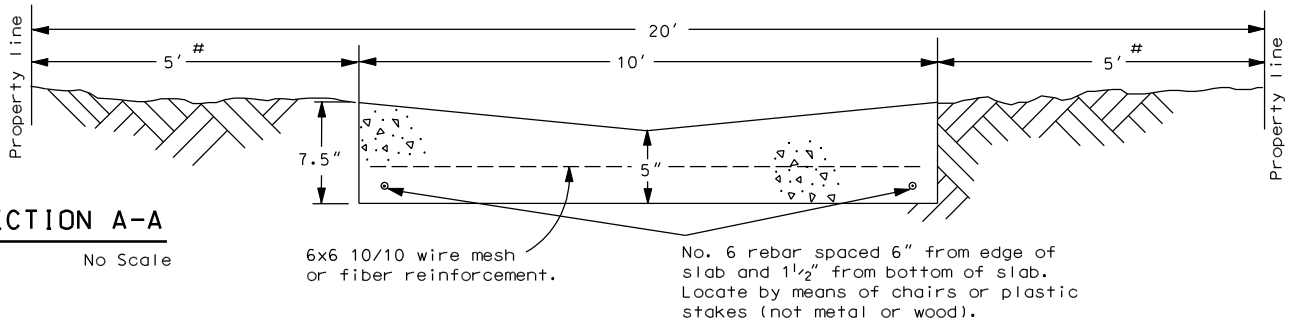

SECTION B-B

No Scale

NOTE: CONSTRUCTION OF THIS TYPE IS ALLOWED ONLY WHERE THE EXISTING ALLEY RETURN, ALLEY PAVING OR STREET GUTTER IS IN GOOD CONDITION AND GRADE AND ALIGNMENT ARE SATISFACTORY.

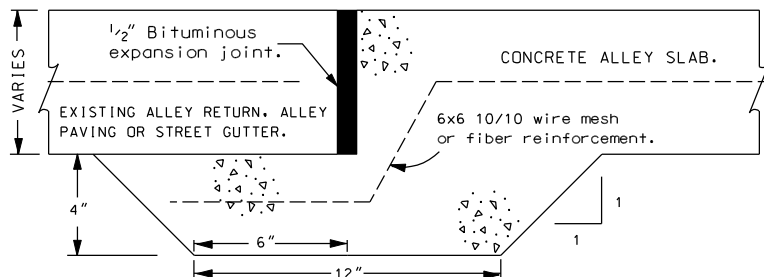

NOTE: W.R. MEADOWS #158, SEALTIGHT SAFE-SEAL 3405, SONNEBORN SL-1 OR APPROVED EQUIVALENT.

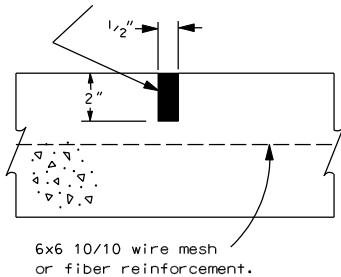

TRANSVERSE DUMMY GROOVE CONTRACTION JOINT

(Required at cold joints and every 13 feet of paving.)

No Scale

Note: All concrete shown to be 3,000 P.S.I. at 7 days. (Class B)

[5% Air \pm 1 1/2%, 5.5 sack/C.Y. (Min.), 5.5 gal./C.Y. (Max. Water), 3" Slump (Max.)]