

FILE NO. 303005A12.DGN  
 FORM SIZE 1  
 DRAWN BY B.DORCEY

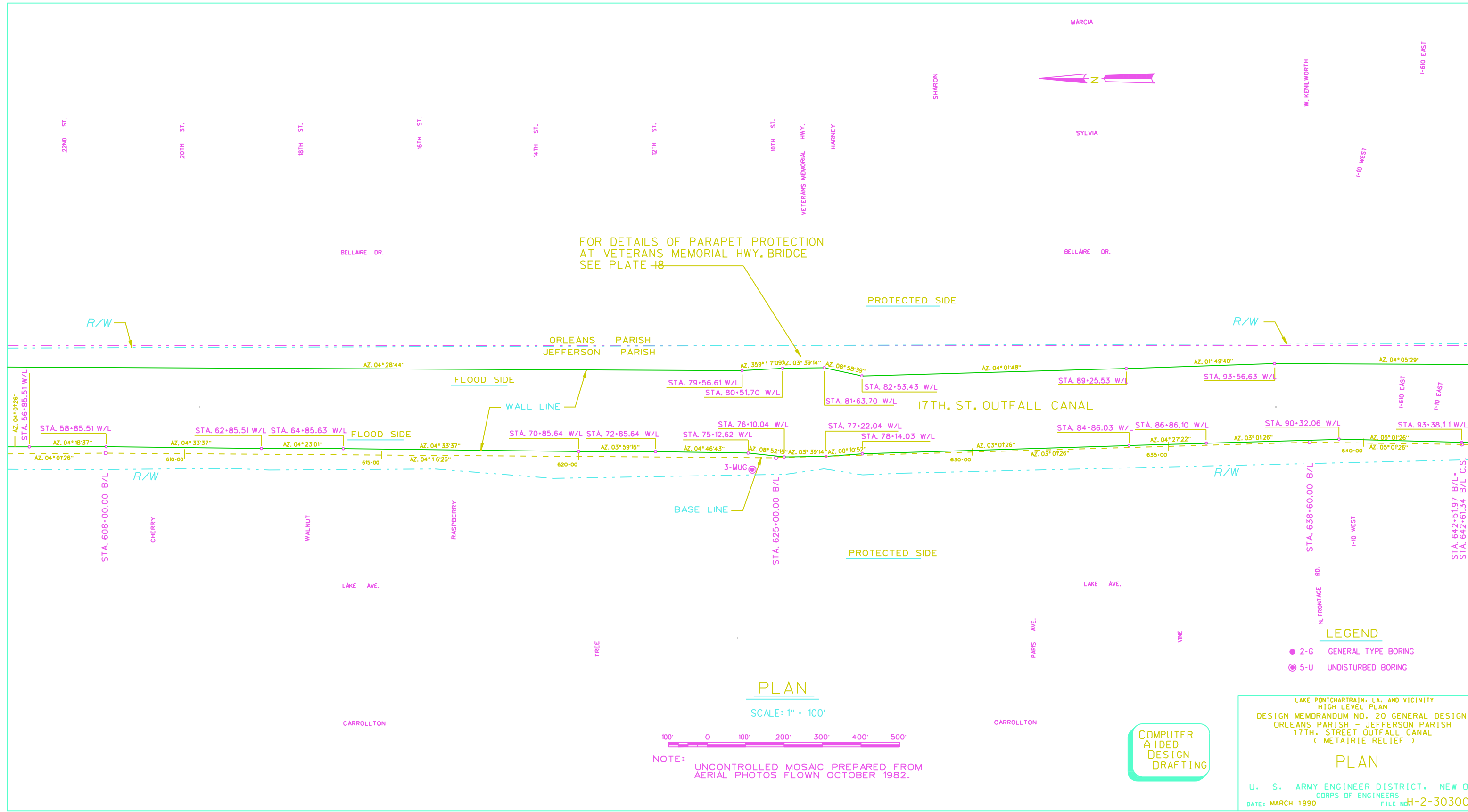

FOR DETAILS OF PARAPET PROTECTION  
 AT VETERANS MEMORIAL HWY. BRIDGE  
 SEE PLATE -18

PROTECTED SIDE

PROTECTED SIDE

17TH. ST. OUTFALL CANAL

PLAN

SCALE: 1" = 100'



NOTE: UNCONTROLLED MOSAIC PREPARED FROM AERIAL PHOTOS FLOWN OCTOBER 1982.

LEGEND

- 2-G GENERAL TYPE BORING
- ⊙ 5-U UNDISTURBED BORING

COMPUTER AIDED DESIGN DRAFTING

LAKE PONTCHARTRAIN, LA. AND VICINITY  
 HIGH LEVEL PLAN  
 DESIGN MEMORANDUM NO. 20 GENERAL DESIGN  
 ORLEANS PARISH - JEFFERSON PARISH  
 17TH. STREET OUTFALL CANAL  
 ( METAIRIE RELIEF )

**PLAN**

U. S. ARMY ENGINEER DISTRICT, NEW ORLEANS  
 CORPS OF ENGINEERS  
 DATE: MARCH 1990 FILE NO. H-2-30300