

FILE NO. 303005A10.DGN
 FORM SIZE 1
 DRAWN BY B.DORCEY

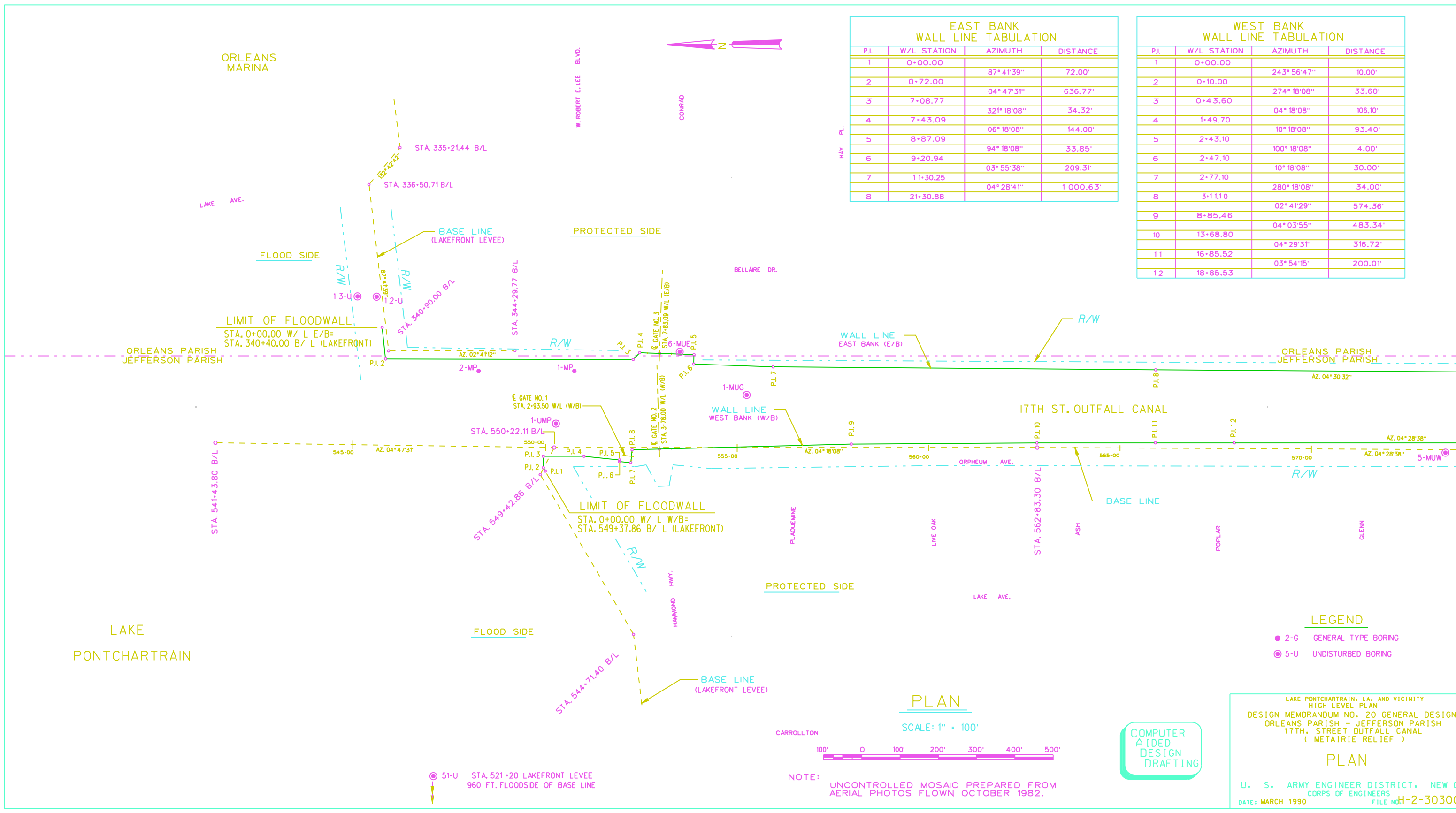

P.I.	W/L STATION	AZIMUTH	DISTANCE
1	0+00.00		
2	0+72.00	87° 41' 39"	72.00'
3	7+08.77	04° 47' 31"	636.77'
4	7+43.09	321° 18' 08"	34.32'
5	8+87.09	06° 18' 08"	144.00'
6	9+20.94	94° 18' 08"	33.85'
7	11+30.25	03° 55' 38"	209.31'
8	21+30.88	04° 28' 41"	1 000.63'

P.I.	W/L STATION	AZIMUTH	DISTANCE
1	0+00.00		
2	0+10.00	243° 56' 47"	10.00'
3	0+43.60	274° 18' 08"	33.60'
4	1+49.70	04° 18' 08"	106.10'
5	2+43.10	10° 18' 08"	93.40'
6	2+47.10	100° 18' 08"	4.00'
7	2+77.10	10° 18' 08"	30.00'
8	3+11.10	280° 18' 08"	34.00'
9	8+85.46	02° 41' 29"	574.36'
10	13+68.80	04° 03' 55"	483.34'
11	16+85.52	04° 29' 31"	316.72'
12	18+85.53	03° 54' 15"	200.01'

PLAN

SCALE: 1" = 100'



NOTE: UNCONTROLLED MOSAIC PREPARED FROM AERIAL PHOTOS FLOWN OCTOBER 1982.

LEGEND

- 2-G GENERAL TYPE BORING
- ⊙ 5-U UNDISTURBED BORING

COMPUTER AIDED DESIGN DRAFTING

LAKE PONTCHARTRAIN, LA. AND VICINITY
 HIGH LEVEL PLAN
 DESIGN MEMORANDUM NO. 20 GENERAL DESIGN
 ORLEANS PARISH - JEFFERSON PARISH
 17TH. STREET OUTFALL CANAL
 (METAIRIE RELIEF)

PLAN

U. S. ARMY ENGINEER DISTRICT, NEW ORLEANS
 CORPS OF ENGINEERS
 DATE: MARCH 1990 FILE NO. H-2-30300