

DISTANCES FROM SIDE STAKES FOR CROSS-SECTIONING

Roadway of any Width. Side Slopes 1½ to 1.

In the figure below: opposite 7 under "Cut or Fill" and under .3 read 11.0, the distance out from the side stake at left. Also, opposite 11 under "Cut or Fill" and under .1 read 16.7, the distance out from the side stake at right.

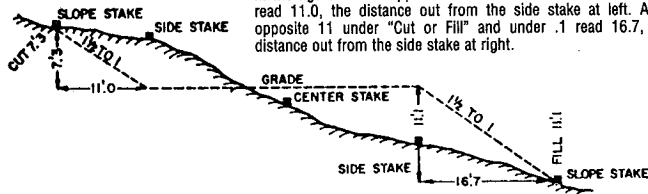

BK 3
060852

Cut or Fill	Distance out from Side or Shoulder Stake										Cut or Fill
	0	.1	.2	.3	.4	.5	.6	.7	.8	.9	
0	0.0	0.2	0.3	0.5	0.6	0.8	0.9	1.1	1.2	1.4	0
1	1.5	1.7	1.8	2.0	2.1	2.3	2.4	2.6	2.7	2.9	1
2	3.0	3.2	3.3	3.5	3.6	3.8	3.9	4.1	4.2	4.4	2
3	4.5	4.7	4.8	5.0	5.1	5.3	5.4	5.6	5.7	5.9	3
4	6.0	6.2	6.3	6.5	6.6	6.8	6.9	7.1	7.2	7.4	4
5	7.5	7.7	7.8	8.0	8.1	8.3	8.4	8.6	8.7	8.9	5
6	9.0	9.2	9.3	9.5	9.6	9.8	9.9	10.1	10.2	10.4	6
7	10.5	10.7	10.8	11.0	11.1	11.3	11.4	11.6	11.7	11.9	7
8	12.0	12.2	12.3	12.5	12.6	12.8	12.9	13.1	13.2	13.4	8
9	13.5	13.7	13.8	14.0	14.1	14.3	14.4	14.6	14.7	14.9	9
10	15.0	15.2	15.3	15.5	15.6	15.8	15.9	16.1	16.2	16.4	10
11	16.5	16.7	16.8	17.0	17.1	17.3	17.4	17.6	17.7	17.9	11
12	18.0	18.2	18.3	18.5	18.6	18.8	18.9	19.1	19.2	19.4	12
13	19.5	19.7	19.8	20.0	20.1	20.3	20.4	20.6	20.7	20.9	13
14	21.0	21.2	21.3	21.5	21.6	21.8	21.9	22.1	22.2	22.4	14
15	22.5	22.7	22.8	23.0	23.1	23.3	23.4	23.6	23.7	23.9	15
16	24.0	24.2	24.3	24.5	24.6	24.8	24.9	25.1	25.2	25.4	16
17	25.5	25.7	25.8	26.0	26.1	26.3	26.4	26.6	26.7	26.9	17
18	27.0	27.2	27.3	27.5	27.6	27.8	27.9	28.1	28.2	28.4	18
19	28.5	28.7	28.8	29.0	29.1	29.3	29.4	29.6	29.7	29.9	19
20	30.0	30.2	30.3	30.5	30.6	30.8	30.9	31.1	31.2	31.4	20
21	31.5	31.7	31.8	32.0	32.1	32.3	32.4	32.6	32.7	32.9	21
22	33.0	33.2	33.3	33.5	33.6	33.8	33.9	34.1	34.2	34.4	22
23	34.5	34.7	34.8	35.0	35.1	35.3	35.4	35.6	35.7	35.9	23
24	36.0	36.2	36.3	36.5	36.6	36.8	36.9	37.1	37.2	37.4	24
25	37.5	37.7	37.8	38.0	38.1	38.3	38.4	38.6	38.7	38.9	25
26	39.0	39.2	39.3	39.5	39.6	39.8	39.9	40.1	40.2	40.4	26
27	40.5	40.7	40.8	41.0	41.1	41.3	41.4	41.6	41.7	41.9	27
28	42.0	42.2	42.3	42.5	42.6	42.8	42.9	43.1	43.2	43.4	28
29	43.5	43.7	43.8	44.0	44.1	44.3	44.4	44.6	44.7	44.9	29
30	45.0	45.2	45.3	45.5	45.6	45.8	45.9	46.1	46.2	46.4	30
31	46.5	46.7	46.8	47.0	47.1	47.3	47.4	47.6	47.7	47.9	31
32	48.0	48.2	48.3	48.5	48.6	48.8	48.9	49.1	49.2	49.4	32
33	49.5	49.7	49.8	50.0	50.1	50.3	50.4	50.6	50.7	50.9	33
34	51.0	51.2	51.3	51.5	51.6	51.8	51.9	52.1	52.2	52.4	34
35	52.5	52.7	52.8	53.0	53.1	53.3	53.4	53.6	53.7	53.9	35
36	54.0	54.2	54.3	54.5	54.6	54.8	54.9	55.1	55.2	55.4	36
37	55.5	55.7	55.8	56.0	56.1	56.3	56.4	56.6	56.7	56.9	37
38	57.0	57.2	57.3	57.5	57.6	57.8	57.9	58.1	58.2	58.4	38
39	58.5	58.7	58.8	59.0	59.1	59.3	59.4	59.6	59.7	59.9	39
40	60.0	60.2	60.3	60.5	60.6	60.8	60.9	61.1	61.2	61.4	40

This paper has been treated to allow usage in "Wet" environments.

Index

Date	Page	Contents
12-21-05	1	BRAITHWAITH PS FF & Side slots
	2	Scarsdale Ps FF & Side slots
	3-5	R194 TO TBM BELA
	6	BELA - Belaire Pump STA FF & Side slots
	7-9	A152 TO TBM G
	10	VOID
	11	Metato TBM H
12-22-05	12	175 th Canal Conduits Palms Horst E & W Northline ST E & W
	13	1010 Pump Station FF & Side slots
1-4-06	14-15	TBM G TO TBM BELL
	16	TBM Bell to BELLEVUE PS FF & Side Slot
	17-18	Levels Pointe a La Haucie LMS 214 TO TBM I
	19-20	Levels TBM I TO POIE TBM
	21	POIE TO Pointe A La Haucie FF & Side slots
1-5-06	22	Segnetic PS FF & Side slots
	23	Westwego PS #2 FF & Side slots
	24	Westminster PS' FF & Side slots
	25	Ames Pump Station FF & Side slots
	26	HARVEY PS FF & Side slots
	27-28	Levels Harv TO TBM J
	29	Cousins PS 1 & 2 TBM J TO FF & Side Slots

RB
MP
ME
JK

12-21-05 1.

Braithwaith PS				
STA	+	HI	-	Elev.
BRAI				9.324
	4.988	14.312		
FF-1			6.499	7.813
FF-2			6.203	8.109
	5.852	13.961		
NG-1			5.350	8.611
NG-2			4.429	9.532
NG-3			4.160	9.801
BRAI			4.634	9.327 F
				9.324 G
				+0.003 E
		Tie		

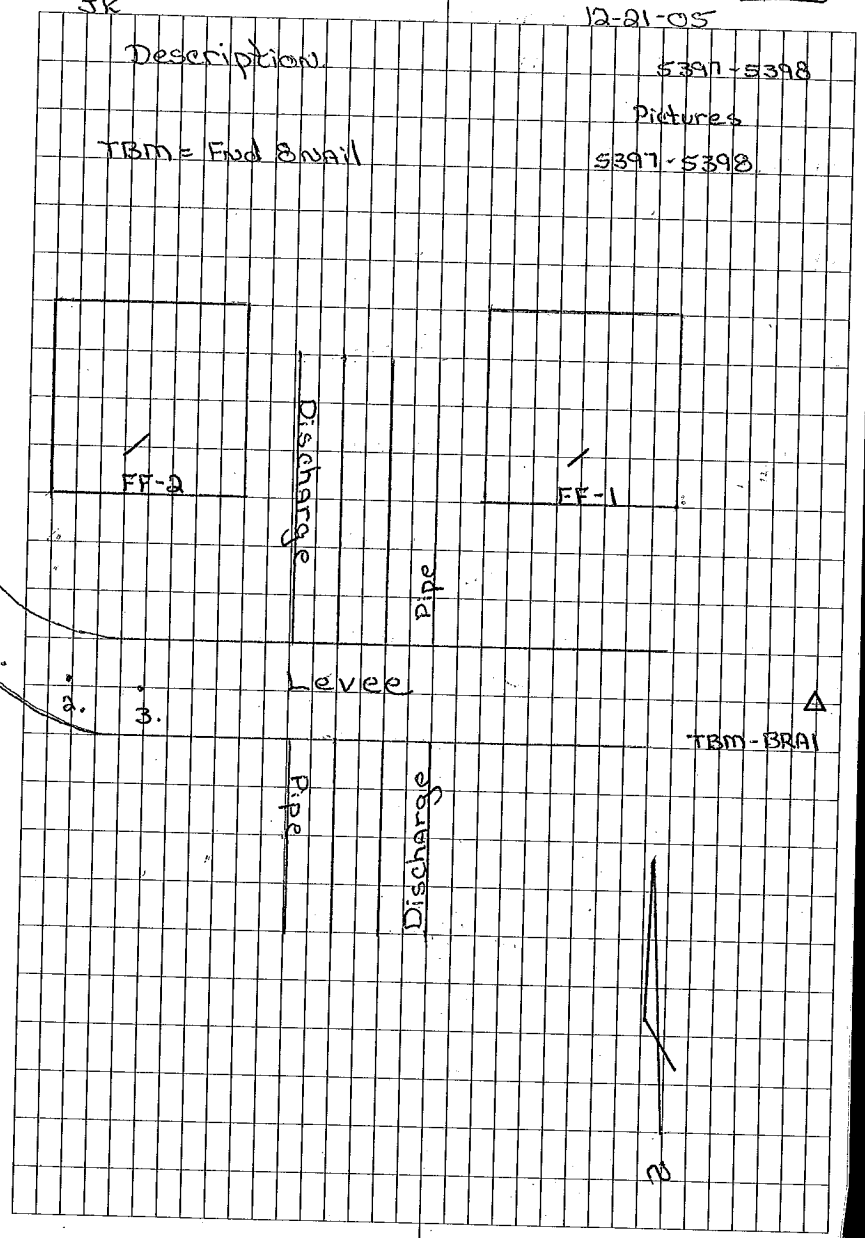

Scarsdale Ps.

STA	+	HI	-	Elev.
SCAR				
	5.456			
FF			4.479	
	4.182			
cone A			4.644	
cone B			4.739	
cone C			4.732	
SCAR			5.163	

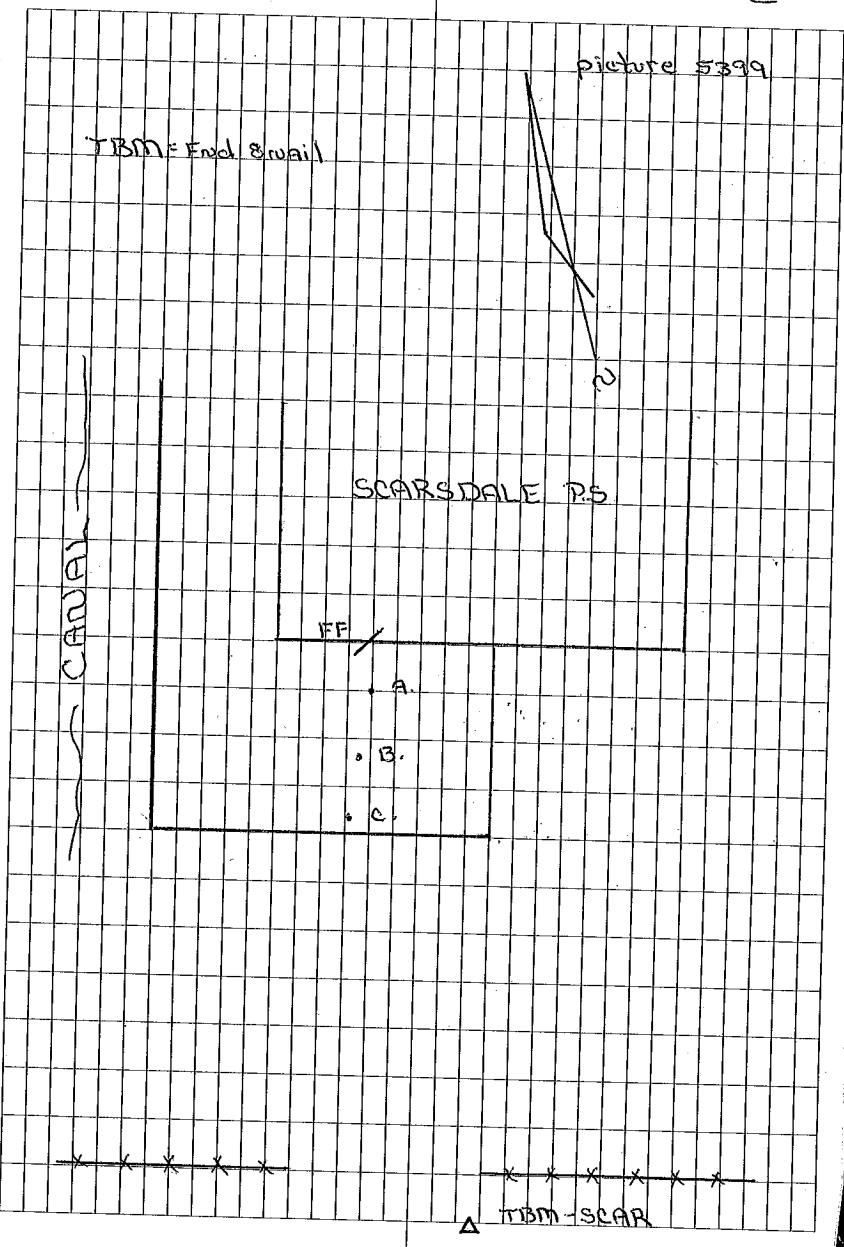
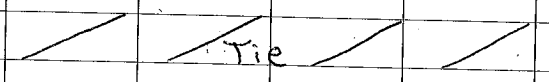

SEA	+	HI	-	Elev.
	2.747	8.802		
T.P			5.033	3.769
	4.206	7.975		
T.P			5.746	2.229
	4.402	6.631		
T.P			5.551	1.080
	4.209	5.289		
T.P			4.933	0.356
	6.369	6.725		
T.P			3.865	2.860
	3.444	6.304		
BELA			4.178	2.126
Beta	4.419	6.545		
T.P			3.679	2.866
	4.059	6.925		
T.P			6.347	0.578
	4.705	5.283		
T.P			3.404	1.879
	5.169	7.048		
T.P			4.177	2.871
	5.178	8.049		
T.P			4.003	4.046

12-21-05

4.

VOID

BELAIR Ps.

STA	+	HI	-	Elev.
BELA				2.126
	3.130			
FF			2.993	
			3.964	
			3.902	
			3.870	
	4.083			
BELA			3.943	

pictures 5400-5401

End. Email = TBM-BELA - Ref the BK 1974

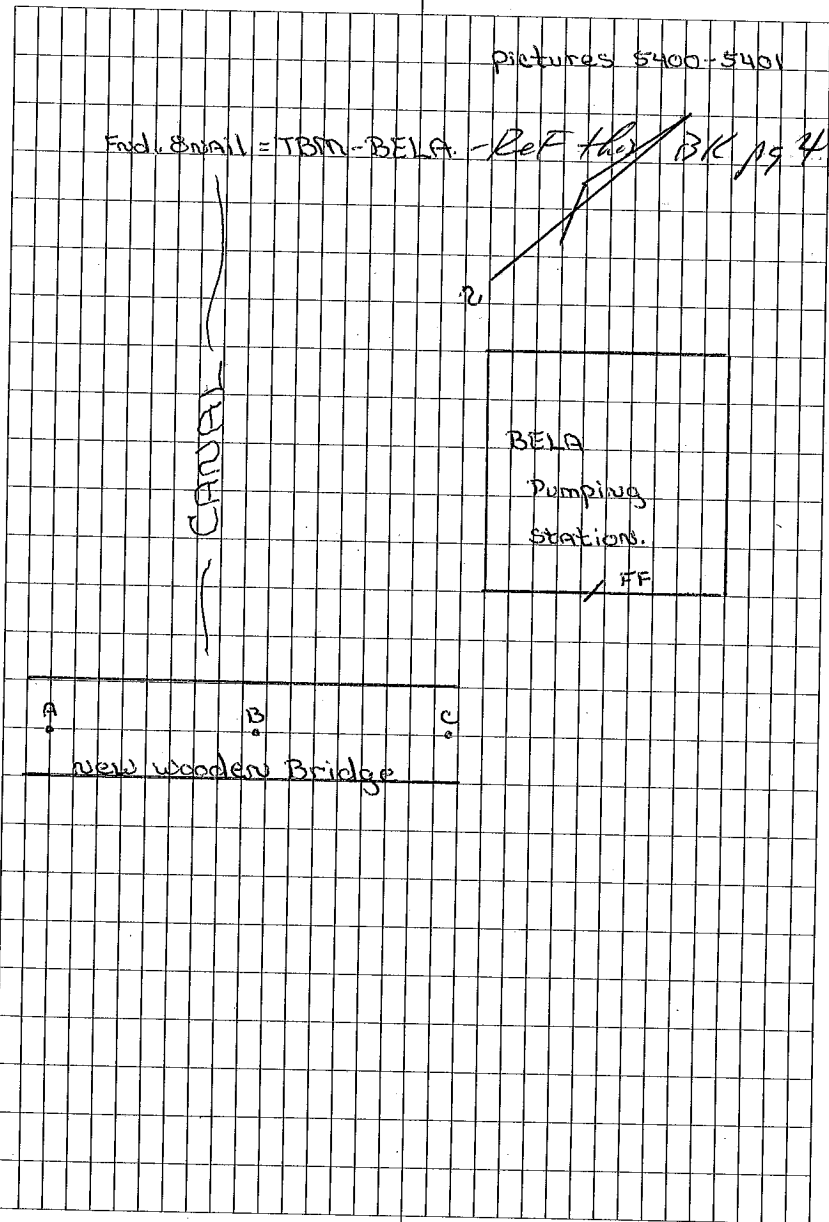

STA	+	A-152 Cont...	-	Elev.
	3.416	8.690		
T.P.			3.868	4.822
	3.673	8.495		
T.P.			4.332	4.163
	4.703	8.866		
TBM-G			5.208 5.0	3.658
	5.413	9.071		
T.P.			4.913	4.158
	4.376	8.534		
T.P.			3.508	5.026
	3.348	8.374		
T.P.			4.969	3.405
	4.609	8.014		
T.P.			4.089	3.925
	4.268	8.193		
T.P.			3.496	4.697
	4.462	9.159		
T.P.			4.682	4.477
	3.500	7.977		
T.P.			4.298	3.679
	4.548	8.227		
T.P.			3.782	4.445

8 nail set in the NE corner of the inter-
section of

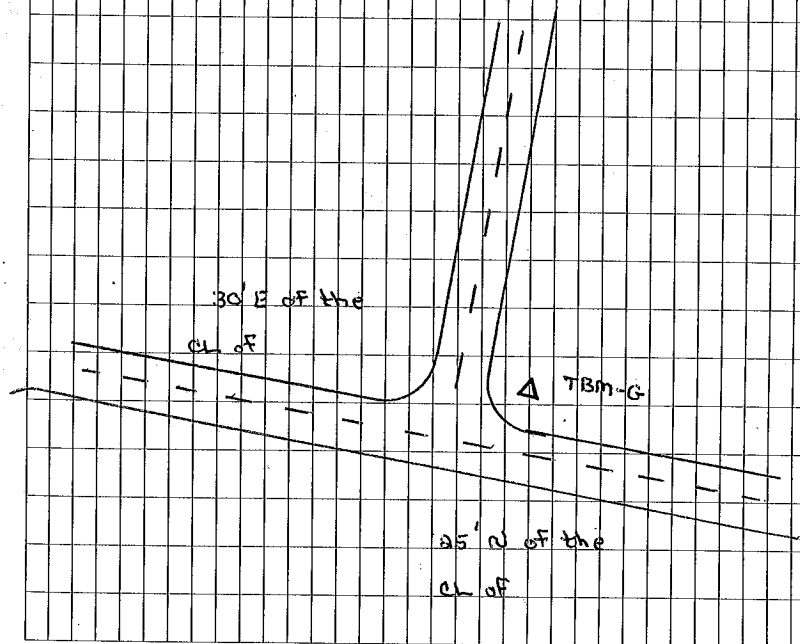

12/22/05¹⁰

STA	+	HI	-	Elev.
FBM 6				
Meta				4.743
	3.168	7.911		
I.P			3.382	4.529
	3.029	7.558		
I.P			3.302	4.256
	3.309	7.565		
I.P			4.696	2.869
	3.959	6.828		
I.P			5.876	0.952
	5.067	6.019		
I.P			2.708	3.311
	5.332	8.643		
I.P			7.902	0.741
	4.748	5.489		
OP 06			5.843	-0.354

Description:

Refer to BK. 1 pg. 23

End PK

STA	+	HI	-	Elev.
				4.831
META		.978		4.743
	6.147	10.890		5.076
T.P		8.672	5.902	4.988
	3.596	8.584		2.151
T.P		5.810	6.521	2.063
	3.659	5.722		0.954
T.P		5.020	4.856	0.866
	4.066	4.932		0.504
T.BM-H		4.732	4.516	0.416
	4.228	4.644		0.954
T.P		5.872	3.778	0.816
	4.918	5.784		2.390
T.P		8.496	3.482	2.302
	6.106	8.408		5.083
T.P		11.100	3.413	4.995
	6.017	11.012		1.844 F
META			6.259	4.753
				4.831 G
				Error = 10.010 E
				Tie

Final point spot = TBM META. - Ref this
 BK. 1946

PK w/spiner. Set at the intersection of
 Bamboo Rd. and Palmetto St.

Final point spot = TBM META.

17th St. Canal

Low Chords For Palmetto and Palm St. Canal

Sta	+	HI	-	Elev.
				0.504
TBM-H		7.132		0.416
	6.628	7.044		
Low Cord.			8.968	-1.836
				-1.924
Low Cord.			10.014	-2.887
				-2.970
I.P.		5.994	6.589	0.543
	5.451	5.906		0.455
Low Cord.			9.714	-3.720
				-3.808
Low Cord.			9.282	-3.288
				-3.376
I.P.		5.240	5.449	0.545
	4.695	5.152		0.457
TBM-H			4.734	0.506
				0.418 F
				0.504 G
			Error = ± 0.002 E	

Tie

12

12-22-05

Palmetto St. 5404 west end

Palmetto St. 5405 east end

Northline
Palmetto St canal 5402 west end.

Northline
Palmetto St canal 5403 east end.

IO10 Pump Station			
STA	+	H1	- Elev.
IO10			-5.207
	5.648	0.441	
FF			12.044 -11.603
FF			4.537 -4.096
	4.323	0.227	
conc.			4.418 -4.191
conc.			4.638 -4.411
conc.			4.890 -4.663
			5.433
IO10			5.434 -5.207 F
			-5.207 G
			0.000 E

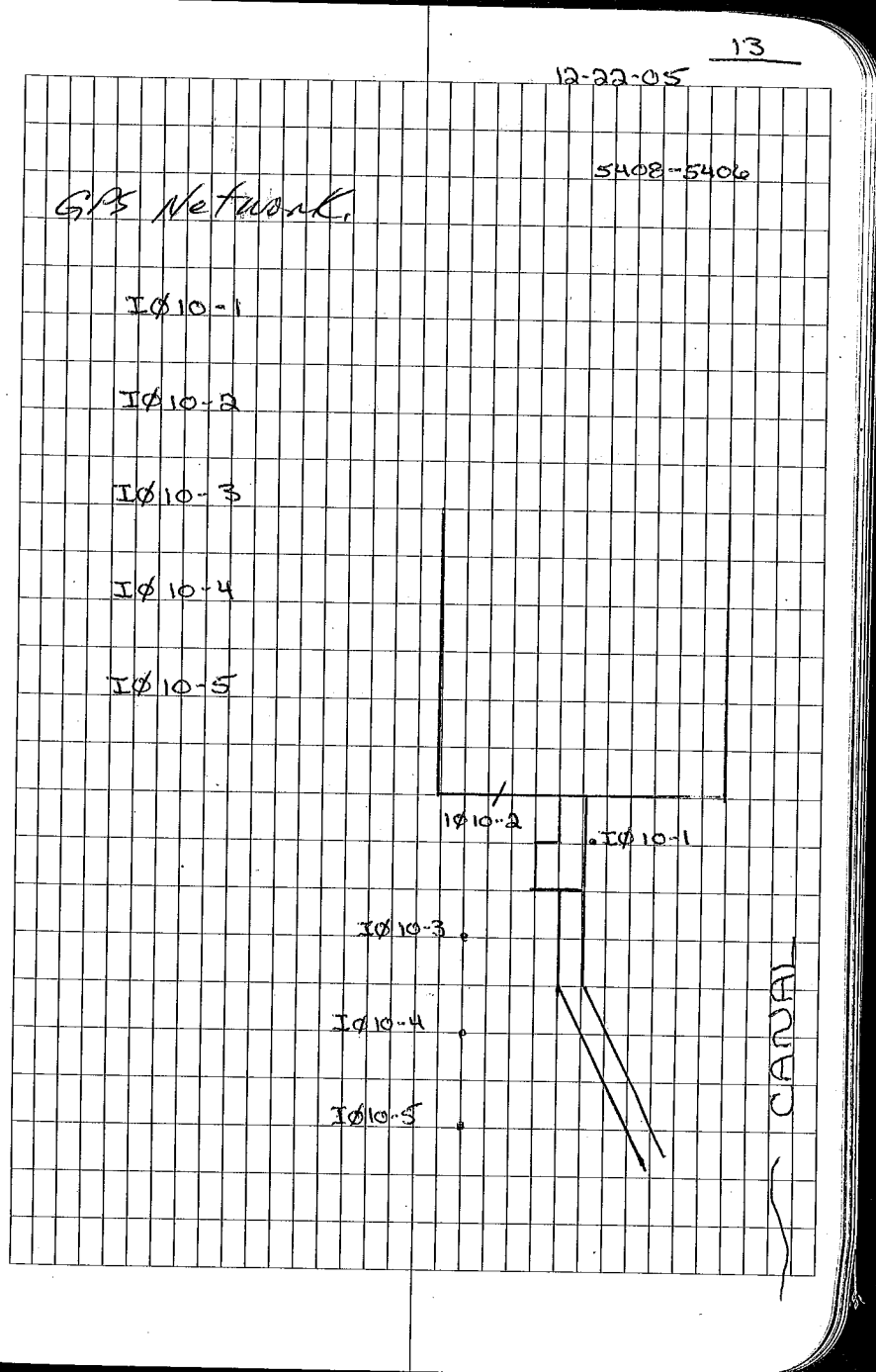

STA	Vertical +	Control HI	For TBM-BELL -	Elev. /
TBM-G				3.658
	4.432	8.090		
T.P			4.297	3.793
	5.108	8.901		
T.P			5.268	3.633
	5.122	8.755		
T.P			4.879	3.876
	4.766	8.642		
T.P			4.572	4.070
	4.554	8.624		
T.P			5.282	3.342
	5.159	8.501		
T.P			4.824	3.677
	5.009	8.686		
T.P			1.311	7.375
	11.825	19.200		
TBM-BELL			2.622	16.578
	2.119	18.697		
T.P			11.323	7.374
	1.198	8.572		
T.P			4.504	4.068

144-06

8 mail - REF. this BK. 17 B

End 8 mail

BELLEVUE Pumping Station

1-4-06

STA	+	HI	-	Elev.
BELL				16.578
	2.303	18.881		
FF			6.158	12.723
conc.-1			8.923	9.958
conc.-2			8.871	10.010
conc.-3			9.048	9.833
	9.349	19.182		
BELL				
BELL			2.606	16.576
			Error =	0.002

Tie

0339 & 0340

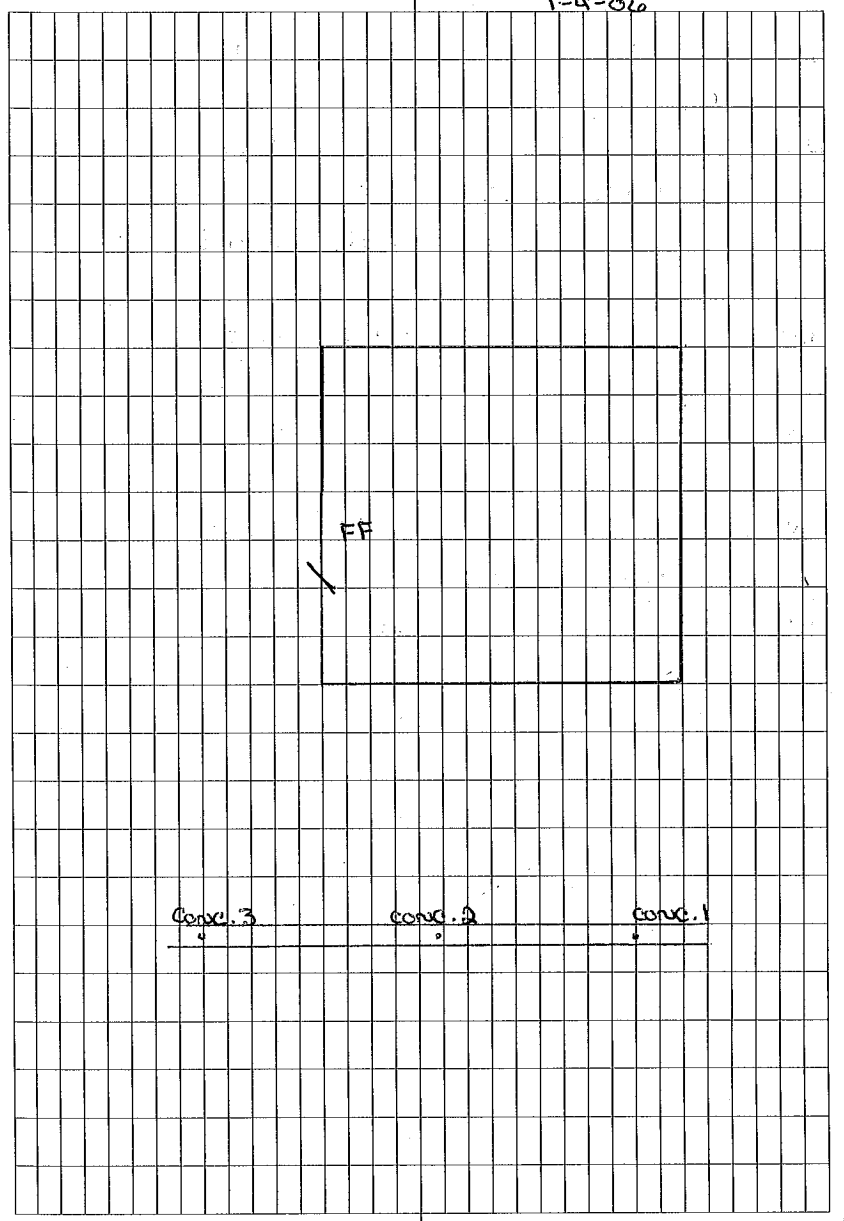

Levels For Pointe-A-La-Hache West P.S.

Sta	+	HI	-	Elev.
LMS-214				13.364
	5.496	18.860		
T.P			4.374	14.486
	3.803	18.289		
T.P			3.708	14.581
	4.329	18.910		
T.P			6.211	12.699
	5.954	18.653		
T.P			4.808	13.845
	1.675	15.520		
T.P			9.100	6.420
	1.225	7.645		
T.P			4.701	2.944
	4.853	7.797		
T.P			4.493	3.304
	4.624	7.928		
T.P			3.823	4.105
	3.554	7.659		
TBM ^I - #			3.529	4.130
	3.779	7.409		
T.P			3.803	4.106

1-4-06

MVA-TBM

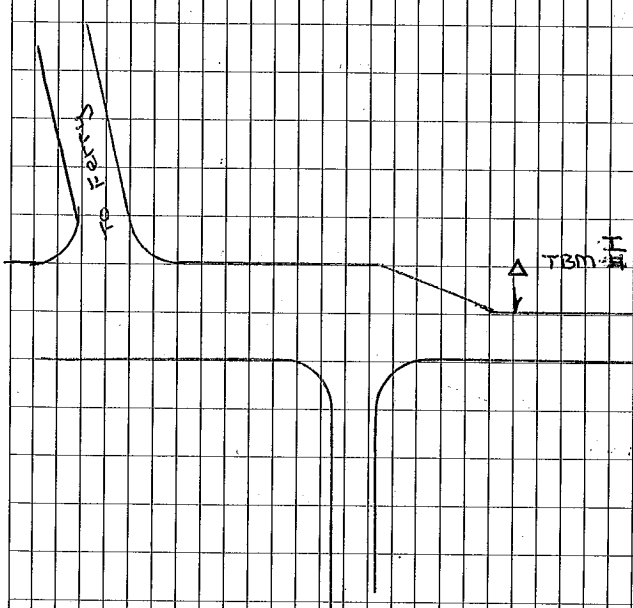

TBM-I is a snail set approx 21' from EA

levels Cont

Sta	+	H1	-	Elev.
I TBM-#				4.130
	5.413	9.543		
T.P			4.206	5.337
	3.121	8.458		
T.P			5.374	3.084
	4.705	7.789		
T.P			4.192	3.597
	3.542	7.139		
T.P			5.364	1.775
	4.181	5.956		
T.P			3.766	2.190
	5.423	7.613		
T.P			0.521	7.092
	10.812	17.904		
POIE			1.154	16.750
	1.195	17.945		
T.P			10.856	7.089
	0.266	7.355		
T.P			5.758	1.597
	4.247	5.844		
T.P			3.942	1.902

1-4-06

600 W. Ave. near Pump Station -
 Ponte-A-la-Mache East,

vertical control cont...

STA	+	H1	-	Elev.
	5.484	7.386		
I.P.			4.469	2.917
	5.186	8.103		
I.P.			5.022	3.081
	5.448	8.529		
I.P.			3.455	5.074
	4.500	9.574		
I BM-14			5.451	4.123

Error =

Tie

1-4-06 20

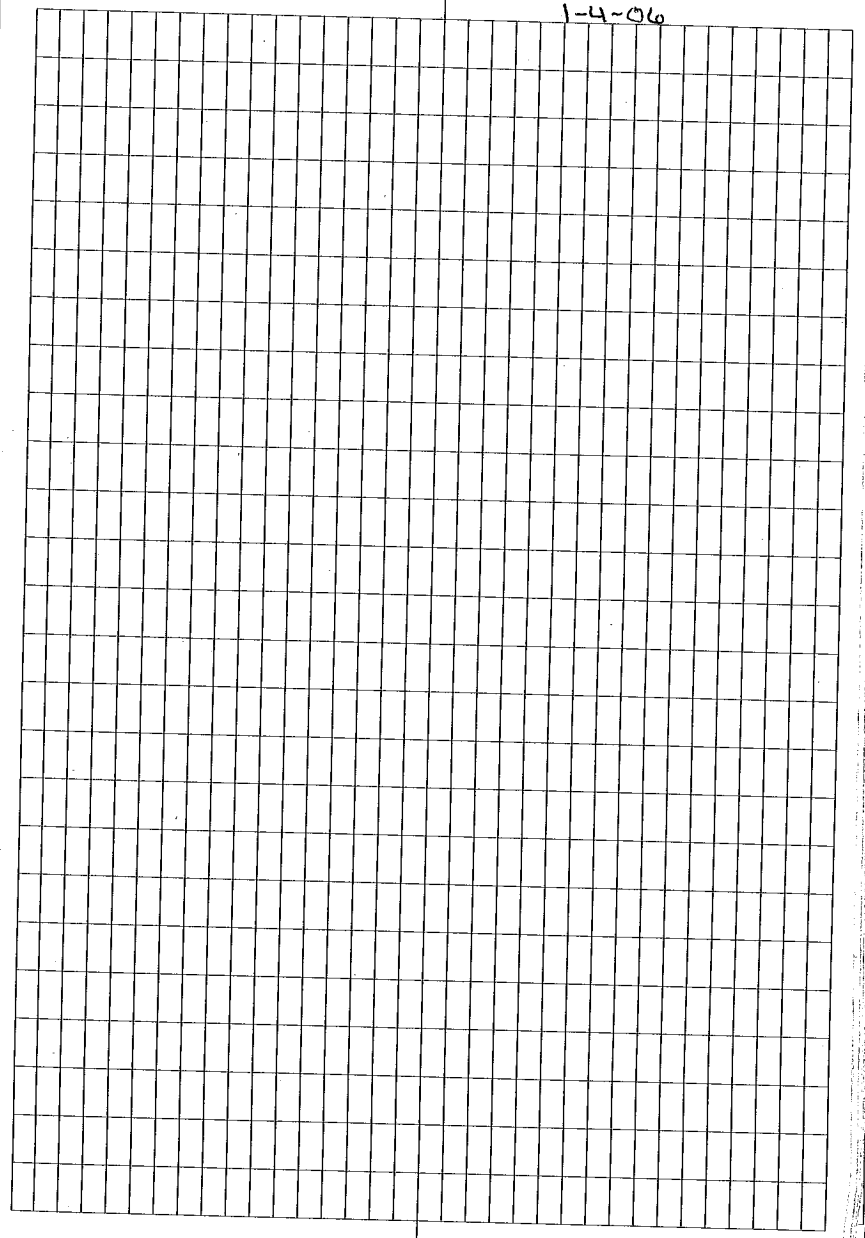

Pointe-A-La-Hache East Pump Station

Sta	+	HI	-	Elev.
POIE				16.750
	0.665	17.415		
FF			4.829	12.586
conc-1			7.632	9.783
conc-2			7.548	9.867
conc-3			7.503	9.912
	7.689	17.601		
POIE			0.849	16.752
			ERROR =	0.00

Tie

1-4-06

21

See BK. 5 pg 31 For Sketch

Segnette PS.				
Sta	+	HI	-	Elev.
Segn.		5.287		-1.722
	7.009	8.737		
FF-1			2.300	2.987 6.431
conc-1			2.607	2.680 6.784
conc-2			2.648	2.639 6.083
conc-3			2.589	2.698 6.142
	5.042	11.184		6.019
FF-2			1.721	9.463
	1.622	11.085		-1.718
			9.359	4.786
				Error = +0.004

Tie

Pitcares 0348 - 0352

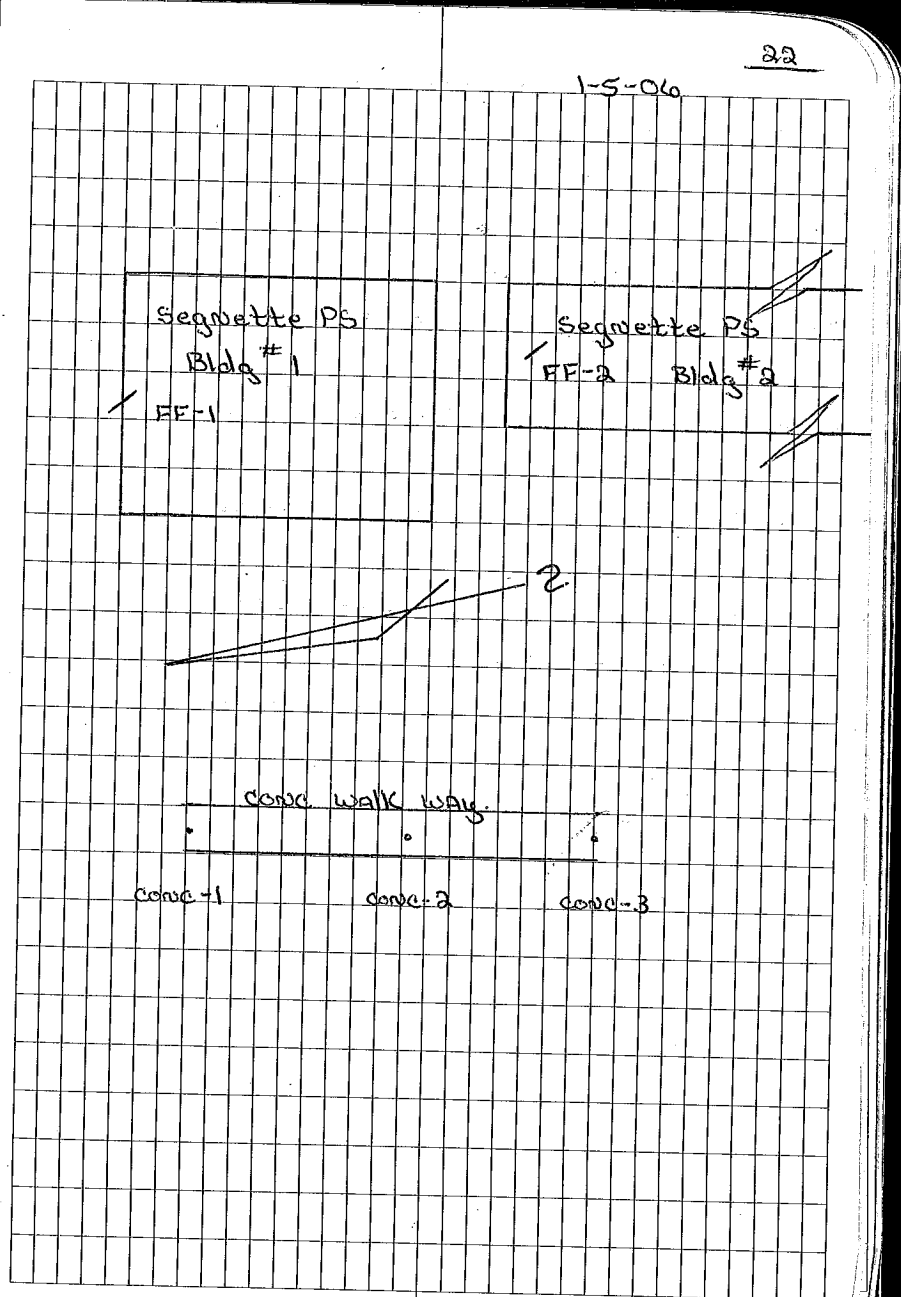

Weswego PS # 2				
Sta	+	HI	-	Elev.
WES-2				-4.380
	6.070	10.450		
FF			5.945	-4.255 4.505
conc-1			4.689	-2.999 5.761
conc-2			4.699	-3.009 5.751
conc-3			4.640	-2.950 5.810
	4.388	10.198		
WES-2			5.820	-4.382 4.378
				Error = 0.002

Tie

Pitours 0353-0355

1-5-06

23

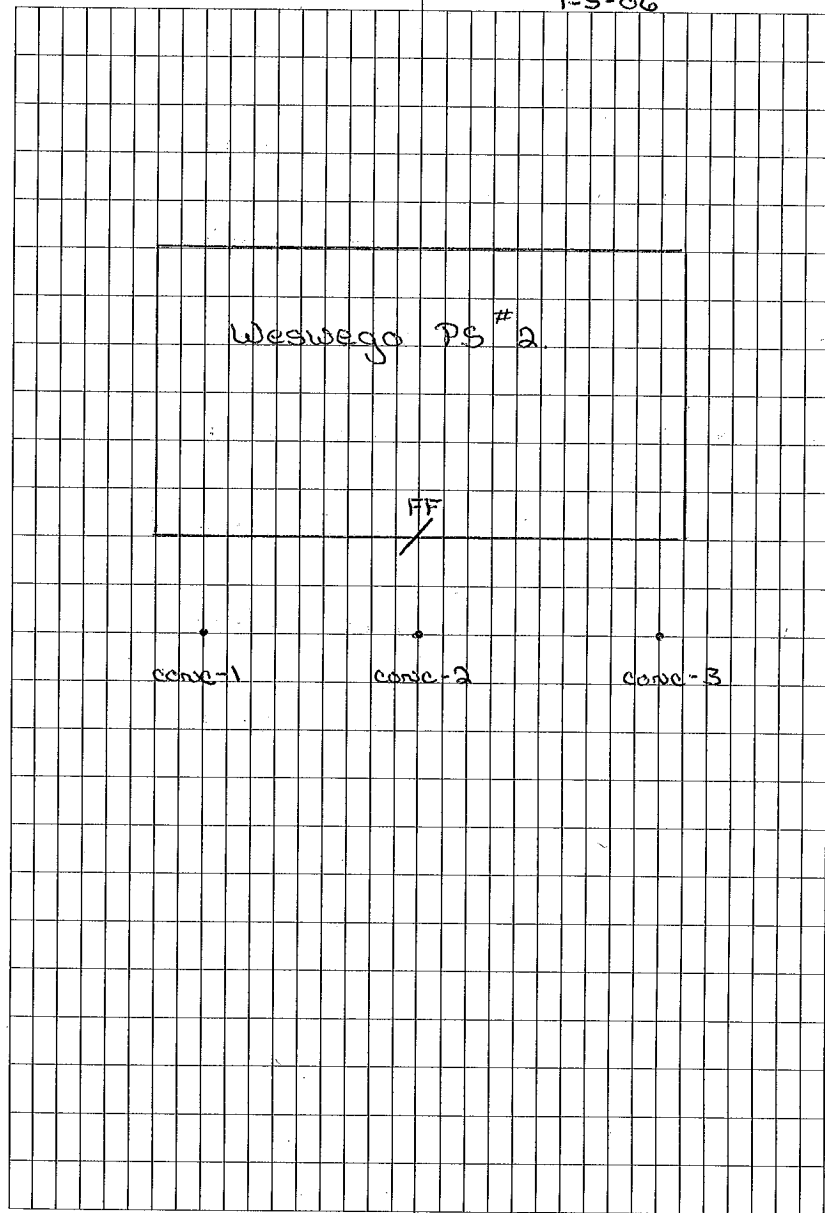

Westminster PS.				
Sta	+	HI	-	Elev.
West.				2.178
	6.369	8.547		
conc-1			5.178	3.369
conc-2			5.187	3.360
conc-3			5.203	3.344
	3.998	7.342		
FF			8.615	-1.273
I.P			2.291	5.051
	3.019	8.070		
West			5.895	2.175
			Error =	0.003
Tie				
Pitcares 0356-0358				

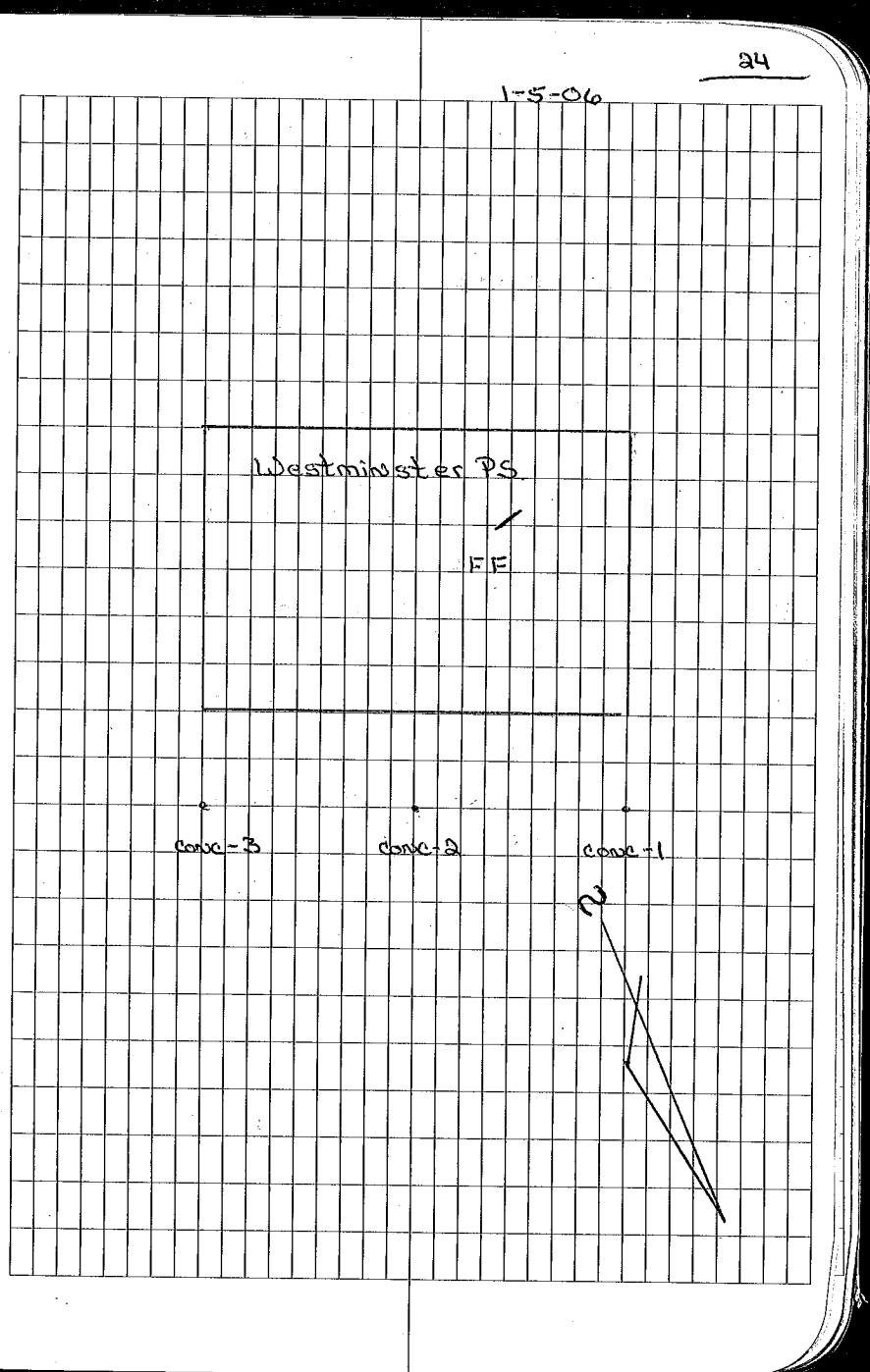

AMES PS.				
Sta	+	HI	-	Elev
AMES.				5.266
	4.927	10.193		
T.P			6.929	3.264
	2.782	6.046		
T.P			7.726	-1.680
	0.992	-0.688		
FF			6.373	-7.061
	6.300	-0.761		
T.P			0.916	-1.677
	6.659	4.982		
conc-1			6.012	-1.030
conc-2			5.916	-0.934
conc-3			6.063	-1.081
	10.504	9.423		
AMES.			4.134	5.289
			Error =	0.023
Tie				
Pitcares 0359 - 0361				

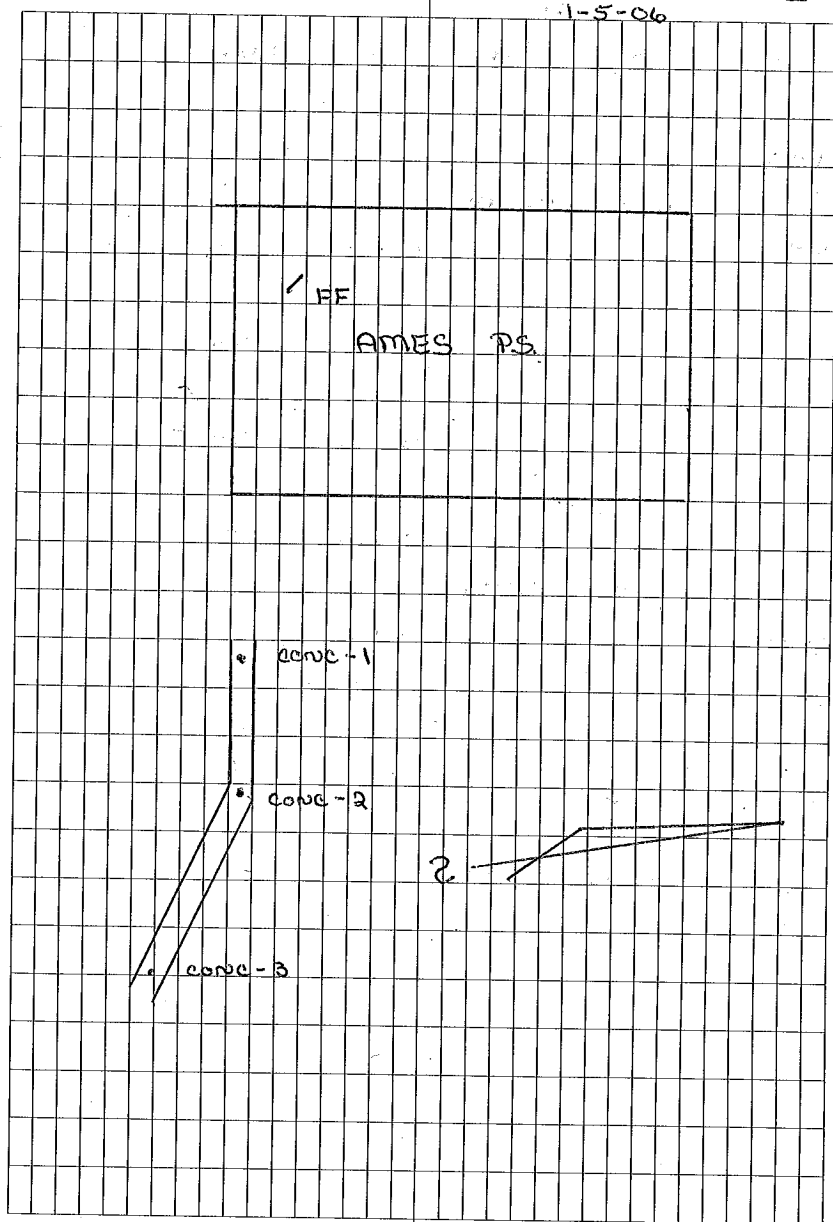

1-5-06

STA	+	HI	-	Elev.
HARV.				-3.904
	7.838	11.742		3.153
FF			0.781	10.901
conc-1			4.946	6.796 -1.012
conc-2			4.986	6.756 -1.052
conc-3			4.989	6.753 -1.055
	2.614	9.367		-3.885
HARV			5.444	3.923
			Error =	0.019
			Error =	3.923

Tie

Pitaves 0362 - 0364

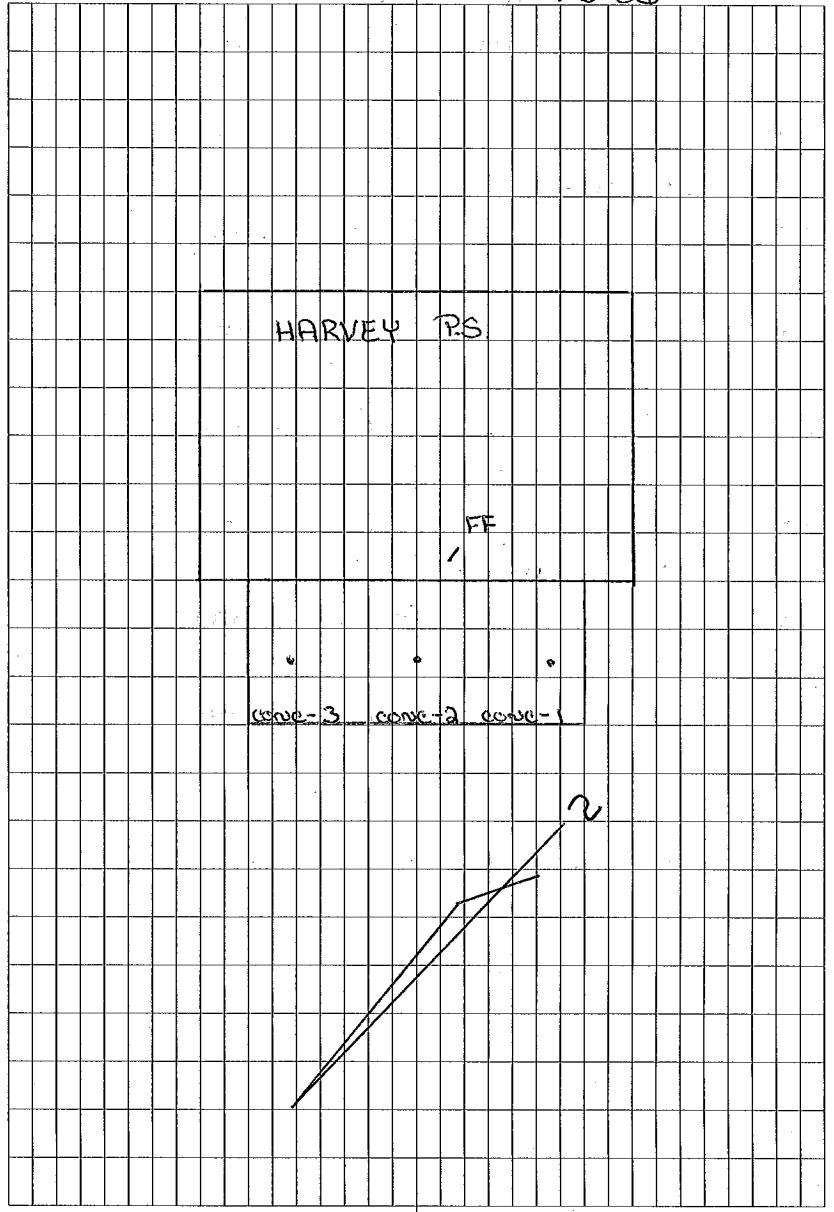

1-5-06

Sta	Coinst	PS #	and #2	Elev.
+	HI	-		
TBM-J				5.059
	6.988	12.047		
FF-1			1.319	10.728
FF-2			2.028	10.019
conc-1			7.761 7.769	4.286
conc-2			7.769	4.278
conc-3			7.896	4.151
	5.454	9.605 9.0		
TBM-J			4.542	5.063
			ERROR =	0.004
Tie				
Pictures 0365 - 0369				

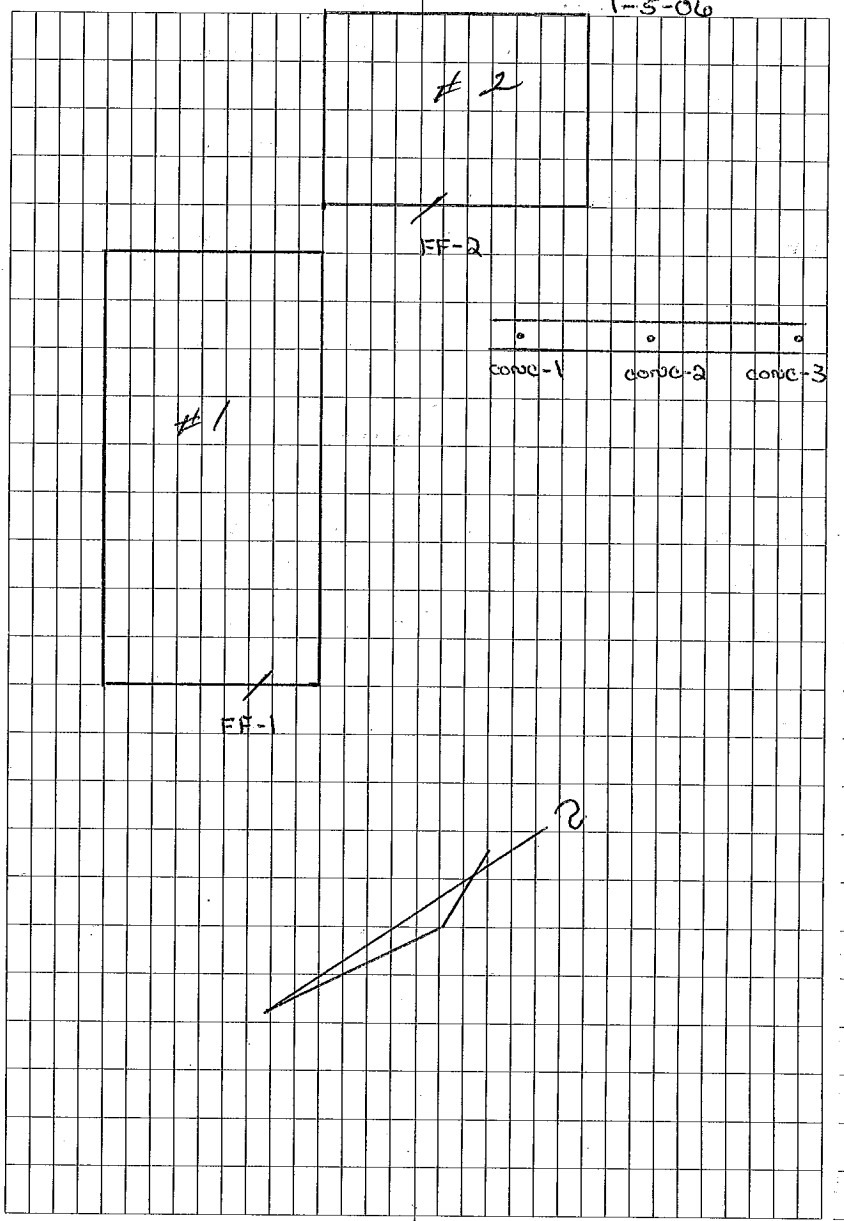

ESTELLE P.S.

Sta	+	HI	-	Elev.
ESTE				-2.310
	5.371	7.681		
FF			0.193	2.868 7.488
conc-1			4.075	-1.014 3.606
conc-2			4.114	-1.053 3.567
conc-3			4.107	-1.046 3.574
	3.766	7.340		
ESTE			5.028	-2.308 2.312
			ERROR =	0.002

Tie

Pictures 0370 - 0372

1-5-06

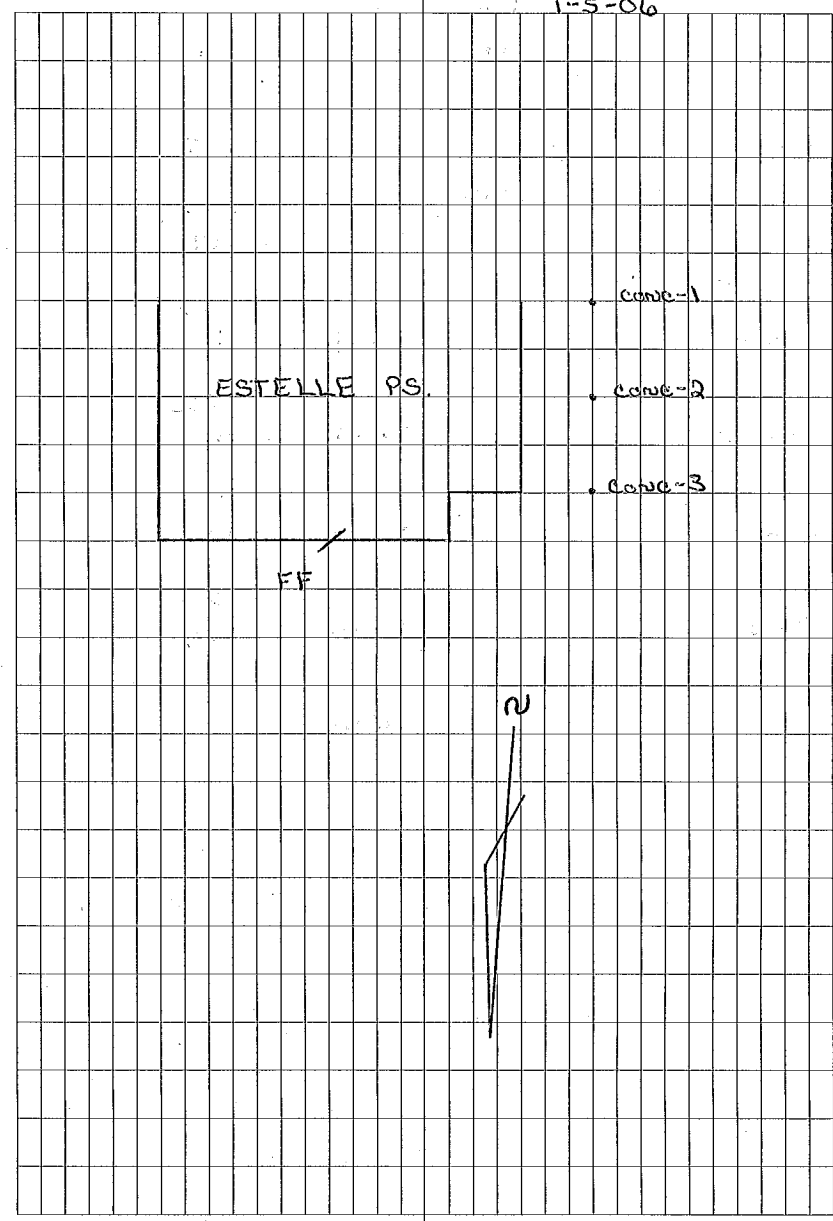

Sta	+	HERO HI	PS. -	Elev.
HERO				-4.275
	7.044	11.319		
conc-1			7.472	3.847
conc-2			7.448	3.871
conc-3			7.482	3.837
	7.079	10.916		
FF-1			2.903	8.013
FF-2			2.948	7.968
HERO			6.046	
			Error =	
			Tie	

1-8-06

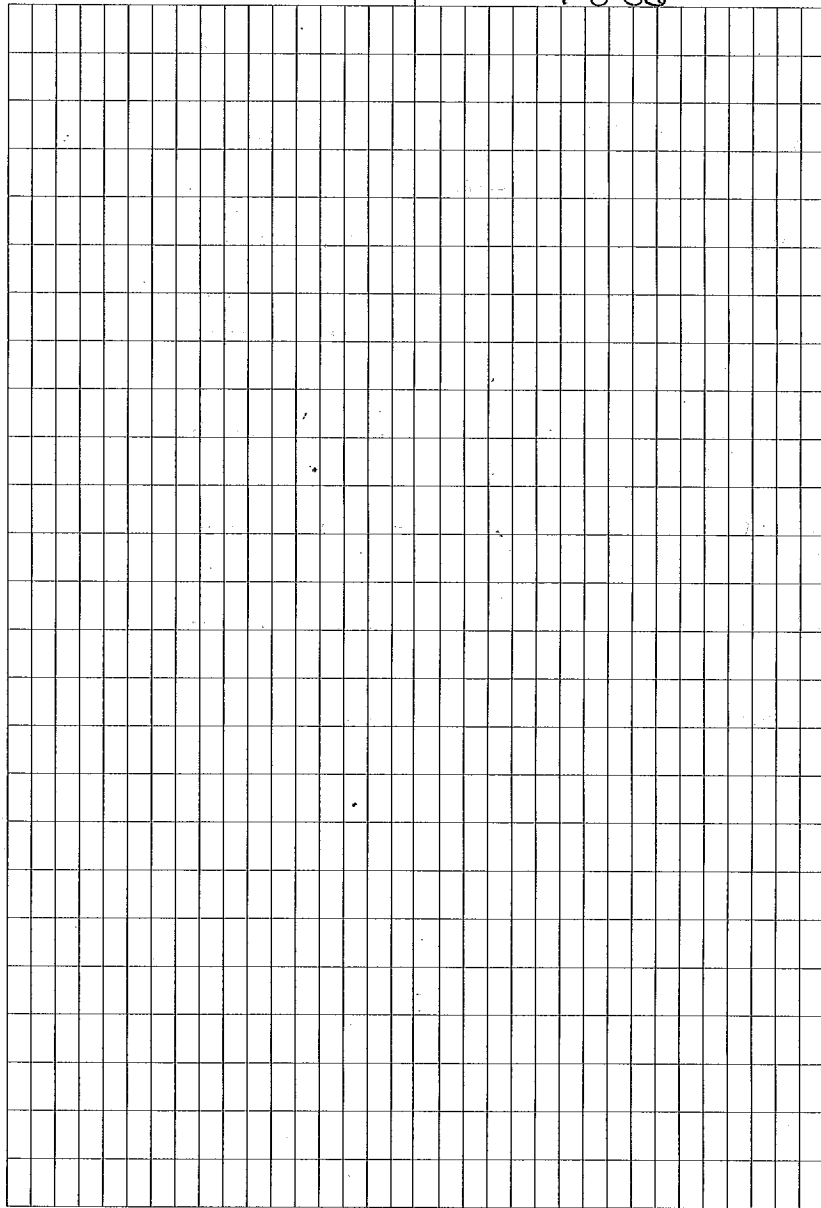
31

Sta	+	HI	-	Elev.
HERO				-4.275
	6.716	10.991		
conc-1			7.149	-4.708 3.842
conc-2			7.124	-4.683 3.867
conc-3			7.153	-4.712 3.838
	6.999	10.837		
FF-1			2.821	-0.534 8.016
FF-2			2.869	-0.582 7.968
				280
HERO			6.567	-4.452 4.270
			ERROR =	0.005

Tie

Pictures = 0387-0391

1-8-05

32

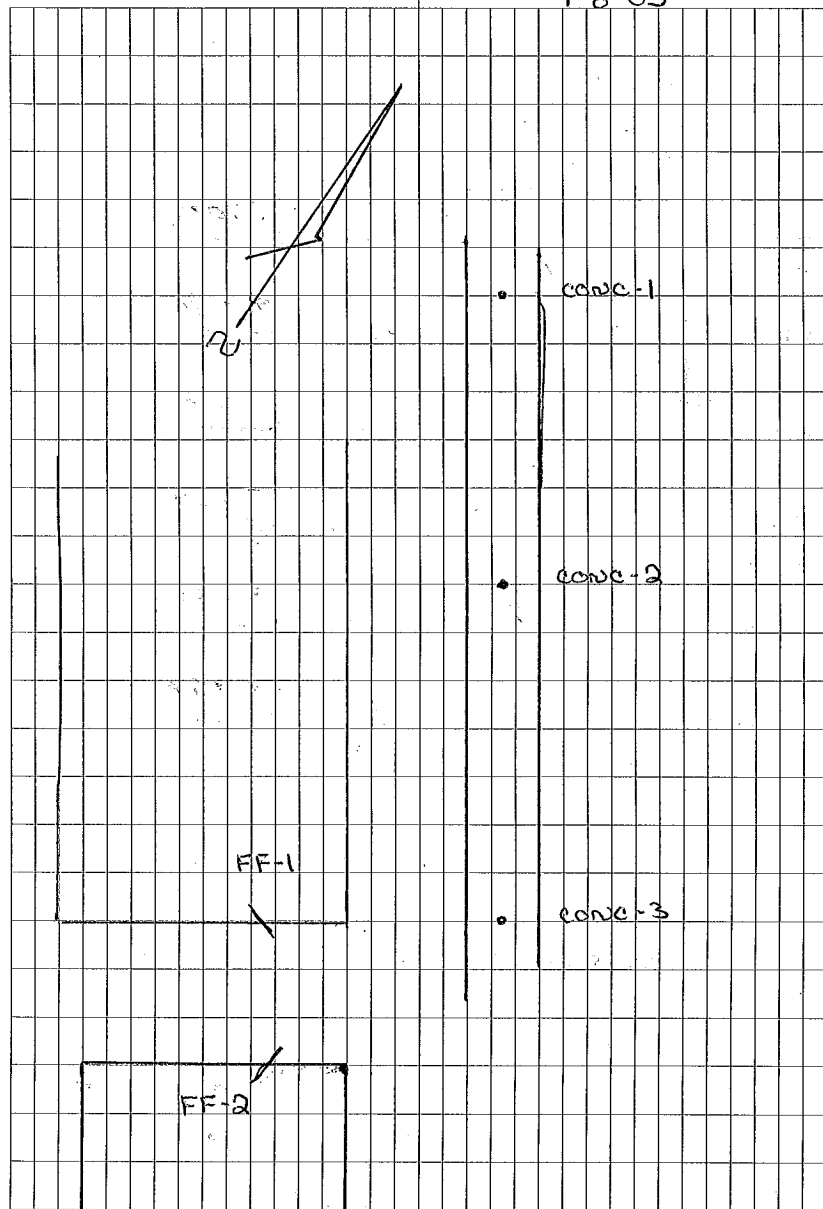

Whitely / ~~Barra~~
 Barra P.S.

Sta	+	HI	-	Elev.
BARR				-4.452
	4.887	9.339		
FF			3.454	-3.019 5.885
IP			5.031	-4.596 4.308
	5.524	9.832		
NG-1			4.611	-3.683 5.221
NG-2			4.082	-3.154 5.750
NG-3			4.066	-3.138 5.766
BARR			5.379	-4.451 4.453
			Error =	0.001

Tie

Pitcures 0.392 - 0.393

1-9-06

End 8.0011 = 73m Barra.

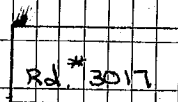
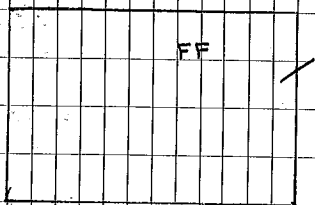

TAM BARR

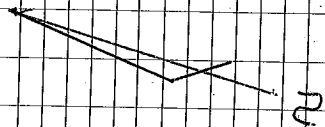

Planters P.S.

Sta	+	HI	-	Elev.
PLAN.				-3.317
	4.202	7.519		
T.P			4.362	-3.477 3.157
	5.700	8.857		1.937
FF			0.286	8.571
	0.440	9.017		
NG-1			7.154	-4.777 4.287
NG-2			7.448	-5.071 4.377
NG-3			7.291	-4.914 4.377
	6.369	8.789		
PLAN			4.766	-3.323 1.443
			Error =	0.006

Tie

Pictures 0394 - 0395

1-9-06

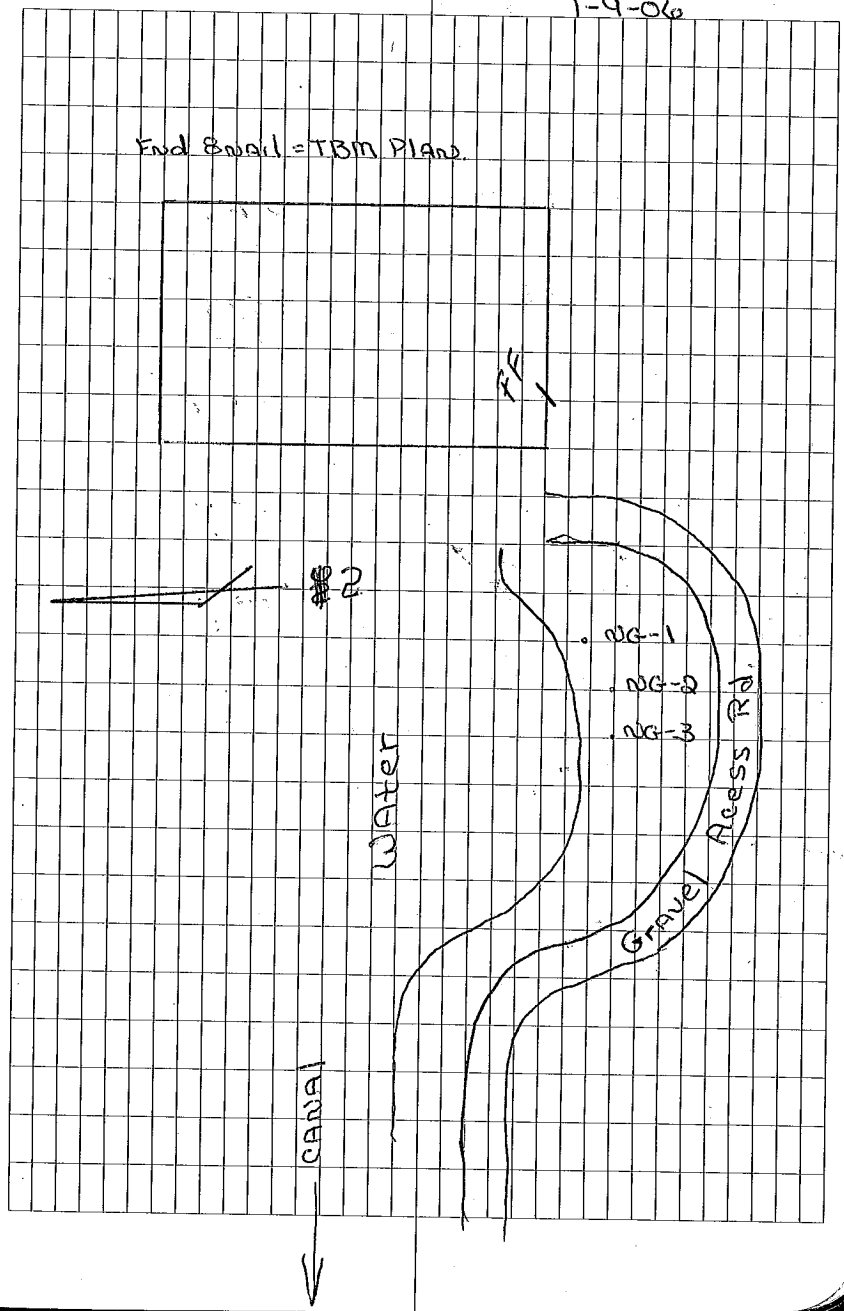

Sta	+	OP-13 P.S.	-	Elev.
OP-13				-6.476
	8.043	14.519		0.638
FF			0.929	13.590
	0.808	14.398		-5.639
NG-1			7.085	7.304
				-5.916
NG-2			7.362	7.027
				-6.175
NG-3			7.621	6.768
				-6.343
TP			7.789	6.609
	6.848	13.457		-6.474
OP-13			6.979	6.478
				Error = 0.002

Tie

Pictures 0396-0397.

1-9-06

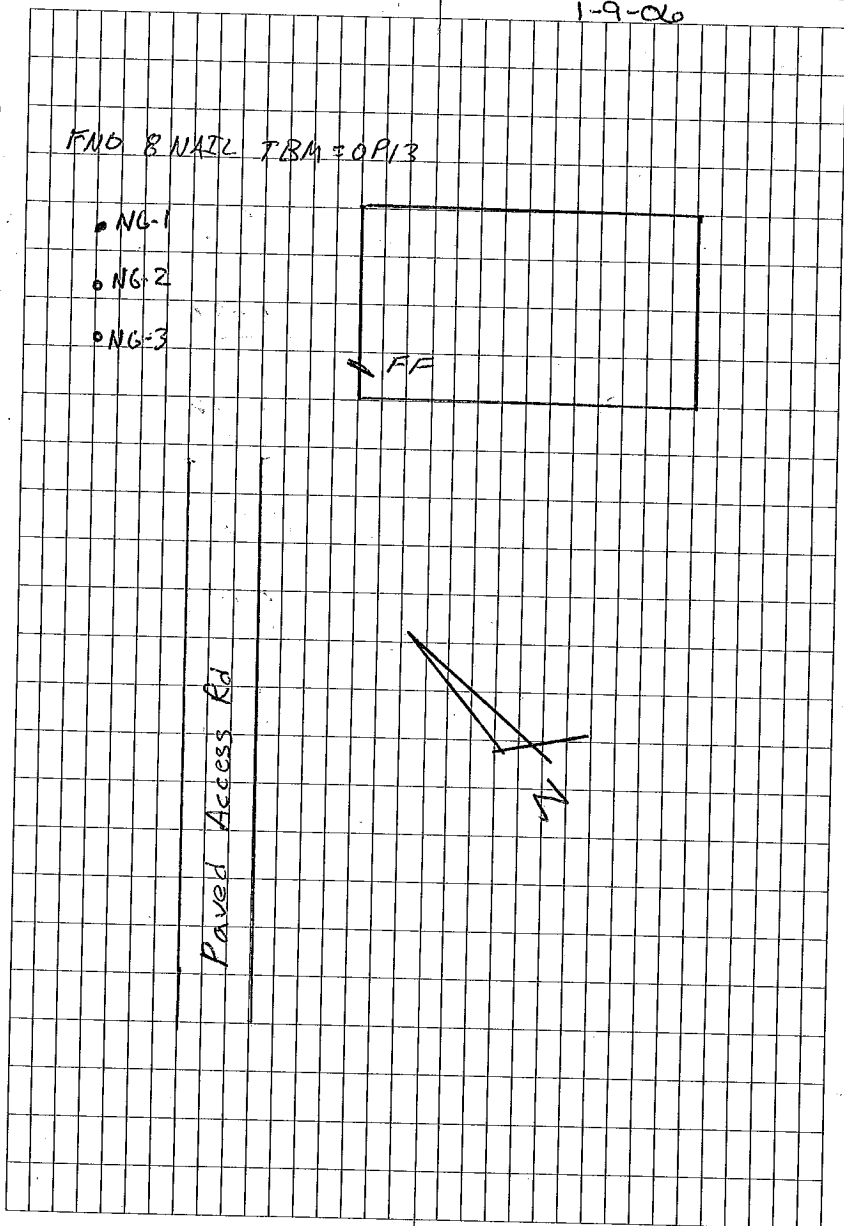

STA	+	II OP-13	PS.	-	Elev.
OP-13					-1.926
	5.263	7.189			
FF			0.721		6.468 2.616
ASP-1			4.879		8.310 -1.542
ASP-2			5.489		1.700 -2.152
ASP-3			5.425		1.704 -2.088
	5.152	6.916			
OP-11			4.999		-1.917 -1.935
			Error =		0.009

Tie

Pictures 0398-0399

1-9-06

Final 8 nail = TBM-OP11

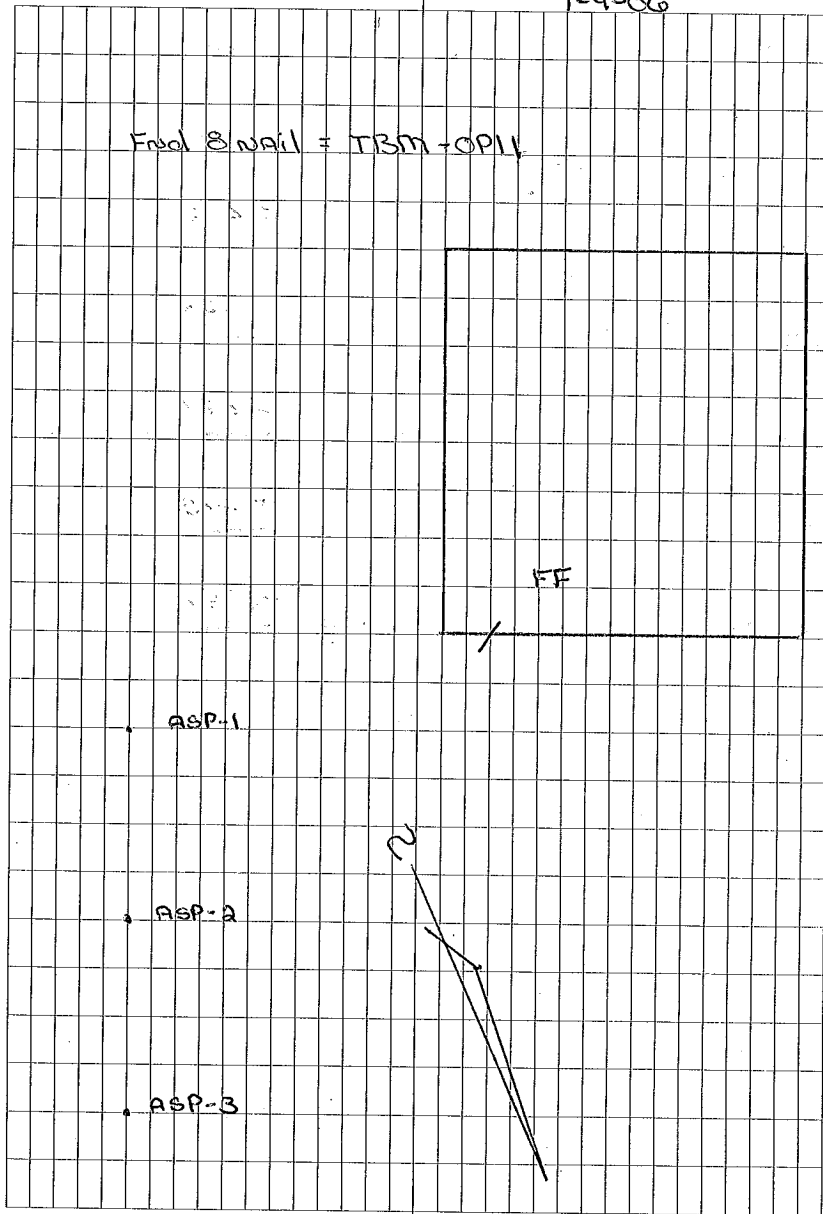

Belle Chase PS # 2.

Sta	+	HI	-	Elev.
BEI #2				-2.470
	6.153	8.023		2.295
I.P			1.388	7.235
	10.618	17.853		9.666
FF			3.247	14.606
	3.156	17.726		2.286
I.P			10.526	7.236
	0.660	7.896		-2.756
GRAV-1			5.702	2.194
				-2.548
GRAV-2			5.494	2.402
				-2.320
GRAV-3			5.266	2.630
				-2.462
BEI #2			5.408	-2.488
			Error =	0.018

Tie

Pictures 0400-0401

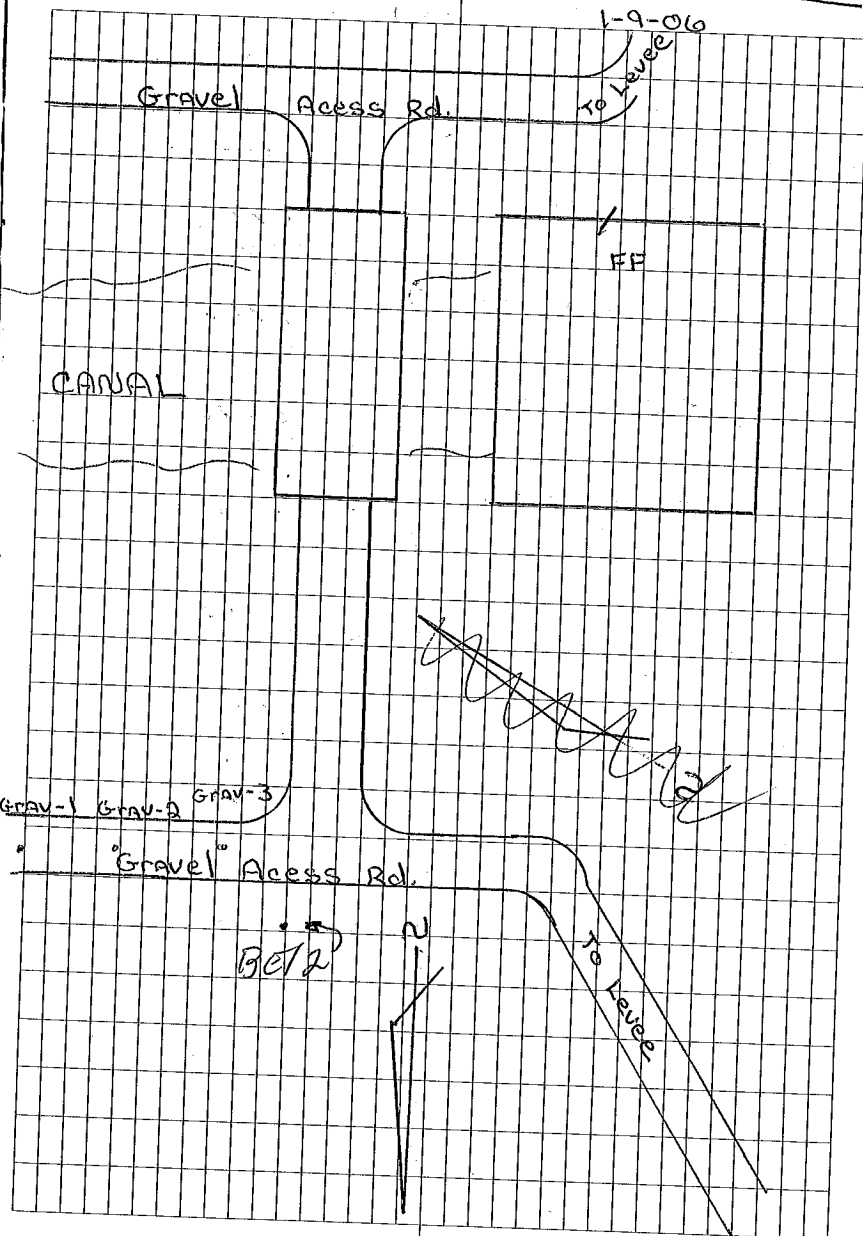

1-9-06

Belle Chase # 1				
STA	+	HI	-	Elev.
Bel # 1				-3.445 -3.415
	5.982	4.397		
I.P			5.783	-3.276 3.614
	8.082	11.696		
FF			0.061	4.805 11.635
	0.100	11.735		
I.P			8.083	-3.178 3.652
	5.609	9.201		
Grav-1			4.028	-1.597 5.233
Grav-2			4.344	-1.913 4.917
Grav-3			4.932	-2.501 4.329
Bel # 1			5.862	-3.431 3.399
				Error = 0.016
Tie				
Pictures 0402 - 0403				

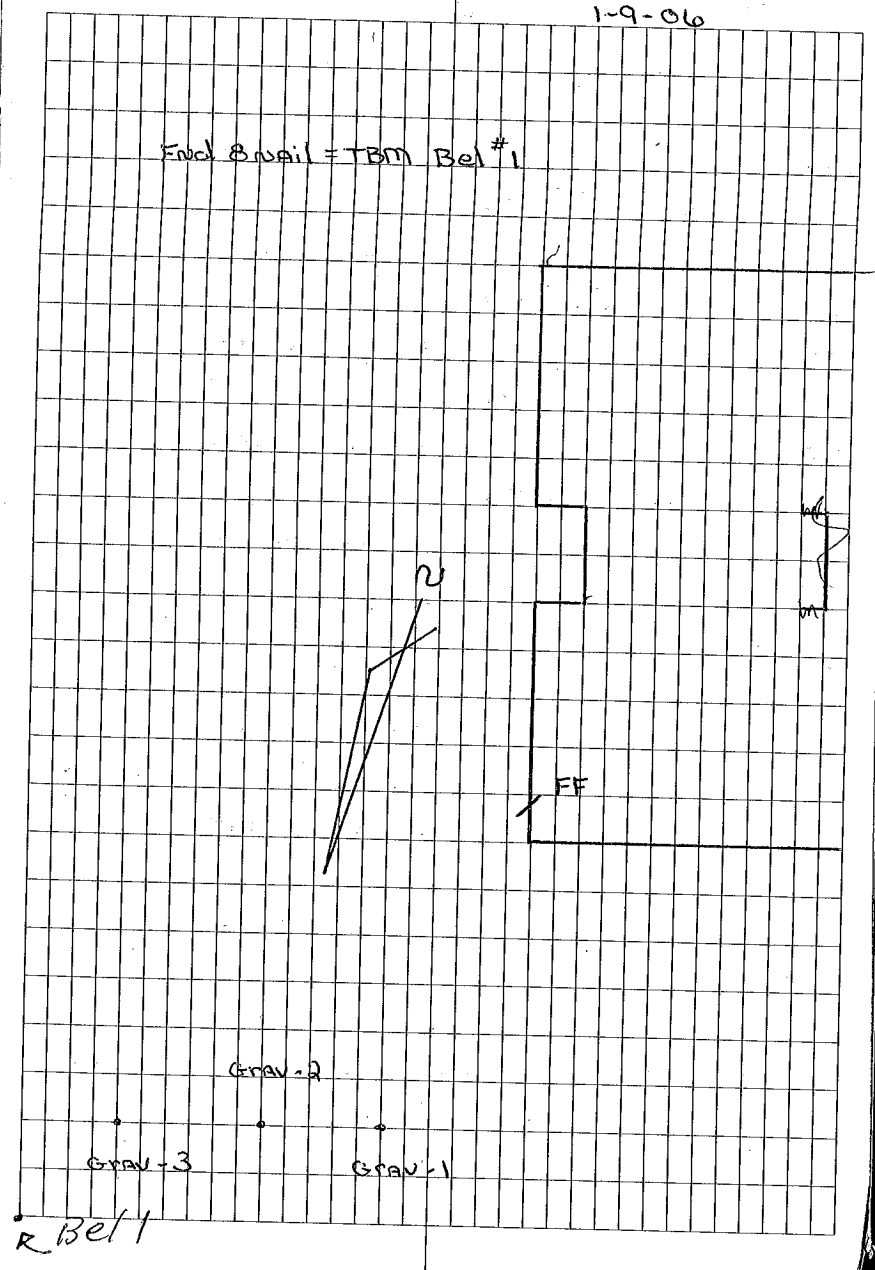

STA	+	OLLIE HI	# 2 PS. -	Elev.
OLL1				0.525
	6.068	6.593		
T.P			3.327	3.266
	10.124	13.390		
FF			3.867	9.523
	2.048	11.571		
T.P			8.321	3.250
	4.022	7.272		
Grav-1			5.079	2.193
Grav-2			5.424	1.848
Grav-3			5.752	1.520
OLL1			6.747	0.525
			Error =	0.000
Tie				
Pictures 0404 - 0405				

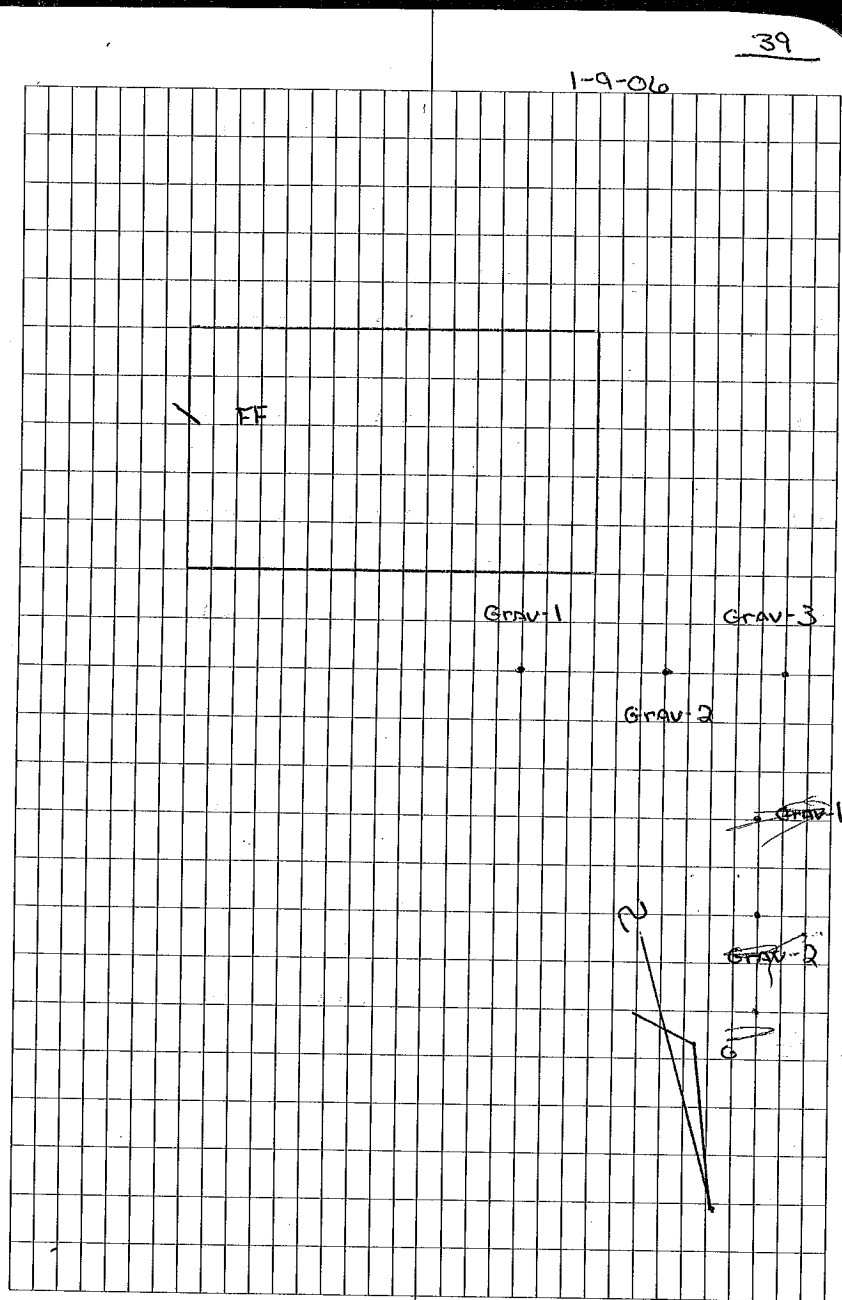

STA	+	OP-6	P.S.	-	Elev.
OP-6					-0.289
	5.856	6.195			1.264
T.P			4.303		1.842
	4.601	6.443			1.897
FF-1			3.968		2.475
	3.707	6.182			1.265
T.P			4.339		1.843
	4.617	6.460			0.853
FF-2			5.029		1.431
					4.752
FF-3			1.130		5.330
	1.043	6.373			0.777
ASP-1			5.018		1.355
					0.666
ASP-2			5.129		1.244
					0.546
ASP-3			5.249		1.129
					-0.284
OP-6			6.079		-0.294
					Error = 0.005

Tie

1-12-06

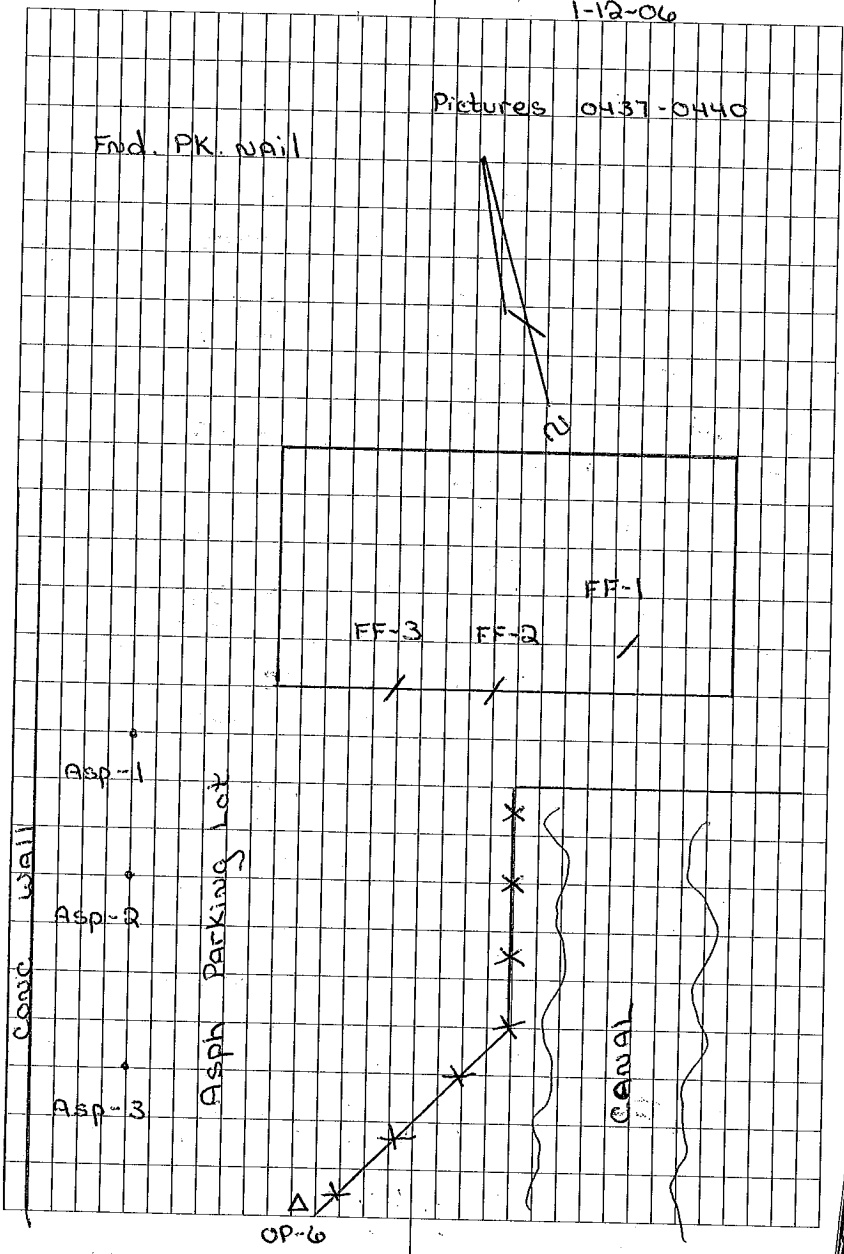

Sta	+	HI	-	Elev.
JP-01				-3.478
	4.998	8.476		
T.P			0.732	7.744
	10.544	18.288		
FF-1			8.462	9.826
	8.413	18.239		
T.P			10.494	7.745
	1.859	1.859 9.704		
T.P			0.616	8.988
	8.834	17.822		
FF-2			7.862	3.004 9.966
	7.801	17.761		
T.P			8.772	8.989
	0.174	9.163		
Asp-1			5.763	-3.556 3.400
Asp-2			5.769	-3.562 3.394
Asp-3			5.827	-3.620 3.336
JP-01			5.682	-3.475 -3.481
			Error =	0.003

Tie

41

1-11-06

Pictures 0441-0444

Fuel Tanks

Fuel Tanks

JP-01 P.S.

FF-1

Asp. Parking Lot

Asp Access Rd

CANAL

JP-01

2

Sta	+	HI	-	Elev.
JP-02				-2.848
	8.183	11.031		3.900
FF-1			1.435	9.596
	5.184	14.780		5.955
FF-2			3.129	4.651
	3.255	14.906		9.596
T.P			5.310	9.596
	1.386	10.982		0.212
Grav-1			5.074	5.908
				-0.816
Grav-2			6.102	4.880
				-1.338
Grav-3			6.624	4.358
				-2.838
JP-02			8.124	2.858
				Error = 0.010

Tie

1-11-06

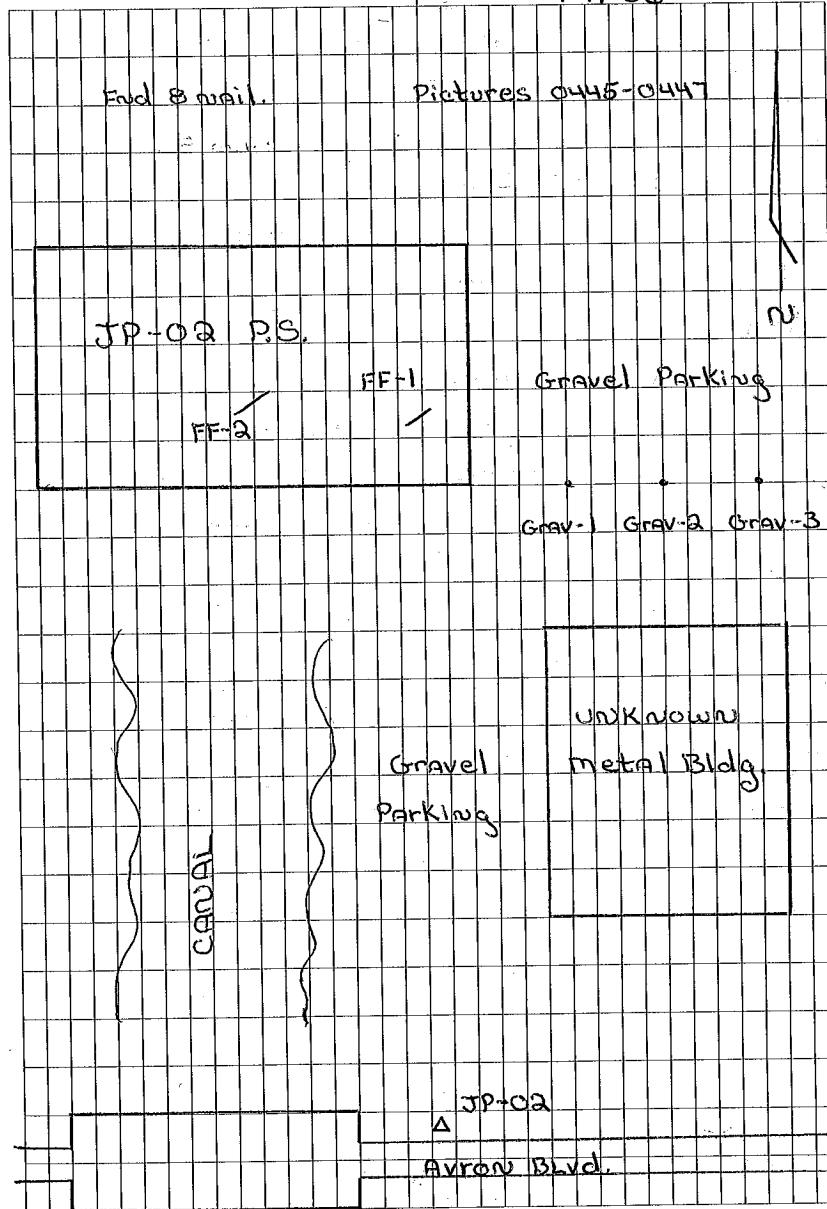

Sta	+	HI	-	Elev.
JP-03				-5.400
	7.647	13.047		
T.P			3.449	9.598
	12.082	21.680		
FF-1			5.009	5.871 10.671
	4.823	21.494		
FF-2			5.941	4.753 15.553
	6.087	21.640		
T.P			4.969	10.671
	5.029	21.700		
T.P			12.318	9.382
	4.382	13.764		
Grav-1			4.607	-1.643 9.157
Grav-2			4.786	-1.822 8.978
Grav-3			5.582	-2.618 8.182
JP-03			8.353	-5.389 5.411
			Error =	0.011
Tie				

1-11-06

Pictures 0448-0451

Fwd 8 nail

FF-1 is on the old section of P.S.

FF-2 is on the new addition of P.S.

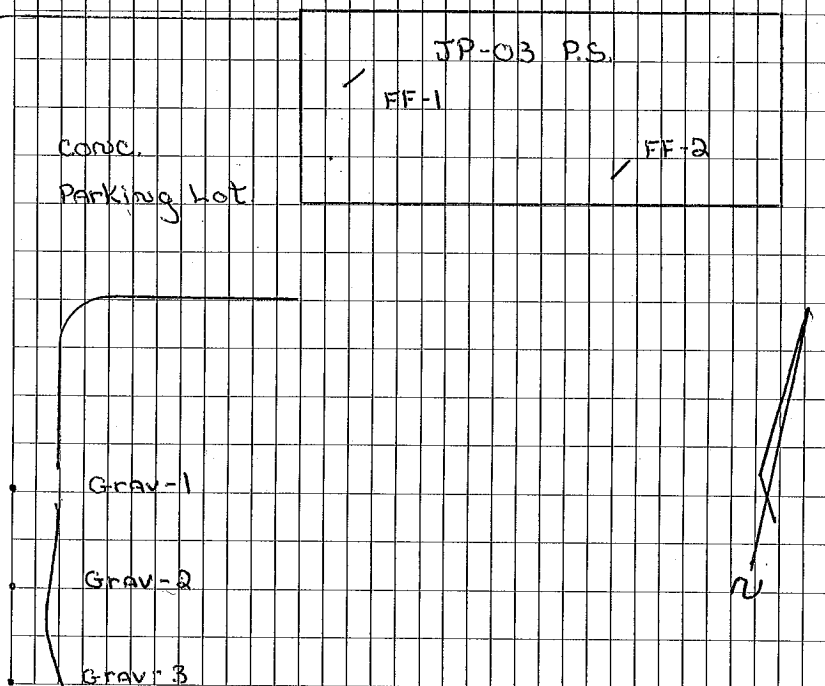

Sta	+	HI	-	Elev.
JP-04				-4.160
	4.389	8.549		
T.P			5.007	3.542
	4.623	8.165		
T.P			0.442	4.723
	11.521	19.244		
FF-1			4.721	6.203
	4.791	19.314		11.523
FF-2			8.270	2.724
	8.167	19.211		11.044
T.P			4.685	14.526
	4.325	18.851		
T.P			11.128	7.723
	0.739	8.462		
Asp-1			4.810	-4.668
				3.652
Asp-2			4.565	-4.423
				3.897
Asp-3			4.127	-3.985
				4.335
	4.378	8.713		-4.155
JP-04			4.548	-4.165
			Error =	0.005

Tie

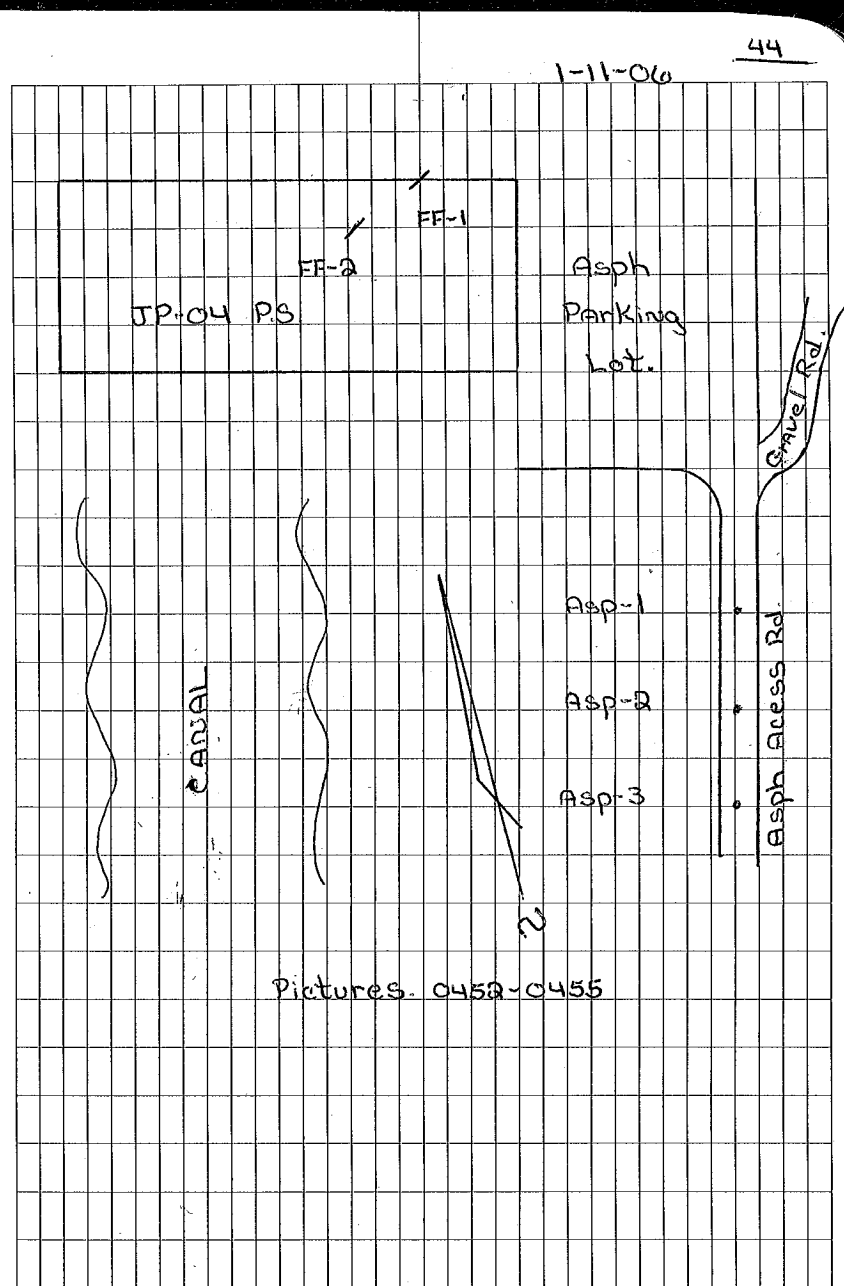

STA	+	PL PS	-	Elev.
PLPS				-6.165
	11.443	17.608		
T.P			0.629	16.979
	9.736	26.715		
FF-1			4.778	9.607 21.937
	4.614	26.557		
T.P			9.578	16.973
	0.623	17.596		
T.P			11.174	6.422
	4.145	10.567		
FF-2			3.621	-5.387 6.946
	3.800	10.746		
APH-1			5.095	-6.679 5.659
APH-2			5.249	-6.833 5.497
APH-3			5.241	-6.825 5.505
PLPS			4.573	-6.157 6.113
			Error =	0.008
Tie				

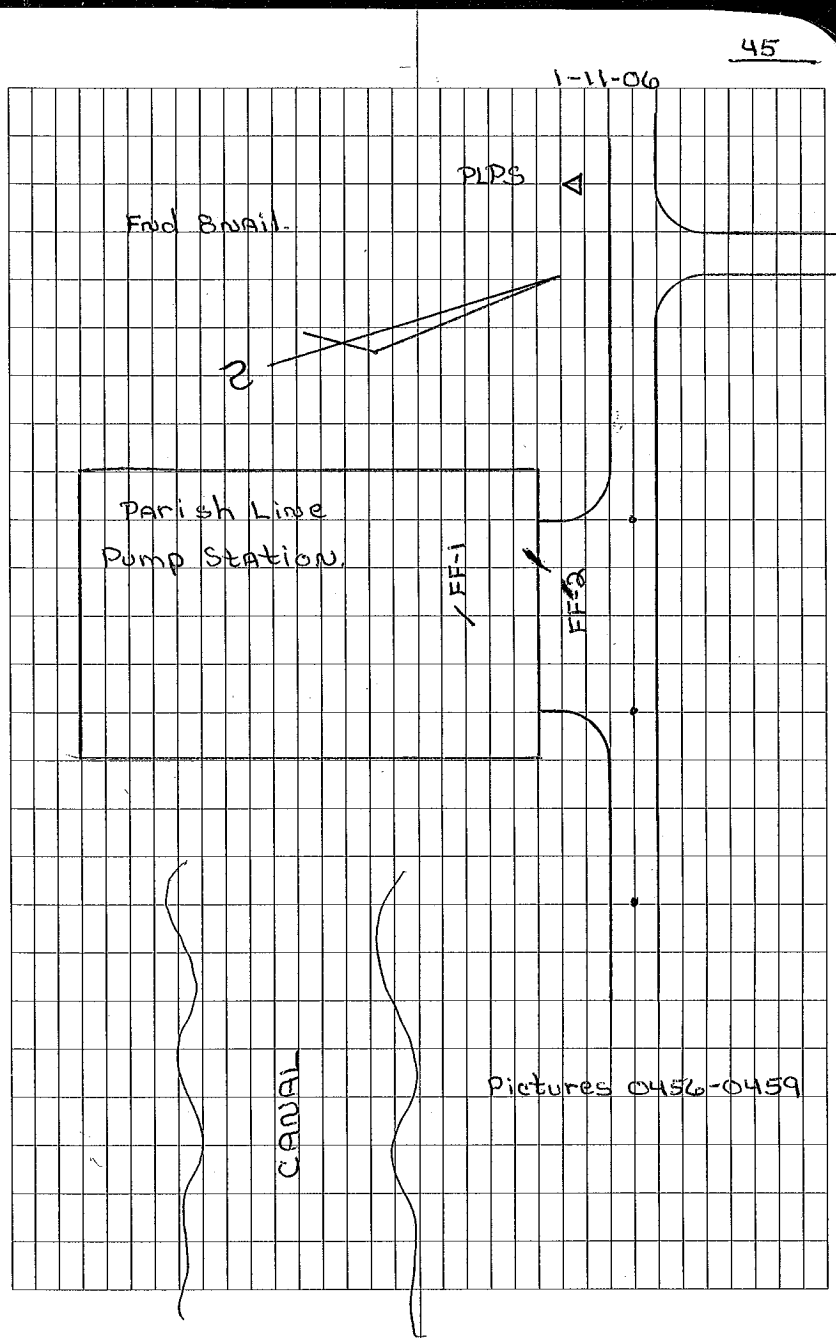

12/22/05 (46)

OP#6 to TBM META

For 17th St. Canal Low Corod's
 STA + Hgt. — Elev.

OP#6 -0.289

	10.40	10.111		
TP			8.41	1.701
	3.92	5.621		
TP			5.45	0.171
	6.18	6.351		
TP			3.71	2.641
	4.61	7.251		
TP			4.81	2.441
	5.64	8.081		
TP			5.60	2.481
	5.40	7.881		
TP			4.81	3.071
	5.21	8.281		
META			3.45	4.831
	3.168	7.999		
TP			3.382	4.617
	3.029	7.646		
TP			3.302	4.344
	3.309	7.653		
TP			4.696	2.957

PK MARK @ OP#6 Pump Station

TBM META - PAINT MARK ^{NEAR} N. END
 CORNER OF METARIE RD BRIDGE
 OVER 17th St. Canal.

Levels Cont.

STA +	H.L.		- Elev.
TP			2.957
	3.959 6.916		
TP		5.876	1.040
	5.067 6.107		
TP		2.708	3.399
	5.332 8.731		
TP		2.902	0.829
	4.748 5.577		
OP66		5.843	-0.266 F
			-0.289 G
			+0.023 E