

Smithsonian
Institution

2009 Group Tour & Visitor Information

**Group Sales Office
Contact Us
(866) 868-7774
groupsales@si.edu
www.si.edu/group_tours**

Theaters & Attractions

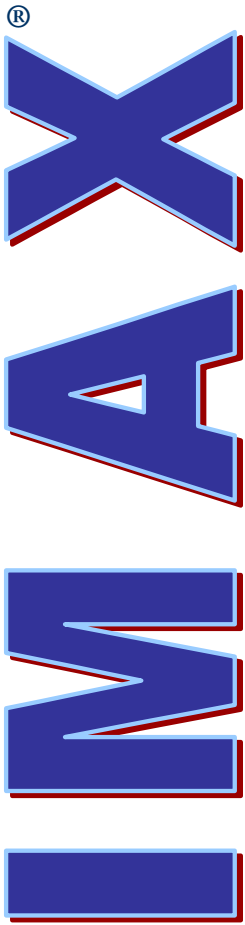

IMAX® Theater

*Steven F. Udvar-Hazy Center
National Air and Space Museum
Chantilly, VA*

Lockheed Martin IMAX® Theater

*National Air and Space Museum
The National Mall
Washington, DC*

Johnson IMAX® Theater

*National Museum of Natural History
The National Mall
Washington, DC*

Einstein Planetarium

*National Air and Space Museum
The National Mall
Washington, DC*

Ride Simulator and Interactive Flight Simulators

*National Air and Space Museum
The National Mall
Washington, DC*

Ride Simulator and Interactive Flight Simulators

*Steven F. Udvar-Hazy Center
National Air and Space Museum
Chantilly, VA*

Group Rates

A group consists of ten (10) or more people for any IMAX or Planetarium show and twenty (20) for our dining packages. All groups will receive one (1) complimentary ticket per every twenty purchased. The Group IMAX/Planetarium rate for all shows under 1 hour in length is \$6.00 per ticket. All groups will be charged a one time processing fee of \$6.00 per order. Payment must be received in Full one (1) week prior to group's arrival. For listings and show times, visit us at www.si.edu/imax.

Shipping Fees

Groups may now have their IMAX, Planetarium, or Group Dining tickets shipped to their location. For shipping deadlines and additional fees please contact the Group Sales office at 866-868-7774

ON DEMAND

View a special morning screening of your favorite IMAX film or Planetarium show at our Smithsonian Theaters. They are located both on the Mall in Washington, DC and in Chantilly, VA. Select a current film, or choose from our IMAX/Planetarium Adventure Library. IMAX/Planetarium **On Demand** screenings are offered for groups of 50 or more every morning at 9:30 am.

Title i Outreach

Outreach tickets are designed for **Title One schools** that find it difficult to encompass fee oriented programs with their regular schedule of events. Give your school a **Smithsonian Experience**. We offer a discounted ticket price of **\$3.00 per person**. That is half off the already discounted group sales rate. Feature length films (over one hour in length) are excluded. Also, take advantage of our Outreach "Movie and a Meal". Groups may attend an IMAX film and enjoy lunch for only **\$6.00 per person**. Call for details.

For questions on these or other available programs call 202-633-IMAX or go to www.wi.edu/group_tours.



Butterfly + Plants: Partners In Evolution — a fee-based, live butterfly experience.

Take a stroll among live butterflies and exotic plants! This tropical oasis offers visitors a rare opportunity to get close to a variety of living butterflies from all over the world. Purchase tickets in advance to avoid sold out time-slots. Tickets are required and are timed-entry at 15-minute intervals.

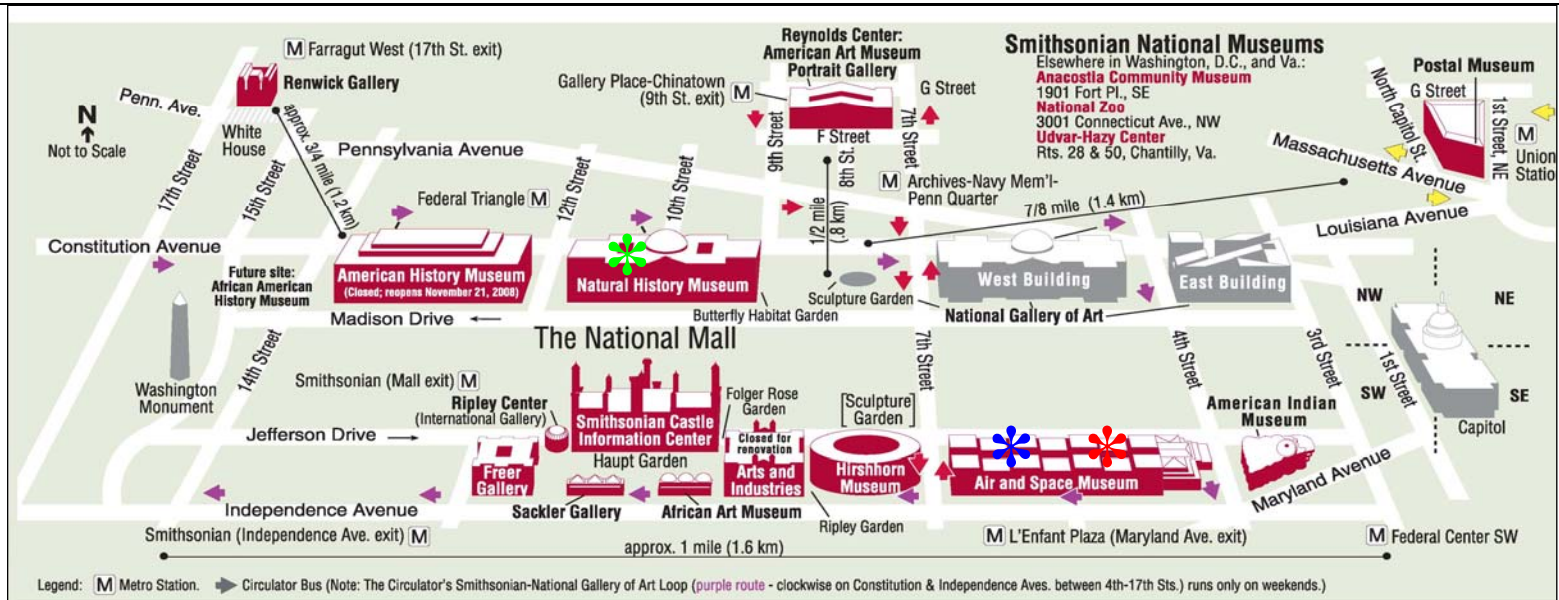

* = Lockheed Martin IMAX Theater

* = Einstein Planetarium

* = Johnson IMAX Theater

Dining Packages

National Air and Space Museum
McDonald's® & McCafé® Restaurants

National Museum of the American Indian
Mitsitam Café

National Museum of Natural History
Atrium Café

Donald W. Reynolds's Center for American Art and Portraiture
Courtyard Café

Both the Air and Space Museum in (DC) and the Air and Space Museum's Steven F. Udvar-Hazy Center in Chantilly, VA, feature: hamburgers, French fries, pizza (DC only), and salad, as well as various espressos, lattes, and desserts.

McDonald's 1: Choice of Big Mac®, Filet-O-Fish®, Double Cheeseburger, or 6-Piece Chicken McNuggets® with medium fries, 21 oz. soft drink and McDonald's cookies. (\$7.50)

McDonald's 2: Choice of Crispy or Grilled McDonald's Salad with 21 oz. soft drink and McDonald's cookies. (\$9.00)

McDonald's 3: (Smithsonian Kid's Meal) Smithsonian Kid's Meal to include choice of hamburger, cheeseburger, or 4-pc Chicken McNuggets® with small fries, soft drink and exclusive Smithsonian toy. (\$5.25)

***Outreach Meal:** hamburger with small fries, soft drink and exclusive Smithsonian toy. (\$3.00)

*** Title One Schools Only**

BULK MEALS: *Minimum order of 100 (no comps)* Choice of Big Mac®, Filet-O-Fish®, Double Cheeseburger, Southern Style Chicken Sandwich or 6-Piece Chicken McNuggets® all served with small Fries, or choice of Crispy or Grilled McDonald's Salad or 7" *Cheese or *Pepperoni Pizza and 21 oz. soft drink. (\$7.00)

***NOT available at the Udvar-Hazy Center**



The Udvar-Hazy Center
 Chantilly, VA

"Mitsitam" means "Let's eat!" in the Native language of the Delaware and Piscataway peoples. The museum's Mitsitam Native Food Café enhances the museum experience by offering Native-inspired cuisines from five regions of the Western Hemisphere



Menu A: Choice of a Campfire Buffalo Burger or Fried Chicken Tenders with Fries, Whole Fruit and a Fountain Beverage **or** 2 Tacos with 2 sides, Whole Fruit and a Fountain Beverage. (\$10.00)

Menu B: Choose any Entrée with two Sides, Fountain Beverage, and Dinner Roll/Corn Bread. (\$16.50)



The Atrium Café features natural and sustainable foods including natural beef burgers, rotisserie chicken, pizza, sandwiches, salads, desserts etc.

Menu 1: Choice of Grilled Hamburger, Cheeseburger, Hot Dog or Large Slice of Pizza with Whole Organic Fruit and 20 oz. Fountain Beverage. (\$9.00) (Fries not included.)

Menu 2: Choice of Gourmet Sandwich or Chicken Caesar or All Natural Roasted Chicken with Two Sides. Choice of Jumbo Cookie or Whole Organic Fruit and 20 oz. Fountain Beverage. (\$13.00) (Fries not included.)

Outreach Meal: Choice of Hot dog or Small Slice of Cheese or Pepperoni Pizza served with Whole Organic Fruit and 20 oz Fountain Beverage. (\$3.00) (Fries not included.)

Title One Schools Only

BULK MEALS: *Minimum order of 100 (no comps).* Choice of Grilled Hamburger, Cheeseburger, Hot Dog, Chicken Caesar or Large Slice of Pizza with Whole Organic Fruit and 20 oz. Fountain Beverage. (\$8.50) (Fries not included.)



The Courtyard Café features a variety of specialty sandwiches and more served under an elegant glass canopy in the newly renovated Kogod Courtyard.



Option 1: Choice of Pre-Made Sandwich or Salad; all sandwiches served with Miss Vickie's Original Recipe Chips, whole fruit and 20 oz. bottled drink. (\$11.00)

Option 2: Choice of Gourmet Deli Sandwich Made -To-Order served with Miss Vickie's Original Recipe Chips, Homemade Chocolate Chip Cookie and 20 oz bottled drink. (\$12.50)

Option 3 (Kids Meal): Peanut Butter & Jelly Sandwich served with Whole Fruit and 20 oz bottled drink or milk. (\$ 5.50)

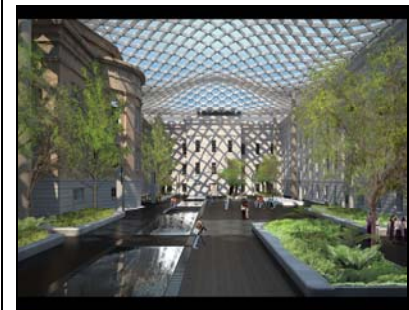

Contact Us
 (866) 868-7774
groupsales@si.edu
www.si.edu/group_tours

2009 TOUR & VISITOR INFORMATION

Museums and Exhibitions

Upcoming Exhibitions

(dates subject to change)

Air and Space Museum, The National Mall

America by Air
New Permanent

American Art Museum

Georgia O'Keeffe and Ansel Adams:
Natural Affinities
September 26, 2008 - January 4, 2009

American Indian Museum

Fritz Scholder: Indian/Not Indian
November 1, 2008–August 16, 2009

Anacostia Community Museum

Jubilee: African American Celebration
December 7, 2008 – September 20, 2009

Hirshhorn Museum & Sculpture Garden

Louise Bourgeois
February 26, 2009 - May 17, 2009

National Portrait Gallery

One Life: The Mask of Lincoln
November 7 – July 5, 2009

Postal Museum

Postal Inspector: The Silent Service
February 7, 2007 - February 28, 2009

Renwick Gallery

The Art and Craft of Greene & Greene
March 13 - June 7, 2009

S. Dillon Ripley Center

Road to Freedom
Photographs of the Civil Rights Movement, 1956 – 1968
Organized with the National Museum of African American History and Culture

Open - November 21, 2008

The National Museum of American History

www.americanhistory.si.edu

The museum, after a two year renovation, has reopened with an updated and stunning new look. It is home to the Star-Spangled Banner, now shown majestically in its own chamber that creates a sense of being flown in "the dawn's early light." The flag joins the first ladies gowns, Lincoln's top hat, Dorothy's ruby slippers, trains, and cars in a gleaming new environment. A five-story skylight breathes life into the museum, and objects rarely seen before are now displayed in artifact walls throughout the galleries. Cafes and stores serve visitors.



National Portrait Gallery and Smithsonian American Art Museum

www.reynoldscenter.org

In July 2006, the Smithsonian opened the Donald W. Reynolds Center for American Art and Portraiture, home to the National Portrait Gallery and the Smithsonian American Art Museum.

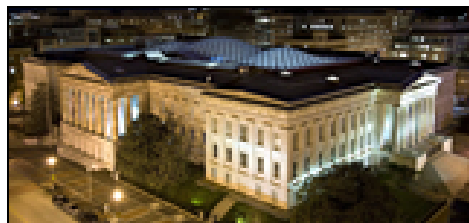

Housed in the historic Patent Office Building, the museums offer visitors a chance to watch conservators at work in a visible conservation center, walk through collections in open storage, and dine in the beautiful and relaxing Courtyard Café.

National Museum of the American Indian

www.nmai.si.edu

The Smithsonian's National Museum of the American Indian (NMAI) is on the National Mall in Washington, D.C., between the National Air and Space Museum and the U.S. Capitol. The museum offers programs and displays artifacts that reflect the life, arts, culture, and history of the Native people of the Western Hemisphere. Dine at the Mitsitam Café on meals based on native traditions.

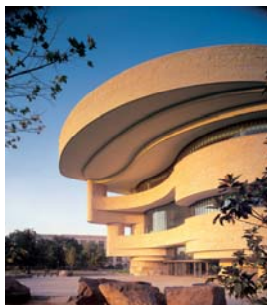

National Museum of Natural History

www.nmnh.si.edu

Known for housing treasures such as the Hope Diamond and exhibit halls devoted to mammals, dinosaurs, fossils, and minerals, a live butterfly pavilion has now opened and as of September 29, 2008, a fabulous new **Sant Ocean Hall**. Visitors learn how experts predict changes in the Earth's environment and how to conserve and manage coastal and marine resources.



Photo by: Dane A. Penland 2004 Steven F. Udvar-Hazy Center

The Smithsonian Institution is the world's largest museum complex. Visit our 16 museums and the National Zoo in Washington, D.C., two museums in New York City and one museum in Chantilly, VA.

Admission to our Smithsonian museums in Washington, D.C., is always free. Most museums are open daily from 10 am–5:30 pm; the Anacostia Community Museum is open 10 am–5 pm; the National Portrait Gallery and the Smithsonian American Art Museum are open 11:30 am–7 pm. All are closed on December 25. Summer hours are determined annually. For more information contact Katherine Neill Ridgley, Director, Visitor Information & Associates; Reception Center, at (202) 633-5262 or ridgleyk@si.edu, or visit our Website at www.si.edu/visit.



Photo by: Jeff Tinsley 1990

Smithsonian Castle



Smithsonian Institution

Start your group visit at the Smithsonian Information Center In the Castle. Open daily from 8:30 am to 5:30 pm. Our Center offers video orientation, maps, interactive kiosks, city models, and friendly volunteers to assist you.

Contact Us

(202) 633-1000

info@si.edu