

NOTES:

1. For periods as noted in Table A, pavement may be unmarked if appropriate vehicle positioning guides are provided.
2. Typical spacing between Vehicle Position Guides is 40 ft as shown. In areas of severe curvature the spacing is 20 ft. Areas of severe curvature are shown in the plans or provided in the Vehicle Positioning Guide Schedule.
3. See Section 718.21(b) requirements for vehicle positioning guides.
4. When ADT > 1000 and special hazards are present, supplement the R4-1 sign at the beginning of each no passing zone with a W14-3 sign mounted on the left of the roadside.
5. Repeat R4-1 at 3,000 ft intervals minimum.

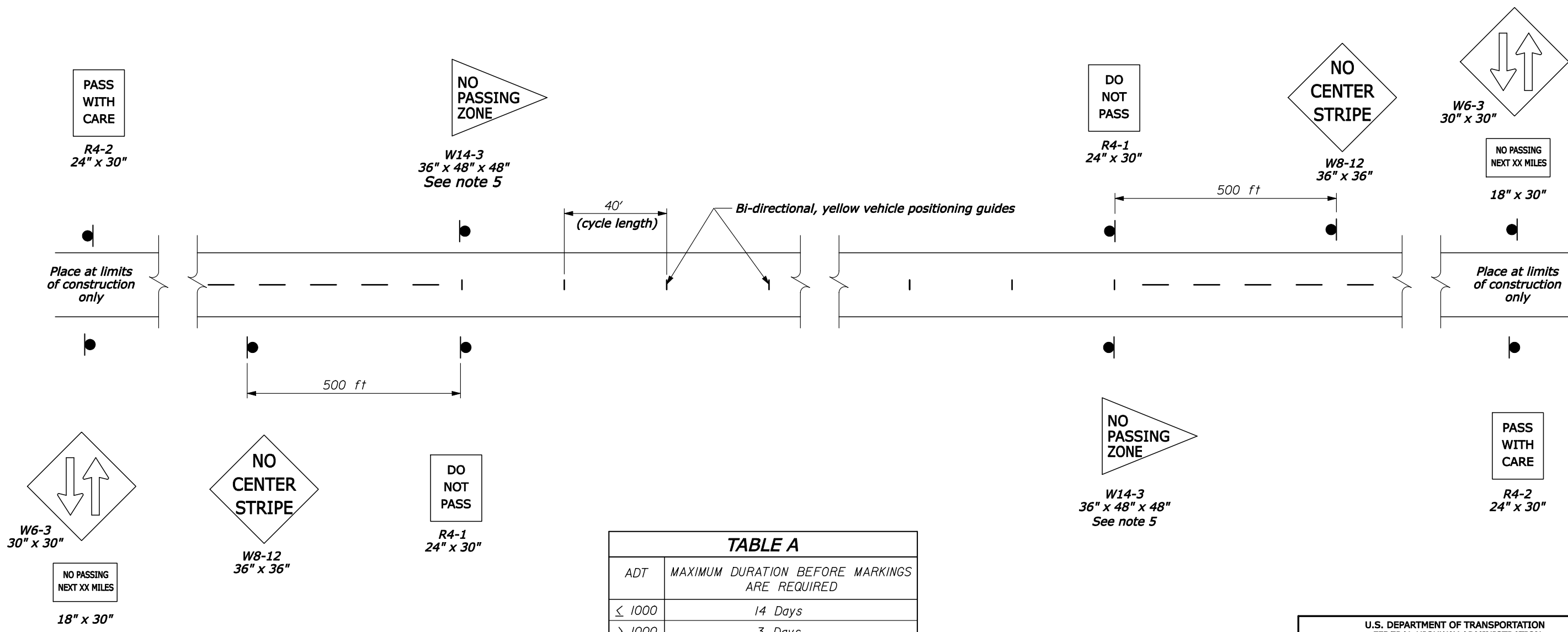

ADT	MAXIMUM DURATION BEFORE MARKINGS ARE REQUIRED
≤ 1000	14 Days
> 1000	3 Days

NO SCALE

U.S. DEPARTMENT OF TRANSPORTATION
 FEDERAL HIGHWAY ADMINISTRATION
 EASTERN FEDERAL LANDS HIGHWAY DIVISION

U.S. CUSTOMARY DETAIL

**VEHICLE POSITIONING GUIDES
 FOR TEMPORARY USE WITH
 UNMARKED PAVEMENTS**

DETAIL APPROVED FOR USE 02/2007

REVISOR: 5/02 02/07

DETAIL
 E635-14