

**RURAL AREA**

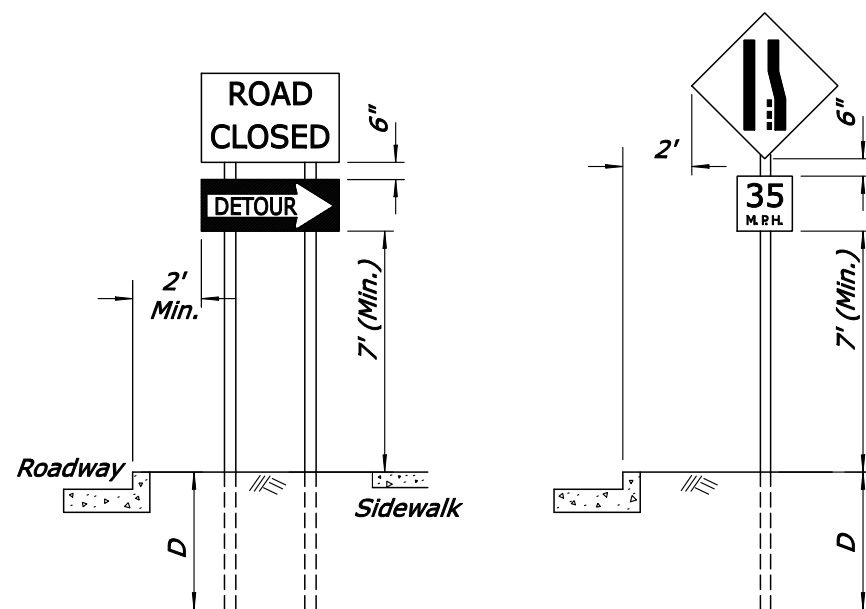

**URBAN AREA**

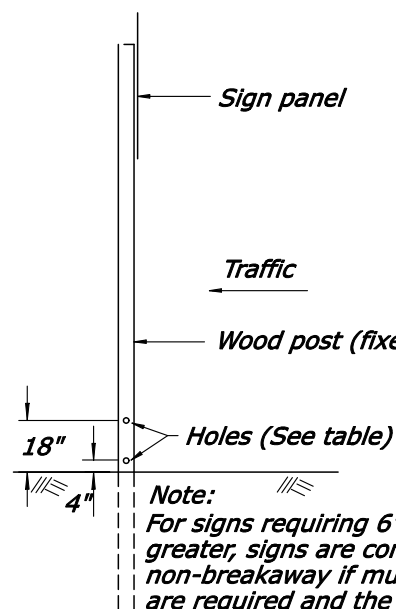

**BREAKAWAY SUPPORT DETAIL**  
(FIXED SIGNS - 4" x 6" AND GREATER POSTS)

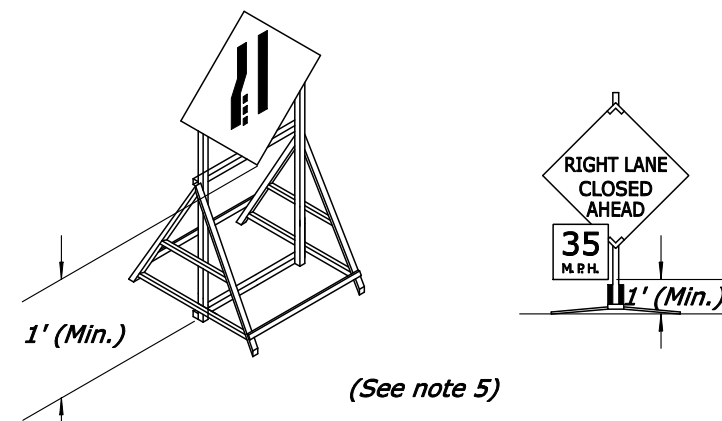

**PORTABLE SIGNS**  
(See note 4)

**Notes:**

1. Wood posts are 4"x 4" unless otherwise indicated.
2. Mount signs that are wider than 3-feet or larger than 10 square feet on double posts.
3. All lumber dimensions are nominal.
4. The Contractor may submit alternate details for portable signs, however, sign mounts hold the sign face in a vertical plane. Portable signs may be mounted lower than fixed signs when approved by the CO. Ensure all portable sign supports meet the requirements of NCHRP-350 for crashworthiness.
5. When parking is permitted within 200 feet of the sign, mount the sign a minimum of 7 feet above the pavement surface.
6. When approved by the CO and the Utility Company, utility poles may be used for sign mounting.
7. For posts greater than 4" x 4" see the Breakaway Support Detail. If breakaway design cannot be used, due to post spacing, the sign should be placed outside the clearzone or be shielded by barrier. Do not place holes in posts of non-breakaway signs

**FIXED ROADWAY SIGNS**

Post size	D	Hole Dia.	Maximum Sign Area - Sq. ft.			
			1 Post	2 Posts	3 Posts	4 Posts
4" x 4"	4'	None Req'd	10	20		
4" x 6"	4'	1.5"		35	50	70
6" x 6"	5'	2"		50	75	100
6" x 8"	5'	3"		85	125	165

NO SCALE

U.S. DEPARTMENT OF TRANSPORTATION FEDERAL HIGHWAY ADMINISTRATION EASTERN FEDERAL LANDS HIGHWAY DIVISION	
U.S. CUSTOMARY DETAIL	
<b>CONSTRUCTION TRAFFIC CONTROL SIGN MOUNTING</b>	
DETAIL APPROVED FOR USE 02/2007	DETAIL
REVISED: 02/07 06/07	E635-01