

DETAIL A
Passing zone both directions
Two-way traffic

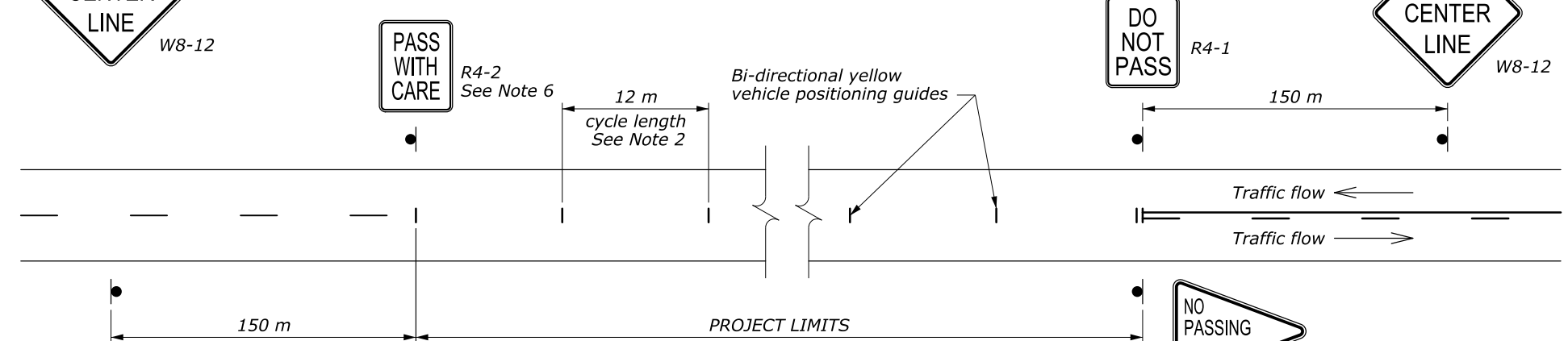

DETAIL B
No Passing zone one direction
Two-way traffic

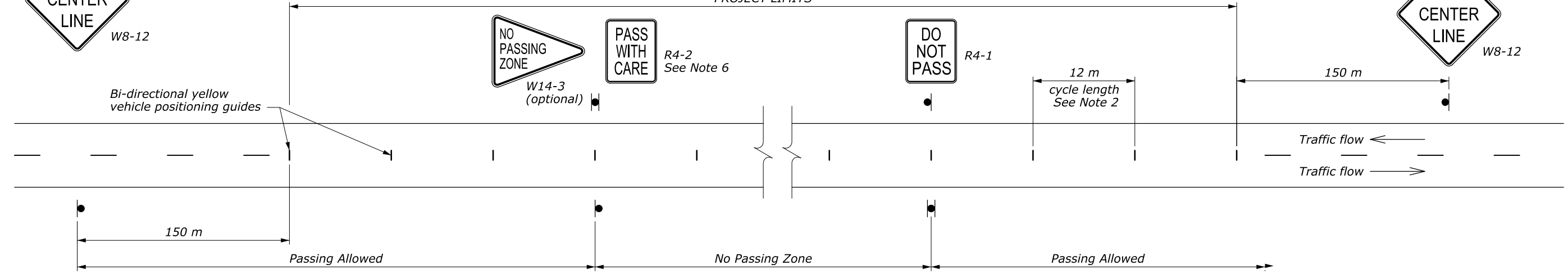

DETAIL C
No Passing zone both directions
Two-way traffic

NOTE:

1. For periods noted in Table A, pavement may be unmarked if vehicle positioning guides and signing are provided per this detail. For longer periods/higher ADT or for application of temporary markings with paint or tape, use Standard M635-2.
2. On curves with radius less than 150 m, reduce cycle length to 6 m.
3. Use permanent markings plan to determine no passing zones for each direction of travel.
4. Repeat R4-1 at 1.5 km intervals.
5. Repeat W8-12 after each major intersection and every 3 km for temporary traffic control zones greater than 5 km long.
6. Use the "PASS WITH CARE" (R4-2) sign at the downstream end of a no-passing zone only if a "DO NOT PASS" (R4-1) sign has been installed at the upstream end of the zone.

ADT	Maximum Duration Before Markings Are Required
≤ 1000	14 Days
> 1000	3 Days

U.S. DEPARTMENT OF TRANSPORTATION
FEDERAL HIGHWAY ADMINISTRATION
FEDERAL LANDS HIGHWAY
METRIC STANDARD

**DELINEATION AND SIGNING
FOR UNMARKED PAVEMENTS**

STANDARD APPROVED FOR USE 6/1998
REVISED: 6/2005
DRAFT: 9/2010

STANDARD
M635-3

NO SCALE