

**NOTE:**

1. For periods noted in Table A, pavement may be unmarked if vehicle positioning guides and signing are provided per this detail. For longer periods/higher ADT or for application of temporary markings with paint or tape, use Standard 635-2.
2. On curves with radius less than 500', reduce cycle length to 20'.
3. Use permanent markings plan to determine no passing zones for each direction of travel.
4. Repeat R4-1 at 1 mile intervals.
5. Repeat W8-12 after each major intersection and every 2 miles for temporary traffic control zones greater than 3 miles long.
6. Use the "PASS WITH CARE" (R4-2) sign at the downstream end of a no-passing zone only if a "DO NOT PASS" (R4-1) sign has been installed at the upstream end of the zone.

ADT	Maximum Duration Before Markings Are Required
≤ 1000	14 Days
> 1000	3 Days

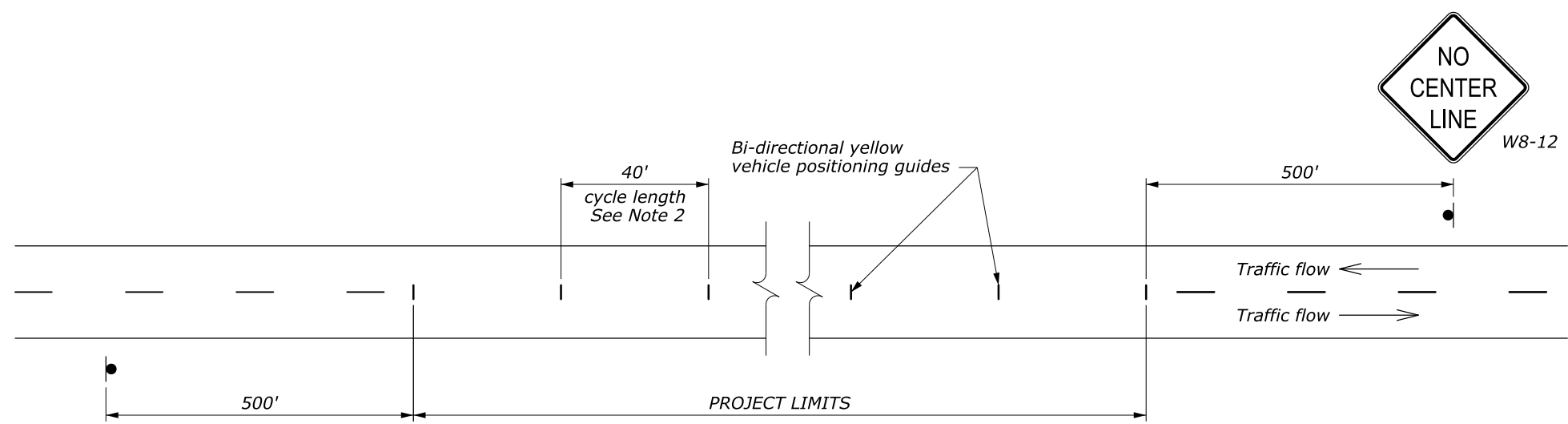

**DETAIL A**  
Passing zone both directions  
Two-way traffic

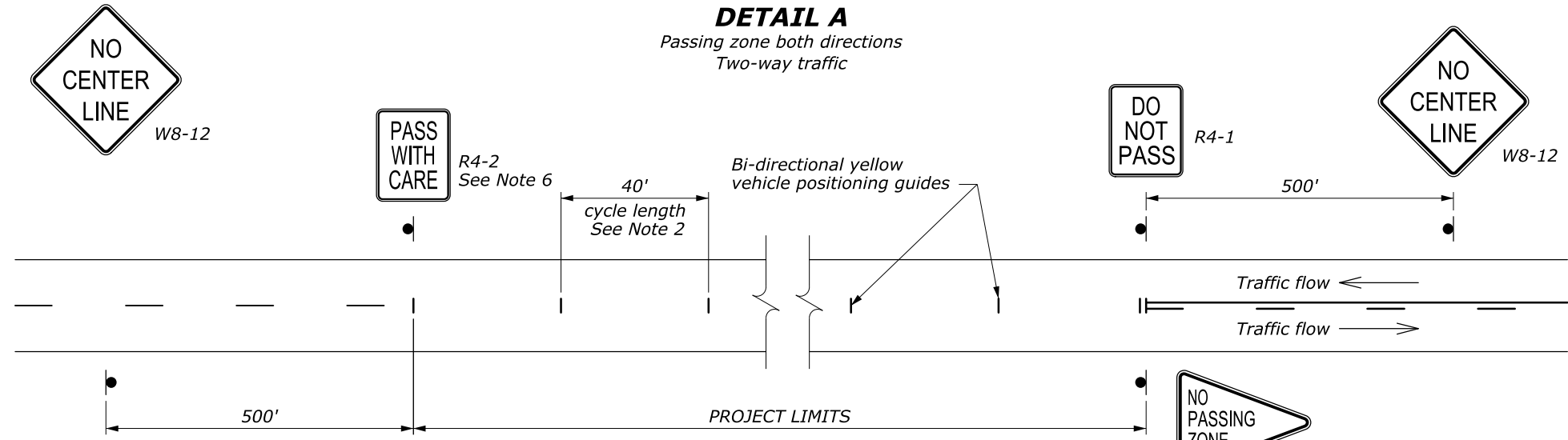

**DETAIL B**  
No Passing zone one direction  
Two-way traffic

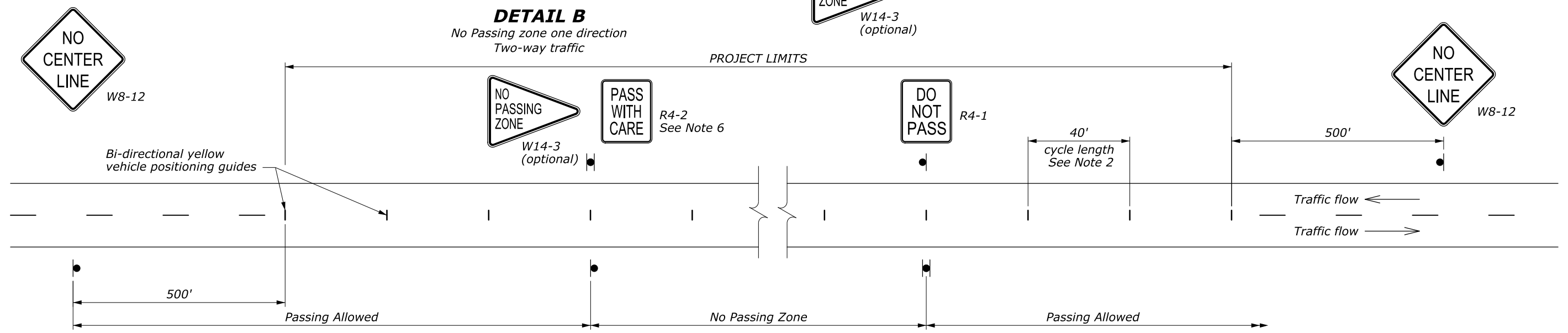

**DETAIL C**  
No Passing zone both directions  
Two-way traffic

NO SCALE

U.S. DEPARTMENT OF TRANSPORTATION  
FEDERAL HIGHWAY ADMINISTRATION  
FEDERAL LANDS HIGHWAY

U.S. CUSTOMARY STANDARD

**DELINEATION AND SIGNING  
FOR UNMARKED PAVEMENTS**

STANDARD APPROVED FOR USE 6/2005	STANDARD
REVISED: DRAFT: 9/2010	635-3