

2007 NIDA INTERNATIONAL FORUM

Québec City Canada • June 15 - 18, 2007

Technological Innovations

To Build International Research Capacity

Program Book

Contact Information

NIDA INTERNATIONAL PROGRAM STAFF

NIDA International Program
National Institute on Drug Abuse
National Institutes of Health
6001 Executive Boulevard
Room 5274, MSC 9581
Bethesda, Maryland 20892, USA

❖ **Steven W. Gust, Ph.D., Director**

Phone: +1-301-443-6480

Fax: +1-301-443-9127

E-mail: sgust@nida.nih.gov

❖ **Dale S. Weiss, Program Analyst**

Phone: +1-301-402-6683

Fax: +1-301-443-9127

E-mail: dweiss@nida.nih.gov

IQ SOLUTIONS STAFF (SUPPORT CONTRACTOR)

IQ Solutions, Inc.
11300 Rockville Pike, Suite 901
Rockville, Maryland 20852, USA

❖ **Kimberly Zink, Project Director**

Phone: +1-301-984-1471, ext. 4299

Fax: +1-301-984-1473

E-mail: kzink@iqsolutions.com

❖ **Enid Shyla John, M.B.A., Program Manager**

Phone: +1-240-221-4331

Fax: +1-301-984-1473

E-mail: sjohn@iqsolutions.com

❖ **Todd Blond, Fellowship Administrator**

Phone: +1-240-912-3891

Fax: +1-301-984-1473

E-mail: tblond@iqsolutions.com

❖ **Judy McCormally, Consultant**

Phone: +1-703-536-9209

Fax: +1-703-532-8116

E-mail: jmccormally@comcast.net

❖ **Deborah Harris, Senior Meeting Planner**

Phone: +1-301-984-1471, ext. 4259

Fax: +1-301-984-1473

E-mail: dharris@iqsolutions.com

Table of Contents

Welcome	3
Agenda	5
Speaker Presentations and Biosketches	11
Speaker List	29
Fellowship and Funding Mechanisms	34
Awards of Excellence	36
Methadone Manual	38
Tourist Information	39
Restaurants	40
The Convention Center	41
Hotel Map	42
Notes	43



The NIDA International Program is pleased to hold its 12th International Forum here in the beautiful city of Quebec. We also are pleased to acknowledge the support of our Canadian hosts and cosponsors, the Canadian Institutes of Health Research Institute of Neurosciences, Mental Health and Addiction (INMHA) and the Canadian Centre on Substance Abuse (CCSA). We invite you to participate fully in the scientific sessions and formal networking activities designed to help you learn about drug abuse research, training, and policy issues in other countries, and hopefully to begin to form or continue to build the professional relationships that produce successful international research teams. We hope your participation in these events will lead to new research topics, grant proposals, or scientific articles that will advance the science of drug abuse internationally.

This year's theme, *Technological Innovations to Build International Research Capacity*, focuses on innovative ways scientists are incorporating high-tech tools—such as ecological momentary assessment, computerized intervention software, and virtual reality—in drug abuse prevention and treatment research projects that we feel may be of particular interest and application internationally. These include several new Web-based tools for education and collaboration that we hope will be useful in training and building fruitful collaboration.

Since 1996, the NIDA International Forum has been a satellite to the annual meeting of the College on Problems of Drug Dependence (CPDD), and we appreciate the support from CPDD, particularly by its Executive Officer, Dr. Martin W. Adler, and the Chair of the CPDD International Committee, Dr. Gabriele Fischer.

Most importantly, we are grateful to you, the NIDA International Forum participants, whose excellent drug abuse research is on display throughout the meeting and without whose commitment and dedication the world could not hope to resolve the pandemic of drug abuse and drug-related health consequences.

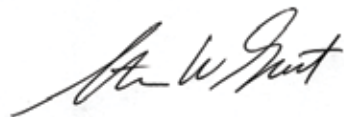

Steven W. Gust, Ph.D.
Director, International Program
National Institute on Drug Abuse

**Forum Workshop
Friday, June 15, 2007
The Québec Hilton Hotel**

3:00 p.m. – 6:00 p.m.	Registration	Porte Ballrooms Foyer
3:30 p.m. – 4:45 p.m.	<p>Building on Your Experience: Post Fellowship Opportunities</p> <p>Learn about funding opportunities open to former NIDA Fellows and new options for connecting with the international research community.</p> <p>Chair: Dale Weiss, <i>Program Analyst, International Program, NIDA</i></p> <p>Funding Opportunities</p> <ul style="list-style-type: none"> ❖ Global Health Research Initiative Program (GRIP) Aron Primack, <i>Fogarty International Center, National Institutes of Health</i> ❖ NIDA-CICAD Research Award Fund Marya Hynes-Dowell, <i>Inter-American Drug Abuse Control Commission (CICAD)</i> <p>Hubert H. Humphrey and INVEST Fellows Alumni Activities</p> <ul style="list-style-type: none"> ❖ Hubert H. Humphrey Fellowship Program Judith Babbitts, <i>Institute for International Education</i> ❖ NIDA Online Networking Tools Dale Weiss, <i>Program Analyst, International Program, NIDA</i> 	Porte St. Louis Room
4:45 p.m. – 5:30 p.m.	<p>Strengthening Regional Research Networks</p> <p>Strong regional networks foster critical research capacity. Discuss the individual and group actions required to implement a stable research network equipped to collaborate with national and international colleagues.</p> <p>Moderator: Flavio Pechansky, <i>Federal University of Rio Grande do Sul, Brazil</i></p>	Porte St. Louis Room
6:00 p.m. – 8:00 p.m.	Welcome and Networking Session	Porte Ballrooms Foyer

**Forum Symposium
Saturday, June 16, 2007
Québec City Convention Center**

7:30 a.m. – 8:30 a.m.	Registration	Foyer 206
8:30 a.m. – 12:15 p.m.	<p>Opening Plenary Session</p> <p>Chair: Steven W. Gust, <i>Director, International Program, NIDA</i></p>	Rooms 206AB
8:30 a.m. – 9:15 a.m.	<p>Welcoming Remarks</p> <ul style="list-style-type: none"> ❖ National Institute on Drug Abuse Timothy P. Condon, <i>Deputy Director, NIDA</i> ❖ College on Problems of Drug Dependence (CPDD) Gabriele Fischer, <i>Chair, CPDD International Committee</i> 	

Forum Symposium (continued)
Saturday, June 16, 2007
Québec City Convention Center

- 8:30 a.m. – 9:15 a.m.
(continued)
- ❖ Canadian Institutes of Health Research, Institute of Neurosciences, Mental Health and Addiction (INMHA) International Collaborations on Addictions
 Richard Brière, *Assistant Director, INMHA*
 - ❖ Canadian Centre on Substance Abuse (CCSA)
 Colleen Anne Dell, *Senior Research Associate and Academic Liaison, CCSA*
- Building the International Research Community: NIDA International Program Update
 Steven W. Gust, *Director, International Program, NIDA*
- 9:15 a.m. – 12:15 p.m.
- 9:15 a.m.
- ❖ Social Network Technology to Evaluate and Facilitate Collaboration
 Daniel Olguin Olguin, *Massachusetts Institute of Technology Media Lab*
- 10:00 a.m.
- ❖ Applying Computer-Based Information Technologies to Substance Abuse Treatment
 Warren K. Bickel, *University of Arkansas*
- 10:20 a.m.**
- ❖ **Break**
- 10:35 a.m.
- ❖ Computerized Assessment and Treatment Interventions: Adventures in Automation
 Kenzie L. Preston, *Intramural Research Program, NIDA*
- 10:55 a.m.
- ❖ In Pursuit of Worldwide Community Impact: The Importance of Reach and the Need for Authorable Computerized Intervention Software
 Steven J. Ondersma, *Wayne State University*
- 11:15 a.m.
- ❖ Ecological Momentary Assessment in Substance Abuse Research
 James W. Hopper, *Harvard University*
- 11:35 a.m.
- ❖ Virtual Reality as a Universal Language for Behavioral Interventions
 Brenda K. Wiederhold, *Virtual Reality Medical Institute*

12:15 p.m. – 12:30 p.m. 2007 NIDA International Program Awards of Excellence **Rooms 206 AB**

12:30 p.m. – 1:45 p.m. Networking Lunch **Rooms 205 ABC**

1:30 p.m. – 4:00 p.m. Building Contacts with NIDA **Rooms 203**

Participants who have signed up for this session will be able to discuss their research agenda with NIDA staff members. Participants are requested to bring abstracts or research plans for a 15-minute, one-on-one conversation about NIDA research priorities, potential funding sources, and possible partnerships.

1:45 p.m. – 4:00 p.m.

Concurrent Breakout Sessions

Breakout #1

Risk Behaviors and Strategies for Risk Reduction Among Drug Users: Qualitative Description from Four Countries

Rooms 204AB

Learn how researchers using in-depth interviews, observational data, and new technologies identify drug-using behaviors and develop approaches to reduce the incidence of HIV/HCV, overdose, and drug dependence.

Co-Chairs: Bill Sanders, *University of Southern California*
Erin L. Winstanley, *Consultant, International Program, NIDA*

- ❖ Gendered Strategies for Being Safe: Injection Drug Users' Notions of Risk Reduction Practices in Dar es Salaam, Tanzania
Sheryl A. McCurdy, *University of Texas Health Science Center at Houston*
- ❖ Crack Injection and the Increased Use of the Femoral Vein: A Mixed-Method Qualitative Study in the United Kingdom
Timothy Rhodes, *London School of Hygiene and Tropical Medicine, University of London, United Kingdom*
- ❖ Injection Drug User Experiences with Policing and Potential Effects on HIV Risk Behaviors in Two Mexico-U.S. Border Cities
Robin Pollini, *University of California San Diego School of Medicine*
- ❖ The Qualitative View: Risk Behaviors and Strategies for Risk Reduction Among Drug Users
Lisia von Diemen, *Federal University of Rio Grande do Sul, Brazil*

Breakout #2

Web Tools for Education and Collaboration

Rooms 208AB

From the virtual university to training modules to real-time editing sessions, discover the expanded range of online resources for the international drug abuse research community.

Chair: Dale Weiss, *Program Analyst, International Program, NIDA*

- ❖ National Library of Medicine Demonstration
Cassandra Allen, *National Library of Medicine, National Institutes of Health*
- ❖ NIDA International Virtual Collaboratory (NIVC)
Krystyna Isaacs, *JGPerpich, LLC*
- ❖ International Collaboration Opportunities and Research Partnerships (I-CORP)
Jonathan Hunt-Glassman, *Danya International, Inc.*
Salvatore Libretto, *Danya International, Inc.*
- ❖ Update on Electronic Grant Submission and Process for Foreign Investigators
Mark Swieter, *Office of Extramural Affairs, NIDA*

(continued)

Forum Symposium (continued)
Saturday, June 16, 2007
Québec City Convention Center

Breakout #3

Moving Forward in Real Time: Catalyst for Global Progress on
Inhalants Research

Room 202

Learn about recent research and how you can join virtual meetings for
inhalants researchers.

Co-Chairs: M. Patricia Needle, *Consultant, International Program, NIDA*
Judy McCormally, *Consultant, International Program, NIDA*

❖ **Background and Update**

M. Patricia Needle, *Consultant, International Program, NIDA*

❖ **Solvent Research in Animal Models of Abuse: A Review of Mechanistic and
Behavioral Studies**

Silvia L. Cruz, *Cinvestav, Mexico*

❖ **Inhalant Abuse Epidemiology in Sub-Saharan Africa**

Robert L. Balster, *Virginia Commonwealth University*

Peter Ndege, *2006-2007 Hubert H. Humphrey Drug Abuse Fellow, Kenya*

Rehanna Kader, *2006-2007 Hubert H. Humphrey Drug Abuse Fellow, South Africa*

❖ **Reasons for, Settings, and Consequences of Inhalant Use**

Matthew O. Howard, *University of Michigan*

❖ **Inhalant Abuse Interventions in Canada**

Debra Dell, *National Youth Solvent Addiction Coordinator, Canada*

❖ **Panel Discussion: Using the NIDA International Virtual Collaboratory to Set
Directions for New Research**

Moderator: Judy McCormally, *Consultant, International Program, NIDA*

Panelists: Inhalants Working Group Steering Committee

❖ **Interactive Discussion: Next Steps**

Moderators: Robert L. Balster, *Virginia Commonwealth University*

Colleen Anne Dell, *Canadian Centre on Substance Abuse, Canada*

**Forum Poster Session
Sunday, June 17, 2007
The Québec Hilton Hotel**

8:00 p.m. – 10:00 p.m. International Research Posters and Web Tools Demonstrations *Porte du Palais Ballroom*

Learn about research conducted outside of the United States and meet NIDA staff and colleagues from around the world.

NEW—Try out new Web tools that support collaborative research. Please refer to the Abstracts book and/or the Poster Presentation Listing flyer to view abstract presentations by poster number. Presenting authors with even poster board numbers must be adjacent to their posters from 8:00 p.m. to 9:00 p.m. Presenting authors with odd poster board numbers must be adjacent to their posters from 9:00 p.m. to 10:00 p.m.

**Forum Review and Future Planning
Monday, June 18, 2007
Québec City Convention Center**

12:00 p.m. – 1:00 p.m. Forum Review and Future Planning *Rooms 204AB*

Review this year's NIDA International Forum and help plan future meetings.

Chair: Steven W. Gust, *Director, International Program, NIDA*

Presentation Summary: The Humphrey Fellowship Program believes that the impact of the fellowship only begins when Fellows return home and use the knowledge and skills they acquired for the benefit of their communities. To support Fellows in their efforts, the program offers two awards to alumni after they return home, one for projects focused on their communities and the other for their professional development. NIDA Humphrey Fellows have won several of these awards, and some have collaborated with other NIDA grantees on multinational projects. The program also supports Fellows who organize regional alumni workshops around the world to enhance the leadership skills and upgrade the knowledge of Humphrey Fellows. This presentation will illustrate these alumni activities by telling the stories of NIDA Humphrey Fellows who have had an impact substance abuse and prevention policies and research in their home countries.

❖ **Dr. Judith Babbitts** is the Director of the Hubert H. Humphrey Fellowship Program at the IIE in Washington, D.C. Before coming to IIE, she was an administrator for the Peace Corps Fellows program and an associate professor and course designer in history for the University of Maryland University College. She has also worked as a program evaluator for the New Jersey Department of Higher Education, a program officer at the Levi Strauss Foundation, and a consultant to the World Bank on scholarship administration. She was a Fulbright lecturer at the University of Tokyo and, early in her career, a Peace Corps volunteer in Thailand. Dr. Babbitts holds a Ph.D. in American Studies from Yale University, an M.A. in Women's History from Sarah Lawrence College, and a Bachelor of Arts in English from Rutgers University.

Robert L. Balster, Ph.D., Virginia Commonwealth University

Inhalant Abuse Epidemiology in Sub-Saharan Africa

Presentation Summary: Although inhalant abuse is a problem in nearly every country in the world, developing countries are widely believed to have some of the most serious problems. Our purpose in this presentation is to review evidence on the epidemiology of inhalant abuse in Sub-Saharan Africa. The review is based on both published papers and governmental reports. Problems of inhalant abuse are often ignored in African surveys reporting other forms of drug abuse, suggesting that the problem may be underappreciated in some areas. In addition to presenting information on prevalence, we will also discuss problems in comparing data among countries and regions of the world. We will conclude with some suggestions for future research.

❖ **Dr. Robert L. Balster** is the Director of the Institute for Drug and Alcohol Studies, a Butler Professor of Pharmacology and Toxicology, and a Research Professor of Psychology and Psychiatry at Virginia Commonwealth University (VCU). He is also the Co-Director of the Virginia Youth Tobacco Project, a multi-university coalition of tobacco scientists in the state, and is the Coordinator of the Hubert H. Humphrey Fellowship Program in Substance Abuse Prevention, Treatment and Policy at VCU. He is a Fellow of the American College of Neuropsychopharmacology, the College on Problems of Drug Dependence (CPDD), and the American Psychological Association. He is a Past-President of the CPDD. Previous appointments also include Chair of the Drug Abuse Clinical and Behavior Study Section at the National Institute on Drug Abuse, Chair of the FDA Drug Abuse Advisory Committee, and Chair of the Board of Scientific Affairs of the American Psychological Association. He is currently Editor-in-Chief of the scientific journal *Drug and Alcohol Dependence* and serves on the editorial boards of four additional journals. In 2000, Dr. Balster received the first annual Mentorship Award from the CPDD and in 2006 received the Excellence in Mentoring Award from the NIDA International Program. The principal areas of Dr. Balster's research program are neurobehavioral pharmacology and substance abuse. His primary interests are in phencyclidine, ketamine, and inhalant abuse. He has also worked in the areas of marijuana, opiate, tobacco, and alcohol research. He also has extensive experience in drug abuse potential evaluation and in the drug approval

(continued)

process for psychiatric, neurologic, and addiction treatment products. Dr. Balster's research program has been continuously funded by the National Institutes of Health since 1976 and he has been the recipient of a National Institute on Drug Abuse MERIT Award. Dr. Balster has published over 240 papers in scientific journals, edited two books, and authored over 35 book chapters. He also has experience in the area of drug abuse policy and has testified before Congress and the Virginia General Assembly.

Warren K. Bickel, Ph.D., University of Arkansas

Applying Computer-Based Information Technologies to Substance Abuse Treatment

Presentation Summary: Numerous challenges exist for substance abuse treatment throughout the world including difficulty retaining treatment staff, inadequate financing, limited treatment availability, and a slow adoption of research-based treatment innovations. Computerizing therapy may provide a means to address some of these concerns. In this presentation, we will present data from a random assignment controlled trial that examined the efficacy of an interactive, computer-based behavioral therapy intervention grounded in the efficacious Community Reinforcement Approach plus voucher-based contingency management model of behavior therapy. We will report the data on treatment outcome and personnel time necessary to implement the procedure and discuss implications for expanding treatment availability.

❖ **Dr. Warren K. Bickel** is Professor of Psychiatry, Wilbur D. Mills Chair of Alcoholism and Drug Abuse Prevention, Director of the UAMS Center for Addiction Research, and Director of the Interdisciplinary Tobacco Program at the University of Arkansas for Medical Sciences (UAMS). He is the recipient of the Joseph Cochin Young Investigator Award from the College on Problems of Drug Dependence (CPDD), the Young Psychopharmacologist Award from the Division of Psychopharmacology and Substance Abuse of the American Psychological Association (APA), and a MERIT award from the National Institute on Drug Abuse. He has served as President of the Division of Psychopharmacology and Substance Abuse of the APA and is the President of the CPDD. He was Editor of the journal *Experimental and Clinical Psychopharmacology* has co-edited four books and published over 230 papers. His research interests include the neurobehavioral mechanisms of addiction and therapeutic processes underlying recovery from addiction.

Richard Brière, Ph.D., Canadian Institutes of Health Research, Institute of Neuroscience, Mental Health and Addiction (INMHA), International Collaborations on Addiction

Welcoming Remarks

❖ **Dr. Richard Brière** received his Ph.D. in Neuroscience from the University of Montréal. Following his post-doctoral training in neuropharmacology at the Institut national de la santé et de la recherche médicale in Paris and at the Rockefeller University in New York, he joined L.H. Lafontaine Hospital, a psychiatric hospital affiliated with the University of Montreal, as a researcher in biological psychiatry with a special interest in the neurobiology of suicide. He was Assistant Director of the Québec Mental Health Network from 1995 to 2000. Since January 2001, he has been the Assistant Director of the Institute of Neurosciences, Mental Health and Addiction, of the Canadian Institutes of Health Research.

Timothy P. Condon, Ph.D., Deputy Director, National Institute on Drug Abuse (NIDA)

Welcoming Remarks

❖ **Dr. Timothy P. Condon** was appointed Deputy Director of NIDA in 2003. As Deputy Director, Dr. Condon supports the Director in developing, implementing, and managing the Institute's programs, priorities, resources, policies, and research dissemination efforts. Dr. Condon has held a number of prominent science policy positions at NIDA since he arrived in 1992. He served as Chief of the Science Policy Branch and Acting Deputy Director of the Office of Science Policy and Communications (OSPC) until 1996 when he was appointed NIDA's first Associate Director for Science Policy, as well as the Director of OSPC. In this capacity, Dr. Condon was responsible for the Institute's science planning, policy, congressional, and communications activities, and coordinated NIDA's research training and science education programs. Prior to joining NIDA, Dr. Condon coordinated research and service programs at the former Alcohol, Drug Abuse, and Mental Health Administration for four years, serving as the Deputy Associate Administrator for Policy Coordination and Deputy Associate Administrator for Science. From 1986 to 1989, he served as Science Policy Analyst and Project Director at the U.S. Congress Office of Technology Assessment, where he directed an assessment of emerging technologies in the neurosciences. Dr. Condon received his Ph.D. in neuroscience from the Ohio State University, College of Medicine. He pursued postdoctoral research in neuroendocrinology and neuropharmacology at the University of California at Los Angeles' Brain Research Institute and at the Oregon Health Sciences University (OHSU); he joined the faculty of OHSU in 1985.

Silvia L. Cruz, Ph.D., Cinvestav

Solvent Research in Animal Models of Abuse: A Review of Mechanistic and Behavioral Studies

Presentation Summary: This presentation describes increasing evidence from animal studies that supports the existence of behavioral and developmental deficiencies associated with prenatal exposure to inhalants. The last decade has seen an important advance in the understanding of inhalants' behavioral effects and mechanisms of action at cellular sites. Volatile solvents in general and toluene in particular, are the best-studied inhalants. The behavioral effects of acute and chronic solvent abuse include motor impairment, alterations in spontaneous motor activity, anticonvulsant effects, anxiolytic effects, sensory effects, and effects on learning, memory, and operant behavior (e.g., response rates and discriminative stimulus effects). The behavioral effects vary in magnitude and duration among the solvents investigated. In addition, repeated exposure may produce tolerance, dependence, and/or sensitization to these effects. NMDA, GABA_A, glycine, nicotine, and 5HT₃ receptors appear to be important targets of action for several abused solvents with emerging evidence suggesting that other receptor subtypes and nerve membrane ion channels may be involved as well. (Based on the paper by Bowen, S.E., Batis, J.C., Paez-Martinez, N., Cruz, S.L.; *Neurotoxicology and Teratology*, 2006; 28(6): 636-647).

❖ **Dr. Silvia L. Cruz** received her Ph.D. in Pharmacology from the Center for Research and Advanced Studies in Mexico (Cinvestav) in 1990. She has worked as a full-time researcher and lecturer in the drug field for the past 20 years. Dr. Cruz is currently Professor and Chair of the Department of Pharmacobiology at Cinvestav. She has published over 35 journal articles and chapters in the areas of drug addiction and psychopharmacology, and her main area of interest is the study of the mechanisms of action of opioids and inhalants. Dr. Cruz is a member of the College of Problems on Drug Dependence, the Society for Neuroscience, the National Hispanic Science Network on Drug Abuse (USA), and the National System of Researchers (Mexico). Her research has been supported by several grants from the Mexican Science and Technology National Council. She is a peer reviewer for numerous journals including but not limited to the *British Journal of Pharmacology*, the *Journal of Pharmacology and Experimental Therapeutics*, and *Toxicology Letters*. In recognition of her contributions, Dr. Cruz received the 2000 Zazil-Avon Award in Science (Mexico).

(continued)

Colleen Anne Dell, Ph.D., Canadian Centre on Substance Abuse (CCSA)

Welcoming Remarks

❖ **Dr. Colleen Anne Dell** holds a joint position as an Associate Professor at Carleton University, Department of Sociology and Anthropology, and the CCSA, where she is a Senior Research Associate and Academic Liaison. In July 2007, she will start as the new Research Chair in Substance Abuse at the University of Saskatchewan. Dr. Dell has worked for several years at the community level, including as the Executive Director with the Elizabeth Fry Society of Manitoba. She also has political and policy level experience, including working for the Senate of Canada and Correctional Services of Canada. Her array of experience contributes to the focus of her research and community advocacy work. Dr. Dell's current research interests and projects focus on women, problematic substance use and the criminal justice system, violence in prisons, including self-harm, and the connection between youth resiliency and inhalant abuse. She is actively involved in community projects, including co-chairing the Manitoba self-harm Inter-Sectoral Committee and serving as the Ethics Chair for the 2007 Issues of Substance Conference.

Debra Dell, Ph.D., National Youth Solvent Addiction Committee (YSAC), Canada

Inhalant Abuse Interventions in Canada

Presentation Summary: Historically, research and literature around solvent abuse have characterized abusers as “volatile, non-complaint and hard to treat.” One frequently cited estimate is that residential treatment centers for inhalant abuse rarely last longer than nine months. This presentation will focus on the historical development of the YSAC network. The challenges, access, and client profiles will be shared. YSAC is comprised of eight residential inhalant centers located across Canada. The centers work together and coordinate their efforts to address inhalant abuse among First Nations and Inuit youth. 2007 marked 10 years in operation for some of YSAC's centers. This by far exceeds the pessimistic estimate of 9 months. The objective of this presentation is to share with others what has worked for YSAC.

❖ **Dr. Debra Dell** has been working in various capacities in the youth addictions field for over 20 years. She has led the development of two separate youth addiction treatment centers. Debra is currently the Coordinator for YSAC, a network of 10 residential youth solvent treatment centers in Canada. She obtained her Psychology degree from the University of Winnipeg, in addition to addictions counseling training through the University of Manitoba. Dr. Dell is a certified Trainer of Assessment and Clinical Interpretation through the Sassi Institute and a trainer in Emotional Intelligence and Resiliency theories. Both theories are incorporated into YSAC's treatment programming. She stands firm on the personal philosophy that residential treatment is only one piece of a coordinated continuum of care and holistic treatment model necessary to “treat” the devastation of inhalant abuse.

Gabriele Fischer, M.D., Chair, College on Problems of Drug Dependence (CPDD) International Committee

Welcoming Remarks

❖ **Dr. Gabriele Fischer** received her doctorate from the Medical University of Vienna in 1984, where she went on to specialize in psychiatry and neurology, with a fellowship at Washington University Medical School, St. Louis, Missouri (1986-1989). In 1994, she became the Medical Director of the Addiction Clinic at the Medical University of Vienna, Austria. She has been involved in many epidemiological and psychopharmacological studies on substance dependence, as well as her pioneering work in the research of substance dependence and pregnancy, which resulted in many scientific publications in addition to nationally and internationally funded publications (e.g., NIH/NIDA funding on the topic of a prospective multi-centre trial on methadone versus buprenorphine in pregnancy). She is a consultant for several international and national groups including the United Nations' Office on Drugs and

Crime and the World Health Organization, and is a board member of the Quality Control Commission in Medicine in Austria. To date, she has given over 400 scientific presentations and has authored over 150 scientific publications. Dr. Fischer is also involved in editorial and review work for many psychiatric journals, is a board member of several addiction societies, and is currently the Chair of the CPDD International Committee.

Steven W. Gust, Ph.D., Director, NIDA International Program

Building the International Research Community: NIDA International Program Update

❖ **Dr. Steven W. Gust**, has directed the NIDA International Program since 1999, where he is responsible for the Institute's efforts to foster rigorous collaborative and peer-reviewed international research and promote cooperation between NIDA and other U.S. agencies; foreign governments; and international, regional, and nongovernmental organizations. Dr. Gust oversees NIDA efforts to build research capacity, administering fellowships for postdoctoral scientists and mid-career drug abuse professionals from low- and middle-income countries as well as research exchange programs for senior scientists. To disseminate NIDA research methods, findings, and tools to international scientists and organizations, Dr. Gust supervises NIDA international scientific exchange activities, the NIDA International Program bimonthly E-News Letter, and the NIDA International Program Web page. Prior to assuming leadership of the NIDA International Program, Dr. Gust served as Deputy and Acting Director of the Institute's Office on AIDS and as a Special Assistant to the Director responsible for research on the medical uses of marijuana. He joined NIDA in 1986 as Acting Chief of the Clinical and Behavioral Pharmacology Branch, Division of Clinical Research, and has also served as Chief of the Research Section for the NIDA Division of Applied Research Workplace Performance Research Branch. Dr. Gust also conducted research at the University of Minnesota and the Minnesota Department of Health. In 1993, Dr. Gust received a prestigious appointment as a Congressional Fellow, where he worked with the U.S. Senate Labor and Human Resources Committee and the late Senator Paul Wellstone (D-Minnesota). He has served on the Surgeon General's Advisory Group on the Health Effects of Smokeless Tobacco; the Transportation Research Board Committee on Alcohol, Other Drugs, and Transportation; and the White House Health Care Reform Task Force.

James W. Hopper, Ph.D., Harvard University

Ecological Momentary Assessment in Substance Abuse Research

Presentation Summary: Ecological momentary assessment (EMA) is a powerful method for gathering real-time, real-world data from substance abusers and holds promise for answering important questions about substance dependence and its treatment. This presentation addresses key issues and lessons learned from a recent study that employed a "minimalist" EMA methodology—a wristwatch-like device capable of eliciting and recording participant data on substance use and craving. General EMA research issues to be discussed include training participants to use the technology, monitoring data quality and completeness, managing and reducing extremely large data sets, choosing appropriate descriptive and inferential analyses, and presenting findings effectively in tables and figures. Benefits of minimalist EMA technology include the simplicity of only requiring participants to enter one piece of data at a time and the unobtrusiveness of a wristwatch-like device and infrequently administered prompts. Finally, challenges specific to this EMA approach include implementation of practical but effective prompting methods and limited capacity to gather data on behaviors and situations associated with substance use events.

❖ **Dr. James W. Hopper** is a researcher, clinical psychologist, and Instructor in Psychology at Harvard Medical School. His work has focused on the effects of interpersonal violence, substance abuse, and the relationships between them. His research has specifically addressed the biological bases of emotion dysregulation in Post-Traumatic Stress Disorder; the unique characteristics of traumatic memories and how these can be transformed by therapy; how people use alcohol and drugs as attempts to manage post-traumatic symptoms and emotions; and possible cognitive

(continued)

bases of marijuana intoxication and its negatively reinforcing effects. With Dr. Scott E. Lukas and other colleagues at McLean Hospital's Behavioral Psychopharmacology Research Laboratory, Dr. Hopper recently published "Incidence and Patterns of Polydrug Use and Craving for Ecstasy in Regular Ecstasy Users: An Ecological Momentary Assessment Study."

Matthew O. Howard, Ph.D., University of Michigan

Reasons for, Settings, and Consequences of Inhalant Use

Presentation Summary: This presentation will describe the findings of a study that was conducted through face-to-face interviews with 723 incarcerated adolescents (M age = 15.5, SD = 1.23, 87 percent male) to identify specific subgroups of adolescent inhalant users based on their reported reasons for using inhalants and typical contexts of use. The study also examined consequences of adolescent inhalant use with particular attention to depression/suicidality. The study subjects were housed in the 27 residential facilities comprising the Missouri Division of Youth Services residential treatment program. Respondents completed the *Volatile Solvent Screening Inventory* and *Comprehensive Solvent Assessment Interview*, which assessed use of 65 specific inhalant products and typical reasons for and contexts/consequences of inhalant and other drug use, current psychiatric symptoms, antisocial traits, criminal behavior, history of trauma, and current suicidal ideation and attempts.

❖ **Dr. Matthew O. Howard** is currently a tenured Professor of Social Work in the School of Social Work and tenured Professor of Medicine in the Department of Psychiatry at the University of Michigan. He serves on the Executive Board and Steering Committee of the National Depression Center and Operating Committee of the Substance Abuse Research Center. Dr. Howard has published approximately 100 articles and a significant additional number of book reviews, government reports, and newspaper articles. Dr. Howard currently serves on the Editorial Boards of *Social Work Research*, *Research on Social Work Practice*, *American Indian and Alaska Native Mental Health Research*, *Journal of Evidence-Based Social Work*, and *The Journal of Studies on Alcohol*. He was previously Editor, Associate Editor, and Book Review Editor of *The Journal of Social Services Research*, is a Consulting Editor for *The Journal of Social Work Education*, was a Consulting Editor for *Health & Social Work*, and reviews for *Psychosomatic Medicine*, *Drug and Alcohol Dependence*, and many other journals. Dr. Howard also reviews mental health textbooks for the Guilford, NASW, Allyn & Bacon, Sage, Lyceum, and McGraw-Hill publication houses. Dr. Howard has served on several grant review study sections of the National Institutes of Health and U.S. Civilian Research and Development Foundation and received two grants from the National Institute on Drug Abuse, where he also has an inhalant RO1 currently under review.

Jonathan Hunt-Glassman, Danya International, Inc.

International Collaboration Opportunities and Research Partnerships (I-CORP)

Presentation Summary: This presentation describes I-CORP, NIDA's Web-based "knowledge network" for international drug abuse researchers. With funding from NIDA, Danya International began the development of I-CORP to link researchers to their peers, make available collaborative workspaces, and provide resources generated by other network members as well as external sources. Using emerging Web 2.0 technologies, such as rich and interactive interfaces, architecture of user participation, and community networking, the knowledge network will provide researchers with a platform to build their own personal portals. I-CORP will provide users with a central location to create, share, and access diverse content relevant to their personal, professional, and research development. Phase II development will focus on ensuring the portal is built on a scalable and expandable technology platform and on building the additional features and functionality documented during Phase I.

- ❖ **Mr. Jonathan Hunt-Glassman** is the Special Assistant to the President of Danya. He supports the development of new products by coordinating the efforts of researchers, content specialists, Web site designers, and programmers to ensure that complex health information is translated into engaging and intuitive Web-based applications. His skills include conducting online and specialty database searches, developing bibliographies, writing literature reviews, conducting market research, developing audience-appropriate content and conducting comparative analyses of technical features.

Marya Hynes–Dowell, M.H.S., Inter-American Drug Abuse Control Commission (CICAD)

NIDA-CICAD Research Award Fund

Presentation Summary: CICAD, through its Observatory on Drugs, and NIDA have developed a Competitive Research Award to support research development and training in Latin America by providing small financial awards to university students in support of drug research. The Competitive Research Award Fund is aimed at graduate-level students and provides incentives to carry out research on drug use through small studies or secondary analysis of existing databases.

- ❖ **Ms. Marya Hynes–Dowell** received her M.H.S. in Public Health from the Johns Hopkins University Bloomberg School of Public Health and Hygiene in 1997. For the past ten years, she has been working in CICAD in its research and analysis unit, the Inter-American Observatory on Drugs (OID), where she develops and promotes programs to study the epidemiology and other scientific research on drug use in Latin America and the Caribbean. In addition, Ms. Hynes–Dowell manages the OID’s Research Development and Training Program that involves several collaborative projects with the National Institute on Drug Abuse.

Krystyna Isaacs, Ph.D., JGPerpich, LLC

NIDA International Virtual Collaboratory (NIVC)

Presentation Summary: NIVC is a suite of Internet-based software tools designed to promote interactions among NIDA International members and help them build “collaboratories” in biomedical research and training. The term “collaboratory” is devised from the words “collaboration” and “laboratory.” The Virtual Collaboratory tools operate over a wide range of computer platforms (Mac, PC, Linux, etc.). High-quality audio and video capacity, even over slow-modem connections, is achieved using a microphone, Web cam, and speakers attached to a laptop or desktop computer. Current uses of the Virtual Collaboratory will be discussed and an actual demonstration of the software will be conducted. Tools in the Virtual Collaboratory include:

- ❖ **A Virtual Meeting Room:** a live audio-videoconferencing room where members can meet in real time with colleagues;
- ❖ **A Wiki:** a Web-based collaborative writing tool where individuals can both create and edit text for a Web page using simple editing tools;
- ❖ **A Discussion Module:** a modified listserv where network members can easily participate in written discussions with archive and search features;
- ❖ **A Community-Built Resource Center:** a Web site where all members can easily post resources of mutual interest and create their own organizational system for displaying these resources; and
- ❖ **A Profile Directory:** a searchable and easily updated online member database containing contact information, educational or training information, and current research interests.

(continued)

❖ **Dr. Krystyna Isaacs** graduated from Williams College in 1984 with a Bachelor of Arts in Biopsychology, and in 1992 from the University of Illinois at Urbana-Champaign with a Ph.D. in neuroscience. After completing a postdoctoral fellowship at the National Institute of Mental Health (NIMH) in neurodegeneration, she took a position in the Howard Hughes Medical Institute (HHMI) International Program as a program official. She has been a science program development and evaluation consultant since 1998. Her current and past clients include HHMI, the American Association for the Advancement of Science (AAAS), the Federation of American Societies for Experimental Biology, the National Academy of Sciences, and the privately owned educational services company, JGPerpich, LLC. As a consultant for HHMI and AAAS, she developed a database, supervised the design of the Web interface for the HHMI/AAAS Undergraduate GrantsNet initiative, and designed the AAAS Minority Scientists Network. Most recently, she conducted the 2005 BWF/HHMI Lab Management course evaluation and wrote material for the BWF/HHMI book, *Making the Right Moves: A Practical Guide to Scientific Management for Postdocs and New Faculty*, summarizing the physician-scientist issues raised during the 2005 course. She has conducted over 200 indepth interviews with scientists who competed for the prestigious Lucille P. Markey Trust Scholars program and completed a summary report as part of the National Academy of Science's assessment of this program in 2006. Dr. Isaacs is now a Senior Program Officer for JGPerpich, LLC, charged with developing and supporting new initiatives and conducting evaluations of Virtual Collaboratories for NIMH, NIDA, and the Sidwell Friends School.

Rehanna Kader, M.Psych., 2006–2007 Hubert H. Humphrey Drug Abuse Fellow, South Africa

Inhalant Abuse Epidemiology in Sub-Saharan Africa

Presentation Summary: In this presentation, results are presented from a literature review of both grey and published literature including updates from previously reported estimates of HIV infection among injection drug users (IDUs) in Kenya between the years 1996 and 2006. In Kenya, the problem of injection drug use is an emerging one which needs to be addressed urgently, given its close association with the rapid spread of HIV and other viral infections. National data on the severity of the problem or the prevalence of HIV among IDUs is patchy or simply nonexistent. The primary aim of this study was to present and update available national and sub-national estimates of the prevalence of HIV infection among IDUs in Kenya. The results of this review clearly indicate that data on the severity of the problem of IDU or the prevalence of HIV among IDUs is patchy or simply nonexistent and that the presence of HIV among IDUs has the potential to fuel an already devastating HIV/AIDS epidemic in Kenya.

❖ **Ms. Rehanna Kader**, from Cape Town, South Africa, earned a Bachelor's degree with honors in Psychology from the University of the Western Cape, where she also completed her Master's degree in Psychology in 2000. She is a clinical psychologist and the former director of Positive Muslims, an HIV/AIDS nongovernmental organization. Currently, she is in private practice and lectures part-time and supervises students at the University of the Western Cape. She is also currently the recipient of a Hubert H. Humphrey Fellowship and will spend her Fellowship year gaining additional experiences and training in community health in areas of mental health, HIV/AIDS, and substance abuse.

Salvatore Libretto, Ph.D., Danya International, Inc.

International Collaboration Opportunities and Research Partnerships (I-CORP)

Presentation Summary: Dr. Libretto is a co-speaker for this session. Please see presentation summary under Mr. Jonathan Hunt-Glassman.

❖ **Dr. Salvatore Libretto**, Associate Director of Research, oversees the development of all I-CORP portal design and content and provides general oversight of the project. He is a researcher, clinician, and teacher with a clinical psychology background and extensive experience in research design, data analysis, and program evaluation. Dr. Libretto has worked in a variety of clinical settings, including community mental health clinics, hospital inpatient units, substance abuse treatment programs, and university counseling centers. His diverse background also includes extensive experience with psychological assessment, diagnosis, and survey construction. Dr. Libretto is the Principle Investigator (PI) on a NIDA-funded Small Business Innovation Research contract to develop a multiproblem screening instrument for adolescents. He also serves as Project Director for an effort funded by the U.S. Department of State, Bureau for International Narcotics and Law Enforcement Affairs, International Demand Reduction Program to conduct assessments of drug treatment and aftercare. The primary objective of this grant is to identify model drug treatment and aftercare program elements, common cross-cultural elements, and lessons learned from organizations in selected countries in Latin America, Southeast Asia, and Europe. In an extension of this project, Dr. Libretto is currently evaluating drug prevention programs in Latin America and Southeast Asia. Dr. Libretto recently served as PI on a NIDA-funded project to develop the Behavioral Health Screening and Assessment Package, an innovative, user-friendly PDA and CD-ROM-based screening system designed to rapidly identify potential mental health disorders that commonly coexist with substance-related disorders. Dr. Libretto is also the Co-PI on two other NIDA contracts to: (1) develop and evaluate an Internet-based adolescent drug and alcohol screening instrument for primary care settings, and (2) develop and evaluate a worksite prevention and job success program for young workers.

Judy McCormally, NIDA International Program Consultant

Moving Forward in Real Time: Catalyst for Global Progress on Inhalants Research

❖ In close cooperation with NIDA staff, **Ms. Judy McCormally** assists in developing International Program activities, assessing new and continuing initiatives for their relevance to both the Institute-wide and International Program missions, strategic plans, and immediate objectives. Currently, Ms. McCormally is working with NIDA staff to coordinate International Program support of a multinational Inhalants Abuse Working Group that is using new online tools to create a research-oriented substance classification scheme. She has helped to implement major International Program projects, such as the 2006 Drug and Alcohol Dependence peer-reviewed scientific journal supplement, *Drug Abuse and HIV/AIDS: International Research Lessons and Imperatives*, the 2006 and 1995 revisions of the NIDA methadone research guide, and the DISCA/USDISCA research exchange programs. Additionally, she writes and edits program materials. Presently a consultant to the NIDA International Program support contractor, IQ Solutions, Inc., Ms. McCormally has more than 20 years of experience as a consultant, 12 of them with the NIDA International Program.

(continued)

Sheryl A. McCurdy, Ph.D., University of Texas Health Science Center at Houston

Gendered Strategies for Being Safe: Injection Drug Users' Notions of Risk Reduction Practices in Dar es Salaam, Tanzania

Presentation Summary: This presentation will present findings of a four-year mixed-method study conducted by the Tanzanian AIDS Prevention Project with injection drug users (IDUs) in Dar es Salaam to examine women's and men's changing sexual and heroin injection practices. We will describe the ways that male and female IDUs managed their daily lives and how they negotiated different types of relationships over time in response to women's greater income-earning abilities and men's growing frustration over women's independence. The discussion of men's and women's changing relationships and drug use practices are situated within the local socioeconomic and political context which is framed in part by the Tanzanian government's "War on Drugs." This study included, in addition to two surveys and the collection of biologicals, semi-structured, face-to-face interviews (n=94) conducted in Swahili with 38 female and 56 male IDUs between February 2003 and December 2006. We elicited detailed descriptions of Tanzanian IDUs' attitudes and beliefs about HIV and its relationships to other topics related to HIV risk and the ways they managed their heroin use.

❖ **Dr. Sheryl A. McCurdy** is an assistant professor in Behavioral Sciences in the School of Public Health at the University of Texas Houston Health Science Center. Her research on HIV/AIDS, substance use, disadvantaged communities, women and health is published in public health and medical journals. She is co-editor, with Dorothy Hodgson, of *"Wicked" Women and the Reconfiguration of Gender in Africa*. Her research on the Manyema and population decline in Western Tanzania is published in history and African Studies journals.

Peter Ndege, M.D., 2006–2007 Hubert H. Humphrey Drug Abuse Fellow, Kenya

Status of Inhalant Abuse in Sub-Saharan Africa: A Review Paper

Presentation Summary: Dr. Ndege is a co-speaker for this session. Please see presentation summary under Ms. Rehana Kader.

❖ **Dr. Peter Ndege**, of Nairobi, Kenya, obtained his medical training at the University of Nairobi in the 1990s with specialty training in Internal Medicine completed in 2003. He also has a post-graduate diploma in sexually transmitted diseases and a certificate in infectious diseases from Tel Aviv University in Israel. Dr. Ndege also worked briefly in Tanzania in 2001 with the African Medical Research Foundation. He has held several positions at the Kenyatta National Teaching and Referral Hospital and is currently a senior clinical instructor in the Department of Respiratory and Infectious Diseases/Comprehensive HIV/AIDS Care Clinic, where he specializes in patients with substance use disorders. He also has considerable experience in training other health professionals and as a consultant on HIV/AIDS prevention and treatment issues. He is an honorary lecturer at the University of Nairobi's Department of Internal Medicine and Department of Psychiatry, and a research associate with the African Mental Health Foundation. He is a member of the National Standing Committee on HIV/AIDS of the Kenya Medical Association where he is also a co-coordinator of a youth program on HIV/AIDS prevention sponsored by the Centers for Disease Control and Prevention.

M. Patricia Needle, Ph.D., NIDA International Program Consultant

Moving Forward in Real Time: Catalyst for Global Progress on Inhalants Research

❖ **Dr. M. Patricia Needle** is currently a consultant to the National Institute on Drug Abuse (NIDA), AIDS Research and International Programs, at the National Institutes of Health. She also served as Director of the NIDA International Program for a number of years before being seconded to take up the position of Director of the Executive Secretariat for the 2002 International AIDS Conference in Barcelona. During her tenure with NIDA, Dr.

Needle was responsible for establishing the NIDA International Fellowship programs, organizing the International Forum at the College on Problems of Drug Dependence, and has participated in all but one of these meetings. She has planned and implemented more than 30 international meetings and has worked to establish multiple international research collaborations.

Daniel Olguin Olguin, M.S., MIT Laboratory

Social Network Technology to Evaluate and Facilitate Collaboration

Presentation Summary: This presentation discusses wearable and environmental sensors and how they will enable social scientists to automatically measure individual and collective patterns of behavior, predict human behavior from unconscious social signals, identify social affinity among individuals working in the same team, and enhance social interactions by providing feedback to the users of the system. Wearable computing and sensing is now ubiquitous; smart phones are everywhere. The Human Dynamics group at the MIT Media Lab asks how we can make them socially aware, and support building social groups, including friends, families, and business organizations. Our initial projects have demonstrated potential to revolutionize social environments and dramatically improve the competitiveness of companies. Our research is focused on how to develop technologies that can produce organizations that are more creative and efficient, and yet better support the individual. The goal of the Sensible Organizations research initiative is to understand how patterns of behavior shape individuals and organizations by using wearable and environmental sensors.

❖ **Mr. Daniel Olguin Olguin** is a first year Ph.D. candidate at the MIT Media Laboratory. He received a Bachelor of Science degree in Electronics and Communications Engineering, an M.S. degree in Electronic Systems Engineering, both from Tecnológico de Monterrey Campus Monterrey (Mexico) in 2003 and 2005 respectively, and a Master's degree in Media, Arts, and Sciences from the MIT Media Laboratory in 2007. He is part of the Sensible Organizations research initiative at the MIT Media Laboratory. He is interested in developing wearable computing healthcare applications, as well as augmenting wearable sensors and mobile devices with computational capabilities. His research interests include: wearable computing, ubiquitous computing, context-aware computing, machine learning, pattern recognition, body sensor networks, and digital signal processing.

Steven J. Ondersma, Ph.D., Wayne State University

In Pursuit of Worldwide Community Impact: The Importance of Reach and the Need for Authorable Computerized Intervention Software

Presentation Summary: This presentation will: (a) elaborate on the potential of computer-based interventions; (b) briefly review the results of controlled trials of solely computer-based approaches; and (c) discuss their potential use in international settings. This presentation will also review obstacles to the development of computer-based interventions and will introduce fully authorable intervention development software designed to facilitate such efforts. Computer-based interventions are: (a) perfectly replicable in any number of settings; (b) highly accessible, regardless of language or literacy; (c) inexpensive to provide, once development is complete; and (d) can be tailored to an infinite number of behavioral target X participant characteristic X process variable interactions. These characteristics give computer-based approaches exceptional reach, such that their potential for meaningful population impact is unique—even if effect sizes are very small. To date, however, effect sizes in most controlled studies of computer-based interventions have been similar to those found for more intensive, therapist-directed interventions.

❖ **Dr. Steven J. Ondersma** received a Bachelor's degree in Psychology from Calvin College, and a Master's and Doctorate in Clinical Psychology from Wayne State University. He completed an internship and fellowship at the University of Oklahoma (OU) Health Sciences Center (HSC), and subsequently stayed on for three years as an Assistant Professor and Director of Clinical Services at the OUHSC Center on Child Abuse and Neglect. He is

(continued)

currently an Assistant Professor in the Departments of Psychiatry and Behavioral Neurosciences and Obstetrics and Gynecology of Wayne State University. His primary interest is in the intersection between substance abuse and parenting. He has served as director of two Federally-funded programs for parents of drug-exposed infants, and is presently serving as editor of the peer-reviewed journal *Child Maltreatment*. He specializes in motivational interventions, is a member of the Motivational Interviewing Network of Trainers, and was a protocol supervisor for a national multisite study of Motivation Enhancement Therapy (under the NIDA Clinical Trials Network). His current program of research is in the area of brief motivational interventions in the perinatal period, and focuses on parents at risk of child maltreatment, especially those with substance use disorders. Ongoing major projects include a large Phase II clinical trial designed to evaluate the efficacy of a computer-based brief motivational intervention for substance abuse among post partum women, and a randomized trial designed to evaluate a computer-based intervention supplement for new mothers receiving early home visitation services.

Flavio Pechansky, Ph.D., Federal University of Rio Grande do Sul

Strengthening Regional Research Networks

Presentation Summary: In this workshop, the author will describe the steps that were implemented during his return to Brazil in 1994 immediately after finishing his NIDA-funded Hubert H. Humphrey Program Fellowship. A historical perspective will lead the audience into the steps and pitfalls that happened in the process of developing a well established research center in southern Brazil, which is affiliated with NIDA-funded senior investigators, and has a leading role in the author's home country. The process of reentry and the development of a stable network of local, national, and international research peers is a delicate maneuver and requires a series of steps to its successful implementation. All of these steps must be thoroughly understood and designed much before the fellow starts his or her reentry process. After an initial presentation, the audience will be invited to share their own comments and impressions on how to achieve individual and group accomplishments.

❖ **Dr. Flavio Pechansky** is Professor at the University of Delaware and Director of the Center for Drug and Alcohol Research affiliated with the Federal University of Rio Grande do Sul (UFRGS) in Brazil. Dr. Pechansky earned his specialty in Psychiatry, his Master's and Doctoral Degrees in Medicine at UFRGS, and was trained as a NIDA-funded Hubert H. Humphrey Fellow at the Johns Hopkins School of Public Health. He currently heads the Drug Addiction Program at Hospital de Clinicas of Porto Alegre, a teaching hospital affiliated with UFRGS. He has worked as an addiction psychiatrist for the last 20 years and has trained a great number of undergraduate, specialty, and postgraduate students of Medicine, Psychology, and Psychiatry. Dr. Pechansky has been an Associate Professor of Psychiatry at UFRGS since 1995 and holds associate research/professor positions at the University of Delaware and the University of Pennsylvania. He has an extensive career in training, consultancy, and writing in the field, with more than 70 papers published in Brazilian and international scientific journals, as well as more than 15 book chapters in the areas of epidemiology and treatment of alcoholism and drug abuse, adolescent drug and alcohol experimentation, and risk behaviors for the transmission of HIV among drug users. He has served as consultant for the Brazilian government and chair/member of scientific committees of Brazilian institutions, as well as editor and member of editorial boards of Brazilian scientific journals. Currently, Dr. Pechansky is Assistant Regional Editor of the *Addiction Journal*. He has been awarded different prizes for papers published and presented throughout his career and has an Award of Excellence in International Leadership by the National Institute on Drug Abuse.

Robin Pollini, Ph.D., M.P.H., University of California, San Diego

Injection Drug User (IDU) Experiences with Policing and Potential Effects on HIV Risk Behaviors in Two Mexico-U.S. Border Cities

Presentation Summary: We present our study findings as evidence that policing practices play a key roll in shaping the injection risk environment in Tijuana, and effective HIV prevention interventions will require collaboration between public health professionals and law enforcement to create an environment more conducive to safer injection practices. Drug users' behaviors can be influenced by structural level factors that shape the "risk environment" in which drug use occurs. These factors include laws governing drug use and their enforcement by local police. Qualitative research is particularly useful in developing a richly detailed description of the risk environment and its impact on behaviors contributing to adverse health effects, including HIV infection. Since 2004, our binational study team has used qualitative methods to characterize the effects of policing practices on risky injection behaviors in Tijuana, Mexico, where HIV prevalence is on the rise. Although syringes can be legally purchased and possessed without a prescription in Mexico, semi-structured qualitative interviews with 20 injection drug users (IDUs) revealed that police nonetheless frequently arrest IDUs for possessing syringes. This heightened risk of arrest discourages IDUs from carrying syringes for their own personal use and contributes to high utilization of shooting galleries, where syringes are commonly rented or shared.

❖ **Dr. Robin Pollini** is a post-doctoral researcher in the Division of International Health and Cross-Cultural Medicine at the University of California, San Diego School of Medicine. Her research focuses on reducing the public health impact of injection drug use through research and interventions informed by both qualitative and quantitative research methodologies. Her current research is conducted in Tijuana, Mexico, where she is elucidating the effects of structural level factors—including policing and pharmacy sales practices—on syringe sharing among IDUs. Dr. Pollini earned her Ph.D. in Infectious Disease Epidemiology and Master of Public Health degree at the Johns Hopkins Bloomberg School of Public Health.

Kenzie L. Preston, Ph.D., NIDA Intramural Research Program

Computerized Assessment and Treatment Interventions: Adventures in Automation

Presentation Summary: This presentation describes two electronic data collection and automated records systems for clinical research that reduce the influence of human error, increase workflow efficiency, and expand capacity to collect data outside the laboratory. The first system, Automated Contingency Management (ACM), was designed to administer voucher- and prize-based abstinence reinforcement with either computerized or manual prize drawings. ACM accesses participants' drug-test results in our electronic Human-Research Information System (HuRIS), calculates earnings, and then tracks the number of prize draws or the amount of voucher reinforcement earned and disbursed. The second system, Transactional Electronic Diary (TED), is a computer program used to collect Ecological Momentary Assessment (EMA) data. The investigator-modifiable EMA program enables study participants to enter data on inexpensive handheld devices (PDAs) in real time and in their own environments. A participant can use TED simultaneously in two different modes: automatic-prompt mode (random sampling) and manual-prompt mode (event-contingent sampling).

❖ **Dr. Kenzie L. Preston** earned a Bachelor of Science Degree in Pharmacy from the University of Illinois at Chicago in 1976 and a Ph.D. in Pharmacology in 1982 from the University of Chicago. From 1982 to 1984, she completed a post-doctoral fellowship in the Department of Psychiatry and Behavioral Sciences, Johns Hopkins University School of Medicine, working in the area of human behavioral pharmacology. In 1985, Dr. Preston took a faculty appointment in the Department of Psychiatry and Behavioral Sciences, Johns Hopkins University School of Medicine, where she currently holds an academic appointment at the level of Visiting Associate Professor. She joined the staff of the Intramural Research Program (IRP), National Institute on Drug Abuse, as Chief of the Clinical Trials Section of the Treatment Branch in 1991. Dr. Preston is currently Chief of the Clinical

(continued)

Pharmacology and Therapeutics Research Branch. In this position, she directs research at the Archway Clinic, the outpatient substance abuse treatment research program of the IRP. Dr. Preston's major research interests are the development and testing of substance abuse treatment, human behavioral pharmacology of drugs of abuse, and methods of monitoring cocaine and heroin use. She has presented her research at numerous national and international meetings, conferences, and workshops and has published more than 150 scientific articles. Dr. Preston has served on the editorial advisory boards of the *Journal of Pharmacology, and Experimental Therapeutics*, *Behavioral Pharmacology* and *Drug and Alcohol Dependence*. She is an active member of the College on Problems of Drug Dependence and the American Society for Clinical Pharmacology Therapeutics, having served on the Board of Directors and numerous committees of both organizations.

Aron Primack, M.D., Fogarty International Center, National Institutes of Health

Global Health Research Initiative Program (GRIP)

Presentation Summary: The Fogarty International Center (FIC) at the National Institutes of Health provides funding for research and research training programs that help build capacity in, and answer questions relevant to, low- and middle-income countries. To that end, FIC has developed the Global Research Initiative Program (GRIP) for scientists trained in the United States under a few specific mechanisms, including NIDA Fellowships, who come from and are returning to such low- and middle-income countries. This highly competitive program funds up to \$50,000 per year, for between three and five years, to foreign country institutions.

❖ **Dr. Aron Primack** graduated from Northwestern Medical School (Chicago) and is board-certified in Internal Medicine and Medical Oncology. He also has a Master's degree in Cultural Anthropology. He worked in Uganda in cancer research as part of the National Cancer Institute's Intramural Program and in Niger as Area Medical Director for the U.S. Peace Corps. At the present, he is a Program Officer at the Fogarty International Center at the National Institutes of Health.

Timothy Rhodes, Ph.D., London School of Hygiene and Tropical and Tropical Medicine, University of London, United Kingdom

Crack Injection and the Increased Use of the Femoral Vein: A Mixed Method Qualitative Study in the United Kingdom

Presentation Summary: In this presentation, we share our findings from a mixed-method qualitative study undertaken between 2005 and 2006 in Bristol (western England) and London. The study undertook approximately 25 hours of video-recorded field observations of "naturally-occurring" speedball and other drug injection in a variety of injecting locations. Additionally, the study undertook 46 in-depth qualitative interviews with crack-based speedball IDUs to explore narratives of shifts to groin injection, and vein damage and vein care associated with crack injection. Evidence will be presented of a need for reviewing harm reduction in the United Kingdom in relation to vein damage and care in the context of shifts to crack and groin injecting, and a need for interventions promoting safer injecting technique and safer groin injecting.

❖ **Dr. Timothy Rhodes** is a Professor in Public Health Sociology and Director of the Center for Research on Drugs and Health Behavior at the London School of Hygiene and Tropical Medicine, University of London. He leads a program of research focused on the social aspects of risk and HIV/HCV prevention associated with injection drug use, including in Eastern and Southeastern Europe. His academic background is in qualitative methods and the sociology of risk, including the social structural production of drug-related health risk. His current research projects include a mixed-method study of drug injecting in Serbia and Montenegro (for the United Kingdom Department for International Development), an evidence-based review and modeling of harm reduction impact

(for the European Commission), a qualitative study of crack and speedball injection (for the United Kingdom National Treatment Agency for Substance Misuse), and a qualitative prospective study of HIV treatment access and experience (for the Economic and Social Research Council). He is Editor-In-Chief of the *International Journal of Drug Policy*.

Bill Sanders, Ph.D., University of Southern California

The Qualitative View: Risk Behaviors and Strategies for Risk Reduction Among Drug Users

Presentation Summary: While identifying emerging patterns of drug use at the local, regional, or national levels are primary research goals, comparing patterns of use across these levels can also inform public policy and intervention strategies. Qualitative research, which utilizes indepth interviews, observational data, and other newer technologies, is particularly useful for identifying risk behaviors and is a means for reducing risk within local settings. An international panel of researchers will present qualitative findings on drug using behaviors and strategies for reducing risks, such as exposure to HIV/HCV, drug overdose, and drug dependence, based upon studies in five countries.

❖ **Dr. Bill Sanders** was born and raised in Southern California. Dr. Sanders is a sociologist who has published empirical research in the areas of drug use, violence, offending amongst at-risk youth, such as homeless youth, young offenders, young injection drug users, and gang-identified youth. A focus of his research is on how risk behaviors shape negative health and social outcomes. He is currently an ethnographer and analyst on a three-city investigation into risk behaviors surrounding injection drug use among high-risk youth with Dr. Steve Lankenau. He is also a Principal Investigator on a study exploring health risks, including HIV and HCV, associated with substance use, violence, and sexual behavior among gang-identified youth in Los Angeles. The National Institute on Drug Abuse funds both studies. Dr. Sanders holds a position within the Department of Pediatrics at the University of Southern California's Keck School of Medicine and works within the Division of Research on Children, Youth and Families at the Saban Research Institute at Children's Hospital Los Angeles. His latest book, *Drugs, Clubs and Young People: Sociological and Public Health Perspectives*, was published in 2006 by Ashgate.

Mark Swieter, Ph.D., NIDA Office of Extramural Affairs

Update on Electronic Grant Submission and Process for Foreign Investigators

Presentation Summary: Now that the Internet is available to essentially everyone, NIH is in the process of modifying how it does business to take advantage of the wealth of resources made possible by e-mail and the World Wide Web. The deployment of some changes has already occurred; other changes will be coming soon and still others are being planned. This presentation will provide an update of changes in NIH business practices that affect how one goes about applying for a grant from the NIH, including electronic grant application submission via Grants.gov and the NIH electronic Research Administration Commons.

❖ **Dr. Mark Swieter** is Chief of the Training and Special Projects Review Branch and Acting Chief of the Contracts Review Branch in the Office of Extramural Affairs at the National Institute on Drug Abuse (NIDA) at the NIH. In those capacities, he supervises staff that are involved in reviewing grant applications and contract proposals seeking funding via the full array of mechanisms supported by NIDA. He also serves on the NIH-wide Review Policy Committee, which recommends review policy to the NIH Deputy Director for Extramural Research; on the NIH-wide Extramural Staff Training and Development Committee, which recommends policy on training of NIH extramural scientist administrators (Program, Review and Grants Management) to the NIH Deputy Director for Extramural Research; and on the NIDA Research Training Committee, which recommends policy on training and career development to the NIDA Director.

(continued)

Lisia von Diemen, M.D., Ph.D., Federal University of Rio Grande do Sul

The Qualitative View: Risk Behaviors and Strategies for Risk Reduction Among Drug Users

Presentation Summary: This presentation will focus on two qualitative studies about the transition from other drugs to crack use in southern Brazil. In the first study, 19 key informant interviews and 5 focus groups were conducted with a variety of individuals who had knowledge of the local drug scene. The first aim of this study was to acquire knowledge about the increments of crack use as well as the decrease in injection drug use in Porto Alegre, Brazil. The findings showed that a high proportion of injection drug users (IDUs) had become infected by HIV and died and the quality of street cocaine had declined, making injection difficult because of a fear of AIDS. Due to this fact, some drug users shifted to crack smoking, which had become a newly available commodity in the street culture. In the second study, conducted in São Paulo, 31 active crack users and former users were interviewed using semi-structured instruments trying to identify factors associated with the transition from other drugs to crack use. The progression of drug use seemed to be more associated with external decisions (e.g., peer pressure, encouragement of drug dealers) rather than the users' preference. Two different kinds of progression were identified; in younger (<30 years old) users: tobacco and/or alcohol, marijuana, snorted cocaine, and crack; in older (>30 years old) users: tobacco and/or alcohol, marijuana, intravenous medication, snorted cocaine, intravenous cocaine, and crack. Both studies suggest that entry into crack use has changed the drug scene in Brazil.

❖ **Dr. Lisia von Diemen** earned her specialty in Psychiatry and her Master's Degree at the Federal University of Rio Grande do Sul (UFRGS). She has been working in research in substance abuse for the last 10 years and is the data manager of the Center for Drug and Alcohol Research affiliated with the UFRGS in Brazil, and the University of Delaware. Dr. von Diemen is also a consultant in drug and alcohol abuse at Hospital de Clinicas of Porto Alegre, a large teaching hospital affiliated with UFRGS. She oversees the residency training and is responsible for a seminar series in drug abuse treatment and prevention. She has 15 papers published in international and Brazilian journals and is the author of three book chapters.

Dale Weiss, Program Analyst, NIDA International Program

❖ **Ms. Dale Weiss** joined the NIDA International Program in October 2001 as Program Analyst, the senior staff person who shares responsibility with the International Program Director for planning, implementing, coordinating, and evaluating the Institute's international research, research training, and information dissemination programs. Ms. Weiss manages the Fellowship and research exchange programs, numerous Small Business Innovative Research contracts to develop and implement new technology initiatives, the International Program Web page and bimonthly E-News Letter, and the Institute's international visitor program. Prior to joining the International Program, Ms. Weiss served for 13 years as a Contracting Officer for NIDA. She has also served as a Contract Specialist for the National Oceanic and Atmospheric Administration, the Coast Guard, and the Department of Defense. She holds a Bachelor's degree from the University of Maryland University College in Management Studies.

Brenda K. Wiederhold, Ph.D., M.B.A., Virtual Reality Medical Institute (VRMI)

Virtual Reality as a Universal Language for Behavioral Interventions

Presentation Summary: This presentation describes work carried out by VRMI and colleagues throughout the world in virtual reality (VR) pain management and provides an illustration of international collaborations that VR has engendered in providing an effective medium for reproducing and/or enhancing the distractive qualities of guided imagery for the majority of the population who cannot visualize successfully. Human cognition, rather than being centralized, abstract, and sharply distinct from peripheral input and output modules, has deep roots in sensorimotor processing. The basis for VR is that a computer can synthesize a 3-D graphical environment from numerical data. Using visual, aural, and/or haptic devices, the human operator can experience the environment as if it were a part of the real world. VR provides a new human-computer interaction paradigm in which users are no longer simply external observers of images on a computer screen but are active participants within a computer-generated, 3-D virtual world. Active participation in a controlled environment makes VR a perfect medium to augment cognitive-behavioral therapy.

❖ **Dr. Brenda K. Wiederhold** serves as President of the Virtual Reality Medical Institute, a BVBA headquartered in Brussels, Belgium. She is also Executive Vice President of the VRMC, a professional medical corporation headquartered in San Diego, California. She is Chief Executive Officer of both the Interactive Media Institute (IMI), a 501(c) 3 nonprofit organization dedicated to furthering the application of advanced technologies for patient care, and its affiliate IMI–Europe (an international VZW). She is President of VRHealth, a woman-owned healthcare company. Dr. Wiederhold is a Clinical Instructor in the Department of Psychiatry at the University of California, San Diego and is a licensed clinical psychologist with a doctorate in Clinical Health Psychology and has national certification in both biofeedback and neurofeedback. She serves on the editorial board for several publications, including *CyberPsychology & Behavior*, *Emerging Communication*, *International Journal of Virtual Reality*, and a book series of the same title by IOS Press. She also serves on the advisory board for the International Child Art Foundation and on the advisory committee for the California Science Center’s exhibit on the scientific and cultural aspects of fear. She is recognized as a national and international leader in the treatment of anxiety, panic, and phobias with virtual reality exposure and cognitive-behavioral therapy, having completed over 6,000 virtual reality therapy sessions. She currently has a funded Phase II program studying VR as a distraction for acute and chronic pain from the National Institute on Drug Abuse, and several funded programs to provide treatment for military members returning from the war. In addition, she has served as an invited speaker in Belgium, Canada, China, Croatia, Denmark, France, Germany, Israel, Italy, Korea, Luxembourg, Slovenia, Sweden, and Switzerland on the topic of technology in healthcare. In 2005, she was the recipient of the prestigious Richard M. Satava award, and in 2006, the Outstanding Research Award. She has authored over 150 publications.

Erin L. Winstanley, Ph.D., NIDA International Program Consultant

The Qualitative View: Risk Behaviors and Strategies for Risk Reduction among Drug Users

❖ **Dr. Erin L. Winstanley** is a Postdoctoral Research Fellow at Johns Hopkins University School of Medicine, Department of Psychiatry and Behavioral Sciences, Behavioral Pharmacology Research Unit. Dr. Winstanley received her Doctorate degree from Johns Hopkins Bloomberg School of Public Health and specializes in behavioral health services research. Dr. Winstanley has been a research consultant at the NIDA International Program for 4 years.

(continued)



AUSTRIA



Gabriele Fischer, M.D.

Medical University of Vienna, Austria
 Währinger Gürtel 18 - 20
 1090 Vienna
 Austria
 Phone: +43-1-40400-2117
 Fax: +43-1-40400-3629
 E-mail: gabriele.fischer@meduniwien.ac.at

BRAZIL



Flavio Pechansky, Ph.D.

1993-1994 Hubert H. Humphrey Fellow (Brazil)
 Department of Psychiatry
 Center for Drug and Alcohol Research
 Federal University of Rio Grande do Sul
 Ramiro Barcelos 2350
 Room 2201A - HCPA
 Iguaçú 119, Room 505
 Porto Alegre 90035-003
 Brazil
 Phone: +55-51-3330-5813
 Fax: +55-51-3334-4092
 E-mail: fpechans@uol.com.br

Lisia von Diemen, M.D., Ph.D.

Psychiatrist
 Center for Drug and Alcohol Research
 Federal University of Rio Grande do Sul
 2350/2201F Ramiro Barcelos Street
 Porto Alegre 91530-060
 Brazil
 Phone: +55-51-9968-7698
 Fax: +55-51-3330-5813
 E-mail: lisiavd@hotmail.com

CANADA



Richard Brière, Ph.D.

Institute of Neurosciences, Mental Health
 and Addiction
 Canadian Institutes of Health Research
 Douglas Hospital
 6875 Lasalle Boulevard
 Quebec, Verdun H4H 1R3
 Canada
 Phone: +1-514-761-6131 ext. 3930
 Fax: +1-514-888-4060
 E-mail: richard.briere@douglas.mcgill.ca

Colleen Anne Dell, Ph.D.

Canadian Centre on Substance Abuse
 75 Albert Street, Suite 300
 Ontario
 Ottawa K1P 5E7
 Canada
 Phone: +613-235-4048 ext. 235
 Fax: +613-235-8101
 E-mail: cadell@ccs.carleton.ca
 cdell@ccsa.ca

Debra Dell, Ph.D.

National Youth Solvent Addiction Coordinator, Canada
 123 Assiniboine Drive
 Saskatoon, Saskatchewan
 Ontario, S7K 1H8
 Canada
 Phone: +306-683-4651
 Fax: +306-382-0989
 E-mail: ysac@shaw.ca

MEXICO



Silvia L. Cruz, Ph.D.

1996-1997 NIDA Invest Fellow (Mexico)
Department of Pharmacobiology
Cinvestav
Czda. Tenorios #235, Col. Granjas Coapa
Mexico City 14330
Mexico
Phone: +52-55-5061-2856
Fax: +52-55-5061-2863
E-mail: cruz_farma@yahoo.com

Judith Babbitts, Ph.D.

Assistant Director
Hubert H. Humphrey Fellowship Program
Institute of International Education
1400 K Street, NW, Suite 600
Washington, District of Columbia 20005
United States
Phone: +1-202-326-7745
Fax: +1-202-326-7702
E-mail: jbabbits@iie.org

UNITED KINGDOM



Timothy Rhodes, Ph.D.

Professor
Centre for Research on Drugs and Health Behavior
London School of Hygiene and Tropical Medicine
Department of Public Health and Policy
1 Keppel Street
London WC1E 7HT
United Kingdom
Phone: +44-777-161-8885
Fax: Did not provide
E-mail: tim.rhodes@lshtm.ac.uk

Robert L. Balster, Ph.D.

Professor
Institute for Drug and Alcohol Studies
Hubert H. Humphrey Fellowship Program
Virginia Commonwealth University
P.O. Box 980310
Richmond, Virginia 23298-0310
United States
Phone: +1-804-828-8402
Fax: +1-804-827-0304
E-mail: balster@vcu.edu

Warren K. Bickel, Ph.D.

Professor and Director
Center for Addiction Research
Department of Psychiatry
University of Arkansas for Medical Sciences
4301 West Markham, Slot 843
Little Rock, Arkansas 72205
United States
Phone: +1-501-526-7802
Fax: +1-501-526-7816
E-mail: WBickel@uams.edu

UNITED STATES



Cassandra R. Allen

Office of Outreach & Special Populations
National Library of Medicine
6707 Democracy Boulevard, MS 5467
Bethesda, Maryland 20894
United States
Phone: +1-301-496-6464
Fax: +1-301-480-3537
E-mail: allenc@mail.nlm.nih.gov

Timothy P. Condon, Ph.D.

Deputy Director
National Institute on Drug Abuse
National Institutes of Health
6001 Executive Boulevard, Room 5274
Bethesda, Maryland 20892
United States
Phone: +1-301-443-6036
Fax: +1-301-443-9127
E-mail: tcondon@nida.nih.gov

Steven W. Gust, Ph.D.

Director
International Program
National Institutes of Health
National Institute on Drug Abuse
6001 Executive Boulevard
Bethesda, Maryland 20892
United States
Phone: +1-301-443-6480
Fax: +1-301-443-9127
E-mail: ipdirector@nida.nih.gov

James W. Hopper, Ph.D.

Instructor in Psychology
Department of Psychiatry
Harvard Medical School
McLean Hospital
115 Mill Street
Behavioral Psychopharmacology Research Laboratory
Belmont, Massachusetts 02474
United States
Phone: +1-617-855-3378
Fax: +1-617-855-3711
E-mail: jhopper@mclean.harvard.edu

Matthew O. Howard, Ph.D.

Professor
Division of Medicine
Department of Psychology
The University of Michigan
1080 South University Avenue
Ann Arbor, Michigan 48109
United States
Phone: +1-734-327-4615
Fax: +1-734-763-3372
E-mail: matthowa@umich.edu

Jonathan Hunt-Glassman

Special Assistant to the President
Danya International, Inc.
8737 Colesville Road, Suite 1100
Silver Spring, Maryland 20910
United States
Phone: +1-301-960-2920
Fax: +1-301-565-3710
E-mail: jglassman@danya.com

Marya Hynes-Dowell, M.H.S.

Organization of American States
Inter-American Drug Abuse Control Commission
Drug Abuse Research Specialist
Observatory on Drugs
1889 F Street, NW
Washington, District of Columbia 22202
United States
Phone: +1-202-458-6119
Fax: +1-202-458-3658
E-mail: mhynes@oas.org

Krystyna Isaacs, Ph.D.

Senior Program Officer
JGPerpich, LLC
7315 Wisconsin Avenue
Suite 500E
Bethesda, Maryland 20814
United States
Phone: +1-469-549-4727
Fax: +1-469-549-4578
E-mail: krysisaac@gmail.com

Rehanna Kader, M.Psych.

2006-2007 Hubert H. Humphrey Fellowship
(South Africa)
Clinical Psychologist
Institute of Drug and Alcohol Studies
Virginia Commonwealth University
National Institute on Drug Abuse
1008 East Clay Street
Richmond, Virginia 23298
United States
Phone: +1-804-651-9597
Fax: +1-804-828-7862
E-mail: kaderr@vcu.edu

Salvatore Libretto, Ph.D.

Associate Director of Research
Danya International, Inc.
8737 Colesville Road, Suite 1100
Silver Spring, Maryland 20910
United States
Phone: +1-240-645-1094
Fax: +1-240-645-1518
E-mail: slibretto@danya.com

(continued)

Judy McCormally

Consultant
IQ Solutions, Inc.
5522 17th Street North
Arlington, Virginia 22205
United States
Phone: +1-703-536-6055
Fax: +1-703-532-8116
E-mail: jmccormally@comcast.net

Sheryl A. McCurdy, Ph.D.

Assistant Professor
Health Promotion and Behavioral Sciences
School of Public Health
University of Texas Houston Health Science Center
7000 Fannin, 2520
Houston, Texas 77030
United States
Phone: +1-713-500-9633
Fax: +1-713-500-9750
E-mail: sheryl.a.mccurdy@uth.tmc.edu

Peter Ndege, M.D.

2006-2007 Hubert H. Humphrey Fellow (Kenya)
Epidemiology and Community Health
Institute of Drug and Alcohol Studies
Virginia Commonwealth University
1008 East Clay Street
P.O. Box 980344
Richmond, Virginia 23298
United States
Phone: +1-804-651-9386
Fax: +1-804-828-7862
E-mail: ndegep@vcu.edu

M. Patricia Needle, Ph.D.

Consultant
1134 Bonview Lane, NE
Atlanta, Georgia 30324
United States
Phone: +1-404-814-9158
Fax: +1-404-814-9158
E-mail: pneedle@bellsouth.net

Daniel Olgiun Olgiun, M.S.

MIT Media Laboratory
20 Ames Street, E15-386)
Cambridge, MA 02139
United States
Phone: +1-617-595-1858
Fax: +1-617-253-8874
E-mail: dolgiun@mit.edu

Steven J. Ondersma, Ph.D.

Assistant Professor
Psychiatry and OB/GYN
Substance Abuse Research Division
Wayne State University
2761 East Jefferson Avenue
Detroit, Michigan 48207
United States
Phone: +1-313-577-6680
Fax: +1-313-993-1372
E-mail: s.ondersma@wayne.edu

Robin Pollini, Ph.D., M.P.H.

Postdoctoral Fellow
Family and Preventive Medicine
International Health and Cross-Cultural Medicine
University of California, San Diego
9500 Gilman Drive, Mailcode 0622
La Jolla, California 92093
United States
Phone: +1-858-534-0710
Fax: +1-858-534-4642
E-mail: rpollini@ucsd.edu

Kenzie L. Preston, Ph.D.

NIDA Intramural Research Program
5500 Nathan Shock Drive
Baltimore, Maryland 21224
United States
Phone: +1-410-550-1639
Fax: +1-410-550-1528
E-mail: kpreston@intra.nida.nih.gov

Aron Primack, M.D.

Fogarty International Center
National Institutes of Health
Building 31, Room B2 C39
Bethesda, Maryland 20892-2220
United States
Phone: +1-301-496-4596
Fax: +1-301-402-0779
E-mail: primacka@mail.nih.gov

Bill Sanders, Ph.D.

University of Southern California
Childrens Hospital Los Angeles
6430 West Sunset Boulevard
Suite 1500
Hollywood, California 90028
United States
Phone: +1-310-429-4085
Fax: +1-323-906-8043
E-mail: bsanders@chla.usc.edu

Mark Swieter, Ph.D.

Branch Chief
Office of Extramural Affairs
National Institute on Drug Abuse
National Institutes of Health
6101 Executive Boulevard, Room 209
Bethesda, Maryland 20892
United States
Phone: +1-301-435-1389
Fax: +1-301-443-0538
E-mail: ms80x@nih.gov

Dale Weiss

Program Analyst
International Program
National Institute on Drug Abuse
National Institutes of Health
6001 Executive Boulevard
Bethesda, Maryland 20892
United States
Phone: +1-301-443-6480
Fax: +1-301-443-9127
E-mail: dweiss@nida.nih.gov

Brenda K. Wiederhold, Ph.D., M.B.A.

Virtual Reality Medical Institute
c/o VRMC, 6160 Cornerstone Court East
Suite 155
San Diego, California 92121
United States
Phone: +1-858-642-0267
Fax: +1-858-642-0285
E-mail: bwiederhold@vrphobia.com

Erin L. Winstanley, Ph.D.

Postdoctoral Research Fellow
Johns Hopkins University School of Medicine
Department of Psychiatry and Behavioral Sciences
Behavioral Pharmacology Research Unit
5510 Nathan Shock Drive, BBRC Building G
Baltimore, Maryland 21224-6823
Phone: +1-410-550-1989
Fax: +1-410-550-0030
E-mail: ewinstal@jhmi.edu

(continued)

Explore

endless possibilities that can change the world.

Explore International Research and Training Opportunities

As part of its International Program, the National Institute on Drug Abuse (NIDA) supports international scientific research and training, especially through collaborative efforts between international and U.S. scientists.

NIDA International Fellowships and Research Exchange Programs

NIDA International Program Fellowships provide unparalleled research training, while Research Exchange Programs support direct collaborations between NIDA grantees and their colleagues from other countries. Researchers who participate in NIDA international research training and exchange programs benefit from their colleagues' differing perspectives and research approaches. For more information, please visit the NIDA International Program Web sites listed for each program.

NIDA International Fellowships

- **INVEST Research Fellowships** are competitive, 12-month postdoctoral appointments to U.S. institutions for scientists from other countries. Fellows complete rigorous postdoctoral research training with a NIDA grantee, attend NIDA orientations, and participate in scientific meetings. The fellowship is fully funded by NIDA. <http://www.international.drugabuse.gov/invest.html>
- **NIDA Hubert H. Humphrey Drug Abuse Research Fellowships** are competitive, 10-month fellowships for mid-career professionals from low- and middle-income countries. Fellows enroll in mentored academic study at Virginia Commonwealth University, complete a research affiliation and professional experience with a NIDA-supported scientist, and participate in scientific meetings and NIDA orientations. <http://www.international.drugabuse.gov/hhhdarf.html>

Research Exchange

- **NIDA Distinguished International Scientist Collaboration Awards (DISCA) and NIDA U.S. Distinguished International Scientist Collaboration Awards (USDISCA)** are competitive, results- and product-oriented awards that support 1- to 3-month professional visits to advance collaborative research efforts. USDISCA is for U.S. citizens and permanent residents; DISCA is for applicants from any other country. <http://www.international.drugabuse.gov/disca.html>

For more information, contact :
National Institute on Drug Abuse
National Institutes of Health
U.S. Department of Health and Human Services

c/o IQ Solutions, Inc.
11300 Rockville Pike, Suite 901, Rockville, Maryland 20852, USA
Telephone: +1-301-984-1471 | Fax: +1-301-984-1473 |
E-mail: ip@nida.nih.gov
Website: www.international.drugabuse.gov

Research Grants for International Collaborations

NIDA supports research on the biomedical and behavioral causes, consequences, prevention, and treatment of drug abuse and addiction. International research is funded through two mechanisms:

- **Foreign grants** allow researchers from outside the United States to compete for funding within the NIH system. The actual research is conducted outside the United States. For a grant to be awarded to a foreign institution, the principal investigator must demonstrate a special opportunity to further drug abuse research through use of expertise, resources, populations, or environmental conditions not readily available in the United States.
- **Domestic grants with a foreign component** enable U.S.-based principal investigators to conduct cooperative international studies with foreign partners. The foreign component is part of the original grant and the entire application is scored competitively.

Current Program Announcements

The NIDA International Program bimonthly E-News Letter lists relevant Program Announcements. Subscribe or visit the online archives at <http://www.international.drugabuse.gov/newsletter.html>.

International Research Collaboration on Drug Addiction solicits collaborative research proposals on drug abuse and addiction that take advantage of unusual talent, resources, populations, or environmental conditions in other countries; speed scientific discovery; and meet NIDA research priorities. Funds are available for research using three grant mechanisms:

- R01: PA-07-275 <http://grants.nih.gov/grants/guide/pa-files/PA-07-275.html>
- R03: PA-07-311 <http://grants.nih.gov/grants/guide/pa-files/PA-07-311.html>
- R21: PA-07-310 <http://grants.nih.gov/grants/guide/pa-files/PA-07-310.html>

Fogarty International Center Opportunities for International Training or Research

The Fogarty International Center administers other NIH programs that support professional development opportunities or collaborative international research. The Fogarty International Center Web site (www.fic.nih.gov) also lists other NIH opportunities and provides links to non-NIH information sources. NIDA currently participates in a number of Fogarty programs:

Research Training Grants

- **AIDS International Training and Research Program Awards (AITRP)** support biomedical and behavioral research training in developing and transitional countries on HIV/AIDS and related tuberculosis (TB), and research on prevention of HIV infection among drug-using populations.

- **International Clinical, Operational, and Health Services Research and Training Awards (ICOHRTA)** support institutional training programs for collaborative, multidisciplinary, international research in developing and transitional countries. ICOHRTA-AIDS/TB awards support training to foster collaborative, multidisciplinary research in developing and transitional countries where AIDS, TB, or both are significant problems.
- **International Bioethics Education and Career Development Awards (BIOETH)** support institutional grants to develop bioethics curricula on research in low- and middle-income nations.
- **The International Collaborative Genetics Research Training Program (GENE)** provides research training and capacity building in developing and transitional countries with an existing institutional infrastructure available to sustain advances in genetic science.

Research Grants

- **The Global Health Research Initiative Program for New Foreign Investigators (GRIP)** supports the return of NIH-trained foreign investigators to their home countries as part of a broader program to enhance the scientific research infrastructure in developing countries, and to stimulate research of high priority global health-related issues. Former NIDA INVEST Fellows are eligible to compete for GRIP awards.
- **Brain Disorders in the Developing World (BRAIN)** supports collaborative research and capacity-building projects on brain disorders in developing countries.
- **The Fogarty International Research Collaboration - Behavioral, Social Sciences Award (FIRCA-BSS) and the companion Fogarty International Research Collaboration - Basic Biomedical Award (FIRCA-BB)** facilitate collaborative research between scientists supported by NIDA and investigators in developing and transitional countries.
- **The International Cooperative Biodiversity Groups (ICBG) Program** is a unique effort that addresses the interdependent issues of drug discovery, biodiversity conservation, and sustainable economic growth.
- **The International Tobacco and Health Research and Capacity Building Program (TOBAC)** supports trans-disciplinary research on tobacco consumption in low- or middle-income nations.
- **The Stigma and Global Health Research Program (STIGMA)** supports interdisciplinary research on the etiology, prevention, or mitigation of stigma and related public health outcomes.



Explore all the funding opportunities in one place: <http://international.drugabuse.gov/funding.html>

The NIDA International Program Awards of Excellence recognize individuals for outstanding contributions to international cooperation in drug abuse research and training. The awards are presented each June at the NIDA International Forum to persons who have demonstrated outstanding and sustained support of the NIDA International Program mission in three categories:

Mentoring.

Excellence in Mentoring

Recognizes NIDA grantees who have served as mentors for the INVEST or NIDA Hubert H. Humphrey Drug Abuse Research Fellowship programs and who have continued their mentoring beyond the fellowship period. The awardees have demonstrated exceptional guidance to help NIDA Fellows achieve research independence and are leaders in the Institute's efforts to develop an international community of scientists who exchange information and collaborate on drug abuse research nationally, regionally, and globally.

International Leadership.

Excellence in International Leadership

Recognizes U.S. or non-U.S. drug abuse researchers who have made significant contributions to international collaborative research and/or capacity building outside the United States. The awardees serve as exemplars to their colleagues through superior efforts to develop the human resources necessary to improve scientific understanding of drug abuse and addiction and develop and implement science-based prevention and treatment programs.

Collaborative Research.

Excellence in Collaborative Research

Recognizes creative or pioneering efforts by bi-national or multinational research teams consisting of at least one NIDA grantee and one non-U.S. research partner who have appreciably improved the mechanisms to foster international collaborative research and/or significantly contributed to scientific knowledge about drug abuse and addiction.

Additional selection criteria include:

- Innovative, creative, and pioneering achievement.
- Unique contributions by the nominee to that achievement.
- Positive change over a sustained period—not simply the potential for such change—through the nominee's achievement.
- A qualitative and quantitative impact.
- Success in overcoming barriers, based on resources available.

Recognition.

Nominations are being accepted for The NIDA International Program Awards of Excellence

The NIDA International Program welcomes nominations from any individual or organization. Nominations should be accompanied by a detailed written description of the accomplishments of the nominee, and an explanation of why those accomplishments merit the NIDA International Program Award of Excellence. Nominations should not exceed 2 pages in length. Only written material will be considered. Letters of endorsement or a curriculum vita in addition to the nomination are not necessary and will not be considered.

2007 NIDA International Program Award of Excellence in Mentoring

Wallace Mandell, Ph.D.

Department of Mental Health
Johns Hopkins Bloomberg School of Public Health
Baltimore, Maryland, United States

Dr. Wallace Mandell has coordinated the Hubert H. Humphrey Fellowship Program at Johns Hopkins University since 1988, where his mentoring has shaped the face of drug abuse research, treatment, prevention, and policy throughout the world. The Mandell version of a Humphrey Fellowship goes beyond science to include leadership skills as well as the sense of community and shared purpose Dr. Mandell creates among individuals from countries with different economic, social, cultural, and political perspectives. Throughout his career, Dr. Mandell has worked to create opportunities for mid-career drug abuse professionals and has served as the gold standard for other senior scientists interested in training the next generation of experts in drug abuse research, treatment, prevention, and policy.

2007 NIDA International Program Award of Excellence in International Leadership

David S. Metzger, Ph.D.

Center for Studies of Addiction
University of Pennsylvania
Philadelphia, Pennsylvania, United States

Dr. David S. Metzger has led global efforts to prevent HIV transmission by reducing drug use and associated risk behaviors. Internationally, his research group is involved in studies among drug users in St. Petersburg, Russia, and Rio de Janeiro and Porto Alegre, Brazil. As Chair of the Substance Use Working Group for the HIV Prevention Trials Network (HPTN), Co-Chair for HPTN Protocol 037, and Chair of HPTN Protocol 058, Dr. Metzger helped develop and implement protocols for studies targeting drug-using populations, with HIV infection as the primary outcome measure. As the Principal Investigator for the HPTN Unit in Philadelphia, Dr. Metzger has contributed significantly to science-based efforts to confront the twin pandemics of drug abuse and HIV/AIDS in Brazil, China, Russia, Thailand, and the United States. .

2007 NIDA International Program Award of Excellence in Collaborative Research

Richard S. Schottenfeld, M.D.

Department of Psychiatry
Yale University School of Medicine
New Haven, Connecticut, United States

Mahmud Mazlan, M.D.

Addiction Medicine
Substance Abuse Center
Muar, Malaysia

Dr. Richard S. Schottenfeld and Dr. Mahmud Mazlan have built an effective partnership on research into drug abuse and HIV risk reduction, including a NIDA-funded clinical trial comparing naltrexone and buprenorphine as maintenance treatments for heroin addicts in Malaysia. Drs. Schottenfeld and Mazlan developed substance abuse treatment training programs for Malaysian primary care providers, needle exchange programs, and scientific publications and presentations. Their work helped improve the availability of HIV treatment for injection drug users and shift Malaysian policy from incarceration to medical treatment. Currently, more than 30,000 opiate-dependent patients are treated with agonist maintenance treatments by more than 500 medical practitioners in Malaysia. The partners continue to collaborate, taking advantage of the new Malaysian policies to develop, implement, and disseminate effective drug treatments and educate drug abusers about the risks of HIV infection and transmission.

The National Institute on Drug Abuse International Program

Methadone Research Web Guide—Updated and Modified

Now available online: The Methadone research findings you want, and the resources you need.

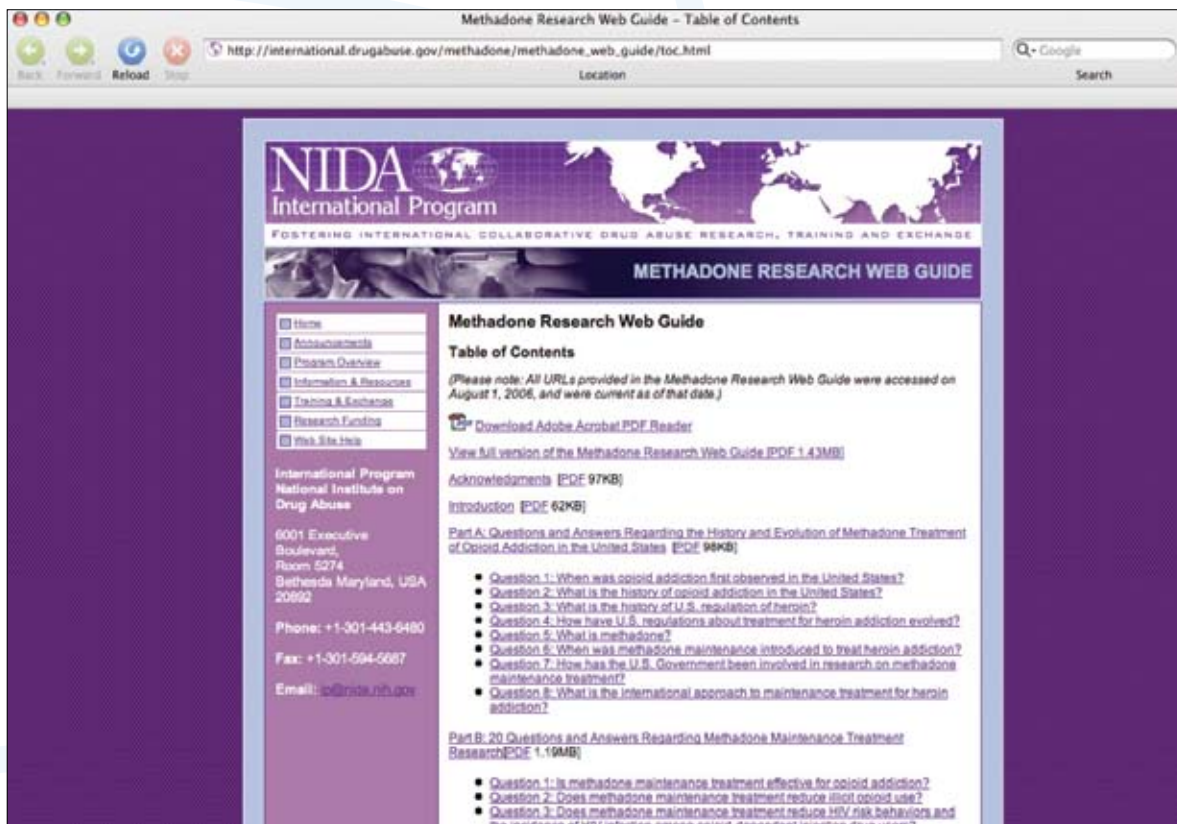

http://international.drugabuse.gov/methadone/methadone_web_guide/toc.html

The Origin and Purpose of the Methadone Research Web Guide

The Methadone Research Web Guide is an updated and modified version of the NIDA publication titled “Methadone Maintenance Treatment: Translating Research Into Policy,” which was published in 1995 in support of the International Visiting Scientists and Technical Exchange Program (INVEST). The research has been updated to include key findings related to methadone treatment of opioid addiction in the United States during the past 40 years. Additional sections have been added to detail the expansive history of methadone maintenance as a treatment modality in the United States and to provide links to resources addressing methadone treatment program implementation considerations.

The purpose of the Web guide is to give a basic overview of research supporting approval of methadone maintenance as a viable opioid treatment therapy in the United States. It is designed to answer the most frequently posed questions by the international community regarding the path of research inquiry used by the United States, which could be used by other countries to support approval of methadone as a treatment therapy.

Québec offers a friendly welcome to all who visit, and such a welcome precedes a host of delights: the greatest gastronomy in Canada; cosmopolitan shopping; wide, sandy beaches; and excellent facilities for adventures ranging from watersports to hiking.

Summer months (June to August) are hot with cooler evenings. For more information about the weather click on <http://www.theweathernetwork.com/weather/cities/can/Pages/CAQC0441.htm>.

Airport: You will fly into Jean Lesage International Airport. The airport is a 25-minute drive into Québec city.

Ground Transport: Airport transportation is by taxi at \$30. (CA) for the 25-minute ride into the city.

Car Rental: Alamo, Avis, Budget, Hertz, National, and Thrifty are represented onsite.

Getting Around Quebec City: Walking is the easiest and most effective way to explore the compact Old City of Québec, where most of the sightseeing opportunities are. Many visitors also enjoy renting a bicycle and making the most of the city's system of cycle paths. If you prefer to save your feet, take a bus. Public buses are run by the Réseau de transport de la Capitale (RTC), operating between 6:00 a.m. and 1:00 a.m. (there are a limited number of night buses on weekends). Tickets are bought (\$2.25 CA) on boarding with exact change or in advance from newsagents, which is cheaper. Transfers are free if a transfer slip is obtained on the first bus. One-day passes, valid for two, can be bought on weekends. Taxis can be hired at ranks and the airport, ordered by telephone, or hailed in the street in the center of the city.



Restaurants

A veritable capital of fine cuisine, Québec City has more gourmet restaurants per capita than any other city on the continent. A few are listed below.

The Allegro Restaurant

(418) 647-6521

Offers elegance and charm, combined with international gourmet dining. Casual attire.
Open from 7:00 a.m. – 11:00 p.m.

Pointe des Amériques (La)

964, rue St-Jean

(418) 694-1199

This restaurant is a pizza lover's dream come true. Every imaginable topping is available, including rarities like duck, caribou, and alligator. Pasta, fajitas, burgers, and paninis are also on the menu, and a party atmosphere is always in the air. In the summer, customers can enjoy their meal on a terrace overlooking Place d'Youville.
Open 11 :00 a.m. – 11 :00 p.m.

Continental (Le)

6, rue Saint-Louis

(418) 694-9995

Located in the heart of Old Québec, near the Château Frontenac, this renowned French restaurant is located in an elegant Victorian mansion built in 1845.
Open from 12 noon – 11 :00 p.m.

Café d'Europe

27 Ste-Angèle

(418) 692-3835

This 30-year-old restaurant is an intimate dining landmark in Québec City. Many loyal clients visit Jean and Renato La Rosa time and time again for their creative mixture of traditional French and Italian cuisine. Meat and potatoes lovers feast on lamb rubbed with garlic and rosemary.

Maurice Bar and Discoteques

575 Grande Allee Est

(418) 647-2000

Located near major hotels, the Maurice Night Club and the Charlotte Lounge occupy a prestigious, century-old building that formerly housed the offices of Québec Premier Maurice Duplessis. Capacity of 1000. Theme nights; hip hop, Latino music, or resident entertainment.

Chez Ashton

640, Grande Allee

(418) 522-3449

Chez Ashtons's specialties include roast beef sandwiches, hamburgers made from fresh ground beef, fries prepared by hand from fresh potatoes, and the traditional Québec "poutines."

La Marie G

1060 Louis-Alexandre-Taschereau

(418) 648-6368

Daily menu at 5.00. Pizza and spaghetti at 4:00
Healthful menu without salt, MSG, and trans fats.
Salad bar at \$13 (CA) per kilogram. Sample plate ranging from 8.00 – 12.00.

The Convention Center

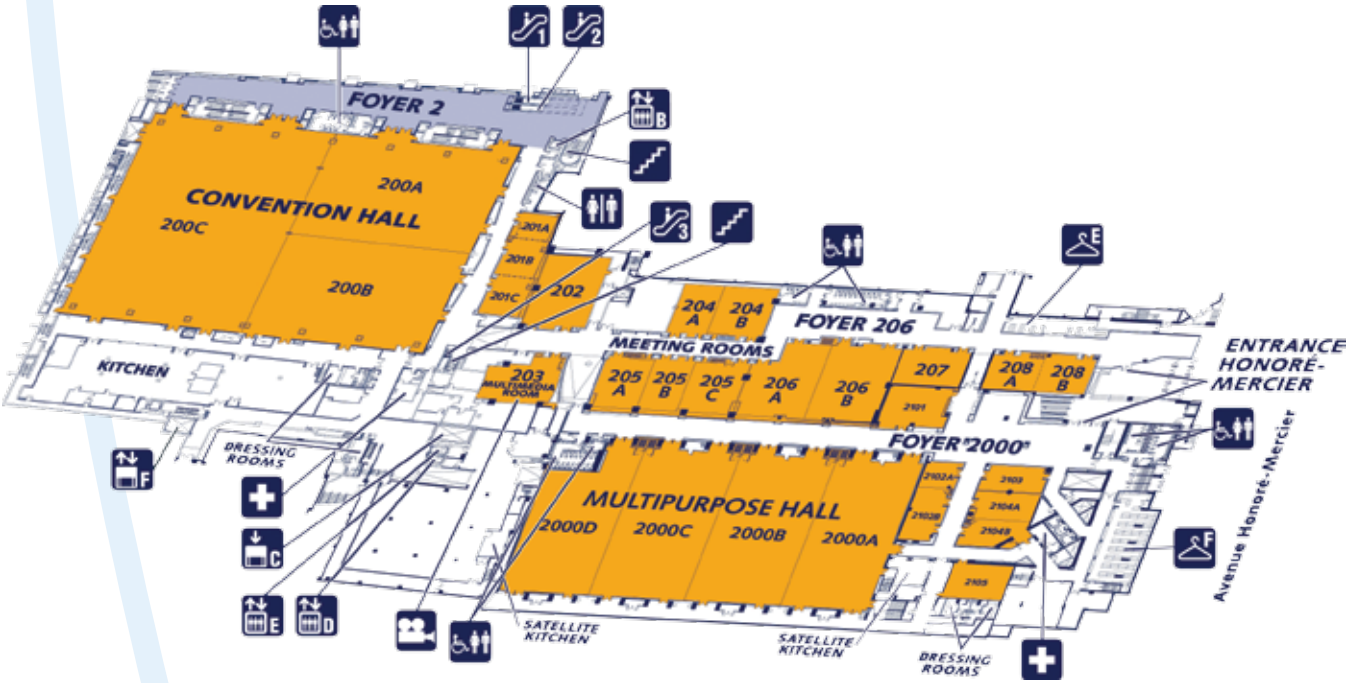
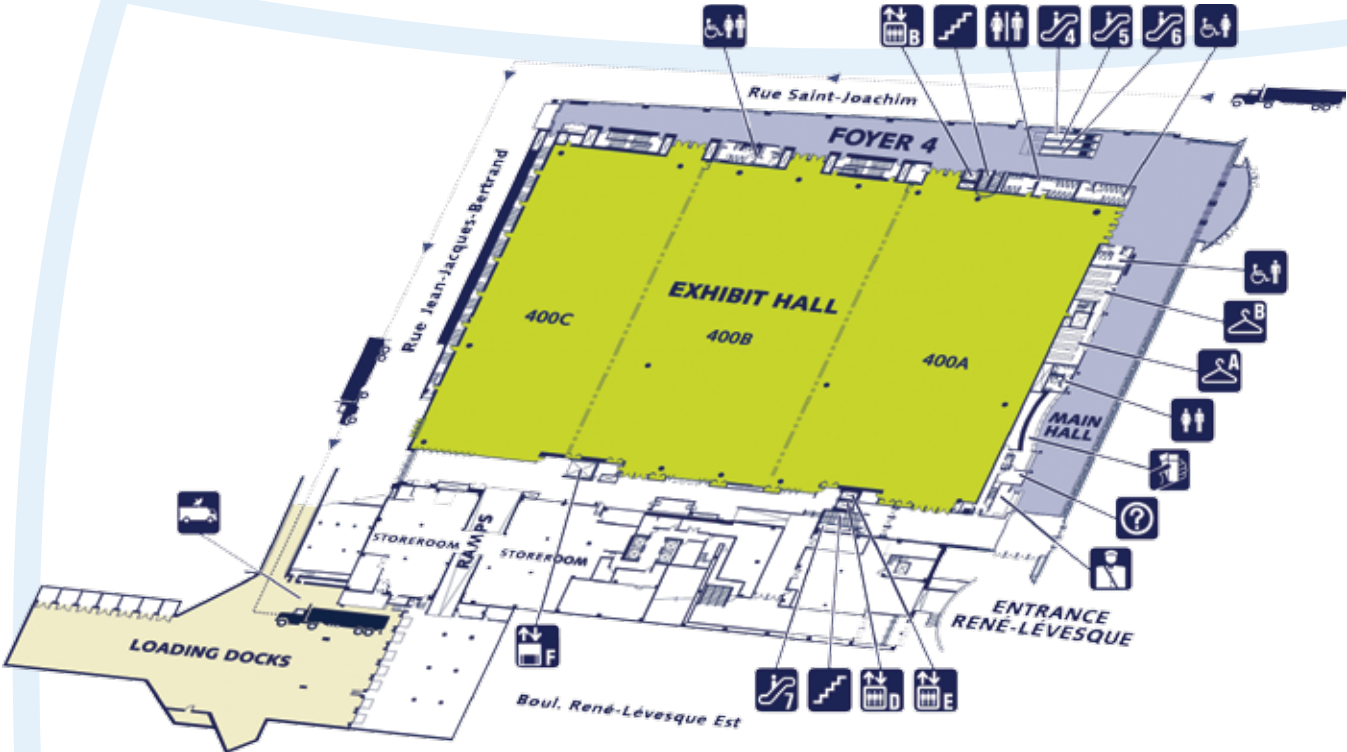



SALLES DE RÉUNION / MEETING ROOMS

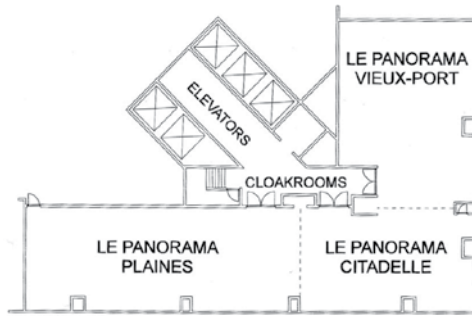

23RD FLOOR **23e étage**

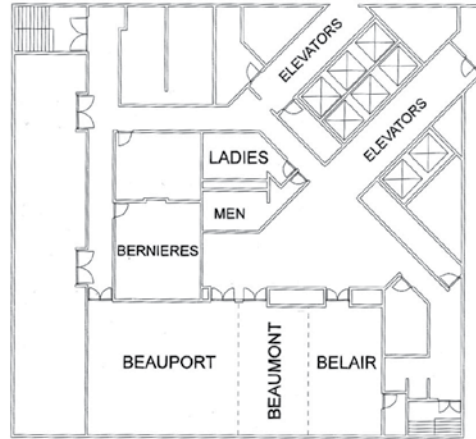

2ND FLOOR **2e étage**

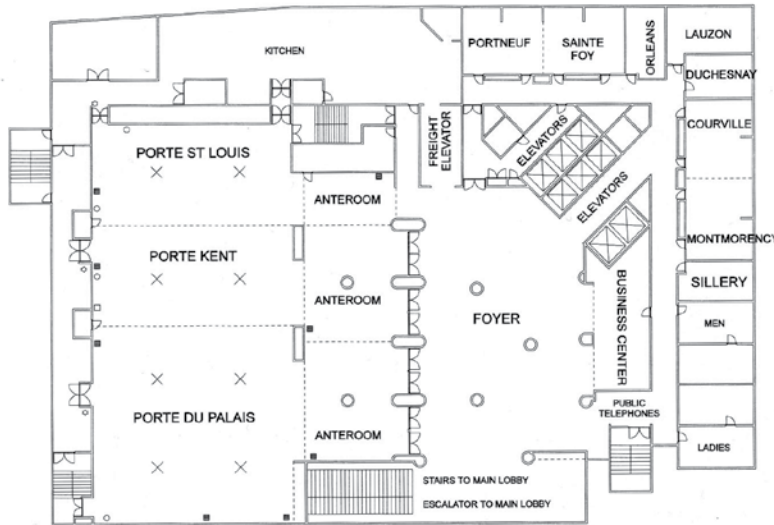

1ST FLOOR **1er étage**



Hilton Québec
1100, boulevard René-Lévesque Est
C.P. 1797, Québec (Qué) G1K 7K7 Canada



2 0 0 7
NIDA INTERNATIONAL FORUM

Programs at a Glance

Forum Workshop Friday, June 15, 2007 The Québec Hilton Hotel

3:00 p.m. – 6:00 p.m.	Registration	<i>Porte Ballrooms Foyer</i>
3:30 p.m. – 4:45 p.m.	Building on Your Experience: Post-Fellowship Opportunities ❖ Funding Opportunities ❖ Hubert H. Humphrey and INVEST Fellows Alumni Activities	<i>Porte St. Louis Room</i>
4:45 p.m. – 5:30 p.m.	Strengthening Regional Research Networks	<i>Porte St. Louis Room</i>
6:00 p.m. – 8:00 p.m.	Welcome and Networking Session	<i>Porte Ballrooms Foyer</i>

Forum Symposium Saturday, June 16, 2007 Québec City Convention Center

7:30 a.m. – 8:30 a.m.	Registration	<i>Foyer 206</i>
8:30 a.m. – 12:15 p.m.	Opening Plenary Session ❖ Welcoming Remarks ❖ Building the International Research Community: NIDA International Program Update ❖ Using Innovative Technology in Drug Addiction Research	<i>Rooms 206AB</i>
12:15 p.m. – 12:30 p.m.	2007 NIDA International Program Awards of Excellence	<i>Rooms 206AB</i>
12:30 p.m. – 1:45 p.m.	Networking Lunch	<i>Rooms 205ABC</i>
1:30 p.m. – 4:00 p.m.	Building Contacts with NIDA	<i>Room 203</i>
1:45 p.m. – 4:00 p.m.	Concurrent Breakout Sessions: ❖ Risk Behaviors and Strategies for Risk Reduction Among Drug Users: Qualitative Description From Four Countries ❖ Web Tools for Education and Collaboration ❖ Moving Forward in Real Time: Catalyst for Global Progress on Inhalants Research	<i>Rooms 204AB</i> <i>Rooms 208AB</i> <i>Room 202</i>

Forum Poster Session Sunday, June 17, 2007 The Québec Hilton Hotel

8:00 p.m. – 10:00 p.m.	International Research Posters and Web Tools Demonstrations	<i>Porte du Palais Ballroom</i>
------------------------	---	---------------------------------

Forum Review and Future Planning Monday, June 18, 2007 Québec City Convention Center

12:00 p.m. – 1:00 p.m.	Forum Review and Future Planning	<i>Rooms 204AB</i>
------------------------	----------------------------------	--------------------