

Anthrax in the U.S. Postal System

Lessons That Stunned Us

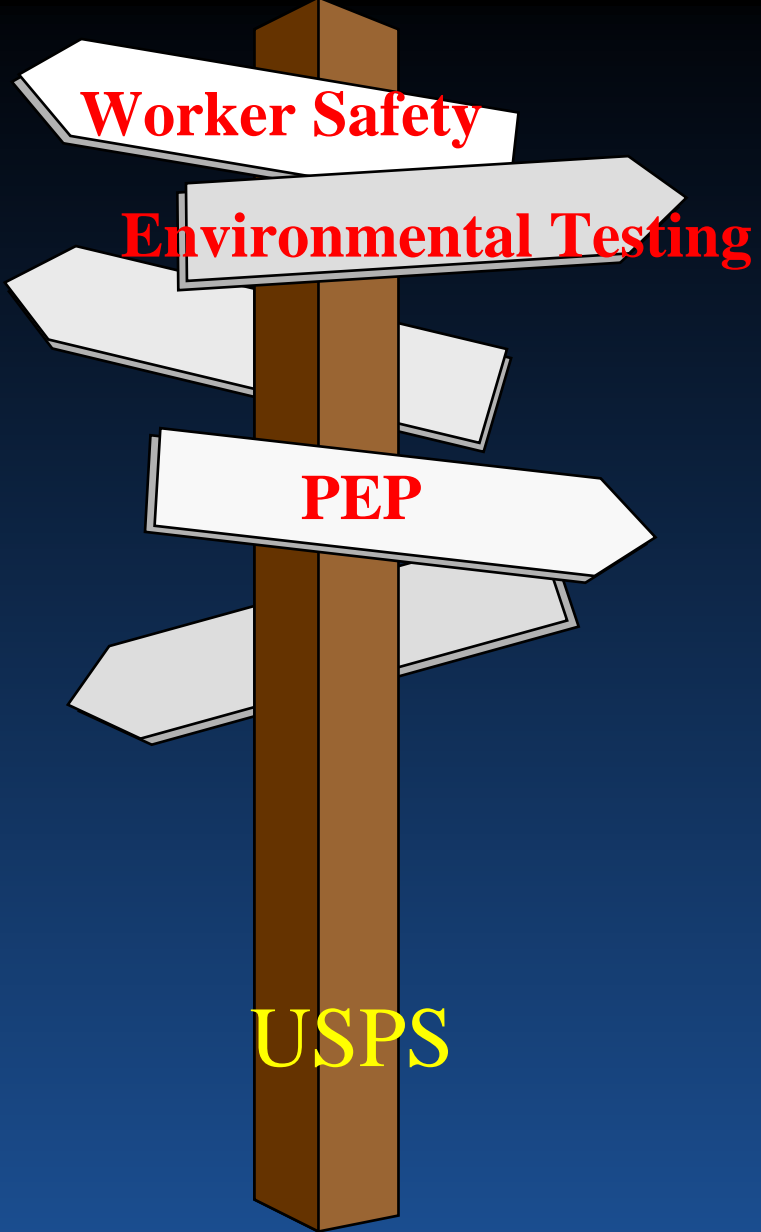



Worker Safety

Environmental Testing

PEP

USPS



U.S. Postal Service

- Delivers >200 billion pieces of mail/year to 134 million addresses
- Serves 7 million customers daily at 38,000 postal retail outlets
- Employs @800,000 career employees
- Delivers 2,300 pieces of mail/day/carrier to 500 addresses

U.S. Postal Service

- Handles 46% of world's card and letter mail volume
- Transports mail by airplane, truck, railroad, boat, and mule (Grand Canyon)

Mail Flow in Florida, New Jersey, New York, and Washington, D.C.

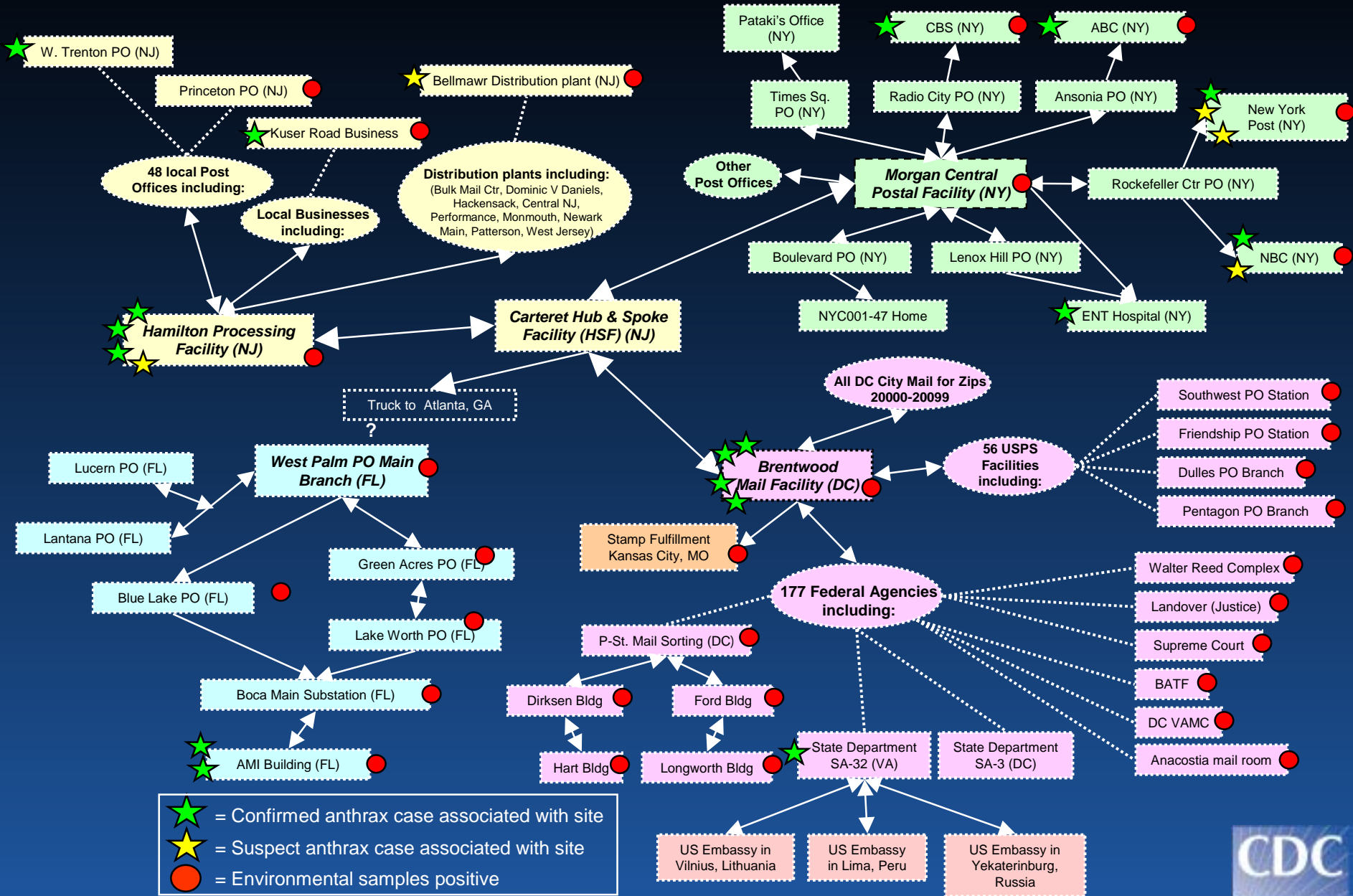

November 7, 2001



New Jersey Trenton Processing and Distribution Center in Hamilton

New Jersey Department of Health USPS Hamilton Facility Preliminary Results Environmental Sampling

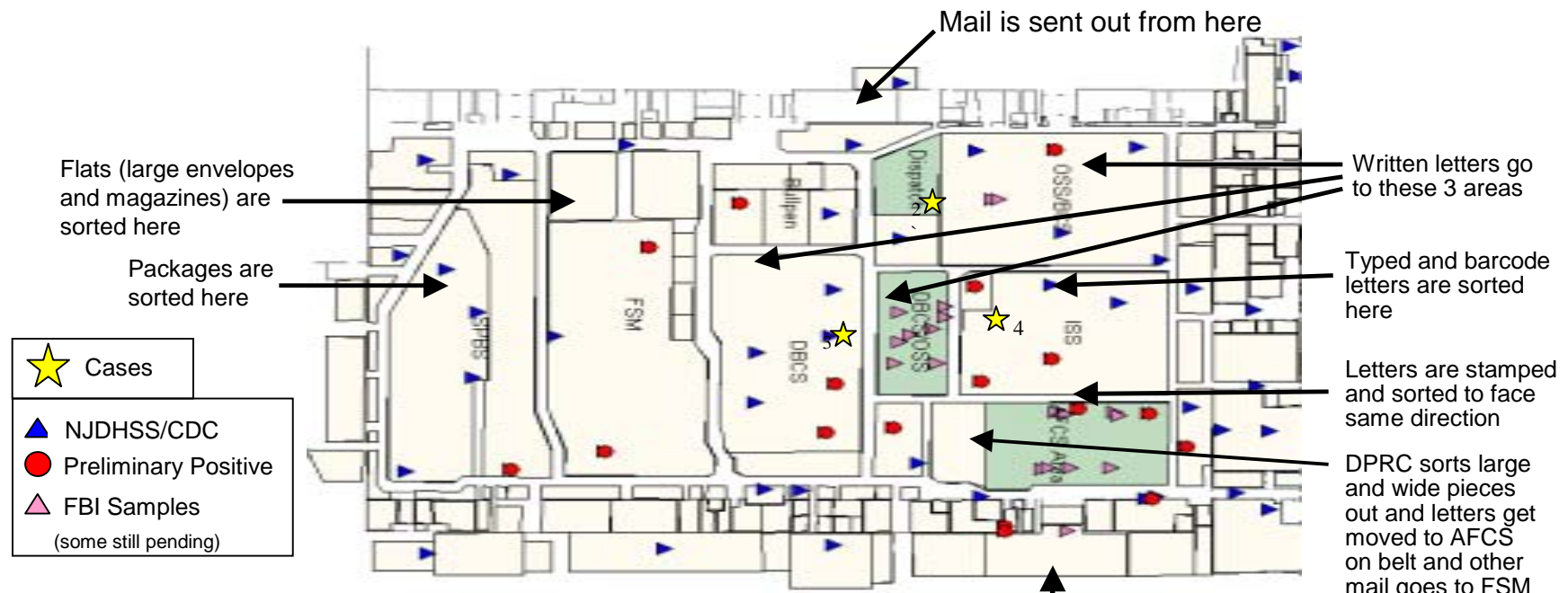

FBI tests in the AFCS area and the DBCS/OSS area were positive on various machines. Tests by NJHDSS and CDC (NIOSH) showed that in other areas of the plant there are also positive results.

Cutaneous cases were found working on the night of October 9th in the DBCS/OSS area (env+) and in the OSS/BCS area. The suspected inhalation case worked in the ISS area (environmental tests above the workstation were positive).



Barcodes

- Series of vertical bars printed on mail to facilitate automated processing
- Can reveal letter's origination and destination

Processing and Distribution Centers

- Large mail-sorting and dispatching plants
- Serve as hub for mail originating
 - post offices
 - collection boxes
 - customer mailboxes
 - large volume mailers



Environmental Sampling Preliminary Results State Annex 32

(Last updated 11/19/2001 12:00 pm)

Lab Results

- Negative
- Pending
- Positive
- No Data

Sample type

- HEPA-Vac
- Swipe

Area lines

★ Case

Interior areas

- Cubicle
- File unit
- Hand sorting
- Lobby
- Mail sorter
- Mens locker
- Meter area
- Packages
- Pigeon hole
- Toledo scale
- Wood chute
- Work station
- X-ray

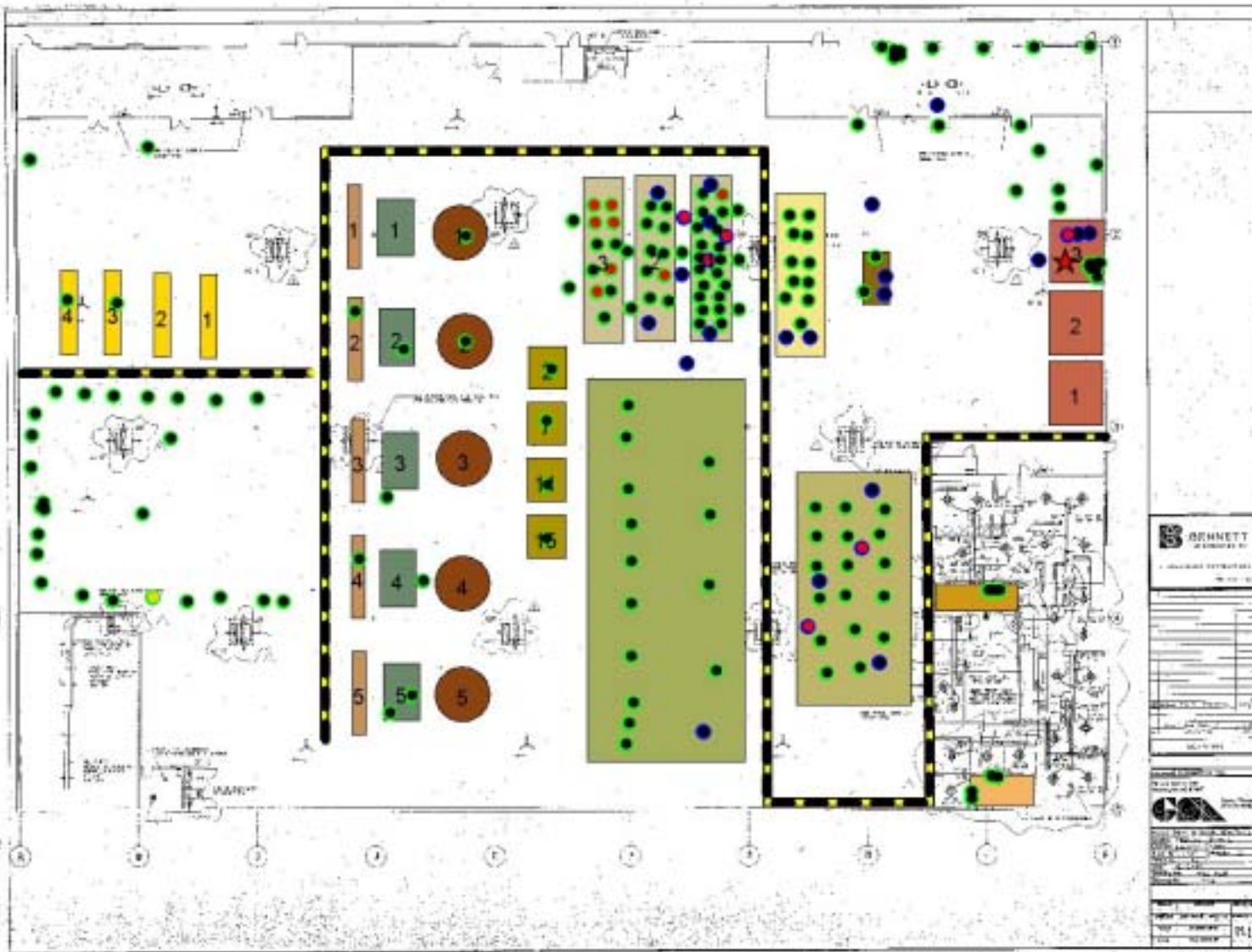

BARNETT									
LABORATORY SERVICES									
1111 11th St, NW									
Atlanta, GA 30309									
Phone: 404.528.1111									
Fax: 404.528.1112									
E-mail: barnett@cdc.gov									
www.cdc.gov/barnett									
<table border="1"> <tr> <td>DATE</td> <td>11/15/2001</td> </tr> <tr> <td>TIME</td> <td>12:00 pm</td> </tr> <tr> <td>BY</td> <td>Dabo Brantley</td> </tr> <tr> <td>FOR</td> <td>State Annex 32</td> </tr> </table>		DATE	11/15/2001	TIME	12:00 pm	BY	Dabo Brantley	FOR	State Annex 32
DATE	11/15/2001								
TIME	12:00 pm								
BY	Dabo Brantley								
FOR	State Annex 32								

Epidemiologic Investigations



Postal Facilities Tested for *Bacillus anthracis*

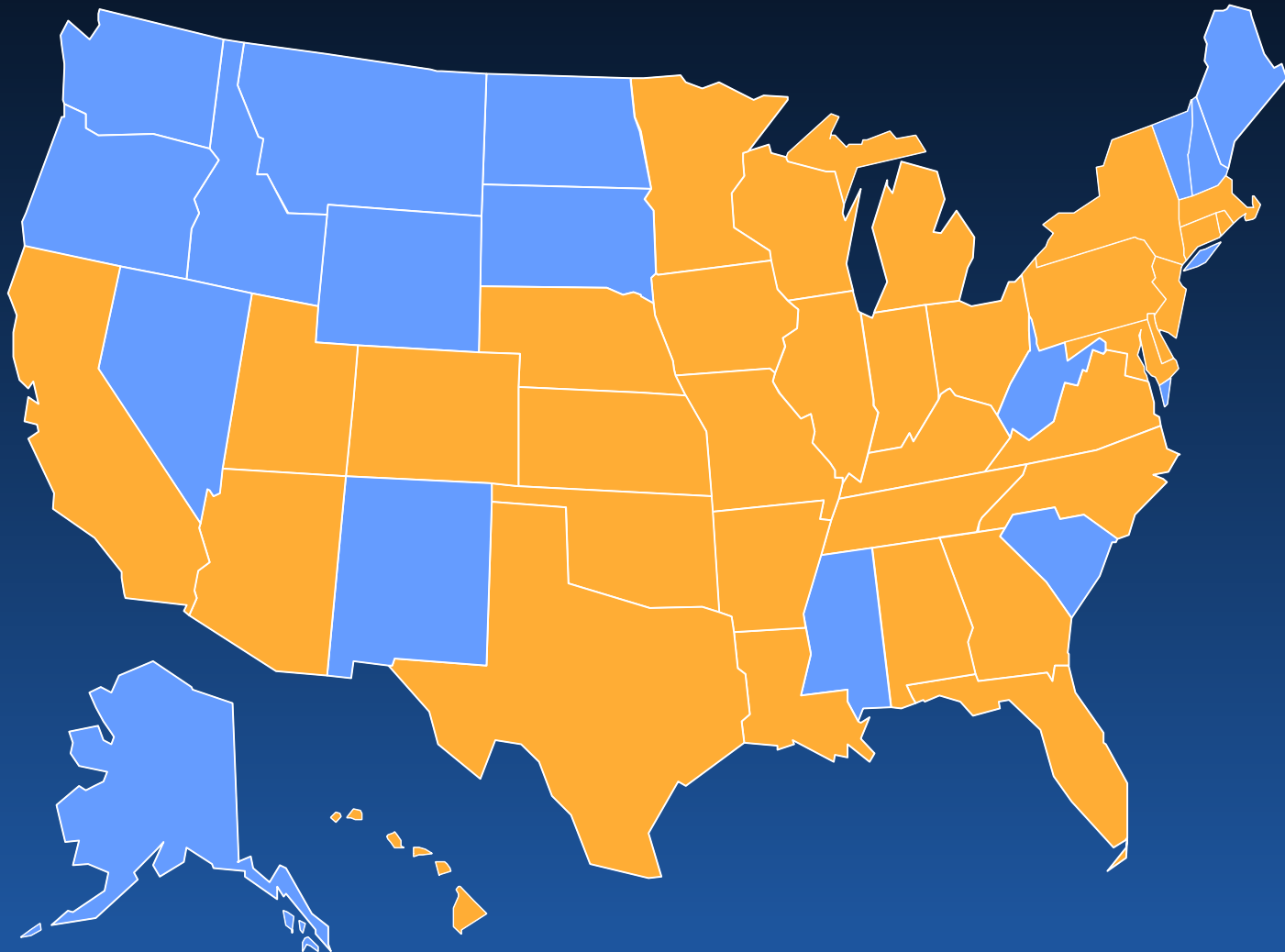

EOC International Team: Number of Responses by Date and Type of Request Oct. 12 – Nov. 2

Summary: 94 total requests from 61 countries

Number of Calls per Day

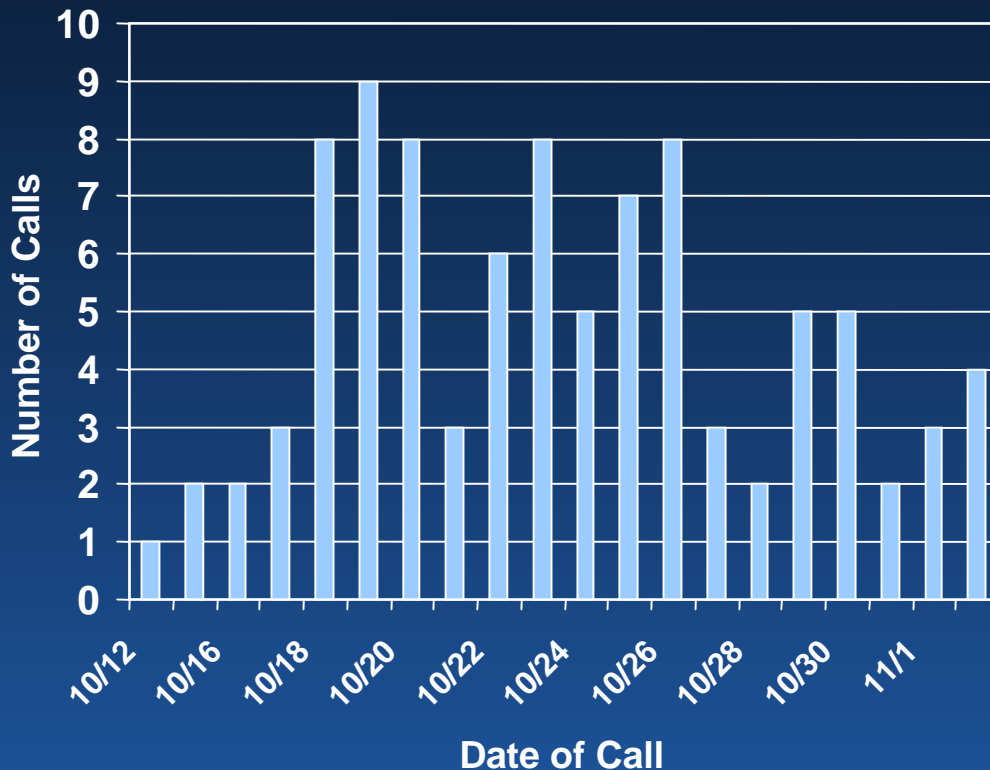

Type of Request	Total
Anthrax vaccine	1
Bioterrorism preparedness	6
Environmental/occupational request	11
Lab-related	31
Request for information	30
Threat	10
Training	4
Unknown	1
Total Requests	94

Postal Workers and Mailhandlers



Mail Industry

- Employs 9 million people
- Accounts for 8% gross domestic product
- Anthrax Hoax: 132 powder-laden packages sent clinics in at least three states product

Bioterrorism-associated Anthrax Cases

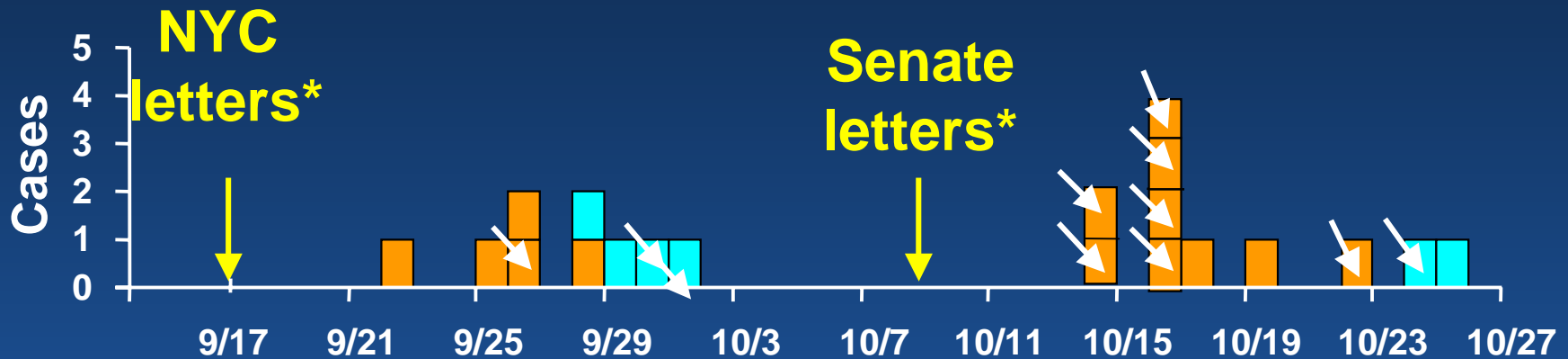
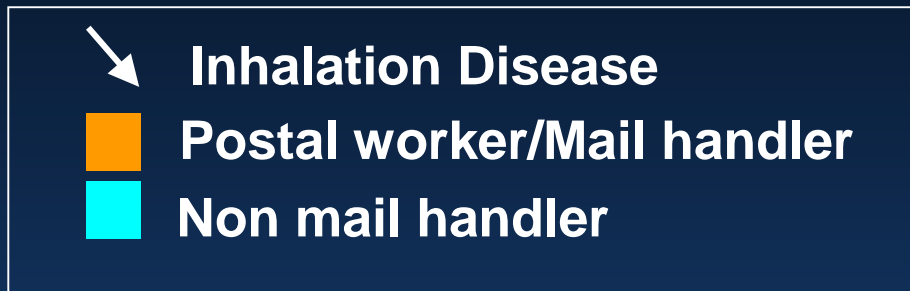

*Postmarked date of known contaminated letters.

Date of Onset

Epidemic Curve

NJ Cutaneous

NYC Cutaneous

FL Inhalational

DC Inhalational

NJ Inhalational

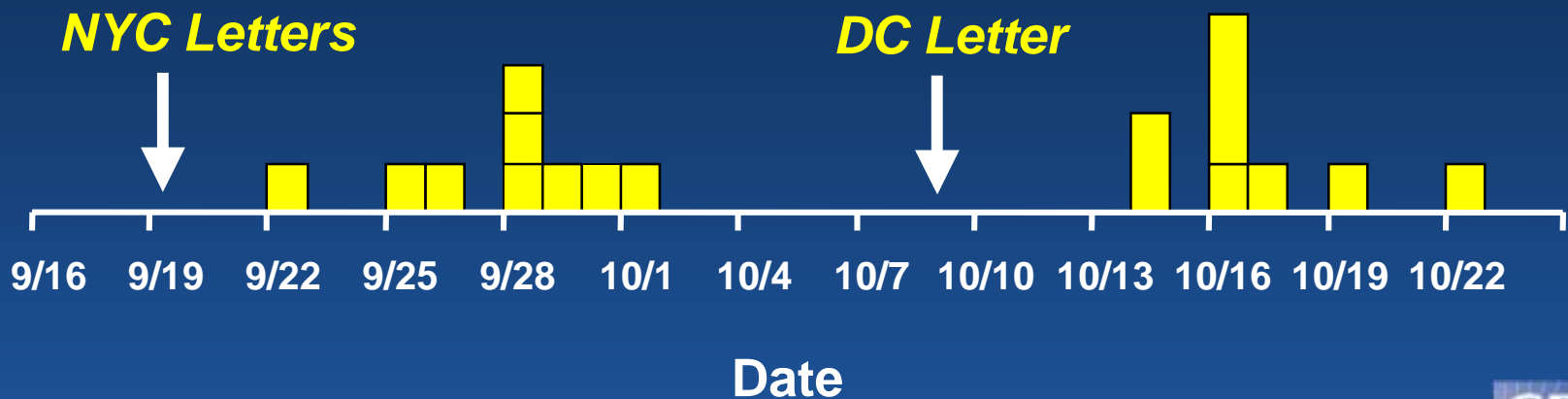

Anthrax Cases

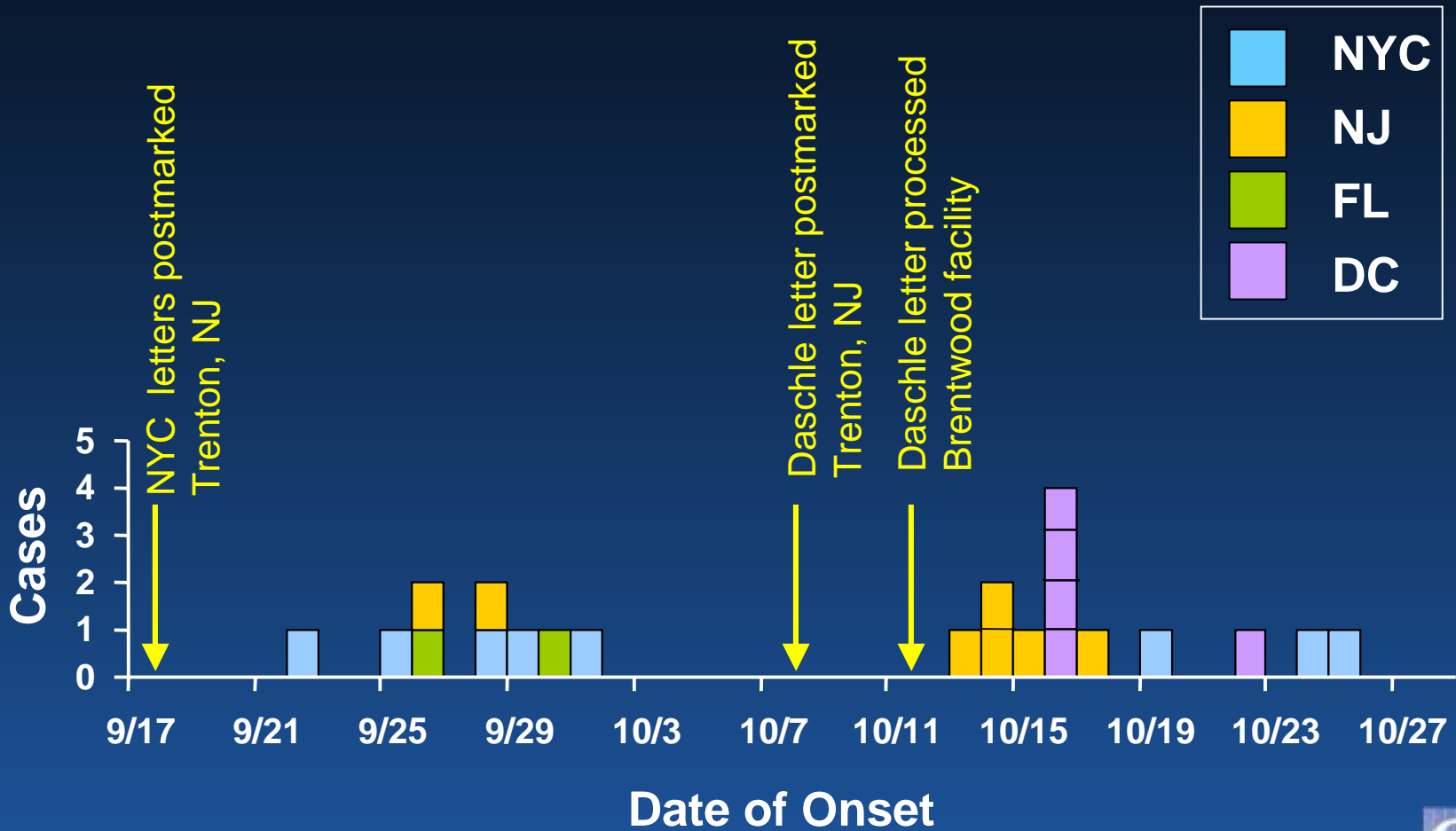

Anthrax and the Mail

IMPACT ON POSAL WORKERS AND MAIL HANDLERS

- Cases of inhalation or cutaneous anthrax
- Deaths among postal workers
- Postal facilities closed due to environmental contamination with *Bacillus anthracis*
- Numerous inquiries to CDC, health departments and US Postal Service (USPS) regarding mail and workplace safety

Anthrax and the Mail

PUBLIC HEALTH GUIDELINES

- OCTOBER 26: Investigation of Bioterrorism-Related Anthrax and Interim Guidelines for Exposure Management and Antimicrobial Therapy, October 2001
- OCTOBER 31: CDC Interim Recommendations for Protecting Workers from Exposure to *Bacillus anthracis* in Work Sites Where Mail is Handled or Processed
- NOVEMBER 4: Interim Guidelines for Investigation of and Response to *Bacillus anthracis* Exposures

EDUCATIONAL NEEDS OF POSTAL WORKERS

- Basics of anthrax
- Personal protective equipment and workplace safety
- Recognition/handling suspicious mail
- Postexposure management

Conclusions

- USPS used as vehicle for executing anthrax bioterror attack
- Intentional delivery of *B. anthracis* resulted in illness and death among mailhandlers and others, contamination and closure of postal facilities, curtailment in mail services, implementation of new security measures

Conclusions

- Partnerships with public and private sector partners is essential to adequately prepare and respond to bioterrorist attacks

**“This has been a year of challenge.
It has been a year of success.
It has been a year of change.”**

Chief Financial Officer, USPS

November 9, 2001