

*Safety is a Part of Your Contract*

NOTE: DRAWING REDUCED TO ONE HALF SCALE

THIS PLAN ACCOMPANIES MODIFICATION POOL TO CONTRACT NO. DACW29-70-C-0275

**GENERAL NOTES**

- All elevations are in feet and refer to Mean Sea Level except for Logs of Borings from M.R.-G.O. which are Mean Low Gulf.
- Miss. River - Gulf Outlet Boring Log 24-D thru 31-D located on dwg. 1. For log borings see dwg. 3.
- Soil borings (●) 18-C thru 21-C are 1 1/2" I.D. core barrel general type boring.
- Soil borings (◆) 15-CU, 15-CUA, 18-CU are 5" dia. undisturbed boring.
- For soil borings legend, see dwg. file No. H-2-21800.
- Drainage canal (El. 8.0) soundings were taken on 12-22-69 and 12-24-69.
- The contractor shall perform his operations in such a manner as not to interfere with the operations of the adjoining contract for levee work (levee Sta. 995+00 = M.R.-G.O. Sta. 1000+84) and along the effluent retaining dike separating the ponding area.
- See SP-17 for right-of-way access between Sta. 1040+00 and Sta. 1119+50

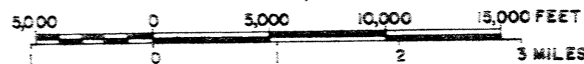

**LOCATION PLAN**  
SCALE: 1:50,000

TABULATION OF BENCH MARKS		
STATION	EL. M.S.L.	LOCATION AND DESCRIPTION
M.R.-G.O. Sta. 936+00 P.B.M. 930+00 (1970)	9.702	Mark is top of bronze disc set on 1-inch iron pipe driven 88.5 feet in ground set inside 1 1/4 inch P.V.C. plastic pipe driven 80.2 feet in ground on south bank M.R.-G.O.; 780 feet south of M.R.-G.O. Base Line. Disc is stamped 936+00.
P.B.M. 1039+00 (1970)	6.166	Mark is top of bronze disc set on 1-inch iron pipe driven 87.5 feet in ground set inside 1 1/4 inch P.V.C. plastic pipe driven 80.0 feet in ground, 400 feet right levee and station 1039+00. Approx 50 feet back of drainage canal. Disc is stamped P.B.M. 1039+00.

INDEX TO DRAWINGS	
DWG.	DESCRIPTION
1	LOCATION PLAN, VICINITY MAP AND INDEX
2	PLAN, PROFILE AND BORINGS
3	PLAN, PROFILE AND BORINGS
4	DESIGN SECTIONS
5	DESIGN SECTIONS
PLATE A - SOIL BORING LEGEND FILE NO. H-2-21800.	

10-5-70 Revised ponding dike Mod. #1		G.E.
DESIGNED: R.P.L.	DRAWN: U.S.	CHECKED: R.P.L.
U.S. ARMY ENGINEER DISTRICT, NEW ORLEANS CORPS OF ENGINEERS NEW ORLEANS, LA.		
LAKE PONTCHARTRAIN, LA. AND VICINITY CHALMETTE AREA PLAN, CHALMETTE EXTENSION HURRICANE PROTECTION LEVEE FIRST LIFT - STA. 995+00 - STA. 1119+50 ST. BERNARD PARISH, LA.		
APPROVED: [Signature]	CODE IDENT. NO.:	SIZE: FILE NO.
ACTING CHIEF, ENGINEERS DIVISION		<b>H-8-25204</b>
APPROVED: [Signature]	SCALE: SHOWN	SPEC. NO. DACW29-70-B-0223
COLONEL, U.S. ARMY ENGINEER DISTRICT ENGINEER		DWG. NO. 1 OF 5

MISSISSIPPI RIVER GULF OUTLET

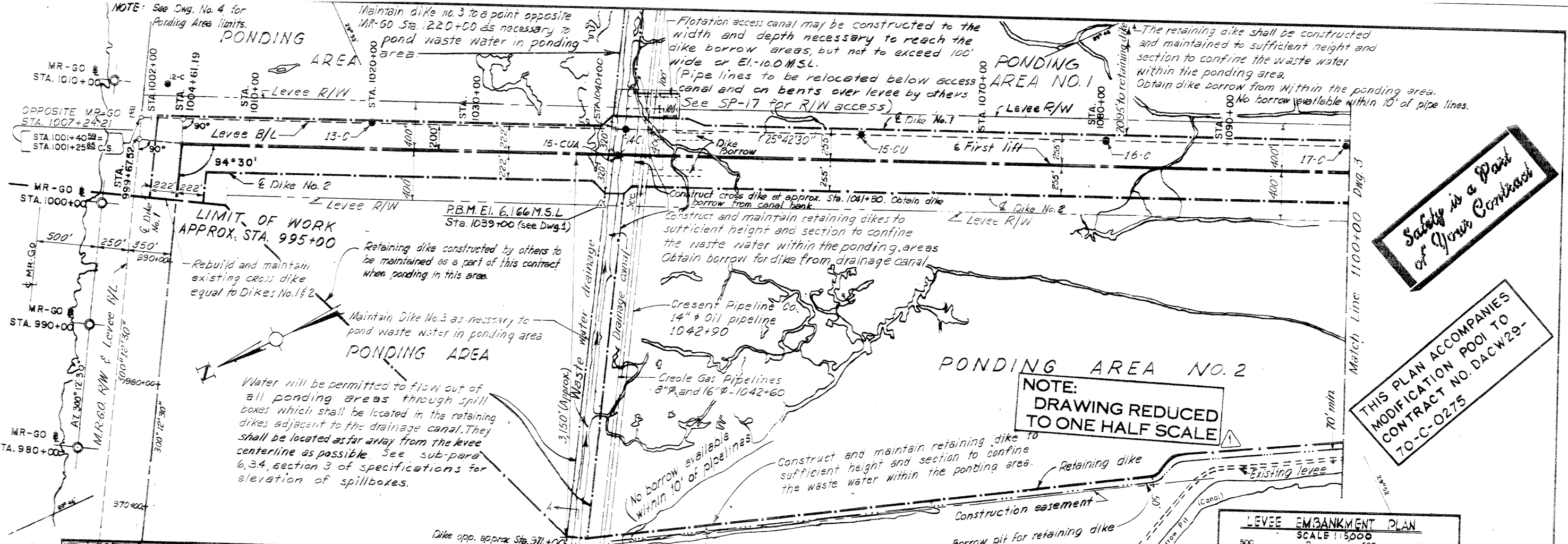

Safety is a Part of Your Contract

THIS PLAN ACCOMPANIES MODIFICATION POOL TO CONTRACT NO. DACW29-70-C-0275

Contractor shall close gap between Sta. 997+00 and Sta. 993+00. Divided construction is complete on other contract between Sta. 995+00 and Sta. 950+00.

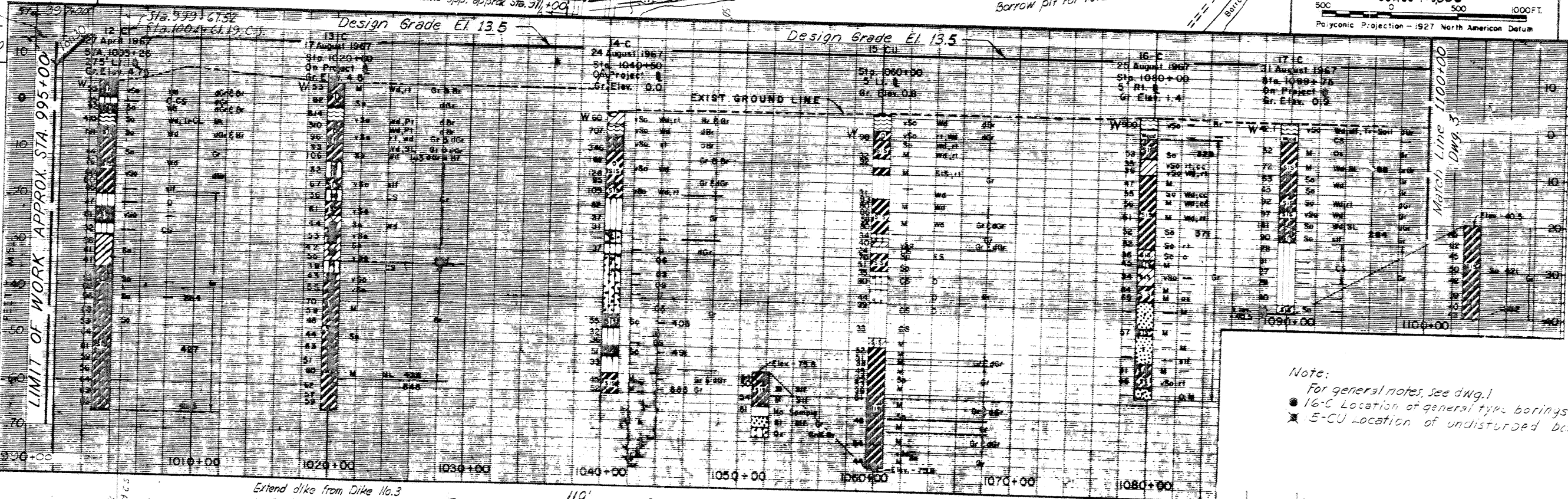

Note: For general notes, see dwg. 1. 16-C Location of general type borings. 5-CU Location of undisturbed borings.

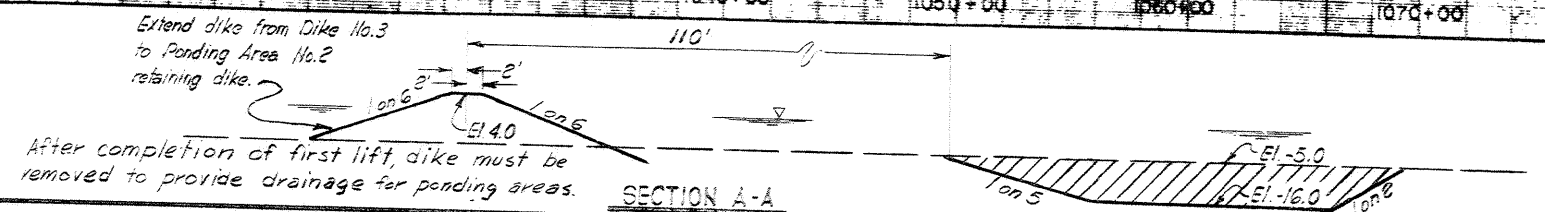

REVISION	DATE	DESCRIPTION	BY
1	10-5-70	Revised retaining dike & added borrow pit for dike Mod. G.B.	
DESIGNED BY	DRAWN BY	CHECKED BY	DATE
R.P.L.	J.S.	R.P.L.	MAY 1970
FILE NO.	SIZE	SPEC. NO.	DWG. NO.
H-8-25204	11x17	70-B-0223	2 of 5



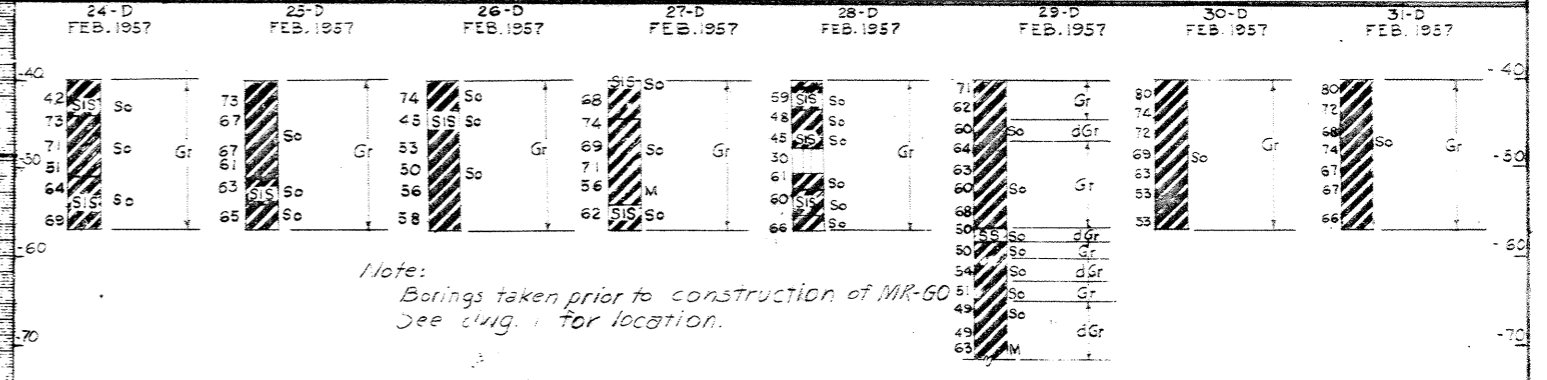
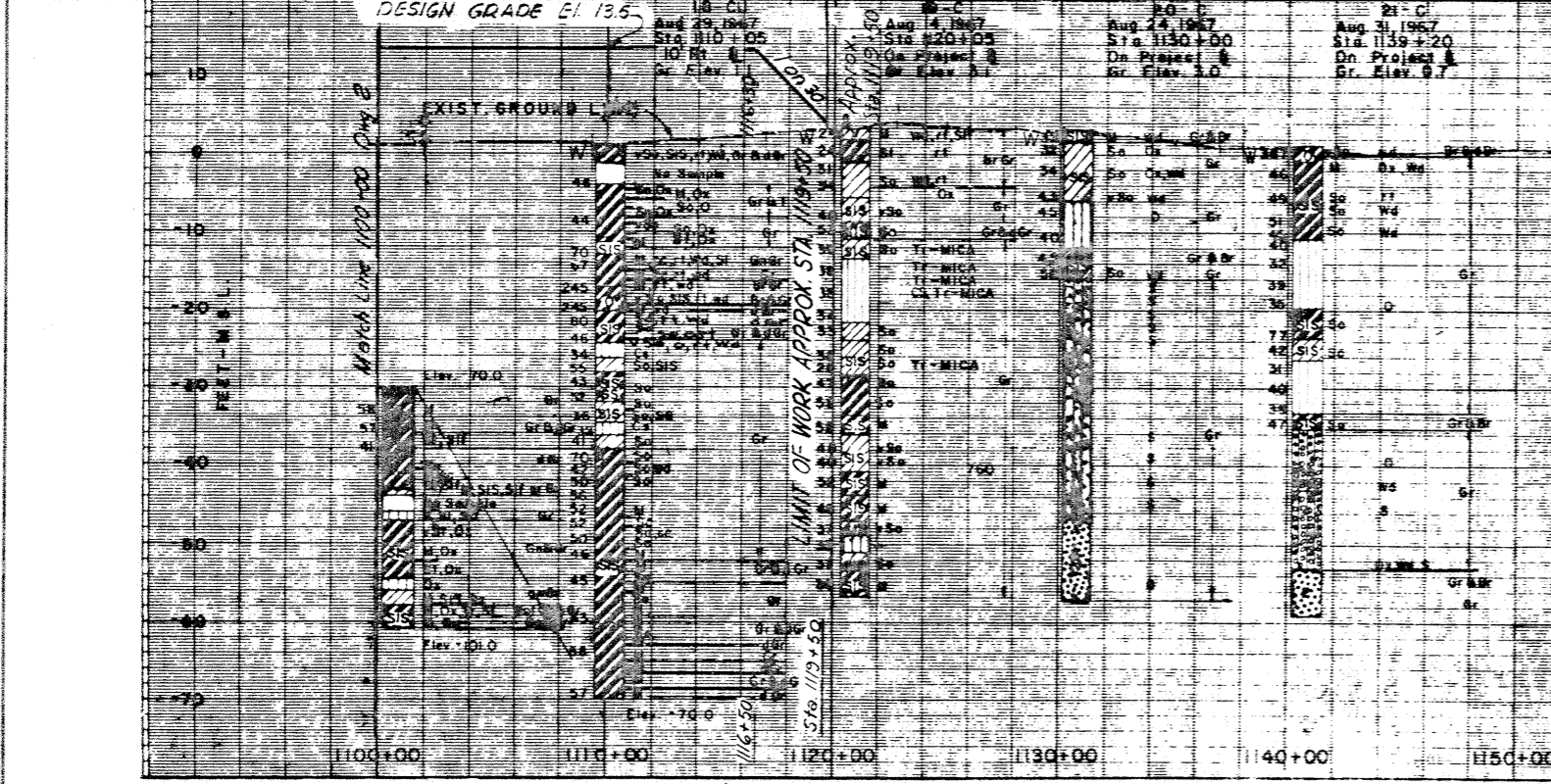
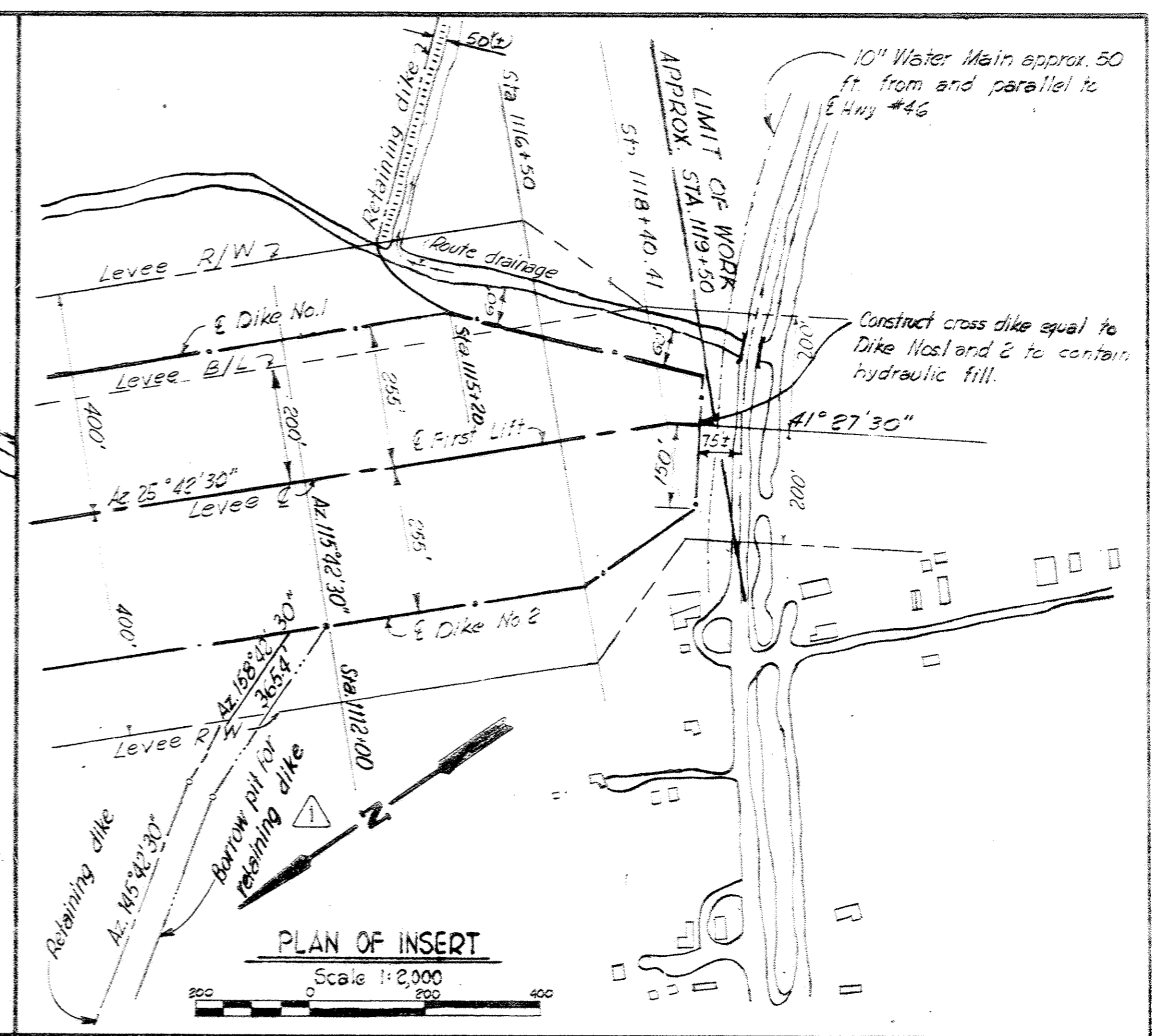
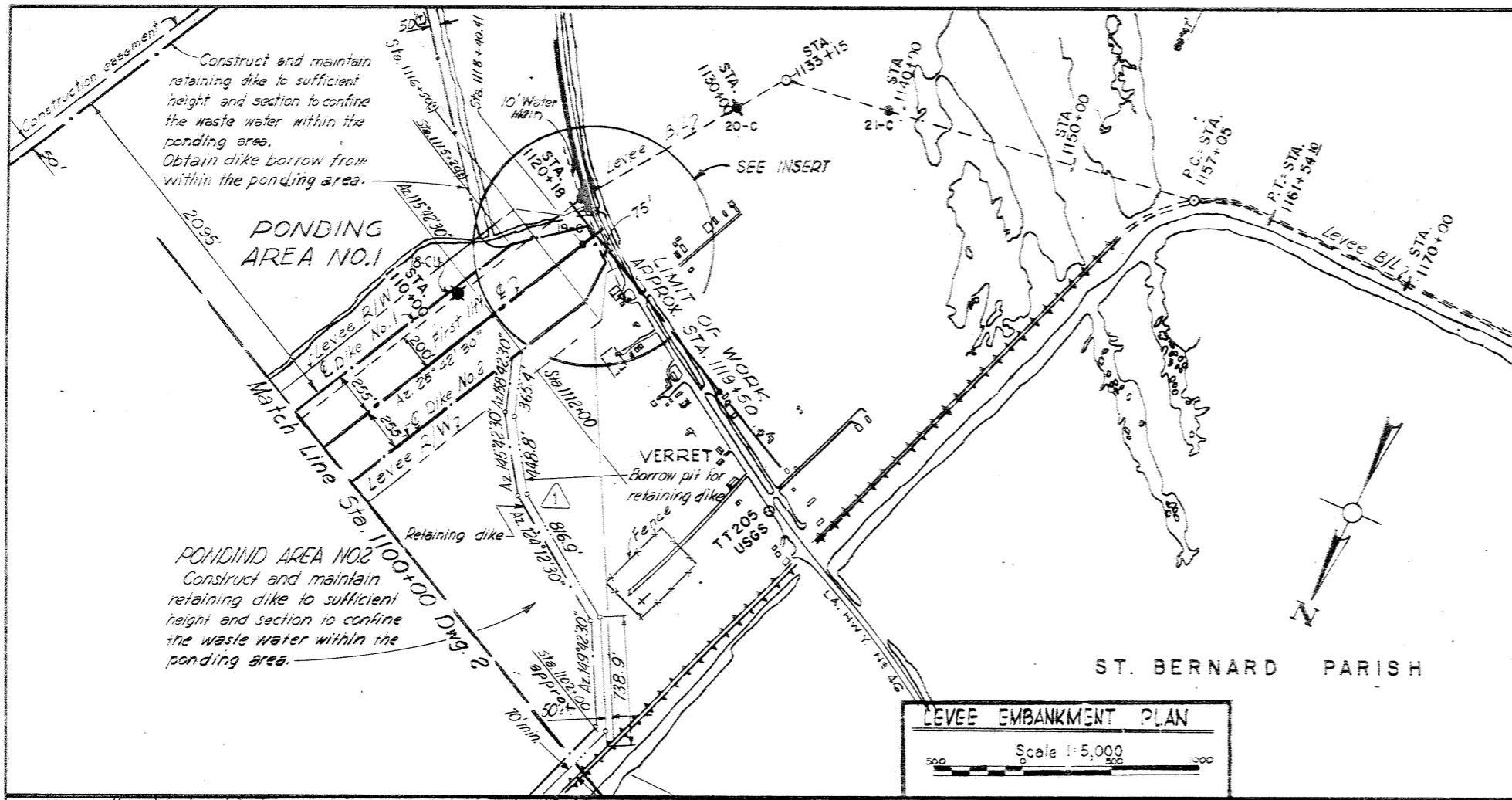

**NOTE: DRAWING REDUCED TO ONE HALF SCALE**

*Safety is a Part of Your Contract*

THIS PLAN ACCOMPANIES MODIFICATION POOL TO CONTRACT NO. DACW29-70-C-0275

Note: For general notes see dwg. 1

- 19-C Location of general type borings
- ✱ 18-CU Location of undisturbed borings

DESIGNED BY	R.P.L.	DRAWN BY	B.G.W.	CHECKED BY	R.P.L.	FILE NO.	H-8-25204
DATE	MAY 1970	SCALE	SHOWN	SPEC. NO.	DAQW29 70-B-0223	DWG. NO.	3 OF 5

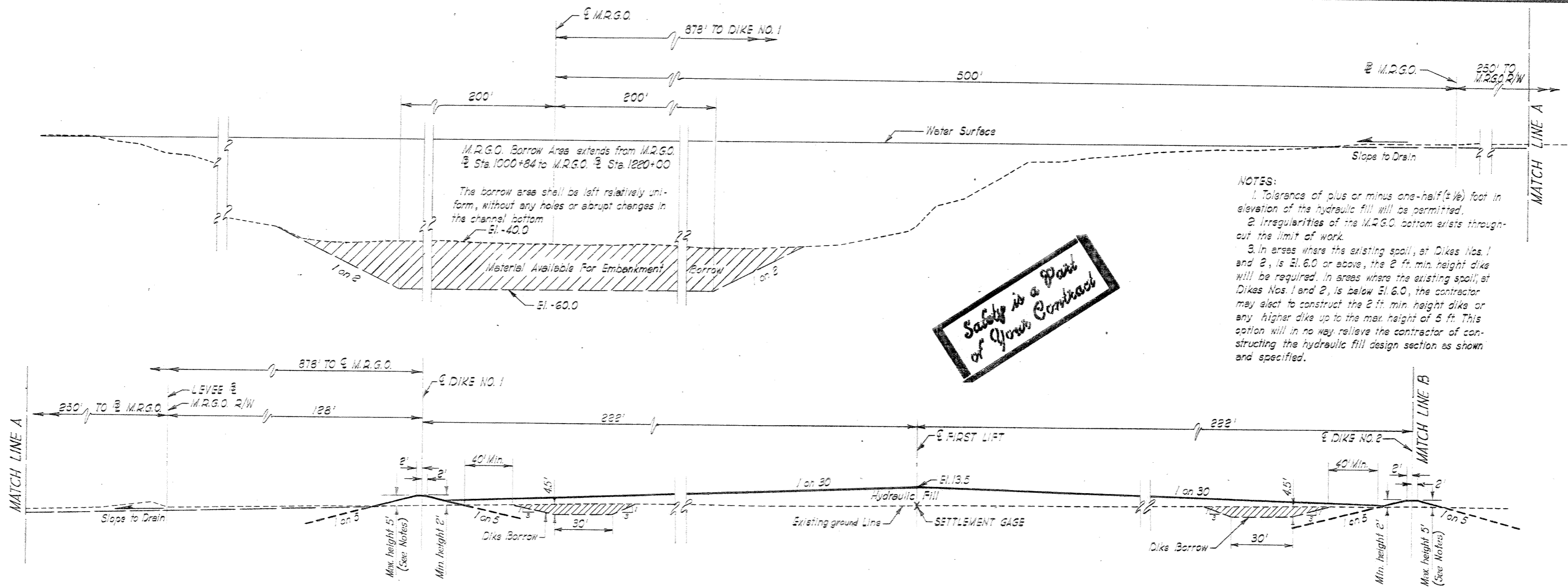

- NOTES:**
1. Tolerance of plus or minus one-half ( $\pm 1/2$ ) foot in elevation of the hydraulic fill will be permitted.
  2. Irregularities of the M.R.G.O. bottom exists throughout the limit of work.
  3. In areas where the existing spoil, at Dikes Nos. 1 and 2, is El. 6.0 or above, the 2 ft. min. height dike will be required. In areas where the existing spoil, at Dikes Nos. 1 and 2, is below El. 6.0, the contractor may elect to construct the 2 ft. min. height dike or any higher dike up to the max. height of 5 ft. This option will in no way relieve the contractor of constructing the hydraulic fill design section as shown and specified.

**Safety is a Part of Your Contract**

Settlement gages may be installed at locations indicated below and as shown on the Levee Design Section. (See para 12 of Sec. 3 of specs.) The Contractor may at his option install additional settlement gages. The length of the settlement measurement range for any additional settlement measurement gage shall not exceed 300 feet and shall extend for a maximum distance of 250 feet on each side of the settlement gage, measured along the centerline of the embankment, except where settlement gages are placed at less than 500 foot intervals, in which case, the settlement measurement range shall be a point  $1/2$  the distance between settlement gages.

**SETTLEMENT MEASUREMENT**  
Steel Plate, Square  
Minimum 4" x 4"  
 $1/8$ " (10 Gage)

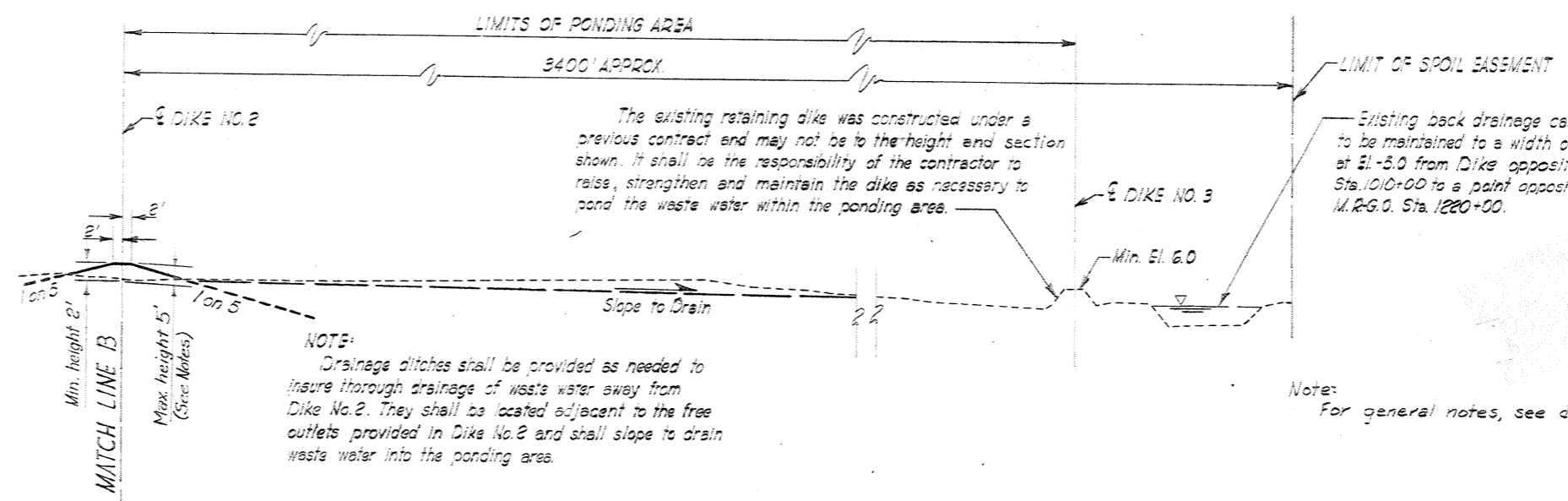

**NOTE: DRAWING REDUCED TO ONE HALF SCALE**

**FIRST LIFT LEVEE EMBANKMENT - DESIGN SECTION**  
FROM STA. 995+00 TO APPROX. STA. 997+00  
TRANSITION BETWEEN STA. 997+00 & STA. 1007+00

NOT TO SCALE

REVISION	DATE	CHECKED	DESCRIPTION	BY
DESIGNED:	DRAWN:	R.P.L.	CODE IDENT. NO. SIZE FILE NO.	
R.P.L.	B.G.W.	R.P.L.	H-8-25204	
DATE: MAY 1970		SCALE: SHOWN SPEC. NO. DACW29-70-B-0223 DWG. NO. 4 OF 5		

**Safety is a Part of Your Contract**

**NOTE: DRAWING REDUCED TO ONE HALF SCALE**

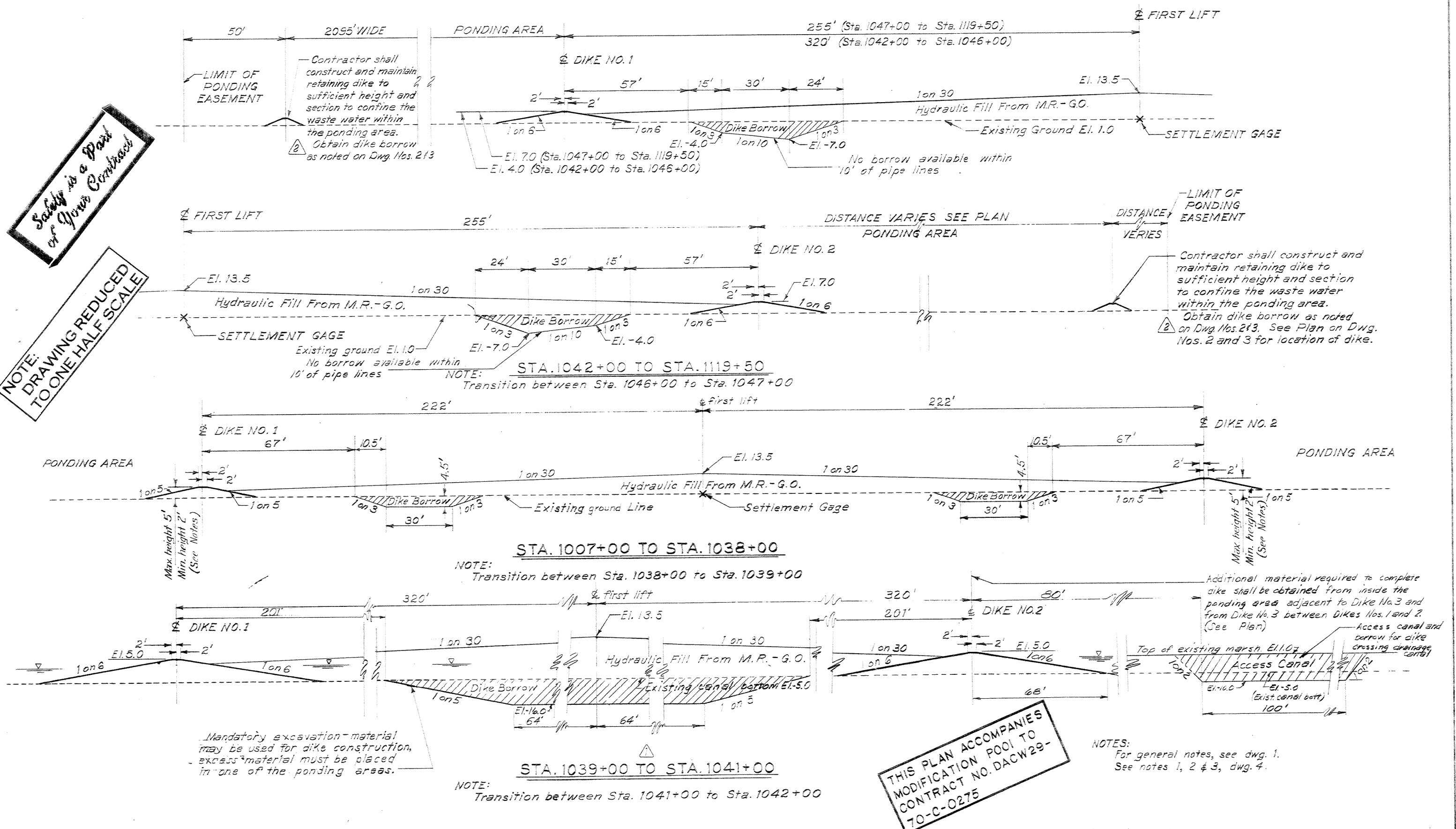

**FIRST LIFT LEVEE EMBANKMENT - DESIGN SECTIONS**

NOT TO SCALE

**THIS PLAN ACCOMPANIES MODIFICATION POOL TO CONTRACT NO. DACW29-70-C-0275**

NOTES:  
For general notes, see dwg. 1.  
See notes 1, 2 & 3, dwg. 4.

REVISION	DATE	CHECKED	CODE IDENT. NO.	SIZE	FILE NO.	BY
DESIGNED:	DRAWN:	CHECKED:	CODE IDENT. NO.	SIZE	FILE NO.	
R.P.L.	A.E.F. B.G.W.	R.P.L.			H-8-25204	
DATE: MAY 1970	SCALE: SHOWN	SPEC. NO. DACW29-70-C-0223	DWG. NO. 5	OF 5		