

SECTION A  
17/18

WEST BOUND ROADWAY - SHOWN  
EAST BOUND ROADWAY - OPP. HAND  
TYPICAL SECTION THRU EXPANSION JOINT

SCALE: 3/8" = 1'-0"

TABLE 1		
MEMBER	LOCATION	EL. "A"
ABUTMENT 1 & 2	WBB	EL. 4.40
	EBB	EL. 4.50
BENT A	WBB	EL. 5.25
	EBB	EL. 5.00
BENT B	WBB	EL. 5.35
	EBB	EL. 5.55
BENT C	WBB	EL. 5.40
	EBB	EL. 5.40
BENT D	WBB	EL. 5.00
	EBB	EL. 5.00

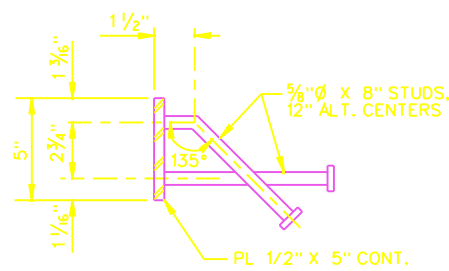

END DAM PLATE

SCALE: 3" = 1'-0"

STUDS SHALL BE 5/8"Ø X 8" ANCHOR WELDED STUDS (1 1/4"Ø MIN. HEAD). STUDS ARE TO BE OF THE AUTOMATIC END WELDED TYPE. ALL BENDS ARE TO BE MADE PRIOR TO WELDING.

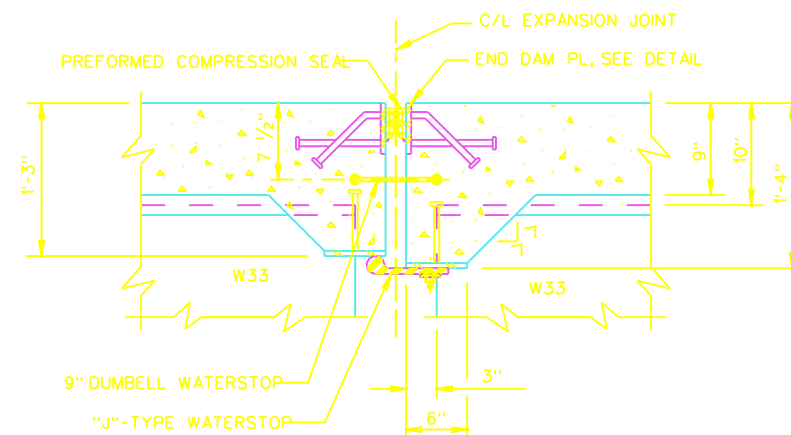

TYPICAL BRIDGE EXPANSION JOINT DETAIL

SCALE: 1 1/2" = 1'-0"

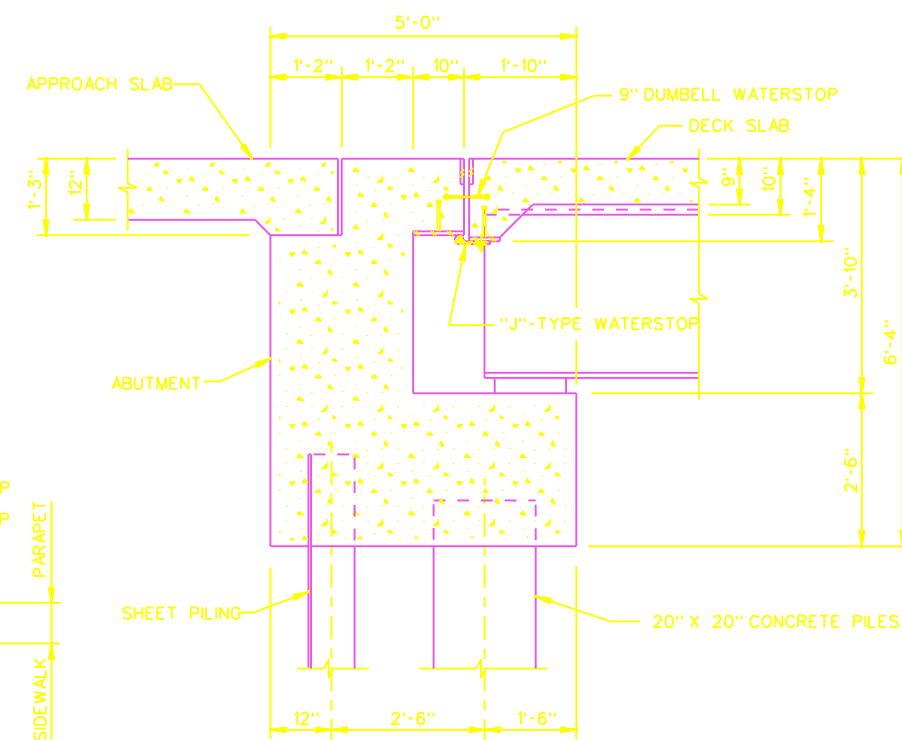

TYPICAL ABUTMENT SECTION

SCALE: 3/4" = 1'-0"

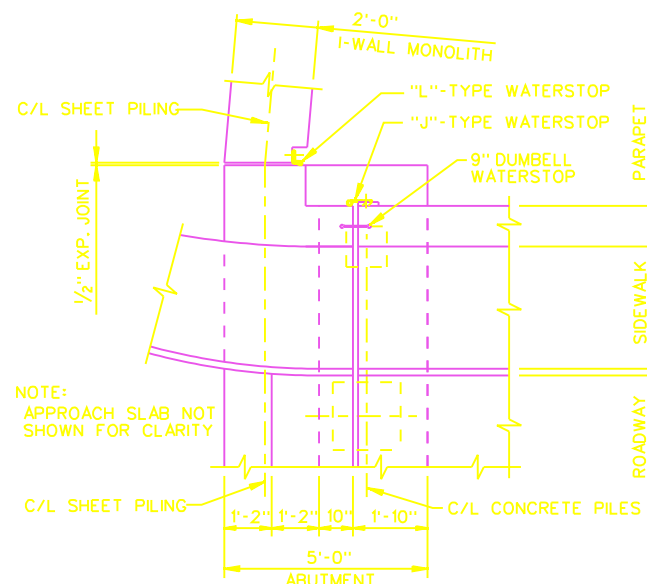

PLAN  
DETAIL

SCALE: 1/2" = 1'-0"

17/18

COMPUTER  
AIDED  
DESIGN  
DRAFTING

LAKE PONTCHARTRAIN, LA. AND VICINITY  
HIGH LEVEL PLAN  
DESIGN MEMORANDUM NO. 20 GENERAL DESIGN  
ORLEANS PARISH - JEFFERSON PARISH  
17TH. STREET OUTFALL CANAL  
( METAIRIE RELIEF )

SECTION AND DETAILS  
VETERANS MEMORIAL BLVD. BRIDGE

U. S. ARMY ENGINEER DISTRICT, NEW ORLEANS  
CORPS OF ENGINEERS  
DATE: MARCH 1990 FILE NO. H-2-30300