



# PUBLIC NOTICE

**US Army Corps  
of Engineers**®  
New England District

696 Virginia Road  
Concord, MA 01742-2751

**Date: February 26, 2008**  
**Comment Period Ends: March 26, 2008**  
**File Number: NAE-2005-3245**  
**In Reply Refer To: David Keddell**  
**Or by e-mail: david.m.keddell@usace.army.mil**

The District Engineer has received a permit application from the applicant below to **conduct work in waters of the United States** as described below. The Corps is soliciting comments on both the project itself and the range of issues to be addressed in the environmental documentation.

## APPLICANT

Mark Audette, Manager  
Ring's Island Marina  
16 First Street  
Salisbury, Massachusetts 01952

## ACTIVITY

Ring's Island Marina has applied for an authorization to extend their currently authorized floats lines as follows: Float line "A" shall extend 25 feet by 8 feet in width, float line "B" shall extend 100 feet X 8 feet in width, float line "C" shall extend an additional 100 feet X 8 feet in width, float line "D" shall extend another 100 feet X 6 feet in width and shall extend another 100 feet X 6 feet in width for a total of 425 linear feet of new float lines.

The work is described on the enclosed plans entitled "PLAN FOR ADDITION / RECONFIGURATION OF FLOAT SYSTEM," on 5 sheets, and dated "Feb. 1, 2008."

## WATERWAY AND LOCATION OF THE PROPOSED WORK

This work is proposed in the Merrimack River at 16 First Street, Salisbury, Massachusetts. The proposed location on the USGS Newburyport East quadrangle sheet is at UTM coordinates 4741810 N and 347239 E Zone 19 or Lat/Long 42 degrees 48 minutes 55.85 seconds N and 70 degrees 52 minutes 6.82 seconds.

## AUTHORITY

Permits are required pursuant to:

- Section 10 of the Rivers and Harbors Act of 1899  
 Section 404 of the Clean Water Act  
 Section 103 of the Marine Protection, Research and Sanctuaries Act).

The decision whether to issue a permit will be based on an evaluation of the probable impact of the proposed activity on the public interest. That decision will reflect the national concern for both protection and utilization of important resources. The benefit which may reasonably accrue from the proposal must be balanced against its reasonably foreseeable detriments. All factors which may be relevant to the proposal will be considered, including the cumulative effects thereof; among those are: conservation, economics, aesthetics, general environmental concerns, wetlands, cultural value, fish and wildlife values, flood hazards, flood plain value, land use, navigation, shoreline erosion and accretion, recreation, water supply and conservation, water quality, energy needs, safety, food production and, in general, the needs and welfare of the people.

The Corps of Engineers is soliciting comments from the public; Federal, state, and local agencies and officials; Indian Tribes; and other interested parties in order to consider and evaluate the impacts of this proposed activity. Any comments received will be considered by the Corps of Engineers to determine whether to issue, modify, condition or deny a permit for this proposal. To make this decision, comments are used to assess impacts on endangered species, historic properties, water quality, general environmental effects, and the other public interest factors listed above. Comments are used in the preparation of an Environmental Assessment and/or an Environmental Impact Statement pursuant to the National Environmental Policy Act. Comments are also used to determine the need for a public hearing and to determine the overall public interest of the proposed activity.

Where the activity involves the discharge of dredged or fill material into waters of the United States or the transportation of dredged material for the purpose of disposing it in ocean waters, the evaluation of the impact of the activity in the public interest will also include application of the guidelines promulgated by the Administrator, U.S Environmental Protection Agency, under authority of Section 404(b) of the Clean Water Act, and/or Section 103 of the Marine Protection Research and Sanctuaries Act of 1972 as amended.

## **ESSENTIAL FISH HABITAT**

The Magnuson-Stevens Fishery Conservation and Management Act, as amended by the Sustainable Fisheries Act of 1996 (Public Law 104-267), requires all federal agencies to consult with the National Marine Fisheries Service on all actions, or proposed actions, permitted, funded, or undertaken by the agency, that may adversely affect Essential Fish Habitat (EFH).

This project will have an adverse effect on .01 acres of Essential Fish Habitat (EFH) for Atlantic salmon (*Salmo salar*), Atlantic cod (*Gadus morhua*), haddock (*Melanogrammus aeglefinus*), pollock (*Pollachius virens*), whiting (*Merluccius bilinearis*), offshore hake (*Merluccius albidus*), red hake (*Urophycis chuss*), white hake (*Urophycis tenuis*), redfish (*Sebastes fasciatus*), witch flounder (*Glyptocephalus cynoglossus*), winter flounder (*Pleuronectes americanus*), yellowtail flounder (*Pleuronectes ferruginea*), windowpane flounder (*Scopthalmus aquosus*), American plaice (*Hippoglossoides platessoides*), ocean pout (*Macrozoarces americanus*), Atlantic halibut (*Hippoglossus hippoglossus*), Atlantic sea scallop (*Placopecten magellanicus*), Atlantic sea herring (*Clupea harengus*), monkfish (*Lophius americanus*), bluefish (*Pomatomus saltatrix*), long finned squid (*Loligo pealei*), short finned squid (*Illex illecebrosus*), Atlantic butterfish (*Peprilus triacanthus*), Atlantic mackerel (*Scomber scombrus*), summer flounder (*Paralichthys dentatus*), scup (*Stenotomus chrysops*), black sea bass (*Centropristus striata*), surf clam (*Spisula solidissima*), ocean quahog (*Artica islandica*), spiny dogfish (*Squalus acanthias*), tilefish (*Lopholatilus chamaeleonticeps*). This habitat consists of ledge bottom.

Loss of this habitat may adversely affect Atlantic salmon (*Salmo salar*), Atlantic cod (*Gadus morhua*), haddock (*Melanogrammus aeglefinus*), pollock (*Pollachius virens*), whiting (*Merluccius bilinearis*), offshore hake (*Merluccius albidus*), red hake (*Urophycis chuss*), white hake (*Urophycis tenuis*), redfish (*Sebastes fasciatus*), witch flounder (*Glyptocephalus cynoglossus*), winter flounder (*Pleuronectes americanus*), yellowtail flounder (*Pleuronectes ferruginea*), windowpane flounder (*Scopthalmus aquosus*), American plaice (*Hippoglossoides platessoides*), ocean pout (*Macrozoarces americanus*), Atlantic halibut (*Hippoglossus hippoglossus*), Atlantic sea scallop (*Placopecten magellanicus*), Atlantic sea herring (*Clupea harengus*), monkfish (*Lophius americanus*), bluefish (*Pomatomus saltatrix*), long finned squid (*Loligo pealei*), short finned squid (*Illex illecebrosus*), Atlantic butterflyfish (*Peprilus triacanthus*), Atlantic mackerel (*Scomber scombrus*), summer flounder (*Paralichthys dentatus*), scup (*Stenotomus chrysops*), black sea bass (*Centropristus striata*), surf clam (*Spisula solidissima*), ocean quahog (*Artica islandica*), spiny dogfish (*Squalus acanthias*), tilefish (*Lopholatilus chamaeleonticeps*).

However, the District Engineer has made a preliminary determination that the site-specific adverse effect will not be substantial. Further consultation with the National Marine Fisheries Service regarding EFH conservation recommendations is being conducted and will be concluded prior to the final decision.

#### SECTION 106 COORDINATION

Based on his initial review, the District Engineer has determined that little likelihood exists for the proposed work to impinge upon properties with cultural or Native American significance, or listed in, or eligible for listing in, the National Register of Historic Places. Therefore, no further consideration of the requirements of Section 106 of the National Historic Preservation Act of 1966, as amended, is necessary. This determination is based upon one or more of the following:

- a. The permit area has been extensively modified by previous work.
- b. The permit area has been recently created.
- c. The proposed activity is of limited nature and scope.
- d. Review of the latest published version of the National Register shows that no presence of registered properties listed as being eligible for inclusion therein are in the permit area or general vicinity.
- e. Coordination with the State Historic Preservation Officer and/or Tribal Historic Preservation Officer(s)

The States of Connecticut, Maine, Massachusetts, New Hampshire and Rhode Island have approved **Coastal Zone Management Programs**. Where applicable the applicant states that any proposed activity will comply with and will be conducted in a manner that is consistent with the approved Coastal Zone Management Program. By this Public Notice, we are requesting the State concurrence or objection to the applicant's consistency statement.

The following authorizations have been applied for, or have been, or will be obtained:

- ( X ) Permit, License or Assent from State.
- ( X ) Permit from Local Wetland Agency or Conservation Commission.
- ( ) Water Quality Certification in accordance with Section 401 of the Clean Water Act.

**CENAE-R**  
**FILE NO. NAE-2005-3245**

In order to properly evaluate the proposal, we are seeking public comment. Anyone wishing to comment is encouraged to do so. **Comments should be submitted in writing by the above date.** If you have any questions, please contact David Keddell at (978) 318-8692, (800) 343-4789 or (800) 362-4367, if calling from within Massachusetts.

Any person may request, in writing, within the comment period specified in this notice, that a public hearing be held to consider the application. Requests for a public hearing shall specifically state the reasons for holding a public hearing. The Corps holds public hearings for the purpose of obtaining public comments when that is the best means for understanding a wide variety of concerns from a diverse segment of the public.

The initial determinations made herein will be reviewed in light of facts submitted in response to this notice. All comments will be considered a matter of public record. Copies of letters of objection will be forwarded to the applicant who will normally be requested to contact objectors directly in an effort to reach an understanding.

For more information on the New England District Corps of Engineers programs, visit our website at <http://www.nae.usace.army.mil>.

**THIS NOTICE IS NOT AN AUTHORIZATION TO DO ANY WORK.**

*for Ted Lento*  
**Karen K Adams**  
**Chief, Permits and Enforcement Branch**  
**Regulatory Division**

If you would prefer not to continue receiving Public Notices, please contact Ms. Tina Chaisson at (978) 318-8058 or e-mail her at [bettina.m.chaisson@usace.army.mil](mailto:bettina.m.chaisson@usace.army.mil). You may also check here ( ) and return this portion of the Public Notice to: Bettina Chaisson, Regulatory Division, U.S. Army Corps of Engineers, 696 Virginia Road, Concord, MA 01742-2751.

NAME: \_\_\_\_\_  
ADDRESS: \_\_\_\_\_

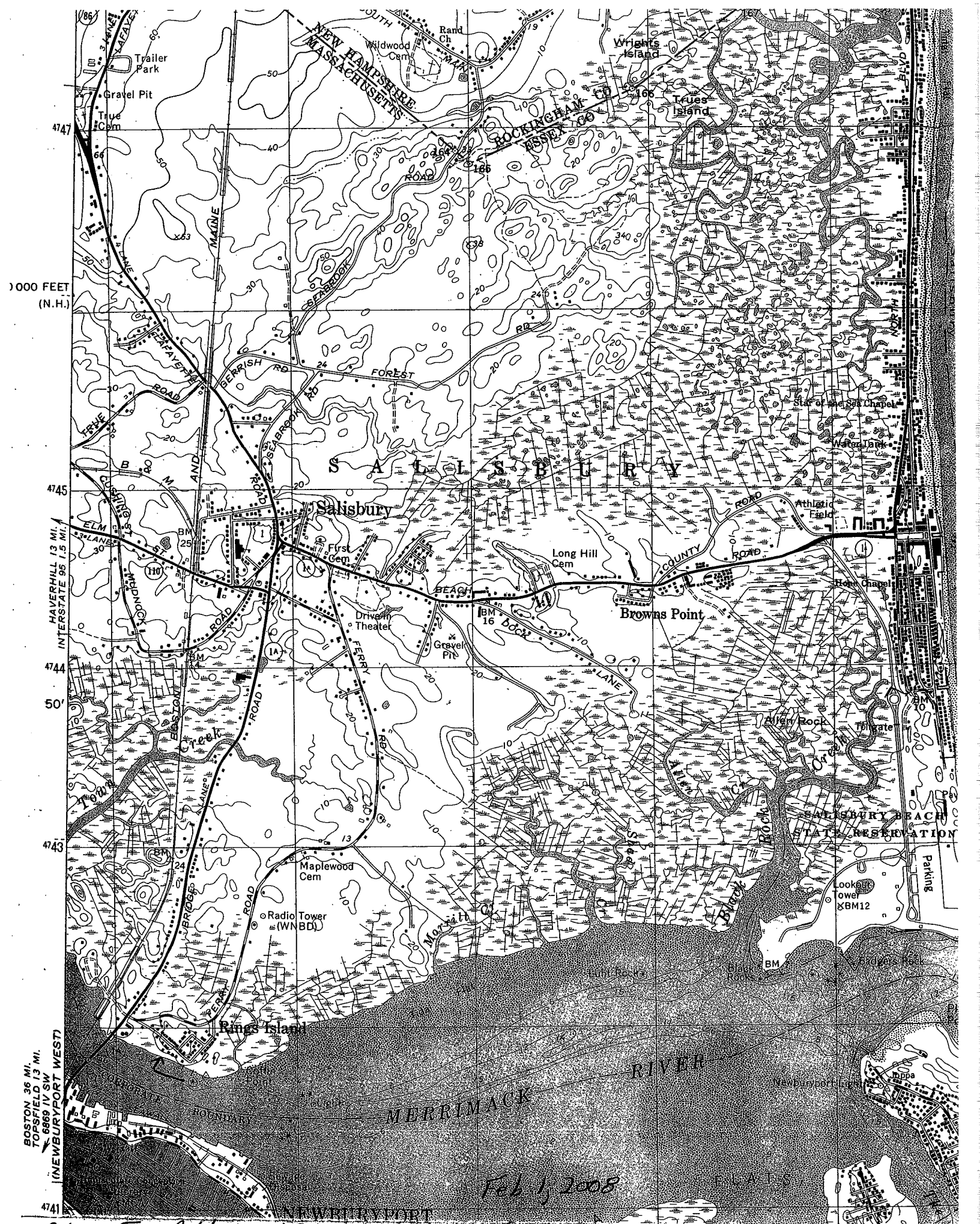

Plan For Addition / Reconfiguration of Plot System Sheet 1 of 4

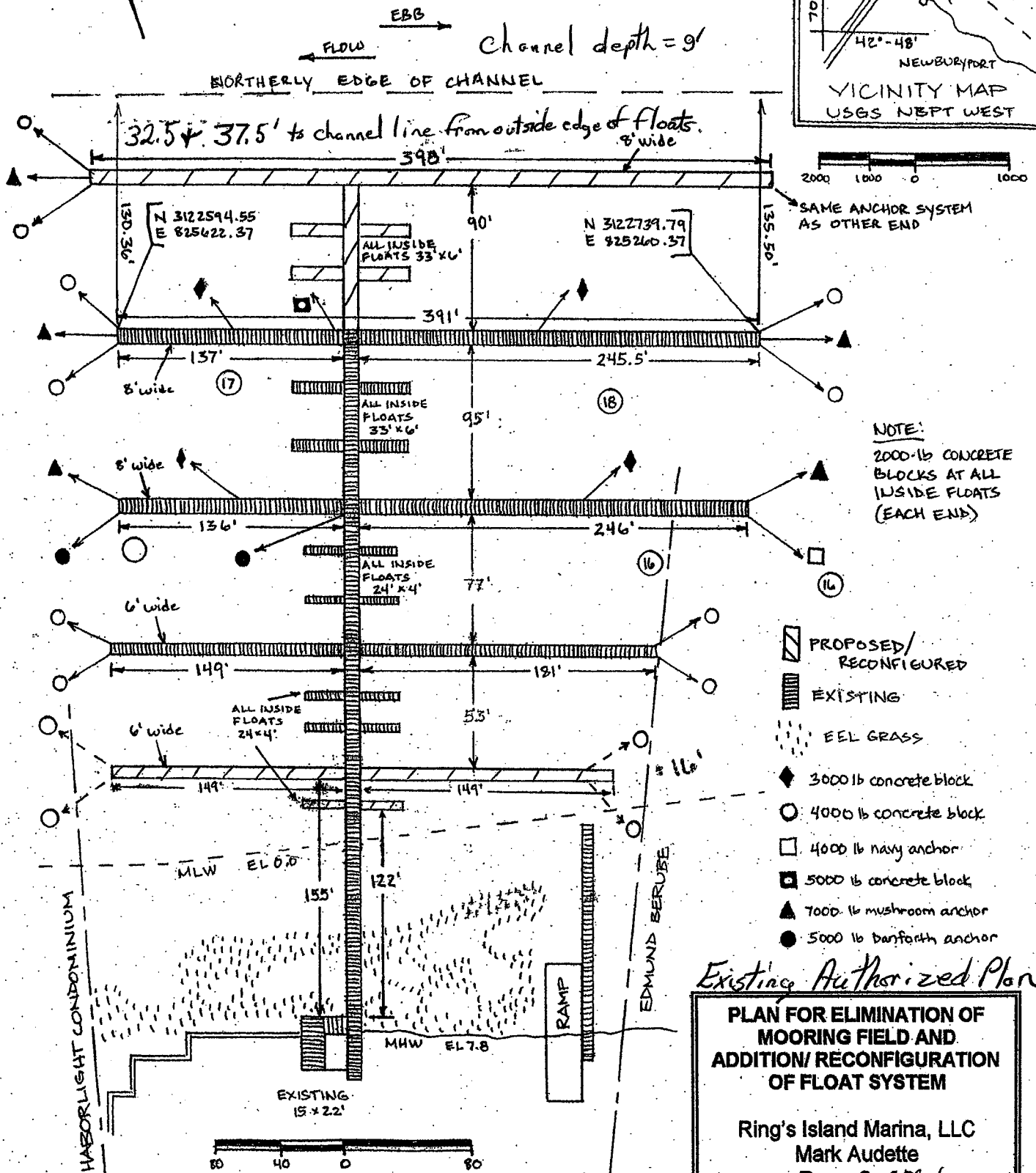
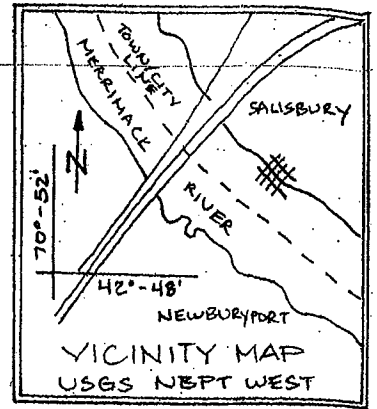

PLAN VIEW

10/24/05

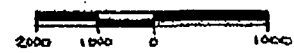
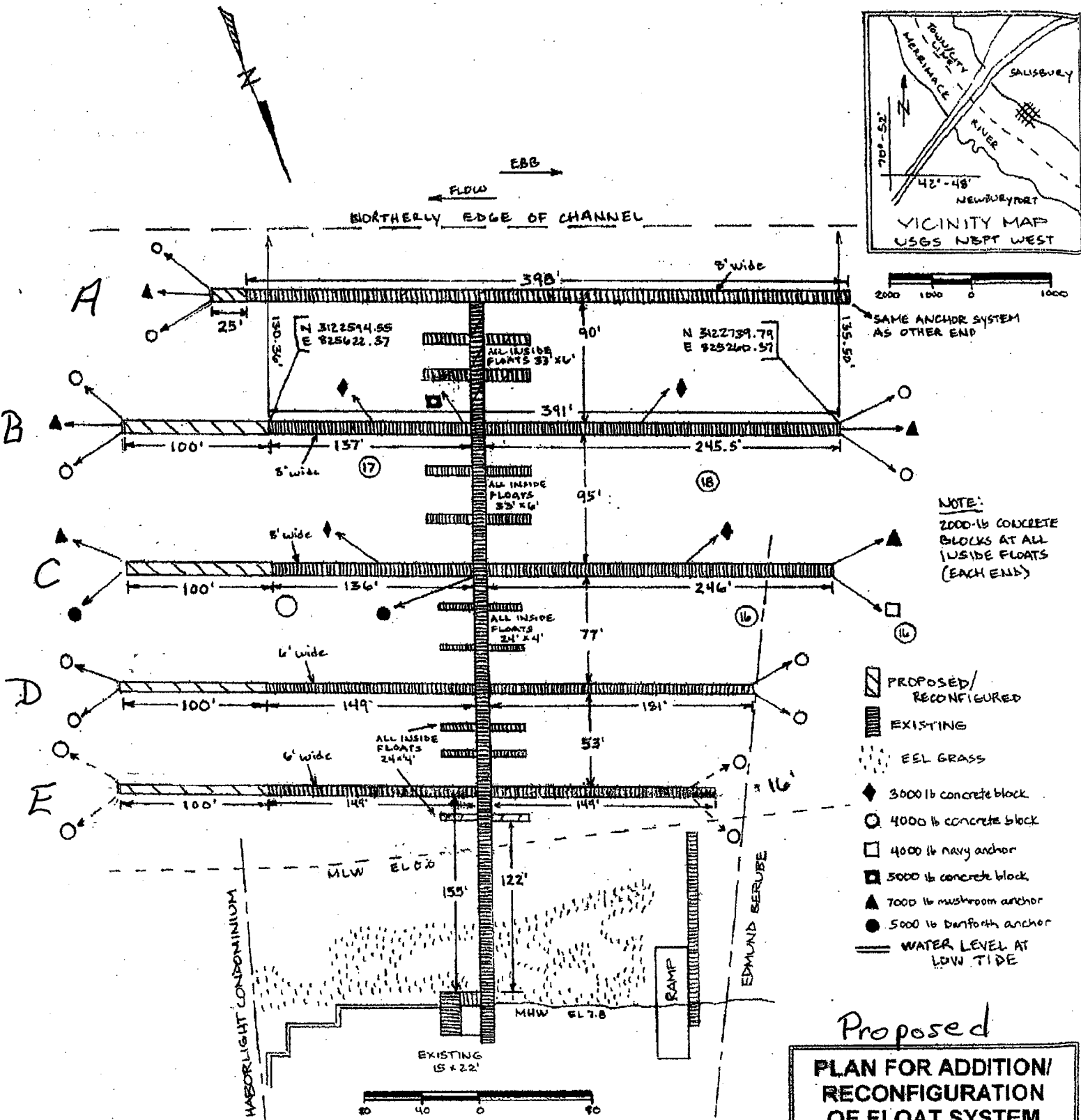
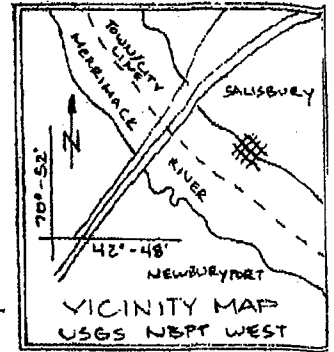

**NOTE:**  
2000-lb CONCRETE BLOCKS AT ALL INSIDE FLOATS (EACH END)

- PROPOSED/ RECONFIGURED
- EXISTING
- EEL GRASS
- 3000 lb concrete block
- 4000 lb concrete block
- 4000 lb navy anchor
- 5000 lb concrete block
- 7000 lb mushroom anchor
- 5000 lb Danforth anchor
- WATER LEVEL AT LOW TIDE

**Proposed**  
**PLAN FOR ADDITION/ RECONFIGURATION OF FLOAT SYSTEM**  
Ring's Island Marina, LLC  
Mark Audette, Manager

Feb. 1, 2008  
Sheet 3 of 5

# SKETCH PLAN

SHOWING  
EXISTING FLOAT SYSTEM  
AND  
WITH PROPOSED FLOATS  
AND  
FEDERAL CHANNEL

- NOTE:
- 1.) THE COORDINATE VALUES SHOWN FOR THE EXISTING DOCK ARE BASED ON GPS OBSERVATIONS TO ESTABLISH STATE PLANE COORDINATES. (SEPT. 2005)
  - 2.) SEE PLAN ENTITLED "PLAN FOR ADDITION/RECONFIGURATION OF FLOAT SYSTEM" RING'S ISLAND MARINA, LLC MARK AUDETTE, MANAGER, FOR ANCHORING SYSTEM.
  3. LOCATION FOR THIS SECTION OF FLOATS WAS NOT FIELD LOCATED.

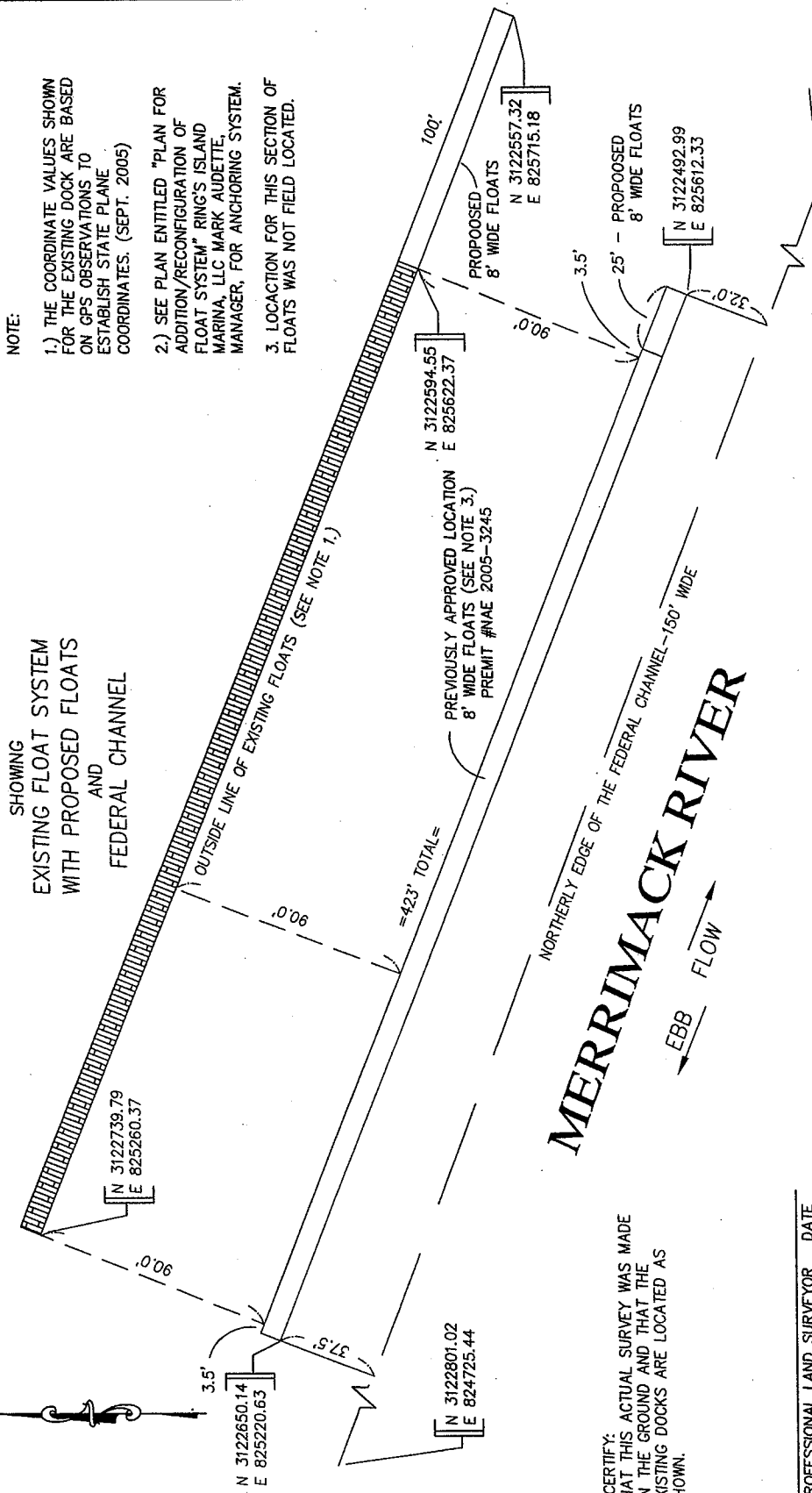

I CERTIFY:  
THAT THIS ACTUAL SURVEY WAS MADE  
ON THE GROUND AND THAT THE  
EXISTING DOCKS ARE LOCATED AS  
SHOWN.

GRAPHIC SCALE



SCALE: 1"=40'  
DATE: FEB. 1, 2008  
PROJECT: M051892

**MILLENNIUM ENGINEERING, INC.**  
ENGINEERS AND LAND SURVEYORS  
62 ELM ST. SALISBURY, MA 01952

PROFESSIONAL LAND SURVEYOR DATE

*Plan for additional  
reconfiguration  
of float system  
Sheet 4 of 5*



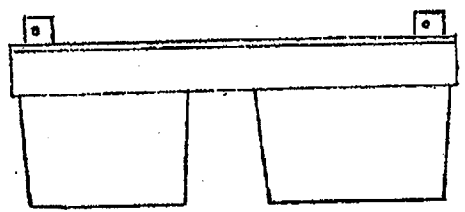
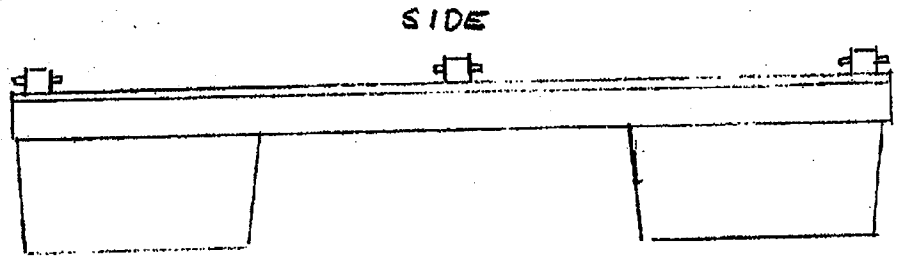
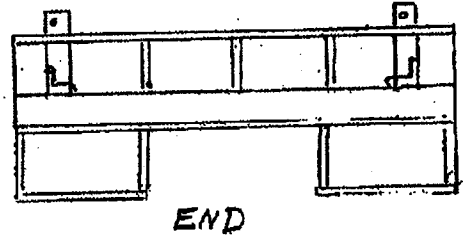
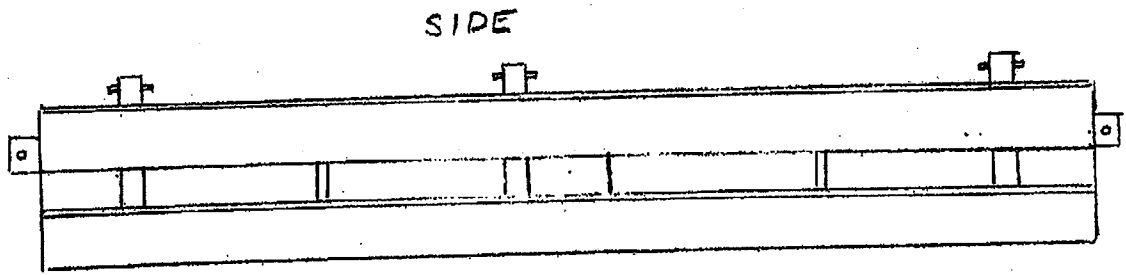

END

Plan For Addition /  
Reconfiguration  
of Float System  
Feb. 1, 2008  
Sheet 5 of 5