



US Army Corps
of Engineers®
New England District

PUBLIC NOTICE

696 Virginia Road
Concord, MA 01742-2751

Date: December 11, 2007
Comment Period Ends: January 11, 2008
File Number: NAE-2005-01068
In Reply Refer To: Brian E. Valiton
Or by e-mail: brian.e.valiton@usace.army.mil

The District Engineer has received a permit application from the applicant below to **conduct work in waters of the United States** as described below. The Corps is soliciting comments on both the project itself and the range of issues to be addressed in the environmental documentation.

APPLICANT: Massachusetts Port Authority (MASSPORT) Runway 5/23 Safety Area Improvements Laurence G. Hanscom Field, Bedford, Massachusetts.

ACTIVITY: MASSPORT has applied to place fill in inland waters and wetlands to improve the existing Runway End 5/23 safety areas at Hanscom Field to meet FAA standards to the extent feasible. The proposed safety area improvements involve impacts to 92,288 sq. ft. (2.12 acres) of waters and wetlands subject to Corps of Engineers jurisdiction. Since the project will require the filling of jurisdictional waters and wetlands MASSPORT has proposed a detailed mitigation plan that is intended to mitigate for unavoidable adverse impacts to the wetlands functions and values at the Runway 23 end of the project. A detailed description and plans of the activity, including the mitigation, are attached.

WATERWAY AND LOCATION OF THE PROPOSED WORK:

This work is proposed in waters and adjacent wetlands associated with a number of small streams that are tributary to the Shawsheen River at the airport property at Hanscom Drive, Bedford, Massachusetts. The proposed location of the Runway 23 filling is on the USGS Concord quadrangle sheet at Zone 19 UTM coordinates 4704940.00 N and 0312300.00 E or Lat/Long

AUTHORITY

Permits are required pursuant to:

- Section 10 of the Rivers and Harbors Act of 1899
 Section 404 of the Clean Water Act
 Section 103 of the Marine Protection, Research and Sanctuaries Act).

The decision whether to issue a permit will be based on an evaluation of the probable impact of the proposed activity on the public interest. That decision will reflect the national concern for both protection and utilization of important resources. The benefit which may reasonably accrue from the proposal must be balanced against its reasonably foreseeable detriments. All factors which may be relevant to the proposal will be considered, including the cumulative effects thereof; among those are: conservation, economics, aesthetics, general environmental concerns, wetlands, cultural value, fish and wildlife values, flood hazards, flood plain value, land use, navigation, shoreline erosion and accretion, recreation, water supply and conservation, water quality, energy needs, safety, food production and, in general, the needs and welfare of the people.

CENAE-R
FILE NO. NAE-2005-1068

The Corps of Engineers is soliciting comments from the public; Federal, state, and local agencies and officials; Indian Tribes; and other interested parties in order to consider and evaluate the impacts of this proposed activity. Any comments received will be considered by the Corps of Engineers to determine whether to issue, modify, condition or deny a permit for this proposal. To make this decision, comments are used to assess impacts on endangered species, historic properties, water quality, general environmental effects, and the other public interest factors listed above. Comments are used in the preparation of an Environmental Assessment and/or an Environmental Impact Statement pursuant to the National Environmental Policy Act. Comments are also used to determine the need for a public hearing and to determine the overall public interest of the proposed activity.

Where the activity involves the discharge of dredged or fill material into waters of the United States or the transportation of dredged material for the purpose of disposing it in ocean waters, the evaluation of the impact of the activity in the public interest will also include application of the guidelines promulgated by the Administrator, U.S Environmental Protection Agency, under authority of Section 404(b) of the Clean Water Act, and/or Section 103 of the Marine Protection Research and Sanctuaries Act of 1972 as amended.

Based on his initial review, the District Engineer has determined that little likelihood exists for the proposed work to impinge upon properties with cultural or Native American significance, or listed in, or eligible for listing in, the National Register of Historic Places. Therefore, no further consideration of the requirements of Section 106 of the National Historic Preservation Act of 1966, as amended, is necessary. This determination is based upon one or more of the following:

- a. The permit area has been extensively modified by previous work.
- b. The permit area has been recently created.
- c. The proposed activity is of limited nature and scope.
- d. Review of the latest published version of the National Register shows that no presence of registered properties listed as being eligible for inclusion therein are in the permit area or general vicinity.
- e. Coordination with the State Historic Preservation Officer and/or Tribal Historic Preservation Officer(s)

The States of Connecticut, Maine, Massachusetts, New Hampshire and Rhode Island have approved **Coastal Zone Management Programs**. Where applicable the applicant states that any proposed activity will comply with and will be conducted in a manner that is consistent with the approved Coastal Zone Management Program. By this Public Notice, we are requesting the State concurrence or objection to the applicant's consistency statement.

The following authorizations have been applied for, or have been, or will be obtained:

- (X) Permit, License or Assent from State.
- (X) Permit from Local Wetland Agency or Conservation Commission.
- (X) Water Quality Certification in accordance with Section 401 of the Clean Water Act.

In order to properly evaluate the proposal, we are seeking public comment. Anyone wishing to comment is encouraged to do so. **Comments should be submitted in writing by the above date.** If you have any questions, please contact Mr. Brian Valiton at (978) 318-8166, (800) 343-4789 or (800) 362-4367, if calling from within Massachusetts.

CENAE-R
FILE NO. NAE-2005-1068

Any person may request, in writing, within the comment period specified in this notice, that a public hearing be held to consider the application. Requests for a public hearing shall specifically state the reasons for holding a public hearing. The Corps holds public hearings for the purpose of obtaining public comments when that is the best means for understanding a wide variety of concerns from a diverse segment of the public.

The initial determinations made herein will be reviewed in light of facts submitted in response to this notice. All comments will be considered a matter of public record. Copies of letters of objection will be forwarded to the applicant who will normally be requested to contact objectors directly in an effort to reach an understanding.

For more information on the New England District Corps of Engineers programs, visit our website at <http://www.nae.usace.army.mil>.

THIS NOTICE IS NOT AN AUTHORIZATION TO DO ANY WORK.



Karen K. Adams
Chief, Permits and Enforcement Branch
Regulatory Division

If you would prefer not to continue receiving Public Notices, please contact Ms. Tina Chaisson at (978) 318-8058 or e-mail her at bettina.m.chaisson@usace.army.mil. You may also check here () and return this portion of the Public Notice to: Bettina Chaisson, Regulatory Division, U.S. Army Corps of Engineers, 696 Virginia Road, Concord, MA 01742-2751.

NAME: _____
ADDRESS: _____

PROPOSED WORK AND PURPOSE

The proposed project consists of regrading and other improvements to runway safety areas (RSA's) at Runways 5/23 at Hanscom Field. The RSA is a defined surface surrounding the runway and is designed to reduce the risk of damage to the aircraft in the event of an excursion from the runway. The RSA also provides access for fire fighting and rescue equipment during such incidents. The current runway 5/23 does not meet FAA design standards and the FAA has requested that the safety area be improved. The work will require the discharge of fill material into waters of the United States for various project features including relocating the roadway, widening the runway 23 safety areas 23 from 300 to 500 feet, and constructing the mitigation project. Total fill area to be placed is currently estimated to be a total of 91,413 sq. ft. of wetlands. The site mitigation will provide 2.25 acres of new wetlands at Site 1 and 1.6 acres of new wetland at Site 2.

The work is described on the enclosed plans entitled "LAURENCE G. HANSCOM FIELD RUNWAY 5/23 – SAFETY AREA IMPROVEMENTS," on 13 sheets, and dated "SEPTEMBER 2007."

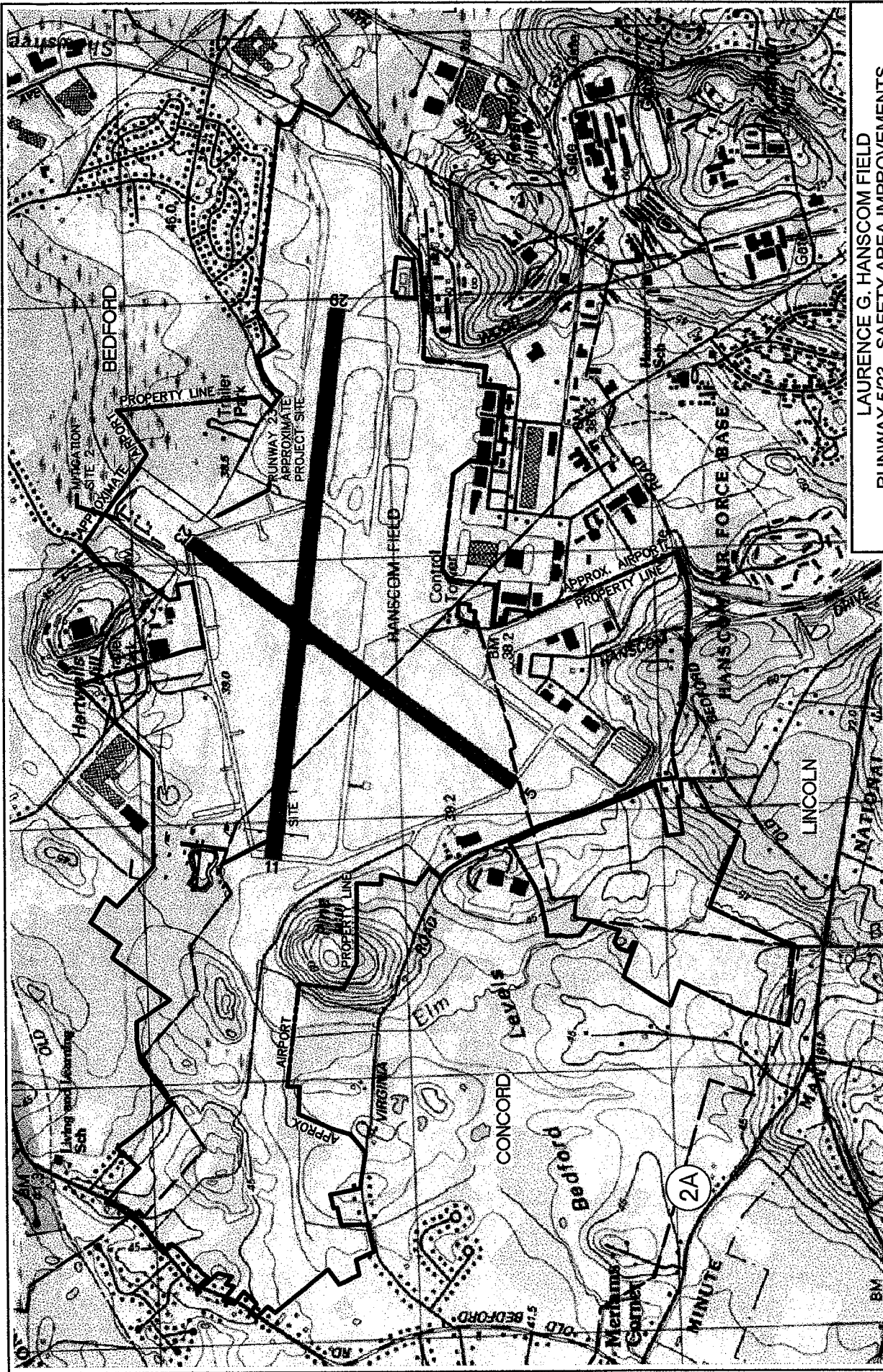

LAURENCE G. HANSCOM FIELD
 RUNWAY 5/23 - SAFETY AREA IMPROVEMENTS
 LOCATION MAP

SCALE: 1" = 1650'
 (APPROX.)

USGS MAP: MAYNARD, MA



MASSACHUSETTS PORT AUTHORITY
 ONE HARBORSIDE DRIVE
 EAST BOSTON, MA 02128



WETLANDS & WILDLIFE, INC.
 233 RUSSELL HILL ROAD
 ASHBURNHAM, MA 01430



McFarland-Johnson, Inc.
 10 FERRY STREET, UNIT 11,
 CONCORD CENTER, SUITE 210, CONCORD, NH 03301
 PH: 603-225-2978 FAX: 603-225-0095

FIGURE
 1



NOT TO SCALE
 0 800 1600 3200 FEET



MASSACHUSETTS PORT AUTHORITY
 ONE HARBORSIDE DRIVE
 EAST BOSTON, MA 02128

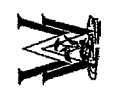

WETLANDS & WILDLIFE, INC.
 233 RUSSELL HILL ROAD
 ASHBURNHAM, MA 01430



McFarland-Johnson, Inc.
 10 FERRY STREET, UNIT 11,
 CONCORD CENTER, SUITE 210, CONCORD, NH 03301
 PH: 603-225-2978 FAX: 603-225-0095

NATIONAL WETLAND INVENTORY

LAURENCE G. HANSCOM FIELD
 RUNWAY 5/23 - SAFETY AREA IMPROVEMENTS
 RUNWAYS 5 AND 23

FIGURE

2



NOT TO SCALE

LAURENCE G. HANSCOM FIELD
RUNWAY 5/23 - SAFETY AREA IMPROVEMENTS
RUNWAY 23 EXISTING
CONDITIONS PLAN

McFarland-Johnson, Inc.
 10 FERRY STREET, UNIT 11,
 CONCORD CENTER, SUITE 210, CONCORD, NH 03301
 PH: 603-225-2978 FAX: 603-225-0095

WETLANDS & WILDLIFE, INC.
 233 RUSSELL HILL ROAD
 ASHBURNHAM, MA 01430

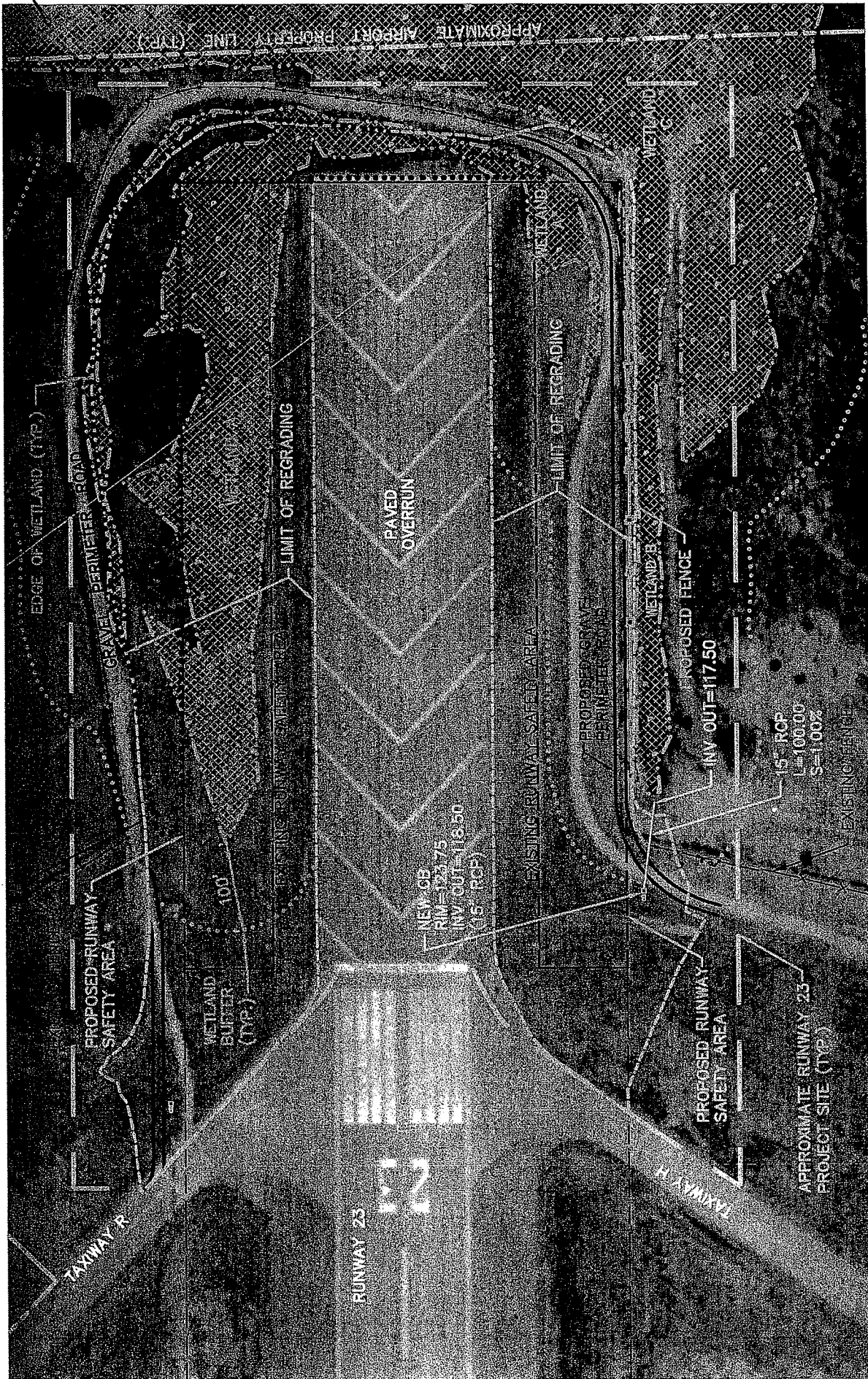

MASSACHUSETTS PORT AUTHORITY
 ONE HARBORSIDE DRIVE
 EAST BOSTON, MA 02128



LAURENCE G. HANSCOM FIELD
 RUNWAY 5/23 - SAFETY AREA IMPROVEMENTS
 RUNWAY 23 PROPOSED
 IMPROVEMENTS

McFarland-Johnson, Inc.
 10 FERRY STREET, UNIT 11,
 CONCORD CENTER, SUITE 210, CONCORD, NH 03301
 PH: 603-225-2978 FAX: 603-225-0095

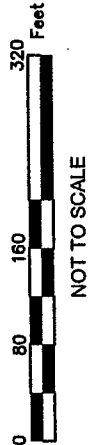
FIGURE
 5



WETLANDS & WILDLIFE, INC.
 233 RUSSELL HILL ROAD
 ASHBURNHAM, MA 01430

MASSACHUSETTS PORT AUTHORITY
 ONE HARBORSIDE DRIVE
 EAST BOSTON, MA 02128



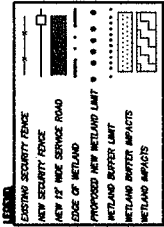
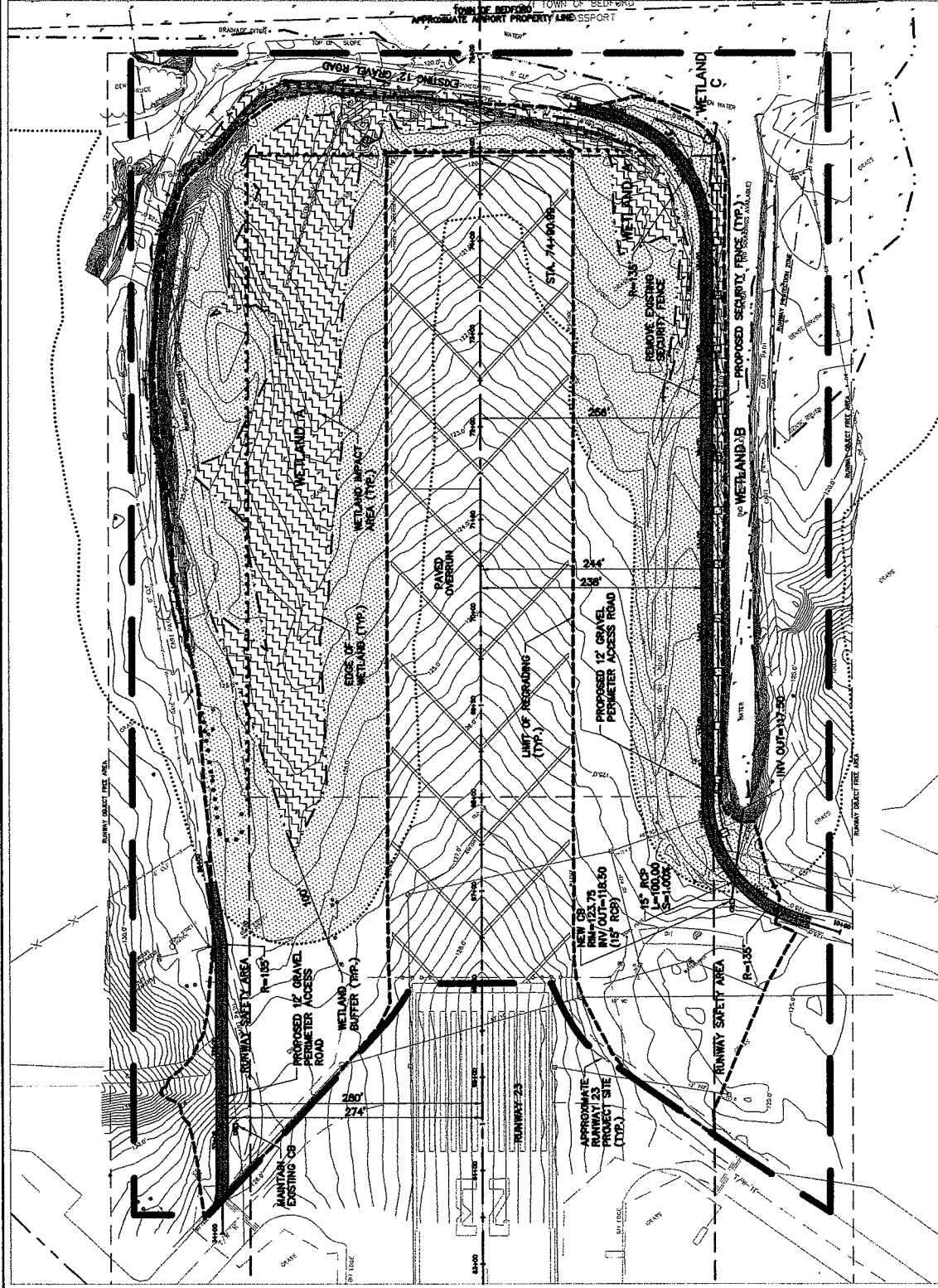

- NOTES:**
- 1) HORIZONTAL CONTROL IS BASED ON MASSACHUSETTS CONTROL, IS BASED ON NAD 1983. VERTICAL CONTROL IS BASED ON NAD 1983.
 - 2) TOPOGRAPHICAL SURVEY PROVIDED BY MASSPORT SURVEY ON PLANS DATED 1/20/04. TOPOGRAPHICAL SURVEY PROVIDED BY MASSPORT SURVEY ON PLANS DATED 1/20/04. TOPOGRAPHICAL SURVEY PROVIDED BY MASSPORT SURVEY ON PLANS DATED 1/20/04. TOPOGRAPHICAL SURVEY PROVIDED BY MASSPORT SURVEY ON PLANS DATED 1/20/04.
 - 3) TOPOGRAPHICAL SURVEY HAS BEEN SUPPLEMENTED BY 1/2" GRID AND RECORD INFORMATION PROVIDED BY MASSPORT.
 - 4) ALL SURVEY DATA SYSTEMS ARE BASED ON NAD 1983. ALL DATA SYSTEMS ARE BASED ON NAD 1983. ALL DATA SYSTEMS ARE BASED ON NAD 1983.

**LAURENCE G. HANSCOM FIELD
RUNWAY 5/23 - SAFETY AREA IMPROVEMENTS
RUNWAY 23 SITE PLAN**

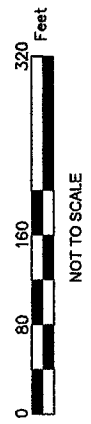

WETLANDS & WILDLIFE, INC.
233 RUSSELL HILL ROAD
ASHBURNHAM, MA 01430

MASSACHUSETTS PORT AUTHORITY
ONE HARBOURSIDE DRIVE
EAST BOSTON, MA 02128



McFarland-Johnson, Inc.
10 FERRY STREET, UNIT 11,
CONCORD CENTER, SUITE 210, CONCORD, NH 03301
PH: 603-225-2978 FAX: 603-225-0095

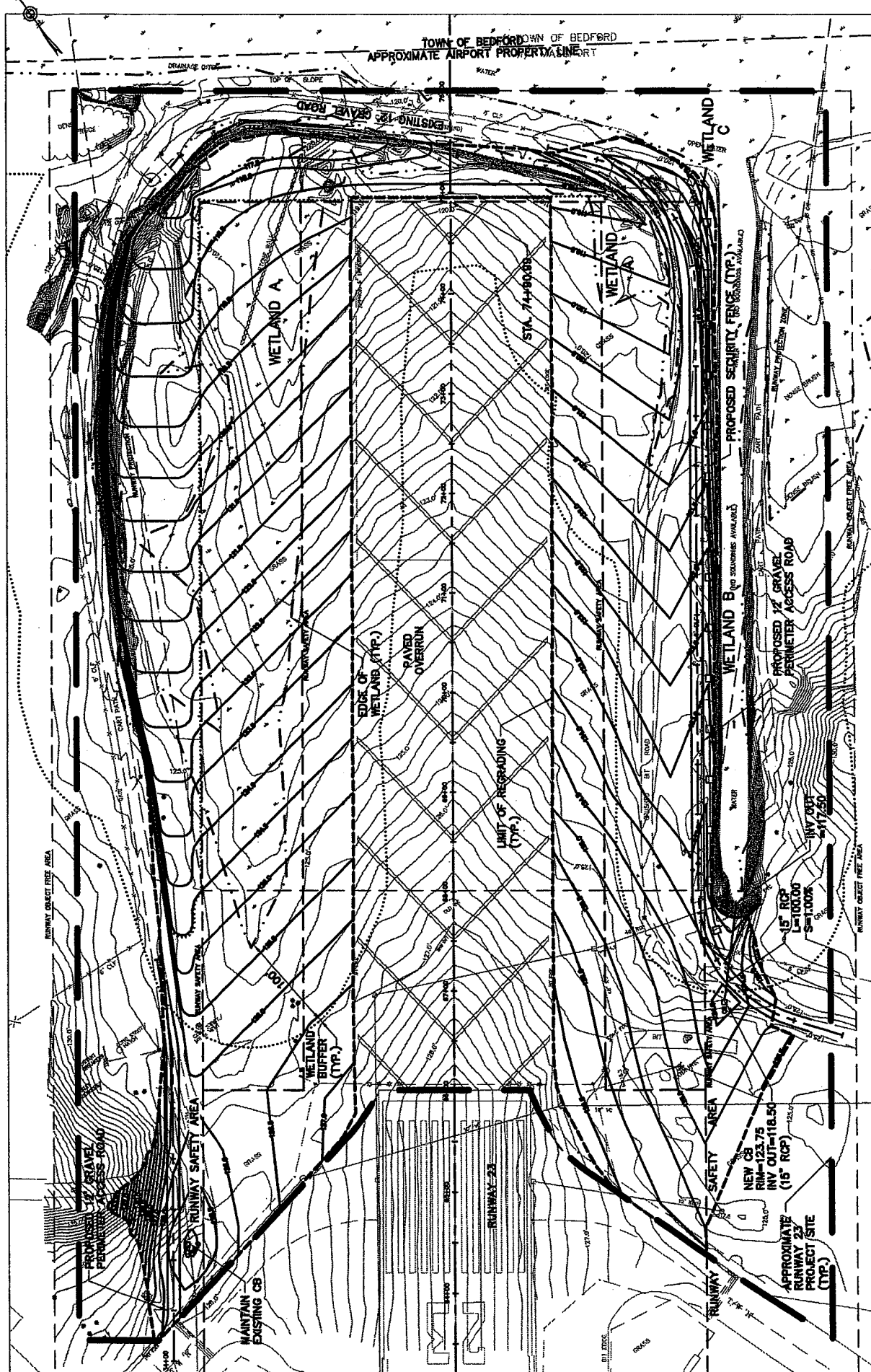

LAURENCE G. HANSCOM FIELD
 RUNWAY 5/23 - SAFETY AREA IMPROVEMENTS
 RUNWAY 23 GRADING PLAN

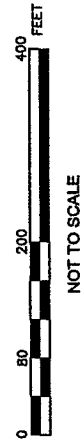

	<p>MASSACHUSETTS PORT AUTHORITY ONE HARBORSIDE DRIVE EAST BOSTON, MA 02128</p>	<p>WETLANDS & WILDLIFE, INC. 233 RUSSELL HILL ROAD ASHBURNHAM, MA 01430</p>	<p>MJ</p> <p>McFarland-Johnson, Inc. 10 FERRY STREET, UNIT 11, CONCORD CENTER, SUITE 210, CONCORD, NH 03301 PH: 603-225-2978 FAX: 603-225-0095</p>	<p>FIGURE 7</p>
--	--	---	---	----------------------------

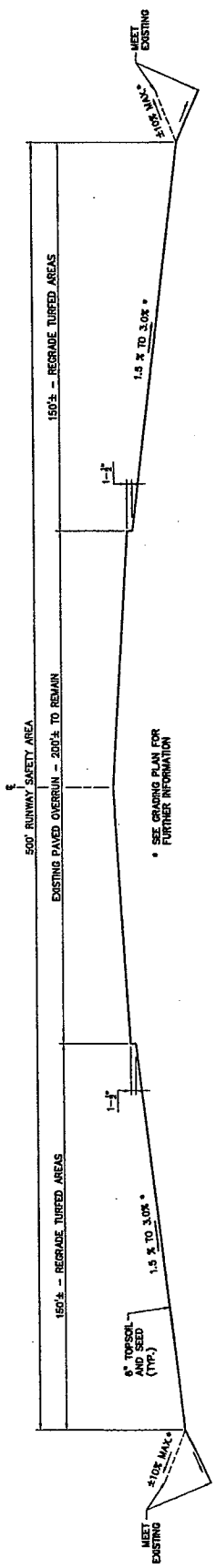

TYPICAL SECTION 0'-200' BEHIND THRESHOLD.
NOT TO SCALE

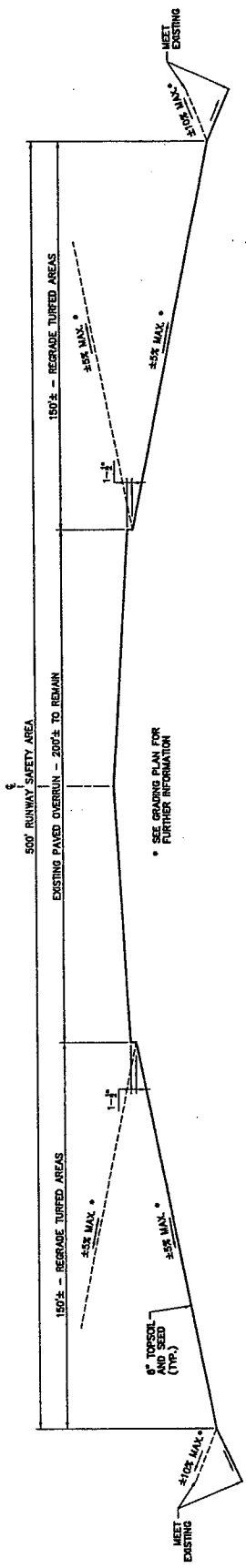

TYPICAL SECTION MORE THAN 200' BEHIND THRESHOLD.
NOT TO SCALE

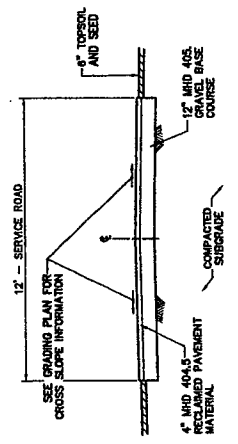

TYPICAL SECTION SERVICE ROAD.
NOT TO SCALE

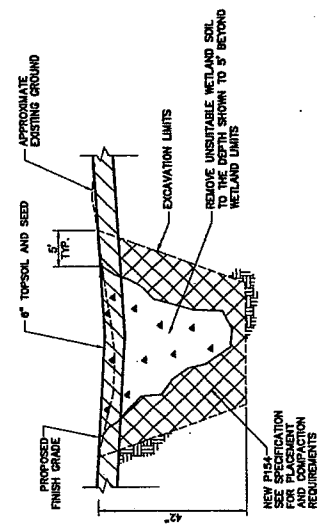

TYPICAL WETLAND SOIL REPLACEMENT
NOT TO SCALE

NO.	DATE	DESCRIPTION	BY	CHKD.
1	3/14/05	3RD DESIGN SUBMISSION	WT	BT

MASSACHUSETTS PORT AUTHORITY
BOSTON, MASSACHUSETTS

LAWRENCE G. HANSON, FIELD ENGINEER
REDFORD, MASSACHUSETTS
2002-2004 AIRFIELD IMPROVEMENT PROGRAM

RUNWAY 5/23 - RUNWAY SAFETY AREA
TYPICAL SECTIONS

McFarland-Johnson, Inc.
CONCRETE CENTER, 10 FERRY STREET, UNIT 11, BOSTON, MA 02110
CONCRETE, INC. 1000 PH. 617-252-2774 FAX. 617-252-2775

SCALE: NOT TO SCALE | DATE: FEB. 18, 2005 | 84' PANEL B | IMPROVE
DRAWN BY: TSB | CHECK BY: RSB | CIVIL 574 2005 | PROJECT NO.:
SHEET NO.: 1052-021 | TOTAL SHEETS: 1052-021 | 6

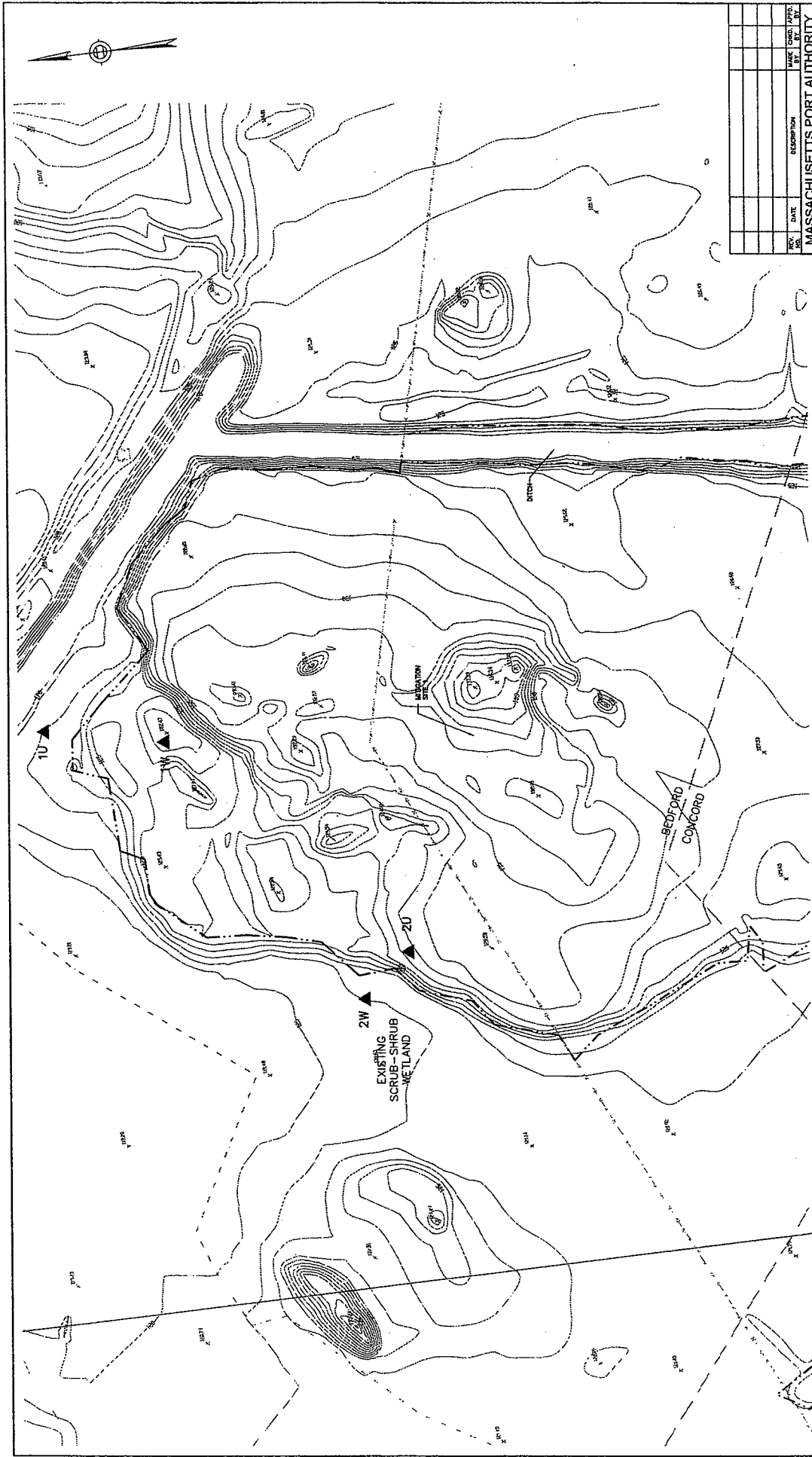

- NOTES:**
1. WETLANDS NORTH OF THE FENCE WERE DELINEATED IN DECEMBER 2006 BY WETLANDS AND WILDLIFE, INC. IN ACCORDANCE WITH "DELINEATING BORROWING WETLANDS UNDER THE MASSACHUSETTS WETLANDS PROTECTION ACT," MASS DEP. ENV. AER. 915 CMR 2.00 AND IN ACCORDANCE WITH THE "COMPASS OF EMERGENCY WETLANDS DELINEATION MANUAL," (ENVIRONMENTAL LABORATORY, 1987).
 2. WETLANDS SOUTH OF THE FENCE WERE DELINEATED BY BUSSENGER-HENRY, INC. THE WETLAND DELINEATIONS WERE CONFIRMED BY AN ORDER OF RESOURCE AREA DELINEATION (ORD) ISSUED ON MARCH 7, 2003 FOR THE "2002-2006 VEGETATION MANAGEMENT PLAN FOR LAURENCE G. HANSCOM FIELD."
 3. SOIL AND VEGETATION INFORMATION FOR DATA POINTS DEPICTED HERE ARE DESCRIBED IN THE "MASS DEP BORROWING VEGETATED WETLAND (S/D CMR 16.05) DELINEATION FIELD DATA FORMS" ATTACHED TO THE NOTICE OF VIOLATION.

- LEGEND**
- EXISTING WETLAND BOUNDARY
 - EXISTING CONTOUR
 - EXISTING FENCE LINE
 - TRANSECT DATA POINT



NO.	DATE	DESCRIPTION	MADE BY	CHECKED BY

MASSACHUSETTS PORT AUTHORITY
 BOSTON, MASSACHUSETTS
 LAURENCE G. HANSCOM FIELD
 BEDFORD, MASSACHUSETTS
 2002-2004 AIRPORT IMPROVEMENT PROGRAM
 RUNWAY 5/23 - SAFETY AREA IMPROVEMENTS
 SITE 1 EXISTING
 CONDITIONS

McFarland-Johnson, Inc.
 CONSULTING ENGINEERS
 100 WASHINGTON ST., SUITE 200
 CONCORD, MA 01742
 TEL: 978-365-2370 FAX: 978-365-2300
 SCALE: DATE: MAY 2007 DRAWN BY: JPC CHECKED BY: JPC
 DRAWN BY: JPC CHECKED BY: JPC
 DATE: 05/02/07
 PROJECT NO.: L492-08
 SHEET NO.: 9

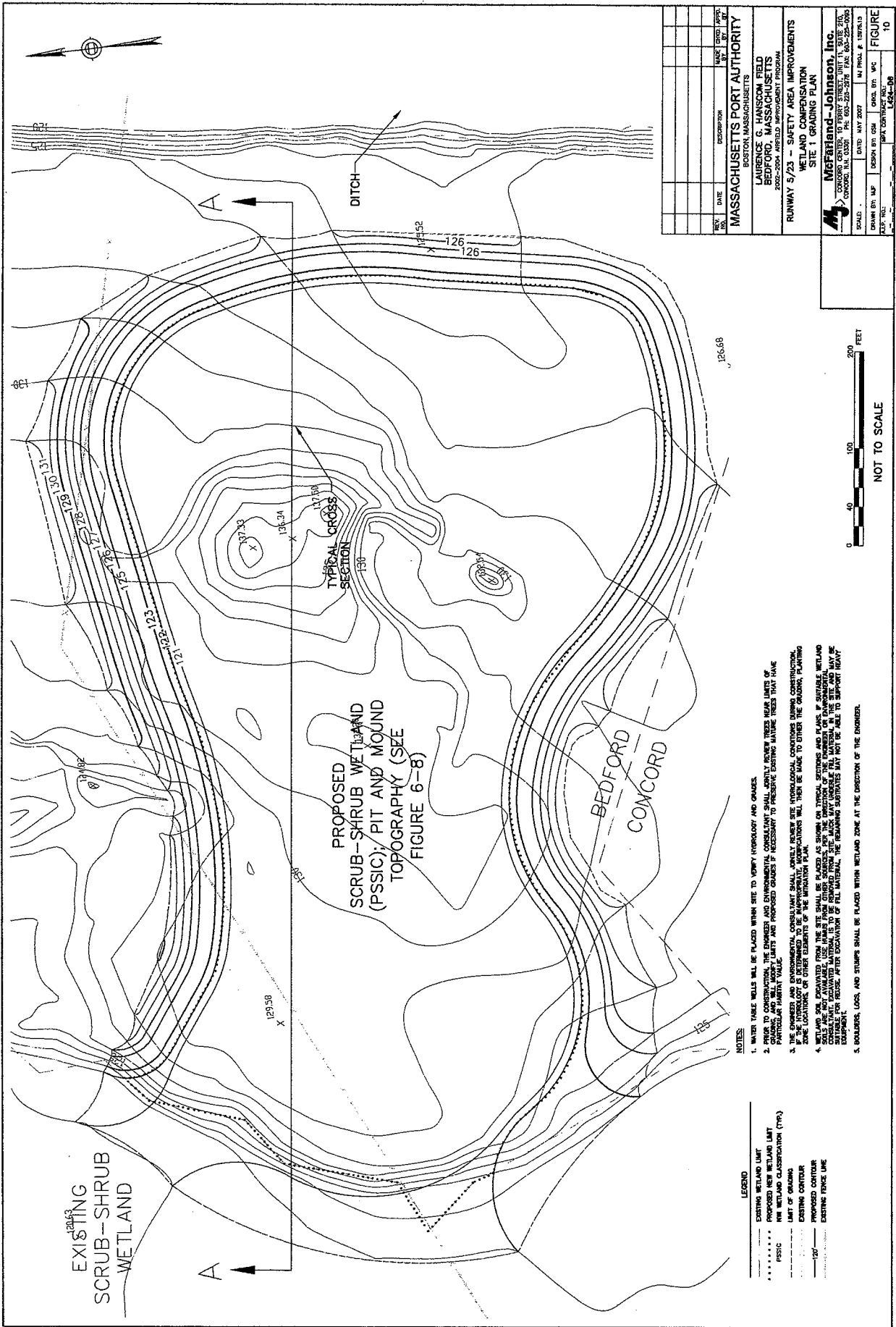

EXISTING
SCRUB-SHRUB
WETLAND

PROPOSED
SCRUB-SHRUB WETLAND
(PSSIC) PIT AND MOUND
TOPOGRAPHY (SEE
FIGURE 6-8)

BEDFORD
CONCORD

LEGEND

- EXISTING WETLAND LIMIT
- PROPOSED NEW WETLAND LIMIT
- PSSIC WETLAND CLASSIFICATION (17%)
- LIMIT OF GRADING
- EXISTING CONTOUR
- PROPOSED CONTOUR
- EXISTING FENCE LINE

NOTES:

1. WATER TABLE WELLS SHALL BE PLACED WITHIN SITE TO VERIFY HYDROLOGY AND GRADES.
2. WETLANDS SHALL BE PROTECTED TO THE MAXIMUM EXTENT POSSIBLE. ANY REMOVAL SHALL BE LIMITED TO THE MINIMUM NECESSARY TO PERFORM ESSENTIAL NATURE FUNCTIONS THAT HAVE PARTICULAR HUMANITY VALUE.
3. THE ENGINEER AND ENVIRONMENTAL CONSULTANT SHALL JOINTLY REVIEW SITE HYDROLOGICAL CONDITIONS DURING CONSTRUCTION. ANY CHANGES TO THE PROPOSED GRADING SHALL BE MADE TO ENSURE THE PROTECTION OF THE WETLANDS AND OTHER ELEMENTS OF THE MITIGATION PLAN.
4. WETLAND SOIL EXCAVATED FROM THE SITE SHALL BE PLACED AS SHOWN ON TYPICAL SECTIONS AND PLANS. IF SUITABLE WETLAND SOIL IS NOT AVAILABLE, EXCAVATED MATERIAL IS TO BE REMOVED FROM THE SITE. ANY WETLAND FILL MATERIAL IN THE SITE AND EXCAVATED MATERIAL SHALL BE REMOVED FROM THE SITE. AFTER EXCAVATION OF FILL MATERIAL, THE REMAINING SUBSTRATES MAY NOT BE ABLE TO SUPPORT HEAVY EQUIPMENT.
5. BRIDGES, LOGS, AND STUMPS SHALL BE PLACED WITHIN WETLAND ZONE AT THE DISCRETION OF THE ENGINEER.

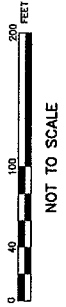

REV.	DATE	DESCRIPTION	MADE BY	CHECKED BY

MASSACHUSETTS PORT AUTHORITY
BOSTON, MASSACHUSETTS

LAURENCE G. HANCOCK FIELD
BEDFORD, MASSACHUSETTS
2002-2004 AIRFIELD IMPROVEMENT PROGRAM

WETLAND COMPENSATION
SITE 1 GRADING PLAN

McFarland-Johnson, Inc.
CONCORD, MASSACHUSETTS
CONCORD, MA 03301 TEL: 603-252-5211 FAX: 603-252-0055

SCALE: 1" = 40' DATE: MAY 2007
DRAWN BY: MF DESIGN BY: GJM CHECKED BY: WPC
DATE: MAY 2007
PART: 10 OF 10
PROJECT: 04-01-006

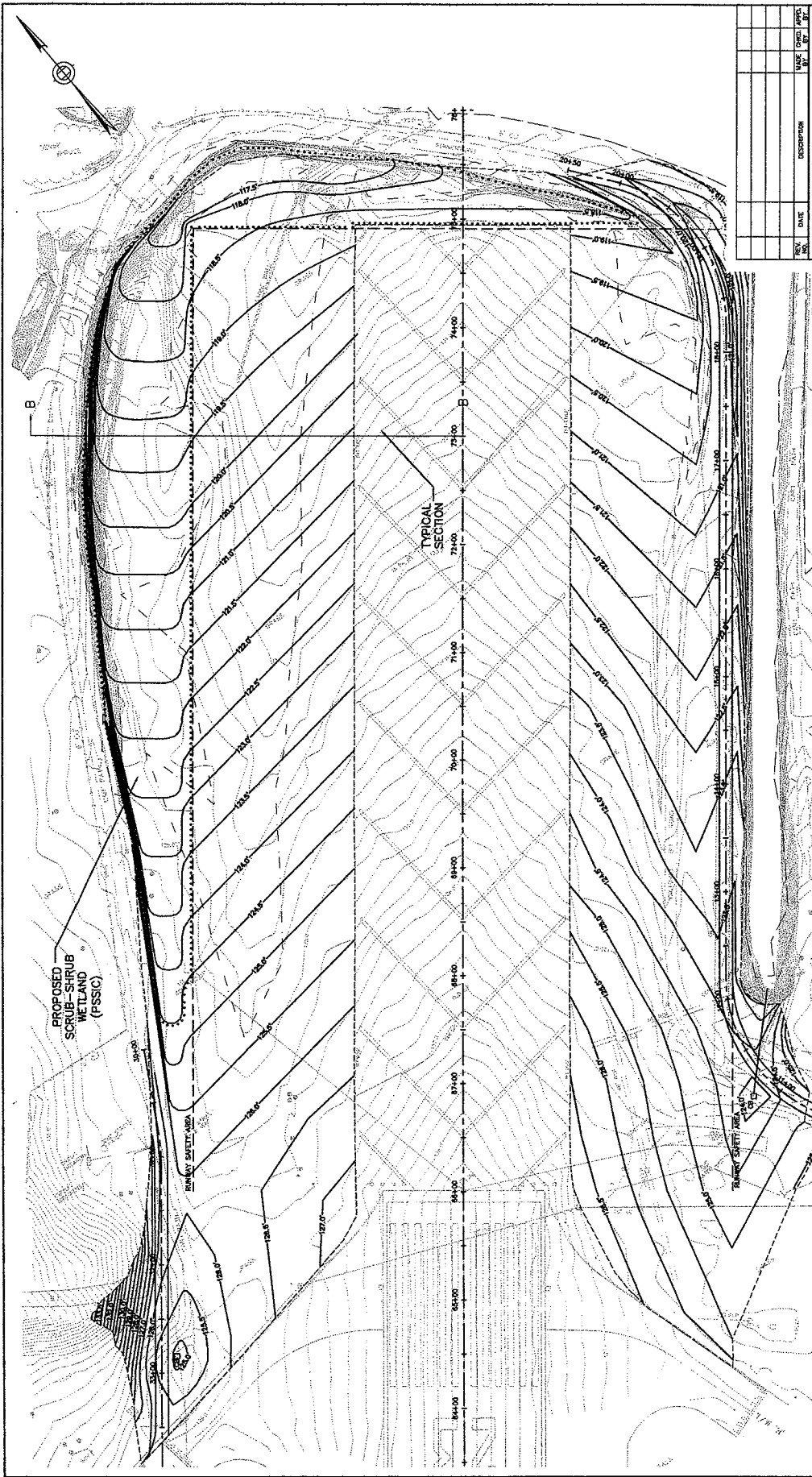

NOTES:

1. THE NUMBER, DIMENSIONS, MATERIALS, AND INTERSECTIONARY SHALL BE REVIEWED BY THE APPLICANT'S ENGINEER AND THE APPLICANT'S ATTORNEY. IF THE INTERSECTIONARY IS TO BE CONSTRUCTED, THE APPLICANT SHALL BE RESPONSIBLE FOR OBTAINING ALL NECESSARY PERMITS AND APPROVALS FROM THE APPLICANT'S ATTORNEY AND THE APPLICANT'S ENGINEER.
2. WETLAND SOIL EXCAVATED FROM THE SITE SHALL BE PLACED AS SHOWN ON TYPICAL SECTIONS AND PLANS. IF SATURATED WETLAND SOILS ARE NOT AVAILABLE, USE MATERIAL FROM OTHER SOURCES. FOR THE PURPOSES OF THIS CONTRACT, THE APPLICANT SHALL BE RESPONSIBLE FOR OBTAINING ALL NECESSARY PERMITS AND APPROVALS FROM THE APPLICANT'S ATTORNEY AND THE APPLICANT'S ENGINEER. THE REMAINING SUBSTRATES MAY NOT BE ABLE TO SUPPORT HEAVY EQUIPMENT.

- LEGEND
- EXISTING WETLAND LIMIT
 - - - - - FSSIC
 - - - - - WETLAND CLASSIFICATION (TYP)
 - LIMIT OF GRADING
 - EXISTING CONTOUR
 - PROPOSED CONTOUR
 - EXISTING TIE LINE
 - EXISTING FENCE LINE

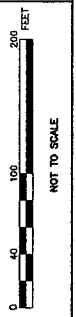

REV.	DATE	DESCRIPTION	DATE	BY

MASSACHUSETTS PORT AUTHORITY
BOSTON, MASSACHUSETTS

LAURENCE G. HANSCOM FIELD
BEDFORD, MASSACHUSETTS
2002-2004 WETLAND IMPROVEMENT PROGRAM

RUNWAY 5/23 - SAFETY AREA IMPROVEMENTS
WETLAND COMPENSATION
SITE 2 GRADING PLAN

M **McFatiand-Johnson, Inc.**
CONCORD CENTER, 10 FERRY STREET, SUITE 111, CONCORD, MA 01742
CONCORD, MASSACHUSETTS TEL: 978-353-7770 FAX: 978-353-8825

SCALE: DATE: MAY 2007 DRAWN BY: MJP CHECKED BY: JDP/MSD
DESIGN BY: MJP DATE: MAY 2007 DRAWN BY: MJP CHECKED BY: JDP/MSD
JOB NO.: 1424-08

FIGURE 11

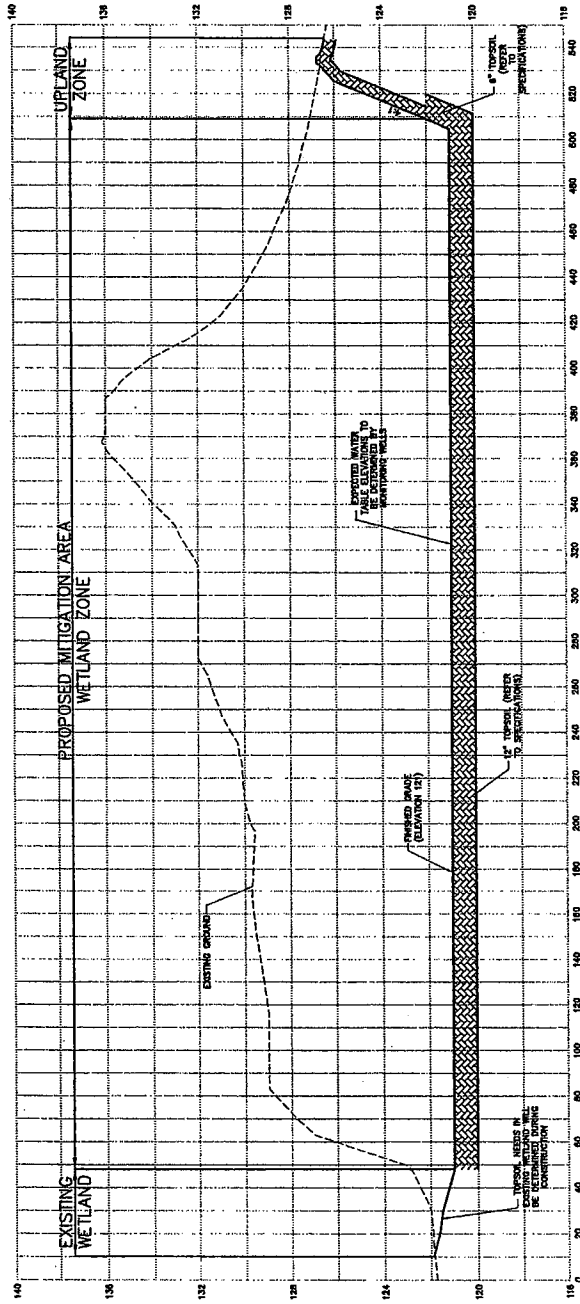

TYPICAL SECTION A-A
MITIGATION SITE 1
NOT TO SCALE

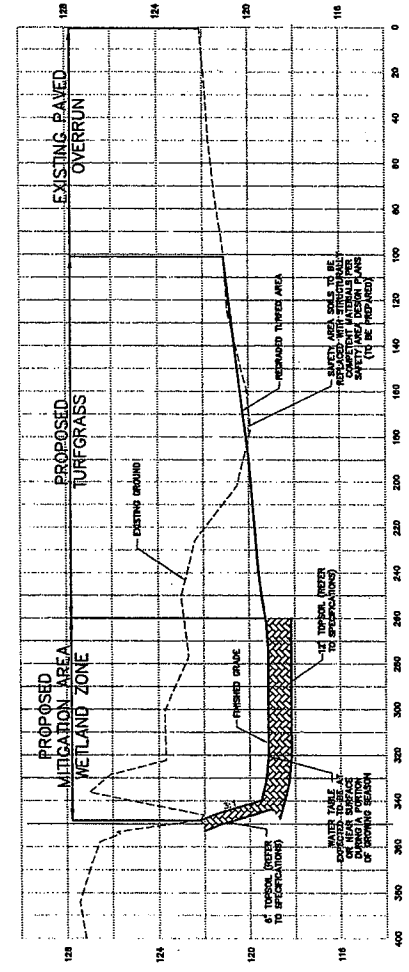

TYPICAL SECTION B-B
MITIGATION SITE 2
NOT TO SCALE

REV. NO.	DATE	DESCRIPTION	MADE BY	CHKD. APPR. BY

MASSACHUSETTS PORT AUTHORITY
 BOSTON, MASSACHUSETTS
LAURENCE G. HANSON FIELD
 BEDFORD, MASSACHUSETTS
 2002-2004 AIRFIELD IMPROVEMENT PROGRAM
 RUNWAY 5/23 - SAFETY AREA IMPROVEMENTS
 WETLAND COMPENSATION
 SITES 1 AND 2
 TYPICAL SECTIONS

McFarland-Johnson, Inc.
 CONCORD CENTER, 10 FERRY STREET, UNIT 11, SUITE 210,
 CONCORD, N.H. 03301, PH: 603-252-2978 FAX: 603-252-0082
 SCALE: AS SHOWN DATE: MAY 2007 IN FINAL # 189FALLS
 DRAWN BY: JAF CHECKED BY: GJM CHECKED BY: VPC
 LEAD: WCL WPT CONTRACT NO.: 4424-08

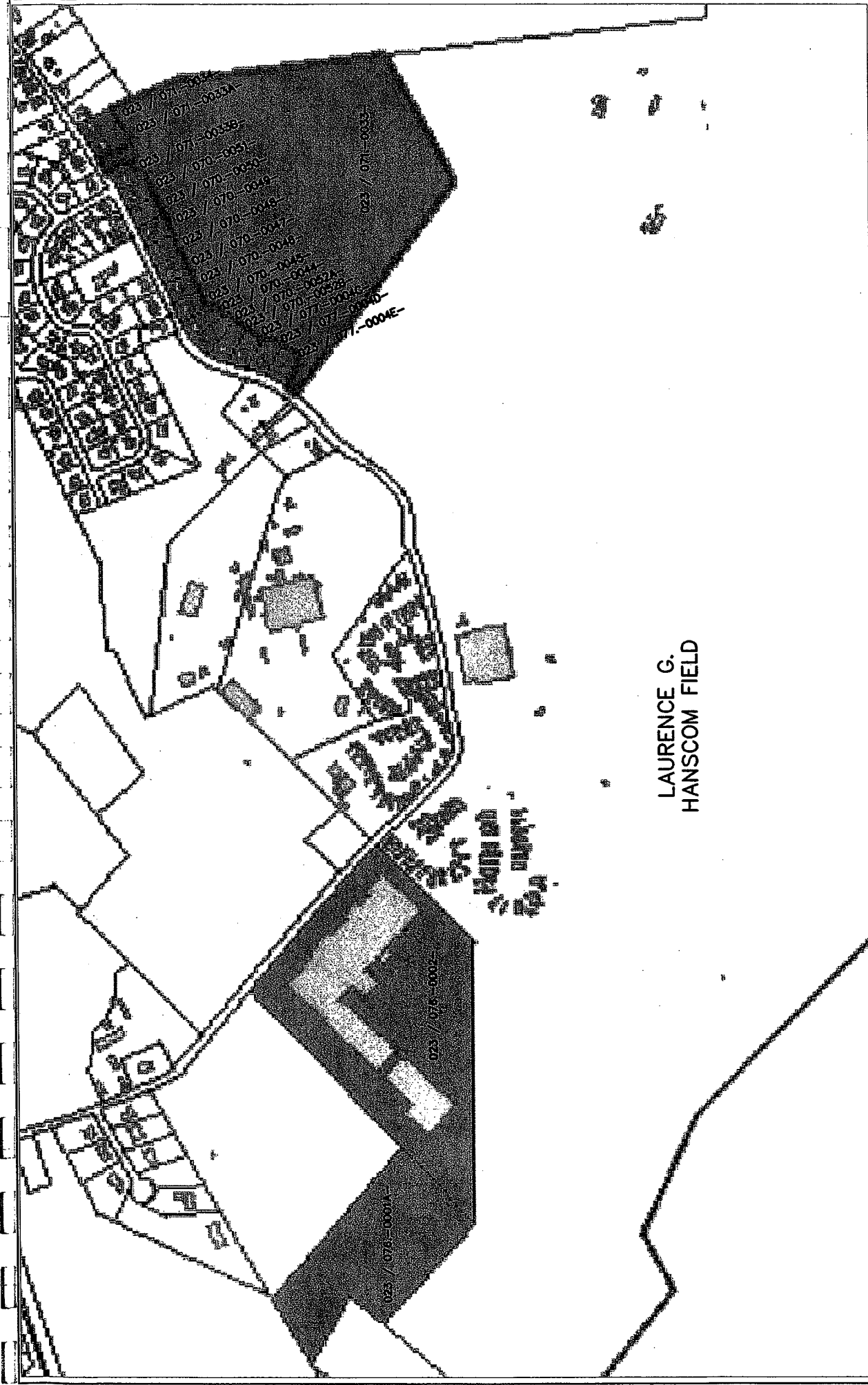

LAURENCE G.
HANSCOM FIELD

Copyright 2004 Town of Bedford, MA, All rights reserved. Developed by AppGeo.com.

NOT TO SCALE

LAURENCE G. HANSCOM FIELD
RUNWAY 5/23 - SAFETY AREA IMPROVEMENTS
ADJOINING PARCELS



MASSACHUSETTS PORT AUTHORITY
ONE HARBORSIDE DRIVE
EAST BOSTON, MA 02128



WETLANDS & WILDLIFE, INC.
233 RUSSELL HILL ROAD
ASHBURNHAM, MA 01430



McFarland-Johnson, Inc.
10 FERRY STREET, UNIT 11,
CONCORD CENTER, SUITE 210, CONCORD, NH 03301
PH: 603-225-2978 FAX: 603-225-0095

FIGURE
13