



**US Army Corps
of Engineers**®
New England District

696 Virginia Road
Concord, MA 01742-2751

PUBLIC NOTICE

Date: January 23, 2007
Comment Period Ends: February 23, 2007
File Number: NAE-2006-219
In Reply Refer To: Ms. Diane M. Ray
Or by e-mail: diane.m.ray@usace.army.mil

The District Engineer has received a permit application from the applicant below to **conduct work in waters of the United States** as described below. The Corps is soliciting comments on both the project itself and the range of issues to be addressed in the environmental documentation.

APPLICANT: 190 South Thames Street, LLC

ACTIVITY

A detailed description and plans of the applicant's proposed activity are attached.

WATERWAY AND LOCATION OF THE PROPOSED WORK

This work is proposed in the Thames River at 190 South Thames Street, Norwich, Connecticut. The proposed location on the USGS Norwich quadrangle sheet is at UTM coordinates 4600494 N and 0743730 E.

AUTHORITY

Permits are required pursuant to:

 X Section 10 of the Rivers and Harbors Act of 1899

The decision whether to issue a permit will be based on an evaluation of the probable impact of the proposed activity on the public interest. That decision will reflect the national concern for both protection and utilization of important resources. The benefit which may reasonably accrue from the proposal must be balanced against its reasonably foreseeable detriments. All factors which may be relevant to the proposal will be considered, including the cumulative effects thereof; among those are: conservation, economics, aesthetics, general environmental concerns, wetlands, cultural value, fish and wildlife values, flood hazards, flood plain value, land use, navigation, shoreline erosion and accretion, recreation, water supply and conservation, water quality, energy needs, safety, food production and, in general, the needs and welfare of the people.

The Corps of Engineers is soliciting comments from the public; Federal, state, and local agencies and officials; Indian Tribes; and other interested parties in order to consider and evaluate the impacts of this proposed activity. Any comments received will be considered by the Corps of Engineers to determine whether to issue, modify, condition or deny a permit for this proposal. To make this decision, comments are used to assess impacts on endangered species, historic properties, water quality, general environmental effects, and the other public interest factors listed above. Comments are used in the preparation of an Environmental Assessment and/or an Environmental Impact Statement pursuant to the National Environmental Policy Act. Comments are also used to determine the need for a public hearing and to determine the overall public interest of the proposed activity.

CENAE-R
FILE NO. NAE-2006-219

Where the activity involves the discharge of dredged or fill material into waters of the United States or the transportation of dredged material for the purpose of disposing it in ocean waters, the evaluation of the impact of the activity in the public interest will also include application of the guidelines promulgated by the Administrator, U.S Environmental Protection Agency, under authority of Section 404(b) of the Clean Water Act, and/or Section 103 of the Marine Protection Research and Sanctuaries Act of 1972 as amended.

ESSENTIAL FISH HABITAT

The Magnuson-Stevens Fishery Conservation and Management Act, as amended by the Sustainable Fisheries Act of 1996 (Public Law 104-267), requires all federal agencies to consult with the National Marine Fisheries Service on all actions, or proposed actions, permitted, funded, or undertaken by the agency, that may adversely affect Essential Fish Habitat (EFH).

This project will impact approximately 13,852 acres of Essential Fish Habitat (EFH) for the attached list of species and their life stages. This habitat consists of sand and silt. Loss of this habitat may adversely affect those species. However, the District Engineer has made a preliminary determination that the site-specific adverse effect will not be substantial. Further consultation with the National Marine Fisheries Service regarding EFH conservation recommendations is being conducted and will be concluded prior to the final decision.

SECTION 106 COORDINATION

Based on his initial review, the District Engineer has determined that the proposed work may impact properties listed in, or eligible for listing in, the National Register of Historic Places. Additional review and consultation to fulfil requirements under Section 106 of the National Historic Preservation Act of 1966, as amended, will be ongoing as part of the permit review process.

Pursuant to the **Endangered Species Act**, the District Engineer is hereby requesting that the appropriate Federal Agency provide comments regarding the presence of and potential impacts to listed species or its critical habitat.

The States of Connecticut, Maine, Massachusetts, New Hampshire and Rhode Island have approved **Coastal Zone Management Programs**. Where applicable the applicant states that any proposed activity will comply with and will be conducted in a manner that is consistent with the approved Coastal Zone Management Program. By this Public Notice, we are requesting the State concurrence or objection to the applicant's consistency statement.

The following authorizations have been applied for, or have been, or will be obtained:

- (X) Permit, License or Assent from State.
- () Permit from Local Wetland Agency or Conservation Commission.
- () Water Quality Certification in accordance with Section 401 of the Clean Water Act.

CENAE-R
FILE NO. NAE-2006-219

In order to properly evaluate the proposal, we are seeking public comment. Anyone wishing to comment is encouraged to do so. **Comments should be submitted in writing by the above date.** If you have any questions, please contact Ms. Diane M. Ray at (978) 318-8831, (800) 343-4789 or (800) 362-4367, if calling from within Massachusetts.

Any person may request, in writing, within the comment period specified in this notice, that a public hearing be held to consider the application. Requests for a public hearing shall specifically state the reasons for holding a public hearing. The Corps holds public hearings for the purpose of obtaining public comments when that is the best means for understanding a wide variety of concerns from a diverse segment of the public.

The initial determinations made herein will be reviewed in light of facts submitted in response to this notice. All comments will be considered a matter of public record. Copies of letters of objection will be forwarded to the applicant who will normally be requested to contact objectors directly in an effort to reach an understanding.

For more information on the New England District Corps of Engineers programs, visit our website at <http://www.nae.usace.army.mil>.

THIS NOTICE IS NOT AN AUTHORIZATION TO DO ANY WORK.

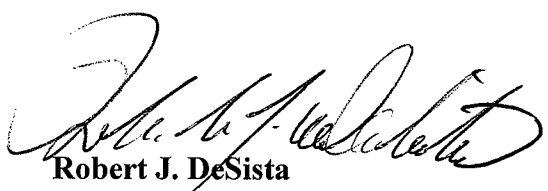

Robert J. DeSista
Chief, Permits and Enforcement Branch
Regulatory Division

If you would prefer not to continue receiving Public Notices, please contact Ms. Tina Chaisson at (978) 318-8058 or e-mail her at bettina.m.chaisson@usace.army.mil. You may also check here () and return this portion of the Public Notice to: Bettina Chaisson, Regulatory Division, U.S. Army Corps of Engineers, 696 Virginia Road, Concord, MA 01742-2751.

NAME: _____
ADDRESS: _____

PROPOSED WORK AND PURPOSE:

The proposed project includes work in navigable waters in conjunction with the construction of a 28-slip marina facility.

Construct and maintain approximately 1,470 linear feet of 8' wide floats, a 10' x 20' landing float and twelve 6' x 24' finger floats w/ tie-off pilings and fender pilings.

Construct and maintain two 10' x 10' pile and timber landing, one with a 4'x 26' ramp and the other with a 4'x 40' ramp.

The structures will be place parallel to the shoreline and maintain a minimum 35' setback from the Federal Navigation Channel.

The work is described on the enclosed plans entitled "New Dock Facility, City of Norwich, New London County, Connecticut, Thames River" in seven sheets, dated, "December 20, 2005", revised, "2/7/06" and "6/2/06".

Summary of Essential Fish Habitat (EFH) Designation

10' x 10' Square Coordinates:

Boundary	North	East	South	West
Coordinate	41° 30.0' N	72° 00.0' W	41° 20.0' N	72° 10.0' W

-

Square Description (i.e. habitat, landmarks, coastline markers): The waters within the square within the Connecticut River estuary affecting the following: within New London Harbor from Long Island Sound on the south, north up to just north of Smith Cove within the Thames River. These waters affect the following: Greens Harbor, Hog Back, White Rock, Melton Ledge, Groton, CT., and New London CT., Winthrop Pt., Jacobs Rock, Bailey Pt., Mamacoke River, and Harrison, CT. Also, the waters within this square are found within the Poquonock River north of the Groton – New London Airport, and affect waters within northern Jordan Cove, Jordan Brook, and North Wing Brook, near Jordan CT.

Species	Eggs	Larvae	Juveniles	Adults
Atlantic salmon (<i>Salmo salar</i>)			X	X
pollock (<i>Pollachius virens</i>)			X	X
red hake (<i>Urophycis chuss</i>)	X	X	X	X
windowpane flounder (<i>Scophthalmus aquosus</i>)	X	X	X	X
Atlantic sea herring (<i>Clupea harengus</i>)			X	X
monkfish (<i>Lophius americanus</i>)				X
bluefish (<i>Pomatomus saltatrix</i>)			X	X
king mackerel (<i>Scomberomorus cavalla</i>)	X	X	X	X
Spanish mackerel (<i>Scomberomorus maculatus</i>)	X	X	X	X
cobia (<i>Rachycentron canadum</i>)	X	X	X	X
sand tiger shark (<i>Odontaspis taurus</i>)		X		

REGULATORY DIVISION
 AUG 28 2006
 RECEIVED

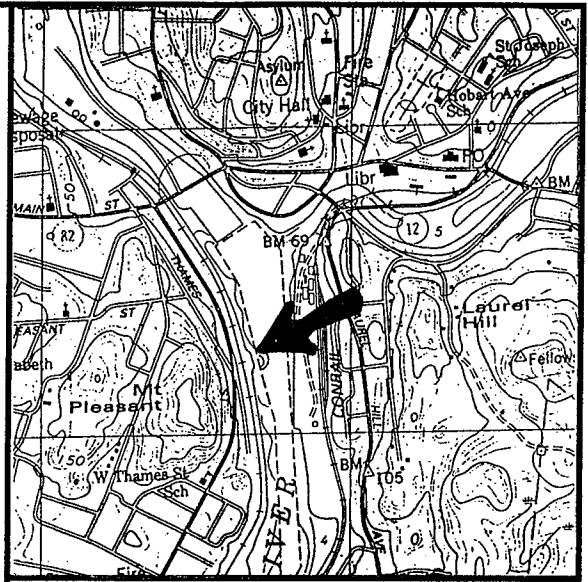

LOCATION MAP
 REFERENCE CHART: 12372
 GRAPHIC SCALE IN YARDS
 1000 0 1000

- NOTES:**
- ELEVATION DATUM IS NGVD 1929. TIDE DATA IS TAKEN FROM 2005 NOAA TIDE TABLES REFERENCE : NORWICH.
 - PROJECT DESCRIPTION:**
 CONSTRUCT 1,470±LF OF 8' WIDE FLOATS, A 10' WIDE X 20' LANDING FLOAT AND TWELVE 6' X 24' FINGER FLOATS WITH ASSOCIATED TIE-OFF, FENDER AND RESTRAINT PILINGS. CONSTRUCT TWO 10' X 10' FIXED PILE AND TIMBER LANDINGS, ONE WITH A 4' X 26' RAMP THE OTHER A 4' X 40' RAMP, ALL AT OR WATERWARD OF THE HIGH TIDE LINE.
 - PROJECT PURPOSE:**
 THIS IS A COMMERCIAL DOCK FACILITY TO PROVIDE SHOREFRONT ACCESS FOR RECREATIONAL BOATING.
 - THESE APPLICATION DRAWINGS REPRESENT A COMPILATION OF SURVEYS FOR PERMIT PURPOSES. THEY ARE NOT CONSTRUCTION CONTRACT DOCUMENTS.
 - ADJOINING PROPERTY OWNERS:**
 NORTH and SOUTH
 NEW ENGLAND RAILROAD
 c/o STEVE WICHMAN
 SOUTHERN CONNECTICUT RAILROAD
 70 TOLLAND STREET
 EAST HARTFORD, CT 06108

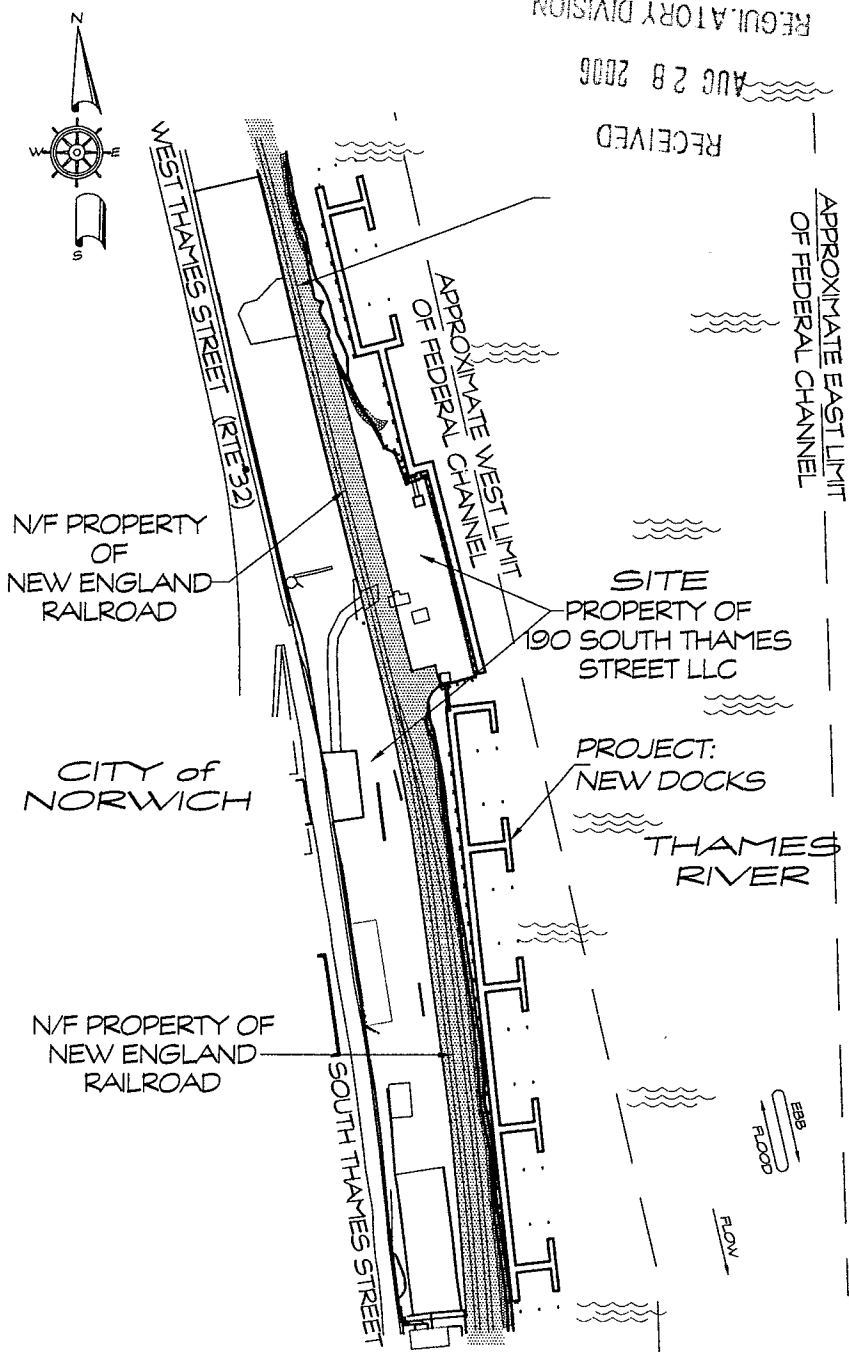

PLAN VIEW
 GRAPHIC SCALE 1" = 200'
 200 100 0 200

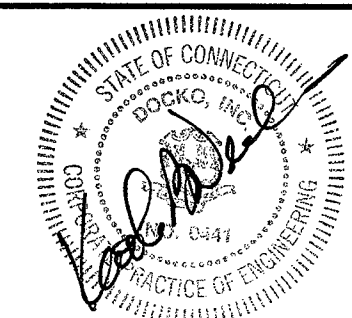

PROJECT: NEW DOCK FACILITY

LOCATION: CITY OF NORWICH
 NEW LONDON COUNTY, CONNECTICUT

WATERWAY: THAMES RIVER

DATE: DECEMBER 20, 2005

APPLICANT: 190 SOUTH THAMES STREET LLC

AGENT: SHEET 1 OF 7

DOCKO, INC.
 Keith B. Nellson, PE
 Mystic, CT 06355
 860 572 8939 FAX 860 572 7569
 EMAIL: docko@snet.net

DWG 04-11-1637

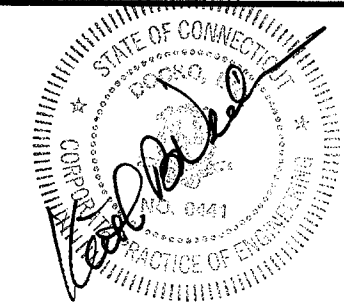
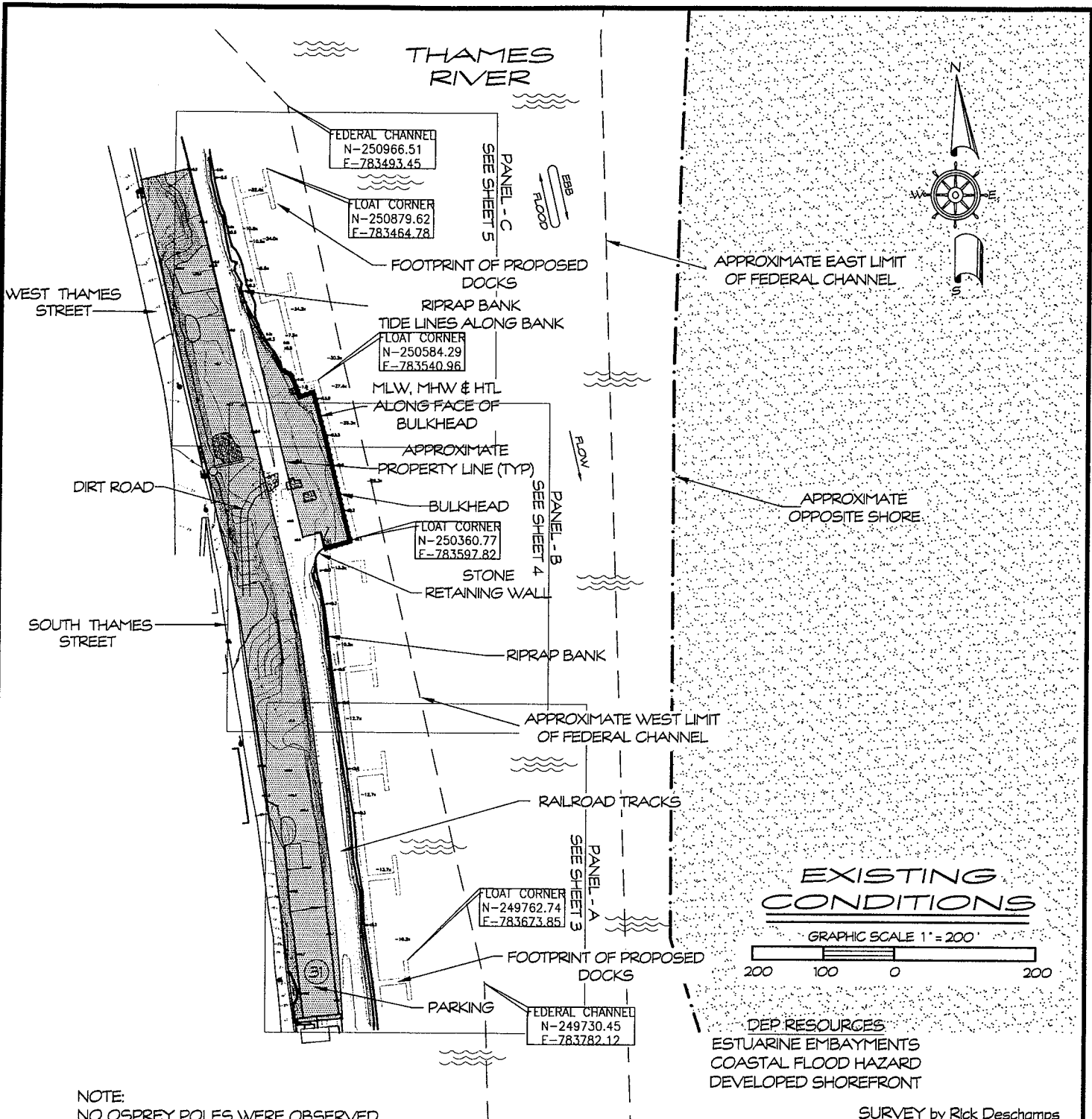

REVISION 2/7/06 ACOE
COORDINATES
REVISION 6/2/06 DEP
PARKING CALLOUT

PROJECT: **NEW DOCK FACILITY**

LOCATION: CITY OF NORWICH
NEW LONDON COUNTY, CONNECTICUT

WATERWAY: THAMES RIVER

DATE: DECEMBER 20, 2005

APPLICANT: 190 SOUTH THAMES
STREET LLC

AGENT: SHEET 2 OF 7

DOCKO, INC.
Keith B. Nelson, PE
Mystic, CT 06355
860 572 8939 FAX 860 572 7569
EMAIL: docko@snet.net

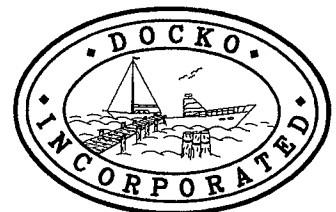

DWG 04-11-1637

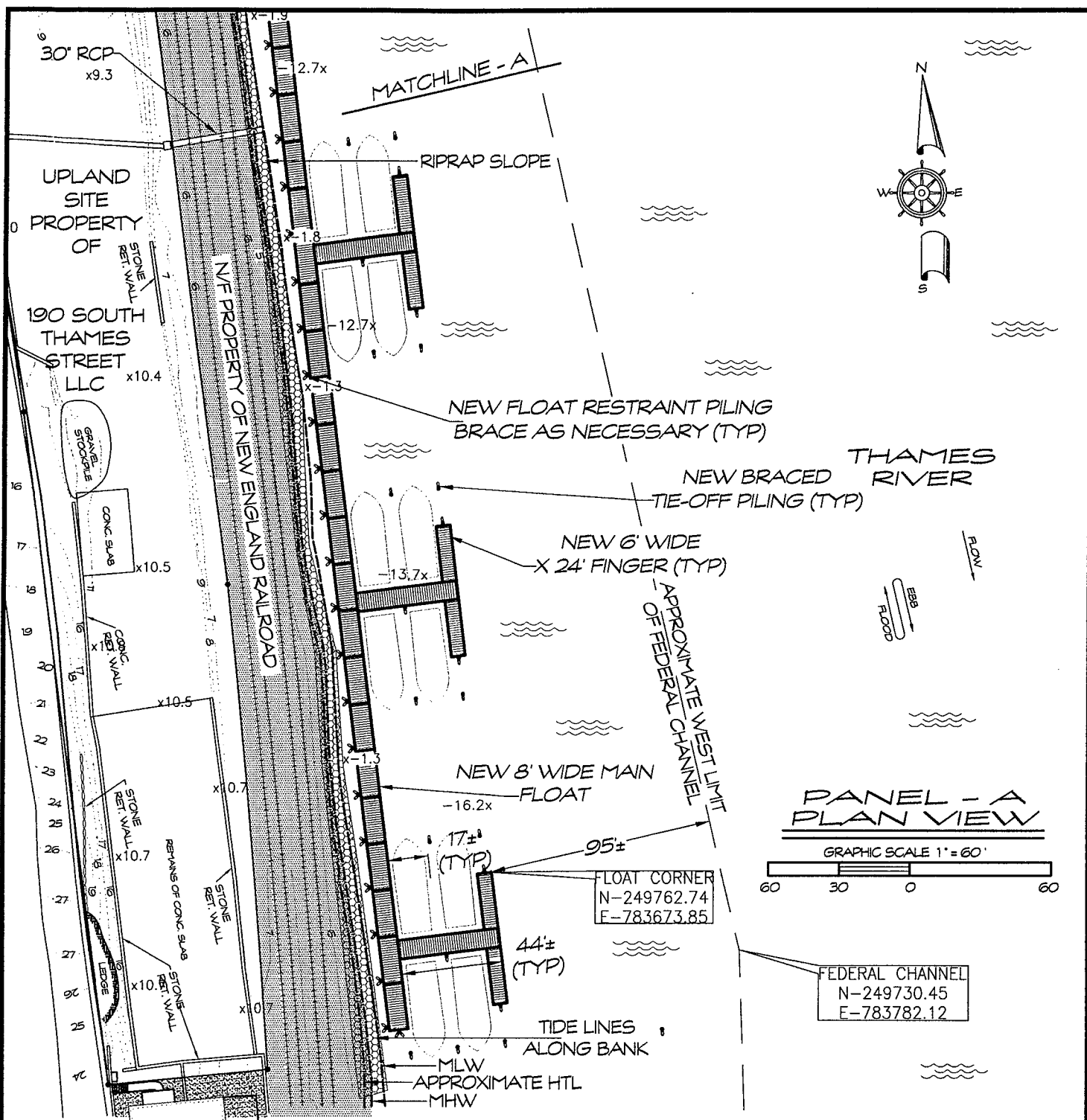

SURVEY by Rick Deschamps

REVISION 2/7/06 ACOE
COORDINATES
REVISION 6/2/06 DEP
HIGH TIDE LINE

PROJECT: NEW DOCK FACILITY

LOCATION: CITY OF NORWICH
NEW LONDON COUNTY, CONNECTICUT

WATERWAY: THAMES RIVER
DATE: DECEMBER 20, 2005
APPLICANT: 190 SOUTH THAMES
STREET LLC
AGENT: SHEET 3 OF 7

DOCKO, INC.

Keith B. Neilson, PE
Mystic, CT 06355
860 572 8939 FAX 860 572 7569
EMAIL: docko@snet.net

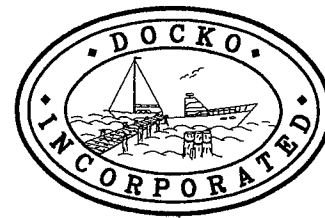

DWG 04-11-1637

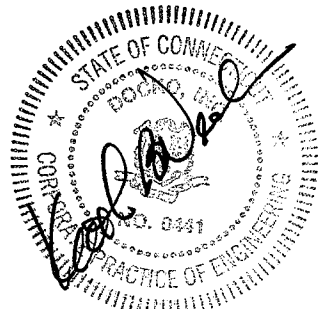

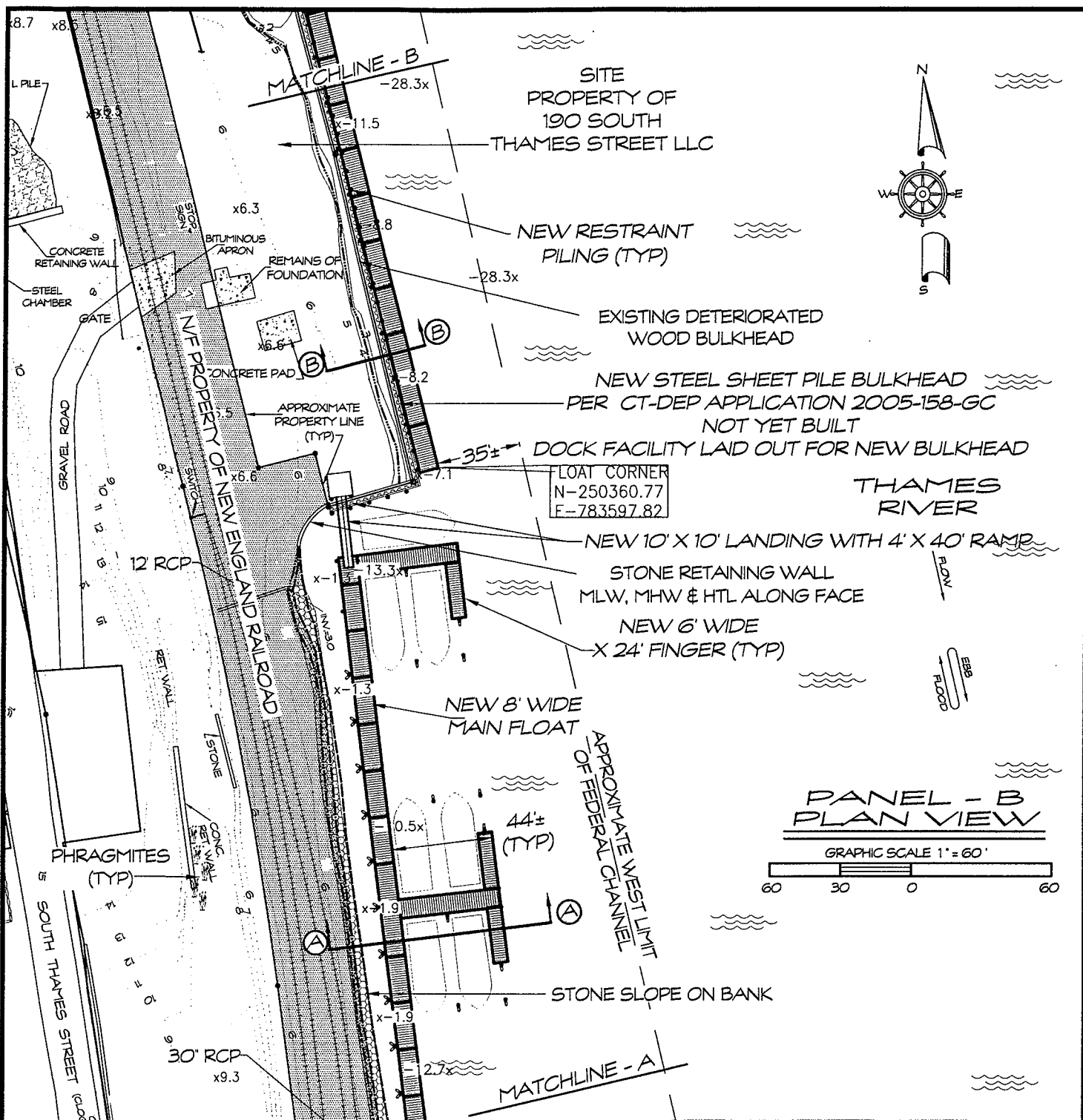

SURVEY by Rick Deschamps

REVISION 2/7/06 ACOE
COORDINATES

REVISION 6/2/06 DEP
HIGH TIDE LINE

PROJECT: NEW DOCK FACILITY

LOCATION: CITY OF NORWICH
NEW LONDON COUNTY, CONNECTICUT

WATERWAY: THAMES RIVER

DATE: DECEMBER 20, 2005

APPLICANT: 190 SOUTH THAMES
STREET LLC

AGENT: SHEET 4 OF 7

DOCKO, INC.
Keith B. Neilson, PE
Mystic, CT 06355
860 572 8939 FAX 860 572 7569
EMAIL: docko@snet.net

DWG 04-11-1637

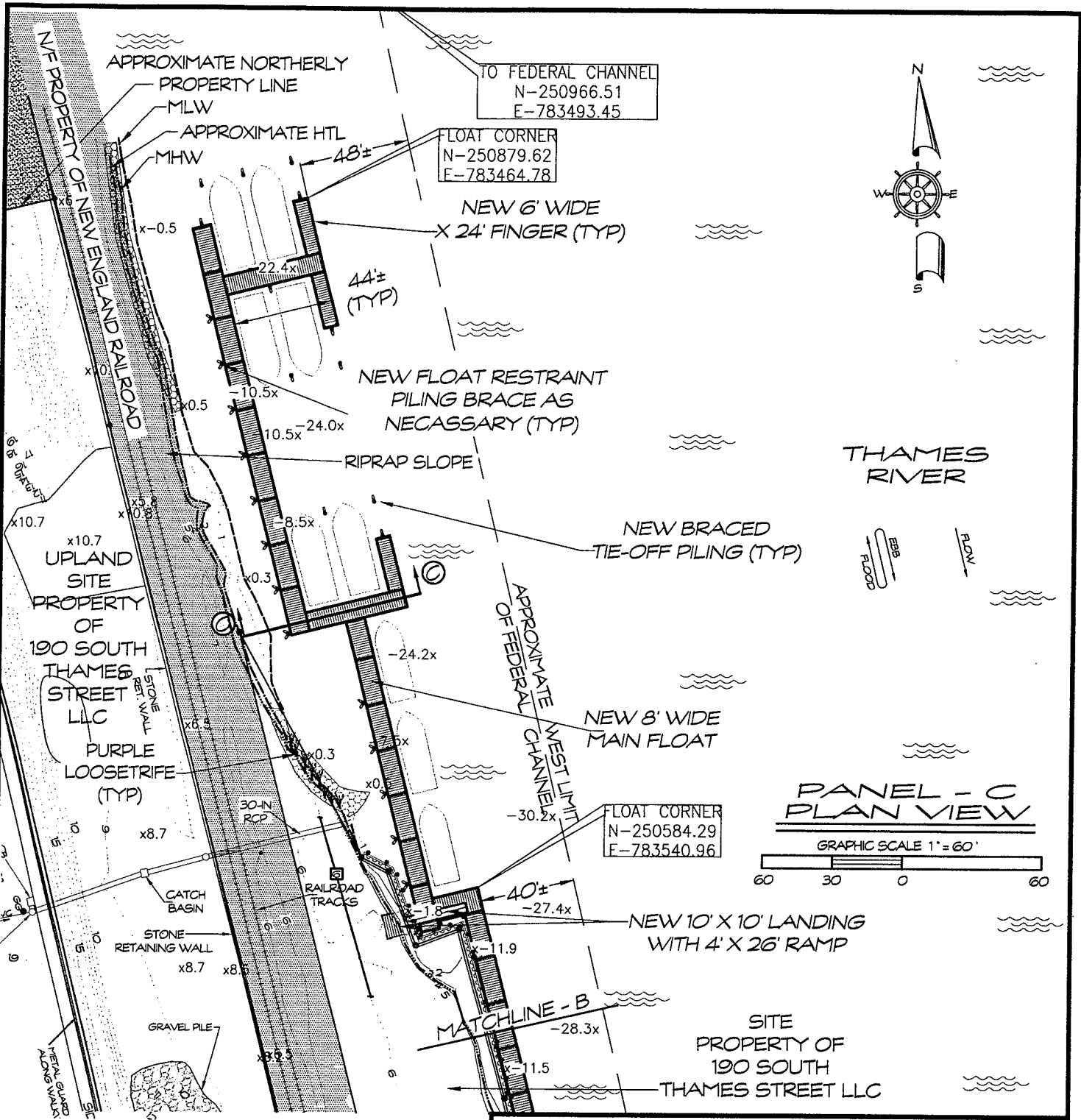

SURVEY by Rick Deschamps

PROJECT: NEW DOCK FACILITY

LOCATION: CITY OF NORWICH
NEW LONDON COUNTY, CONNECTICUT

WATERWAY: THAMES RIVER
DATE: DECEMBER 20, 2005
APPLICANT: 190 SOUTH THAMES STREET LLC
AGENT: SHEET 5 OF 7

DOCKO, INC.
Keith B. Neilson, PE
Mystic, CT 06355
860 572 8939 FAX 860 572 7569
EMAIL: docko@snet.net



DWG 04-11-1637

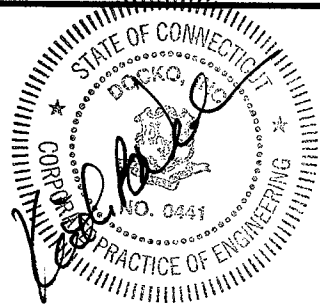

REVISION 2/7/06 ACOE COORDINATES
REVISION 6/2/06 DEP HTL, [6] CONTOUR

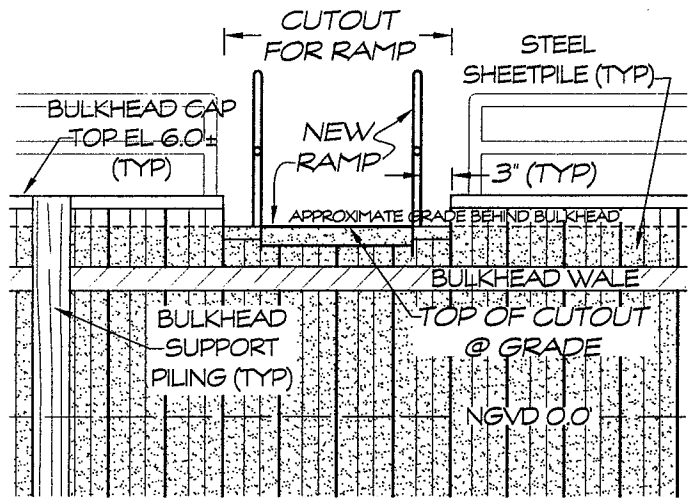
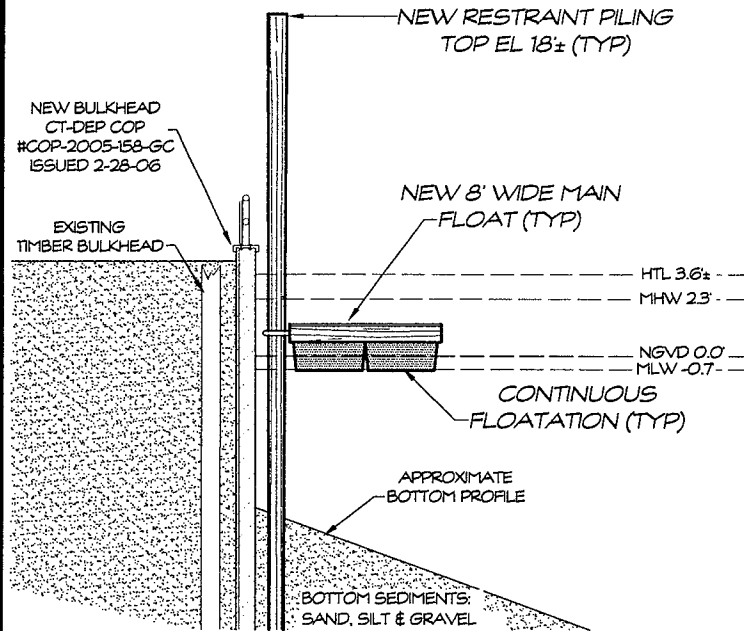
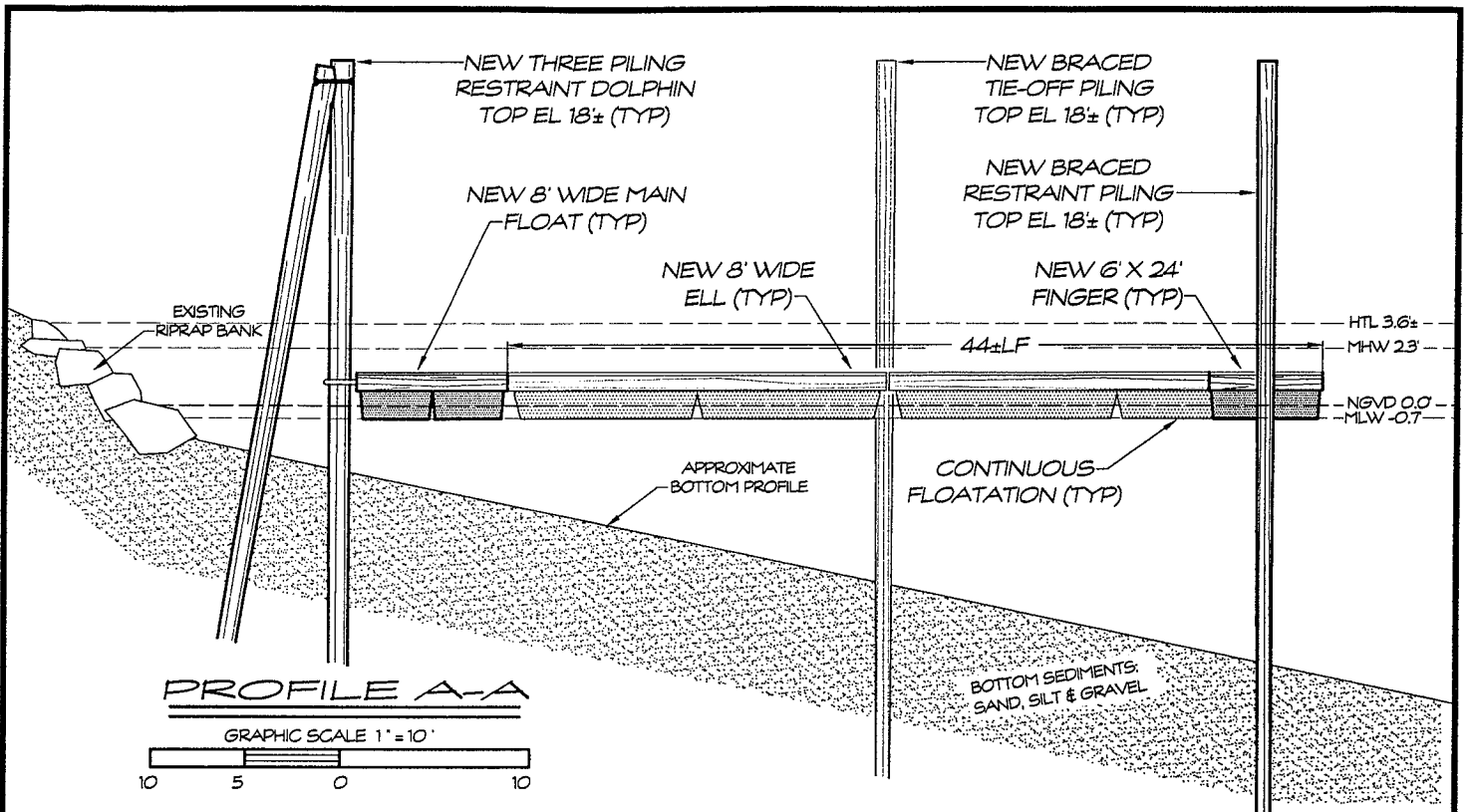

PROJECT: NEW DOCK FACILITY

LOCATION: CITY OF NORWICH
NEW LONDON COUNTY, CONNECTICUT

WATERWAY: THAMES RIVER
DATE: DECEMBER 20, 2005
APPLICANT: 190 SOUTH THAMES STREET LLC

AGENT: SHEET 6 OF 7

DOCKO, INC.

Keith B. Nelson, PE
Mystic, CT 06355
860 572 8939 FAX 860 572 7569
EMAIL: docko@snet.net

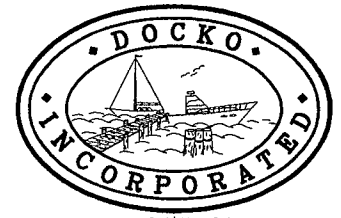

DWG 0441-1637

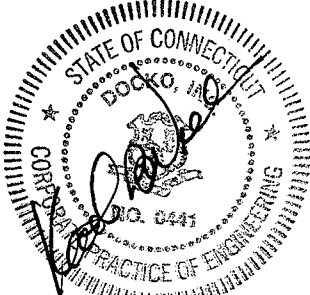

REVISION 6/2/06 DEP BULKHEAD, CALLOUTS

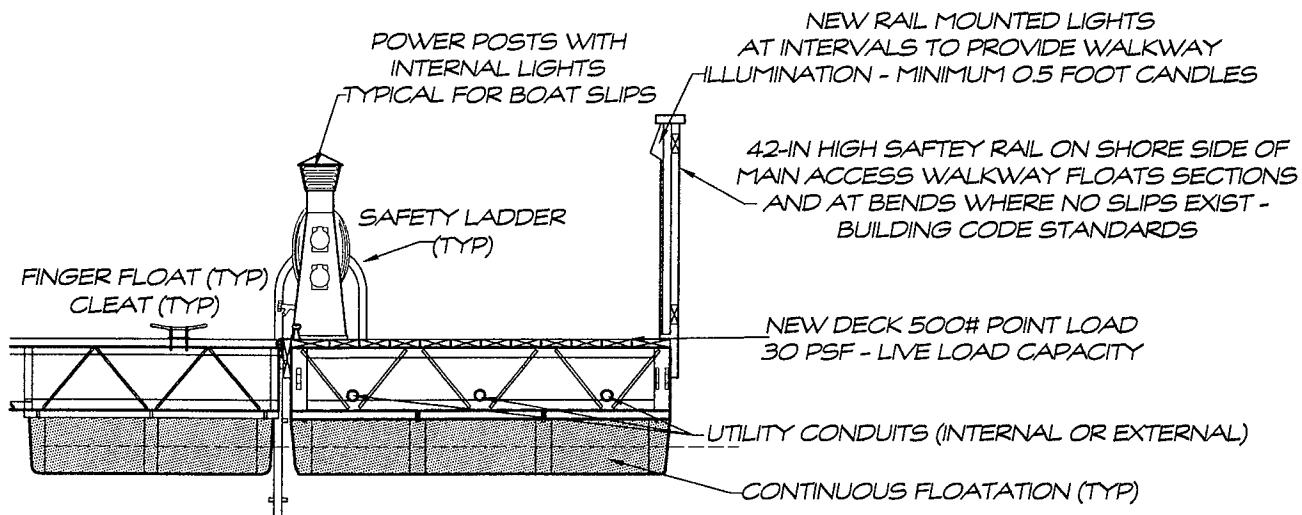

UTILITIES & RAIL DETAILS

GRAPHIC SCALE 1" = 3'

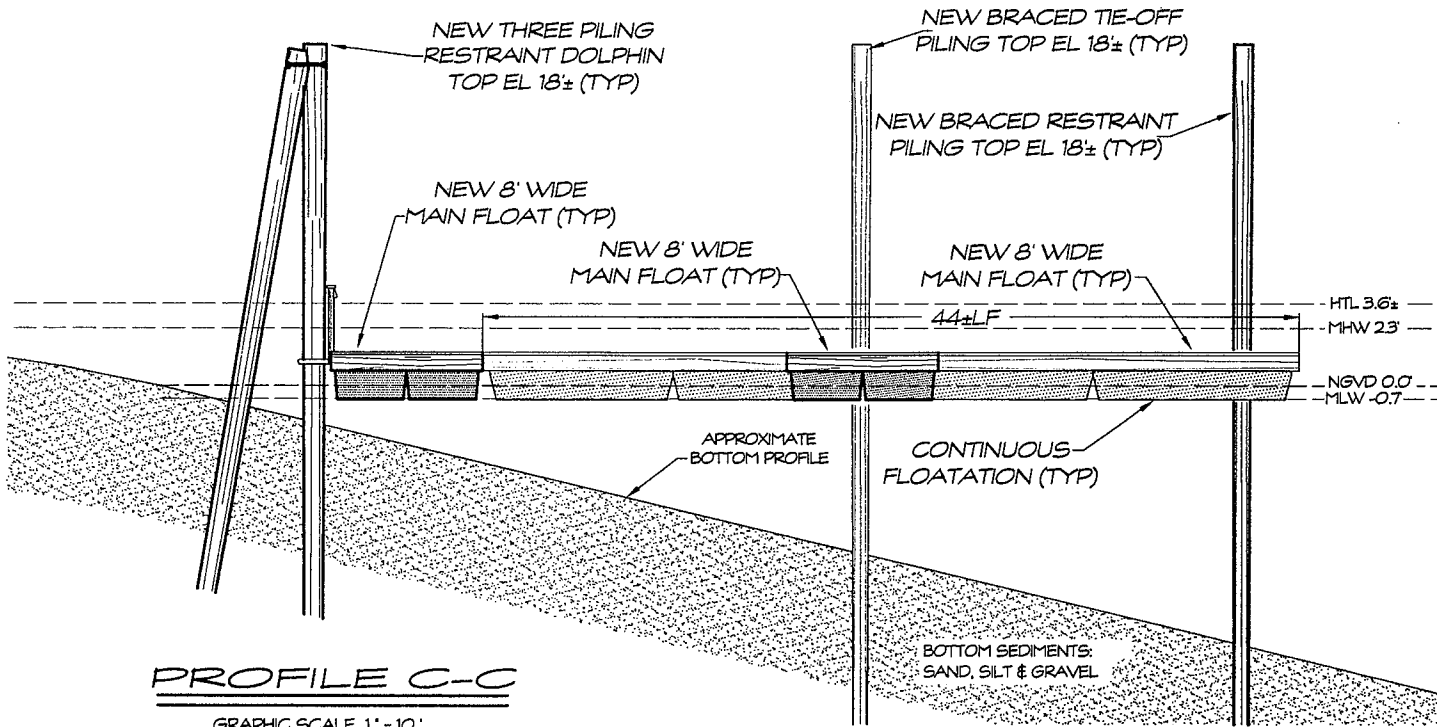
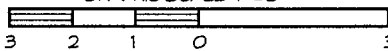

PROFILE C-C

GRAPHIC SCALE 1" = 10'



PROJECT: NEW DOCK FACILITY

LOCATION: CITY OF NORWICH
NEW LONDON COUNTY, CONNECTICUT

WATERWAY: THAMES RIVER

DATE: DECEMBER 20, 2005

APPLICANT: 190 SOUTH THAMES STREET LLC

AGENT: SHEET 7 OF 7

DOCKO, INC.

Keith B. Nelson, PE
Mystic, CT 06355
860 572 8939 FAX 860 572 7569
EMAIL: docko@snet.net

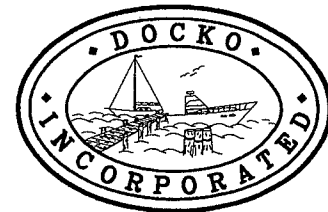

DWG 04-11-1637

