

*Safety is a Part of Your Contract*

NOTE: DRAWING REDUCED TO ONE HALF SCALE

TABULATION OF BENCH MARKS		
B.M. (Sta. No.)	El. M.S.L.	DESCRIPTION
M.R.-6.0 STA. 780+00 LEVEE STA. 712+50 (1970)	8.657	Mark is top of bronze disc set on 1-inch iron pipe driven in ground on South Bank Miss. River Gulf Outlet, 850 feet South of Miss. River Gulf Outlet Bank Line.
M.R.-6.0 STA. 336+00 LEVEE STA. 330+00 (1970)	9.708	Mark is top of bronze disc set on 1-inch iron pipe driven in ground on South Bank Miss. River Gulf Outlet, 780 feet South of Miss. River Gulf Outlet Bank Line.
1039+00 (1970)	6.166	Mark is top of bronze disc set on 1-inch iron pipe driven in ground 400 feet Right of Levee E Sta. 1039+00. Approx. 50 feet Back of Drainage Canal.

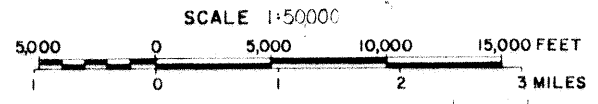

**GENERAL NOTES:**

- All elevations are in feet and refer to Mean Sea Level except for Logs of Borings from M.R.-6.0
- Logs of undisturbed borings (⊙) are not shown on drawings but are available for inspection at the Corps of Engineers District Office in New Orleans, La.
- Miss. River - Gulf Outlet Boring Logs B-D thru E-D located on Days 2 thru 4, are shown on Day 7.
- Soil borings I-C thru H-C are 1 1/2" ID core barrel general type borings.
- Drainage canal EI-8.0 soundings were taken on 12-22-69 and 2-24-69.
- The contractor shall perform his operations in such a manner as not to interfere with the operations of the adjoining contract for levee work (Levee Sta. 995+00 - M.R.-G.O. Sta. 1000+84) and along the effluent retaining dike separating the ponding areas.

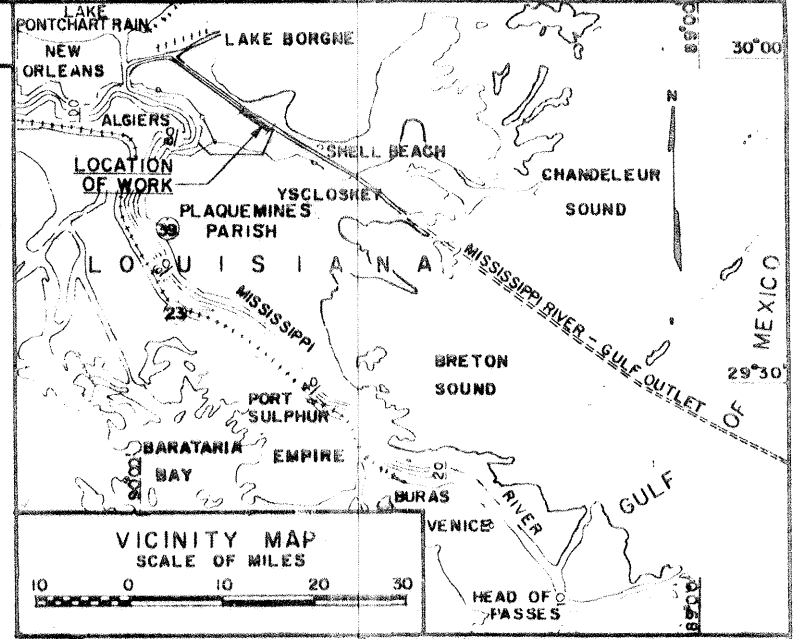

REVISION	DATE	DESCRIPTION	BY
1	5/15/70	Rev. levee sta, note file block, deleted maint. dredging - Amend #2	E.M.
DESIGNED:	DRAWN:	CHECKED:	U.S. ARMY ENGINEER DISTRICT, NEW ORLEANS
RPL	CT	RPL	CORPS OF ENGINEERS NEW ORLEANS, LA.
SUBMITTED:			LAKE PONTCHARTRAIN AND VICINITY
DATE: APRIL 1970			CHALMETTE AREA PLAN CHALMETTE EXTENSION
APPROVED:			HURRICANE PROTECTION LEVEE
APPROVED:			FIRST LIFT STA. 770+00 - STA. 995+00
APPROVED:			ST. BERNARD PARISH, LA.
APPROVED:			H-8-24937
APPROVED:			SCALE: SHOWN
APPROVED:			SPRC NO. DACW29-70-B-0181
APPROVED:			DWG. NO. 1 OF 7

**Safety is a Part of Your Contract**

**NOTE: DRAWING REDUCED TO ONE HALF SCALE**

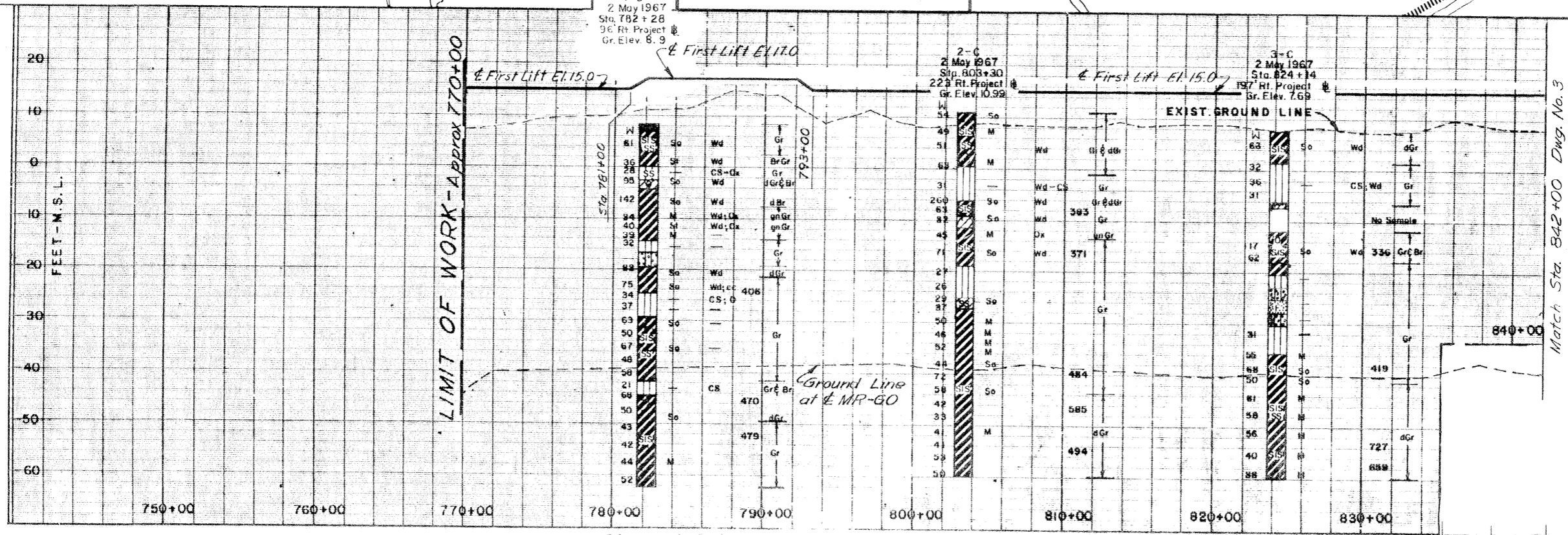
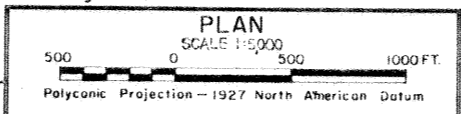
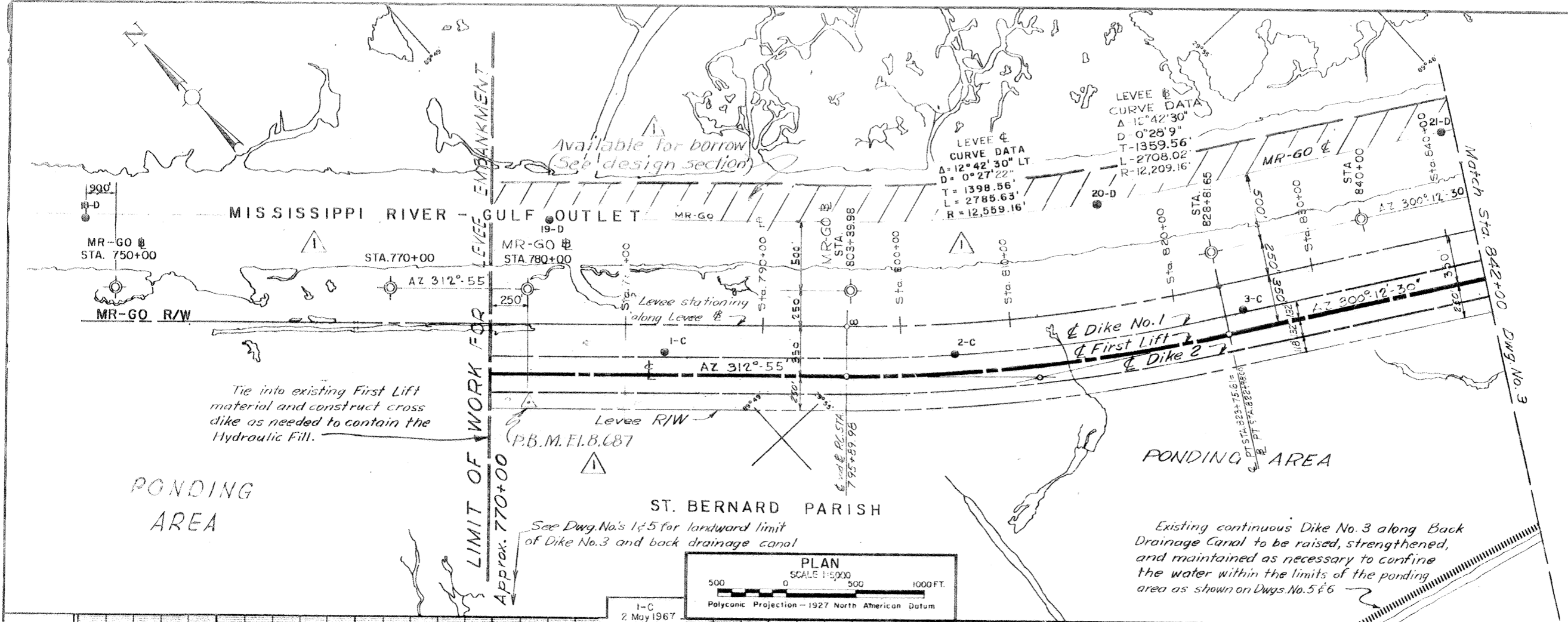

**NOTE:**  
 1. For general notes, see dwg. 1.  
 2. ● Location of General Type Spring

REVISION	DATE	DESCRIPTION	BY
1	5/15/70	Rev. P.B.M. D., deleted maint. dredging added borrow area. Amend #2	E.M.
DESIGNED BY:	DRAWN BY:	CHECKED BY:	CODE IDENT. NO.:
RPL	CT	RPL	
H-8-24937			
DATE: APRIL 1970		SCALE: SHOWN	SPEC. NO. DACW29-70-B-0181
		DWG. NO. 2	OF 7

*Safety is a Part of Your Contract*

**NOTE: DRAWING REDUCED TO ONE HALF SCALE**

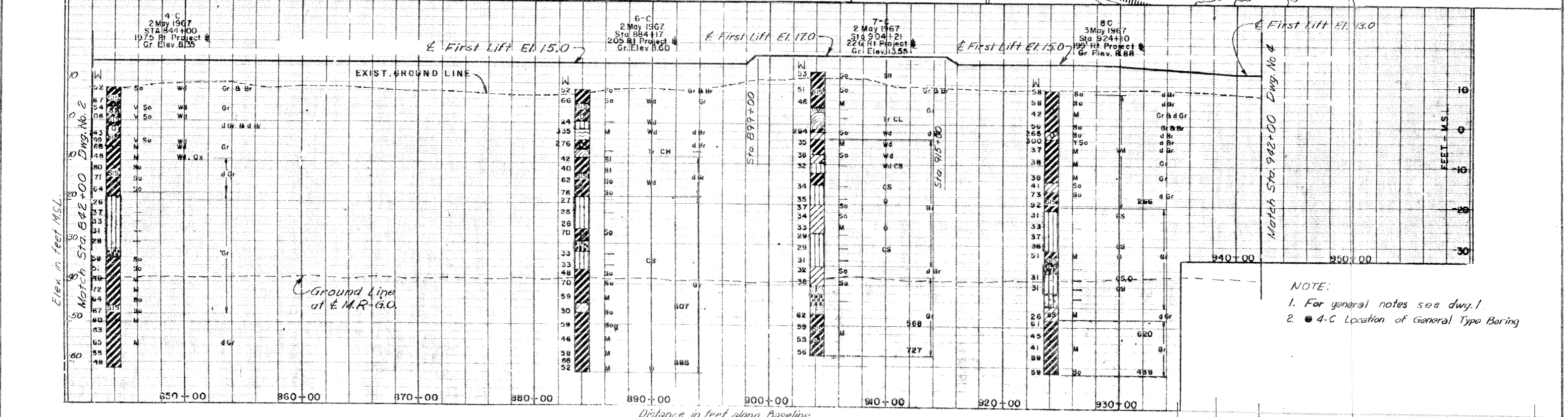
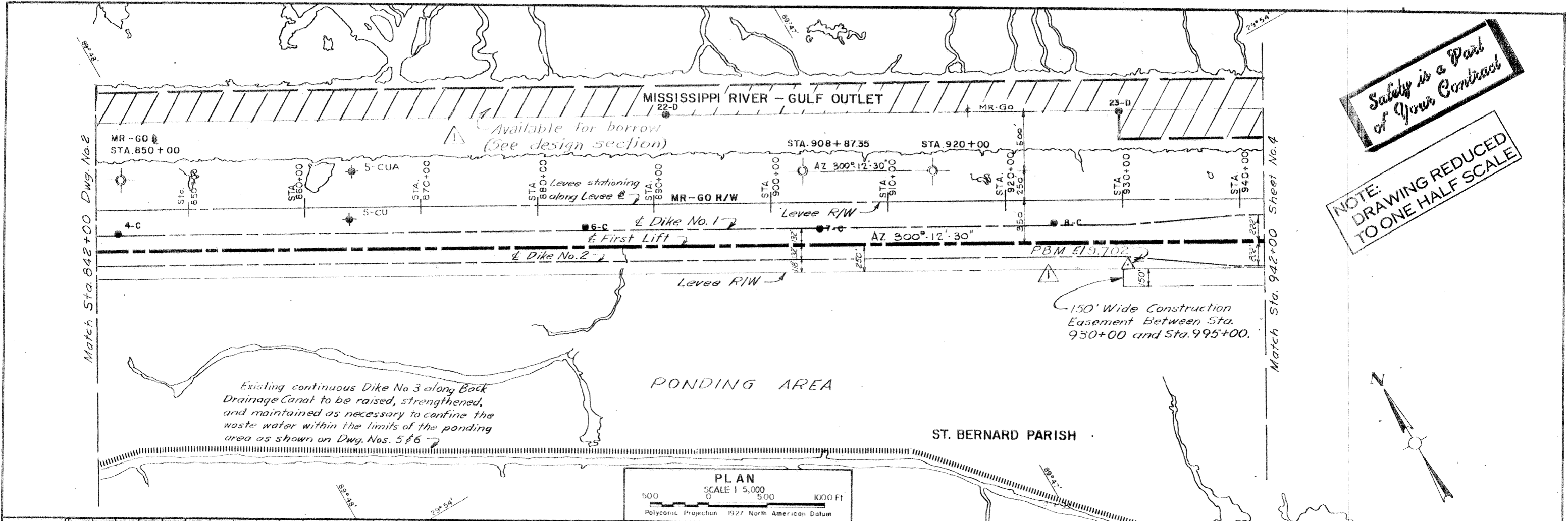

**NOTE:**  
 1. For general notes see dwg. 1.  
 2. 4-C Location of General Type Boring

REVISION	DATE	DESCRIPTION	BY
1	5/15/70	Rev. P.B.M.EI., deleted maint. dredging added borrow area, Amend. #2	EM
DESIGNED BY	DRAWN BY	CHECKED BY	CODE IDENT NO.
RPL	CT	RPL	
DATE: APRIL 1970			FILE NO.
			H-8-24937

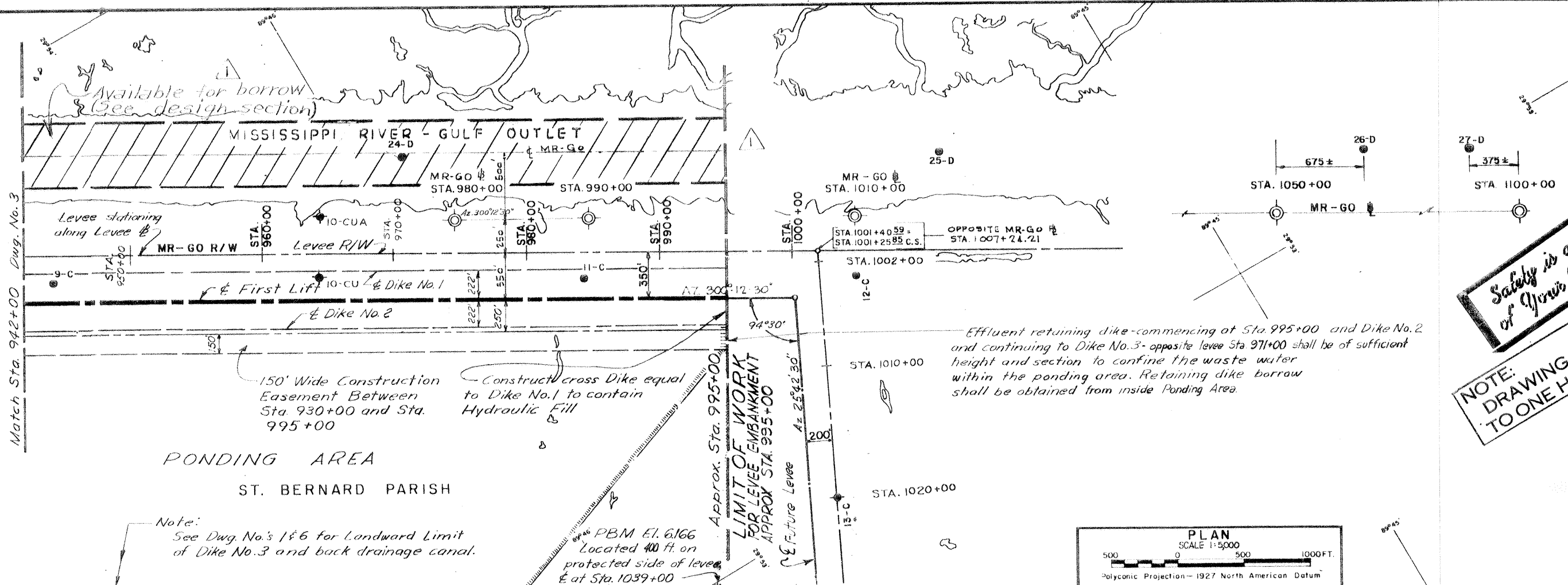

**Safety is a Part of Your Contract**

**NOTE: DRAWING REDUCED TO ONE HALF SCALE**

Note: See Dwg. No.'s 1 & 6 for Landward Limit of Dike No.3 and back drainage canal.

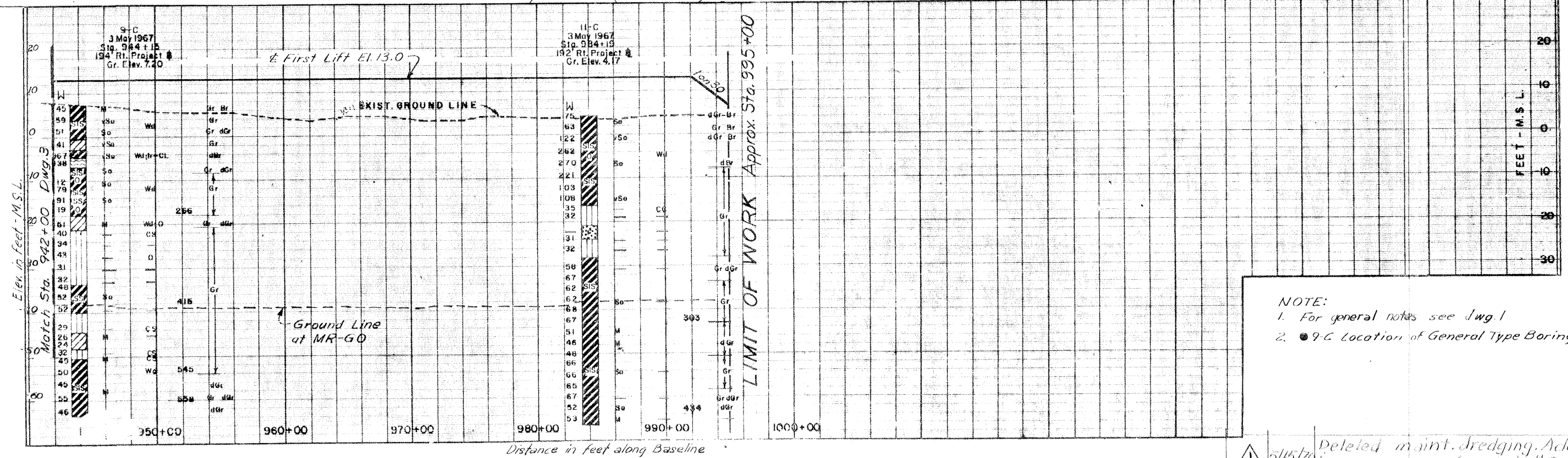
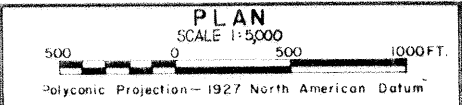

NOTE:  
 1. For general notes see Dwg. 1  
 2. 9-C Location of General Type Boring

REVISION	DATE	DESCRIPTION	BY
1	5/15/70	Deleted maint. dredging. Added borrow area - Amend. #2	E.M.
DESIGNED BY	DRAWN BY	CHECKED BY	CODE IDENT. NO.
RPL	CT	RPL	H-8-24937
DATE	APRIL 1970	SCALE	SHOWN
SPEC. NO.	DACW 29-70-B-0181	DWG. NO.	4 OF 7

**Safety is a Part of Your Contract**

**NOTE: DRAWING REDUCED TO ONE HALF SCALE**

Monumental baseline referred to MR-G.O. Centerline Stationing

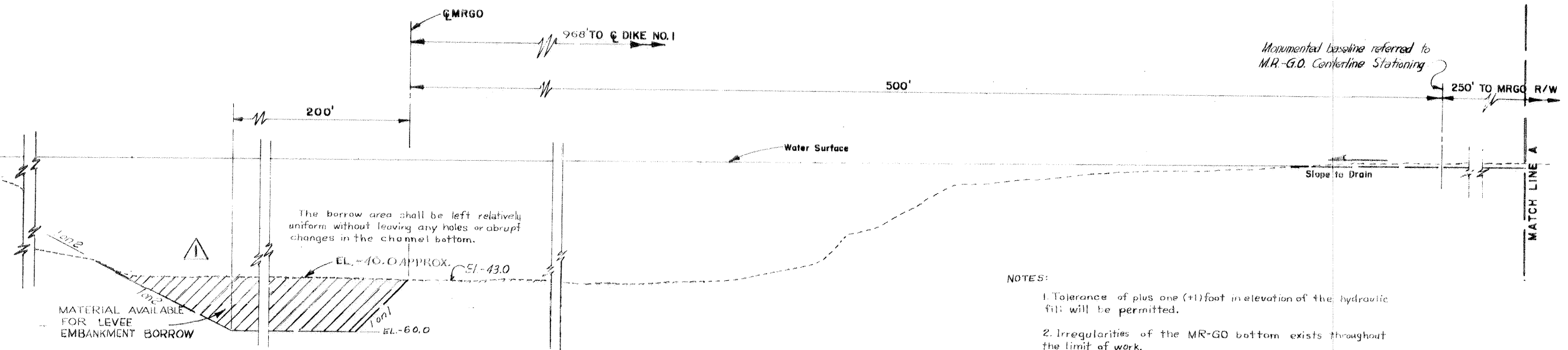

The borrow area shall be left relatively uniform without leaving any holes or abrupt changes in the channel bottom.

MATERIAL AVAILABLE FOR LEVEE EMBANKMENT BORROW

**NOTES:**

1. Tolerance of plus one (+) foot in elevation of the hydraulic fill will be permitted.
2. Irregularities of the MR-GO bottom exists throughout the limit of work.
3. In areas where the existing spoil, at Dikes Nos. 1 and 2, is EL "B" or within 2 ft. of EL "B", the 2 ft. min. height dike will be required. In areas where the existing spoil, at Dikes Nos. 1 and 2, is 2 ft. below el. "B" or lower, the contractor may elect to construct the 2 ft. min. height dike or any higher dike up to the el. "B". This option will in no way relieve the contractor of constructing the hydraulic fill design section as shown and specified.

TABULATIONS OF ELEVATIONS			
Station to	Station	EL "A"	EL "B"
770+00	- 781+00	15.0	13.0
781+00	- 782+00	Transition	
782+00	- 792+00	11.0	15.0
792+00	- 793+00	Transition	
793+00	- 898+00	15.0	13.0
898+00	- 899+00	Transition	
899+00	- 915+00	11.0	15.0
915+00	- 916+00	Transition	
916+00	- 930+00	15.0	13.0

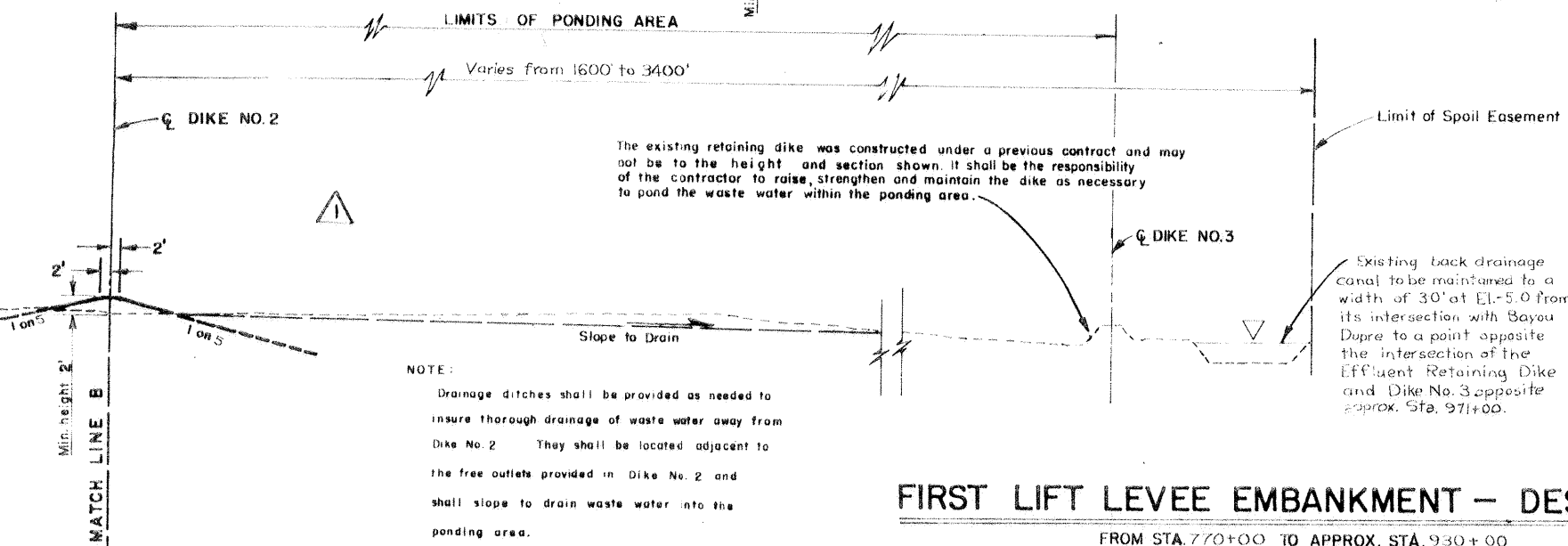
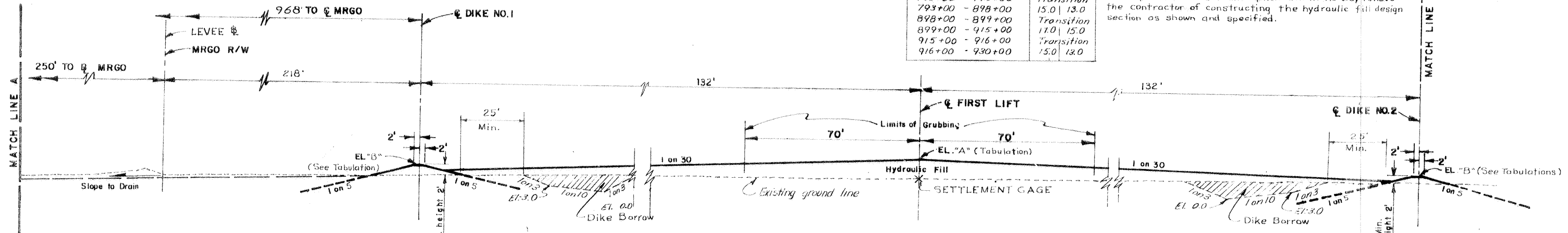

The existing retaining dike was constructed under a previous contract and may not be to the height and section shown. It shall be the responsibility of the contractor to raise, strengthen and maintain the dike as necessary to pond the waste water within the ponding area.

Existing back drainage canal to be maintained to a width of 30' at EL -5.0 from its intersection with Bayou Dupre to a point opposite the intersection of the Effluent Retaining Dike and Dike No. 3 opposite approx. Sta. 971+00.

**NOTE:**  
 Drainage ditches shall be provided as needed to insure thorough drainage of waste water away from Dike No. 2. They shall be located adjacent to the free outlets provided in Dike No. 2 and shall slope to drain waste water into the ponding area.

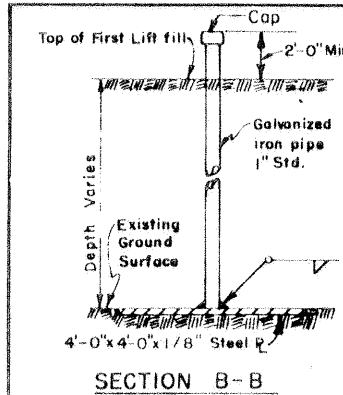

Settlement gages shall be installed at locations indicated below and as shown on the Levee Design Section. (See par. 162 of Sec. 3 of specs.). The Contractor may at his option install additional settlement gages. The length of the settlement measurement range for any additional settlement measurement gage shall not exceed 500 feet and shall extend for a maximum distance of 250 feet on each side of the settlement measurement gage, measured along the centerline of the embankment, except where settlement gages are placed at less than 500 foot intervals, in which case, the settlement measurement range shall be to a point 1/2 the distance between settlement gages.

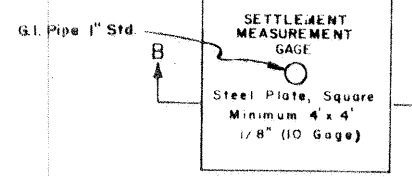

Install gage with riser pipe at stations 860+00, 870+00, & 880+00. All other gages may be installed without riser pipes.

SETTLEMENT MEASUREMENT GAGE

**FIRST LIFT LEVEE EMBANKMENT - DESIGN SECTION**

FROM STA. 770+00 TO APPROX. STA. 930+00  
 Smooth Transition From Sta. 930+00 to 940+00  
 Not to Scale

REVISION		DATE	CHECKED BY	LODGE NO.	SIZE	FILE NO.	BY
DESIGNED BY		DRAWN BY	CHECKED BY	LODGE NO.	SIZE	FILE NO.	BY
RPL		C.T.	RPL			H-8-24937	
DATE: 10/11/1970		SCALE AS SHOWN		SPEC. NO. 100-101		DRAWN BY: E.M.	

**NOTE:  
DRAWING REDUCED  
TO ONE HALF SCALE**

**Safety is a Part  
of Your Contract**

Monumented baseline referred to  
M.R.-G.O. Centerline Stationing

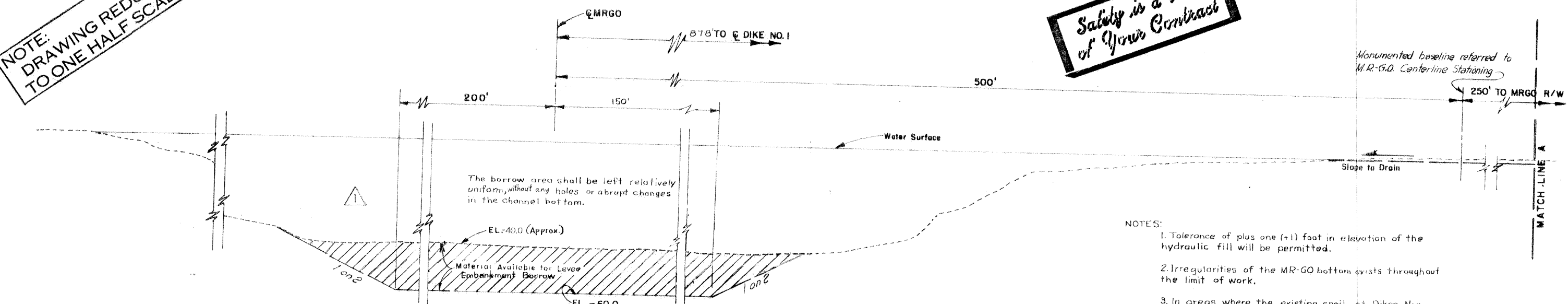

- NOTES:
1. Tolerance of plus one (+1) foot in elevation of the hydraulic fill will be permitted.
  2. Irregularities of the MR-GO bottom exists throughout the limit of work.
  3. In areas where the existing spoil, at Dikes Nos. 1 and 2, is el. 6.0 or above, the 2 ft. min. height dike will be required. In areas where the existing spoil, at Dikes Nos. 1 and 2, is below el. 6.0, the contractor may elect to construct the 2 ft. min. height dike or any higher dike up to the el. shown. This option will in no way relieve the contractor of constructing the hydraulic fill design section as shown and specified.

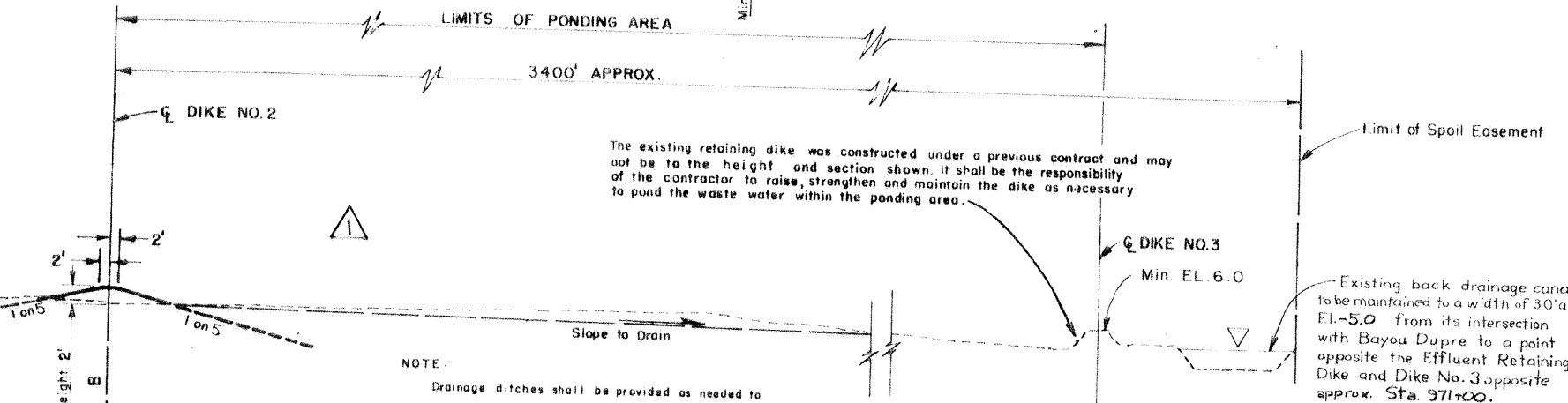
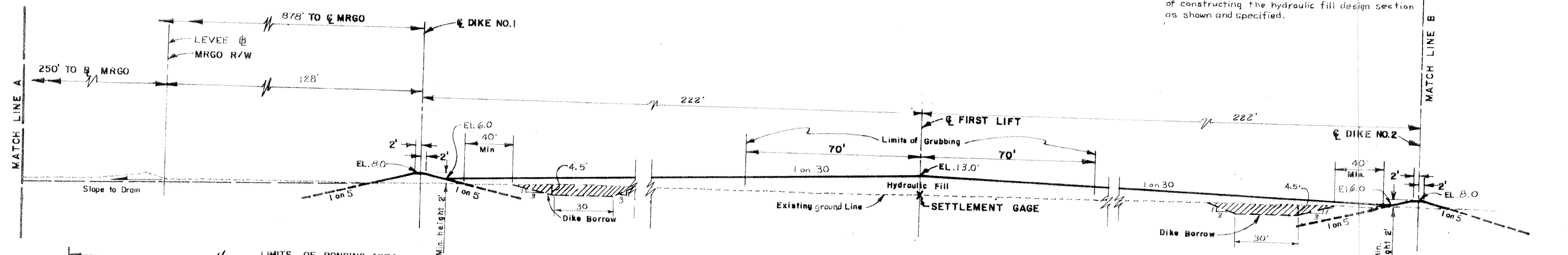

NOTE:  
Drainage ditches shall be provided as needed to insure thorough drainage of waste water away from Dike No. 2. They shall be located adjacent to the free outlets provided in Dike No. 2 and shall slope to drain waste water into the ponding area.

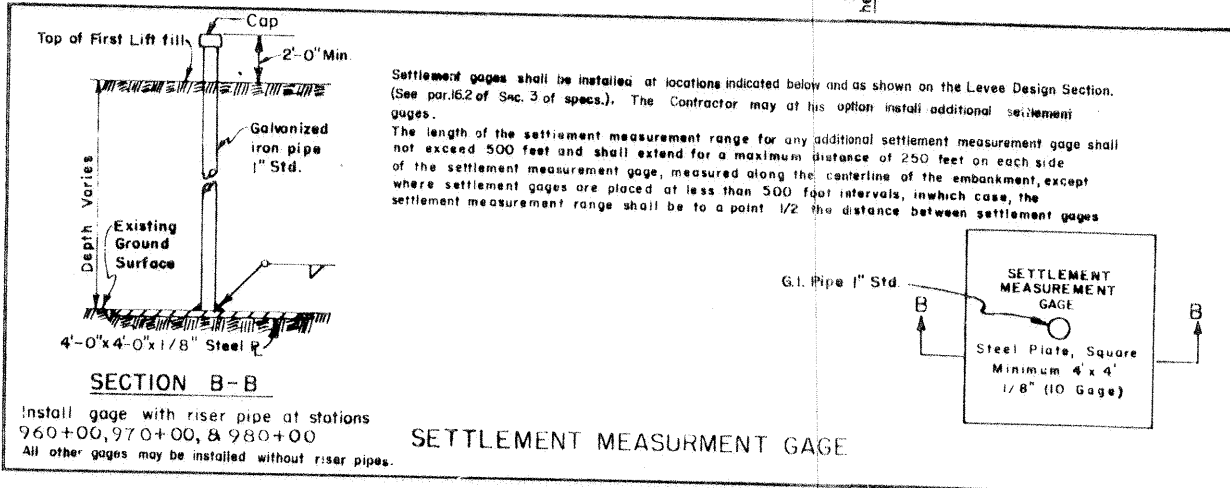

**FIRST LIFT LEVEE EMBANKMENT - DESIGN SECTION**  
FROM STA. 940+00 TO APPROX. STA. 995+00  
NOT TO SCALE

REVISION	DATE	CHECKED BY	CODE IDENT. NO.	SIZE	FILE NO.	BY
RPL.	CT.	RPL.				
5/15/70 Deleted maint. dredging - Amend. #2 EM						
H-8-24937						

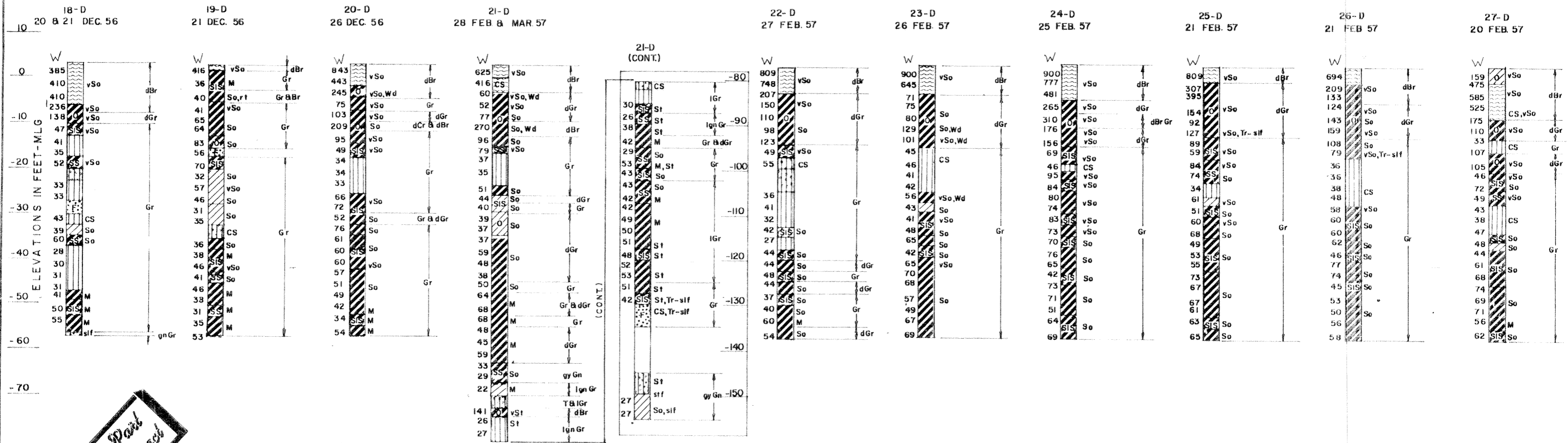

*Safety is a Part of Your Contract*

NOTE: DRAWING REDUCED TO ONE HALF SCALE

NOTE:

- Elevations refer to Mean Low Gulf Datum (M.L.G.) for above Borings.
- For location of Borings 18-D and 27-D see Dwg. 2 thru 4.
- See drawing file No. 2-21800 for soil boring legend.
- These borings were taken prior to construction of the Mississippi River Gulf Outlet.

1 5/15/70 Added note #4 - Amend. #2		E.M.	
REVISION	DATE	DESCRIPTION	BY
DESIGNED BY:	DRAWN BY:	CHECKED BY:	CODE IDENT. NO. SIZE FILE NO.
RPL	CT	RPL	H-8-24937
DATE: APRIL 1970		SCALE: SHOWN	SPEC. NO. DACW29 70-B-0181 DWG. NO. 7 OF 7