

EAST BANK WALL LINE TABULATION			
P.I.	W/L STATION	AZIMUTH	DISTANCE
1	0+00.00	87° 41' 39"	72.00'
2	0+72.00	04° 47' 31"	636.77'
3	7+08.77	32° 18' 08"	34.32'
4	7+43.09	06° 18' 08"	144.00'
5	8+87.09	94° 18' 08"	29.00'
6	9+16.09	04° 18' 08"	48.22'
7	9+64.31	04° 18' 08"	41.00'
8	10+05.31	04° 18' 08"	64.50'
9	10+69.81	12° 62' 13"	50.00'
10	11+19.81		

WEST BANK WALL LINE TABULATION			
P.I.	W/L STATION	AZIMUTH	DISTANCE
1	0+00.00	243° 56' 47"	10.00'
2	0+10.00	274° 18' 08"	33.60'
3	0+43.60	04° 18' 08"	106.10'
4	1+49.70	10° 18' 08"	93.40'
5	2+43.10	100° 18' 08"	4.00'
6	2+47.10	10° 18' 08"	30.00'
7	2+77.10	280° 18' 08"	34.00'
8	3+11.10	02° 41' 29"	175.00'
9	4+86.10	345° 02' 02"	40.35'
10	5+26.45	04° 18' 08"	41.00'
11	5+67.45	04° 18' 08"	64.50'
12	6+31.95	23° 57' 06"	25.28'
13	6+57.23		

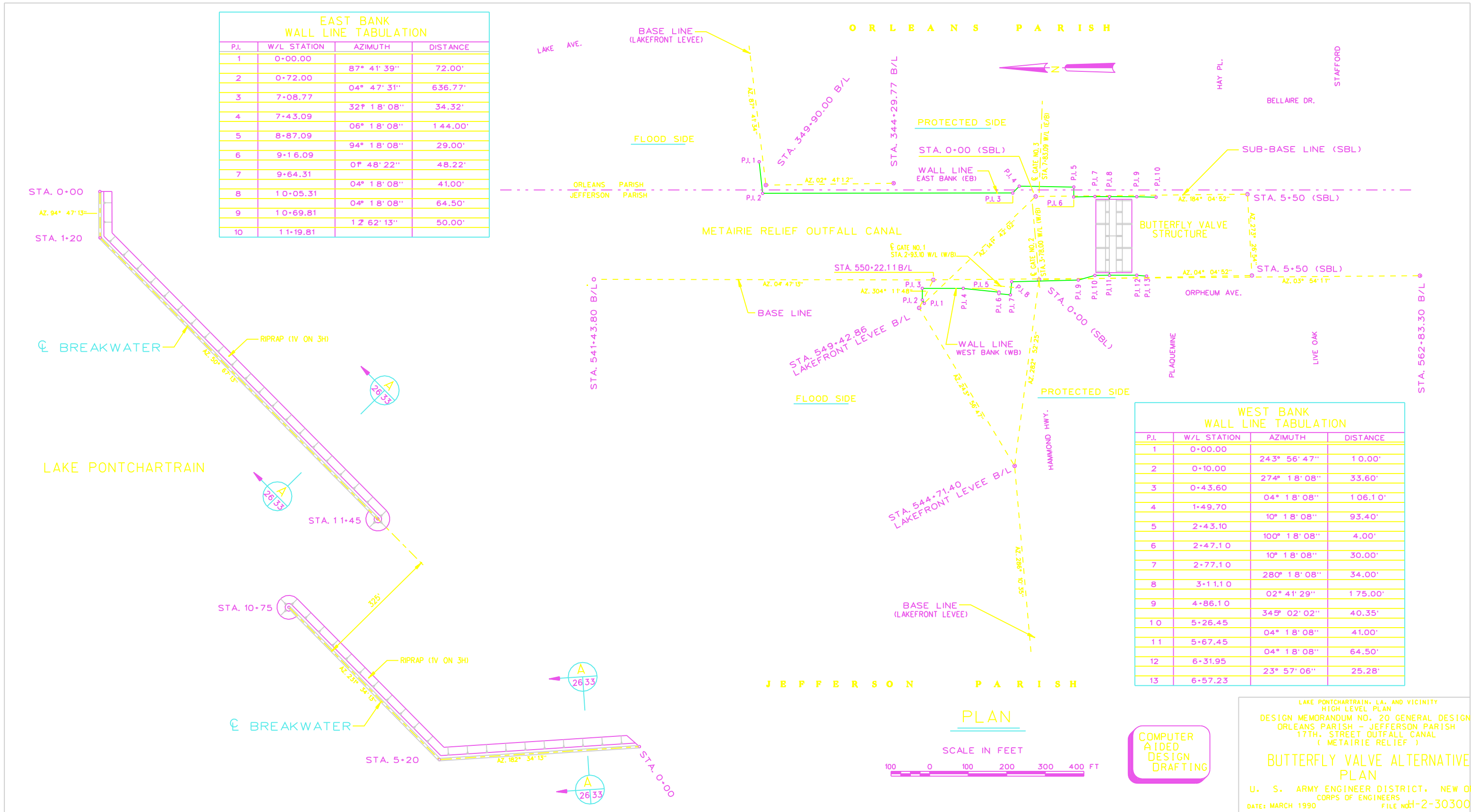

FILE NO. 303005A18.DGN  
 FORM SIZE 1200  
 DRAWN BY B.DORCEY

COMPUTER AIDED DESIGN DRAFTING

LAKE PONTCHARTRAIN, LA. AND VICINITY HIGH LEVEL PLAN  
 DESIGN MEMORANDUM NO. 20 GENERAL DESIGN  
 ORLEANS PARISH - JEFFERSON PARISH 17TH STREET OUTFALL CANAL (METAIRIE RELIEF)  
**BUTTERFLY VALVE ALTERNATIVE PLAN**  
 U. S. ARMY ENGINEER DISTRICT, NEW ORLEANS CORPS OF ENGINEERS  
 DATE: MARCH 1990 FILE NO. H-2-30300