

# Emergency Evacuation Procedures

## Environmental Education, Science, & Technology Building

### Severe Weather

In the event of severe weather, all building occupants should immediately seek shelter in the designated shelter-in-place area in the building. If unable to safely move to the designated shelter-in-place area, seek shelter in a windowless interior room or hallway on the lowest floor of the building.

**All building occupants should take shelter in the large classroom spaces on the first floor of the building.**

---

### Bomb Threat/Fire

In the event of a bomb threat or fire in the building, all building occupants should immediately evacuate the building using the nearest exit. Once outside, proceed to the designated assembly area. If unable to safely move to the designated assembly area, contact one or more members of your department or unit to let them know you are safe and inform them of your whereabouts.

Persons with mobility impairments who are unable to safely exit the building should move to a designated area of refuge and await assistance from emergency responders.

**All building occupants should immediately evacuate the building and proceed to parking lot 7 south of the building.**

# ENVIRONMENTAL SCIENCE BUILDING

BLDG # 0160  
10-2012

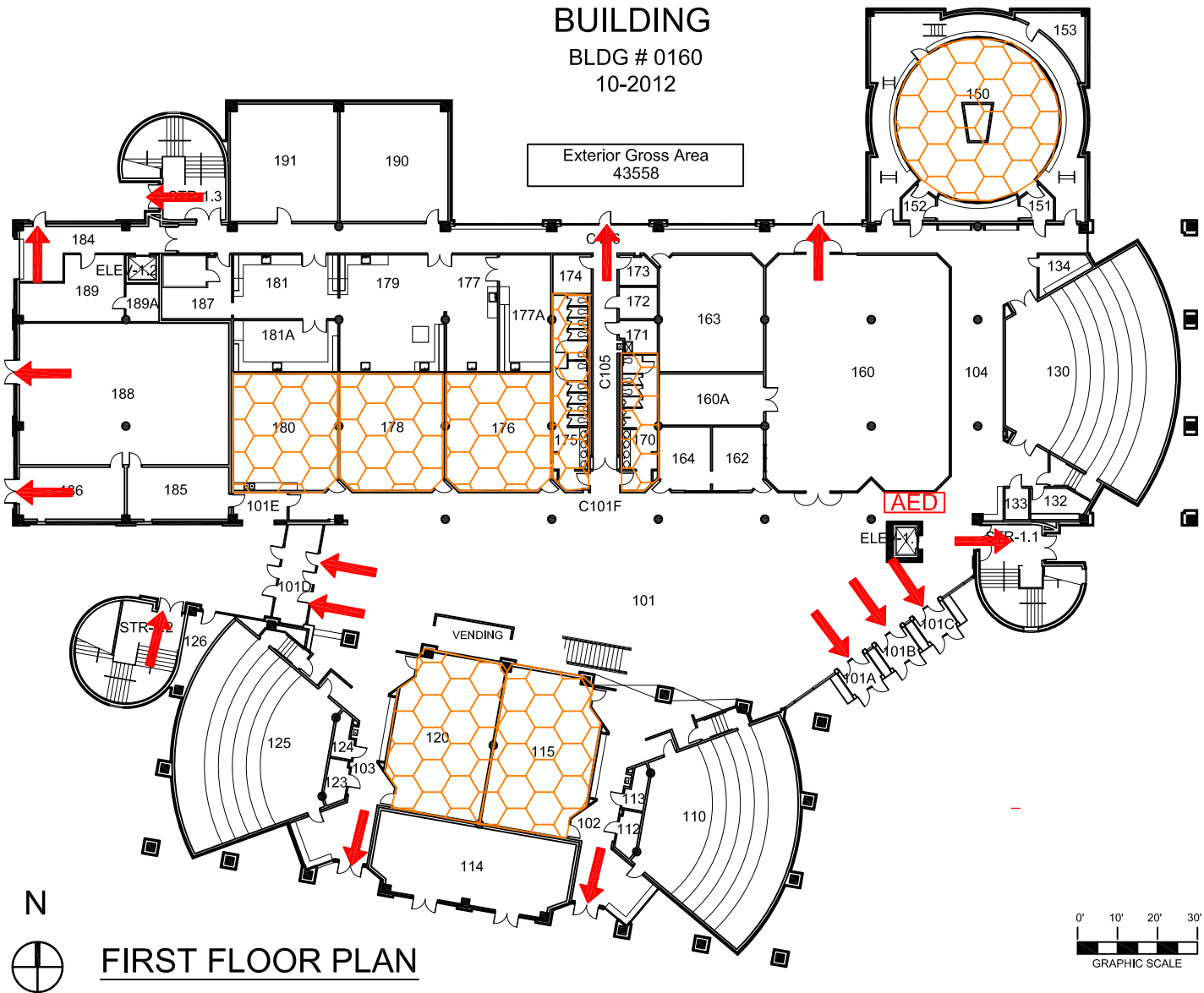

**Safety Legend**

- Areas of Refuge
- Tornado Shelter Areas
- Exit/Evacuation Routes
- In case of fire, do not use elevator*
- Automatic External Defibrillator
- Evacuation Chair

# ENVIRONMENTAL SCIENCE BUILDING

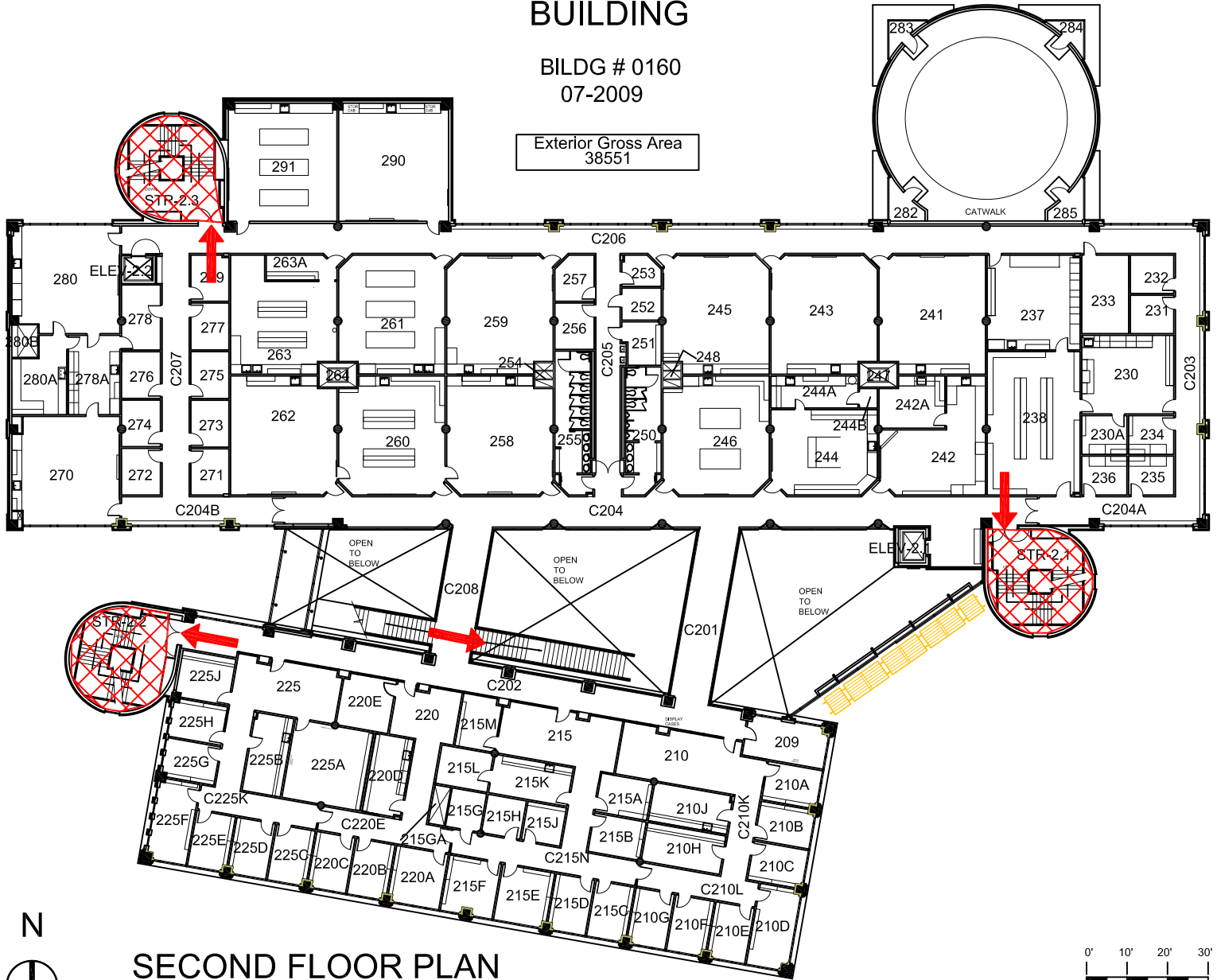

BILDG # 0160  
07-2009

Exterior Gross Area  
38551





## SECOND FLOOR PLAN

### Safety Legend

-  Areas of Refuge
-  Tornado Shelter Areas

 Exit/Evacuation Routes  
*In case of fire, do not use elevator*

-  Automatic External Defibrillator
-  Evacuation Chair

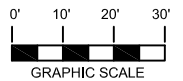

# ENVIRONMENTAL SCIENCE BUILDING



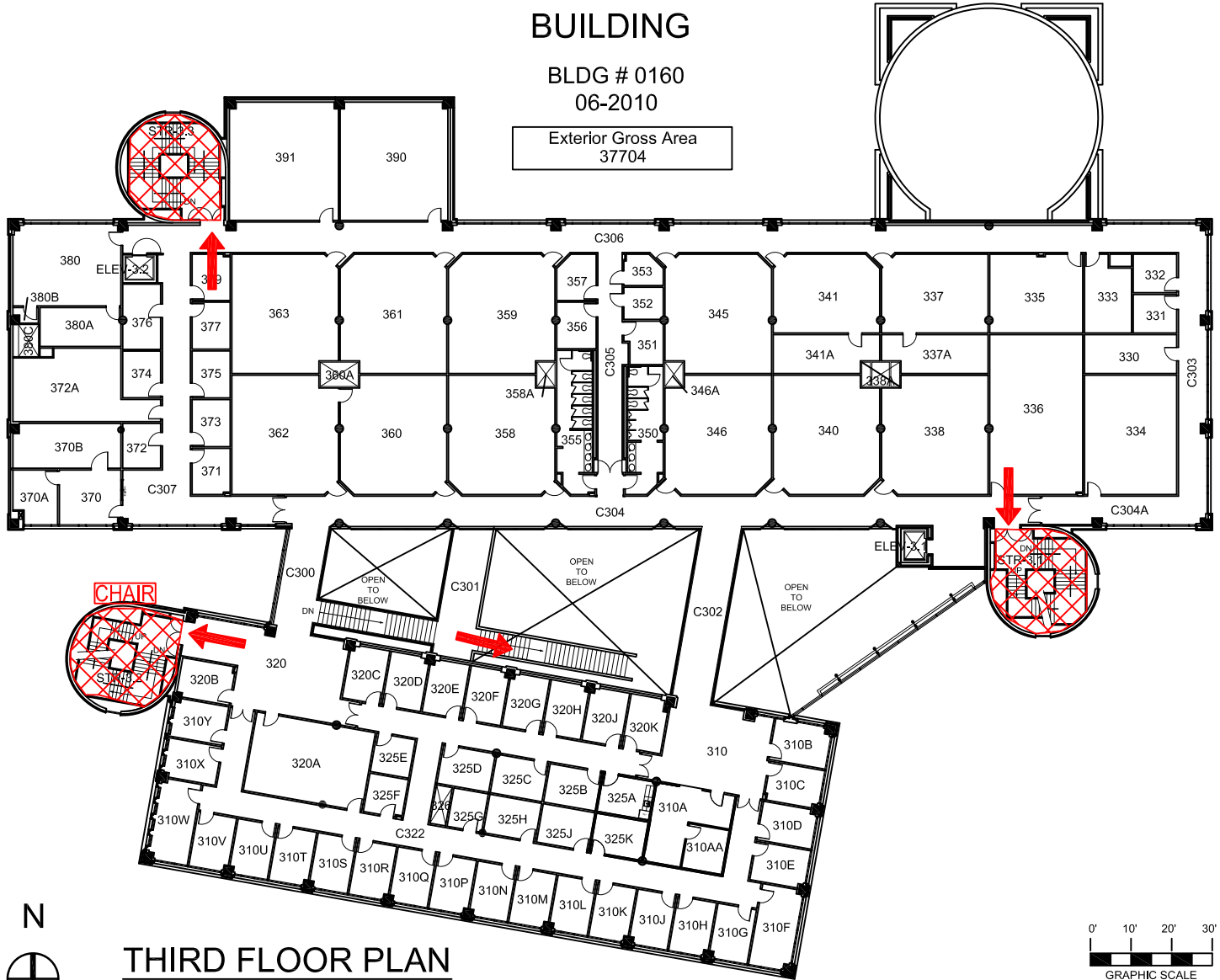

BLDG # 0160  
06-2010

Exterior Gross Area  
37704



**THIRD FLOOR PLAN**

**Safety Legend**

-  Areas of Refuge
-  Tornado Shelter Areas
-  Exit/Evacuation Routes
- In case of fire, do not use elevator*
-  Automatic External Defibrillator
-  Evacuation Chair