



DISCOVERY PARK 1ST FLOOR WALKING TRAIL

 NORTH TEXAS TRAIL: 2379 FT .45 MILES
COLUMNS #1.2.3.4.3.5.6.5.3.2.1

 MEAN GREEN TRAIL: 2404FT .45 MILES
COLUMNS #1.2.3.4 ↑ 10.9.8.7 ↓ 6.5.3.2.1

 GENERAL WALKING TRAIL PATH.
FOR MORE INFORMATION ON WALKING
PATH SEE INDIVIDUAL TRAIL.

 CENTER FOR STUDENT AFFAIRS

 FOR QUESTIONS ABOUT WALKING TRAIL,
EQUIPMENT RENTAL, OR EXTRA ACTIVITIES
PLEASE VISIT THE CSA MAIN OFFICE #G140

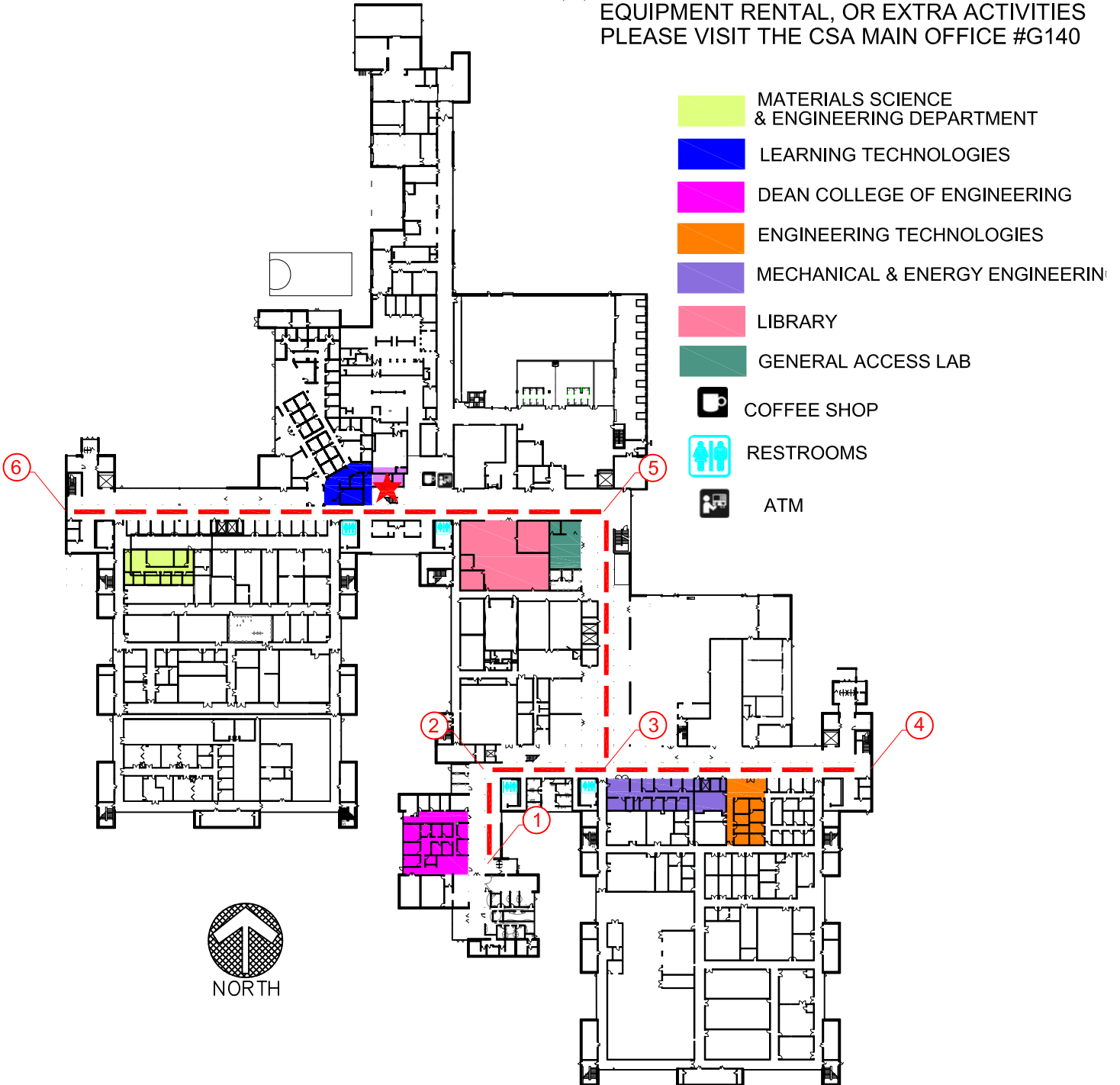

DISCOVERY PARK 2nd FLOOR WALKING TRAIL

 EAGLE TRAIL: 1513 FT .286 MILES
COLUMNS #10.9.8.7.8.9.10

 MEAN GREEN TRAIL: 2404FT .45 MILES
COLUMNS #1.2.3.4 ↑ 10.9.8.7 ↓ 6.5.3.2.1

 GENERAL WALKING TRAIL PATH.
FOR MORE INFORMATION ON WALKING
PATH SEE INDIVIDUAL TRAIL.

 FOR QUESTIONS ABOUT WALKING TRAIL,
EQUIPMENT RENTAL, OR EXTRA ACTIVITIES
PLEASE VISIT THE CSA MAIN OFFICE #G140

 COMPUTER SCIENCE AND ENGINEERING

 ELECTRICAL ENGINEERING

 DEAN OF INFORMATION

 LIBRARY AND INFORMATION SCIENCE

 CITC

 Restrooms

