

# Emergency Evacuation Procedures

## Life Sciences Complex

1511 W. Sycamore St. Denton, TX 76203

### Severe Weather

In the event of severe weather, all building occupants should immediately seek shelter in the designated shelter-in-place area in the building. If unable to safely move to the designated shelter-in-place area, seek shelter in a windowless interior room or hallway on the lowest floor of the building.

**All building occupants should take shelter on the first floor interior hallways, in the northeast stairwell and restrooms B191, B193 and B197. Avoid standing near windows, walls and doors made of glass.**

---

### Bomb Threat/Fire

In the event of a bomb threat or fire in the building, all building occupants should immediately evacuate the building using the nearest exit. Once outside, proceed to the designated assembly area. If unable to safely move to the designated assembly area, contact one or more members of your department or unit to let them know you are safe and inform them of your whereabouts.

Persons with mobility impairments who are unable to safely exit the building should move to a designated area of refuge and await assistance from emergency responders.

**All building occupants should immediately evacuate the building and proceed to the north area of the University Union**

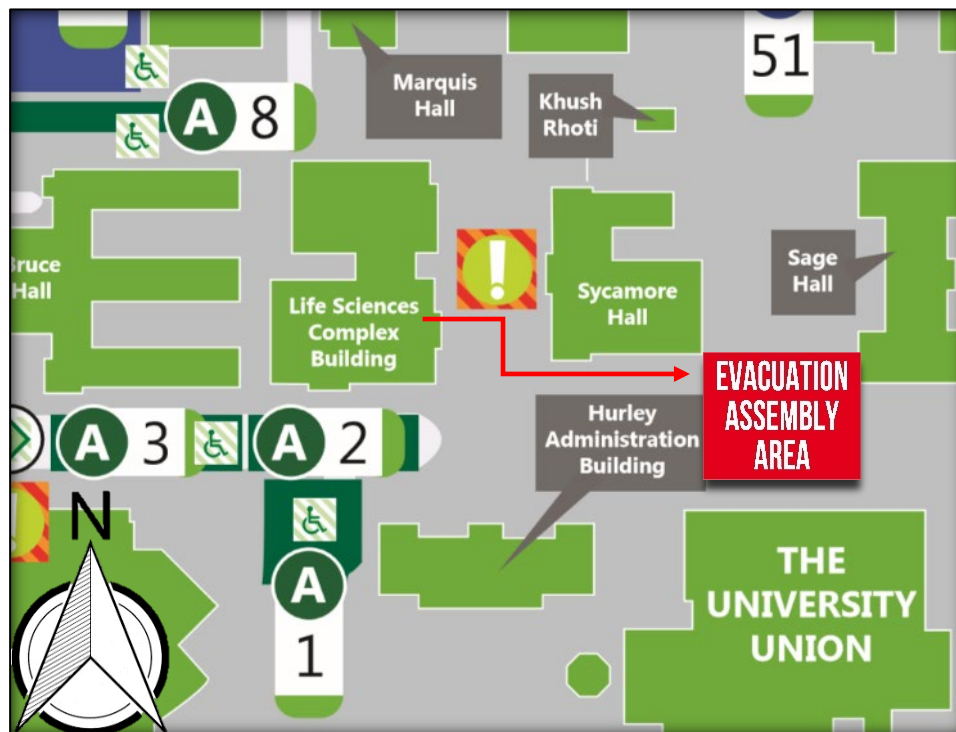

# LIFE SCIENCE COMPLEX

BLDG #0141

12-2014

Exterior Gross Area  
46406

## Safety Legend

 Areas of Refuge

 Tornado Shelter Areas

 Exit/Evacuation Routes  
*In case of fire, do not use elevator*

 Automatic External Defibrillator

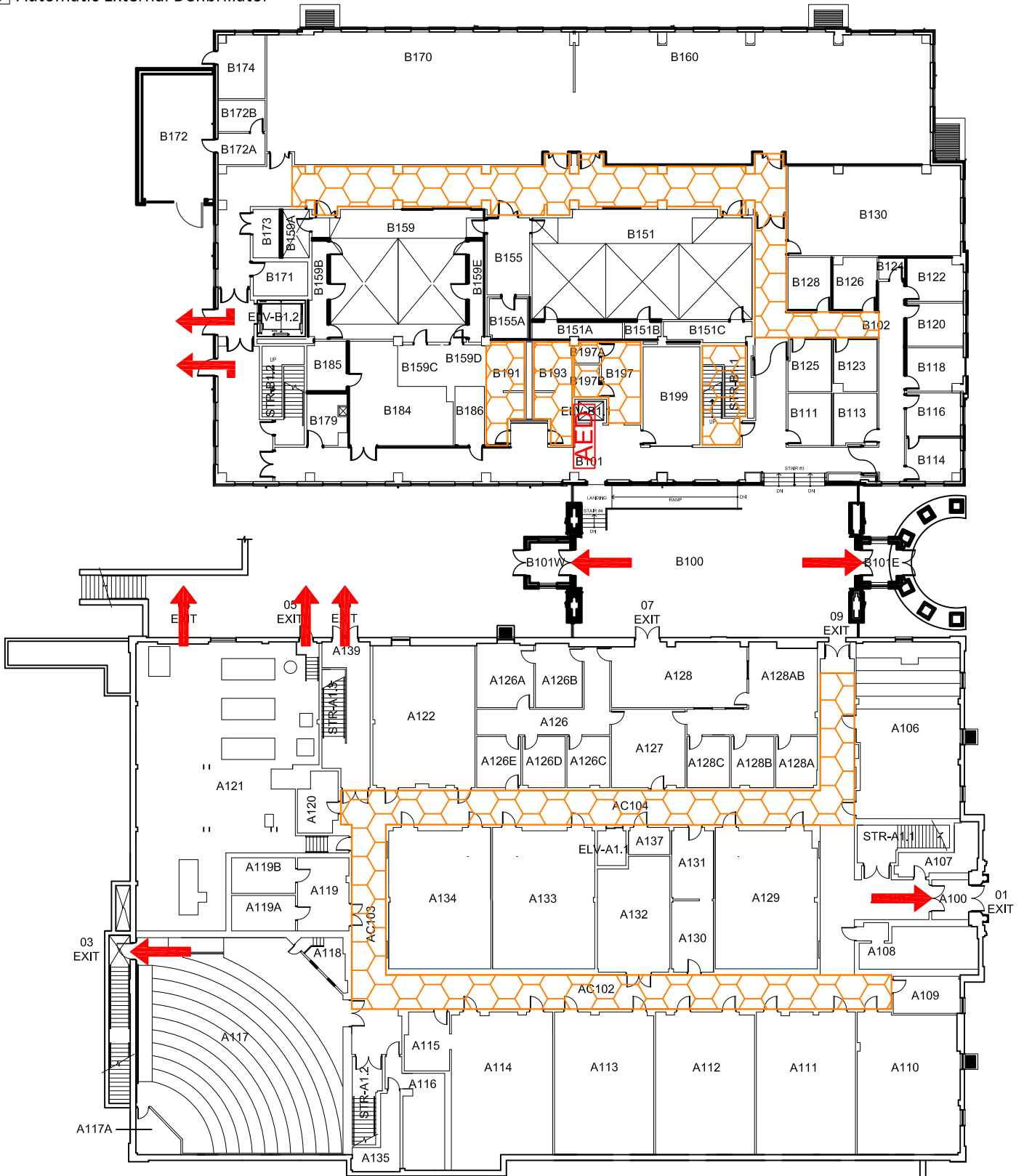

FIRST FLOOR PLAN

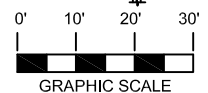

# LIFE SCIENCE COMPLEX

BLDG #0141

02-2017

## Safety Legend



Areas of Refuge



Tornado Shelter Areas



Exit/Evacuation Routes

*In case of fire, do not use elevator*

**AED** Automatic External Defibrillator

Exterior Gross Area  
43353

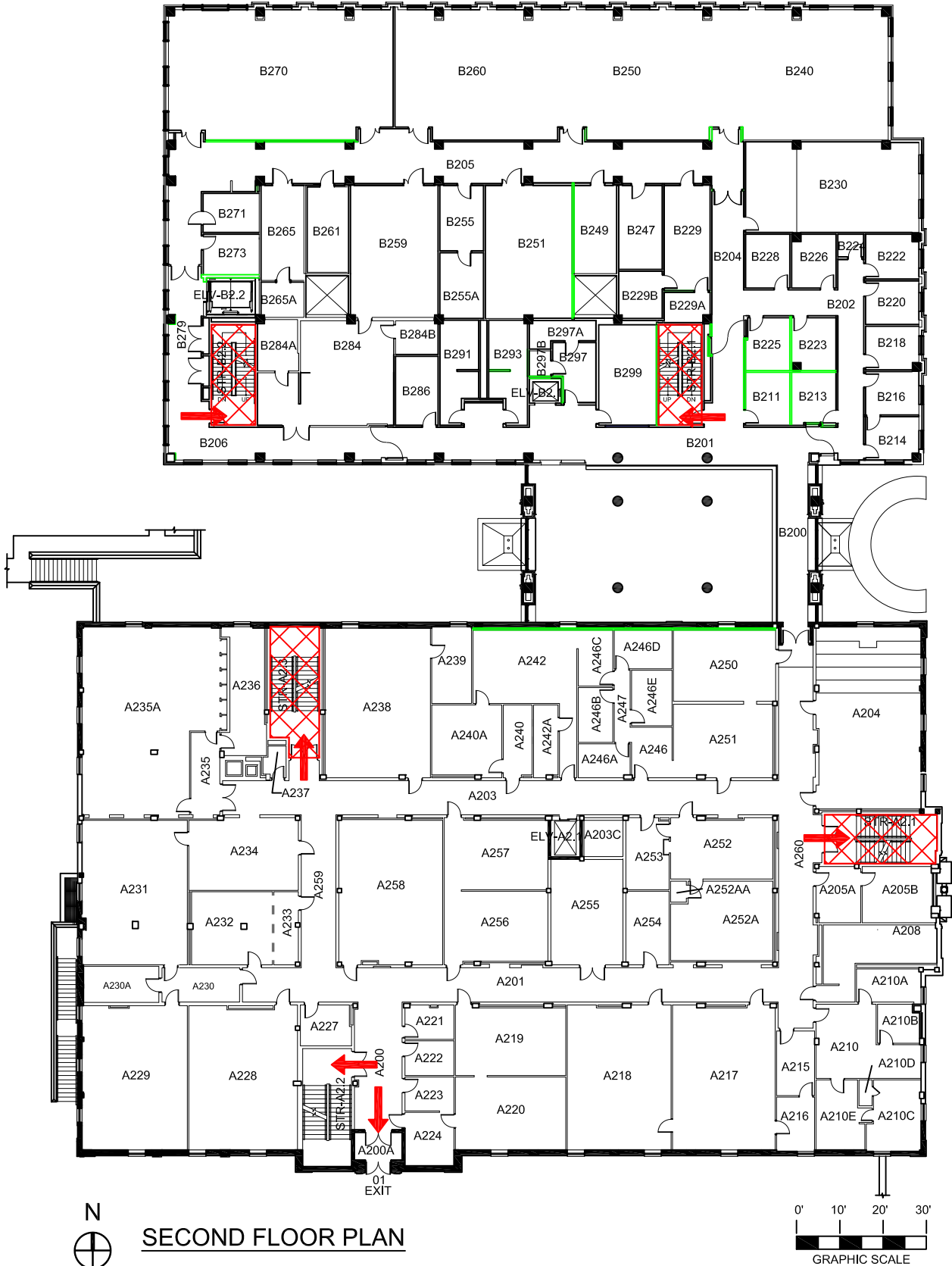

# LIFE SCIENCE COMPLEX

BLDG #0141

02-2016

## Safety Legend



Areas of Refuge



Tornado Shelter Areas



Exit/Evacuation Routes

*In case of fire, do not use elevator*

**AED** Automatic External Defibrillator

Exterior Gross Area  
43197



THIRD FLOOR PLAN

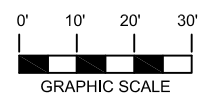





# LIFE SCIENCE COMPLEX

BLDG #0141

07-2014

## Safety Legend

 Areas of Refuge

 Tornado Shelter Areas

 Exit/Evacuation Routes

*In case of fire, do not use elevator*

 Automatic External Defibrillator

Exterior Gross Area  
9161

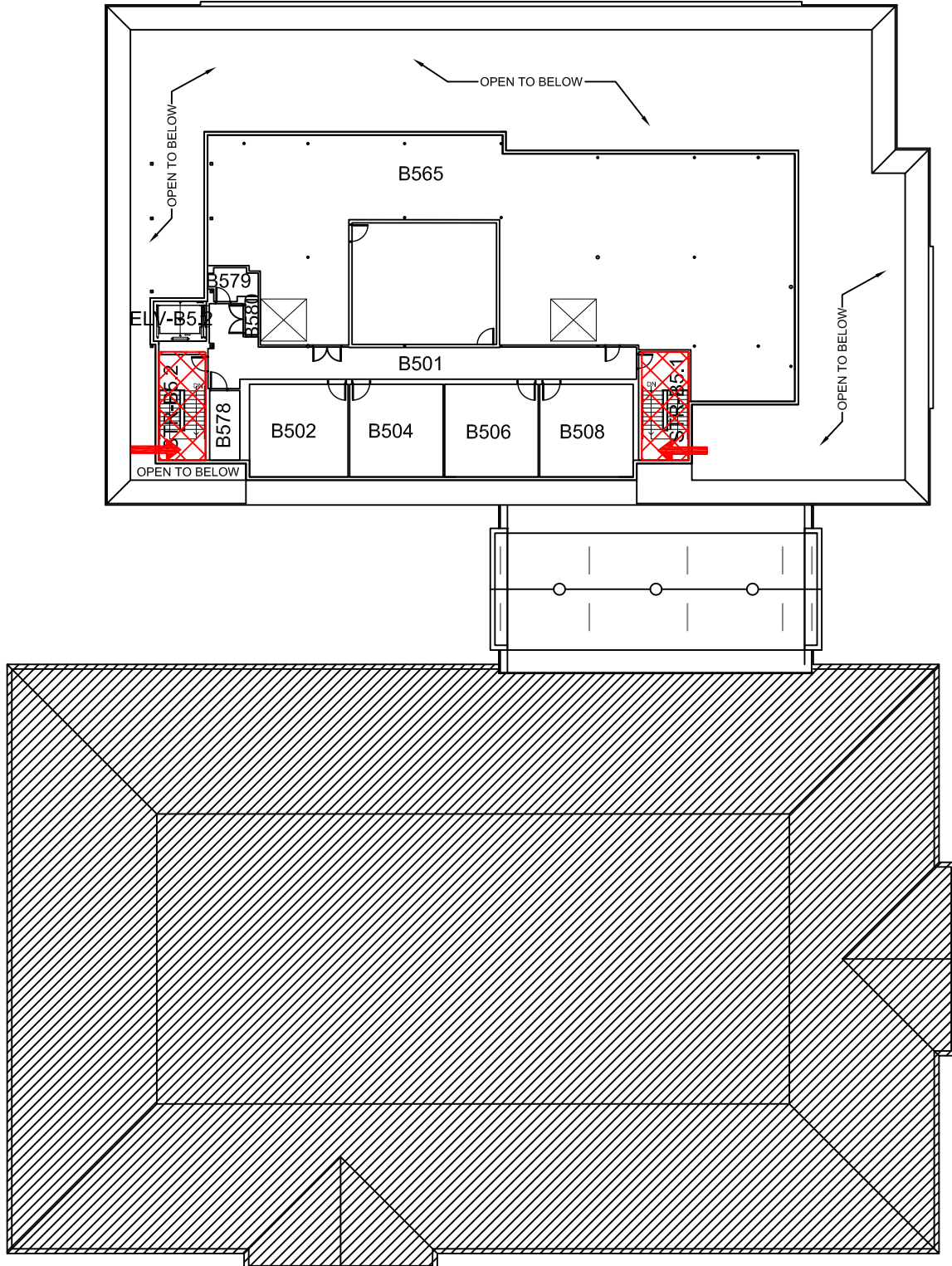

FIFTH FLOOR PLAN

