

Emergency Evacuation Procedures

Ken Bahnsen Gym

1908 W. Highland St. Denton, TX 76201

Severe Weather

In the event of severe weather, all building occupants should immediately seek shelter in the designated shelter-in-place area in the building. If unable to safely move to the designated shelter-in-place area, seek shelter in a windowless interior room or hallway on the lowest floor of the building.

All building occupants should take shelter in the interior hallway on the west side of the building outside of the weight room. Additional shelter is located in the tunnel hallway on the north side of the building. Avoid standing near windows, walls and doors made of glass.

Bomb Threat/Fire

In the event of a bomb threat or fire in the building, all building occupants should immediately evacuate the building using the nearest exit. Once outside, proceed to the designated assembly area. If unable to safely move to the designated assembly area, contact one or more members of your department or unit to let them know you are safe and inform them of your whereabouts.

Persons with mobility impairments who are unable to safely exit the building should move to a designated area of refuge and await assistance from emergency responders.

All building occupants should immediately evacuate the building and proceed to parking lot 26 east of the Ken Bahnsen Gym.

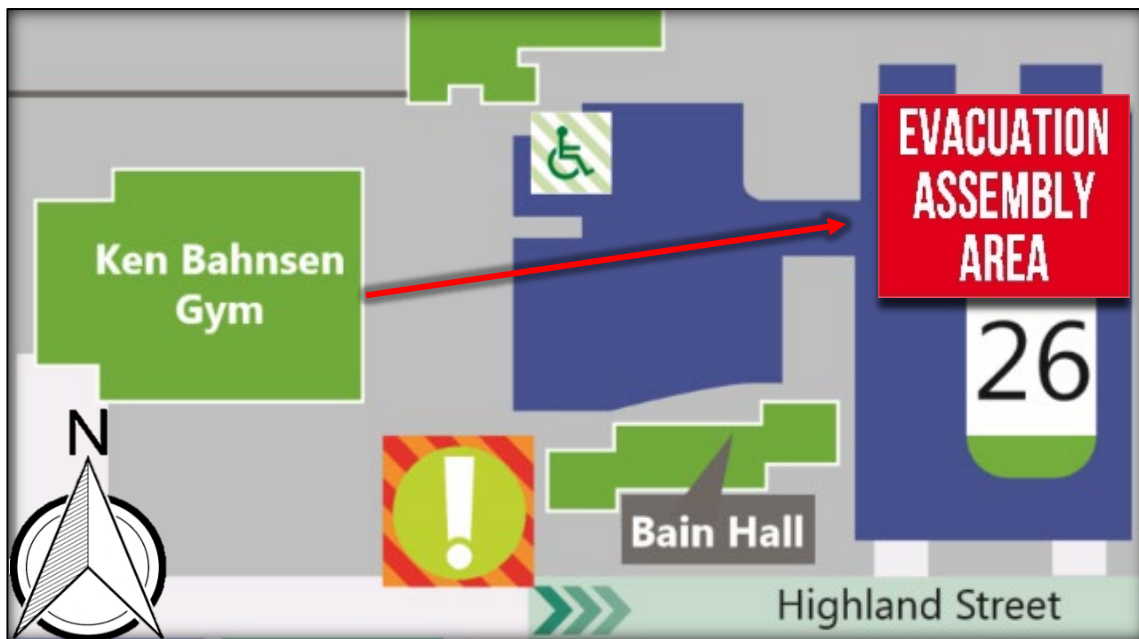

KEN BAHNSEN GYMNASIUM

BLDG #0116

12-2009

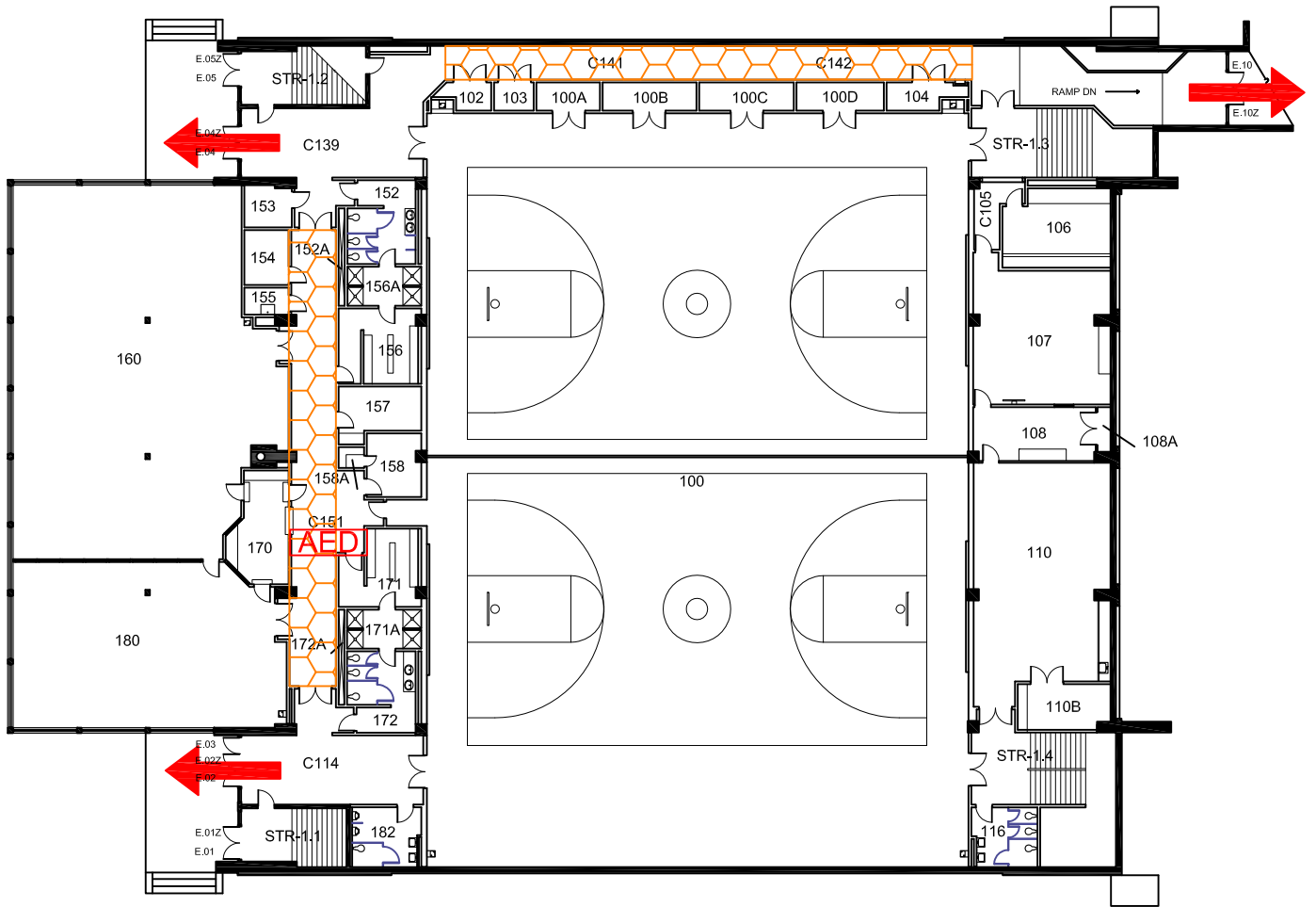

Exterior Gross Area
29287

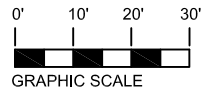

N
FIRST FLOOR PLAN



Safety Legend

-  Areas of Refuge
-  Tornado Shelter Areas
-  Exit/Evacuation Routes

In case of fire, do not use elevator

AED Automatic External Defibrillator

CHAIR Evacuation Chair

KEN BAHNSEN GYMNASIUM

BLDG #0116

06-2007

Exterior Gross Area
8546

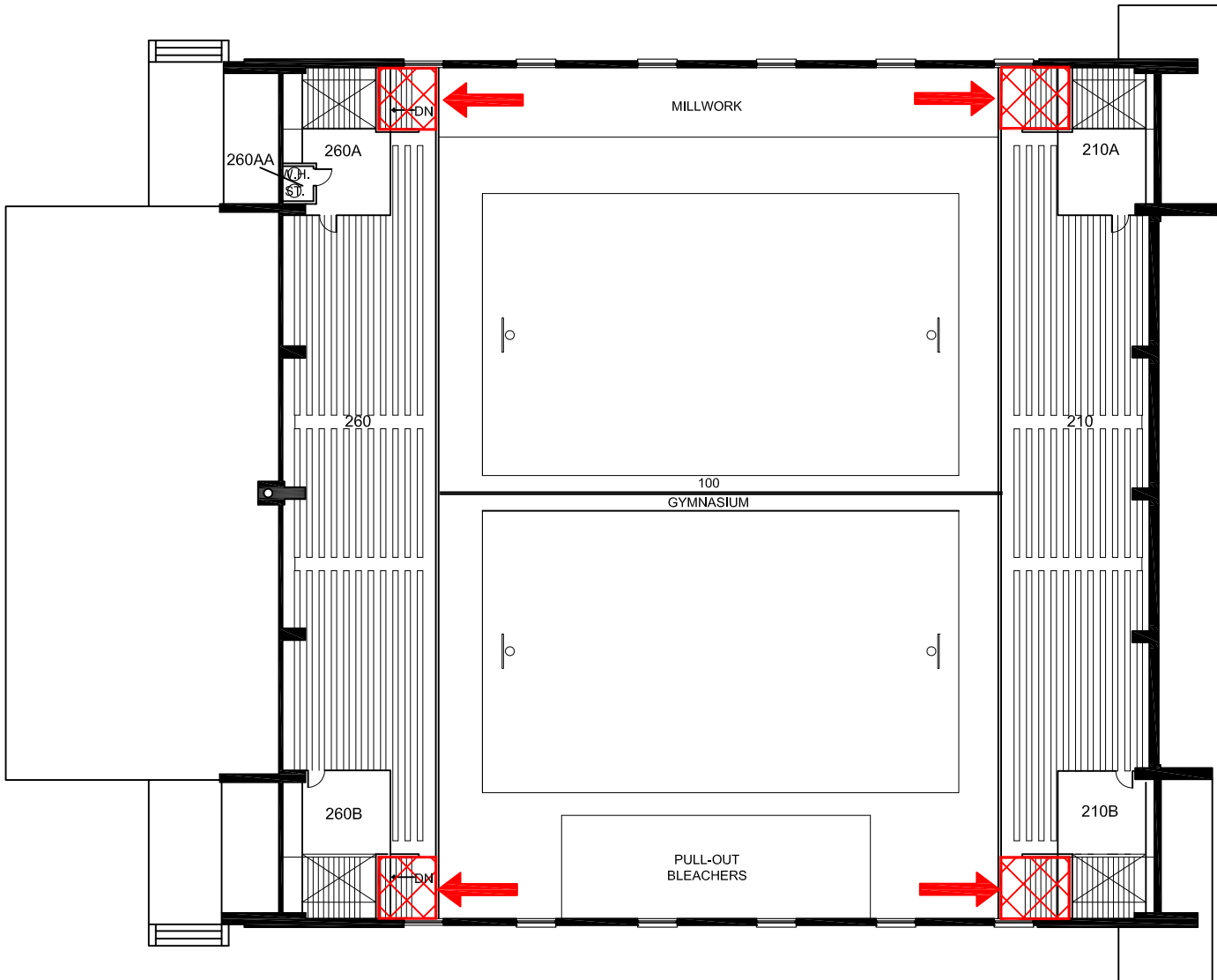

SECOND FLOOR PLAN

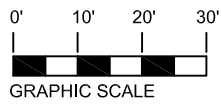

Safety Legend

- Areas of Refuge
- Tornado Shelter Areas

Exit/Evacuation Routes
In case of fire, do not use elevator

Automatic External Defibrillator

Evacuation Chair