

Instructions for the collection of a genital swab for the detection of a group B streptococcus (GBS)

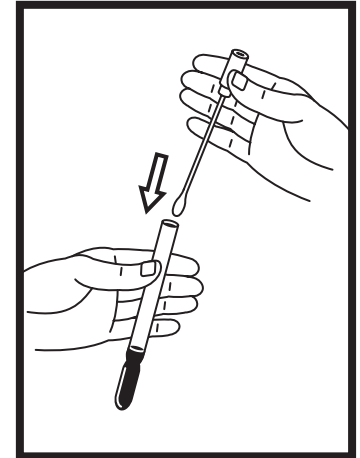
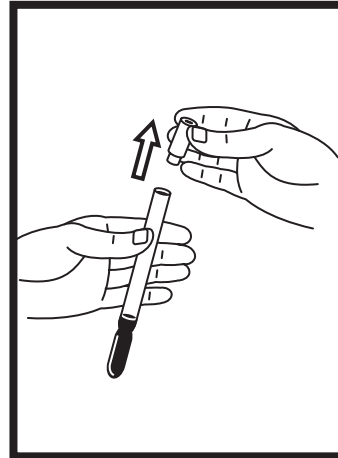
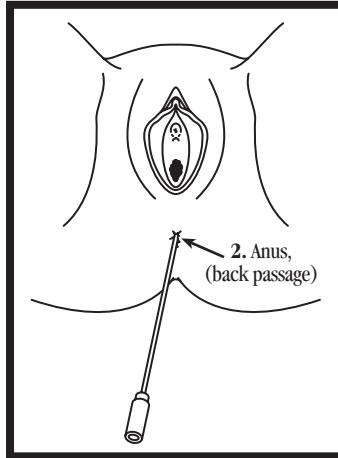
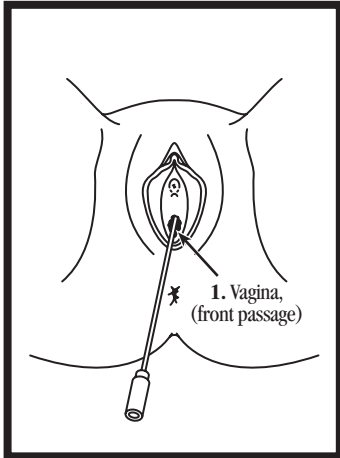

- 1.** Remove swab from packaging. Insert swab 2cm into vagina, (front passage). Do not touch cotton end with fingers.
- 2.** Insert the same swab 1cm into anus, (back passage).
- 3.** Remove cap from sterile tube.
- 4.** Place swab into tube. Ensure cap fits firmly.
- 5.** Make sure swab container is fully labelled with name, u.r. number, date and time of collection. Place swab container into transport bag and hand it to a staff member.