

UNITED STATES
DEPARTMENT OF THE INTERIOR
GEOLOGICAL SURVEY

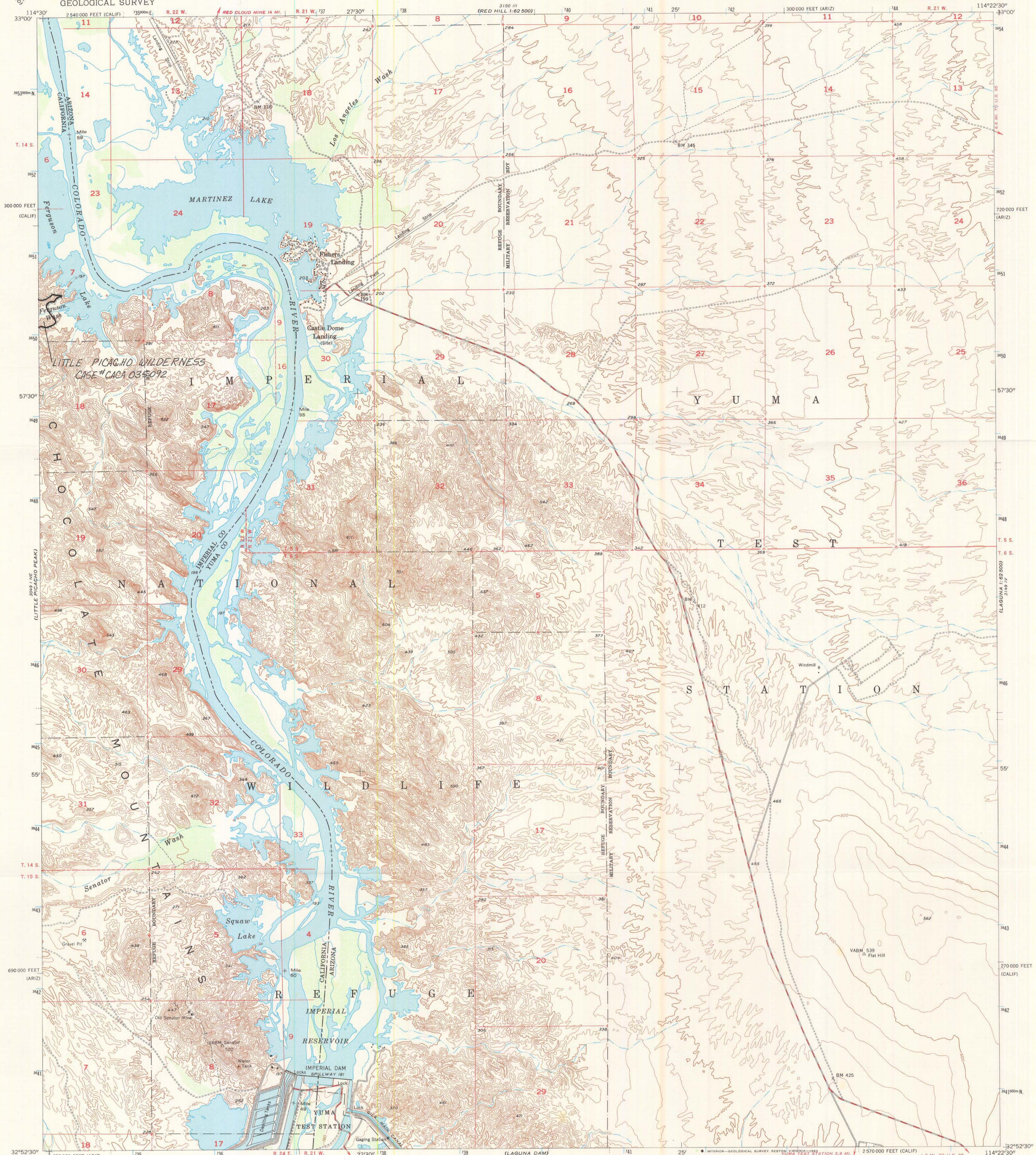

Mapped, edited, and published by the Geological Survey
Control by USGS and USC&GS
Topography from aerial photographs by Kesh plotter
Aerial photographs taken 1953. Field check 1955
Polyconic projection. 1927 North American datum
10,000-foot grids based on Arizona coordinate system, west zone
and California coordinate system, zone 6
1000-meter Universal Transverse Mercator grid ticks,
zone 11, shown in blue
Arizona-California boundary subject to adjustment
To place on the predicted North American Datum 1983,
move the projection lines 4 meters south and
72 meters east as shown by dashed corner ticks
There may be private inholdings within the boundaries of
the National or State reservations shown on this map

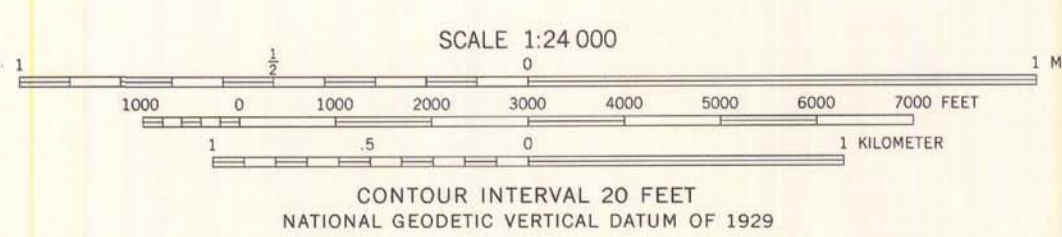
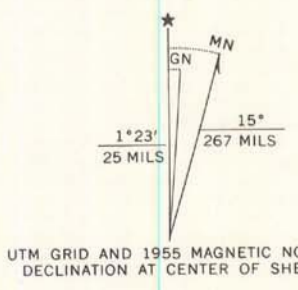

ORIGINAL
FINAL

ROAD CLASSIFICATION
Medium-duty ——— Light-duty ———
Unimproved dirt - - - - -



IMPERIAL RESERVOIR, ARIZ.-CALIF.
NW/4 LAGUNA 15' QUADRANGLE
N 3252.5-W 11422.5/7.5

THIS MAP COMPLIES WITH NATIONAL MAP ACCURACY STANDARDS
FOR SALE BY U. S. GEOLOGICAL SURVEY, DENVER, COLORADO 80225, OR RESTON, VIRGINIA 22092
A FOLDER DESCRIBING TOPOGRAPHIC MAPS AND SYMBOLS IS AVAILABLE ON REQUEST

1955
DMA 3149 IV NW-SERIES V898