



# **ATTACHMENT 15**

## **MAINTENANCE GROUP CHAIRMAN'S FACTUAL REPORT**

**DCA-07-MA-310**

**Right Engine Fuel & Filter – Clean/Replace Work Card 7752, dated 5/28/2008**

RIGHT ENGINE FUEL & AIR FILTERS - CLEAN / REPLACE

Card No. **7752**

Page 1 of 12

Rev. Date 03/16/2006



Equipment MD80

Skill 0

System 73

Section 8

Workzone 72

Pattern



(SIGN NAME/EMPL. #)  
INSP./

MECHANIC CREWCHIEF

American Airlines®

SPECIAL SCHEDULE ENTER CARD NUMBER ON RUNUP CARD 0008.

**MATERIALS & PARTS**

CPN	Description	MPN	Qty/Unit
5933314	Packing	69490D127	1
5933313	Packing	69490D128	1
5933109	Packing	69890-27	1
5862098	Packing	MS29513-013	1
5862000	Packing	MS29513-241	1
5932184	Cartridge	6667621	1
	Nozzle PWA 33682 (or equivalent)		
5824484	Packing	M83248-1-011	3
5845404	Packing	M83248-1-908	3
5694330	Packing	M83248-1-904	3
5790850	Packing	MS29561-110	1
5670940	Packing	M83248-1-910	1
5694328	Packing	M83248-1-906	1
4080459	Packing	AS3578-016	1

**TOOLS & EQUIPMENT**

CPN	Description	MPN	Qty/Unit
WRE9160	Torque Wrench		1
5671239	2-Gallon drain can		1
GAU9308	Source of clean dry compressed air with gauge and regulator		1
5996205	Petrolatum	VVP236	A/R
4157162	Solvent, Crystal Clean 100, PD680		A/R
5994075	Safety Wire, .020		A/R

**NOTE:** This card must still be entered on Run Up Card 0008

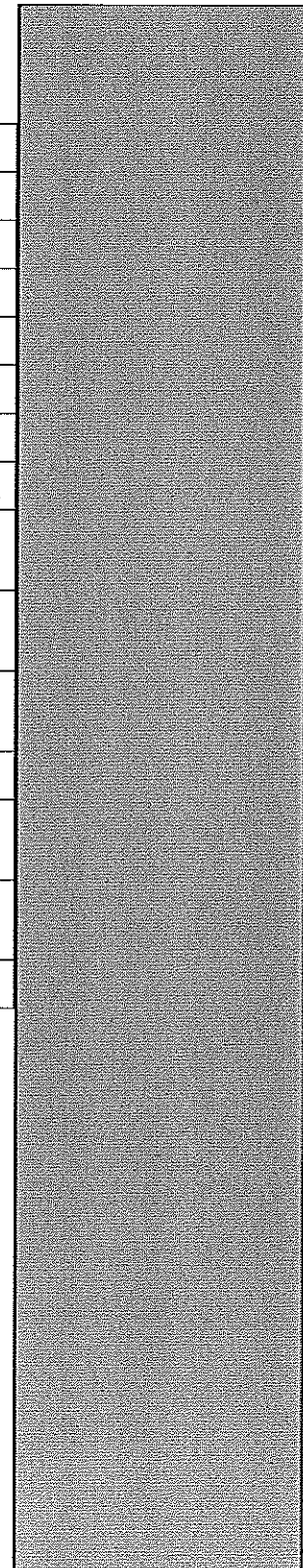



Equipment MD80 Skill 0  
 System 73 Section 8  
 Workzone 72 Pattern

(SIGN NAME/EMPL. #)  
 INSP./  
 MECHANIC CREWCHIEF

Special Schedule:

This card is not required if engine is zero time EHM, Program, or Check and Repair, installed during this C check.

Card is applicable: \_\_\_\_\_ Card is not applicable: \_\_\_\_\_

1. Prepare for Filter Removal/Replacement

**WARNING:** EXERCISE CARE TO AVOID STRAKES WHEN WORKING IN ENGINE AREA WITH COWL DOORS OPEN OR INJURY TO PERSONNEL WOULD RESULT.

**CAUTION:** TO PREVENT STRUCTURAL DAMAGE, USE HOLD-OPEN RODS ON EACH COWL DOOR.

**WARNING:** MAKE CERTAIN CIRCUIT BREAKERS ARE OPEN BEFORE ATTEMPTING MAINTENANCE PROCEDURES. INADVERTENT ENGINE START OR THRUST REVERSER OPERATION COULD RESULT IN SERIOUS INJURY TO PERSONNEL.

A. Tag throttle/thrust reverser lever, and open and tag following circuit breakers.

CIRCUIT BREAKER

PANEL	SERVICE	IDENT.	LOCATION
DC TRANS-FER BUS	ENGINE START PUMP		Lower EPC
DC TRANS-FER BUS	ENGINE IGNITION or ENGINE START VALVE		Lower EPC
AC BUS	CONT IGNITION or ENGINE IGNITION		Upper EPC

B. Place thrust reverser control valve in dump position and install safety pin.

**WARNING:** DO NOT MOVE FIRE CONTROL HANDLE BEYOND FUEL AND HYD OFF POSITION. INADVERTENT DISCHARGE OF FIREX AGENT CONTAINERS WILL OCCUR IF HANDLE IS ACCIDENTALLY ROTATED TO AGENT 1 OR AGENT 2 POSITION.

C. Pull fire control handle located on upper instrument panel.





Equipment MD80

Skill 0

System 73

Section 8

Workzone 72

Pattern

(SIGN NAME/EMPL. #)  
INSP./

MECHANIC CREWCHIEF

B. Test fuel filter differential pressure switch (Ref. Figure 3).

- (1) Prepare test equipment; source of clean dry compressed air or nitrogen, pressure regulator, and 0 to 25 psig pressure gage. Gage should have ±1 percent accuracy with dial marked in 1/4 psi increments.
- (2) Obtain fuel filter differential pressure switch tester from tool room. Connect to pressure source test line and lightly lubricate rubber seat at tip of nozzle with petrolatum (VV-P-236).
- (3) Insert nozzle inside filter housing, and position tip of nozzle in high pressure port for differential pressure switch. Hold nozzle firmly in place.

**CAUTION:** DO NOT EXCEED 20 PSIG GAGE PRESSURE.

- (4) Assure FUEL FILTER PRESSURE DROP CAUTION circuit breaker is closed.
- (5) Slowly apply pressure through nozzle. Check that FUEL FILTER PRESSURE DROP CAUTION LIGHT on engine caution annunciator panel comes on between 3.0 and 8.0 psig.
- (6) Slowly decrease line pressure and check that FUEL FILTER PRESSURE DROP CAUTION LIGHT goes out between 6.0 and 2.0 psig.
- (7) Shut off air pressure and remove nozzle from fuel filter housing.

C. Install filter cartridge.

- (1) Lubricate new O-ring (CPN 5862000) with light coat of petrolatum and install on filter cover.
- (2) Position new filter cartridge (CPN 5932184) on cover assembly and insert into filter housing. Tighten cover assembly to 75 to 100 inch-pounds torque.

**NOTE:** It requires approximately 19 complete turns of the cover assembly jam nut to ensure proper seating of the cover inside the filter housing.

- (3) Lubricate O-ring (CPN 5862098) with light coat of petrolatum and install on cover valve. Install cover valve into valve body and tighten. Insert and lock cotterpin.
- (4) Safety cover assembly with lockwire.



Equipment **MD80**  
System **73**  
Workzone **72**

Skill **0**  
Section **8**  
Pattern

(SIGN NAME/EMPL. #)  
INSP./  
MECHANIC CREWCHIEF

- (5) Lubricate new O-ring with light coat of petrolatum and install on drain plug. Install drain plug in fuel bridle and safety with lockwire.
- (6) Remove fire handle restraining tool and push fire handle in.

**CAUTION:** BE SURE THAT THE DRAIN HOLE IN THE BOTTOM OF THE CONDENSATION TRAP PLUG IS NOT BLOCKED BY THE LOCKWIRE USED TO SAFETY THE PLUG TO THE TRAP (AN OPEN DRAIN HOLE IS NECESSARY TO LET WATER OUT OF THE TRAP). INSTALL LOCKWIRE THROUGH ONLY ONE SIDE OF THE PLUG, NOT FULLY ACROSS THE DRAIN HOLE IN THE BOTTOM OF THE PLUG.

- D. Drain the Fuel Control (PS4) moisture trap by removing and reinserting the drain plug.

**NOTE:** DO NOT insert lockwire through moisture trap bleed hole to confirm accumulated moisture has been drained from trap.

4. Starter Air Shutoff Valve Filter (Ref. Figure 4)

- A. Remove, clean, and reinstall filter.
  - (1) Disconnect sensing line from filter.
  - (2) Remove screen-fitting and metal O-ring from filter body. Check metal O-ring for flatness and general condition. Metal O-ring may be reused if in good condition.
  - (3) CLEANING OPERATIONS USING SOLVENT SHOULD BE PERFORMED IN A WELL-VENTILATED ATMOSPHERE. EXERCISE NORMAL SAFETY PRECAUTIONS DURING USE.
  - (4) Clean screen-fitting with solvent, P-D-680.
  - (5) Dry screen-fitting with clean, dry compressed air.
  - (6) Install screen-fitting and metal O-ring in filter body. Tighten to torque of 420 to 540 inch-pounds.
  - (7) Connect sensing line to filter.

5. Check Starter Air Shutoff Valve Position Indicator Switch Connection.

- A. Disconnect plug from the position indicator switch on the Starter Air Shutoff Valve (Ref. Figure 4, View A)
  - (1) Check plug for any loose wires or contacts.
  - (2) If loose wires or contacts are discovered, repair per Ch. 20 of the SSWD (Standard Wiring Practices Manual). If no repair required, N/A this step.



Card No. **7752**  
 Page 7 of 12  
 Rev. Date 03/16/2006



Equipment MD80 Skill 0  
 System 73 Section 8  
 Workzone 72 Pattern

(SIGN NAME/EMPL. #)  
 INSP./  
 MECHANIC CREWCHIEF

**WARNING:** MAKE CERTAIN THROTTLE/THRUST REVERSER LEVER POSITION CORRESPONDS WITH THRUST REVERSER DOOR POSITION AND THAT ALL PERSONNEL AND EQUIPMENT ARE WELL CLEAR OF THRUST REVERSER BEFORE OPERATION. ANY TIME THAT THRUST REVERSER CONTROL VALVE IS NOT IN DUMP POSITION, 3000 PSI (20,700 KPA) IS AVAILABLE AND WILL MOVE REVERSER DOORS IN RESPONSE TO THROTTLE/THRUST REVERSER LEVER MOVEMENT REGARD LESS WHETHER ANY ELECTRICAL OR HYDRAULIC POWER IS SUPPLIED TO AIRCRAFT.

- C. Remove tag from throttle/thrust reverser lever, and remove tags and close circuit breakers identified in Step 1.A.

**CIRCUIT BREAKER**

PANEL	SERVICE	IDENT.	LOCATION
DC TRANSFER BUS	ENGINE START PUMP		Lower EPC
DC TRANSFER BUS	ENGINE IGNITION or ENGINE START VALVE		Lower EPC
AC BUS	CONT IGNITION or ENGINE IGNITION		Upper EPC

- 9. Enter card number on Card 0008 (Run-up) for leak check of fuel filters.





Equipment MD80

System 73

Workzone 72

Skill 0

Section 8

Pattern

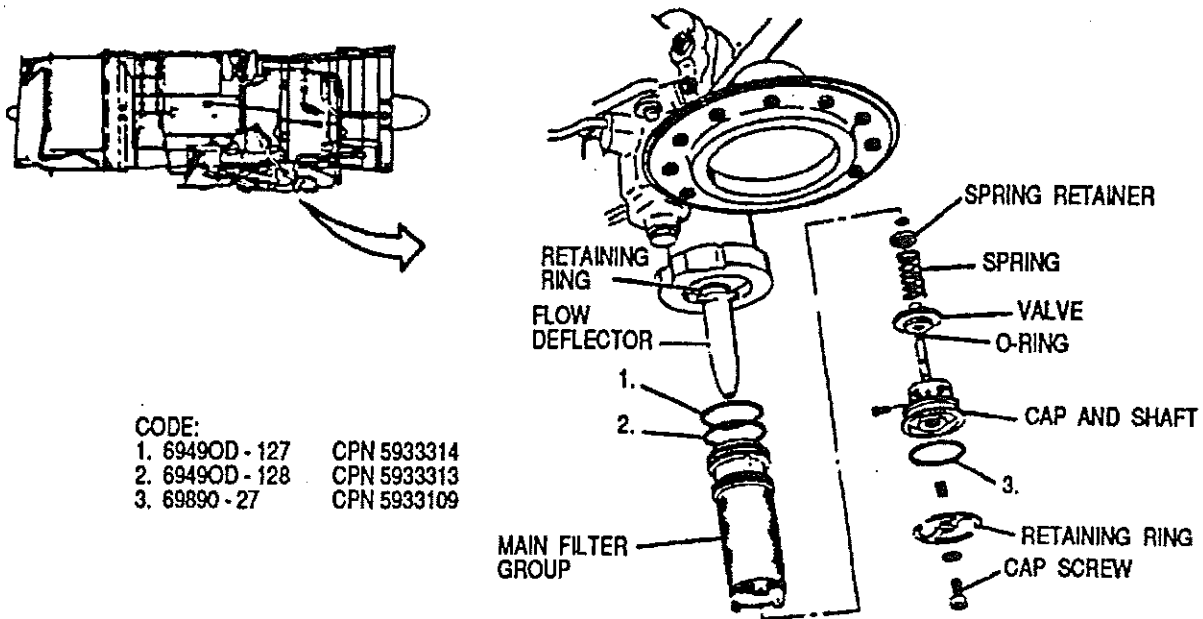

Main Fuel Control Filter - Removal/Installation  
Figure 1:



Equipment MD80

Skill 0

System 73

Section 8

Workzone 72

Pattern

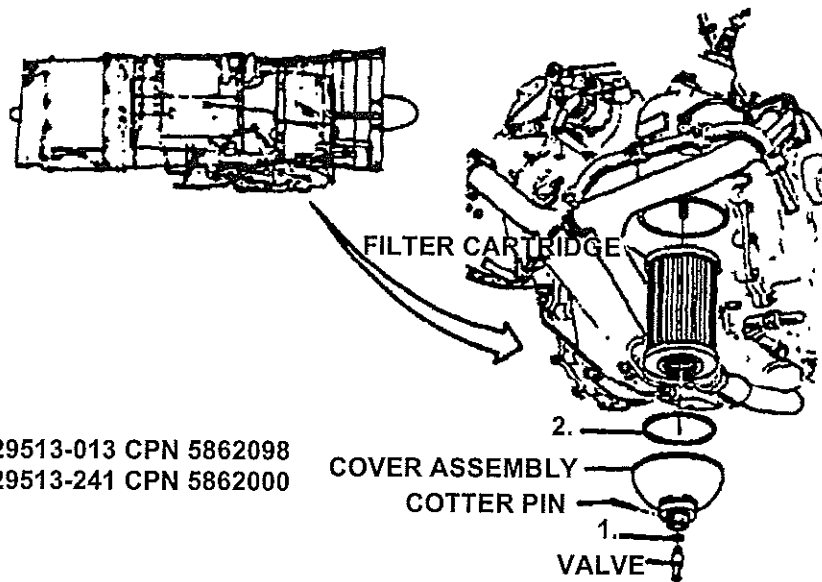

**CODE:**

- 1. MS29513-013 CPN 5862098
- 2. MS29513-241 CPN 5862000

COVER ASSEMBLY  
COTTER PIN

2.

1.

VALVE

Fuel Pump Filter - Removal/Installation  
Figure 2:



Equipment MD80

System 73

Workzone 72

Skill 0

Section 8

Pattern

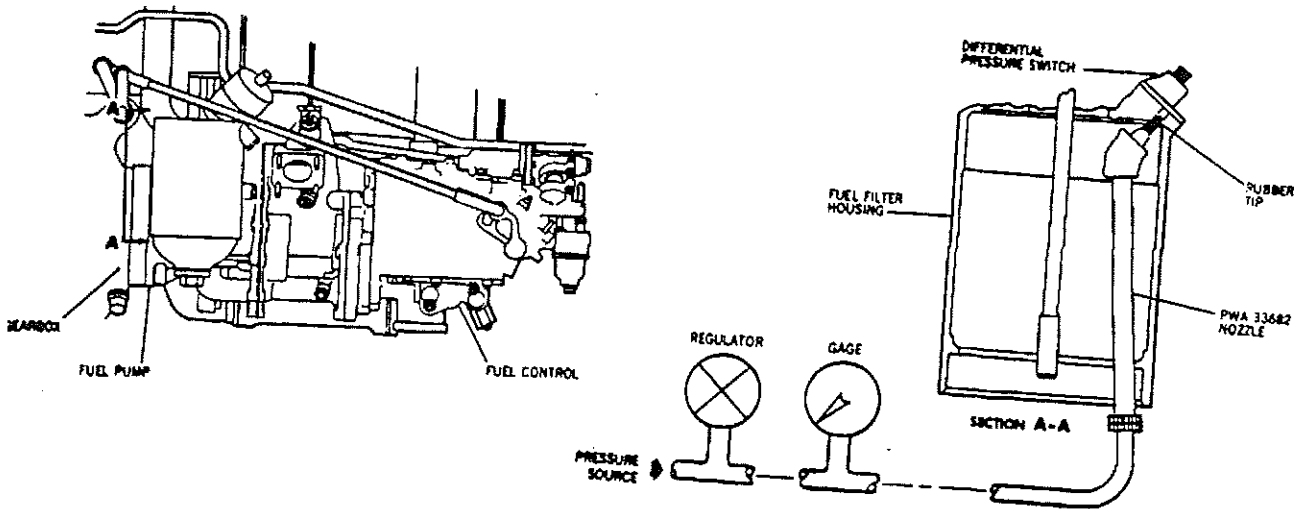

8082-73-20

Fuel Filter Differential Pressure Switch - Check  
Figure 3:



Equipment MD80  
 System 73  
 Workzone 72

Skill 0  
 Section 8  
 Pattern

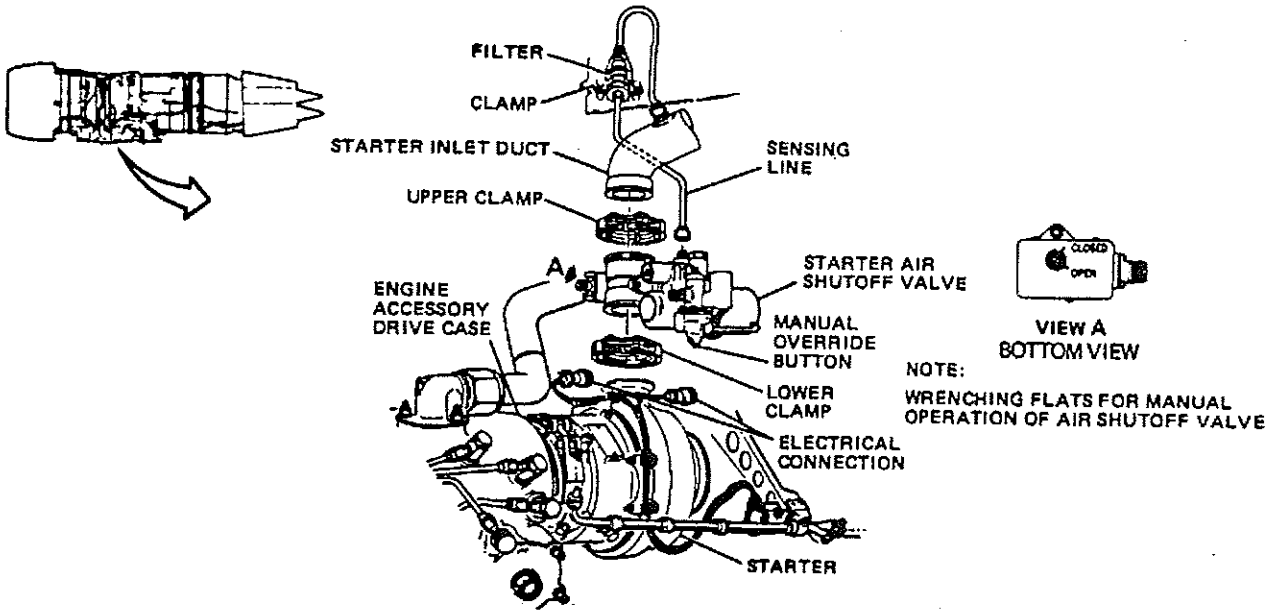

8882-90-7

Starter Air Shutoff Valve - Installation  
 Figure 4:

Card No. **7752**

Page 12 of 12

Rev. Date 03/16/2006



Equipment MD80

System 73

Workzone 72

Skill 0

Section 8

Pattern

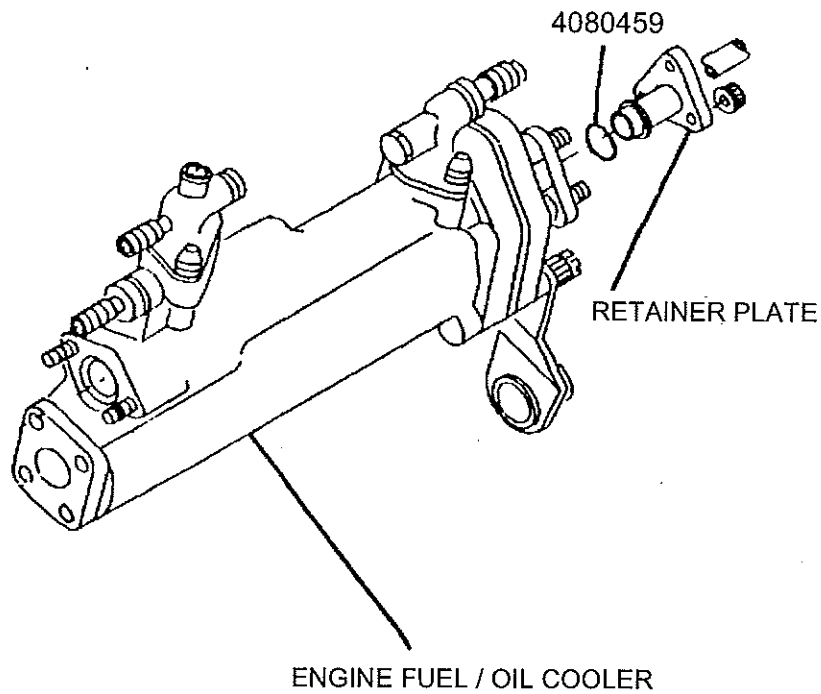

Figure 5: