



ATTACHMENT 13

MAINTENANCE GROUP CHAIRMAN'S FACTUAL REPORT

DCA-07-MA-310

Right Engine Fuel & Filter – Clean/Replace Work Card 7752, dated 3/16/2006

RIGHT ENGINE FUEL & AIR FILTERS - CLEAN / REPLACE

Card No. **7752**

Page 1 of 12

Rev. Date 03/16/2006



Equipment MD80

Skill 0

System 73

Section 8

Workzone 72

Pattern



(SIGN NAME/EMPL. #)
INSP./

MECHANIC CREWCHIEF

American Airlines®

SPECIAL SCHEDULE ENTER CARD NUMBER ON RUNUP CARD 0008.

MATERIALS & PARTS

| CPN | Description | MPN | Qty/Unit |
|---------|----------------------------------|--------------|----------|
| 5933314 | Packing | 69490D127 | 1 |
| 5933313 | Packing | 69490D128 | 1 |
| 5933109 | Packing | 69890-27 | 1 |
| 5862098 | Packing | MS29513-013 | 1 |
| 5862000 | Packing | MS29513-241 | 1 |
| 5932184 | Cartridge | 6667621 | 1 |
| | Nozzle PWA 33682 (or equivalent) | | |
| 5824484 | Packing | M83248-1-011 | 3 |
| 5845404 | Packing | M83248-1-908 | 3 |
| 5694330 | Packing | M83248-1-904 | 3 |
| 5790850 | Packing | MS29561-110 | 1 |
| 5670940 | Packing | M83248-1-910 | 1 |
| 5694328 | Packing | M83248-1-906 | 1 |
| 4080459 | Packing | AS3578-016 | 1 |

TOOLS & EQUIPMENT

| CPN | Description | MPN | Qty/Unit |
|---------|---|--------|----------|
| WRE9160 | Torque Wrench | | 1 |
| 5671239 | 2-Gallon drain can | | 1 |
| GAU9308 | Source of clean dry compressed air with gauge and regulator | | 1 |
| 5996205 | Petrolatum | VVP236 | A/R |
| 4157162 | Solvent, Crystal Clean 100, PD680 | | A/R |
| 5994075 | Safety Wire, .020 | | A/R |

NOTE: This card must still be entered on Run Up Card 0008

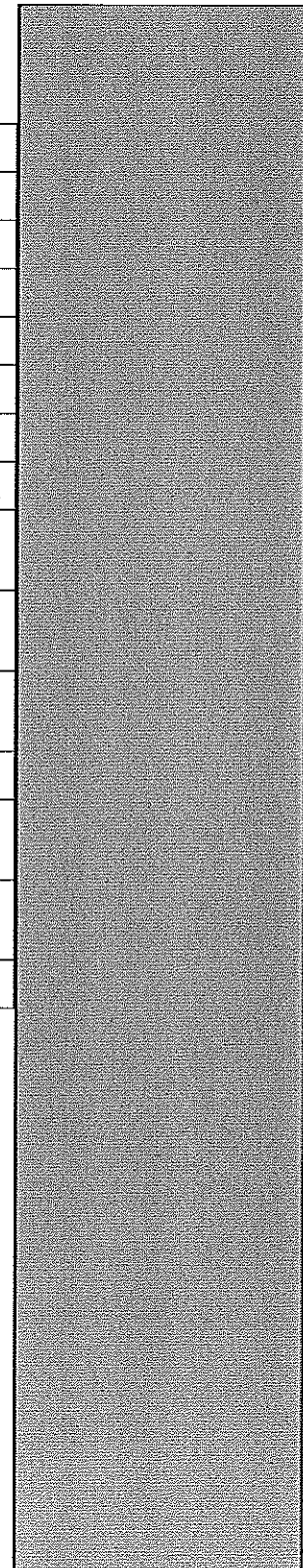



Equipment MD80 Skill 0
 System 73 Section 8
 Workzone 72 Pattern

(SIGN NAME/EMPL. #)
 INSP./
 MECHANIC CREWCHIEF

Special Schedule:

This card is not required if engine is zero time EHM, Program, or Check and Repair, installed during this C check.

Card is applicable: _____ Card is not applicable: _____

1. Prepare for Filter Removal/Replacement

WARNING: EXERCISE CARE TO AVOID STRAKES WHEN WORKING IN ENGINE AREA WITH COWL DOORS OPEN OR INJURY TO PERSONNEL WOULD RESULT.

CAUTION: TO PREVENT STRUCTURAL DAMAGE, USE HOLD-OPEN RODS ON EACH COWL DOOR.

WARNING: MAKE CERTAIN CIRCUIT BREAKERS ARE OPEN BEFORE ATTEMPTING MAINTENANCE PROCEDURES. INADVERTENT ENGINE START OR THRUST REVERSER OPERATION COULD RESULT IN SERIOUS INJURY TO PERSONNEL.

A. Tag throttle/thrust reverser lever, and open and tag following circuit breakers.

CIRCUIT BREAKER

| PANEL | SERVICE | IDENT. | LOCATION |
|------------------|---------------------------------------|--------|-----------|
| DC TRANS-FER BUS | ENGINE START PUMP | | Lower EPC |
| DC TRANS-FER BUS | ENGINE IGNITION or ENGINE START VALVE | | Lower EPC |
| AC BUS | CONT IGNITION or ENGINE IGNITION | | Upper EPC |

B. Place thrust reverser control valve in dump position and install safety pin.

WARNING: DO NOT MOVE FIRE CONTROL HANDLE BEYOND FUEL AND HYD OFF POSITION. INADVERTENT DISCHARGE OF FIREX AGENT CONTAINERS WILL OCCUR IF HANDLE IS ACCIDENTALLY ROTATED TO AGENT 1 OR AGENT 2 POSITION.

C. Pull fire control handle located on upper instrument panel.

| | |
|--|--|
| | |
| | |
| | |



Equipment MD80

Skill 0

System 73

Section 8

Workzone 72

Pattern

(SIGN NAME/EMPL. #)
INSP./

MECHANIC CREWCHIEF

B. Test fuel filter differential pressure switch (Ref. Figure 3).

- (1) Prepare test equipment; source of clean dry compressed air or nitrogen, pressure regulator, and 0 to 25 psig pressure gage. Gage should have ±1 percent accuracy with dial marked in 1/4 psi increments.
- (2) Obtain fuel filter differential pressure switch tester from tool room. Connect to pressure source test line and lightly lubricate rubber seat at tip of nozzle with petrolatum (VV-P-236).
- (3) Insert nozzle inside filter housing, and position tip of nozzle in high pressure port for differential pressure switch. Hold nozzle firmly in place.

CAUTION: DO NOT EXCEED 20 PSIG GAGE PRESSURE.

- (4) Assure FUEL FILTER PRESSURE DROP CAUTION circuit breaker is closed.
- (5) Slowly apply pressure through nozzle. Check that FUEL FILTER PRESSURE DROP CAUTION LIGHT on engine caution annunciator panel comes on between 3.0 and 8.0 psig.
- (6) Slowly decrease line pressure and check that FUEL FILTER PRESSURE DROP CAUTION LIGHT goes out between 6.0 and 2.0 psig.
- (7) Shut off air pressure and remove nozzle from fuel filter housing.

C. Install filter cartridge.

- (1) Lubricate new O-ring (CPN 5862000) with light coat of petrolatum and install on filter cover.
- (2) Position new filter cartridge (CPN 5932184) on cover assembly and insert into filter housing. Tighten cover assembly to 75 to 100 inch-pounds torque.

NOTE: It requires approximately 19 complete turns of the cover assembly jam nut to ensure proper seating of the cover inside the filter housing.

- (3) Lubricate O-ring (CPN 5862098) with light coat of petrolatum and install on cover valve. Install cover valve into valve body and tighten. Insert and lock cotterpin.
- (4) Safety cover assembly with lockwire.

| | |
|--|--|
| | |
| | |
| | |

Card No. **7752**

Page 7 of 12

Rev. Date 03/16/2006



American Airlines®

Equipment MD80

Skill 0

System 73

Section 8

Workzone 72

Pattern

(SIGN NAME/EMPL. #)

INSP./

MECHANIC CREWCHIEF

WARNING: MAKE CERTAIN THROTTLE/THRUST REVERSER LEVER POSITION CORRESPONDS WITH THRUST REVERSER DOOR POSITION AND THAT ALL PERSONNEL AND EQUIPMENT ARE WELL CLEAR OF THRUST REVERSER BEFORE OPERATION. ANY TIME THAT THRUST REVERSER CONTROL VALVE IS NOT IN DUMP POSITION, 3000 PSI (20,700 KPA) IS AVAILABLE AND WILL MOVE REVERSER DOORS IN RESPONSE TO THROTTLE/THRUST REVERSER LEVER MOVEMENT REGARDLESS WHETHER ANY ELECTRICAL OR HYDRAULIC POWER IS SUPPLIED TO AIRCRAFT.

- C. Remove tag from throttle/thrust reverser lever, and remove tags and close circuit breakers identified in Step 1.A.

CIRCUIT BREAKER

| PANEL | SERVICE | IDENT. | LOCATION |
|-----------------|---------------------------------------|--------|-----------|
| DC TRANSFER BUS | ENGINE START PUMP | | Lower EPC |
| DC TRANSFER BUS | ENGINE IGNITION or ENGINE START VALVE | | Lower EPC |
| AC BUS | CONT IGNITION or ENGINE IGNITION | | Upper EPC |

- 9. Enter card number on Card 0008 (Run-up) for leak check of fuel filters.



Equipment MD80

System 73

Workzone 72

Skill 0

Section 8

Pattern

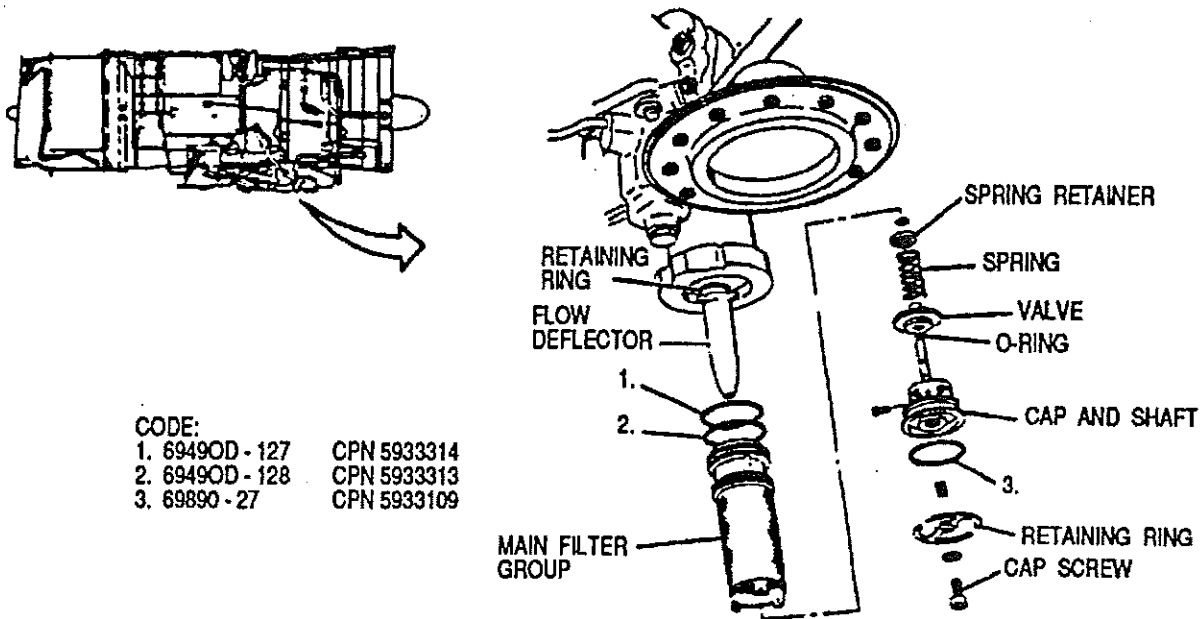

Main Fuel Control Filter - Removal/Installation
Figure 1:



Equipment MD80

Skill 0

System 73

Section 8

Workzone 72

Pattern

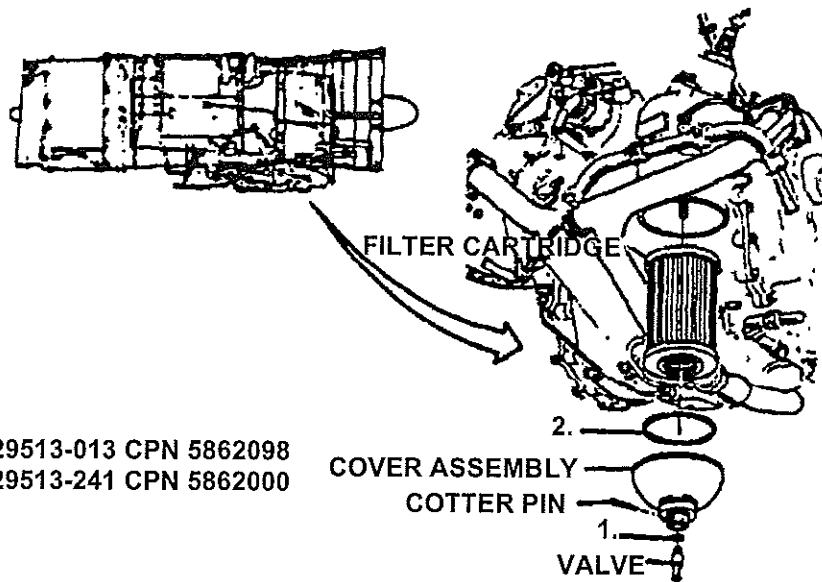

CODE:

- 1. MS29513-013 CPN 5862098
- 2. MS29513-241 CPN 5862000

COVER ASSEMBLY
COTTER PIN

2.

1.

VALVE

Fuel Pump Filter - Removal/Installation
Figure 2:



Equipment MD80

System 73

Workzone 72

Skill 0

Section 8

Pattern

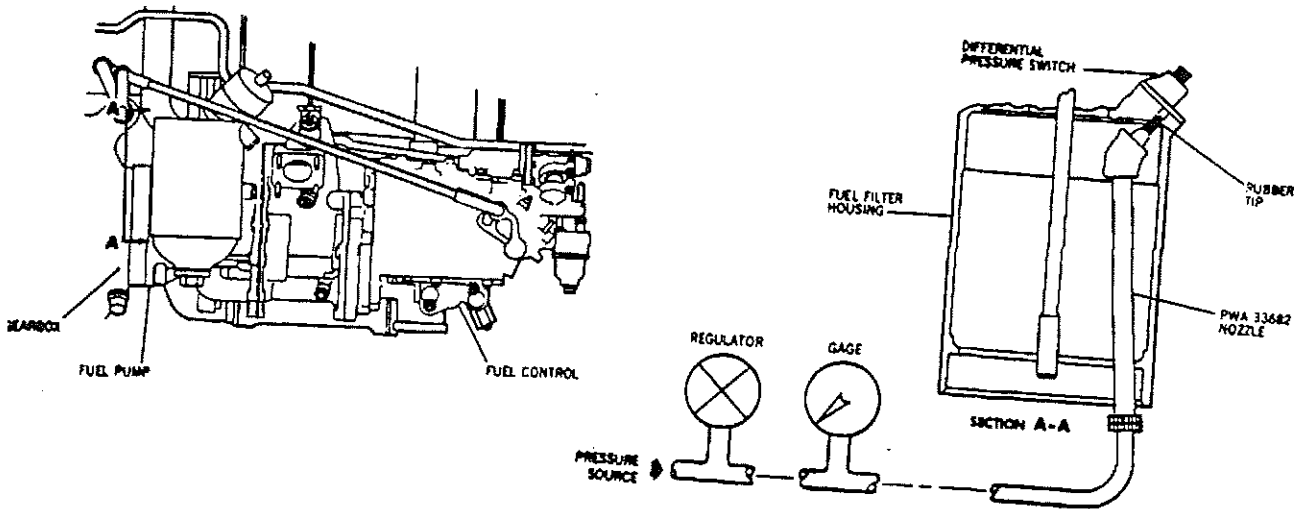

8082-73-20

Fuel Filter Differential Pressure Switch - Check
Figure 3:



Equipment MD80
System 73
Workzone 72

Skill 0
Section 8
Pattern

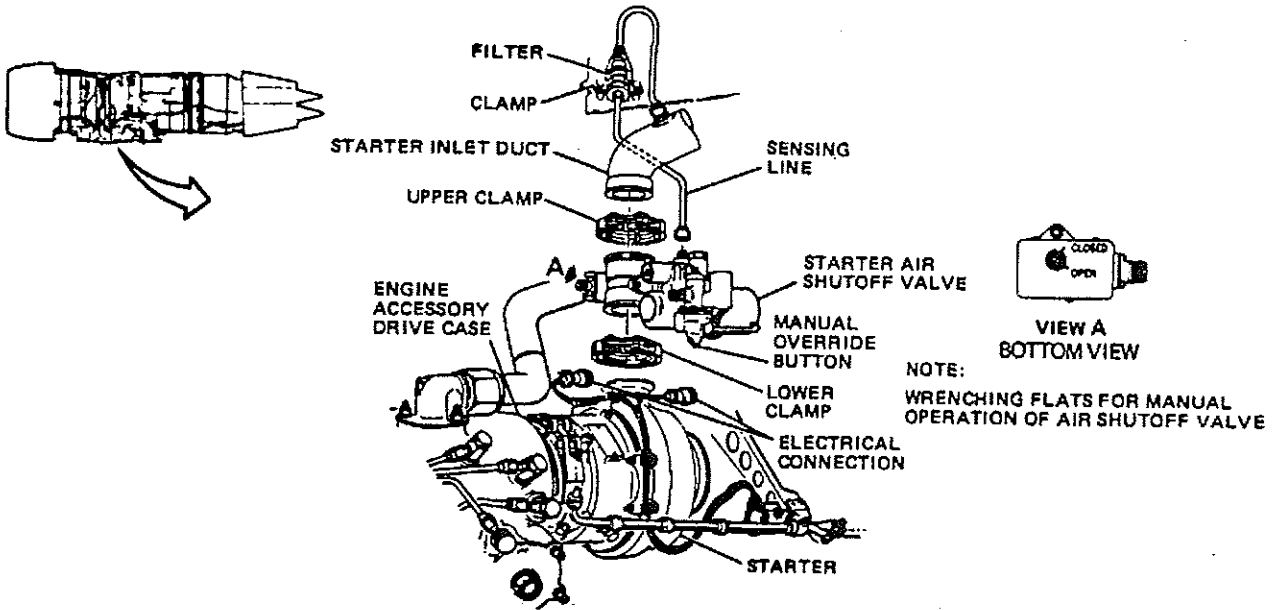

8882-90-7

Starter Air Shutoff Valve - Installation
Figure 4:

Card No. **7752**

Page 12 of 12

Rev. Date 03/16/2006



Equipment MD80

System 73

Workzone 72

Skill 0

Section 8

Pattern

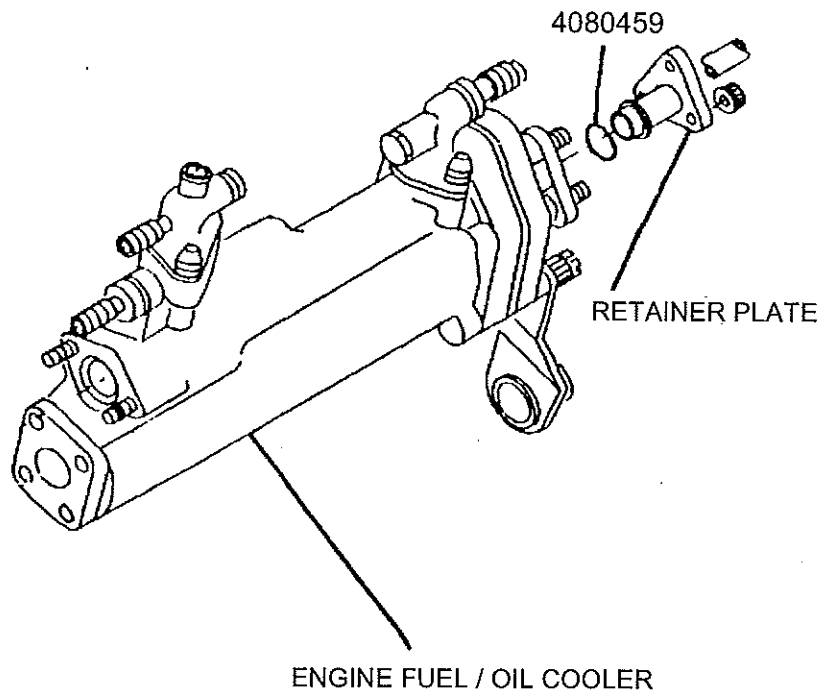

Figure 5: