



# **ATTACHMENT 12**

## **MAINTENANCE GROUP CHAIRMAN'S FACTUAL REPORT**

**DCA-07-MA-310**

**Left Engine Fuel & Filter – Clean/Replace Work Card 7751, dated 3/16/2006**

LEFT ENGINE FUEL & AIR FILTERS - CLEAN / REPLACE

Card No. **7751**

Page 1 of 12

Rev. Date 03/16/2006



Equipment MD80

Skill 0

System 73

Section 8

Workzone 71

Pattern



(SIGN NAME/EMPL. #)  
INSP./

MECHANIC CREWCHIEF

American Airlines®

SPECIAL SCHEDULE ENTER CARD NUMBER ON RUNUP CARD 0008.

**MATERIALS & PARTS**

CPN	Description	MPN	Qty/Unit
5933314	Packing	69490D127	1
5933313	Packing	69490D128	1
5933109	Packing	69890-27	1
5862098	Packing	MS29513-013	1
5862000	Packing	MS29513-241	1
5932184	Cartridge	6667621	1
5824484	Packing	M83248/1-011	3
5845404	Packing	M83248-1-908	3
5694330	Packing	M83248-1-904	3
5790850	Packing	MS29561-110	1
5670940	Packing	M83248-1-910	1
5694328	Packing	M83248-1-906	1
4080459	Packing	AS3578-016	1

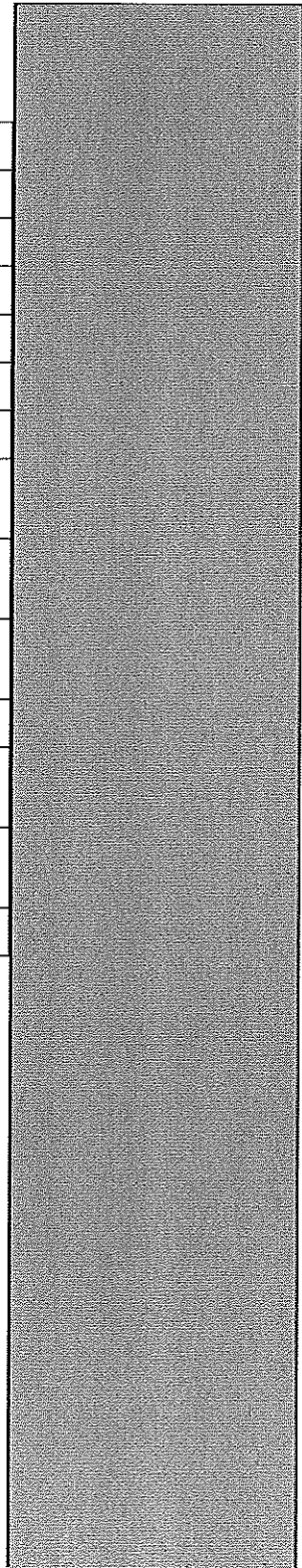

**TOOLS & EQUIPMENT**

CPN	Description	MPN	Qty/Unit
WRE9160	Torque Wrench		1
5671239	2-Gallon drain can		1
GAU9308	Source of clean dry compressed air with gauge and regulator		1
5996205	Petrolatum	VVP236	A/R
4157162	Solvent, Crystal Clean 100, PD680		A/R
	Nozzle PWA 33682 (or equivalent)		
5994075	Safety Wire, .020		A/R

**NOTE:** This card must still be entered on Run Up Card 0008



Equipment MD80 Skill 0  
 System 73 Section 8  
 Workzone 71 Pattern

(SIGN NAME/EMPL. #)  
 INSP./  
 MECHANIC CREWCHIEF

Special Schedule:

This card is not required if engine is zero time EHM, Program, or Check and Repair, installed during this C check.

Card is applicable: \_\_\_\_\_ Card is not applicable: \_\_\_\_\_

1. Prepare for Filter Removal/Replacement

**WARNING:** EXERCISE CARE TO AVOID STRAKES WHEN WORKING IN ENGINE AREA WITH COWL DOORS OPEN OR INJURY TO PERSONNEL WOULD RESULT.

**CAUTION:** TO PREVENT STRUCTURAL DAMAGE, USE HOLD-OPEN RODS ON EACH COWL DOOR.

**WARNING:** MAKE CERTAIN CIRCUIT BREAKERS ARE OPEN BEFORE ATTEMPTING MAINTENANCE PROCEDURES. INADVERTENT ENGINE START OR THRUST REVERSER OPERATION COULD RESULT IN SERIOUS INJURY TO PERSONNEL.

A. Tag throttle/thrust reverser lever, and open and tag following circuit breakers.

CIRCUIT BREAKER

PANEL	SERVICE	IDENT.	LOCATION
DC TRANSFER BUS	ENGINE START PUMP		Lower EPC
DC TRANSFER BUS	ENGINE IGNITION or ENGINE START VALVE		Lower EPC
AC BUS	CONT IGNITION or ENGINE IGNITION		Upper EPC

B. Place thrust reverser control valve in dump position and install safety pin.

**WARNING:** DO NOT MOVE FIRE CONTROL HANDLE BEYOND FUEL AND HYD OFF POSITION. INADVERTENT DISCHARGE OF FIREX AGENT CONTAINERS WILL OCCUR IF HANDLE IS ACCIDENTALLY ROTATED TO AGENT 1 OR AGENT 2 POSITION.

C. Pull fire control handle located on upper instrument panel.

2. Main Fuel Control Filter Check and Clean

**NOTE:** Main filter group includes fuel control main filter and servo fuel filter.

A. Remove filter (Ref. Figure 1).









Card No. **7751**  
 Page 7 of 12  
 Rev. Date 03/16/2006



Equipment MD80 Skill 0  
 System 73 Section 8  
 Workzone 71 Pattern

(SIGN NAME/EMPL. #)  
 INSP./  
 MECHANIC CREWCHIEF

**WARNING:** MAKE CERTAIN THROTTLE/THRUST REVERSER LEVER POSITION CORRESPONDS WITH THRUST REVERSER DOOR POSITION AND THAT ALL PERSONNEL AND EQUIPMENT ARE WELL CLEAR OF THRUST REVERSER BEFORE OPERATION. ANY TIME THAT THRUST REVERSER CONTROL VALVE IS NOT IN DUMP POSITION, 3000 PSI (20,700 KPA) IS AVAILABLE AND WILL MOVE REVERSER DOORS IN RESPONSE TO THROTTLE/THRUST REVERSER LEVER MOVEMENT REGARD LESS WHETHER ANY ELECTRICAL OR HYDRAULIC POWER IS SUPPLIED TO AIRCRAFT.

- C. Remove tag from throttle/thrust reverser lever, and remove tags and close circuit breakers identified in Step 1.A.

**CIRCUIT BREAKER**

PANEL	SERVICE	IDENT.	LOCATION
DC TRANSFER BUS	ENGINE START PUMP		Lower EPC
DC TRANSFER BUS	ENGINE IGNITION or ENGINE START VALVE		Lower EPC
AC BUS	CONT IGNITION or ENGINE IGNITION		Upper EPC

- 9. Enter card number on Card 0008 (Run-up) for leak check of fuel filters.

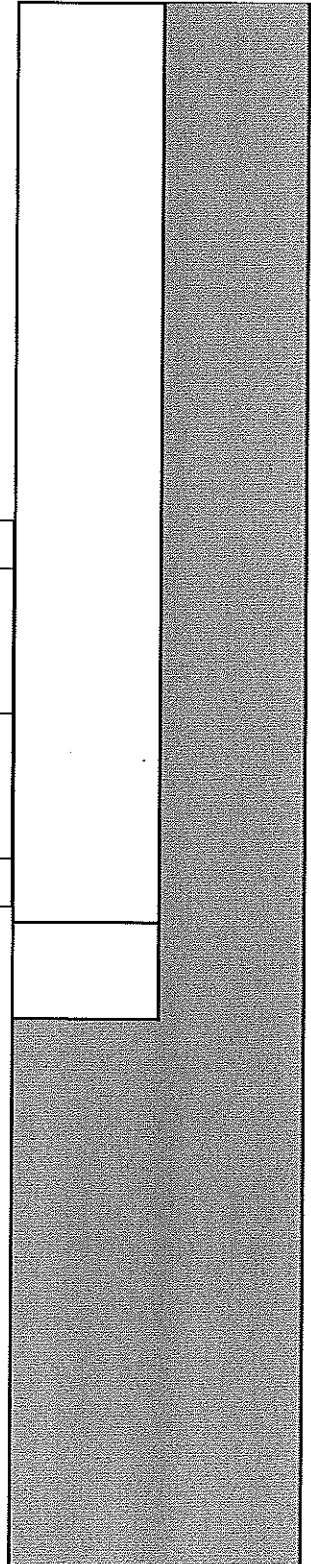





Equipment MD80

System 73

Workzone 71

Skill 0

Section 8

Pattern

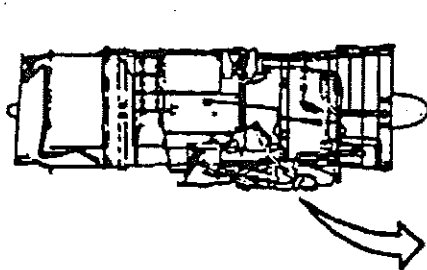

- CODE:  
1. 6949OD - 127 CPN 5933314  
2. 6949OD - 128 CPN 5933313  
3. 69890 - 27 CPN 5933109

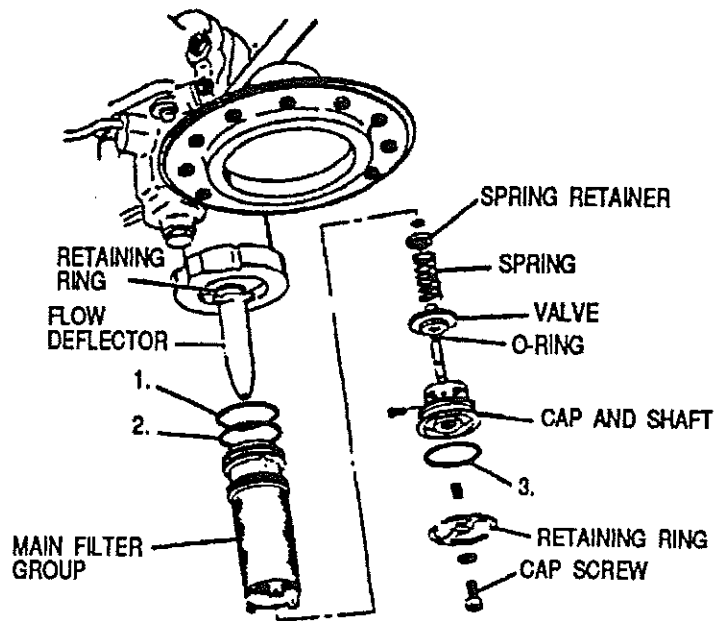

Main Fuel Control Filter - Removal/Installation  
Figure 1:



Equipment MD80

Skill 0

System 73

Section 8

Workzone 71

Pattern

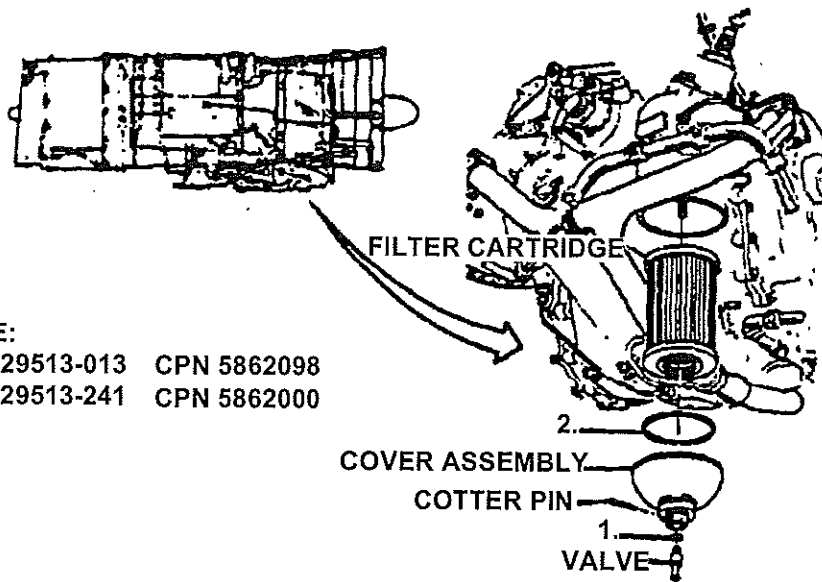

- CODE:  
1. MS29513-013 CPN 5862098  
2 MS29513-241 CPN 5862000

Fuel Pump Filter - Removal/Installation  
Figure 2:



Equipment MD80  
System 73  
Workzone 71

Skill 0  
Section 8  
Pattern

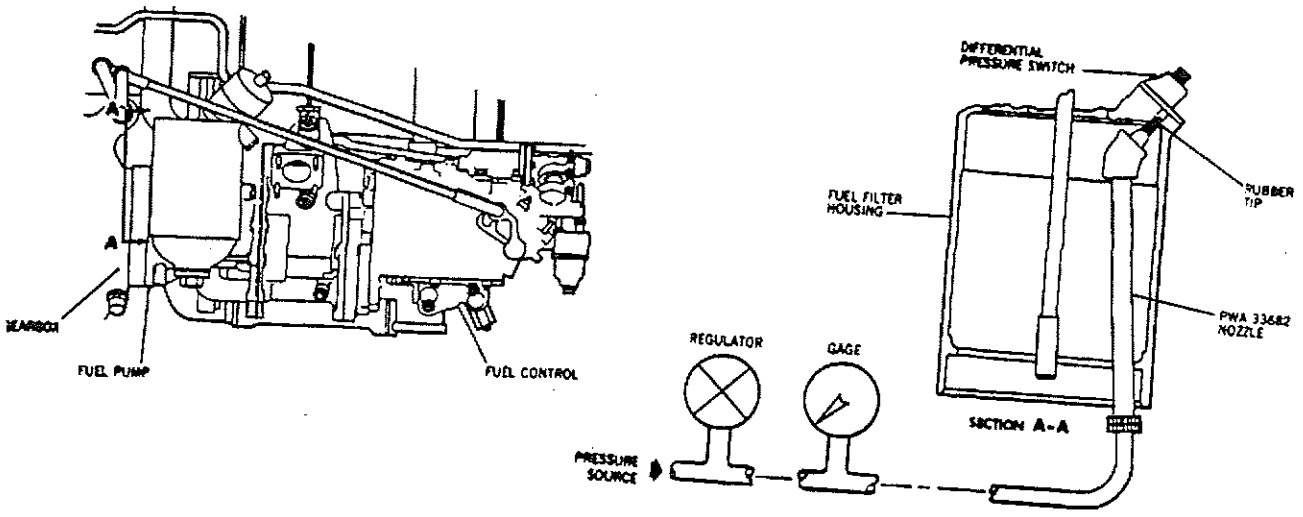

8882-73-20

Fuel Filter Differential Pressure Switch - Check  
Figure 3:



Equipment MD80  
System 73  
Workzone 71

Skill 0  
Section 8  
Pattern

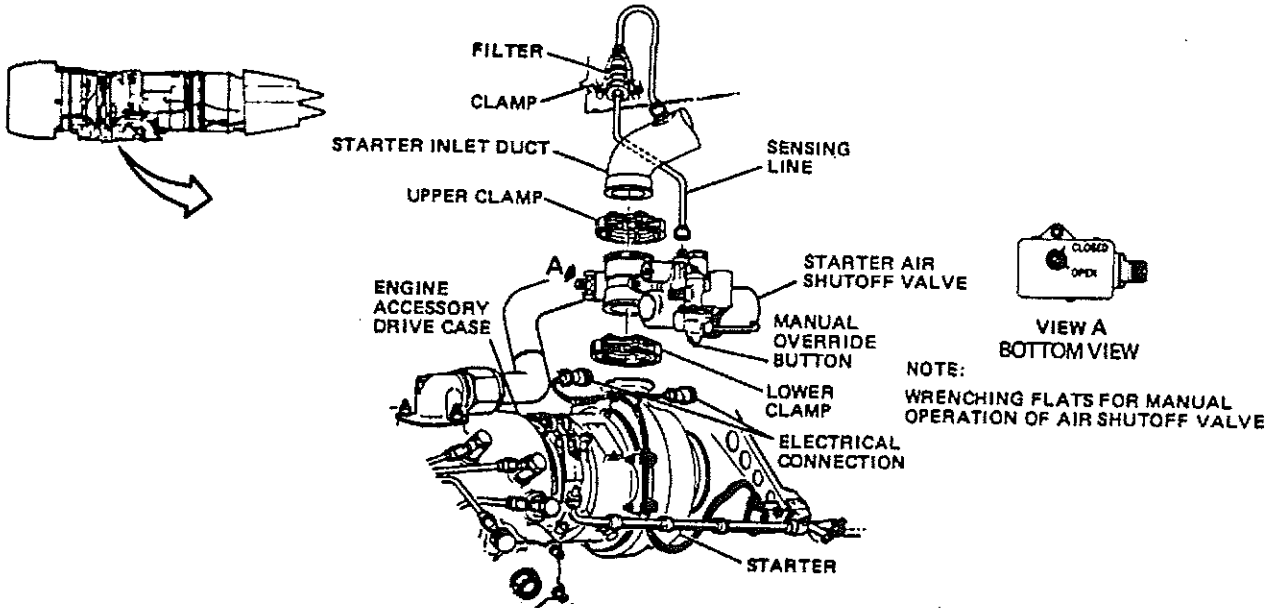

8882-90-7

Starter Air Shutoff Valve - Installation  
Figure 4:

Card No. **7751**

Page 12 of 12

Rev. Date 03/16/2006



Equipment MD80

Skill 0

System 73

Section 8

Workzone 71

Pattern

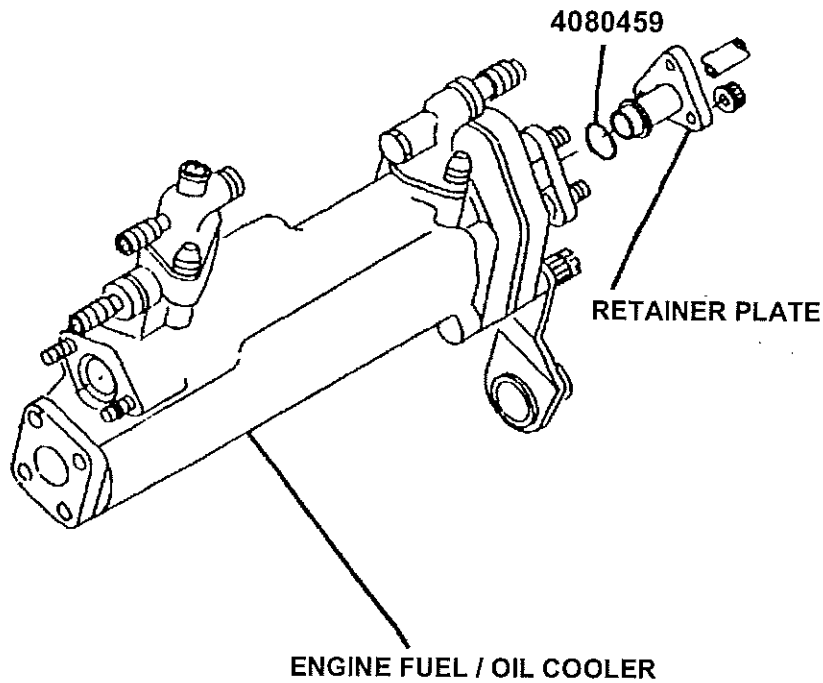

Figure 5: