

APPENDIX C
Preferred Alternative
Conceptual Plan and Graphics

Visual Simulation of Preferred Alternative

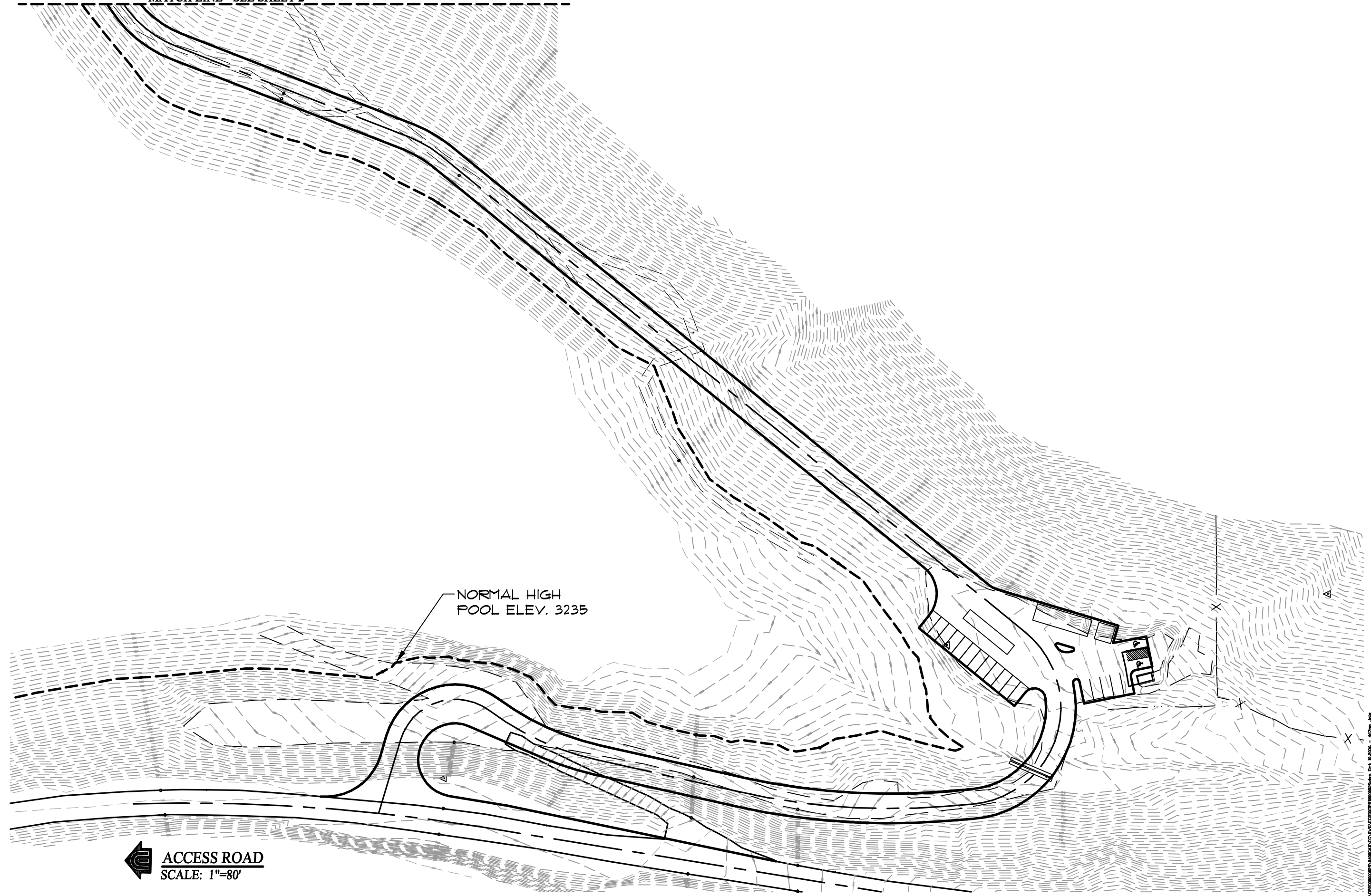

MATCH LINE - SEE SHEET 2



ACCESS ROAD
 SCALE: 1"=80'

NORMAL HIGH
 POOL ELEV. 3235

PRELIMINARY
LAYOUT
PLAN



POWDER HOUSE COVE BOAT
 LAUNCH FACILITY
 PRINEVILLE RESERVOIR
 CROOK COUNTY, OREGON

**DAVID EVANS
 AND ASSOCIATES INC.**
 709 NW Wall Street, Suite 102
 Bend, Oregon 97701 (541) 389-7614

DESIGNER	JULE	CHECKED	JOCK
DRAWN	JULE		
DATE	AUGUST 2008		
SCALE	AS SHOWN		
FILE			
			REVISIONS

1 of 5

P:\2008\080808\080808.dwg, 11/11/2008, 11:11:11 AM, 11/11/2008, 11:11:11 AM

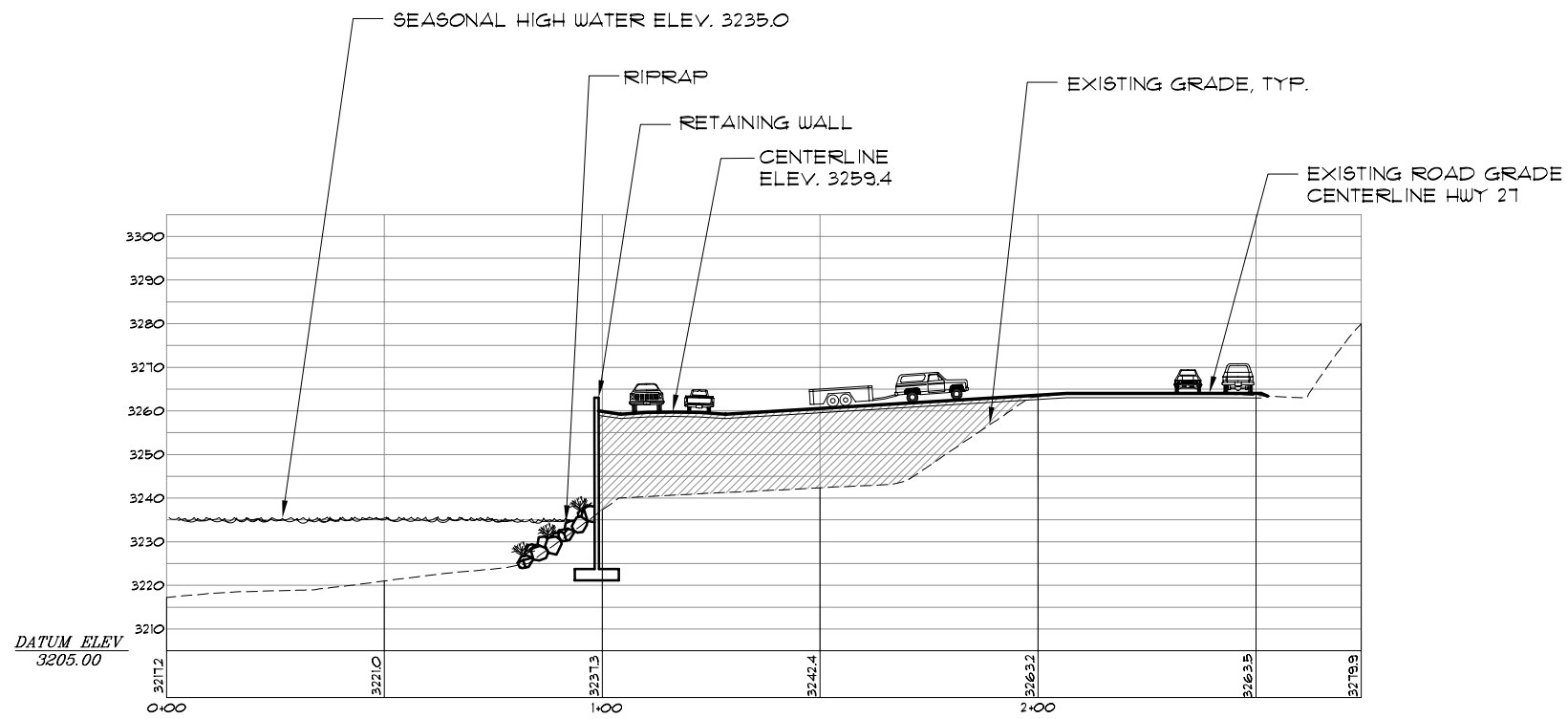

SECTION AT HIGHWAY 21 ENTRANCE ROAD

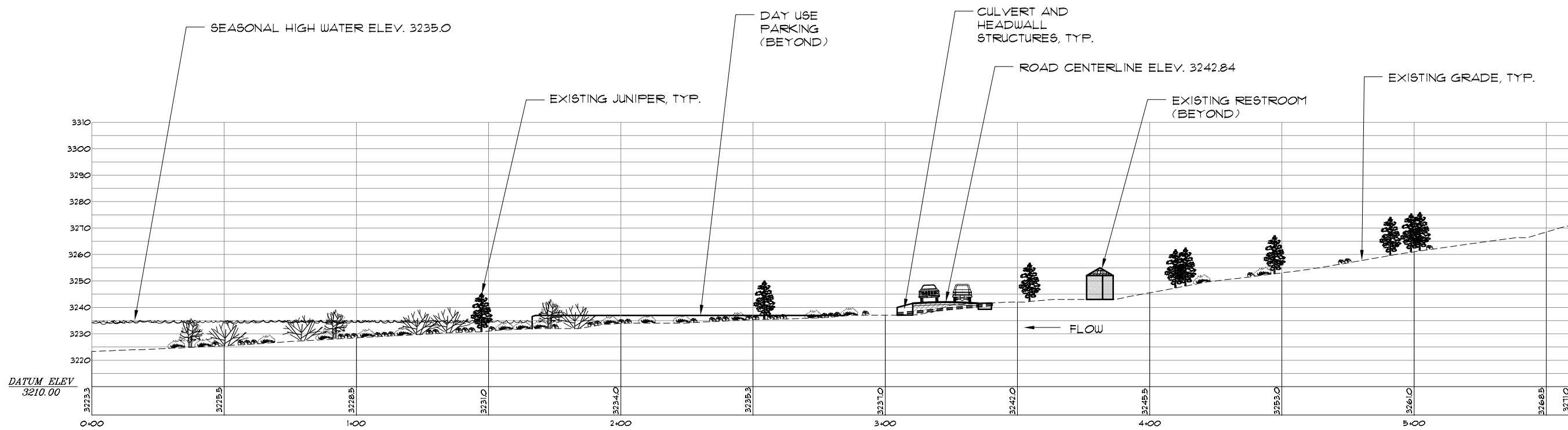

SECTION AT DRAINAGE CROSSING



PRELIMINARY
DESIGN

POWDERHOUSE COVE AT
PRINEVILLE RESERVOIR
CROOK COUNTY, OREGON



DAVID EVANS
AND ASSOCIATES, INC.
709 NW Wall Street, Suite 102
Bend, Oregon 97701 (541) 889-7614

DESIGN	DPO	CHECKER	
DRAWN	CRHU		
DATE	06/21/08		
SCALE	1" = 20'		
FILE	SECTION2.dwg		
			REVISIONS

SHEET 3 OF 5

P:\Projects\062108\062108.dwg

DESIGN: DPO	CHECKER:	
DRAWN: CRHU		
DATE: 06/21/08		
SCALE: 1" = 20'		
FILE: SECTION4.dwg		REVISIONS

SHEET **4** OF **5**

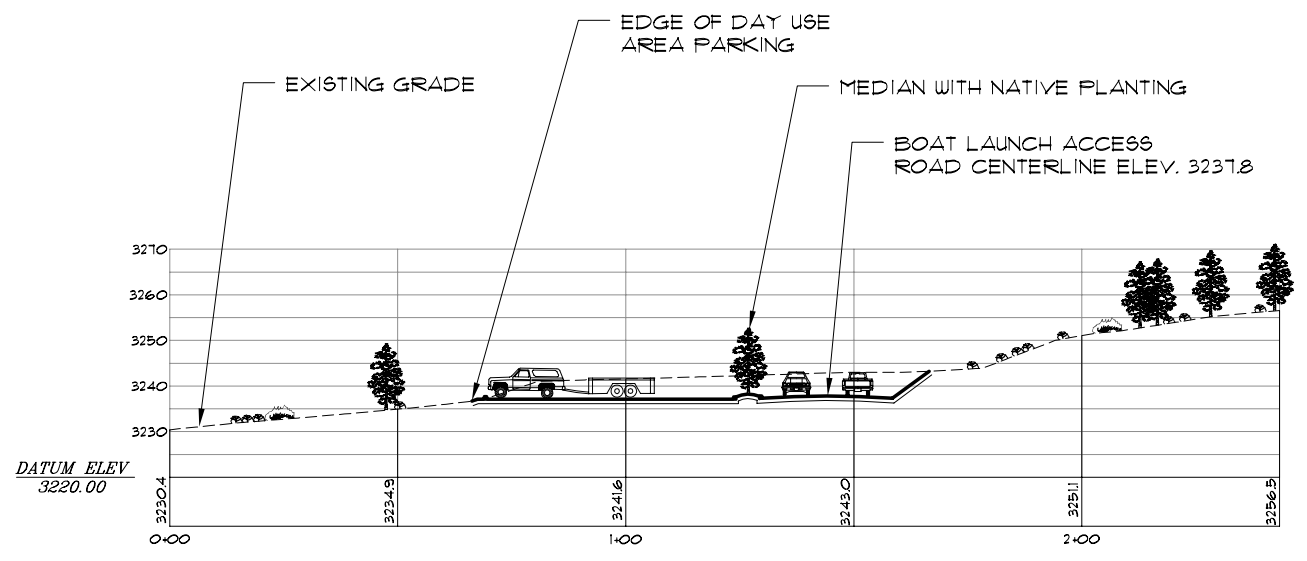

SECTION AT DAY USE PARKING AREA

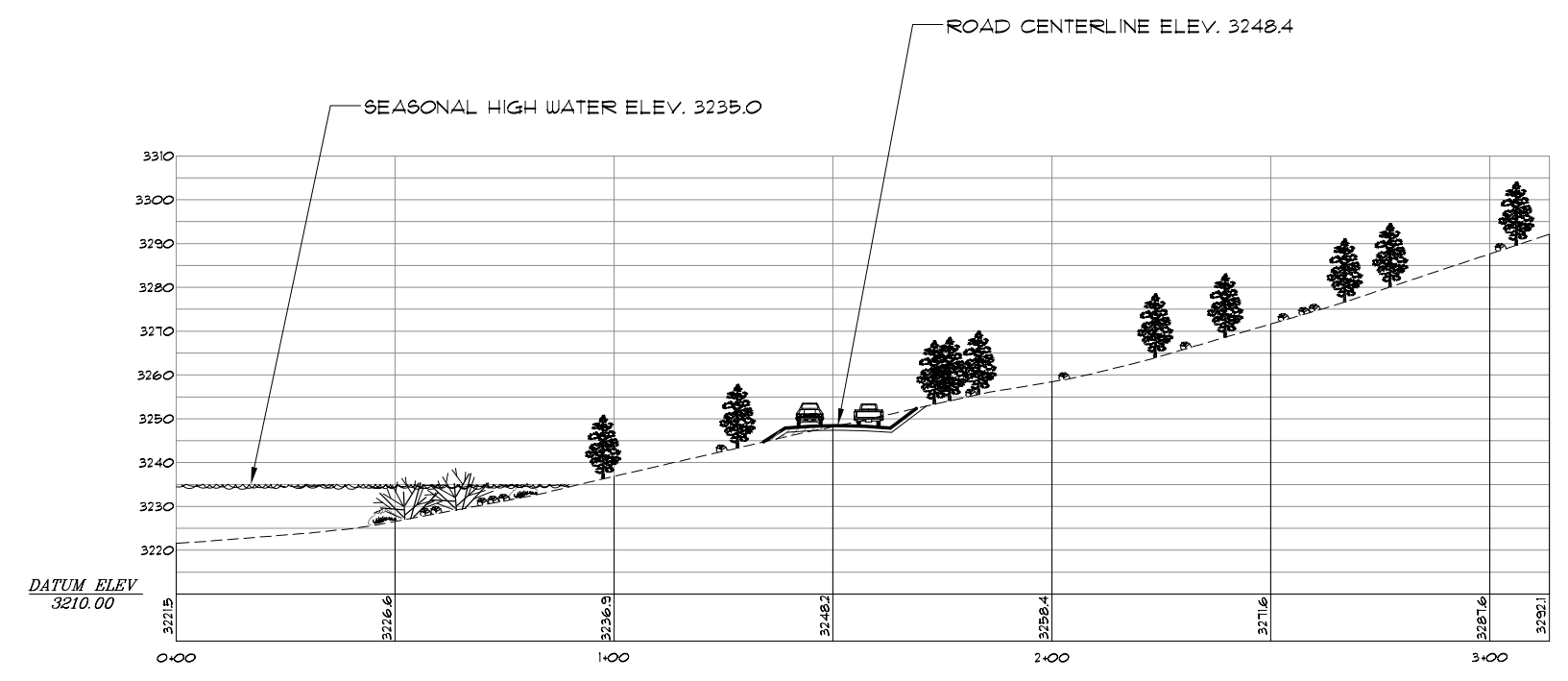

SECTION AT ENTRY ROAD



P:\2008\062108\062108.dwg:SECTION4.dwg Oct 16, 2008 - 8:44am Chu

