



Order No. 19-09-04
USDA Forest Service
Lake Tahoe Basin Management Unit
Roundhill Fuel Reduction Project

Pursuant to 36 CFR 261.50(a), and to provide for public safety, the following act is prohibited within the Lake Tahoe Basin Management Unit. This Order is effective from 7:00 a.m. to 6:00 p.m., Monday through Friday, April 27, 2009, through July 15, 2009.

Going into or being upon Units 21, 22, 23, 24 or 25 of the Roundhill Fuel Treatment Area. The boundary of Units 21, 22, 23, 24 and 25 of the Roundhill Fuel Treatment area begins at the fenceline of Nevada Beach Campground near the west edge of Section 22, Township 18 North, Range 18 East, Mount Diablo Base and Meridian, then continues east 3,200 feet to US Highway 50, then continues southwest 2,100 feet along the unnamed trail to its intersection with Burke Creek and the Lam Wah Tah Trail, then follows Burke Creek west 3,200 feet until it intersects with the north/south fenceline of the Nevada Beach Campground, then continues north along the fenceline back to the starting point, as shown on the attached map.
36 CFR 261.53(e).

Pursuant to 36 CFR 261.50(e), the following persons are exempt from this Order:

1. Persons with a permit from the Forest Service specifically authorizing the otherwise prohibited act or omission.
2. Any Federal, State or local officer, or member of an organized rescue or fire fighting force in the performance of an official duty.

This prohibition is in addition to the general prohibitions in 36 CFR Part 261, Subpart A.

Done at South Lake Tahoe, California, this 22 day of April, 2009.





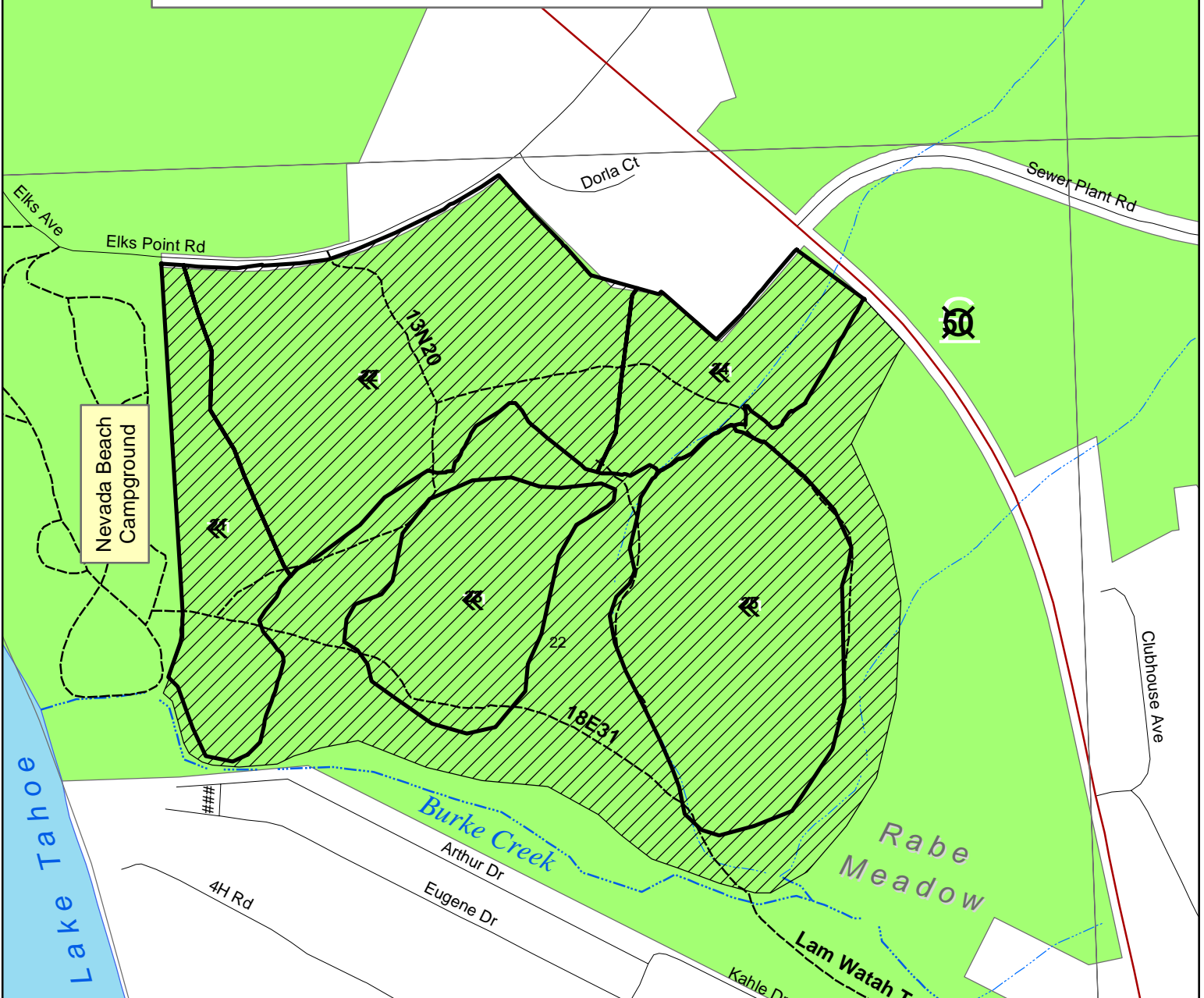

TERRI MARCERON
Forest Supervisor

A violation of this prohibition is punishable by a fine of not more than \$5,000 for an individual or \$10,000 for an organization, or imprisonment for not more than six months, or both.
16 USC 551 and 18 USC 3559, 3571, and 3581.

Roundhill Fuel Treatment Area Closure Order No. 19-09-04



 **Closed to Public Entry**
From 7:00 a.m. to 6:00 p.m.

-  National Forest
-  Other
-  Treatment Area
-  Local Road
-  Forest Road/Trail



T13N
R18E