



United States
Department of
Agriculture

Forest
Service

Hiawatha National Forest
2727 North Lincoln Road
Escanaba, MI 49829

(906) 786-4062
Fax (906) 789-3311
TDD (906) 789-3337

File Code: 1530
Route To: 5300

Date: January 31, 2003

Subject: Forest Supervisor Orders

To: Districts

District Mailrooms:

Enclosed are four attachments to be added to Forest Supervisor Order #5300/10/00/08 dealing with seasonal road closures on the Rapid River/Manistique Ranger District. Please take a moment and update your white "Hiawatha National Forest" binders that should be located at your front counters.

This info should be kept at the front counter for the general public to view if requested.

Should you have any questions, please do not hesitate to contact either Cathy Boudreau or myself at this office.

Sincerely,

Thomas E. Barton
Patrol Captain



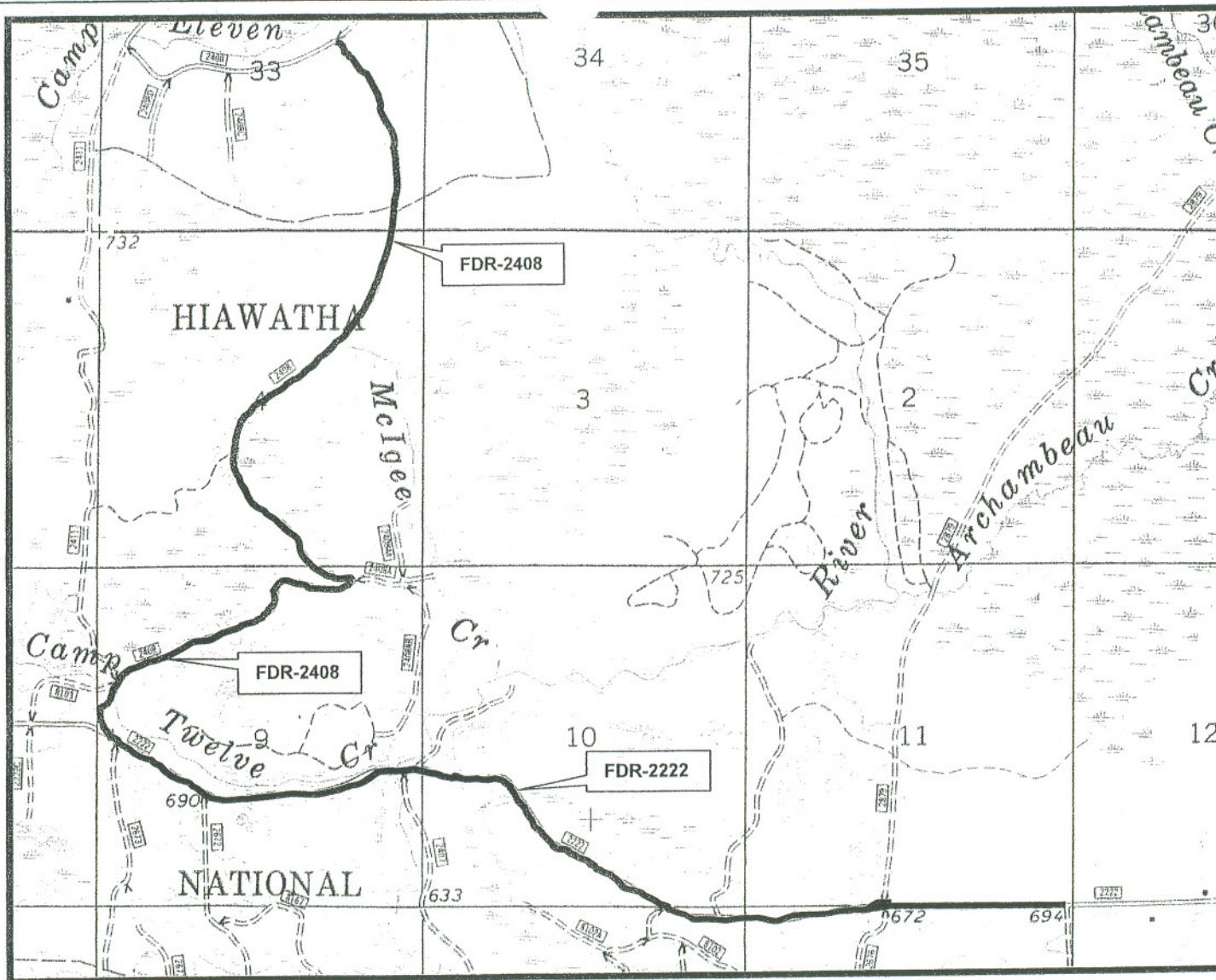

T42N

T41N

R18W



CONTOUR INTERVAL 10 FEET
DATUM IS MEAN SEA LEVEL

**ROAD CLOSURES
FOR WINTER
2003**
HIAWATHA NATIONAL FOREST
FDR-2222, FDR-2408

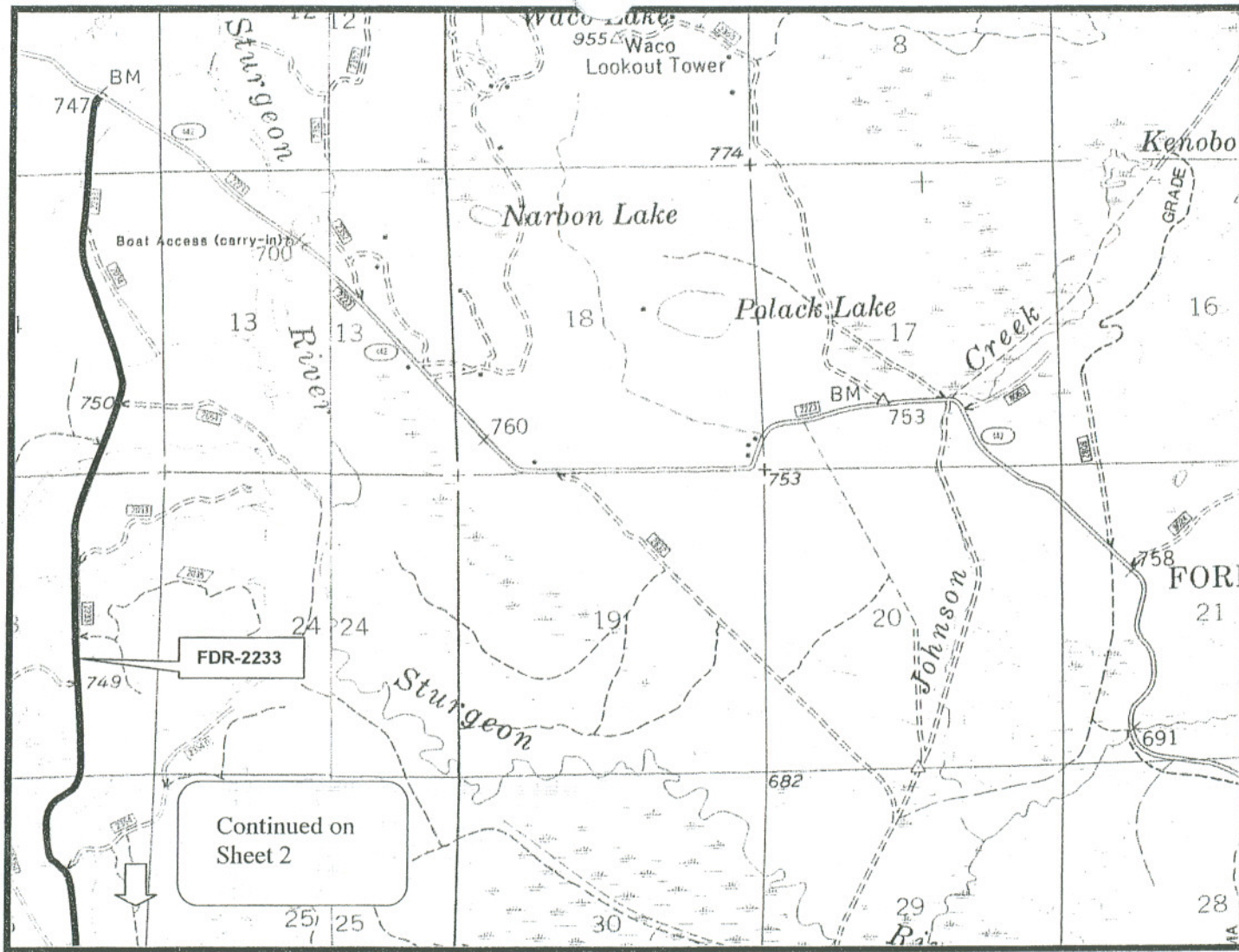

T42N

R20W R19W



**ROAD CLOSURES
FOR WINTER
2003**
HIAWATHA NATIONAL FOREST
FDR-2229, FDR-2233 Sheet 1

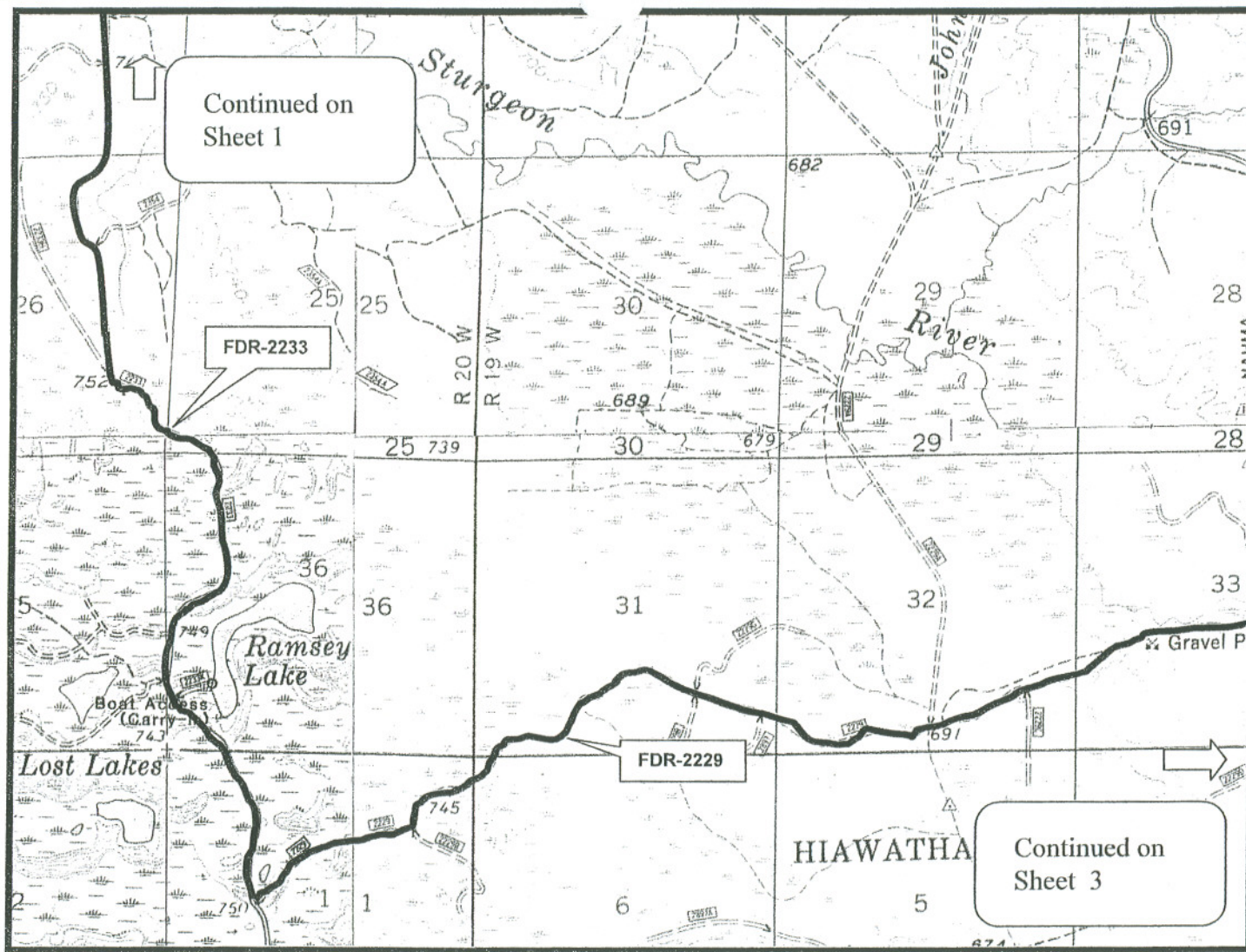

Continued on
Sheet 1

FDR-2233

FDR-2229

Continued on
Sheet 3

T42N

T41N

R20W R19W

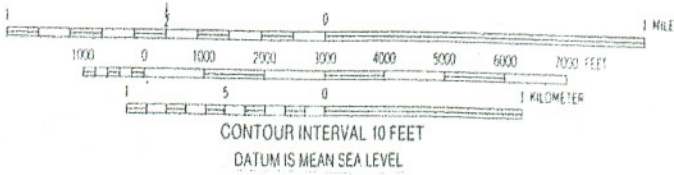

**ROAD CLOSURES
FOR WINTER
2003**
HIAWATHA NATIONAL FOREST
FDR-2229, FDR-2233 Sheet 2

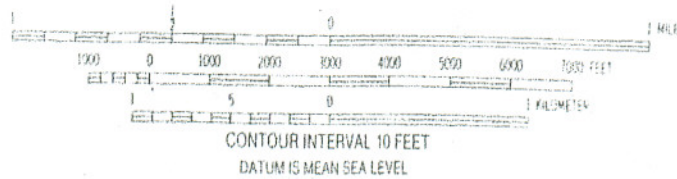
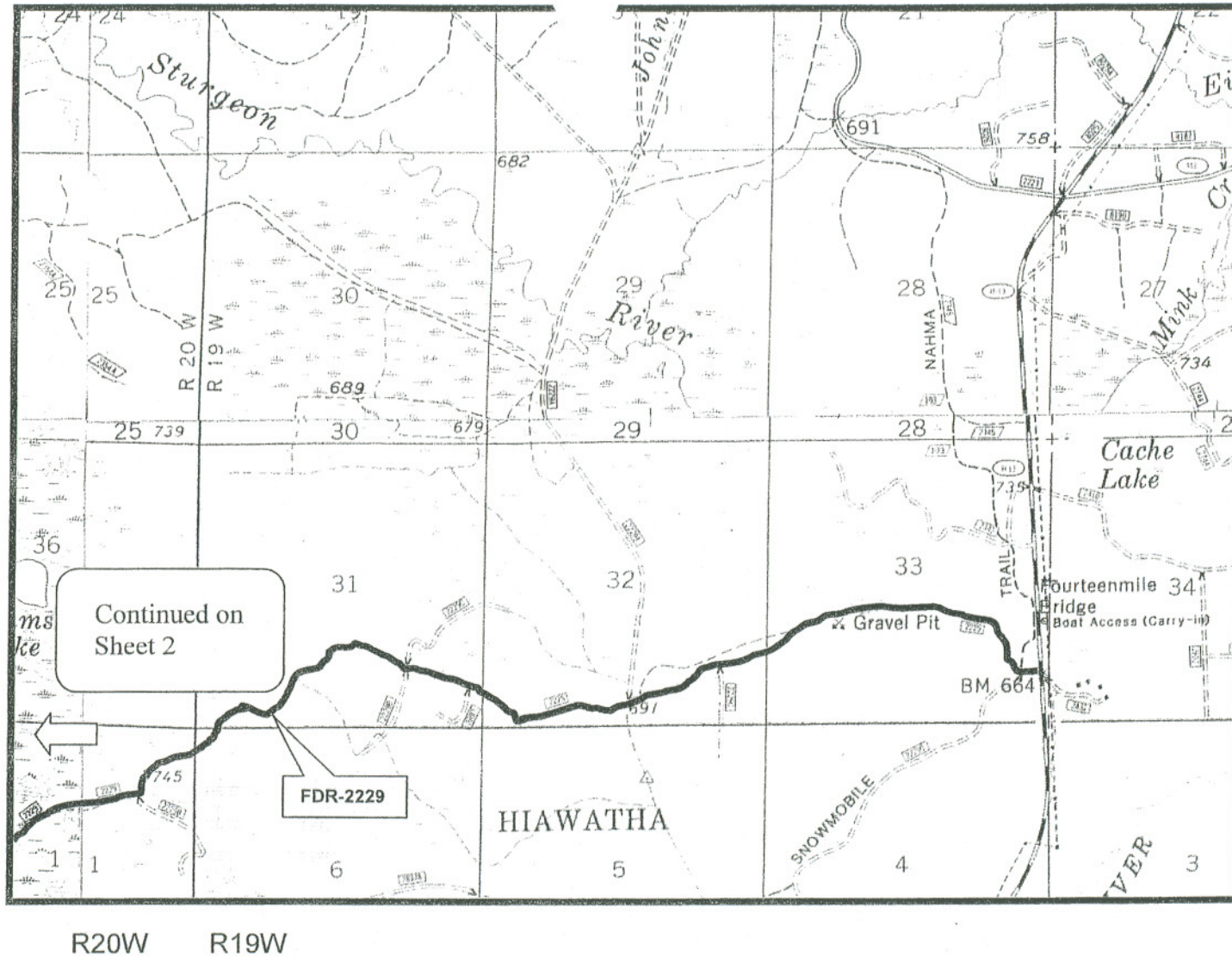

**ROAD CLOSURES
FOR WINTER
2003**
HIAWATHA NATIONAL FOREST
FDR-2229, FDR-2233 Sheet 3