

Client Information Sheet

For

Metacam® (meloxicam) 0.5 mg/mL Oral Suspension

Non-steroidal anti-inflammatory drug for oral use in dogs only

This summary contains important information about Metacam. You should read this information before you start giving your dog Metacam and review it each time the prescription is refilled. This sheet is provided only as a summary and does not take the place of instructions from your veterinarian. Talk to your veterinarian if you do not understand any of this information or if you want to know more about Metacam.

What Is Metacam?

Metacam is a prescription non-steroidal anti-inflammatory drug (NSAID) that is used to control pain and inflammation (soreness) due to osteoarthritis in dogs. Osteoarthritis (OA) is a painful condition caused by “wear and tear” of cartilage and other parts of the joints that may result in the following changes or signs in your dog: Limping or lameness, decreased activity or exercise (reluctance to stand, climb stairs, jump or run, or difficulty in performing these activities) stiffness or decreased movement of joints. Metacam is given to dogs by mouth. **Do not use in cats.**

What Kind Of Results Can I Expect When My Dog Is On Metacam For OA?

While Metacam is not a cure for osteoarthritis, it can control the pain and inflammation of OA and improve your dog’s mobility.

- Response varies from dog to dog but can be quite dramatic.
- In most dogs, improvement can be seen in a matter of days.
- If Metacam is discontinued or not given as directed, your dog’s pain and inflammation may come back.

What Dogs Should Not Take Metacam?

Your dog should not be given Metacam if he/she:

- Has had an allergic reaction to meloxicam, the active ingredient of Metacam.
- Has had an allergic reaction (such as hives, facial swelling, or red or itchy skin) to aspirin or other NSAIDs
- Is presently taking aspirin, other NSAIDs, or corticosteroids (unless directed by your veterinarian).

Metacam Should Only Be Given To Dogs

People should not take Metacam. Keep Metacam and all medication out of reach of children. Call your physician immediately if you accidentally take Metacam.

How To Give Metacam To Your Dog.

The actual dose to be given should be prescribed by the veterinarian.

Directions for Administration:

Dogs under 10 pounds (4.5 kg)

Shake well before use, then remove cap. Particular care should be given with regard to the accuracy of dosing.

To prevent accidental overdosing of small dogs, administer drops on food only, never directly into the mouth. Carefully measure suspension onto food to assure that the correct dose is given before presentation of the food to the dog. The syringe provided with the meloxicam concentration of 0.5 mg/mL cannot be used to measure doses for dogs weighing less than 1 lb (0.45 kg).

For dogs less than 1 lb (0.45 kg), Metacam® Oral Suspension can be given using the dropper bottle: two drops for each pound of body weight for the 0.5 mg/mL concentration (five drops for each kilogram of body weight), dropped directly onto the food.

For dogs between 1-10 pounds, Metacam® Oral Suspension can be given by drops or by using the measuring syringe provided in the package (see dosing procedure below). The syringe fits on to the bottle and has a scale beginning at 1 lb, designed to deliver the daily maintenance dose (0.05 mg/lb or 0.1 mg/kg). When using the syringe, the dog’s weight should be rounded down to the nearest 1 pound increment. Replace and tighten cap after use.

Dogs over 10 pounds (4.5 kg)

Shake well before use then remove cap. Metacam® Oral Suspension may be either mixed with food or placed directly into the mouth. Particular care should be given with regard to the accuracy of dosing. Metacam® Oral Suspension can be given using the measuring syringe provided in the package (see dosing procedure below). The syringe fits on to the bottle and has a scale in pounds designed to deliver the daily maintenance dose (0.05 mg/lb or 0.1 mg/kg). When using the syringe, the dog’s weight should be rounded down to the nearest 1 lb increment. Alternatively, Metacam® Oral Suspension can be given using the dropper bottle: two drops for each pound body weight for the 0.5 mg/mL concentration (five drops for each kilogram of body weight). Replace and tighten cap after use.

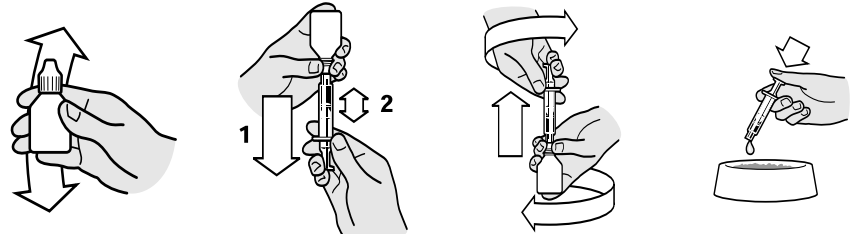

Shake bottle well. Push down and unscrew bottle top. Attach the dosing syringe to the bottle by gently pushing the end on to the top of the bottle.

Turn the bottle/syringe upside down. Pull the plunger out until the black line on the plunger corresponds to the dog’s body weight in pounds.

Turn the bottle right way up and with a twisting movement separate the dosing syringe from the bottle.

Push the plunger to empty the contents of the syringe.