



DEC 26 2000

December 18, 2000

Roger Little, Information Officer
Research and Special Programs Administration
Department of Transportation
Room 7128
400 Seventh St, S.W.
Washington DC 20590

Dear Mr. Little:

Attached please find information on pipeline abandonment in place under the Illinois River per agreement #6472 between TransMontaigne Pipeline and the State of Illinois dated 5/4/98. We are forwarding this information per Department of Transportation, Research and Special Programs Administration Part 195 (Amended) Section 195.59 (b).

Sincerely,

A handwritten signature in black ink that reads 'Dave Lechtenberg'.

Dave Lechtenberg
District Manager
TransMontaigne Pipeline
1802 Robinhood Blvd.
Scherverville, IN 46375

(219) 322-4913

DLL:ram
Enc.

LINE ABANDONMENT IN PLACE-ILLINOIS RIVER -10-2-98

The section of line that was abandoned lay's west of HW 26, 50 foot west of valve site in Marshall County through the Preserve and under the Illinois River then commencing under the Saschawin Creek to 150 foot west. The abandoned pipe was purged of all fuel via 2-3 cup scrapers pushed with air. The line was then laid down in water and each end plated.

Attachments: Map of profile of crossing

TransMontaigne Pipeline

Randy Green

Area Manager



Legal Description
for
TransMontaigne Pipeline/ Illinois River Crossing
Marshall and Peoria Counties, Illinois

Location: (East Side) Part of Sections 33 & 34, Township 29 N., Range 3 W.,
Marshall County, Illinois
Latitude/ Longitude: 40°56'01" N., 89°27'20" W.

(West Side) Part of Section 15, Township 11 N., Range 9 E.,
Peoria County, Illinois
Latitude/ Longitude: 40°56'01" N., 89°27'36" W.

Description: The new 8" diameter petroleum products pipeline shall be installed at a depth of 5'-0" below existing grade and will run West from the existing block valve along the North side of the existing dirt/gravel maintenance road which runs parallel to the Crow Creek. The existing block valve is located approximately 1200 ft. South of the NE corner of Section 34, on the West side of State Hwy. 26, just North of the Crow Creek in Marshall County, Illinois. The new pipeline, will run West from the existing block valve approximately 4400 ft. to a manmade levee. At the levee, the new pipeline will be horizontally directionally drilled in a straight line under the bottom of the Illinois River and will be connected (tied-in) to the existing 8" pipeline within the TransMontaigne Pipeline, Inc. Right-of-Way in Peoria County, Illinois. The pilot hole or start of the directional drill will be located approximately 1400 ft. South and 700 ft. East of the NW corner of Section 34 in Marshall County. The directional drill will gradually decline reaching a maximum depth of 20 ft. below the bottom of the Illinois River (approximately 40 ft. below existing grade) then, gradually incline and exit at a point approximately 500 ft. from the West shoreline of the Illinois River. The exit hole for the directional drill will be located approximately 1200 ft. North and 1300 ft. East of the SW corner of Section 15 in Peoria County, Illinois.

The revised easement shall consist of a 100 ft. wide corridor, approximately 50 ft. to the North and 50 ft. to the South of the new pipeline. This new easement shall be approximately 7500 ft. in length from State Hwy. 26, West to the East shoreline of the Illinois River in Marshall County, Illinois. The existing easement in Peoria County, Illinois will not be revised. Upon completion of this project, the existing 8" pipeline in Marshall County, Illinois will be abandoned-in-place.

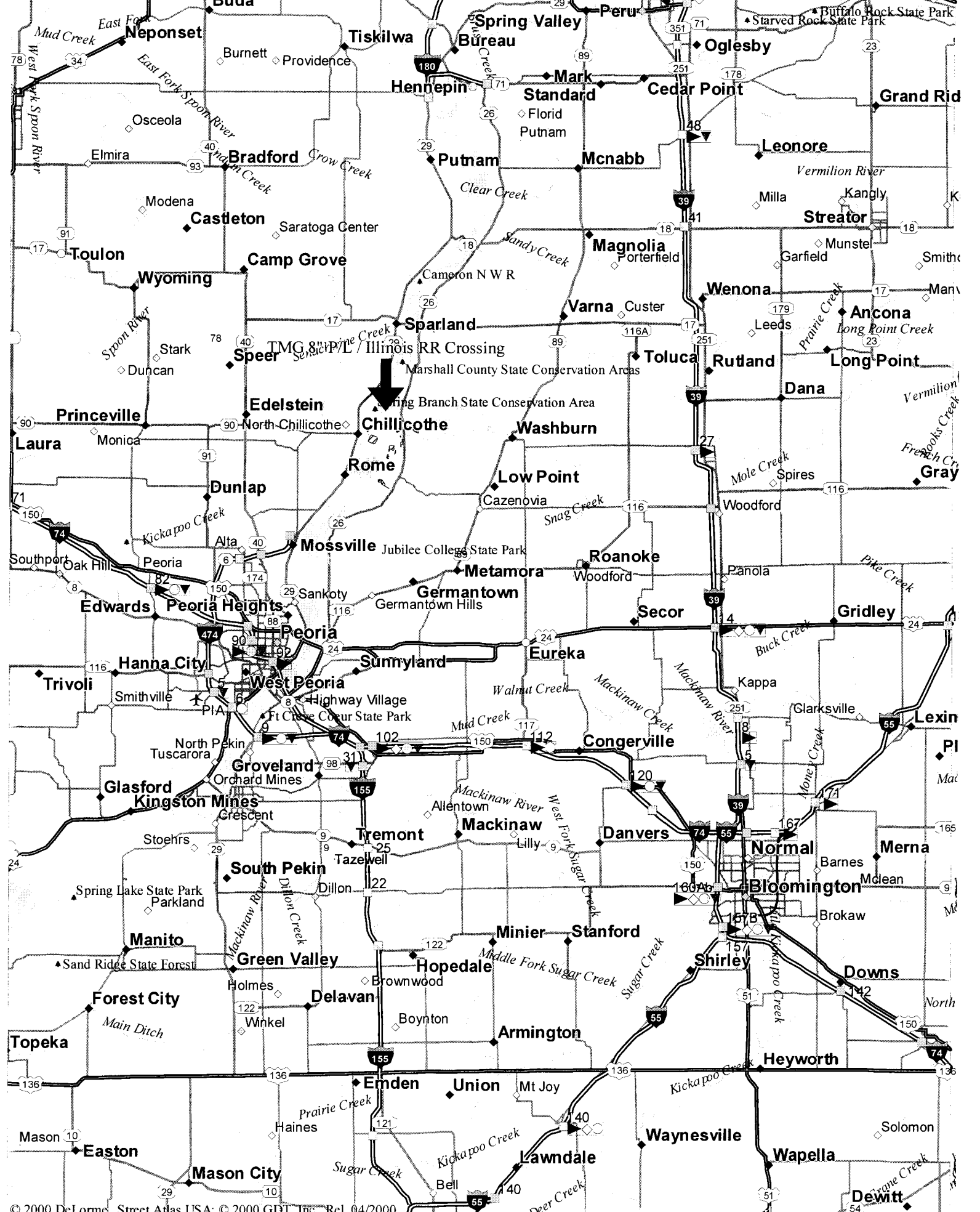



TransMontaigne Pipeline Inc.
P.O. Box 1501, Fayetteville, AR 72702 (501) 581-5565

NORCO MAINLINE CHICAGO TO GALESBURG
ILLINOIS RIVER - PROPOSED LINE LOWERING

CAD NO NWX00100.DWG
ROD BRYANT 10/97

SCALE: NONE
NO. NWX00100

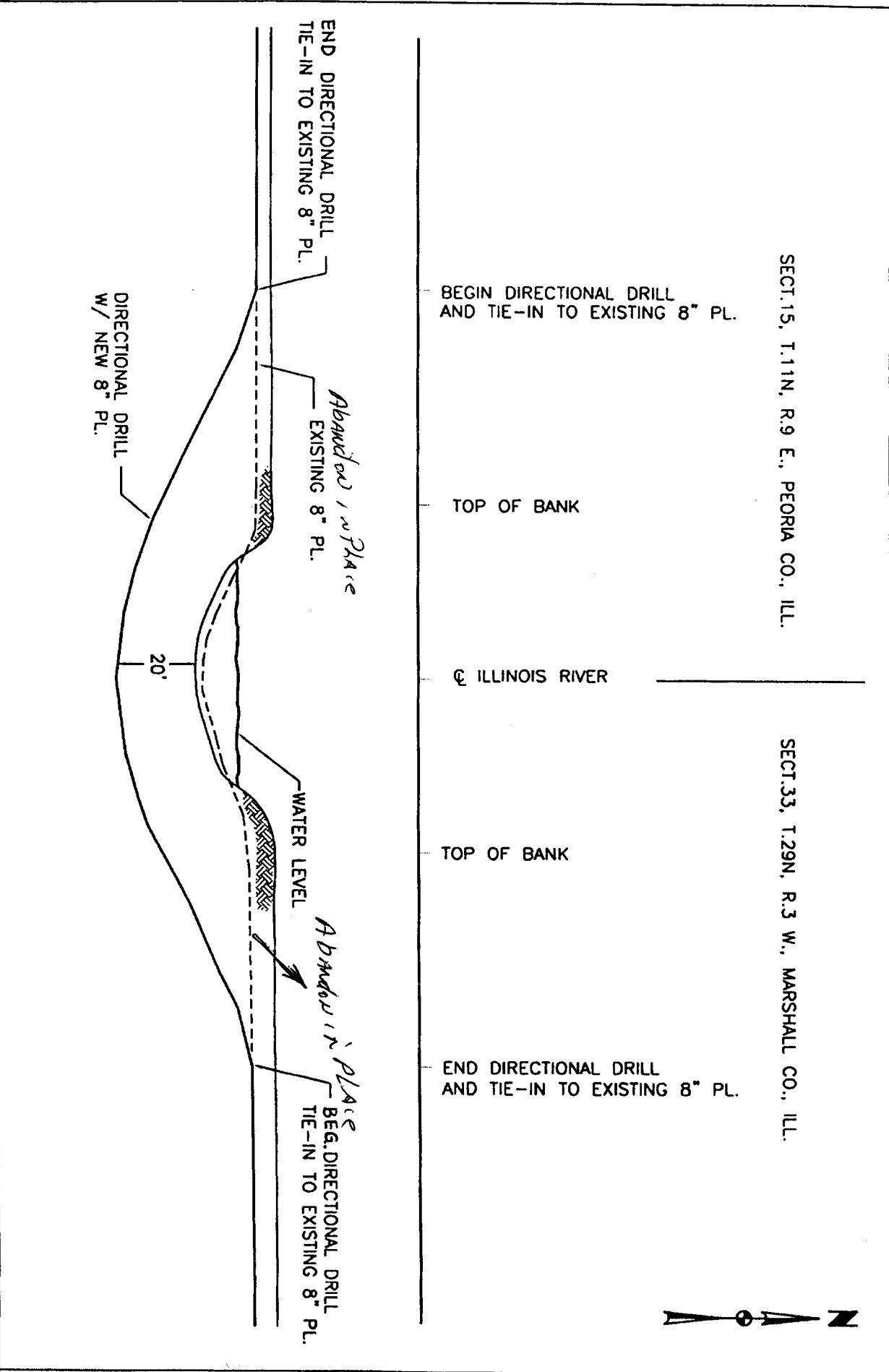

SECT. 15, T. 11N, R. 9 E., PEORIA CO., ILL.

SECT. 33, T. 29N, R. 3 W., MARSHALL CO., ILL.