





	Area
	NCAM - 43,400 ft ²
	COTS - 213,500 ft ²
	CEV - 34,000 ft ²

Updated 2/15/2007

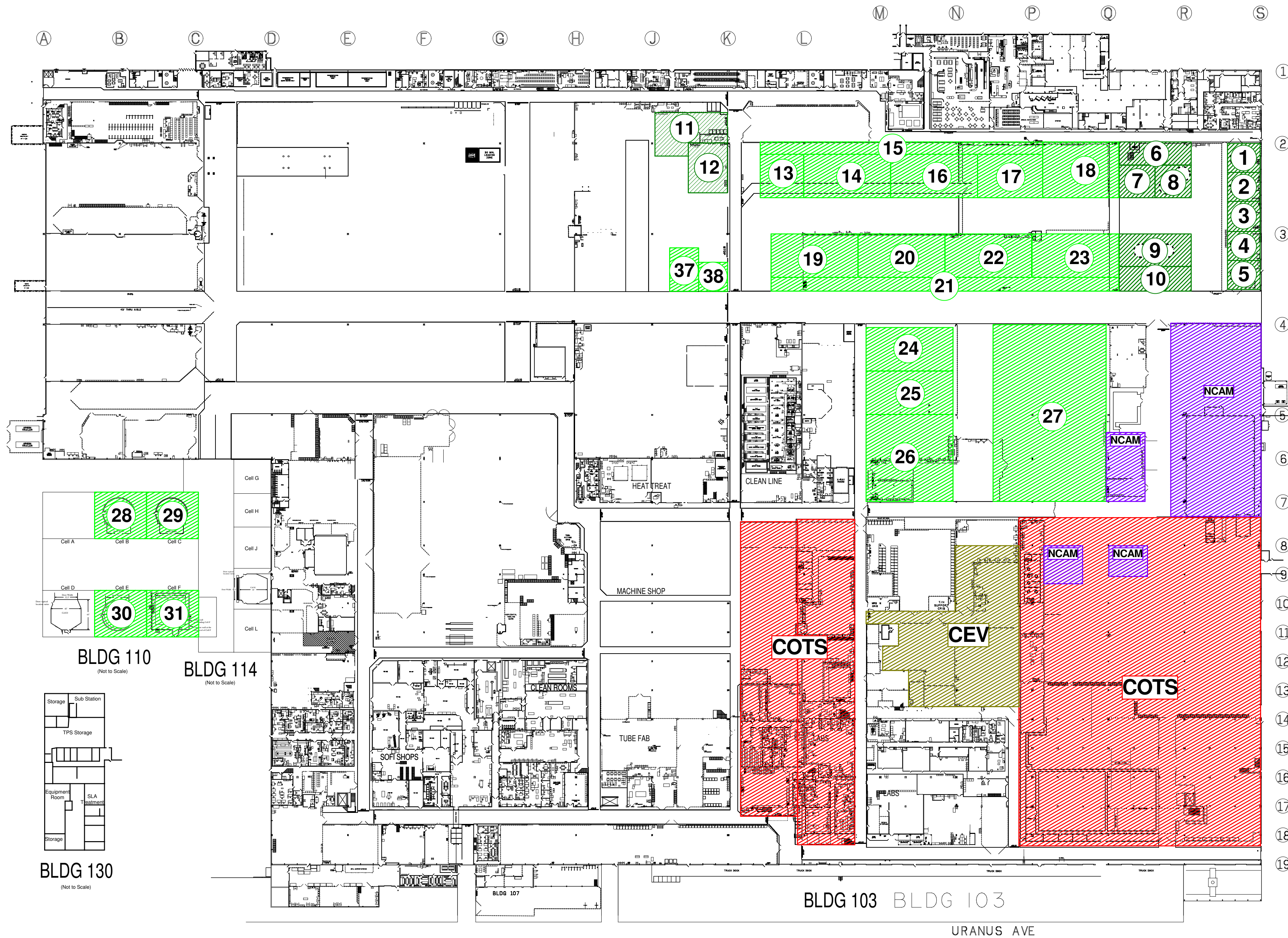

 CLV-Major Structural - 33,380 ft² (Bldg. 103)
 CLV-Final Assembly - 146,002 ft² (Bldg. 103)
Floor Space Total = 179,382 ft² (Bldg. 103)

- 1 CLV-RWT #1, Table #1
- 2 CLV-RWT #1, Table #2
- 3 CLV-RWT Staging
- 4 CLV-RWT #2, Table #1
- 5 CLV-RWT #2, Table #2
- 6 CLV-Major Weld and Slosh Baffle Staging
- 7 CLV-LOX, Major Weld
- 8 CLV-Roll Ring Install & Break-Over
- 9 CLV-LH2 Major Weld
- 10 CLV-Major Weld Staging
- 11 CLV-Flange Drill
- 12 CLV-Flange Trim
- 13 CLV Assy-J2, 120x60ft.
- 14 CLV Assy-LOX, 120x60ft.
- 15 CLV Assy-Staging Area
- 16 CLV Assy-LH2 Tank, 120x60ft.
- 17 CLV Assy-Thrust Structure, 90x60ft.
- 18 CLV Assy-Slosh Baffle, 105x77ft.
- 19 CLV Assy-Aft Skirt, 120x60ft.
- 20 CLV Assy-RCS, 120x60ft.
- 21 CLV Assy-Staging Area
- 22 CLV Assy-MPS, 120x60ft.
- 23 CLV Assy-Intertank, 120x60ft.
- 24 CLV Assy-Interstage, 120x60ft.
- 25 CLV Assy-TVC, 120x60ft.
- 26 CLV Assy-Instrument Unit, 120x120ft.
- 27 CLV Assy-Possible Horizontal Integration
- 28 CLV - SOFI Application, BLDG 110 Cell B
- 29 CLV Assy-Stack, BLDG 110 Cell C
- 30 CLV - Internal Clean, BLDG 110 Cell E
- 31 CLV - LOX Proof Test, BLDG 110 Cell F
- 32 CLV - External Prime, BLDG 131 Cell P
- 33 CLV -Proof Test, BLDG 451 & 452
- 34 CLV -TPS, BLDG 420 Cell 3
- 35 CLV - Integration & Check-out, BLDG 420 Cell 4
- 36 CLV - System Tunnel, BLDG 420 Cell 4
- 37 CLV - Vertical 5 Axis Gantry, 40x60ft.
- 38 CLV - Horizontal Machining Center 5 Axis, 40x40ft.

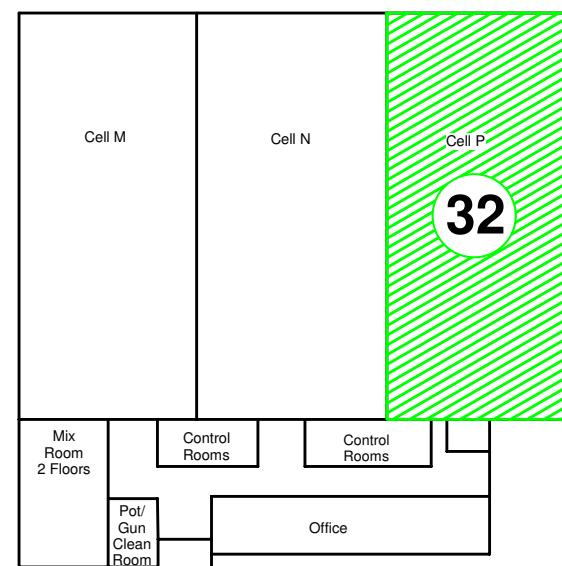

BLDG 131
(Not to Scale)

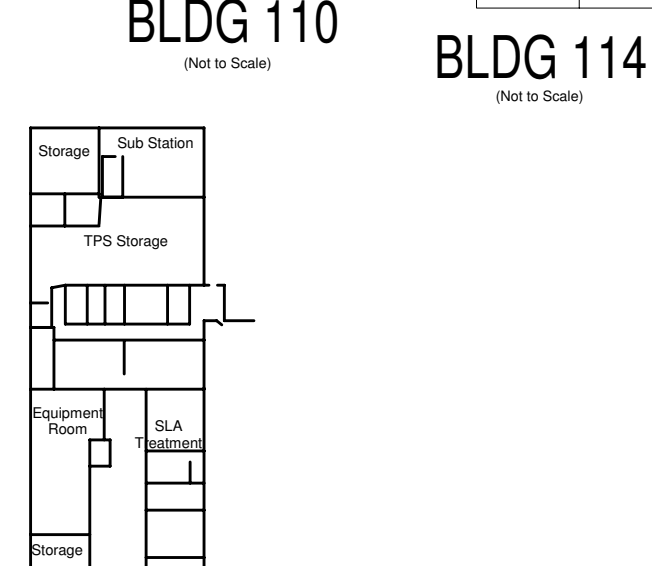

BLDG 110
(Not to Scale)

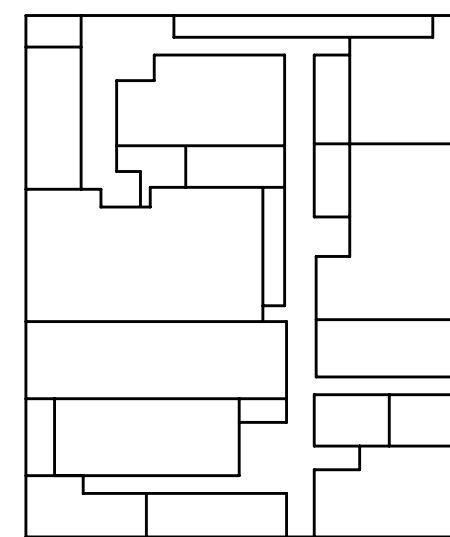

BLDG 318
(Not to Scale)

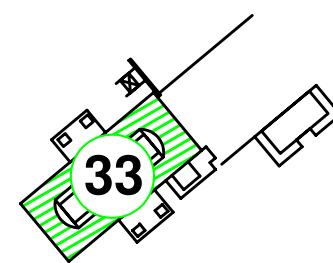

BLDG 451 & 452
(Not to Scale)

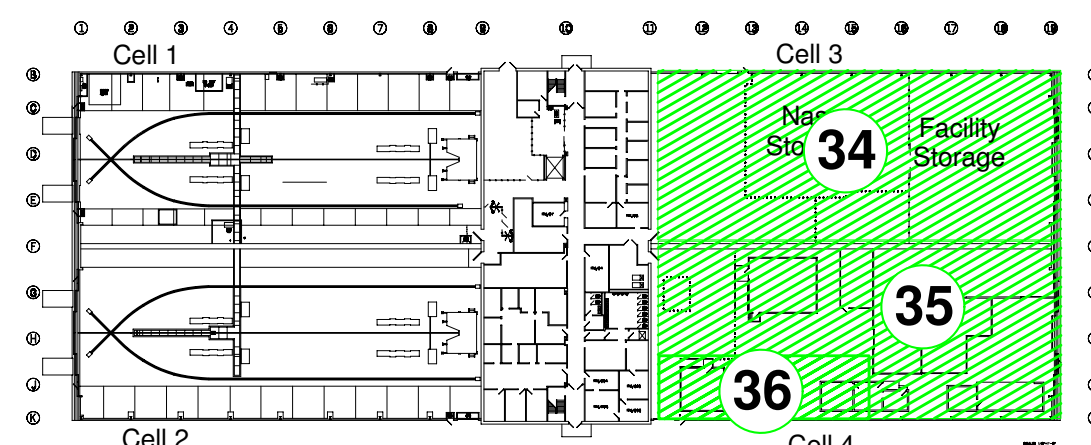

BLDG 420