



Yellowstone National Park www.nps.gov/yell

Education

The following centennial proposal is certified as eligible for Centennial Challenge funding consideration in fiscal year 2008. Funding for the Centennial Challenge requires legislation.

Plan, Design, and Construct a New Old Faithful Visitor Education Center

Location: Wyoming – Old Faithful
Partner(s): The Yellowstone Park Foundation
Partner Website: www.ypf.org
Total Cost: \$28,305,133
Proposal # 69189

Summary: Replace current deficient visitor center with a new, state of the art visitor education center to provide critical visitor information and orientation services, and enhance resource and visitor protection through education. The new visitor center will provide critical visitor services including information and orientation necessary to successfully and safely visit the park and the Upper Geyser Basin (the geyser basin in which Old Faithful Geyser and 200 other active geysers are found), and interpretation and education focused on the rare and outstanding geothermal phenomena of Yellowstone National Park. Currently, there are no exhibits to interpret Yellowstone's geothermal features, which are considered one of Yellowstone's primary/premiere resources and were a significant factor in the park's establishment. The building will be fully accessible, energy efficient, sustainable in design, and built using "green" construction materials and techniques. Unlike the existing structure, the replacement visitor center will fit gracefully into the historic Old Faithful landscape, and it will reflect the importance and value of its surroundings.

For more information contact:
Suzanne Lewis, Superintendent, (307) 344- 2002

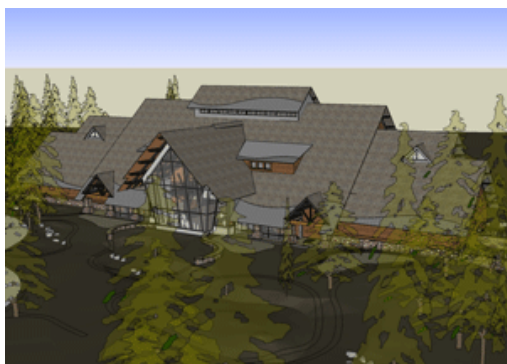

Artist's drawing of the new
visitor education center