

TRAVEL ORDER
 BIGHORN SHEEP TRAVEL MANAGEMENT AREA
 BLACK HILLS NATIONAL FOREST
 PACTOLA/HARNEY RANGER DISTRICT

Pursuant to 36 CFR 261.50(a) and (b), the following acts are prohibited in the area, on roads and utility line Rights of Way described in the portion of the Pactola/Harney Ranger District, Black Hills National Forest known as the Bighorn Sheep Area located in Sections 1, 2, 10, 11, 12, 13 and 14, T1S, R6E, BHM in Pennington County, South Dakota. The area is shown on the attached map.

(1) Possessing or using a vehicle off Forest Development Roads (FDR) 368, 369, 369.1A, 370, 514, 514.1A, 514.1B, 514.1C, 514.1D, 514.1E, 514.1F, 679.1A and utility line Rights of Way within the Bighorn Sheep Area. The length of the closure will be determined by a Cooperative Agreement between the South Dakota Game, Fish and Parks and the U. S. Forest Service. (36 CFR 261.56)

(2) Being on a road with a motorized vehicle in the travel management area. (36 CFR 261.54 (a))

Pursuant to 36 CFR 261.50(e), each of the following is exempted from this order:

- (1) Persons with a permit specifically authorizing the otherwise prohibited act or omission.
- (2) Owners or lessees of land in the area.
- (3) Any Federal, State or local officer, or member of an organized rescue or firefighting force in the performance of an official duty.

DONE at Custer, South Dakota, this 17 day of June, 1996.



 JOHN C. TWISS
 Forest Supervisor

Violation of this order is prohibited by the provisions of the regulations cited, and under 7 USC 1011(f), 16 USC 551, and 18 USC 3571. Any violation is subject to punishment by a fine of not more than \$5000 or imprisonment of not more than six months, or both.

BIGHORN SHEEP AREA CLOSURE

T1N

T1S

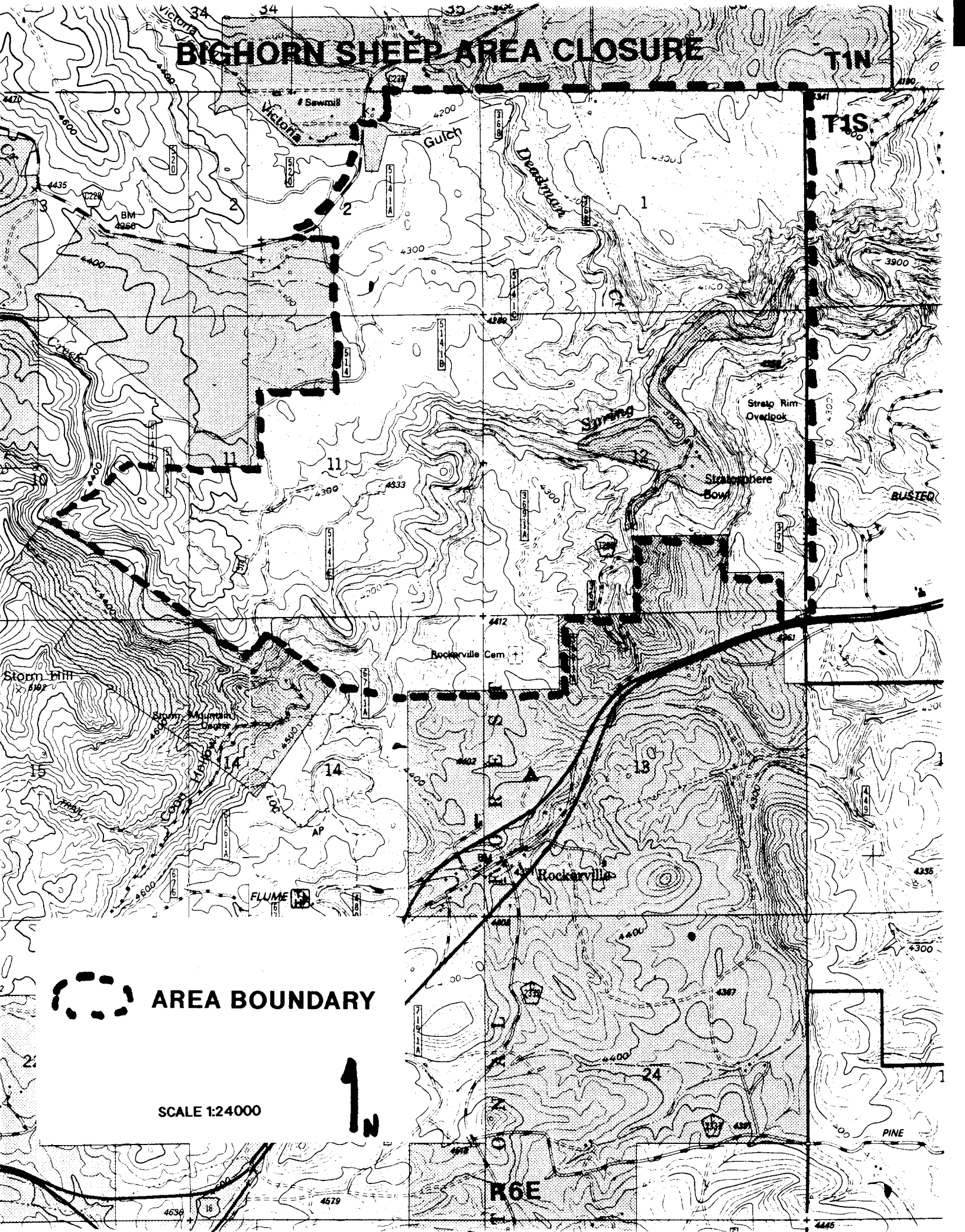

 AREA BOUNDARY

SCALE 1:24000



R6E

PINE