

ORDER

SPECIAL CLOSURE

BLACK HILLS NATIONAL FOREST

PURSUANT TO 36 CFR 261.50 (a) THE FOLLOWING IS PROHIBITED:

1. FOR PUBLIC HEALTH OR SAFETY THE USE OF EXPLOSIVES WITHIN THE BELOW DESCRIBED AREA IS PROHIBITED. (36 CFR 261.53)

WARREN PEAK NUCLEAR BURIAL SITE

T.52N., R.63W., 6th P.M.

Section 19: E $\frac{1}{2}$ E $\frac{1}{2}$ E $\frac{1}{2}$,

Section 29: Lot 2,

Section 20: Lots 1,2,3,4,5, N $\frac{1}{2}$, W $\frac{1}{2}$ SW $\frac{1}{4}$, and

two tracts of land situated within Mineral Survey #474 which is a part of the S $\frac{1}{2}$ of Section 20, more particularly shown on Exhibit A and described as follows:

A 0.90 acre tract of land situated in a portion of Smuglar No. 3, Lode Mining Claim, commencing at the Southwest corner of said Section 20; thence North 44° 17' 00" East 2962.00 feet to the Northwest corner of said Mineral Survey #474 and the point of beginning of said tract of land to be described; thence South 77° 50' 00" East 137.92 feet; thence South 51° 46' 42" East 74.78 feet; thence North 71° 27' 00" East 40.00 feet; thence South 39° 05' 34" East 103.08 feet; thence North 71° 27' 00" East 80.00 feet; thence South 61° 00' 00" West 130.00 feet; thence South 87° 12' 00" West 168.00 feet; thence North 55° 20' 14" West 98.83 feet; thence South 71° 27' 00" West 43.26 feet; thence North 12° 09' 00" East 149.30 feet to the point of beginning, and a 10.56 acre tract of land situated in portions of Smuglar No. 1 and No. 2 Lode Mining Claims.

Violation of this prohibition 36 CFR 261.53 is punishable by a fine of not more than \$500.00 or imprisonment for not more than six months or both (16 USC 551).

June 8, 1979
Date



JAMES R. MATHERS
Forest Supervisor

EXHIBIT "A"

SPECIAL CLOSURE ORDER

June 8, 1979

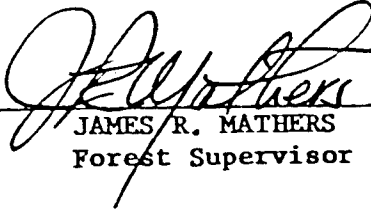
JAMES R. MATHERS, Forest Supervisor

R 63 W.

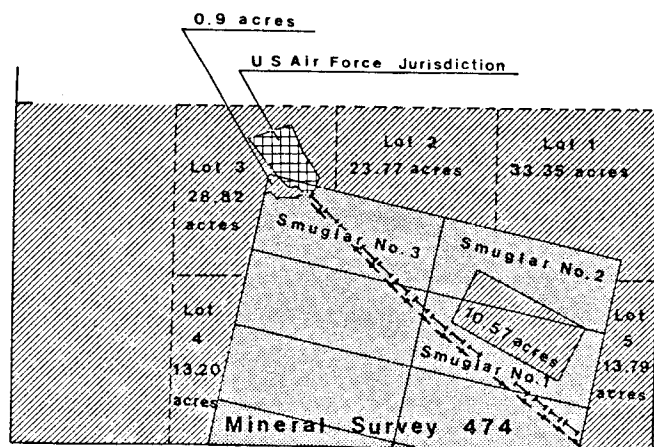
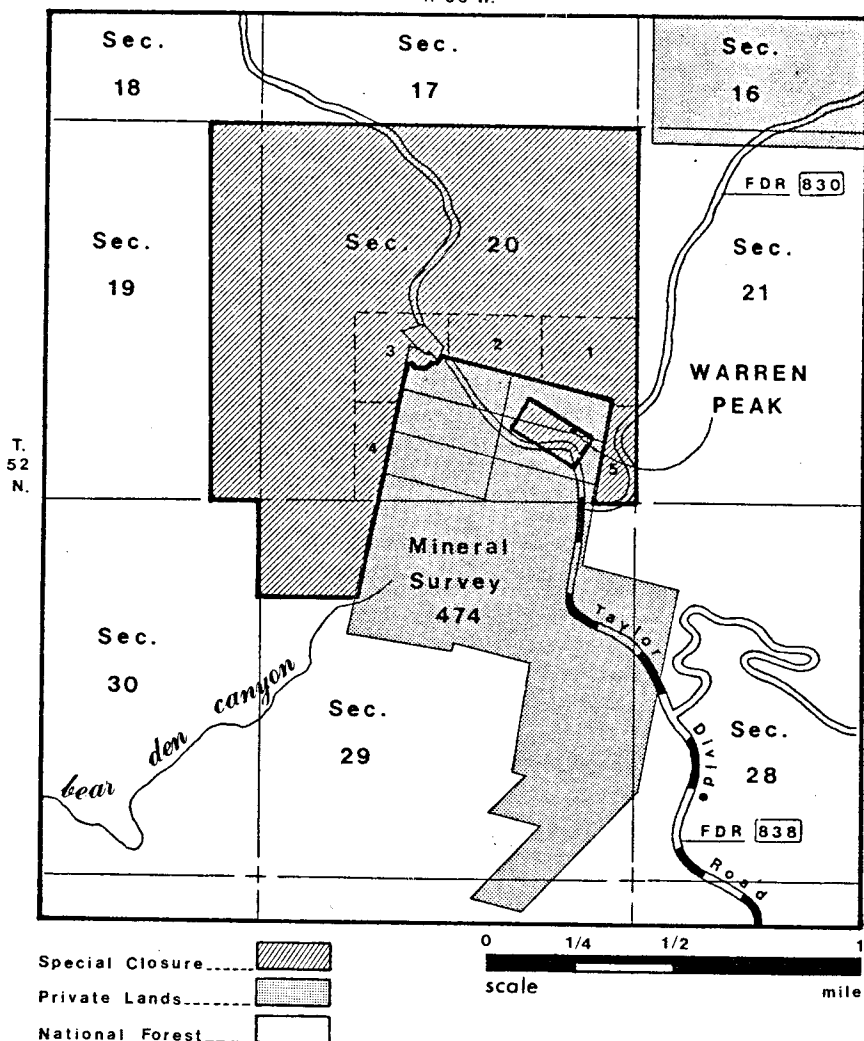

Enlargement of S $\frac{1}{2}$ of Section 20, T52N, R63W