

Figure 6.2-1. SWMU 32-001 site map

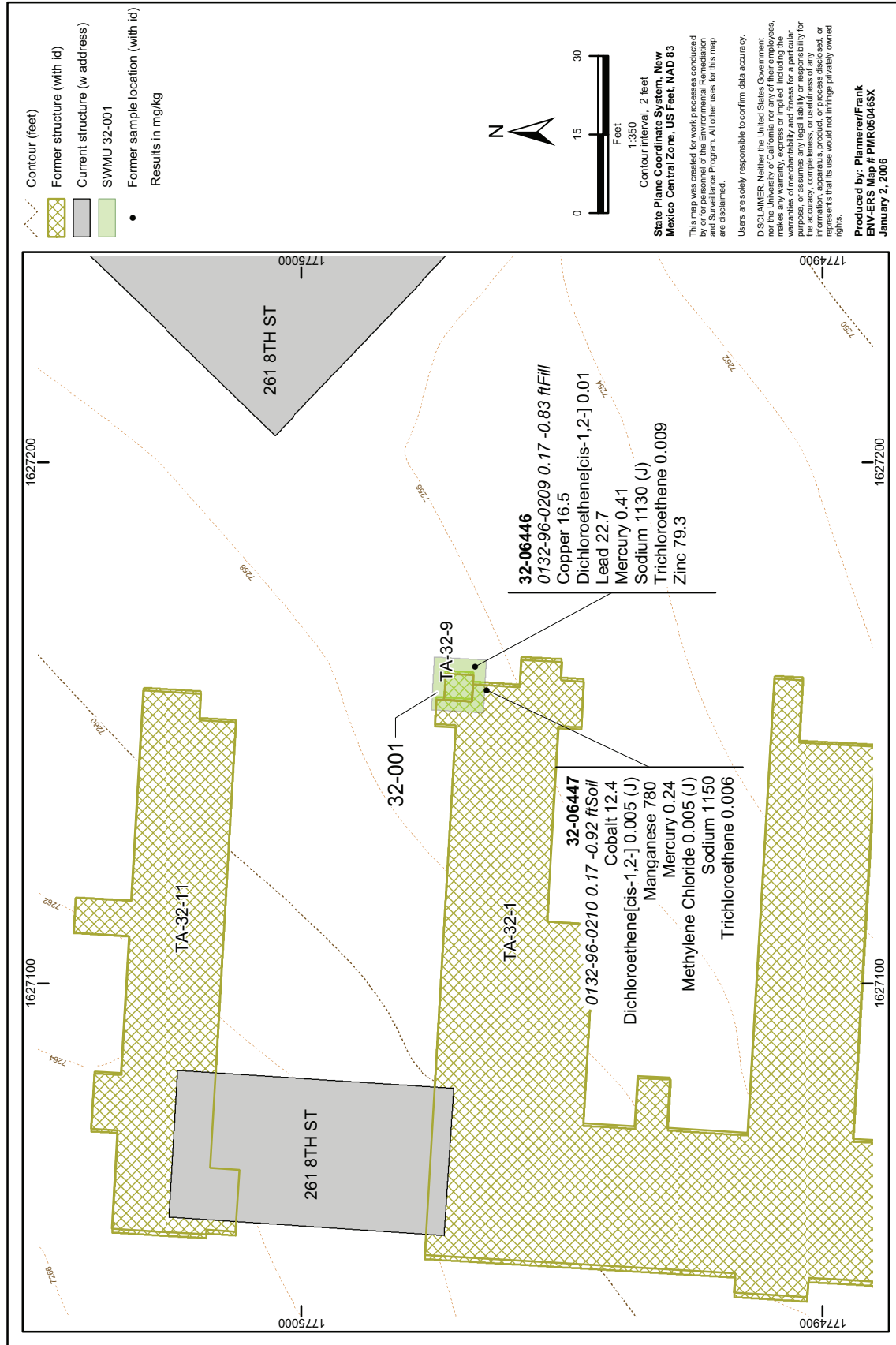

Figure 6.2-2. SWMU 32-001, inorganic chemicals detected greater than BVs and detected organic chemicals

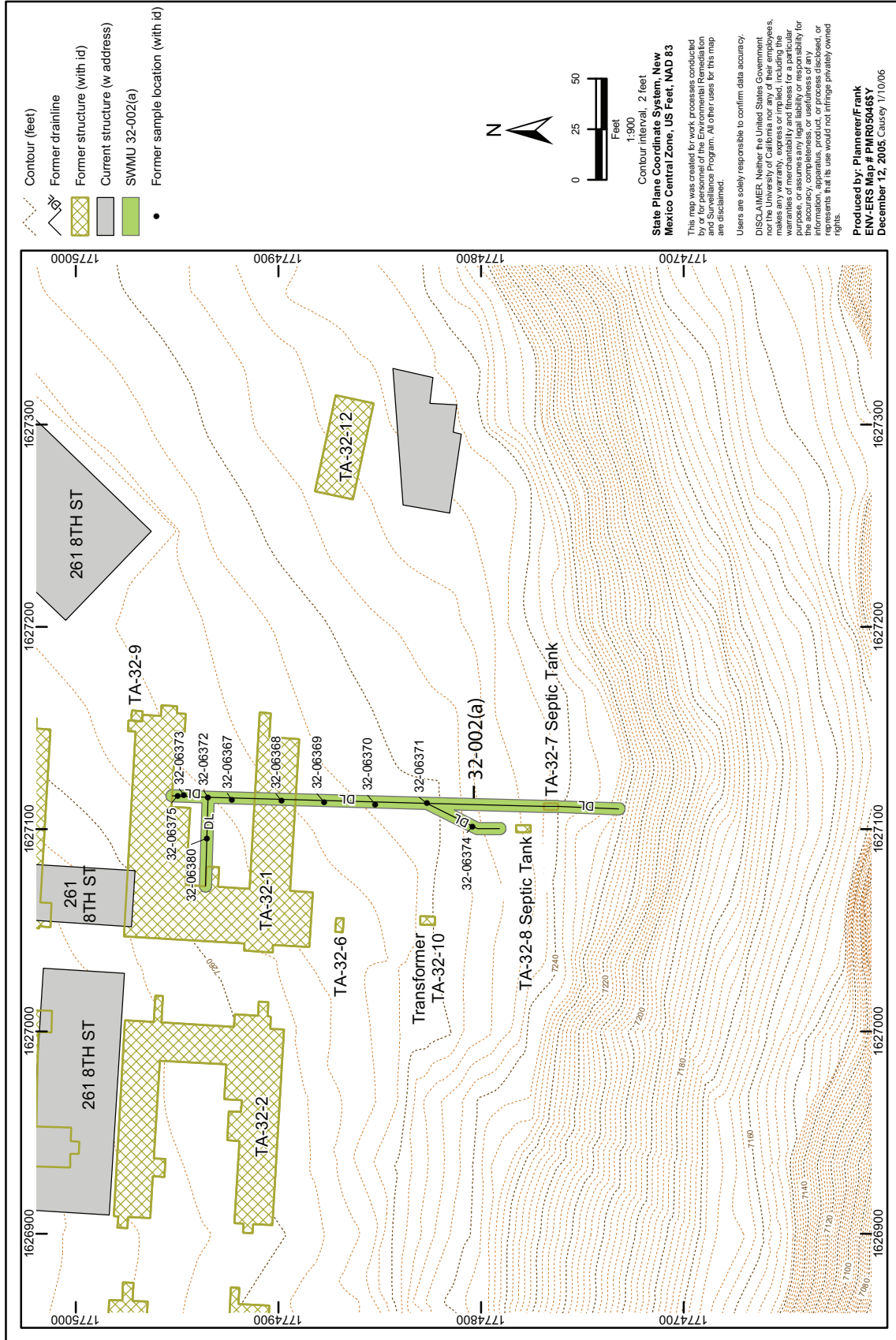

Figure 6.3-1. SWMU 32-002(a) site map

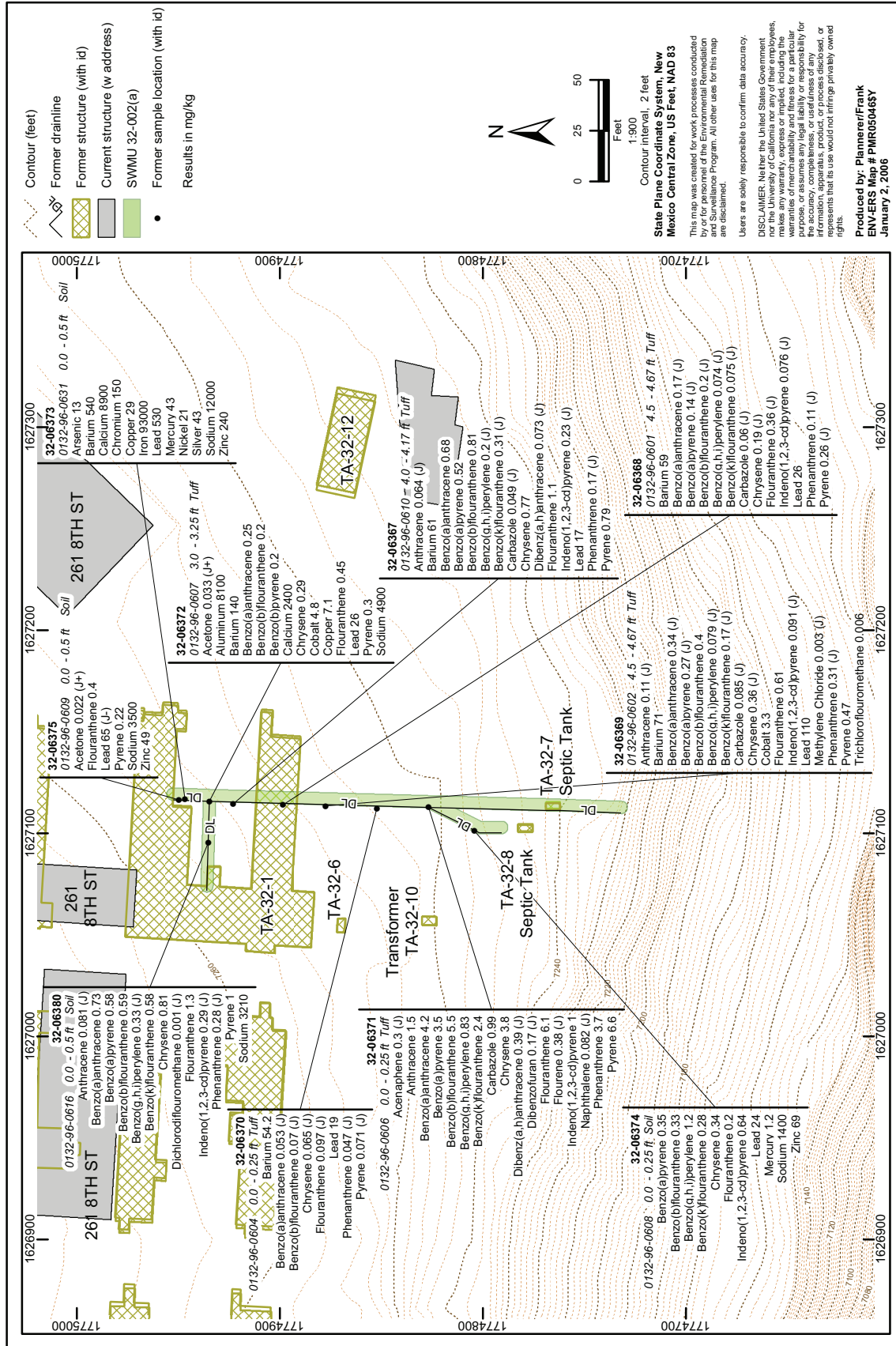

Figure 6.3-2. SWMU 32-002(a), inorganic chemicals detected greater than BVs and detected organic chemicals

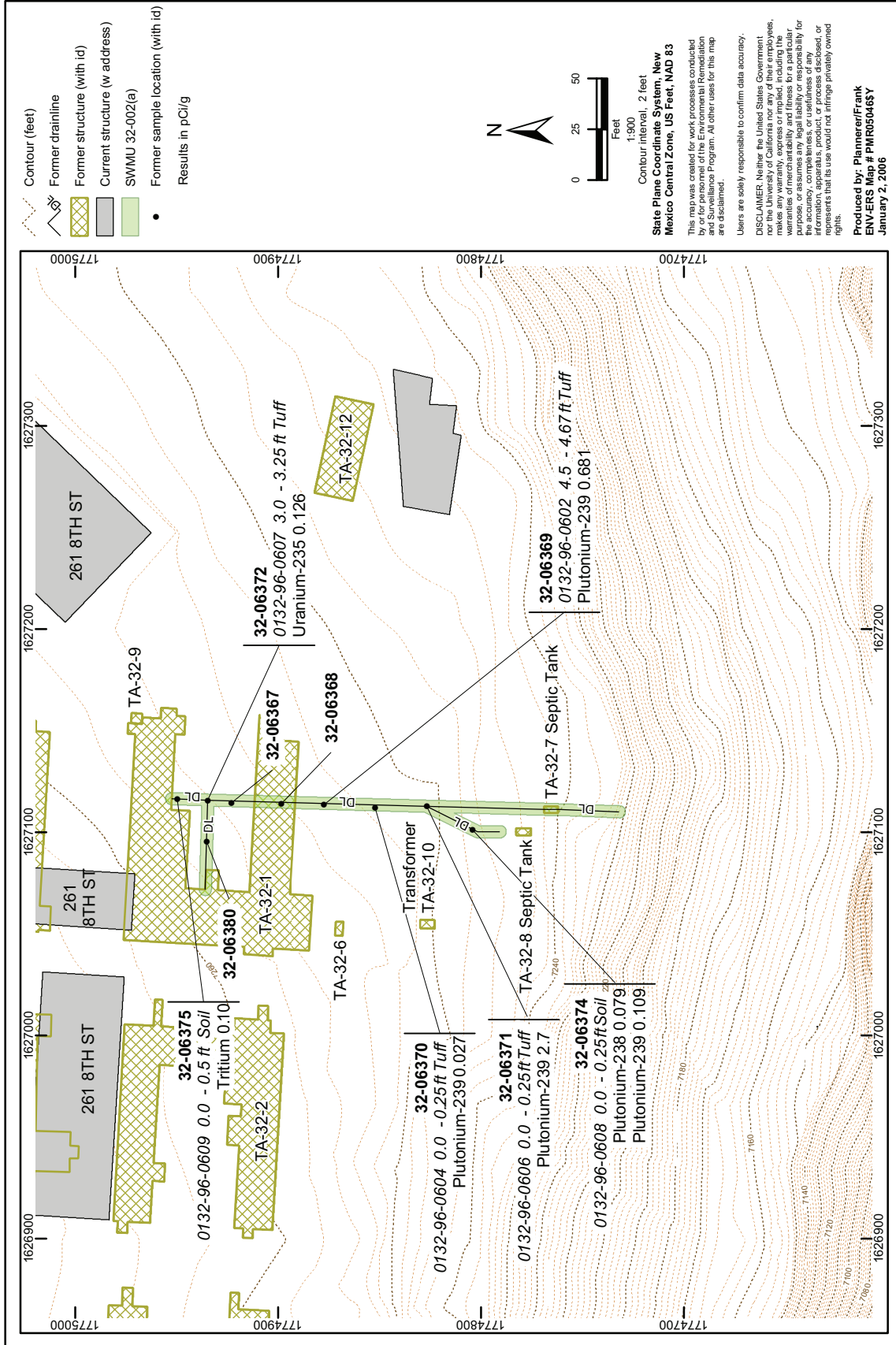

Figure 6.3-3. SWMU 32-002(a), radionuclides detected greater than BVs, FVs, or where FVs do not apply

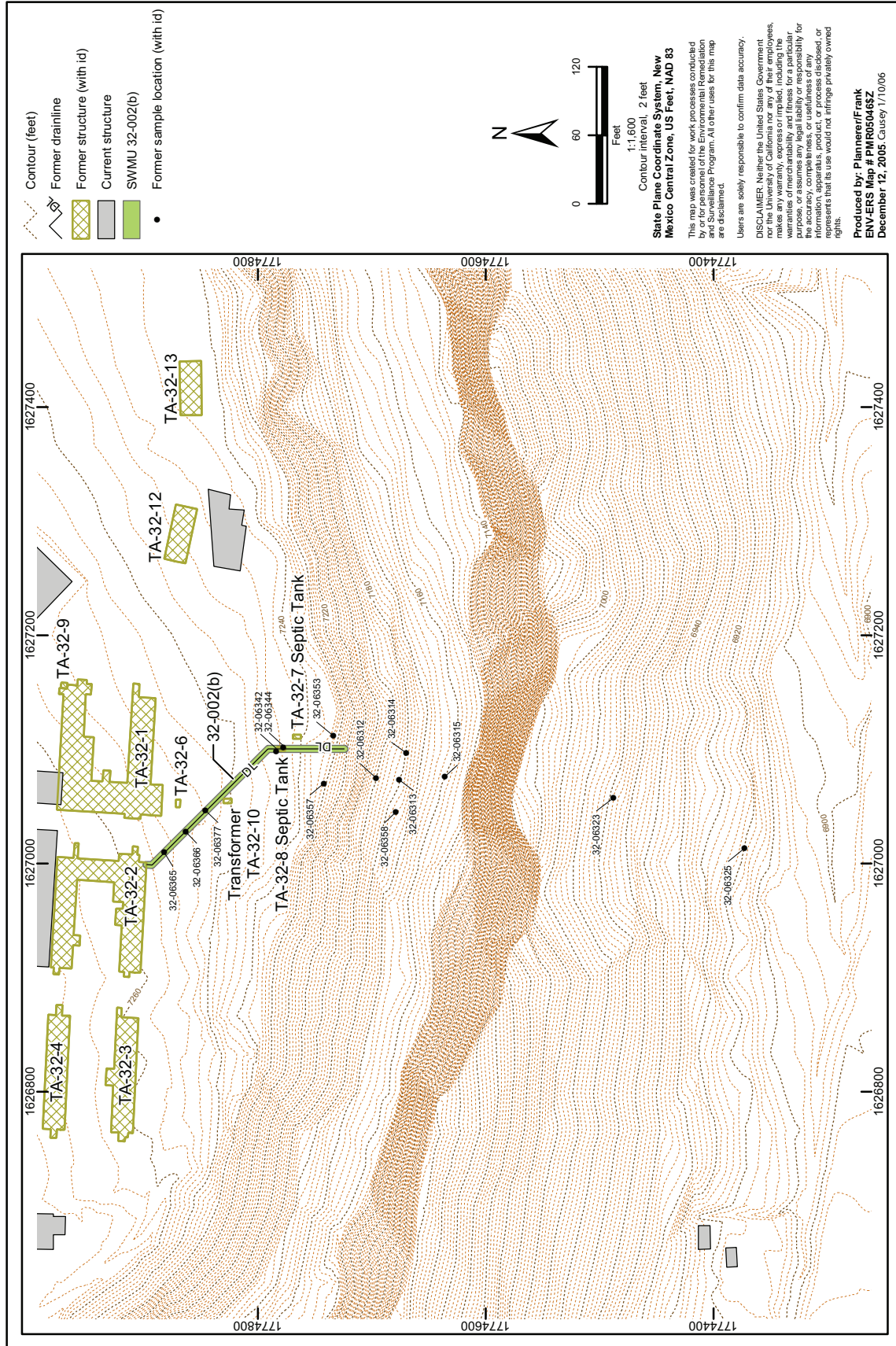

Figure 6.4-1. SWMU 32-002(b) site map

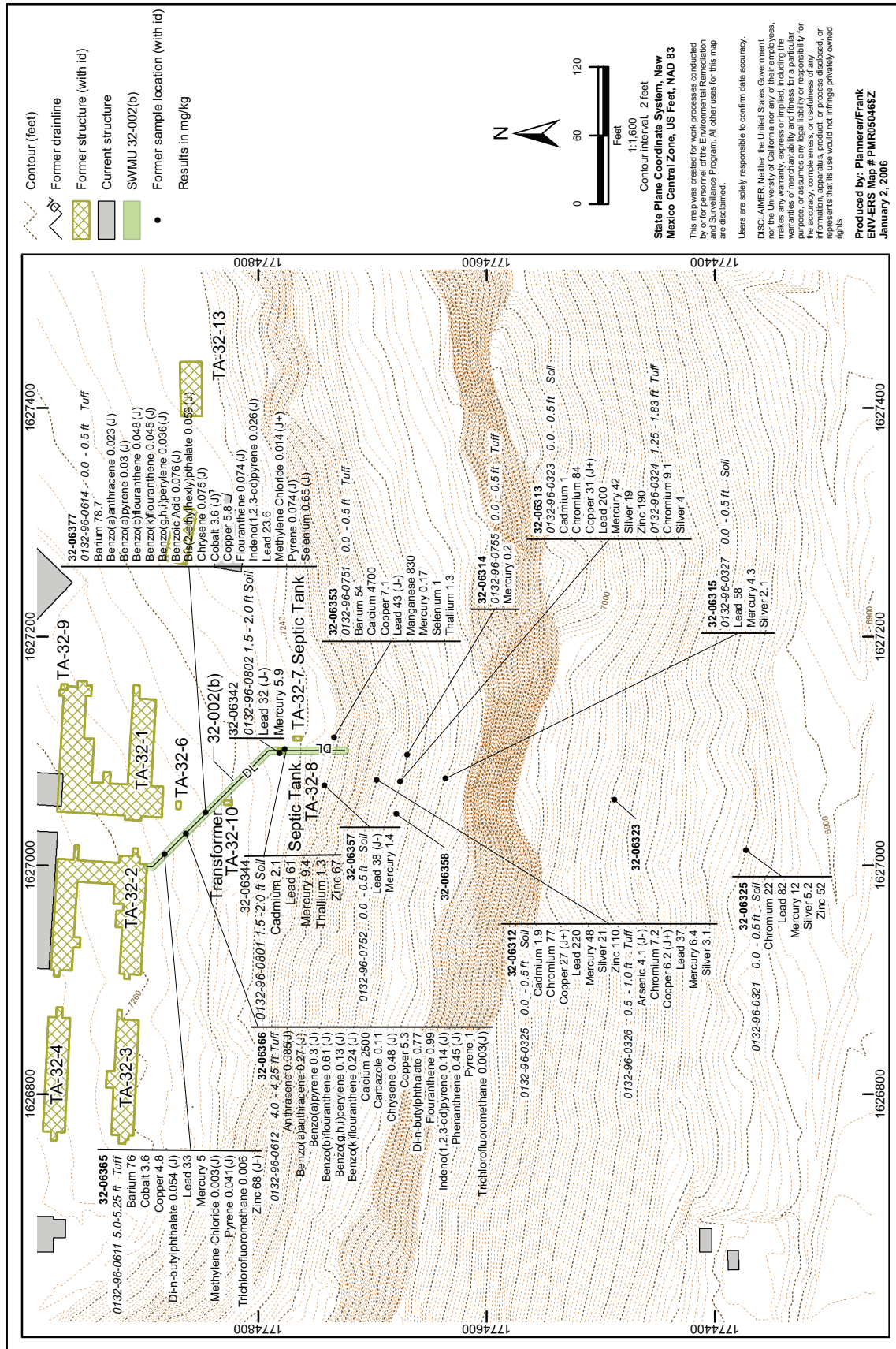

Figure 6.4-2. SWMU 32-002(b), inorganic chemicals detected greater than BVs and detected organic chemicals

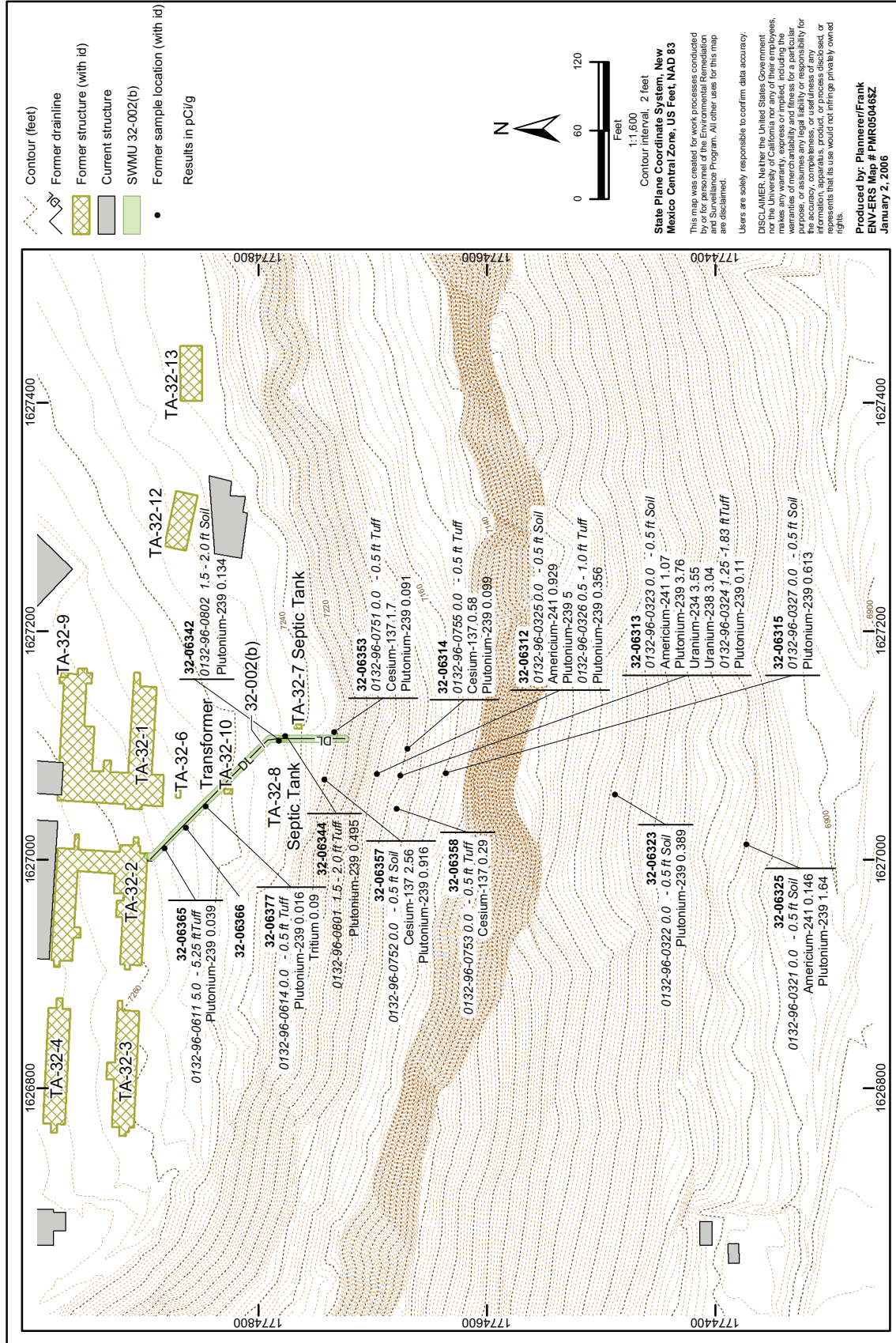

Figure 6.4-3. SWMU 32-002(b), radionuclides detected greater than BVs, FVs, or where FVs do not apply



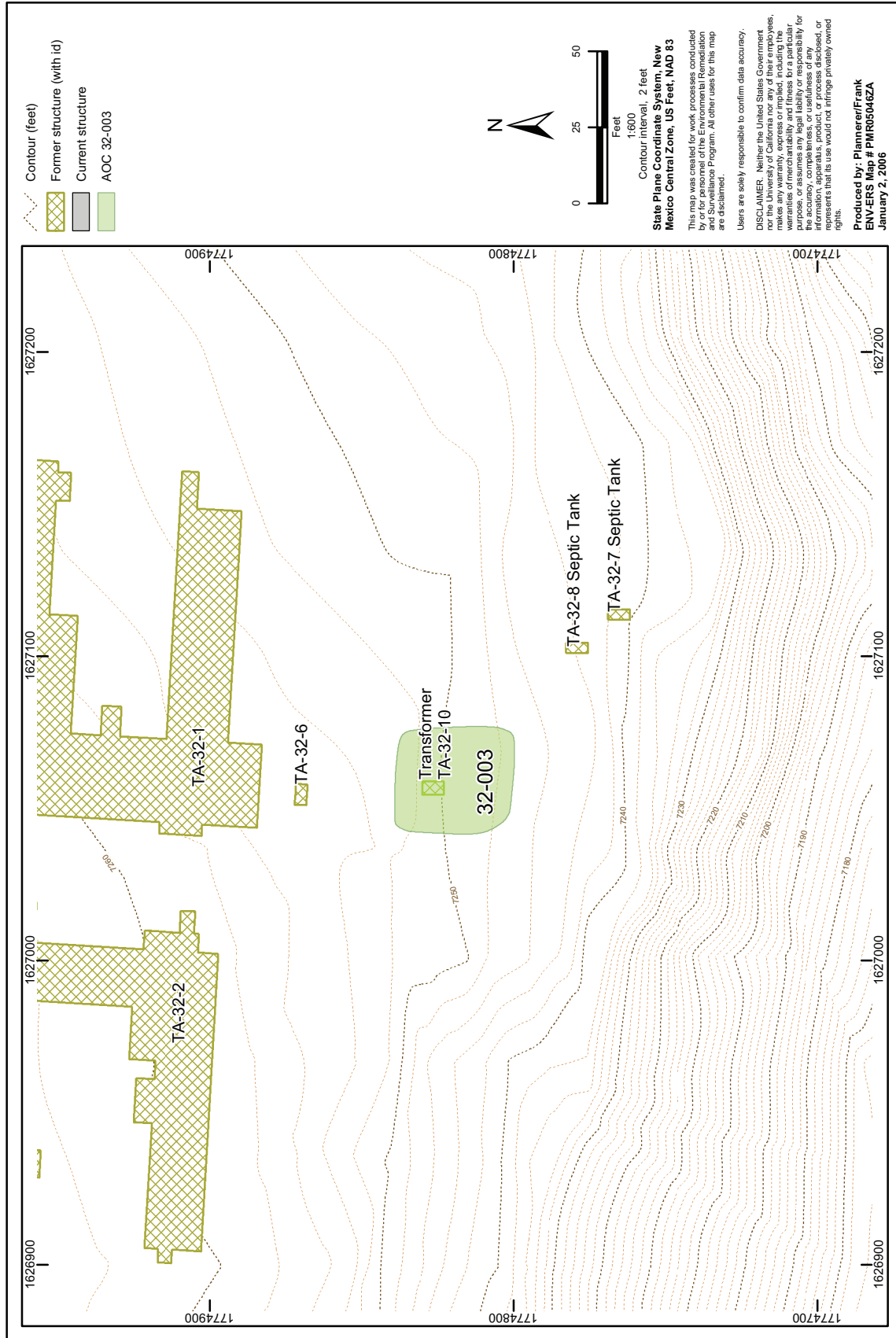

Figure 6.5-1. AOC 32-003 site map

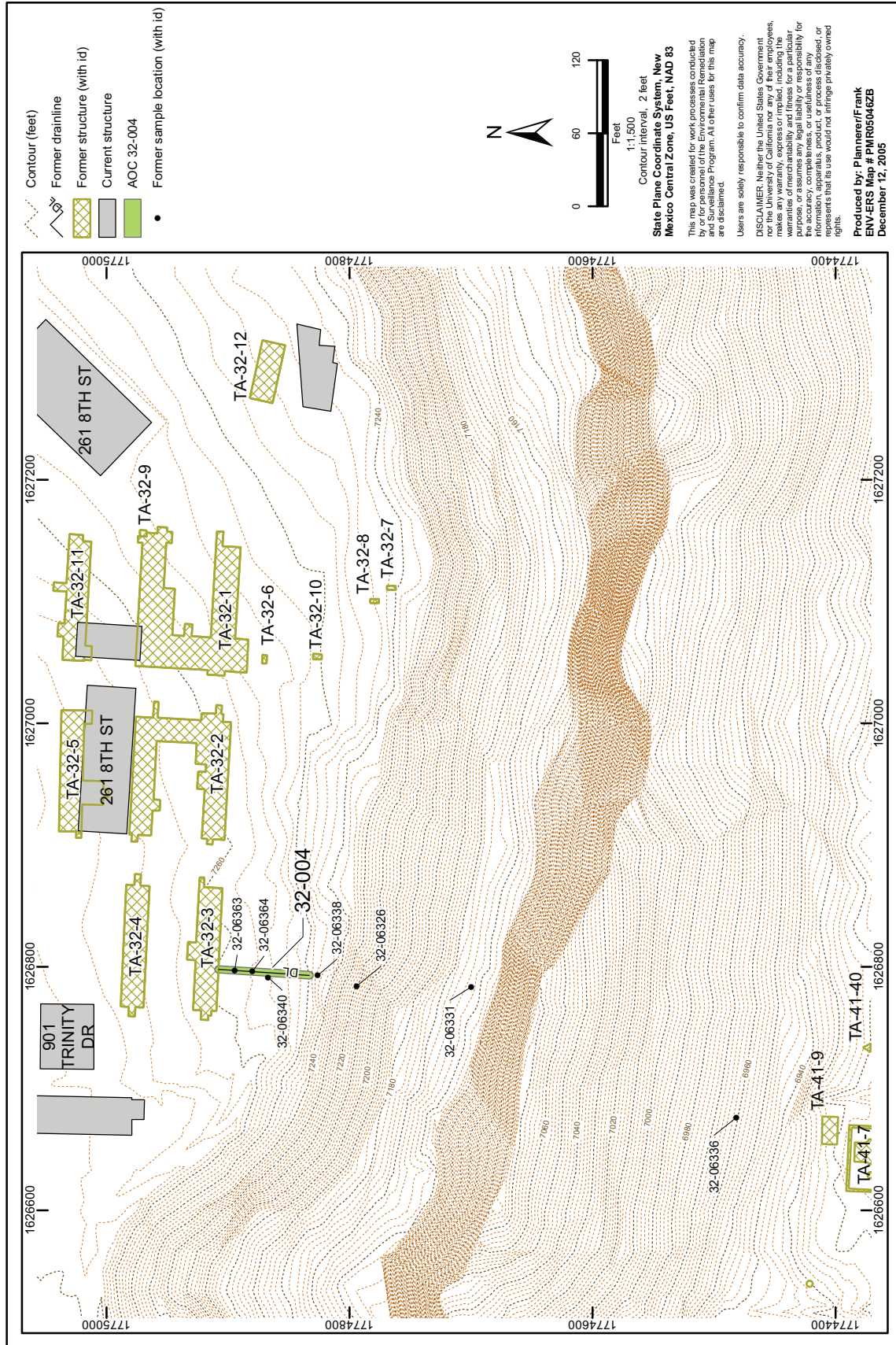

Figure 6.6-1. AOC 32-004 site map

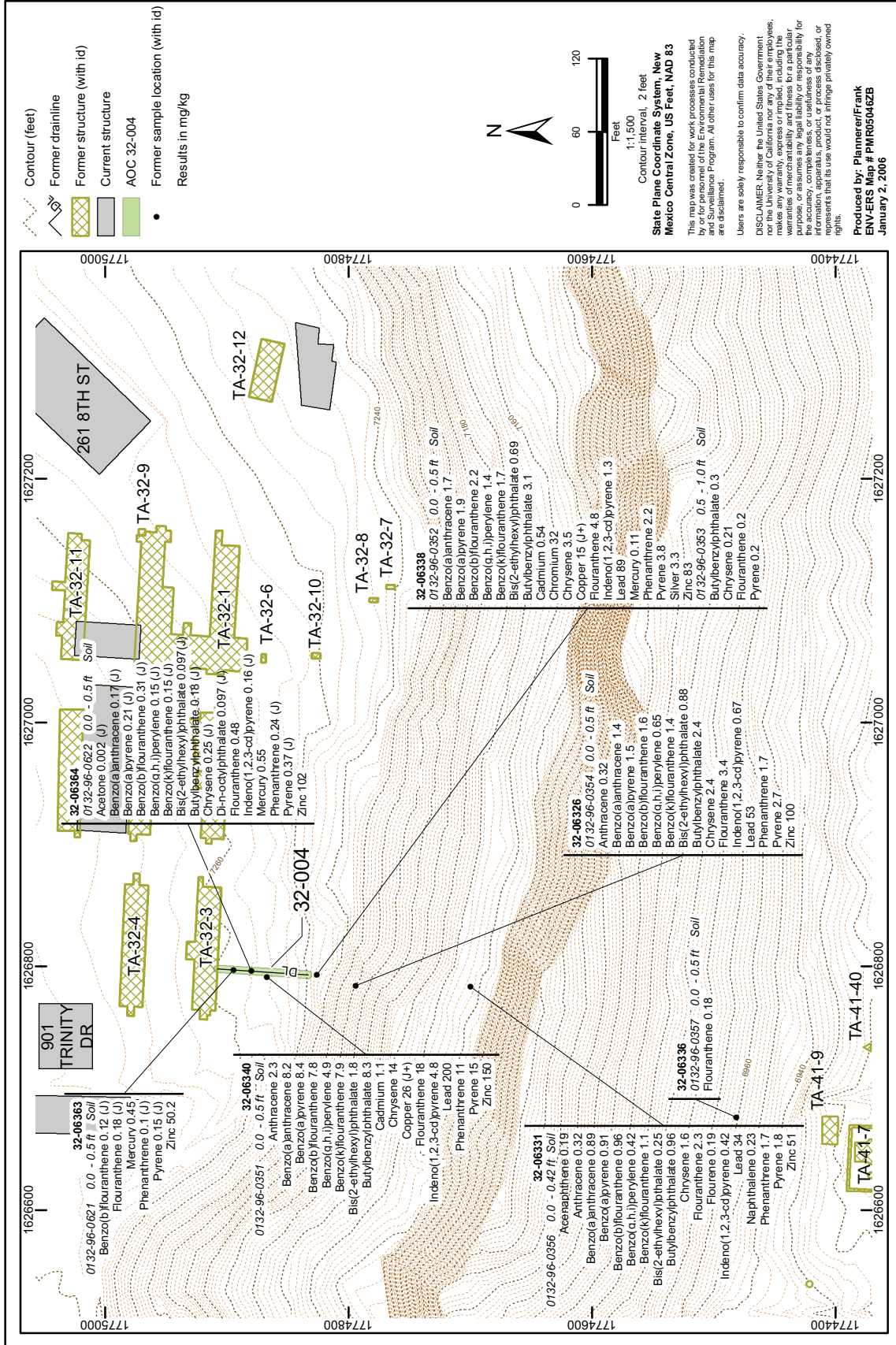

Figure 6.6-2. AOC 32-004, inorganic chemicals detected greater than BVs and detected organic chemicals

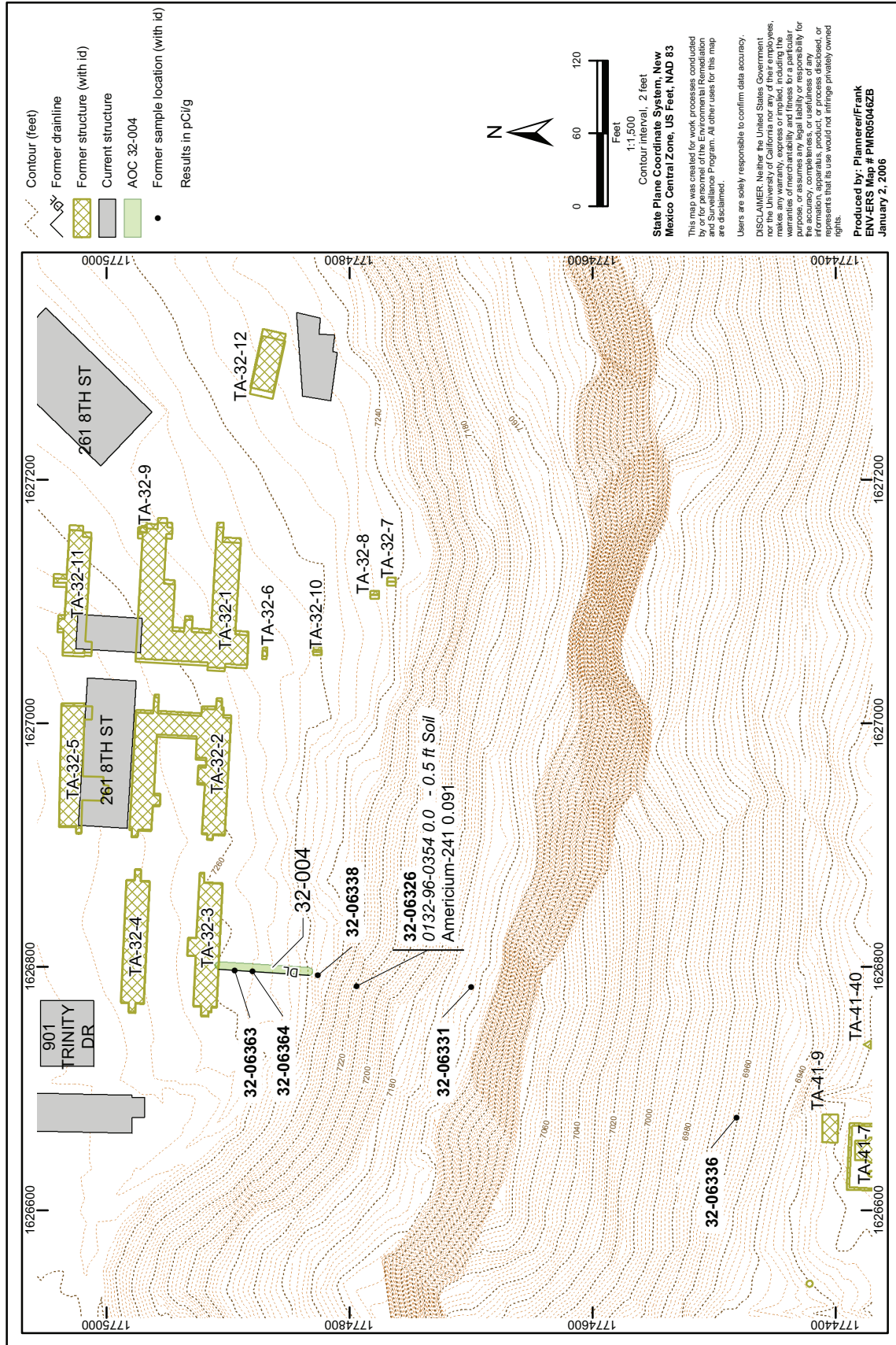

Figure 6.6-3. AOC 32-004, radionuclide detected greater than FV

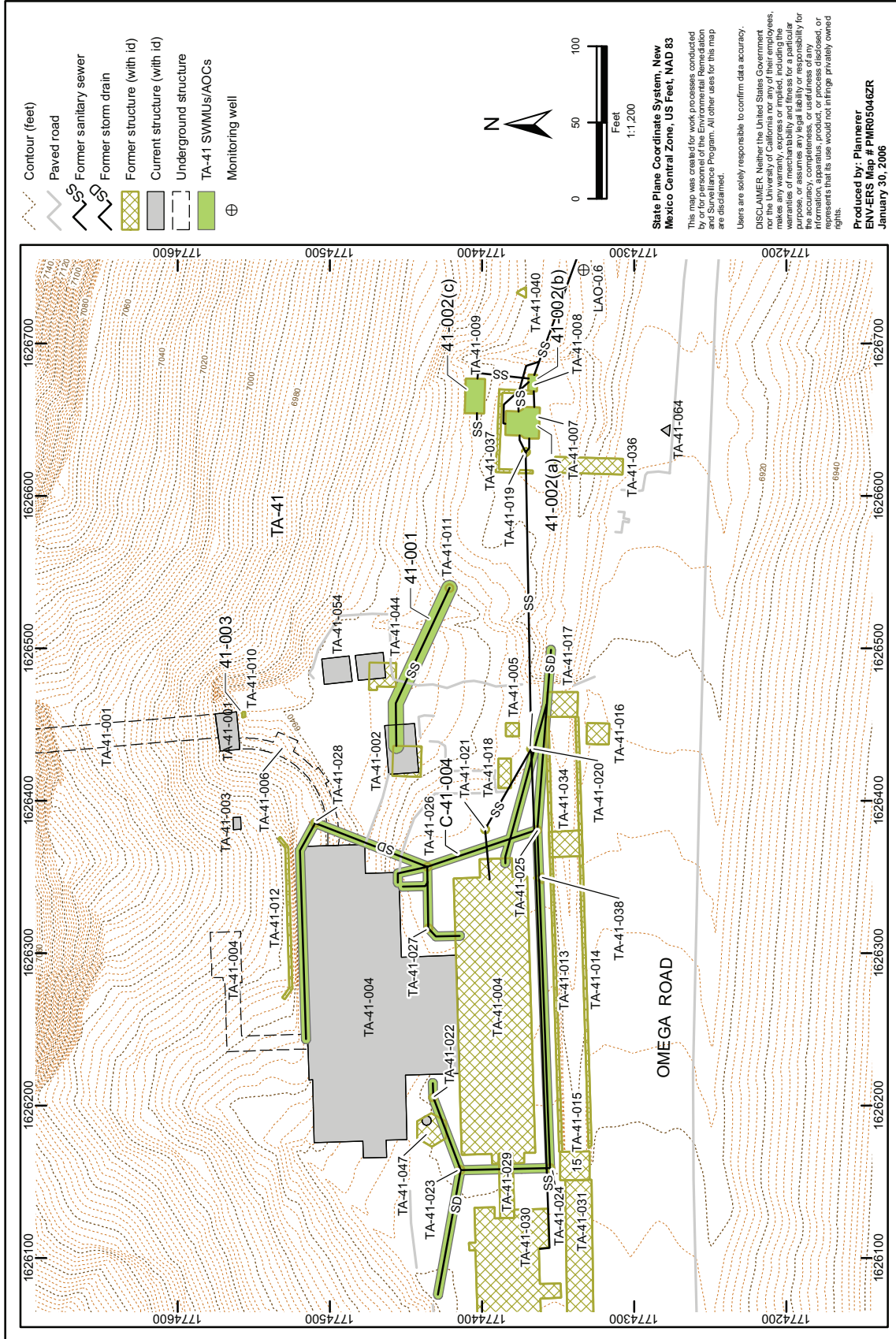

Figure 7.1-1. TA-41 site map

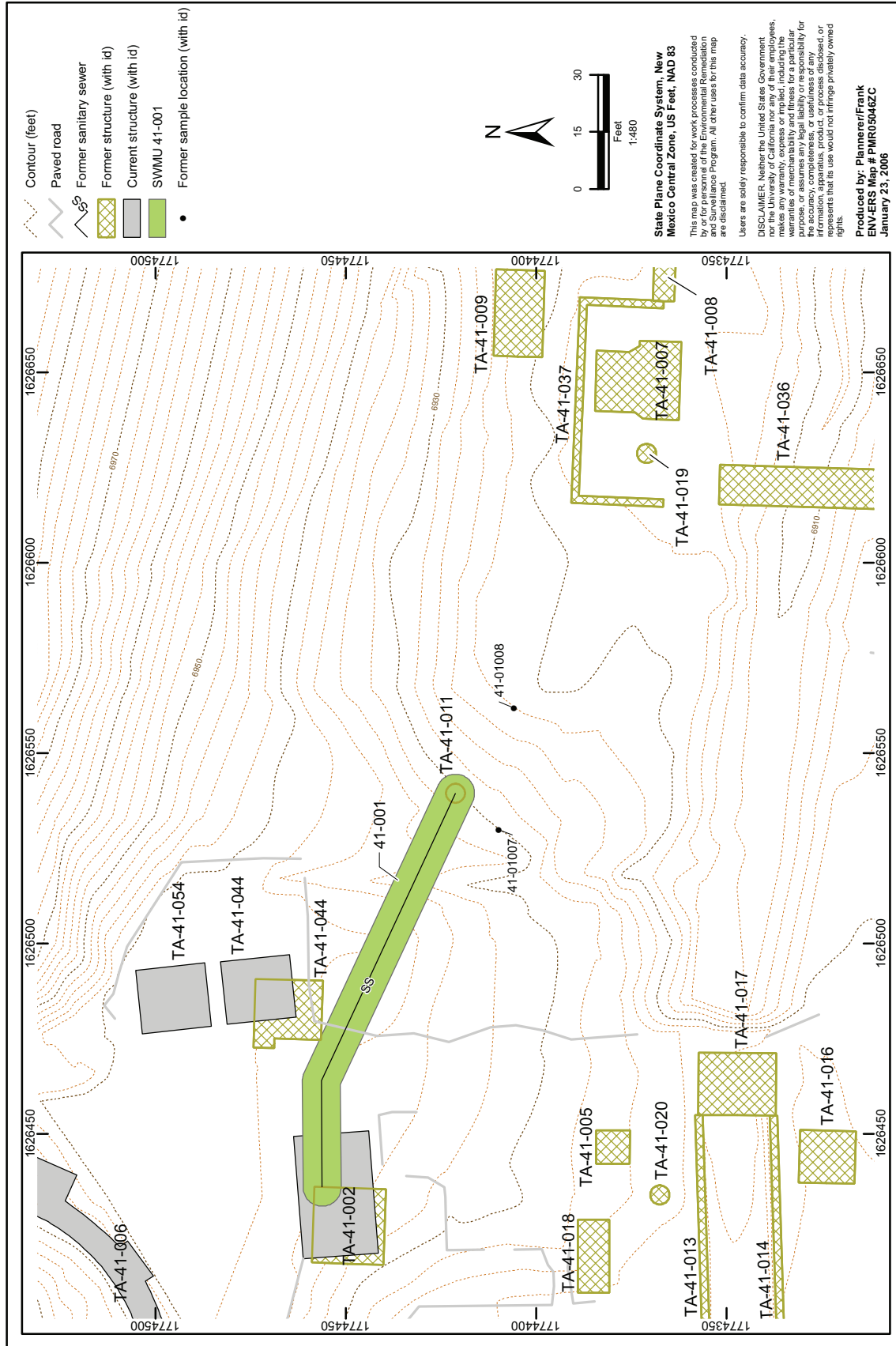

Figure 7.2-1. SWMU 41-001 site map

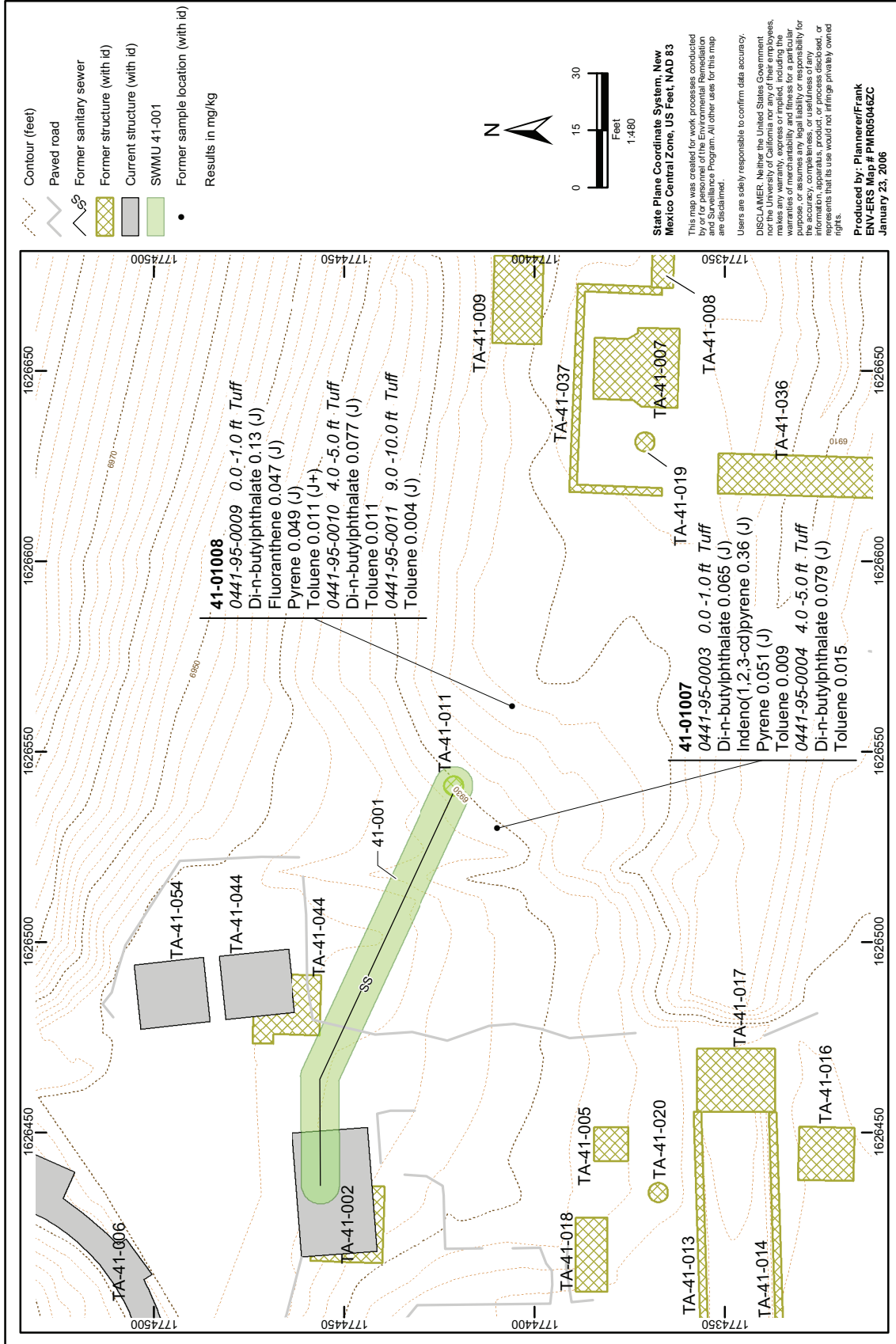

Figure 7.2-2. SWMU 41-001, detected organic chemicals





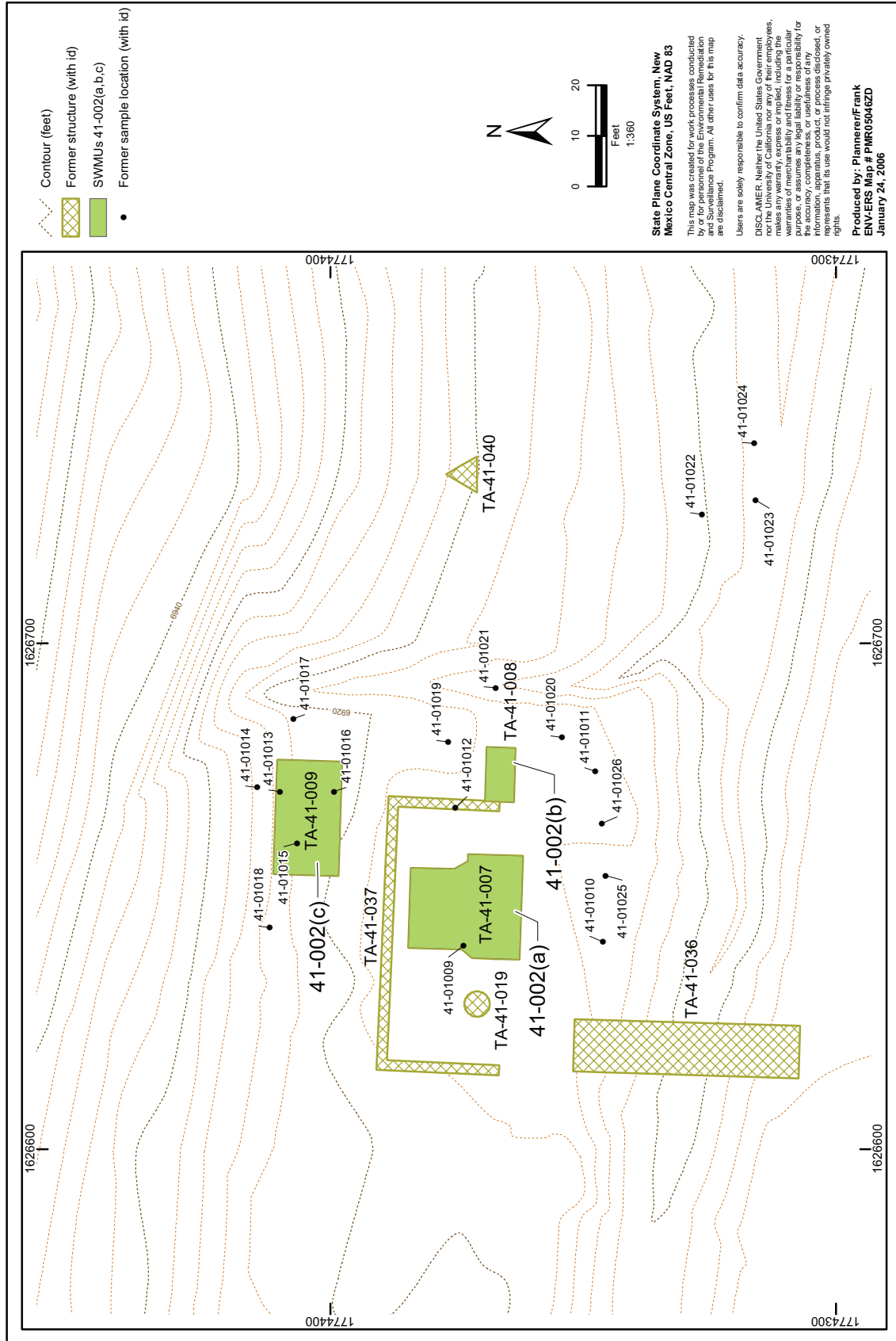

Figure 7.3-1. SWMUs 41-002(a,b,c) site map

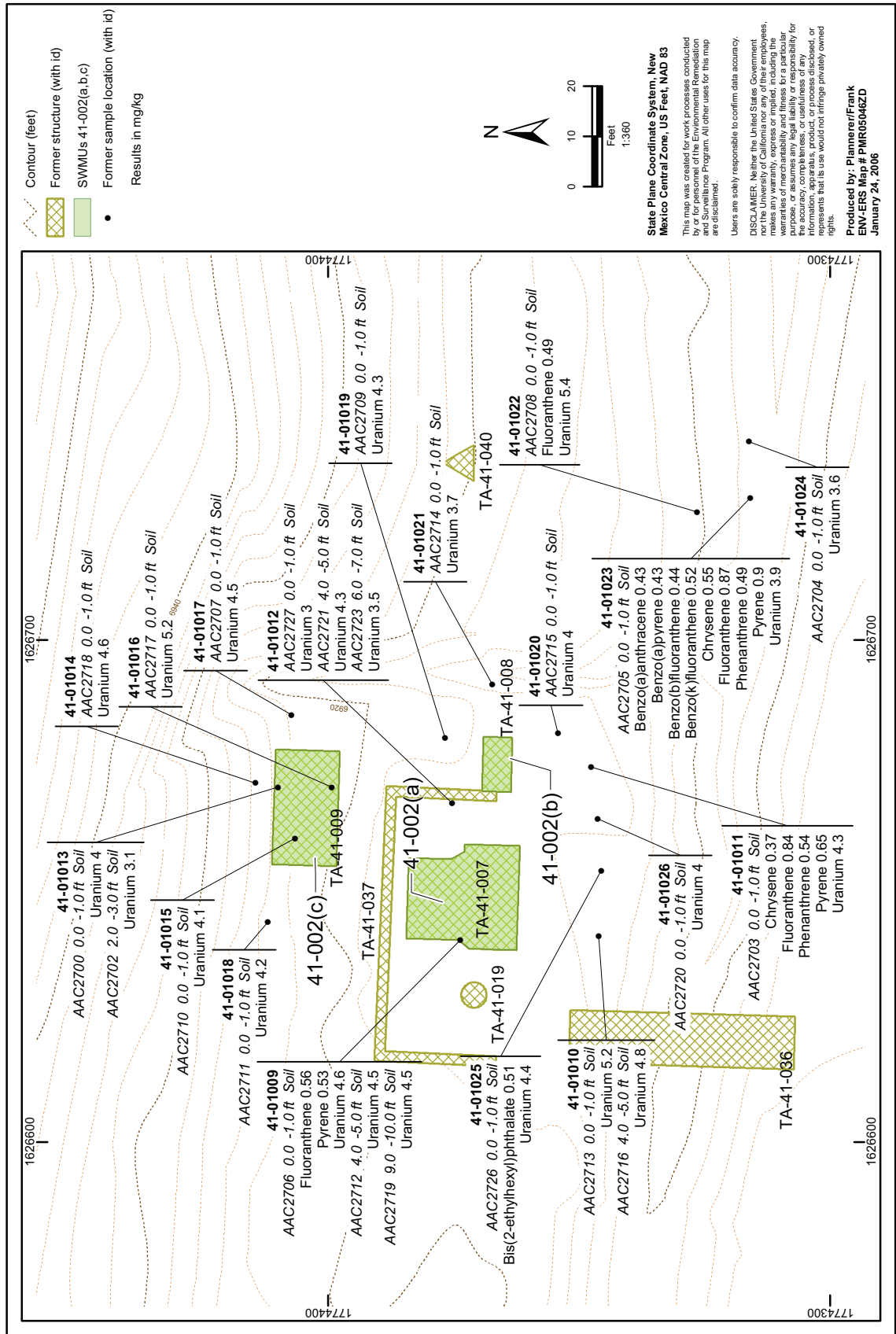

Figure 7.3-2. SWMUs 41-002(a,b,c), inorganic chemicals detected greater than BVs and detected organic chemicals

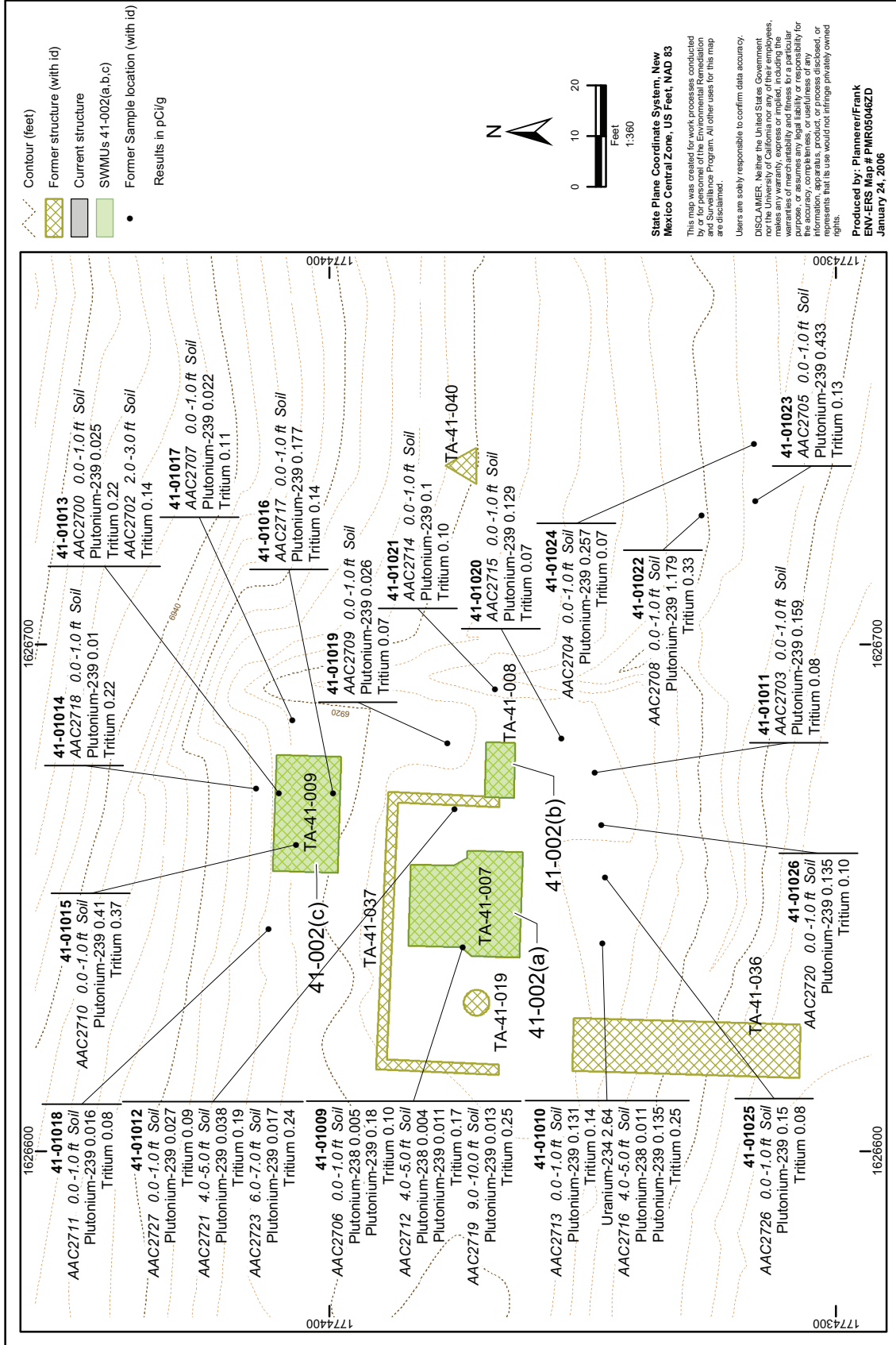

Figure 7.3-3. SWMUs 41-002(a,b,c), radionuclides detected greater than BVs, FVs, or where FVs do not apply

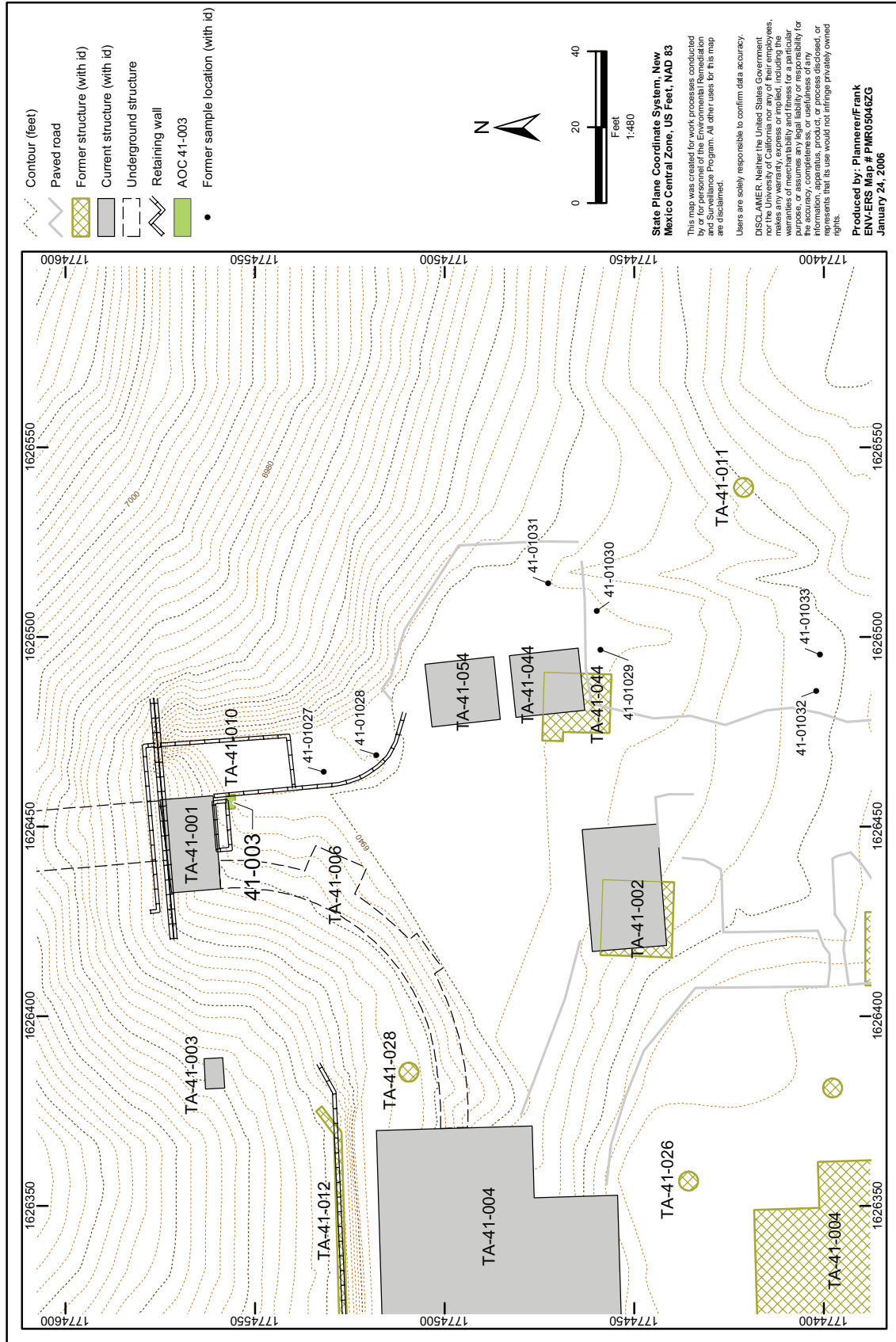

Figure 7.4-1. AOC 41-003 site map

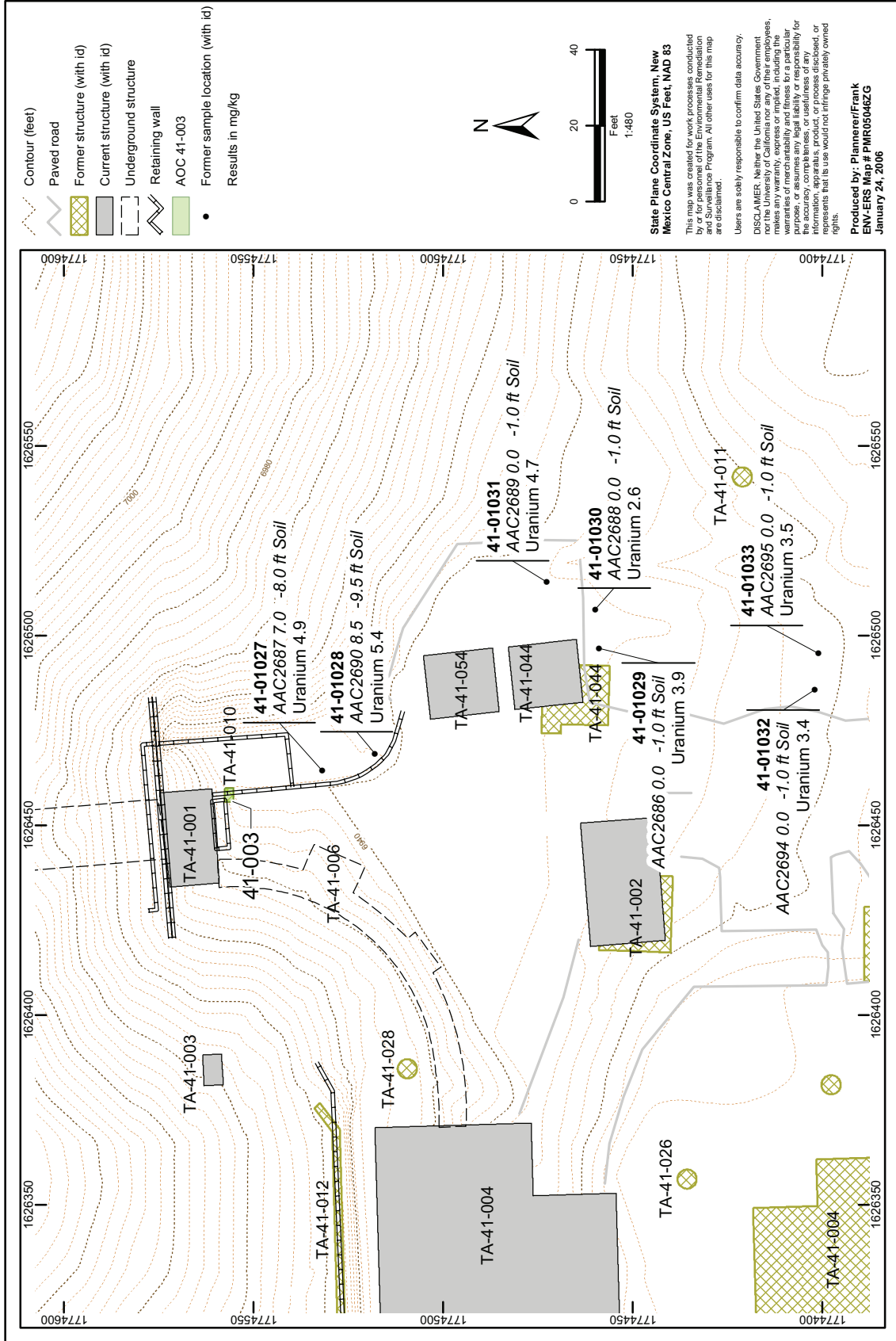

Figure 7.4-2. AOC 41-003, inorganic chemicals detected greater than BVs

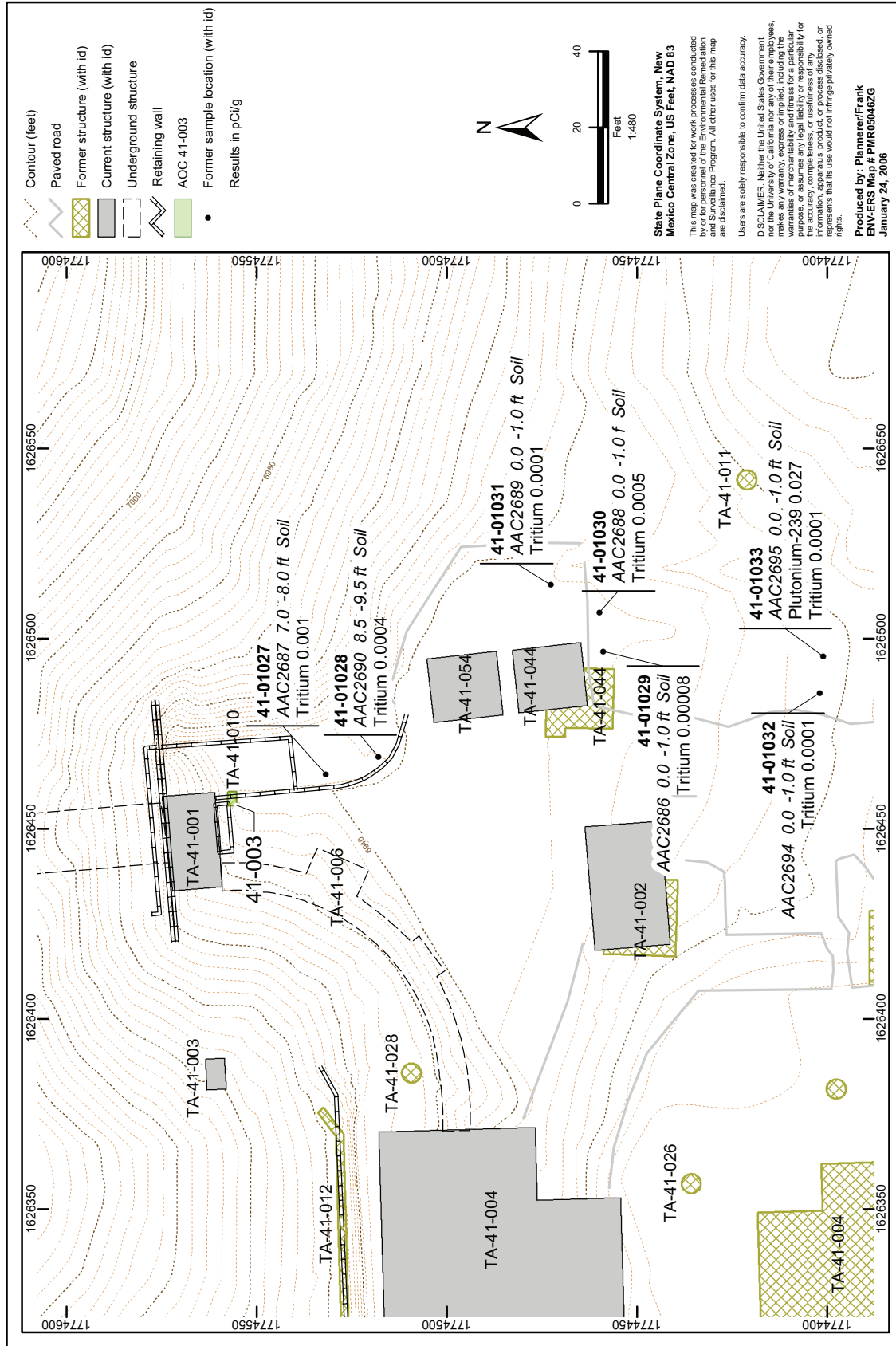

Figure 7.4-3. AOC 41-003, radionuclides detected where FVs do not apply

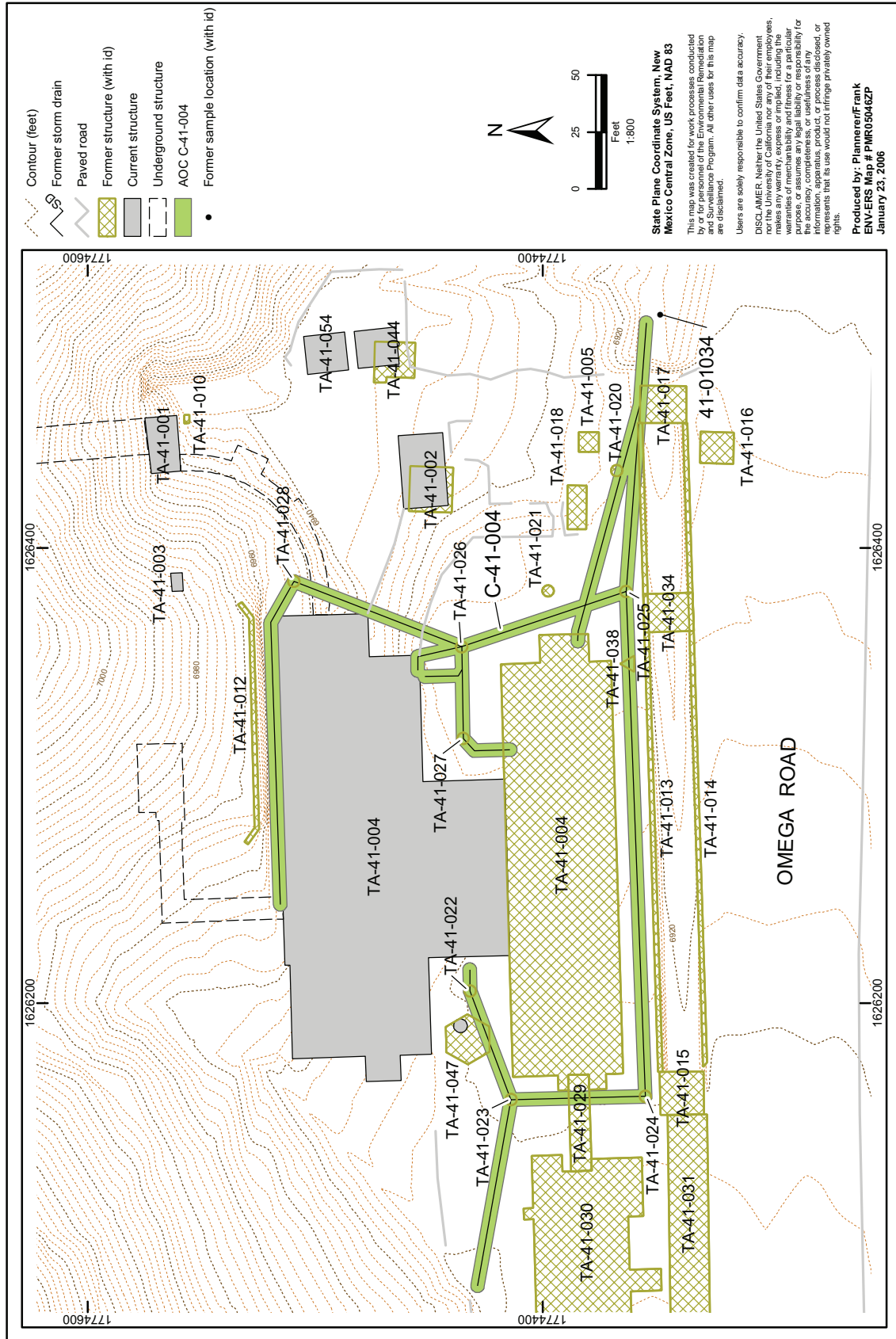

Figure 7.5-1. AOC C-41-004 site map

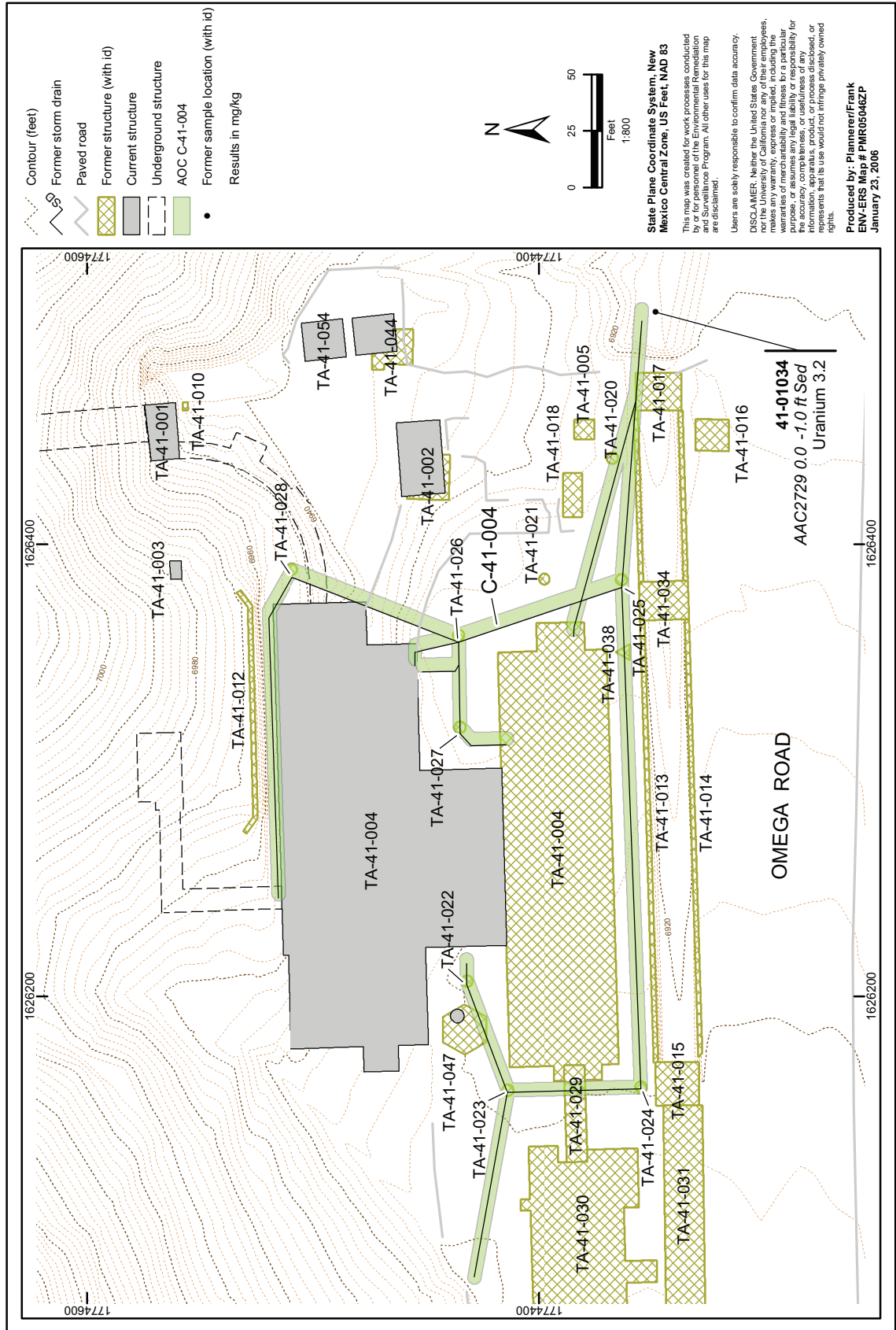

Figure 7.5-2. AOC C-41-004, inorganic chemicals detected greater than BVs



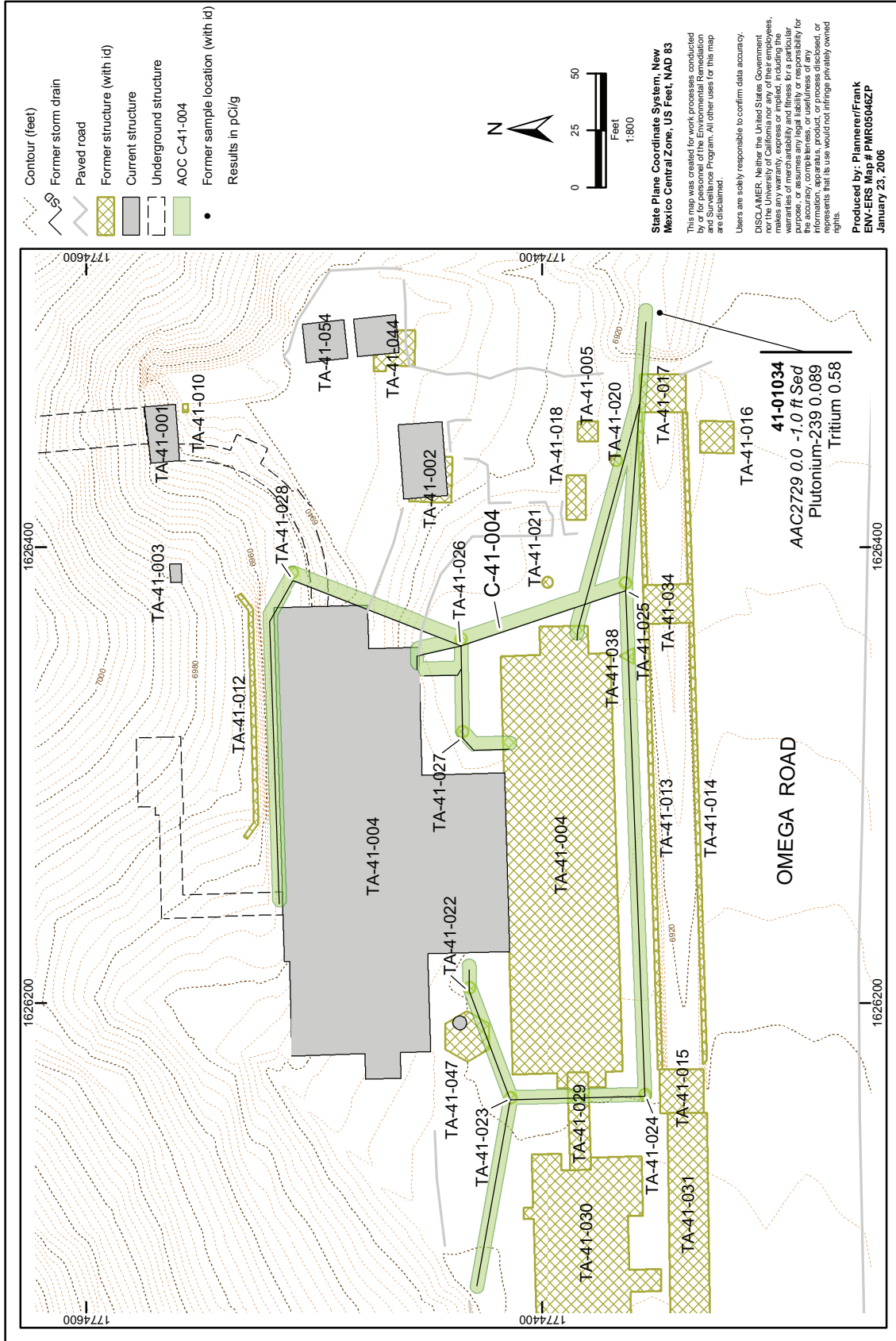

Figure 7.5-3. AOC C-41-004, radionuclides detected greater than FVs

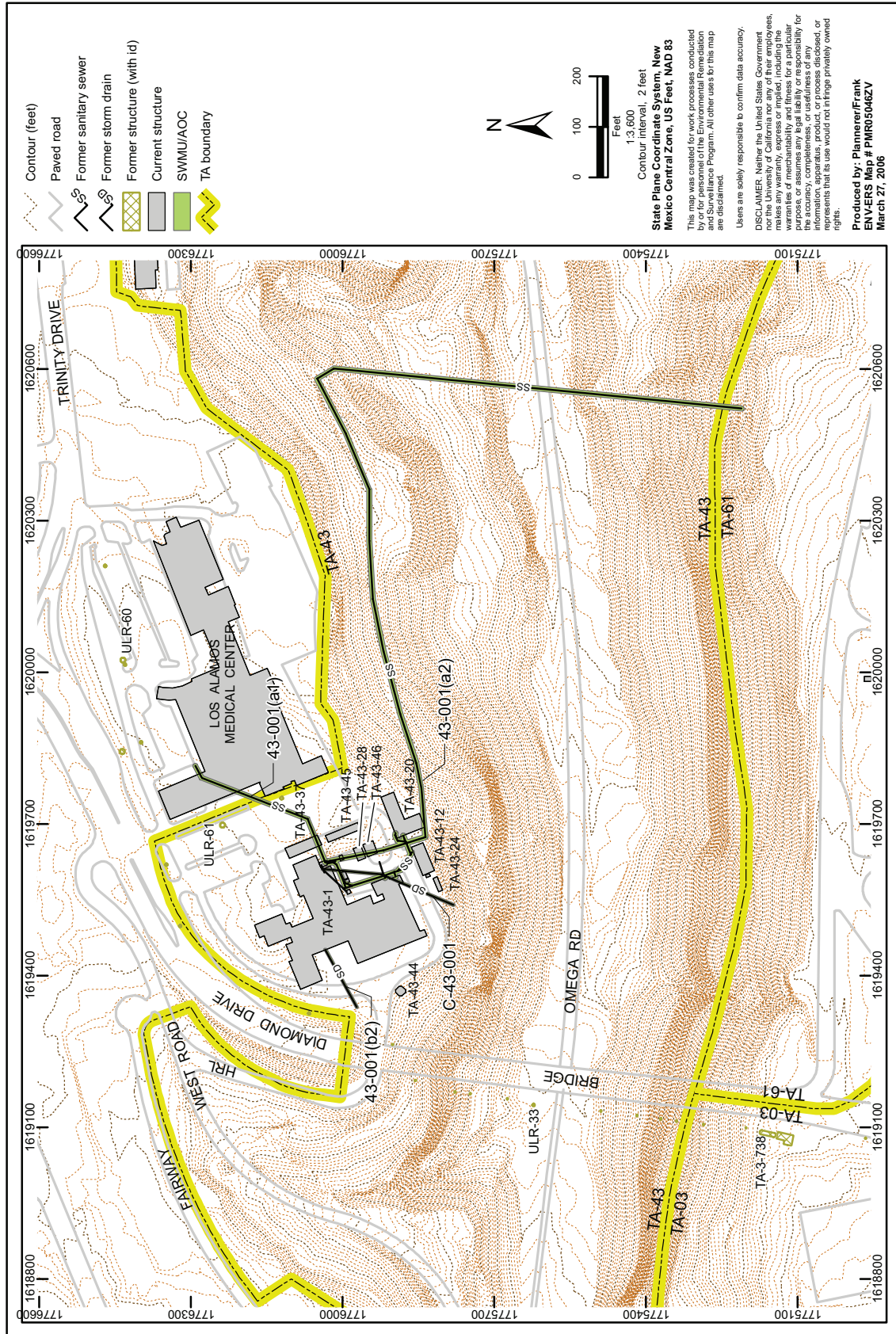

Figure 8.1-1. TA-43 site map

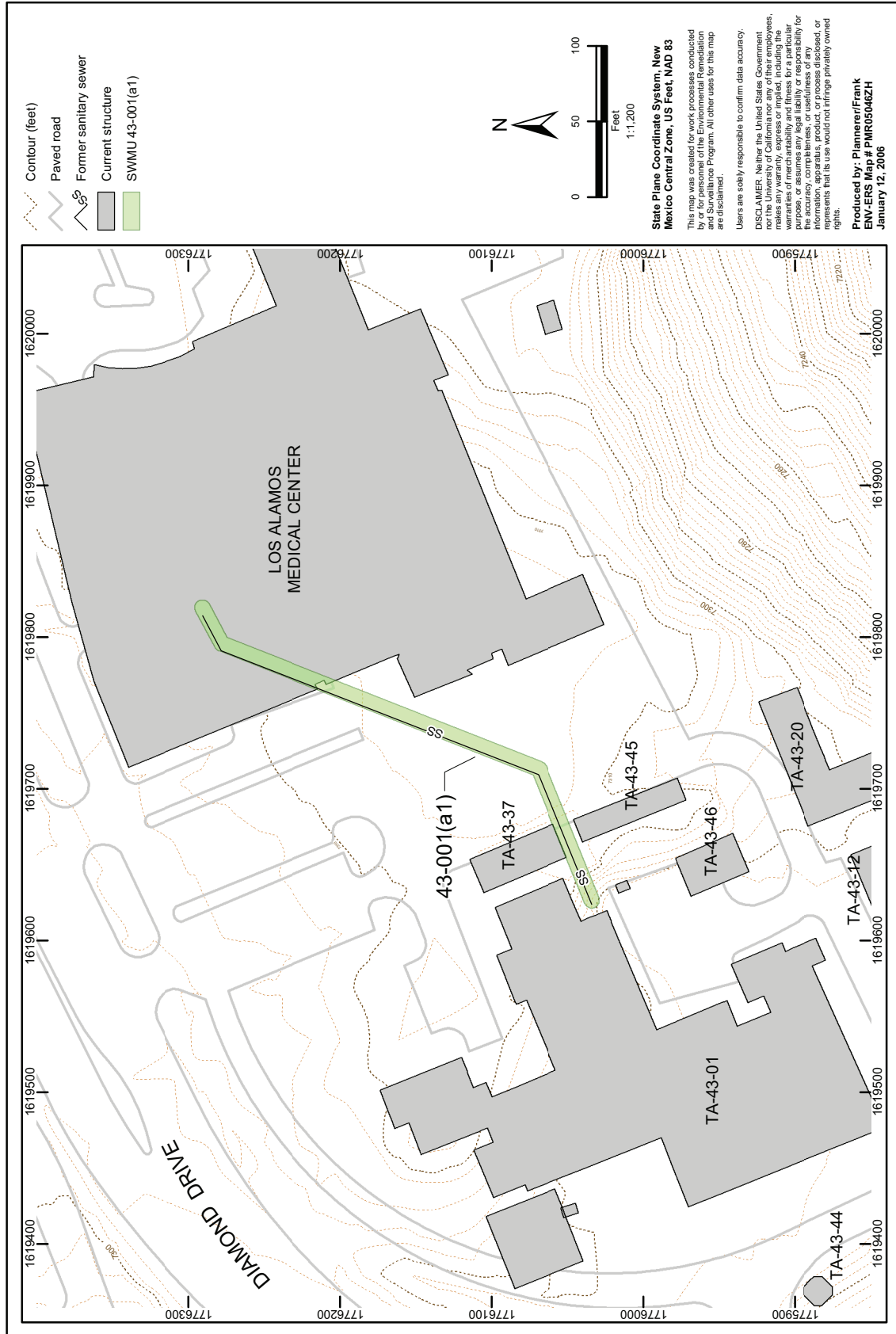

Figure 8.2-1. SWMU 43-001(a1) site map

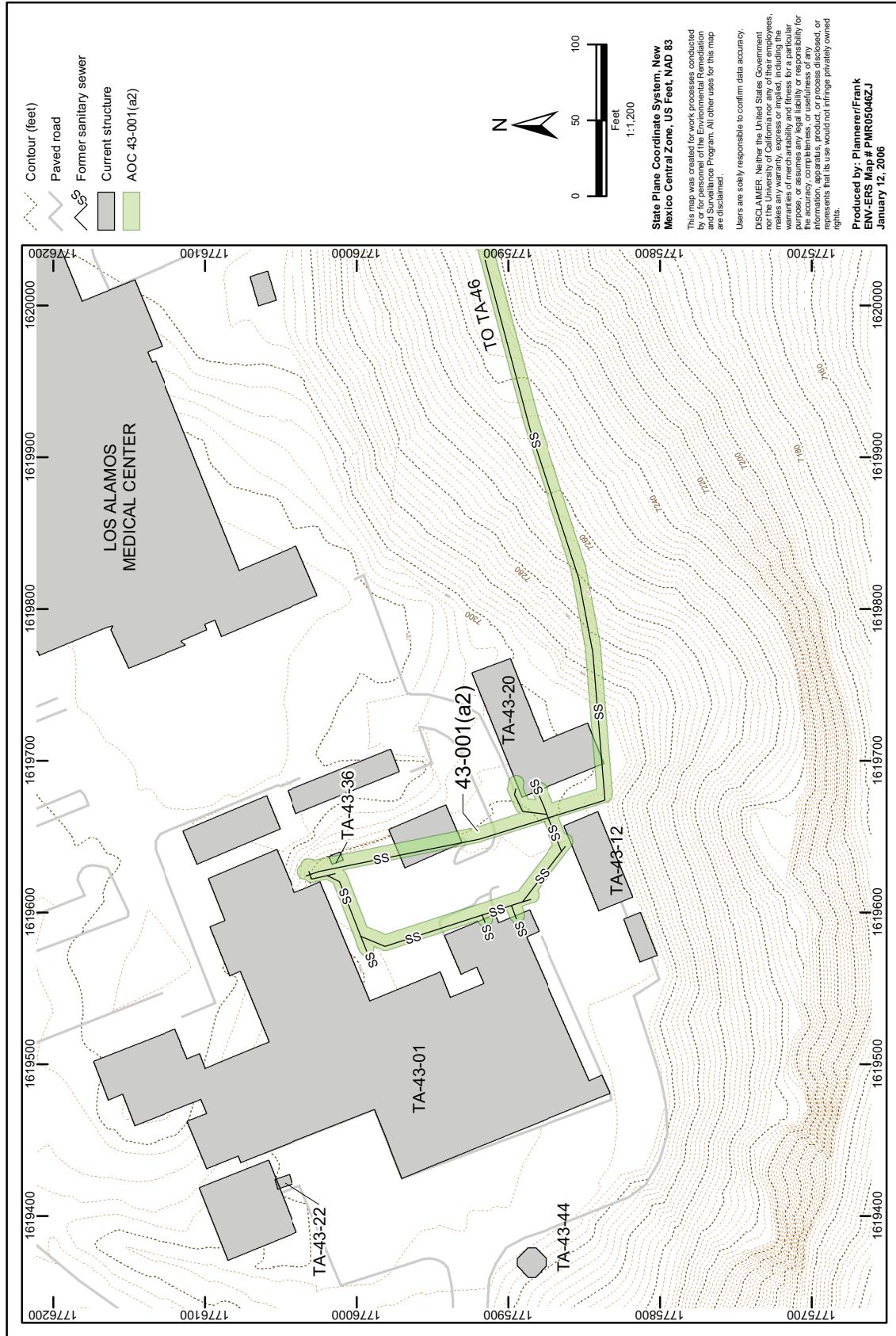

Figure 8.3-1. AOC 43-001(a2) site map

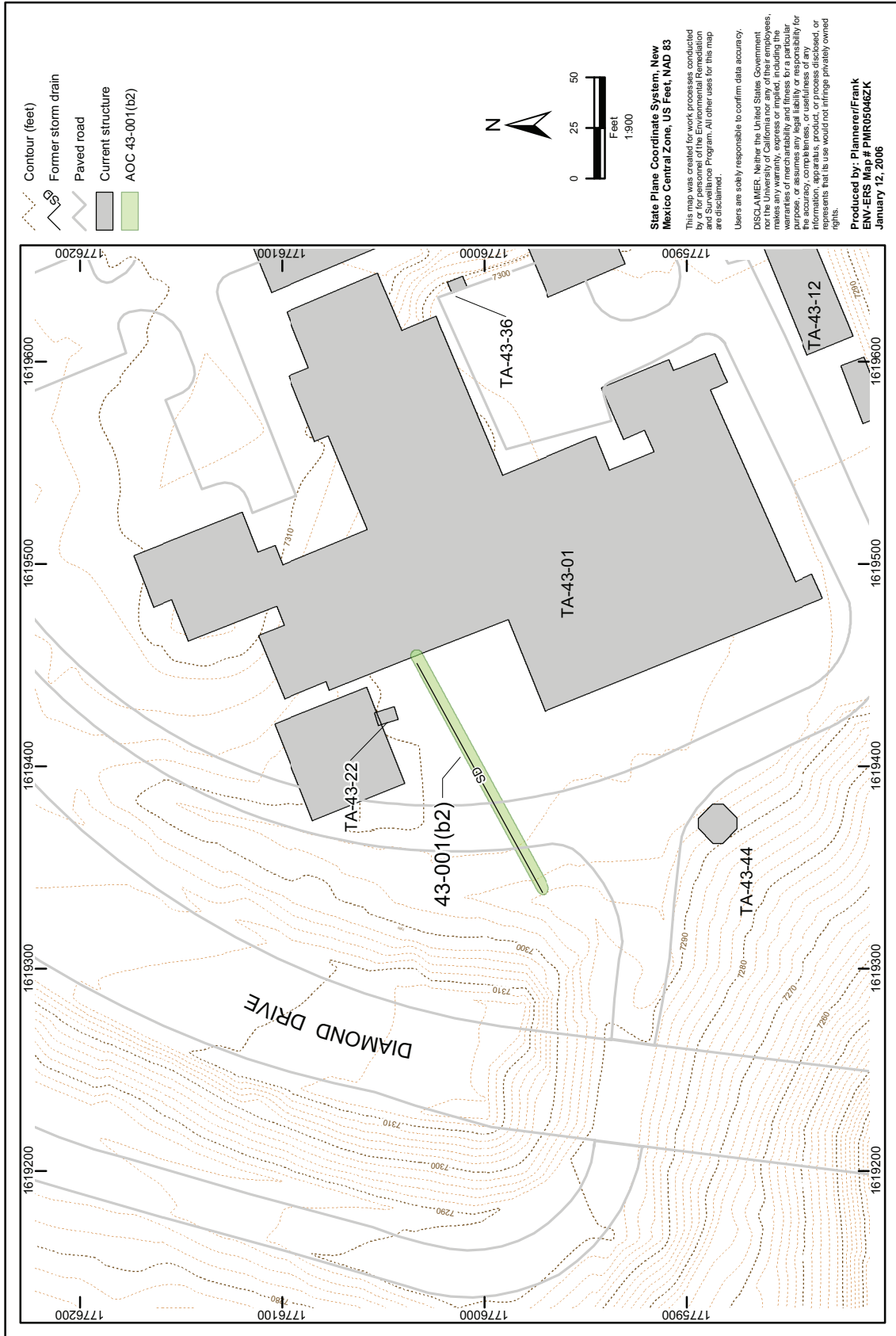

Figure 8.4-1. AOC 43-001(b2) site map

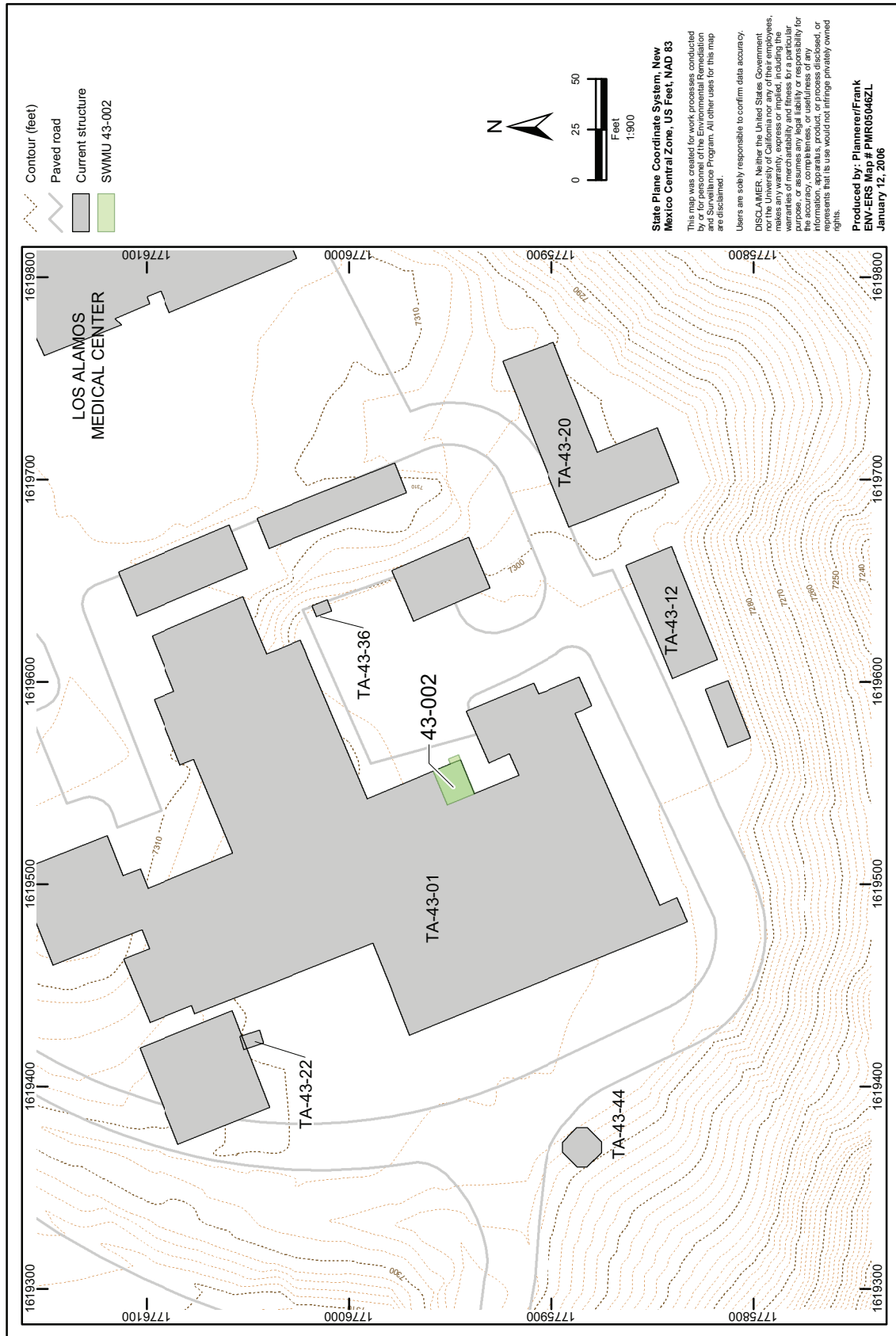

Figure 8.5-1. SWMU 43-002 site map

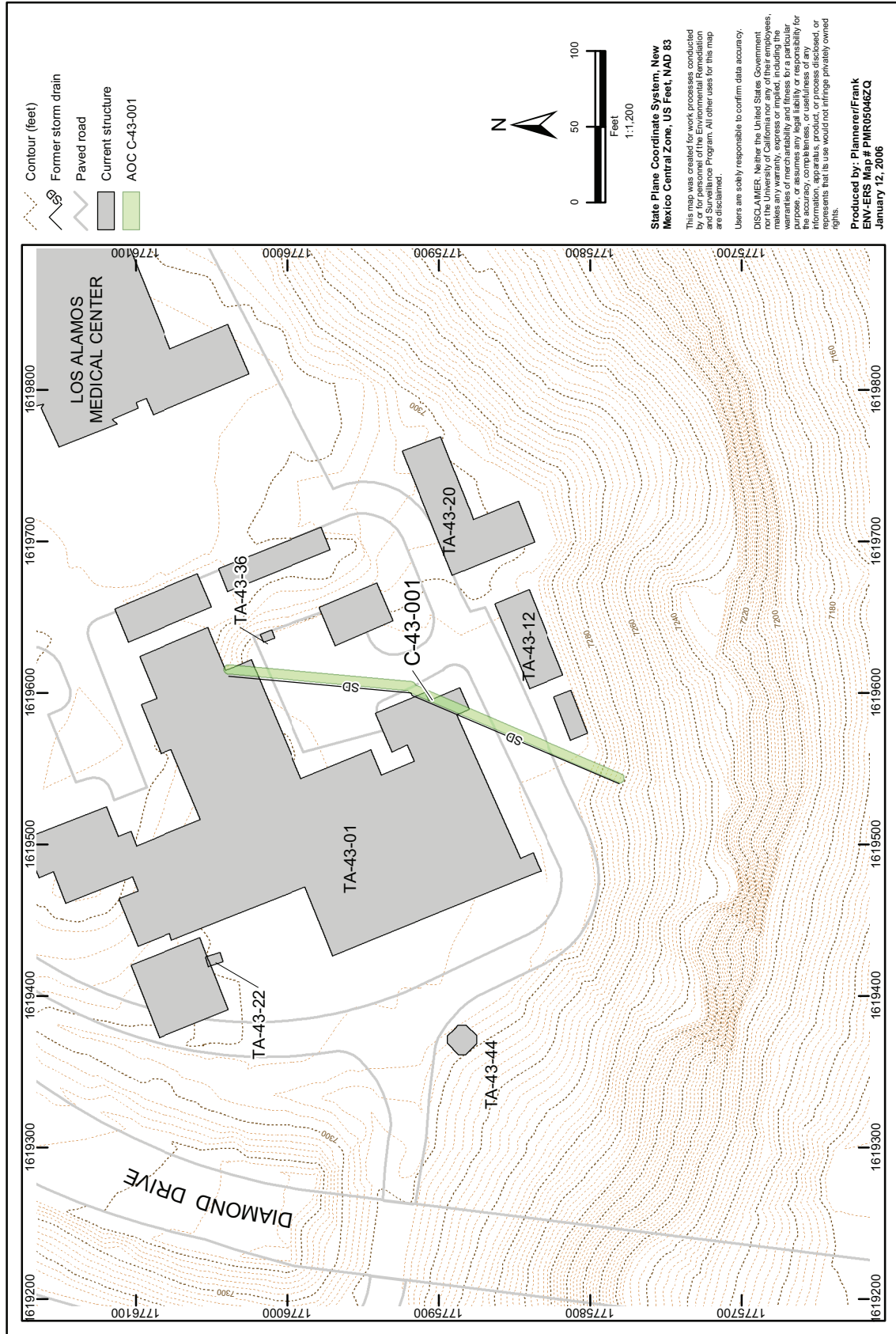

Figure 8.6-1. AOC C-43-001 site map

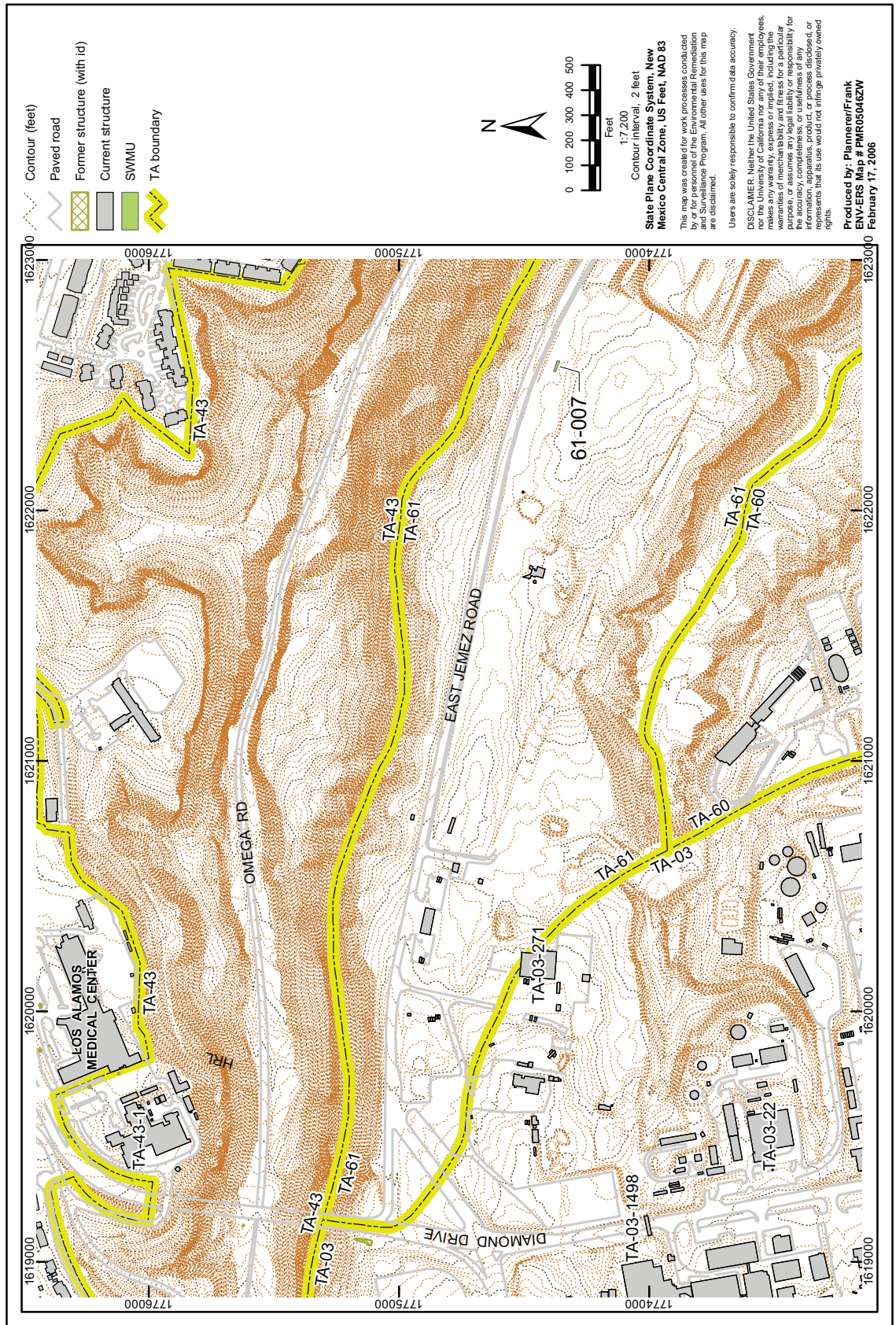

Figure 9.1-1. TA-61 site map



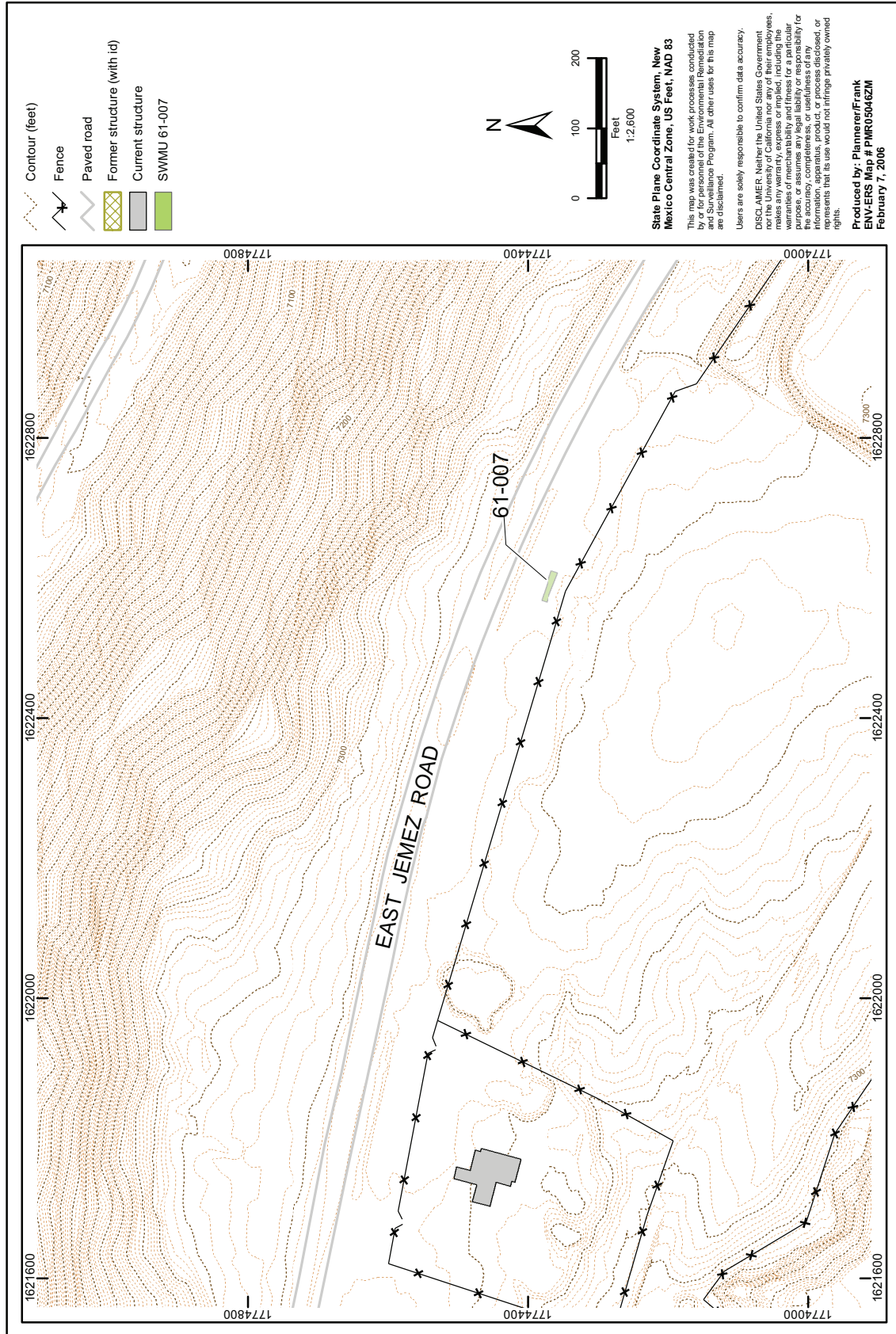

Figure 9.2-1. SWMU 61-007 site map

This page intentionally left blank.