

Figure 1.0-1. Location of Upper Los Alamos Canyon Aggregate Area with respect to Laboratory TAs and surrounding land holdings

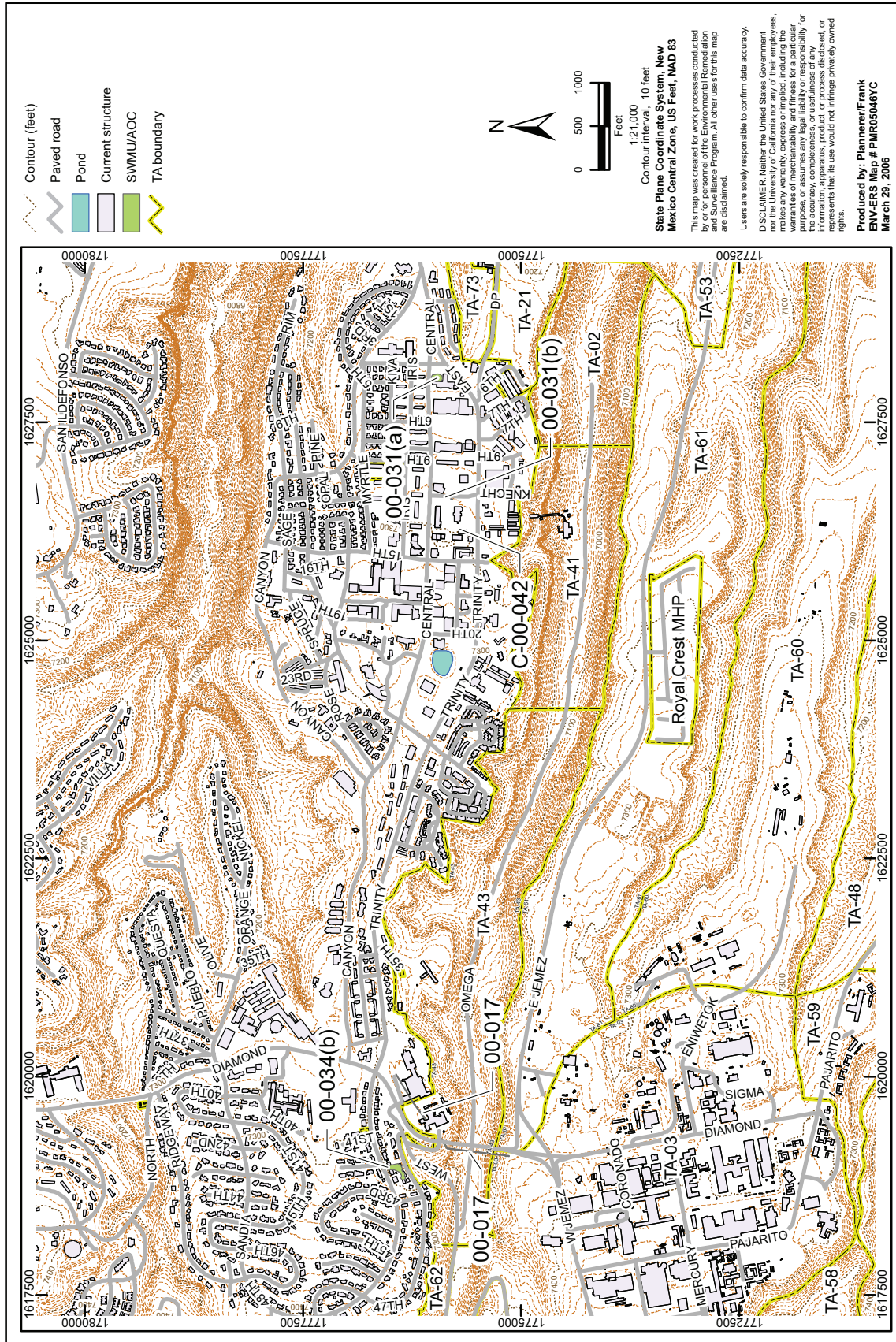

Figure 3.1-1. TA-00 site map

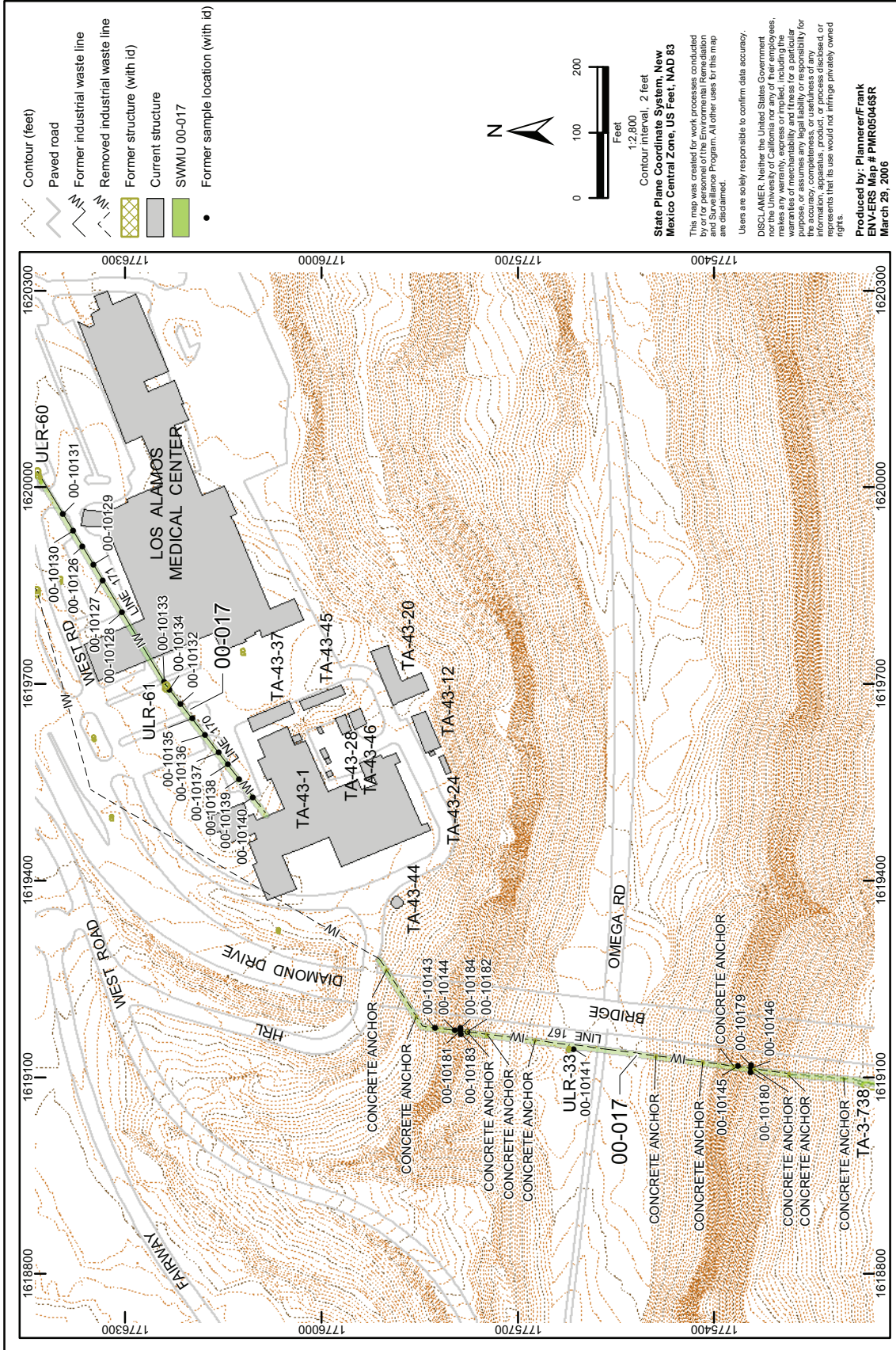

Figure 3.2-1. SWMU 00-017 site map

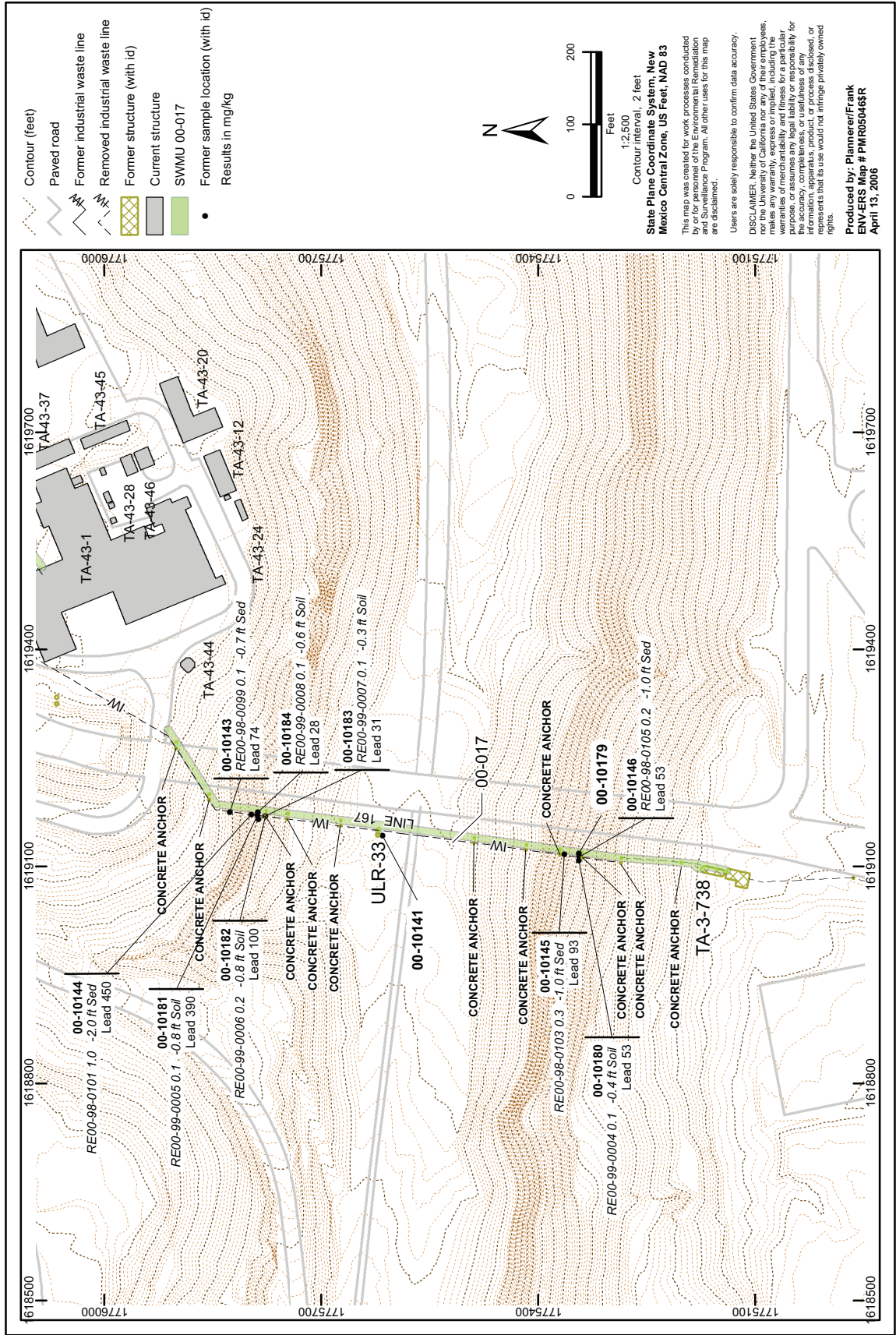

Figure 3.2-2. SWMU 00-017, inorganic chemicals detected greater than BVs at former line 167

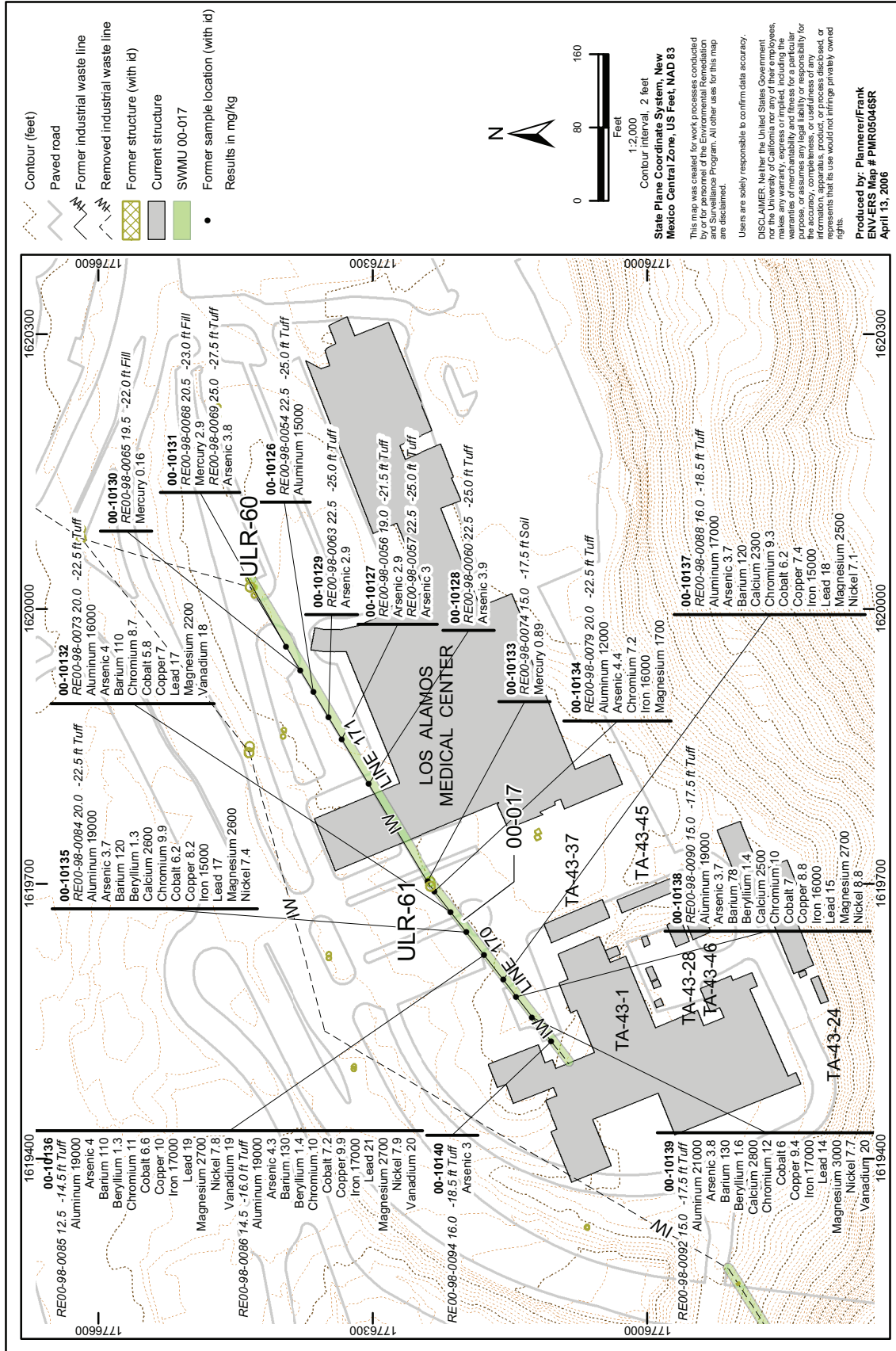

Figure 3.2-3. SWMU 00-017, inorganic chemicals detected greater than BVs at lines 170 and 171

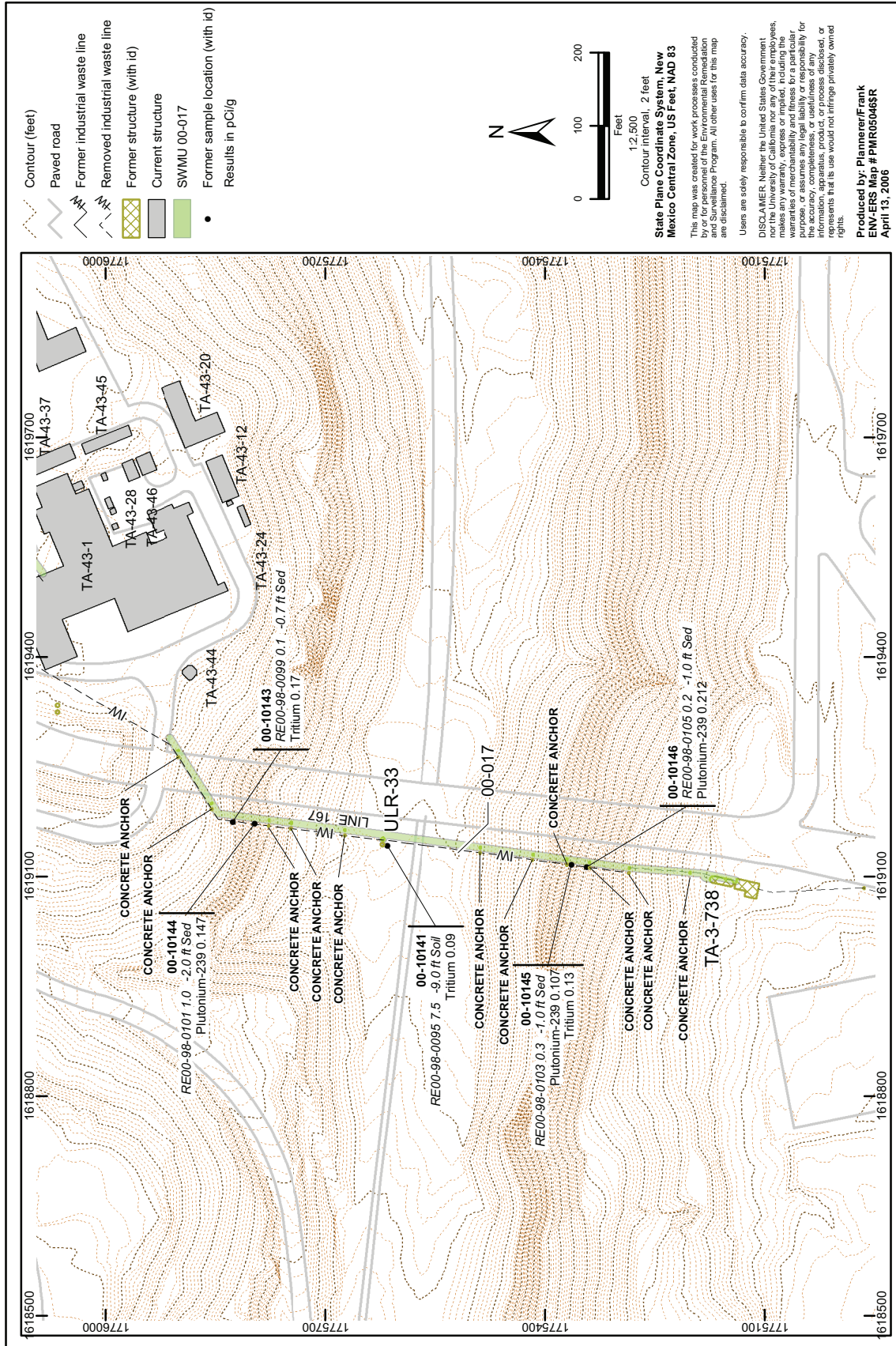

Figure 3.2-4. SWMU 00-017, radionuclides detected greater than BVs, FVs, or where FVs do not apply at former line 167

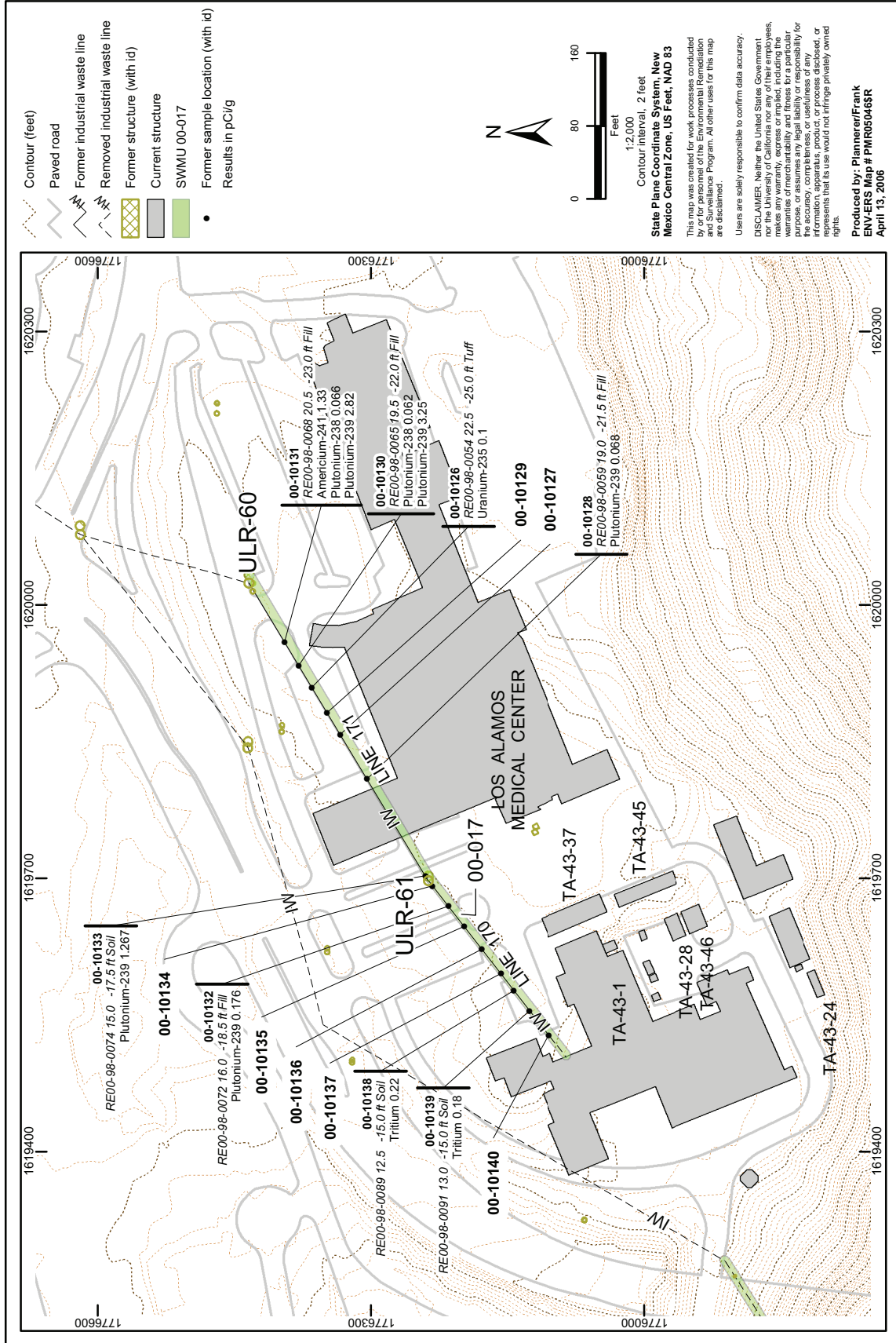

Figure 3.2-5. SWMU 00-017, radionuclides detected greater than BVs, FVs, or where FVs do not apply at lines 170 and 171

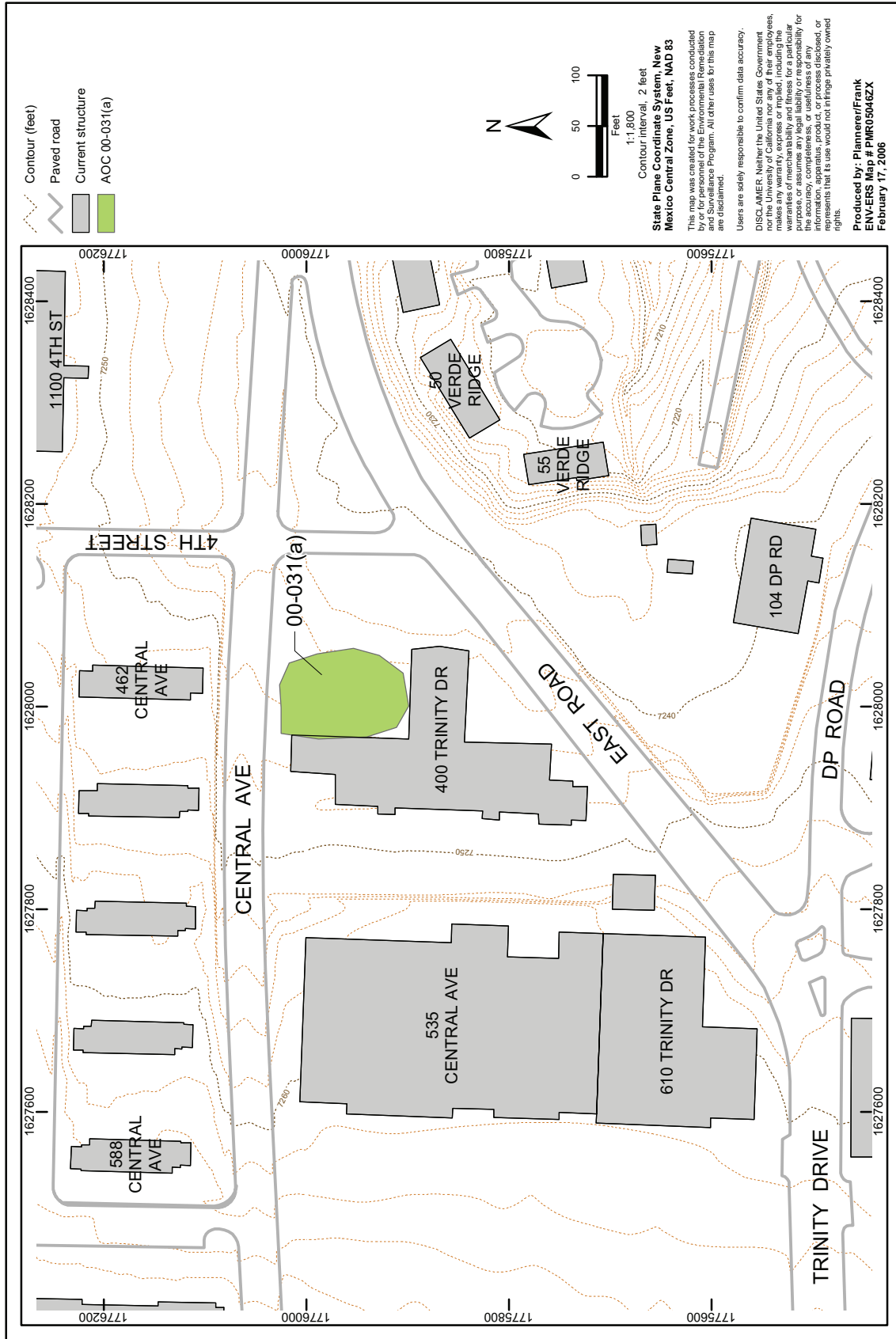

Figure 3.3-1. AOC 00-031(a) site map



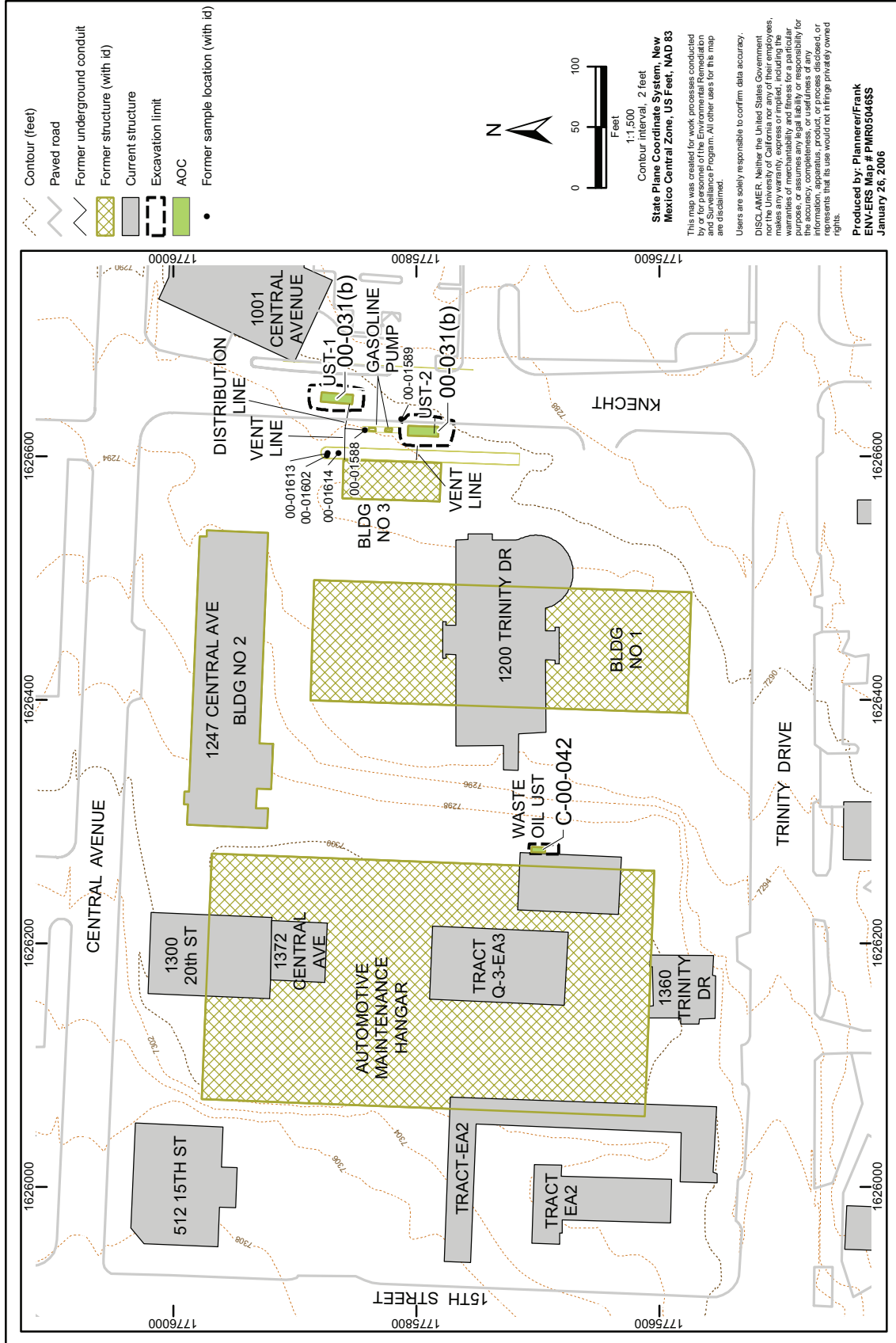

Figure 3.4-1. AOCs 00-031(b) and C-00-042 site map

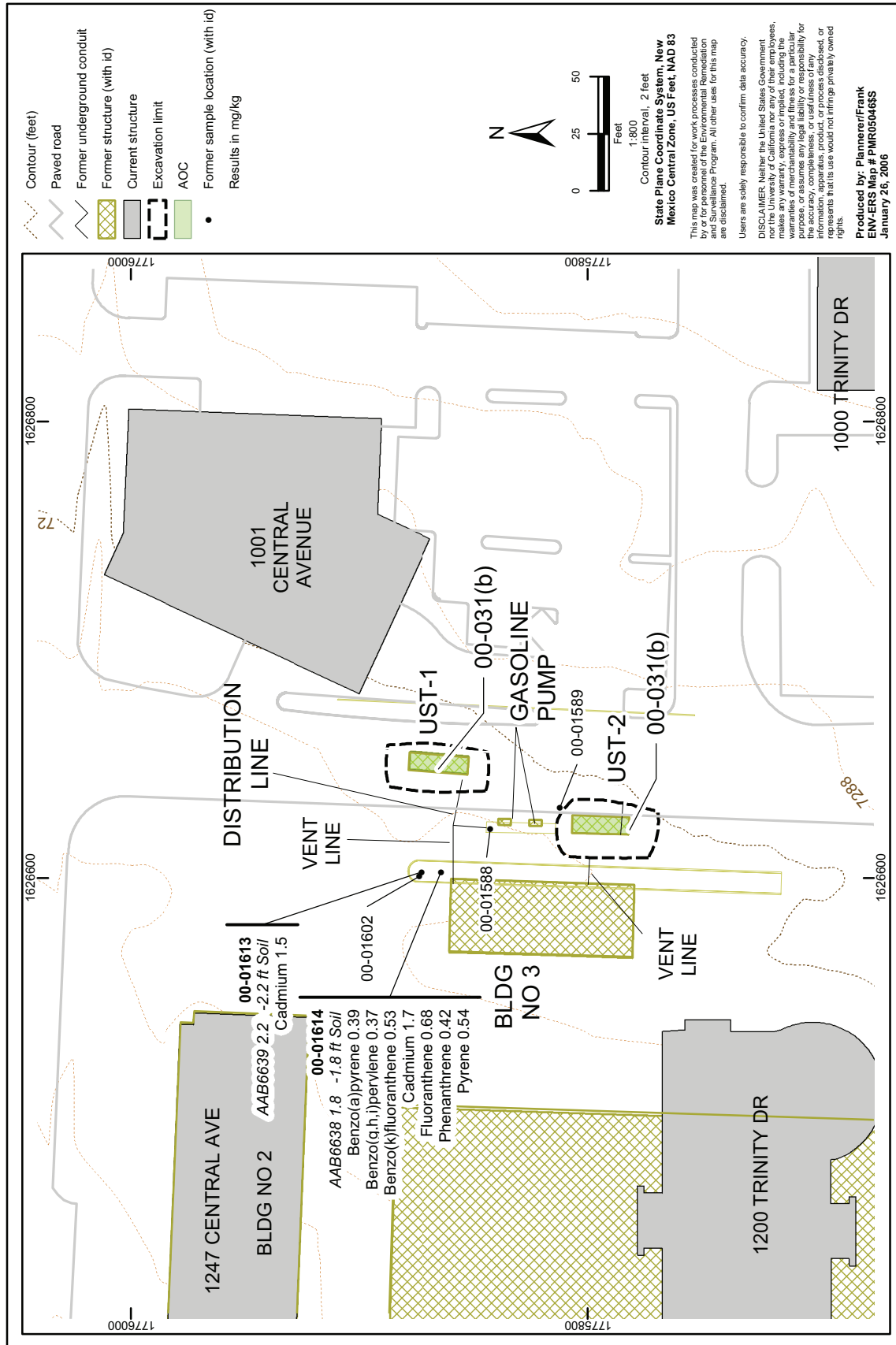

Figure 3.4-2. AOC 00-031(b), inorganic chemicals detected greater than BVs and detected organic chemicals

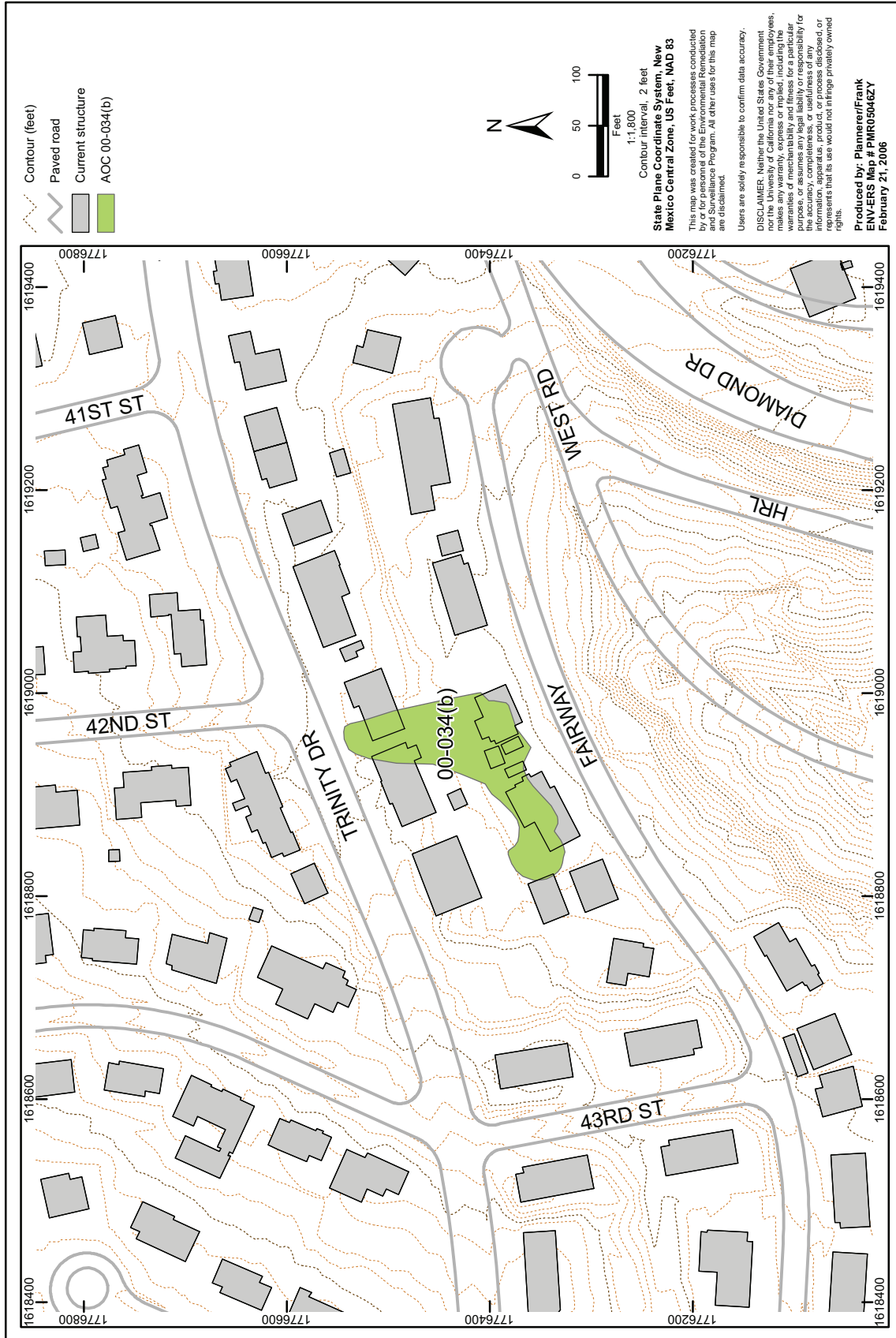

Figure 3.5-1. AOC 00-034(b) site map

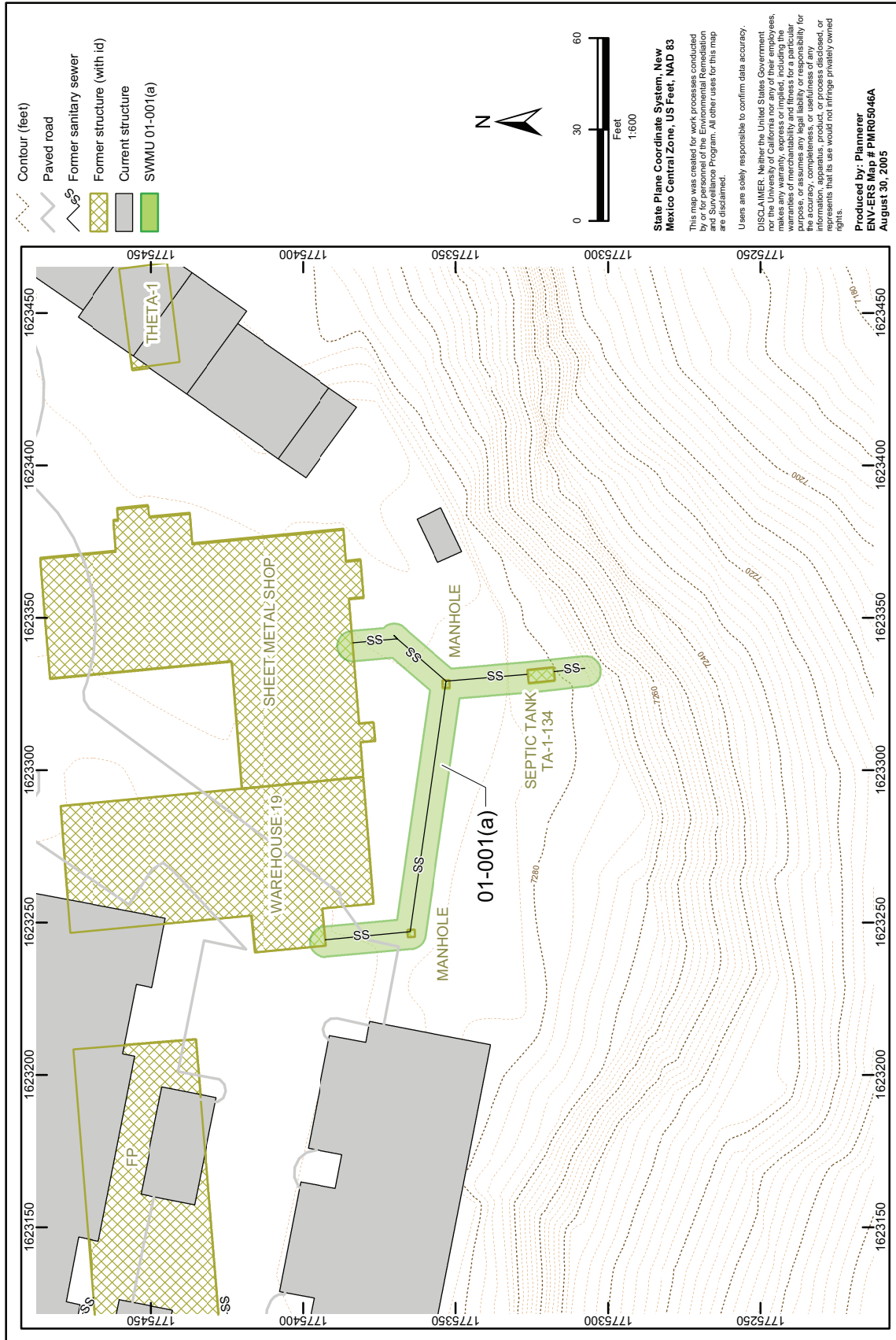

Figure 4.2-1. SWMU 01-001(a) site map

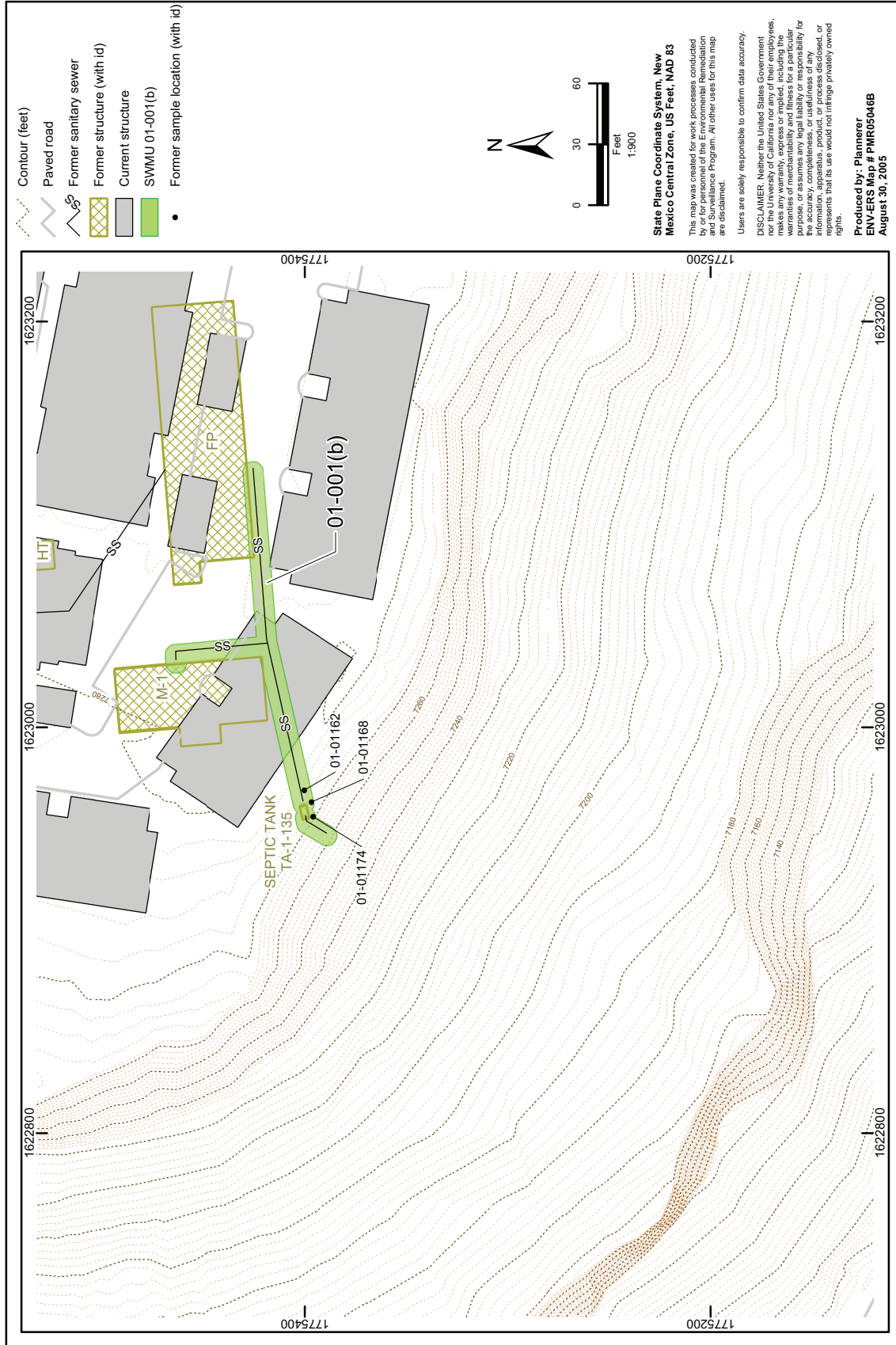

Figure 4.3-1. SWMU 01-001(b) site map

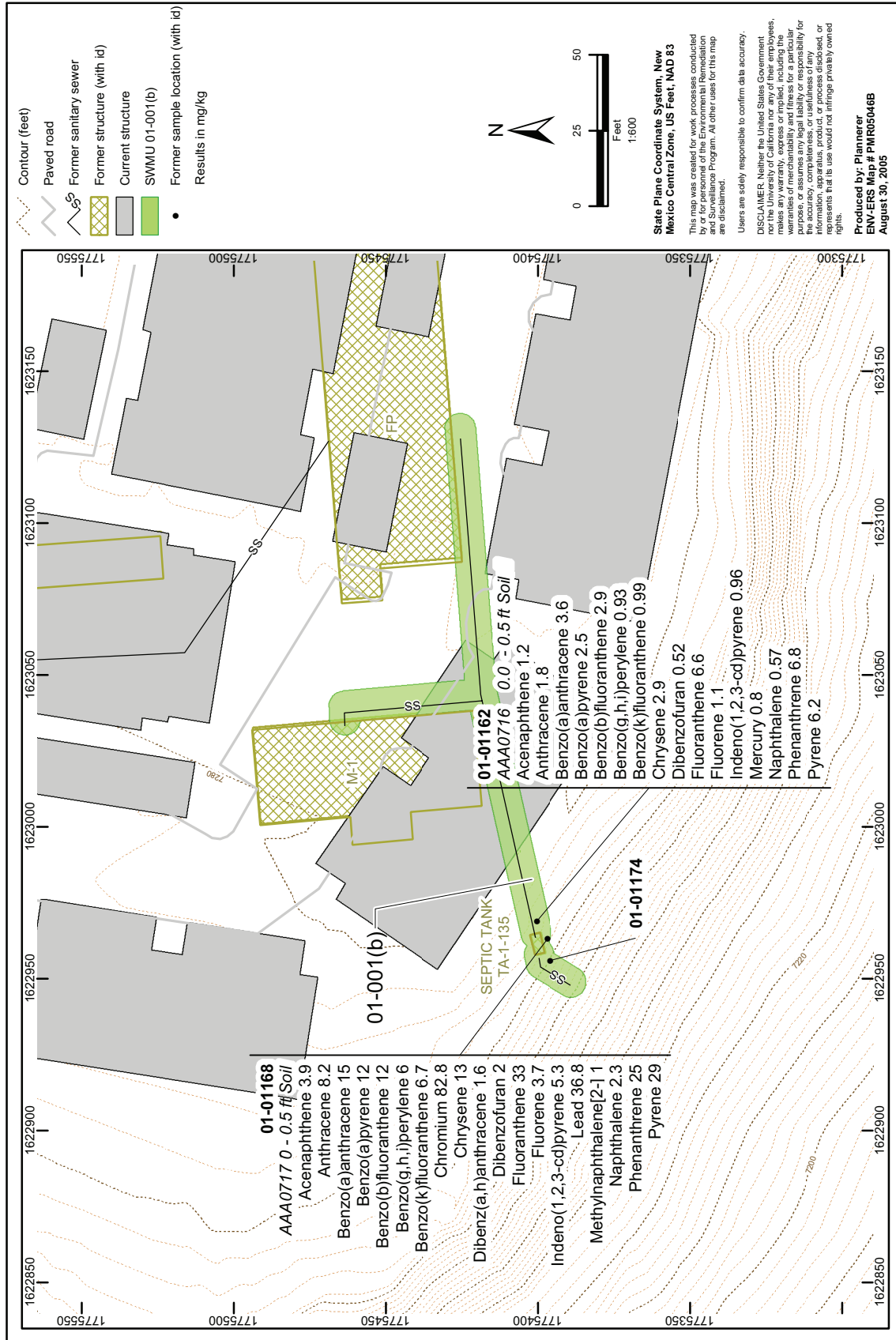

Figure 4.3-2. SWMU 01-001(b), inorganic chemicals detected greater than BVs and detected organic chemicals

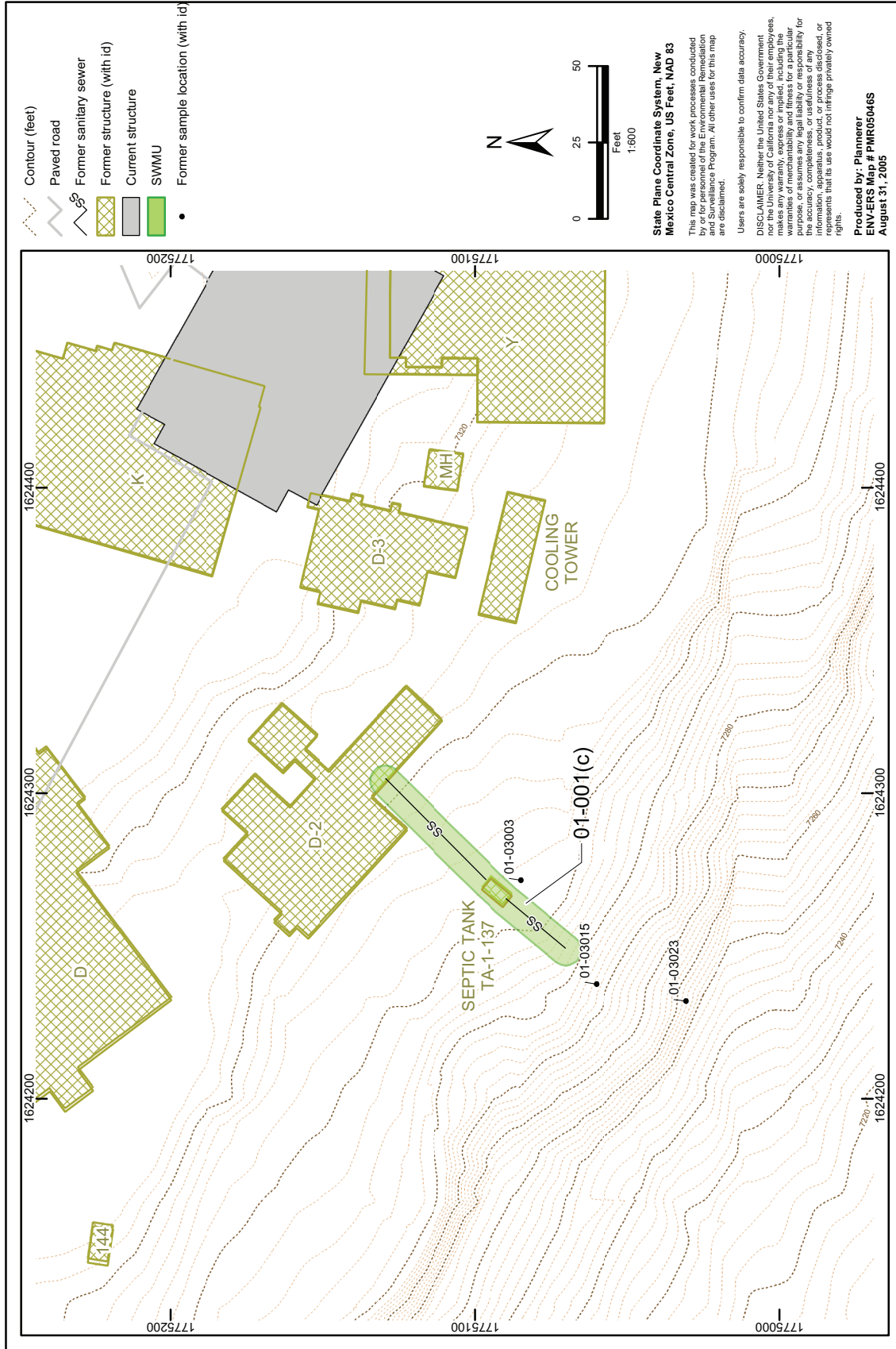

Figure 4.4-1. SWMU 01-001(c) site map

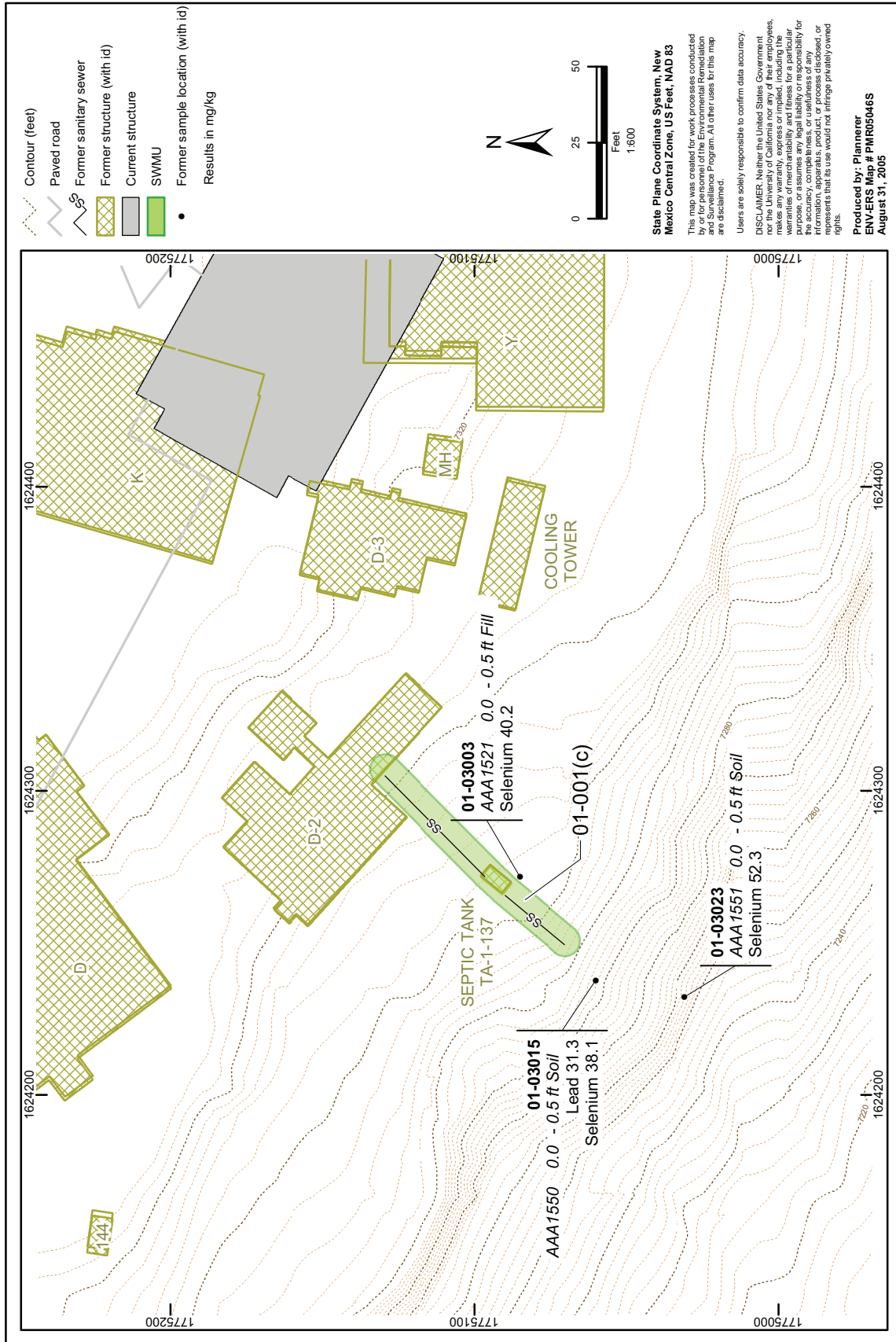

Figure 4.4-2. SWMU 01-001(c), inorganic chemicals detected greater than BVs



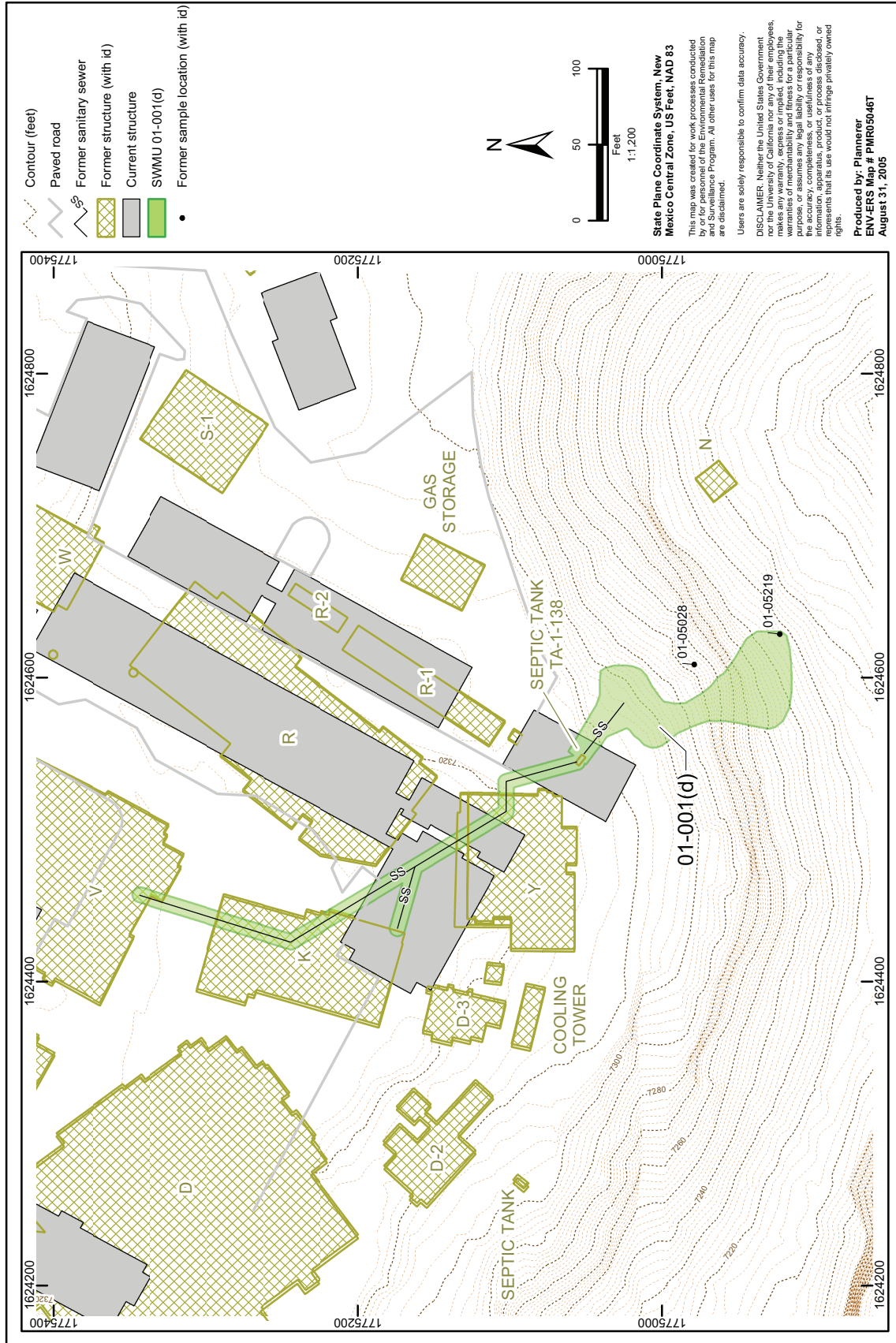

Figure 4.5-1. SWMU 01-001(d) site map

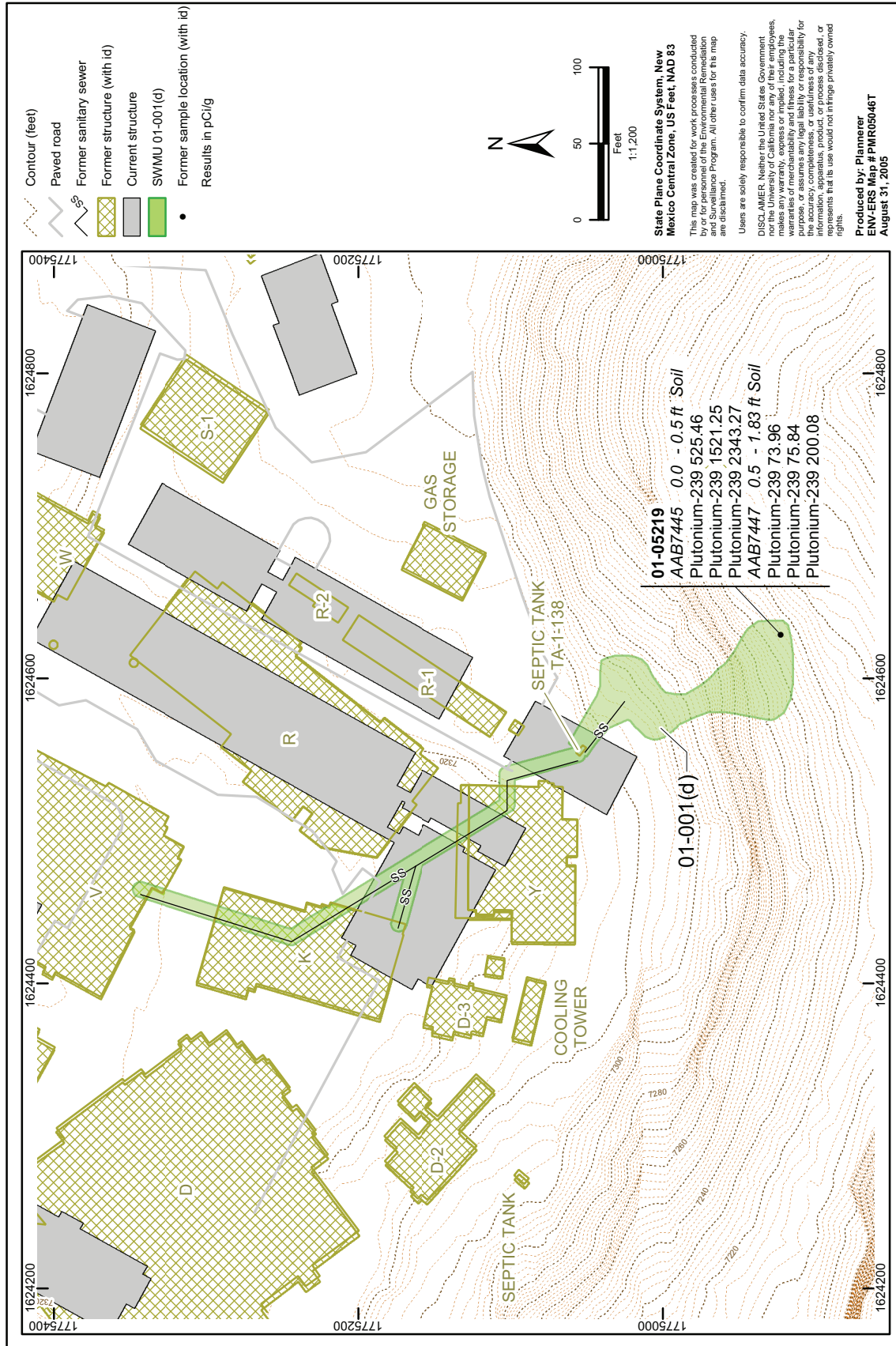

Figure 4.5-2. SWMU 01-001(d), radionuclides detected greater than FVs or where FVs do not apply

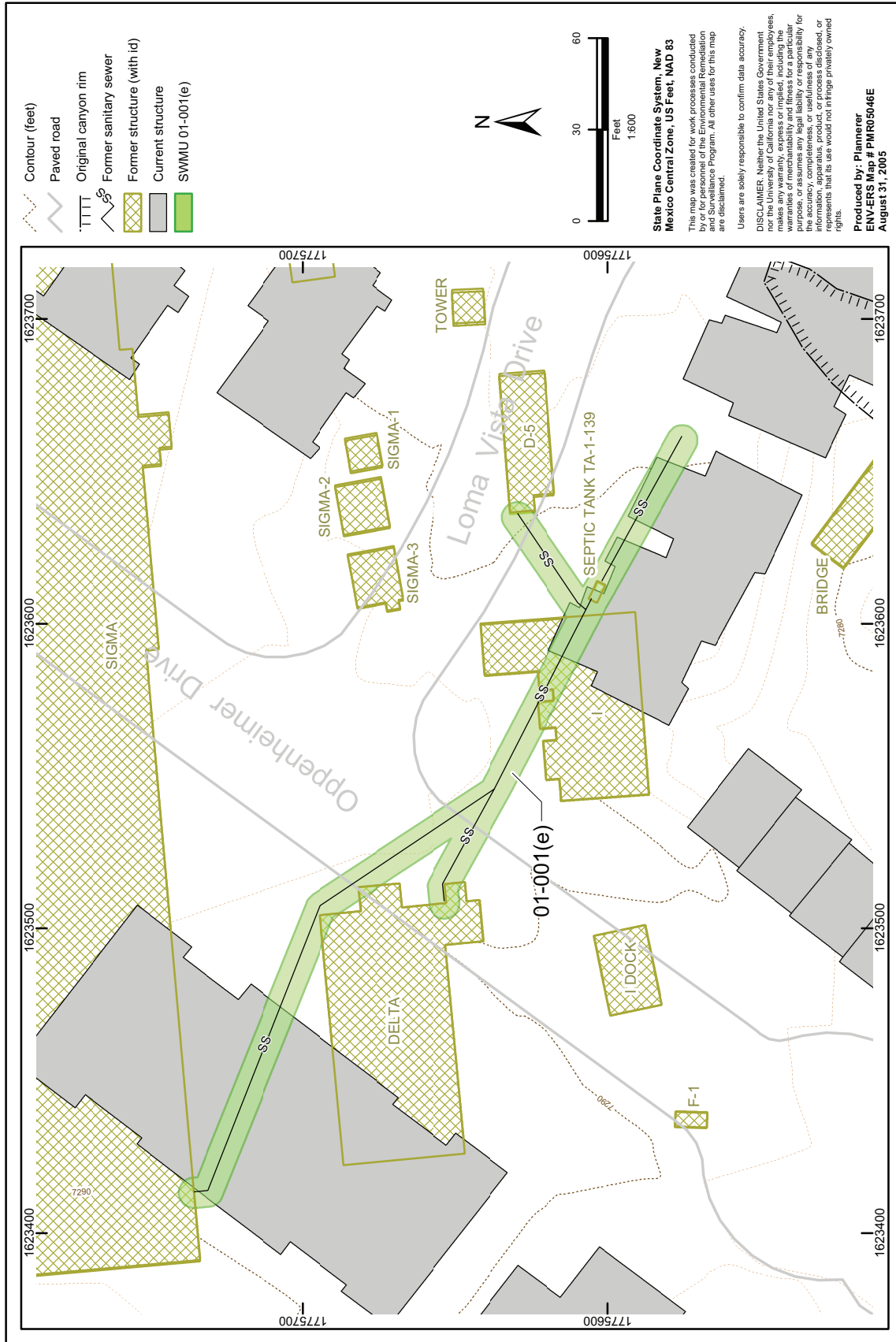

Figure 4.6-1. SWMU 01-001(e) site map

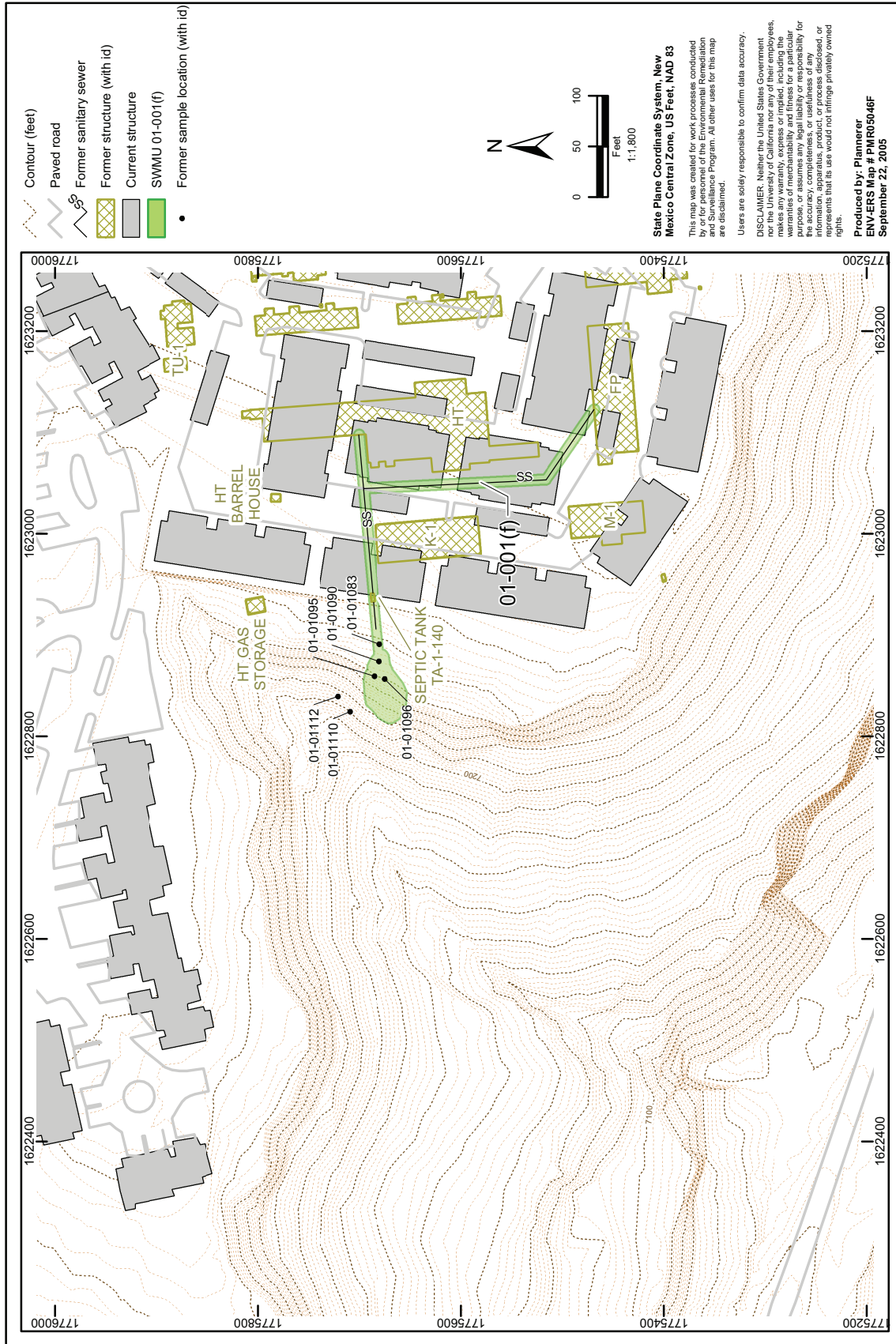

Figure 4.7-1. SWMU 01-001(f) site map

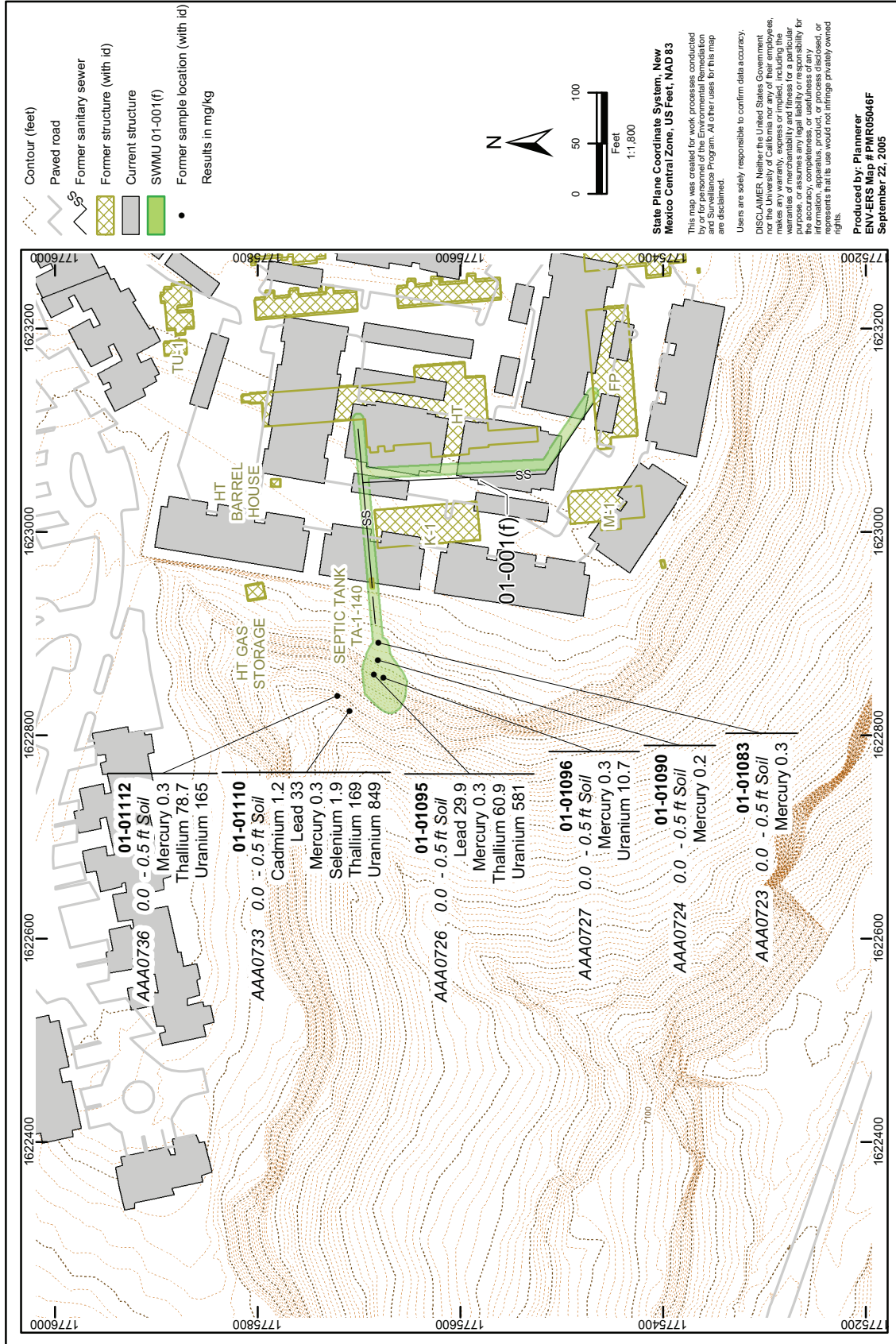

Figure 4.7-2. SWMU 01-001(f), inorganic chemicals detected greater than BVs

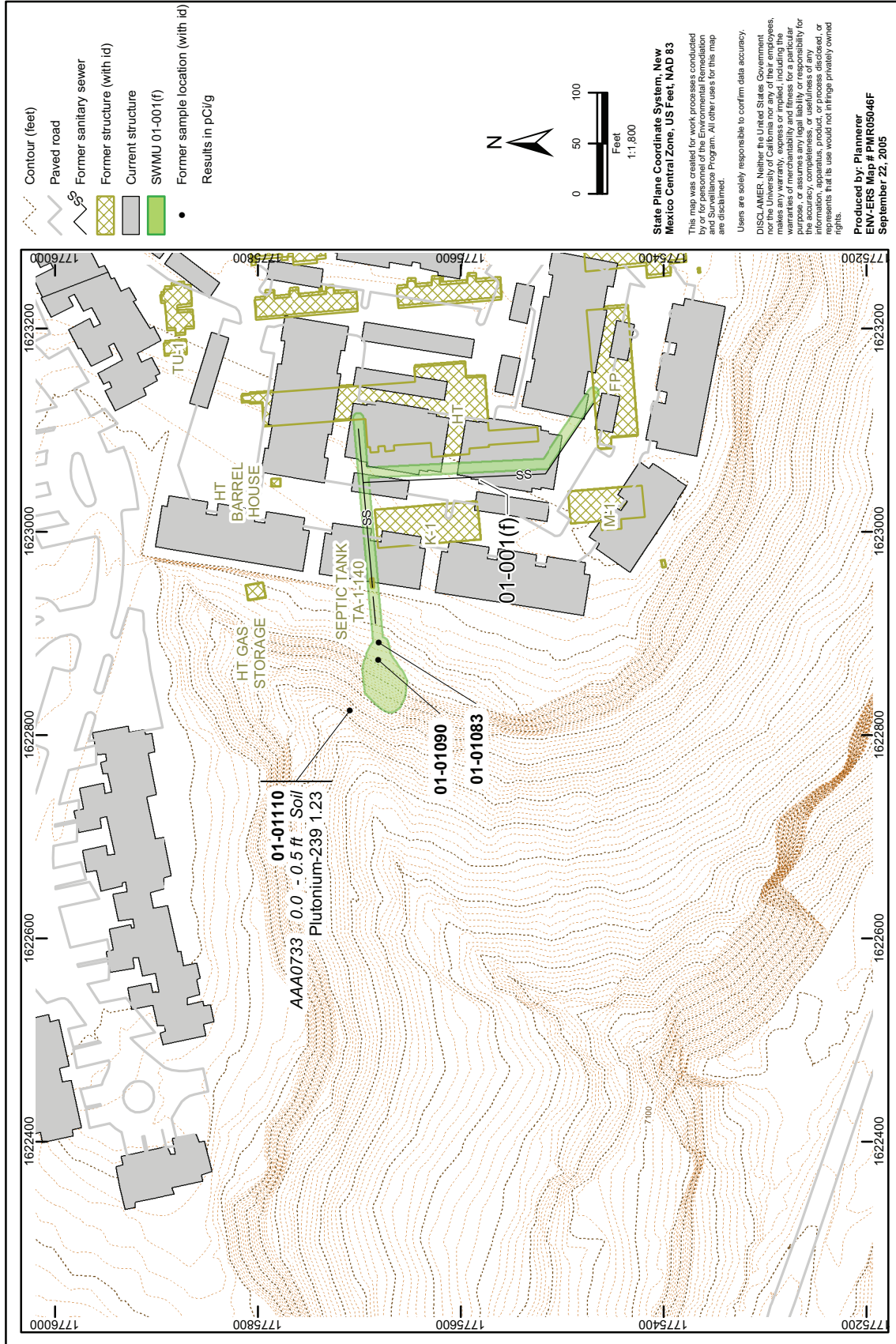

Figure 4.7-3. SWMU 01-001(f), radionuclide detected greater than FV

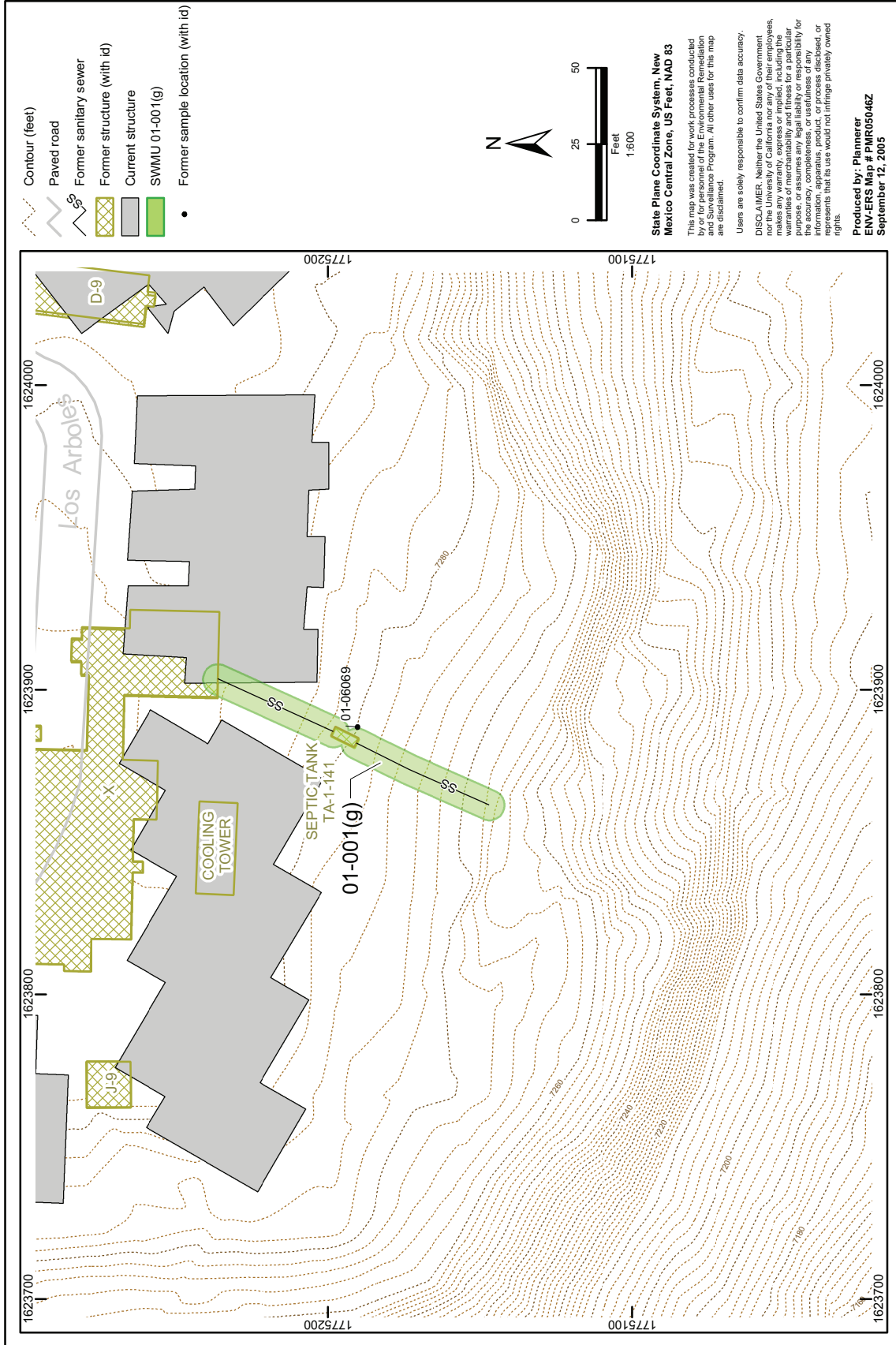

Figure 4.8-1. SWMU 01-001(g) site map

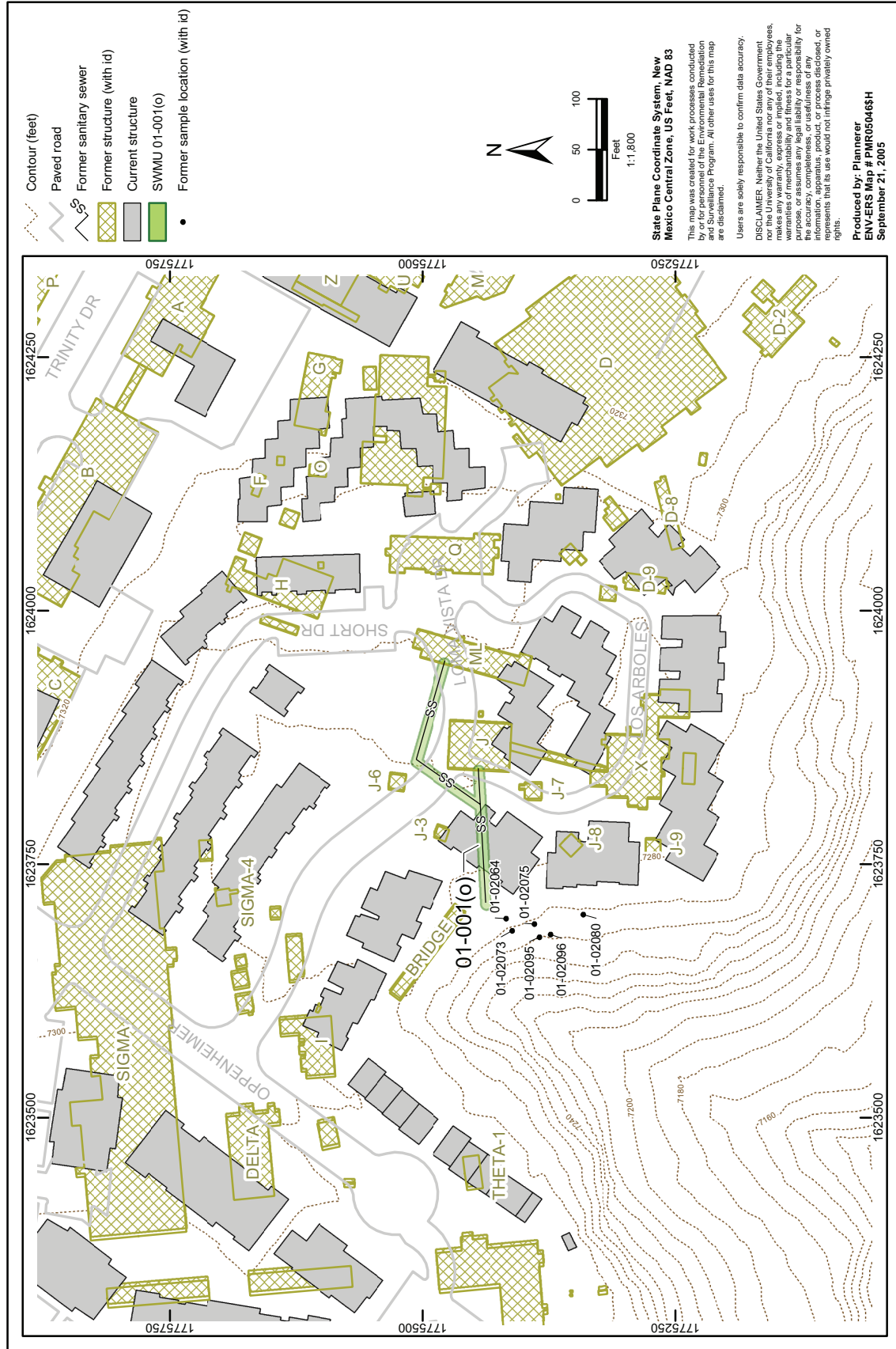

Figure 4.9-1. SWMU 01-001(o) site map



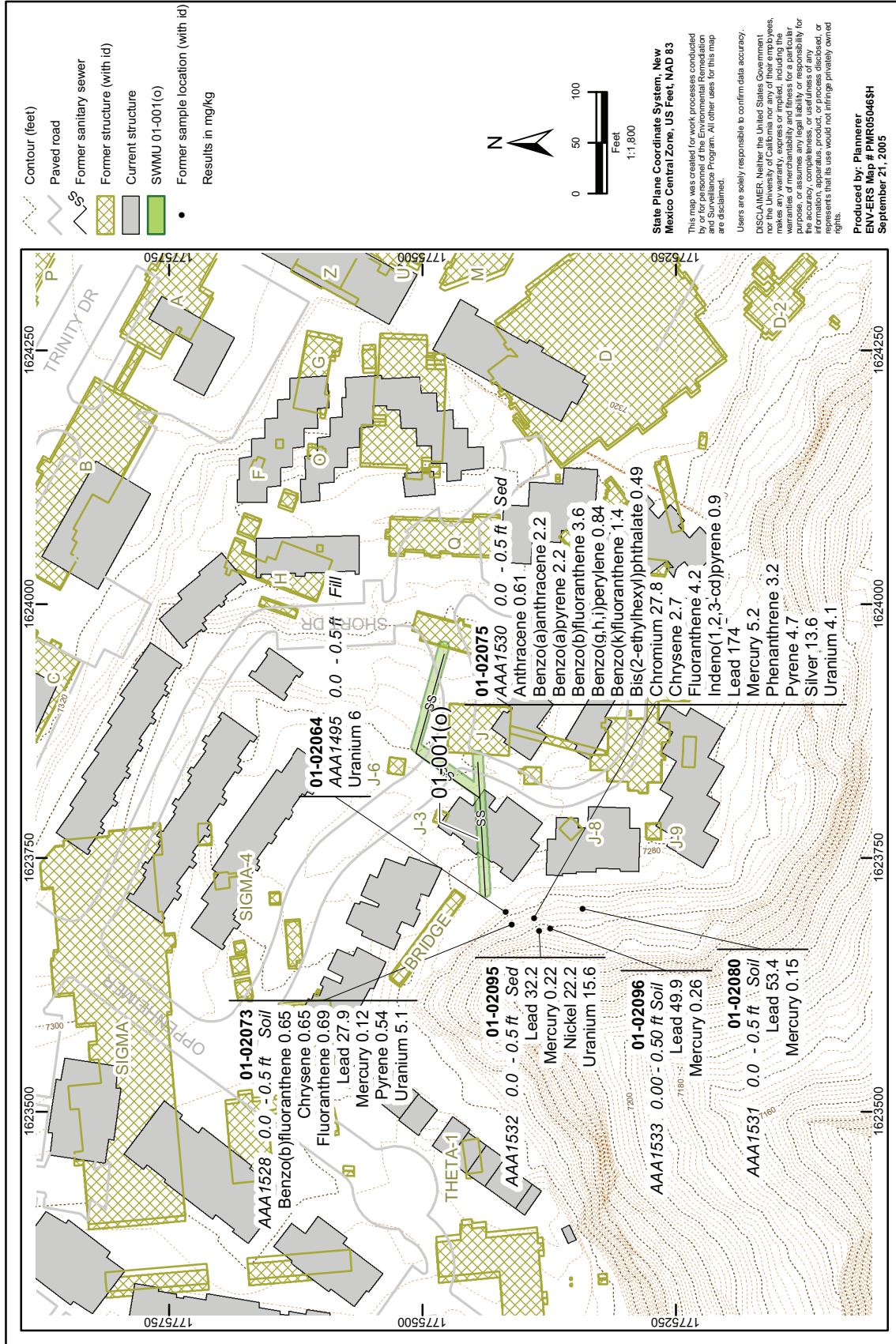

Figure 4.9-2. SWMU 01-001(o), inorganic chemicals detected greater than BVs and detected organic chemicals

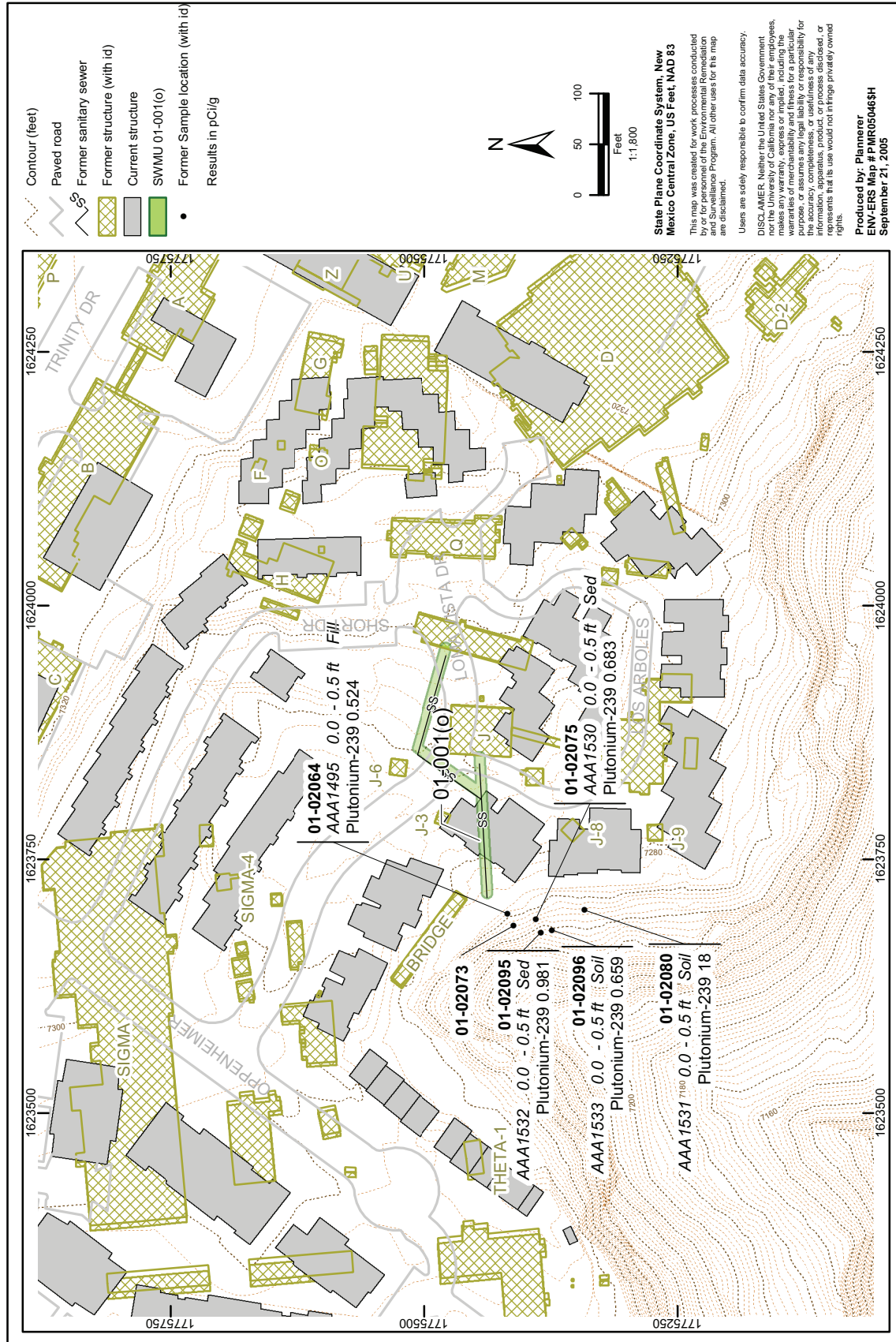

Figure 4.9-3. SWMU 01-001(o), radionuclide detected greater than FV

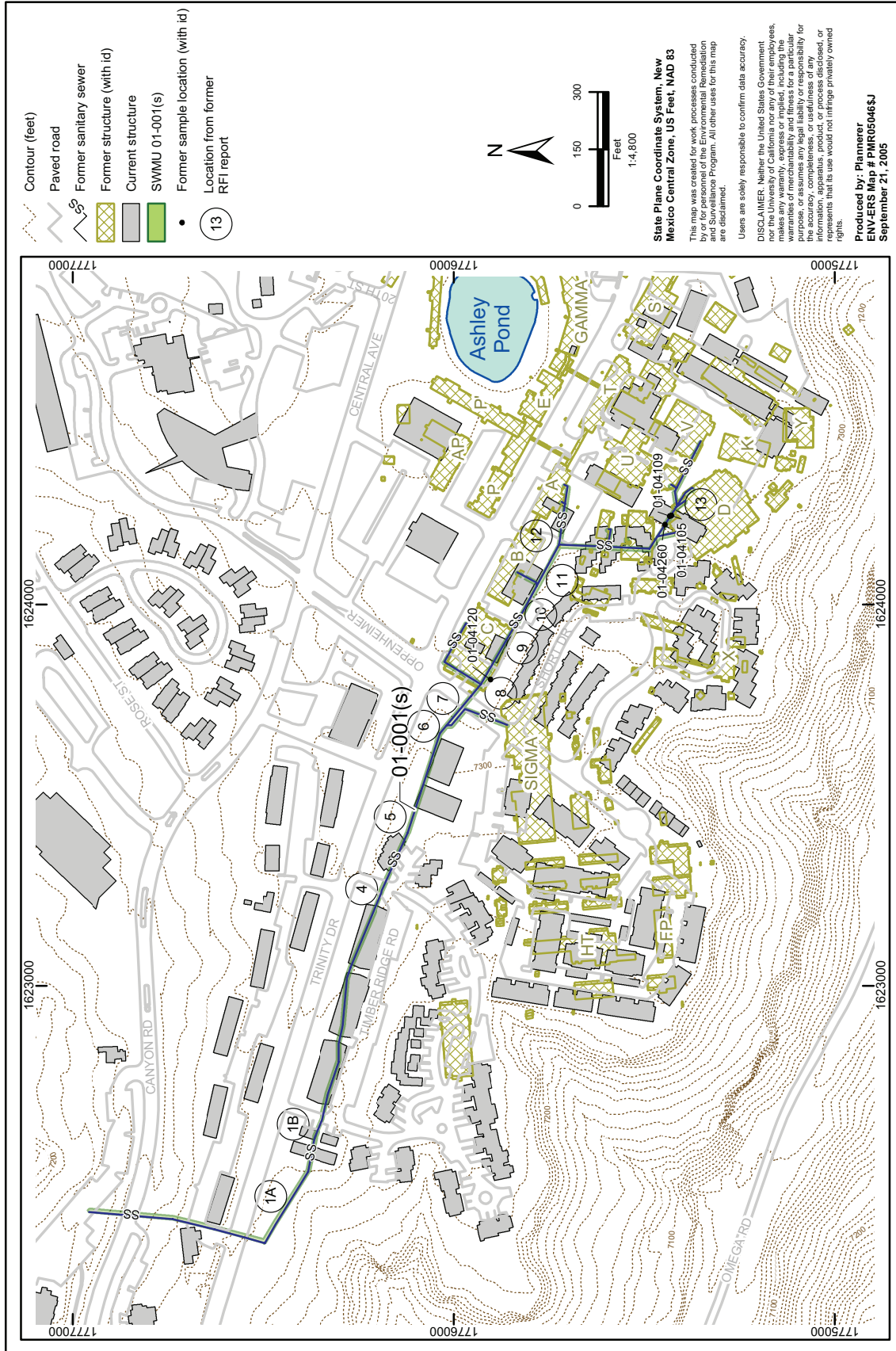

Figure 4.10-1. SWMU 01-001(s) site map

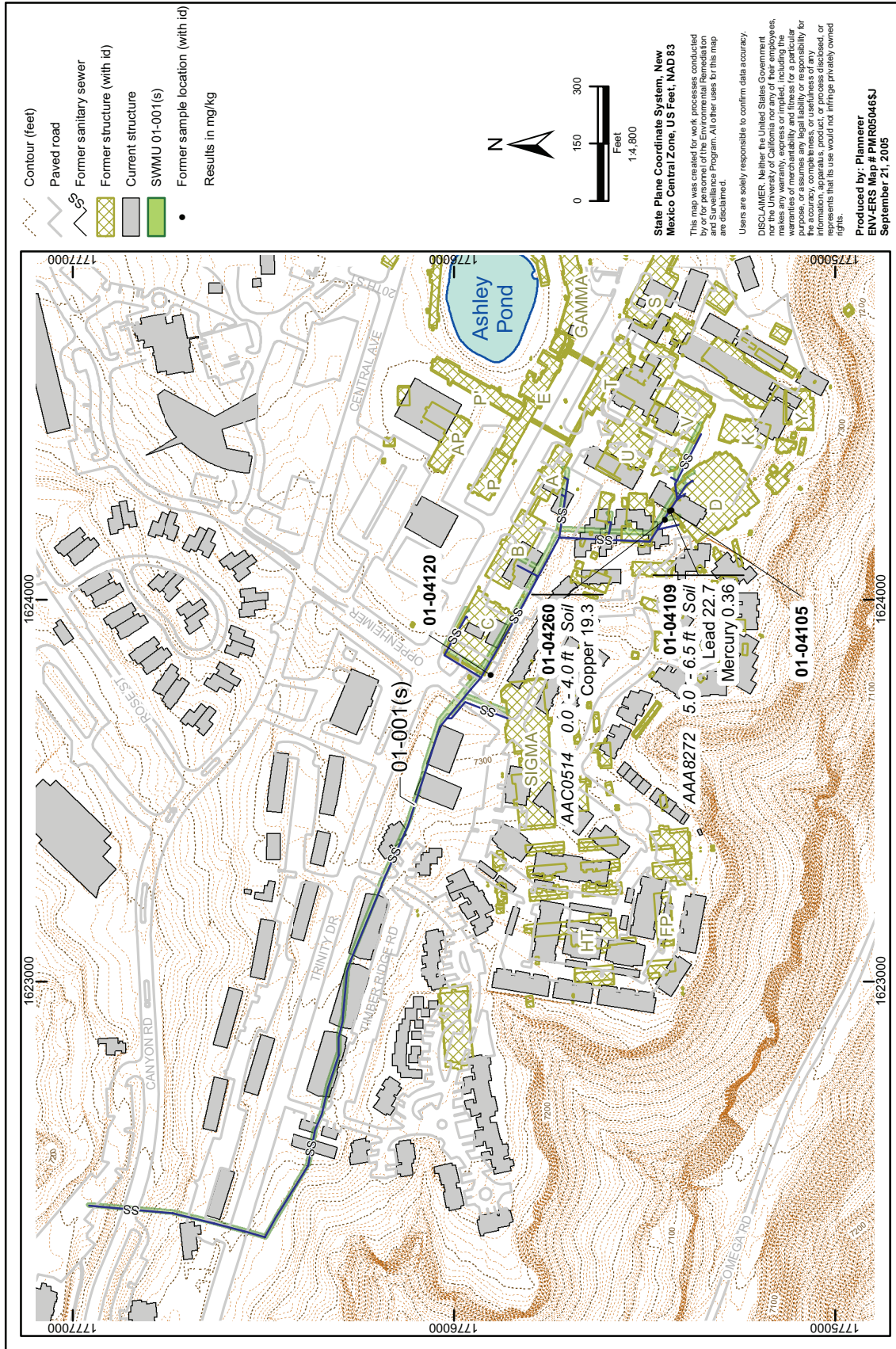

Figure 4.10-2. SWMU 01-001(s), inorganic chemicals detected greater than BVs